

**COVERS SHOULD REMAIN ON MATTRESS OR BOXSPRING FOR AT LEAST 1 YEAR TO ACHIEVE MAXIMUM EFFECTIVENESS.**

---

## **INSTALLATION INSTRUCTIONS:**

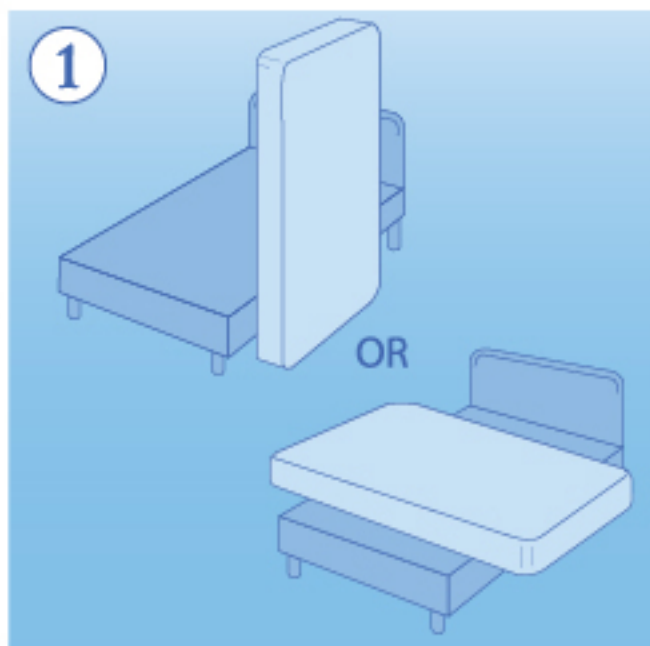

**Stand mattress or  
boxspring on end**

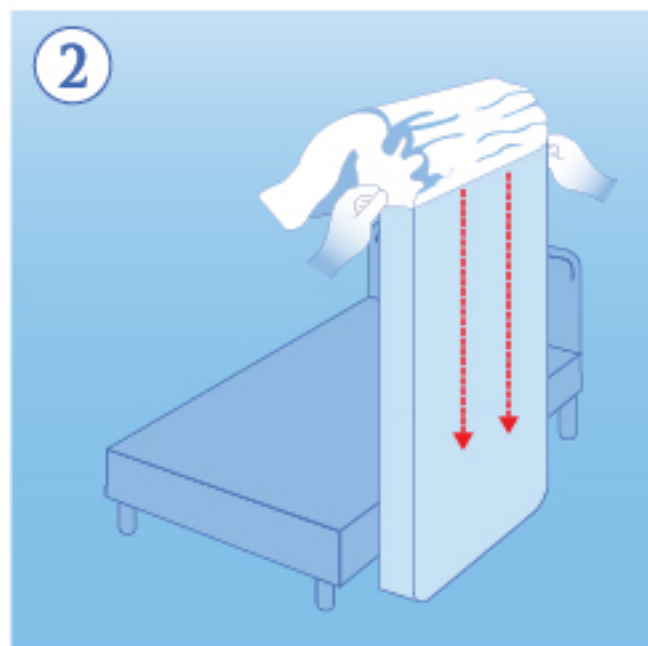

**Gently ease the cover over the end  
of the mattress or boxspring.  
Do not pull the cover from the end,  
especially not from the zipper.**

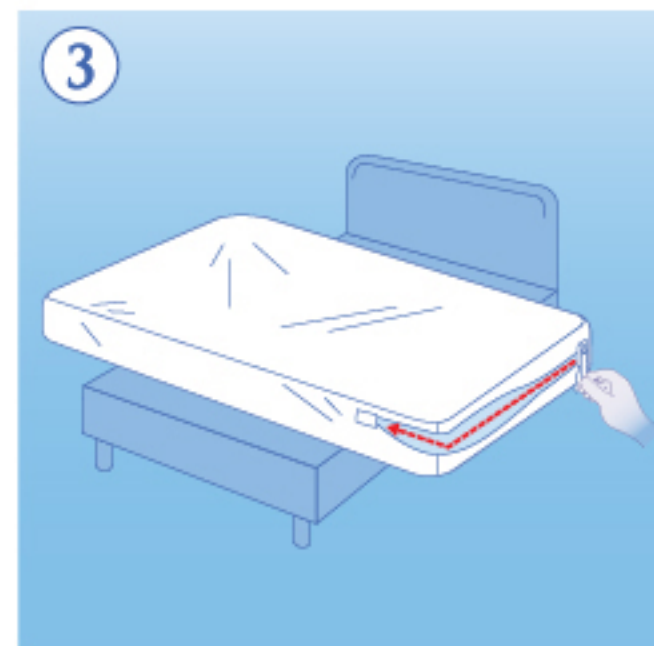

**Once the cover is completely on,  
gently pull taut.**

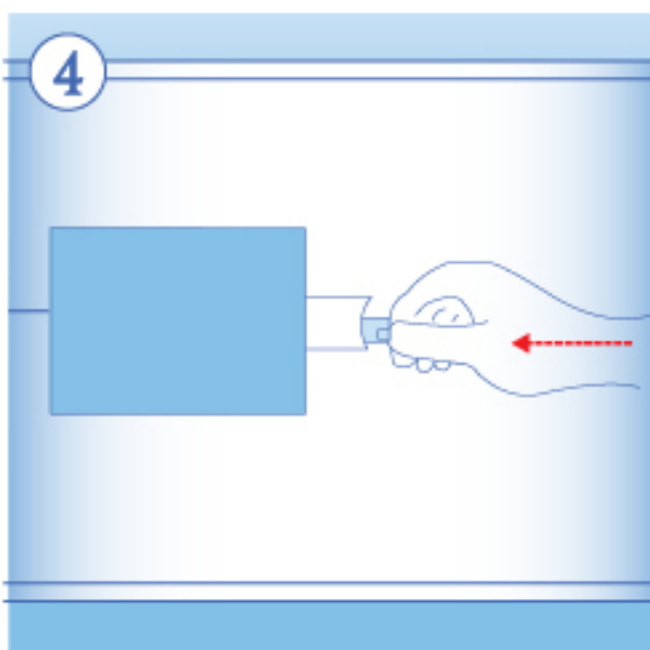

**Gently close the zipper**

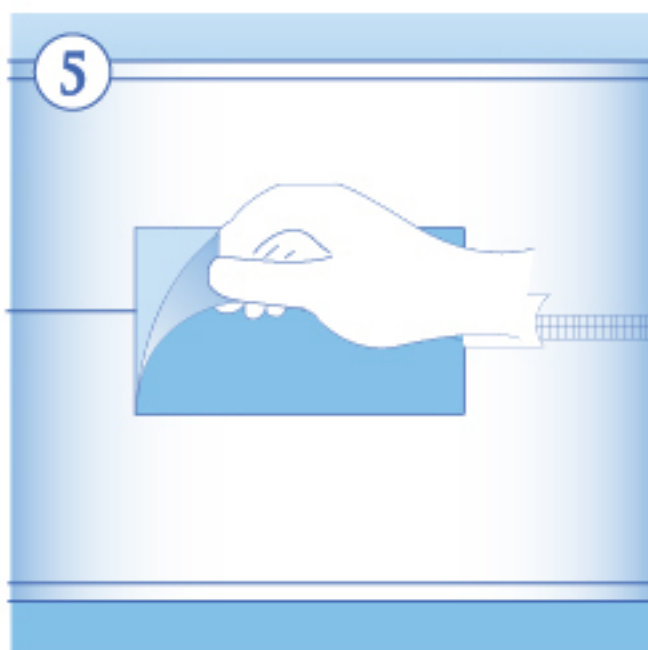

**Peel the protective backing**



**Place the tape over the zipper**