

Starck 3 Tank # 0920400004

| < 15 3/8" Inch > |

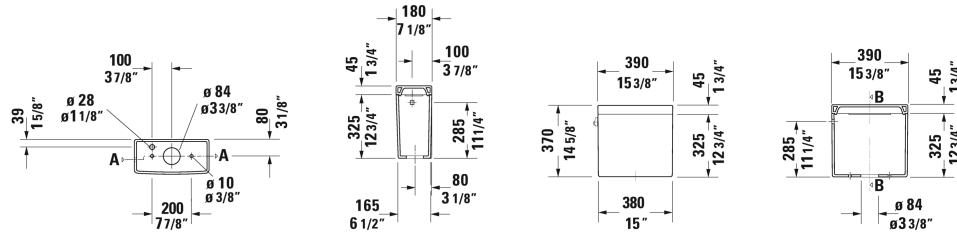

Tank	Dimension	Weight	Order number
with single flush mechanism, with side lever, 3" flapper valve, bottom left supply, WaterSense® listed, cUPC® listed*			
Colors			
00 White			
Variant			
◆ 1.28 gpf	15 3/8" x 7 1/8" Inch	30.4 lb	0920400004
Infobox			
* Complies with following standards: ASME A112.19.2/CSA B45.1, Not available with WonderGliss			
Suitable products			
Two-Piece toilet (without tank), suitable for SensoWash Starck, syphonic, 12" rough-in, vertical outlet, cUPC® listed*, WaterSense® listed, 1.28 gpf, 14 5/8" x 27 3/4" Inch	14 5/8" x 27 3/4" Inch		212501

All drawings contain the necessary measurements which are subject to standard tolerances. They are stated in inch & mm and are non-binding. Exact measurements, in particular for customized installation scenarios, can only be taken from the finished ceramic piece.