

Product & Packaging Specs

2" Standard Rafter Clip (RC-IW-2)

Item #: 51717

ITEM NO.	QTY.	PART NUMBER	DESCRIPTION
1	2	80014	Screw, FHP #12 X 1.25", Black
2	1	51717-11	Clip, 2" Rafter

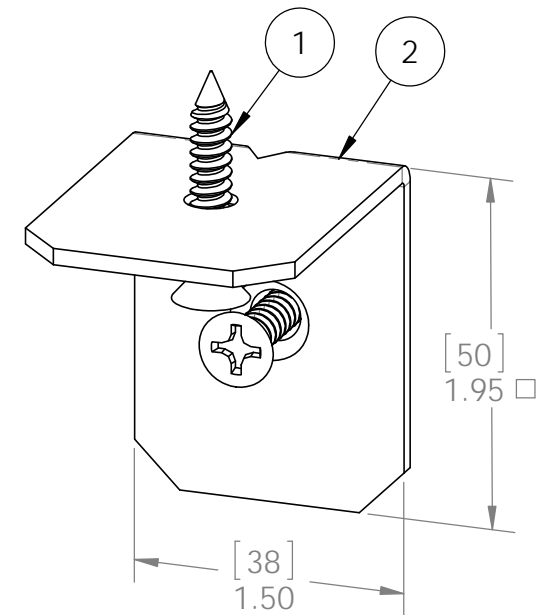
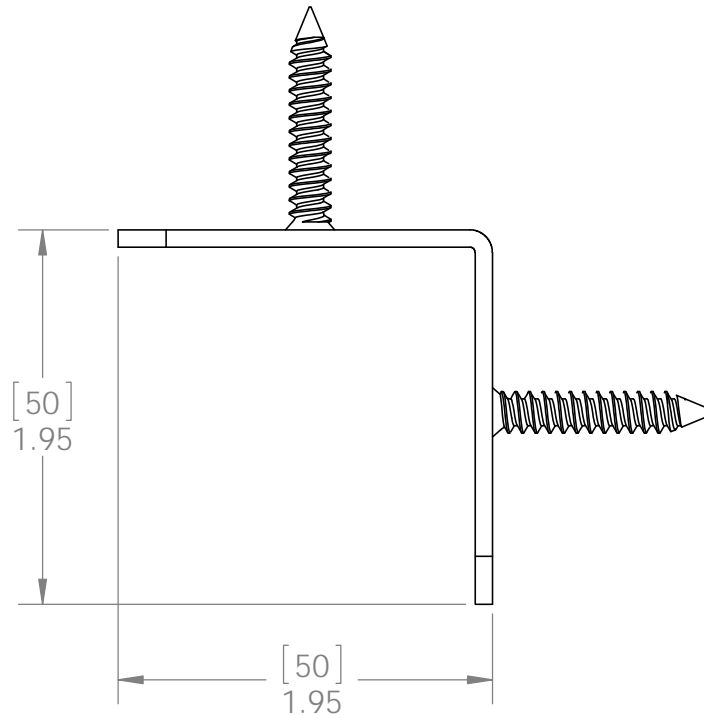
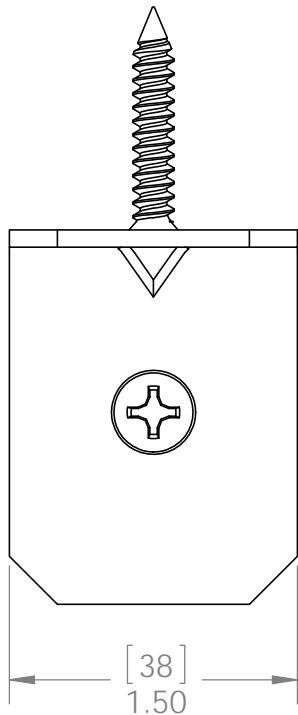

Weight: 2.87 LBS
Scale: 1:1
Last updated: 9/12/2015

51717

Product & Packaging Specs

2" Standard Rafter Clip (RC-IW-2)

Item #: 51717

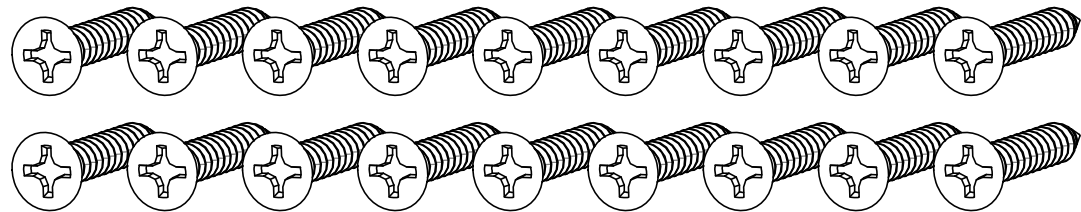
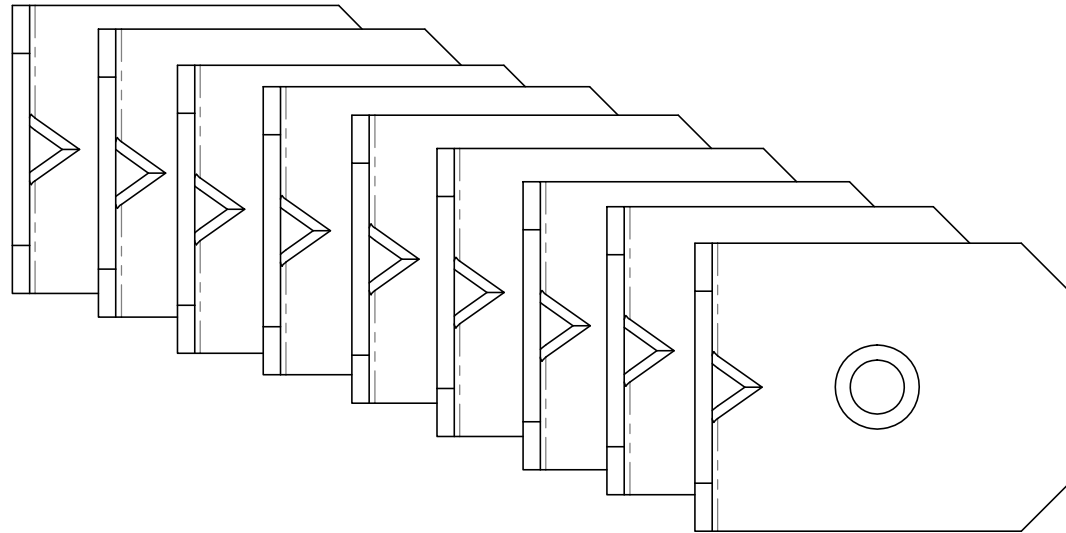
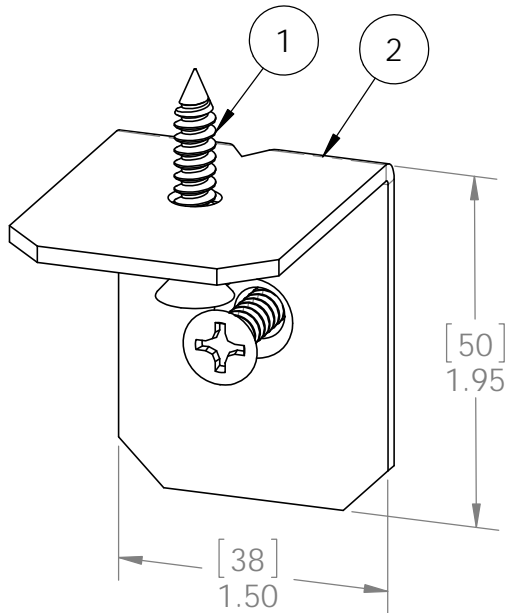

Weight: 2.87 LBS
Scale: 1:1
Last updated: 9/12/2015

51717

Product & Packaging Specs

2" Standard Rafter Clip (RC-IW-2)

Item #: Typical Installation & Basic Assembly

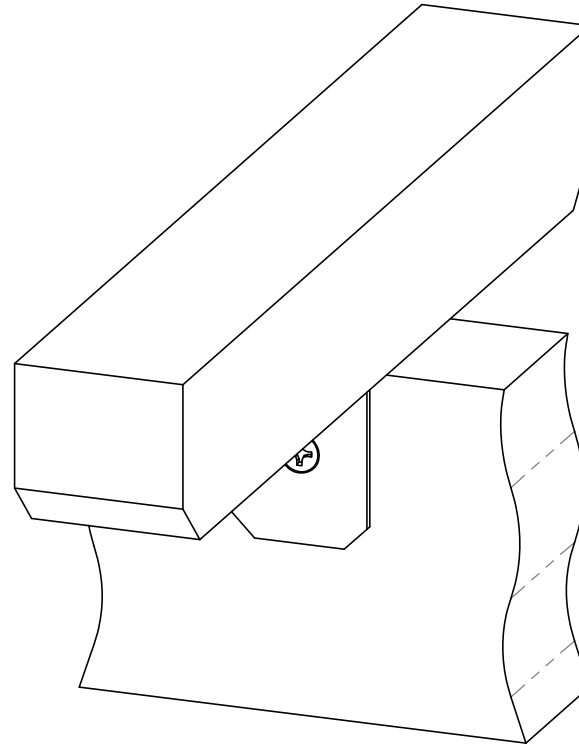
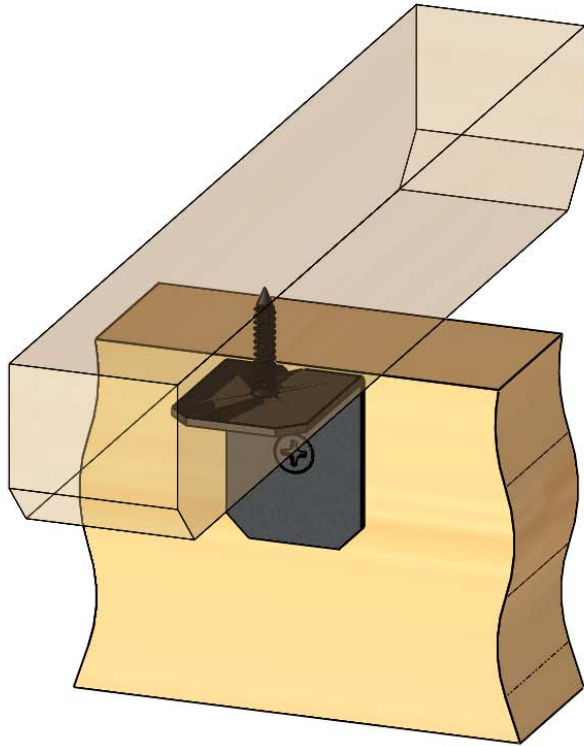

Scale: 1:2
Last updated: 9/12/2015

51717

Product & Packaging Specs

2" Standard Rafter Clip (RC-IW-2)

Item #: Typical Installation & Basic Assembly

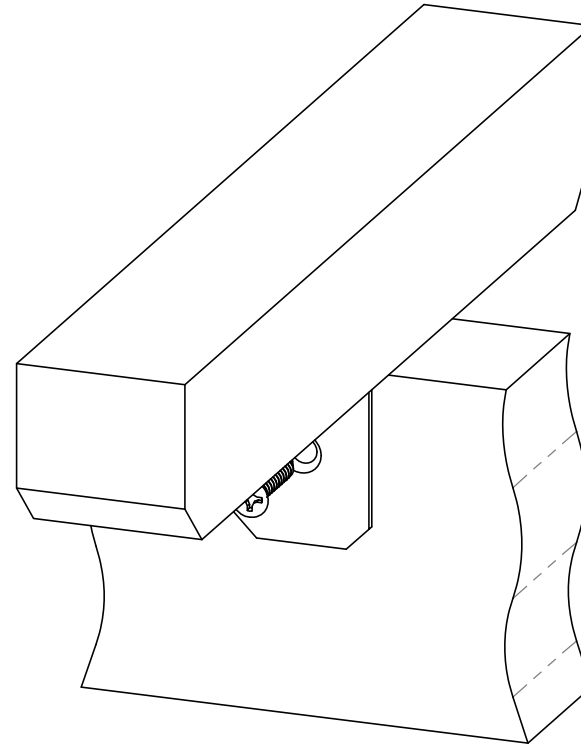
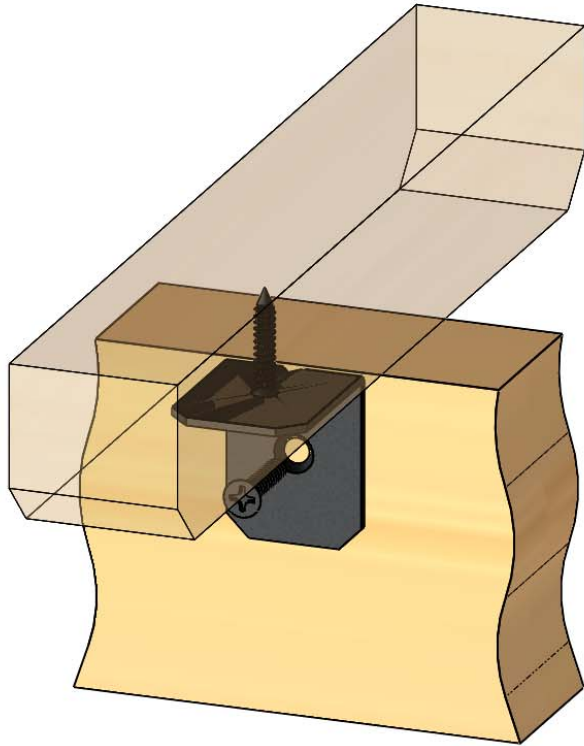

Scale: 1:2
Last updated: 9/12/2015

51717

Product & Packaging Specs

Box, 51717

Item #: Box

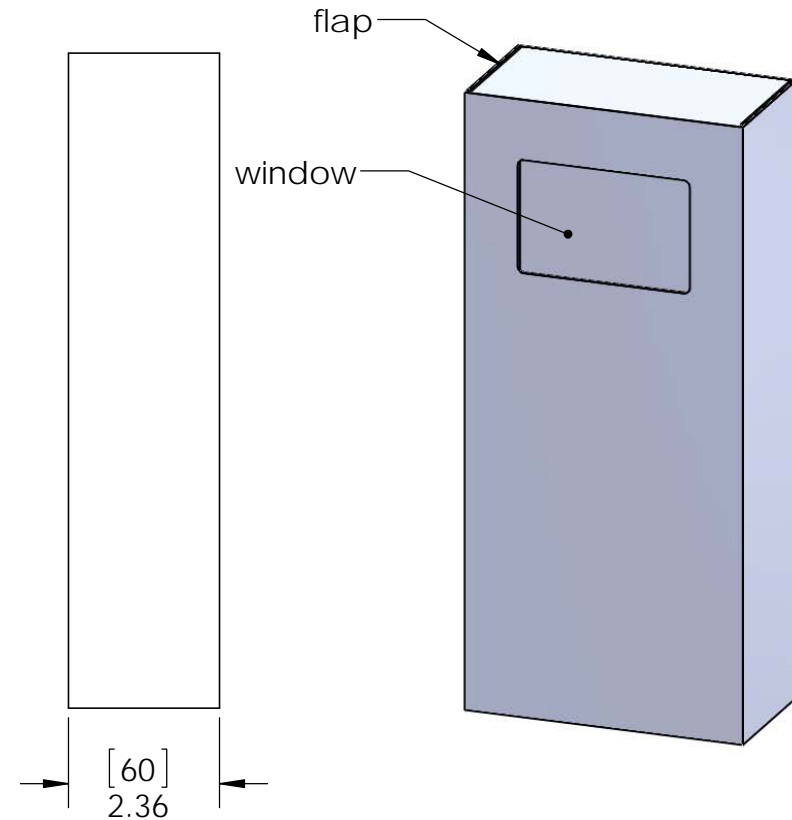
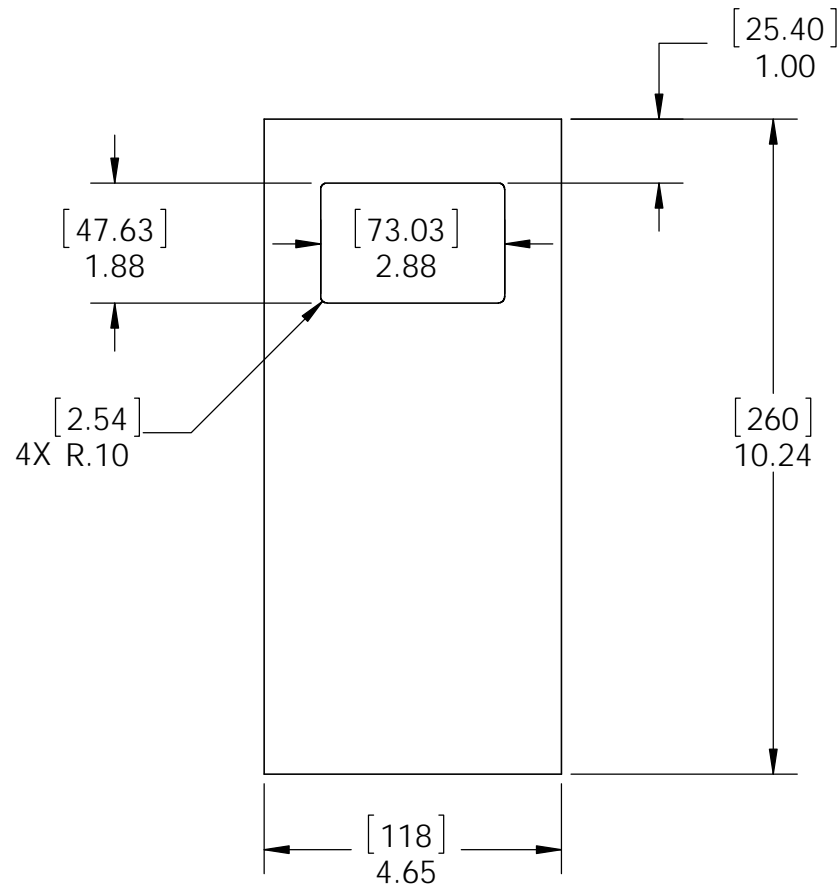

Material: Corrugated Paper
Finish: See Artwork
Weight: 16.06 LBS
Scale: 1:3
Last updated: 9/12/2015

51717

Product & Packaging Specs

56617 Packing

Item #: Box packing

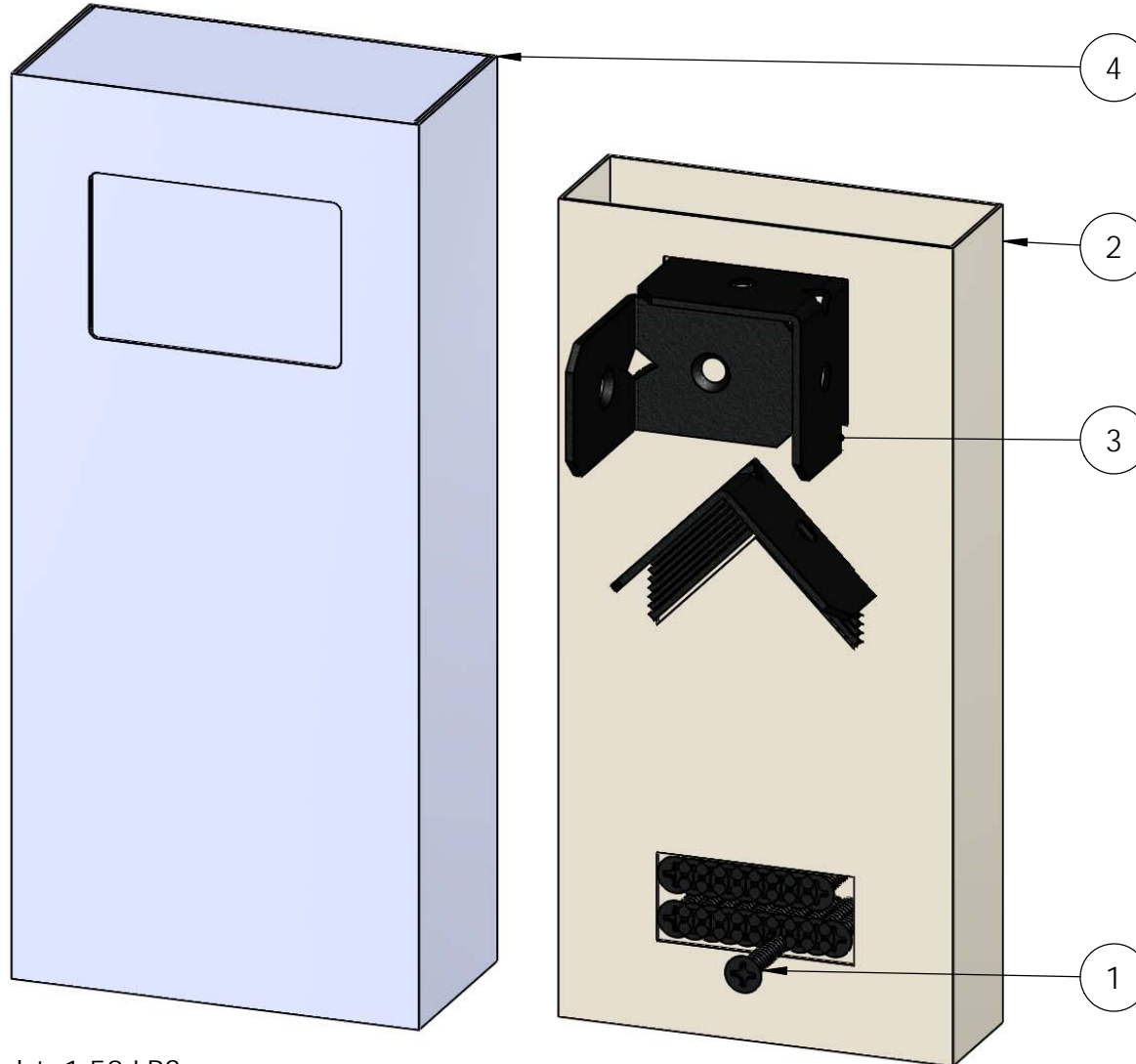

ITEM NO.	QTY.	PART NUMBER	DESCRIPTION
1	20	80014	Screw, FHP #12 X 1.25", Black
2	1	56617 Box Insert	Insert, 56617
3	10	51717-11	Clip, 2" Rafter
4	1	Box, 51717	Box, 51717

screws shall be placed in plastic bag and packed as shown

Weight: 1.58 LBS
Scale: 1:2
Last updated: 9/12/2015

51717

Product & Packaging Specs

Case, 51717

Item #: Case

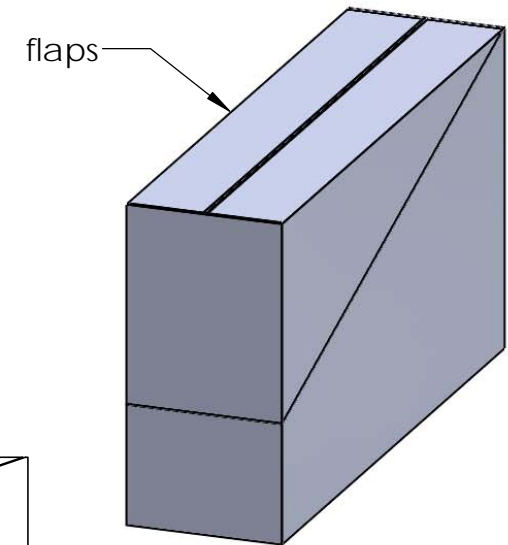
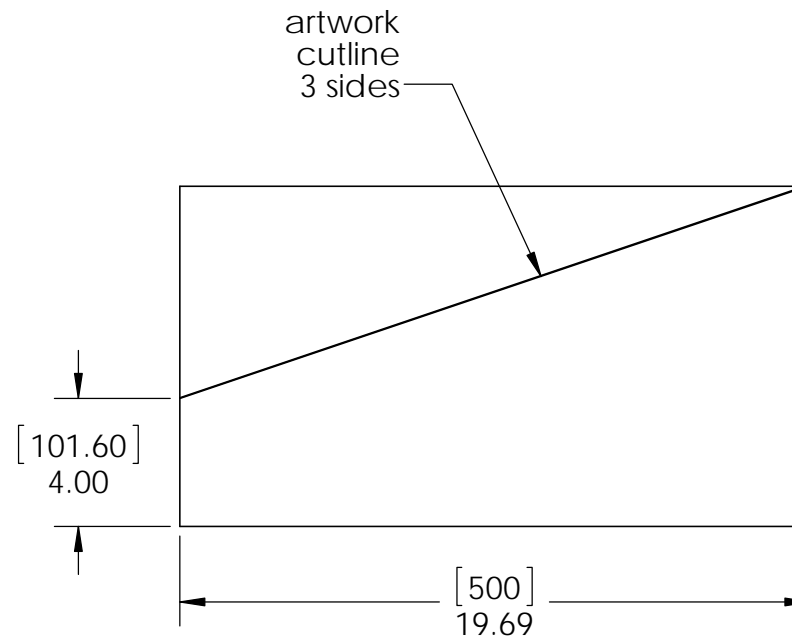
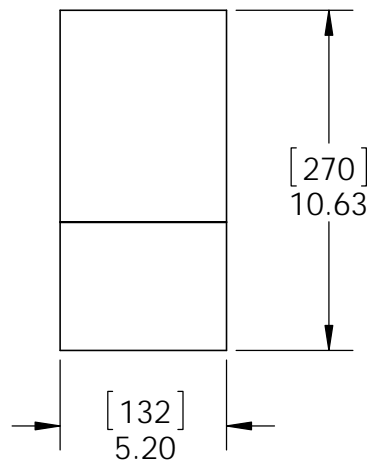

Material: Corrugated Paper
Finish: Natural
Weight: 146.70 LBS
Scale: 1:6
Last updated: 9/12/2015

51717

Product & Packaging Specs

56617 Packing

Item #: Case packing

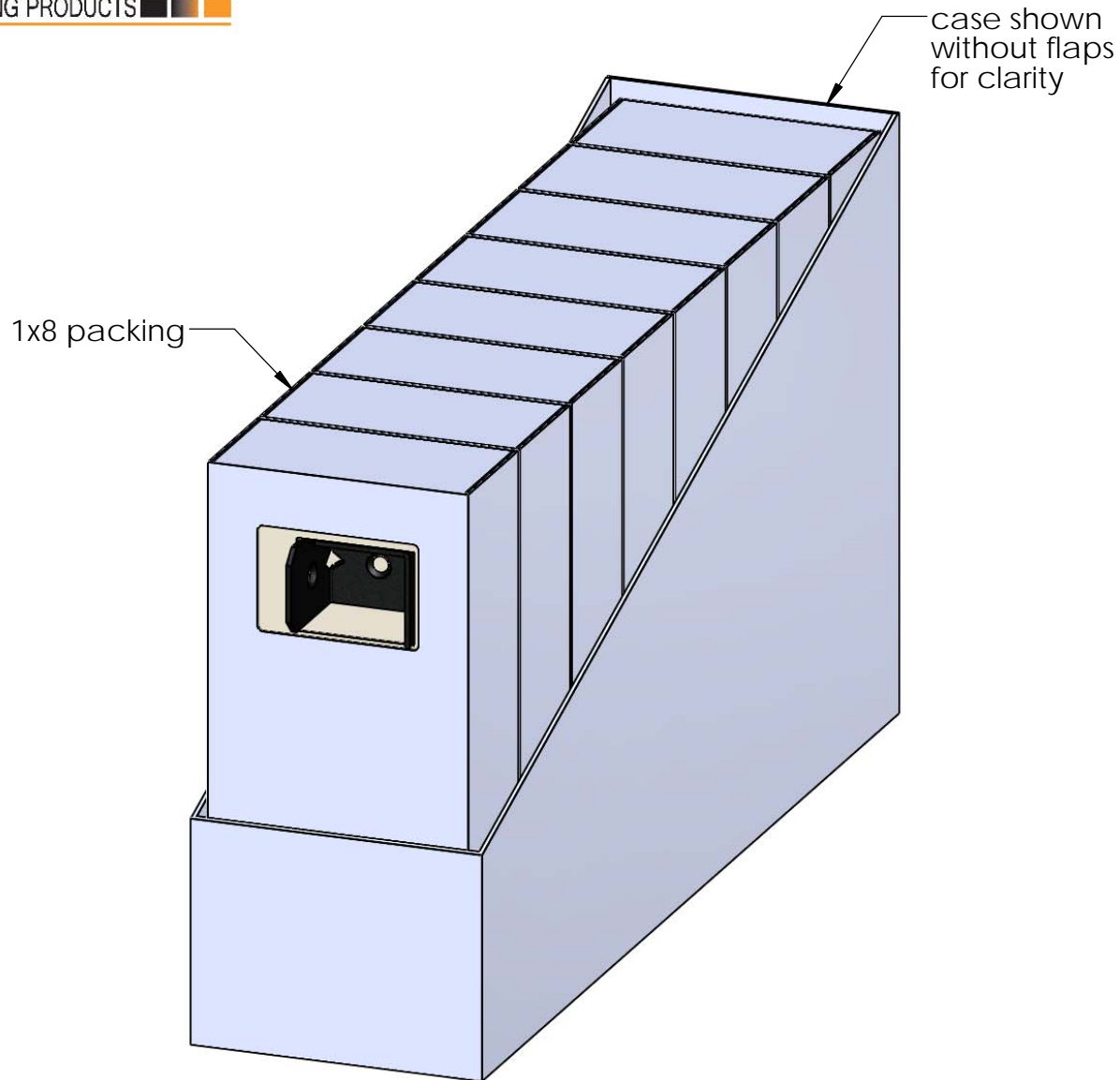

Weight: 16.64 LBS
Scale: 1:3
Last updated: 9/12/2015

51717

Product & Packaging Specs

56617 Packing

Item #: Pallet packing

ADD PALLET LABEL

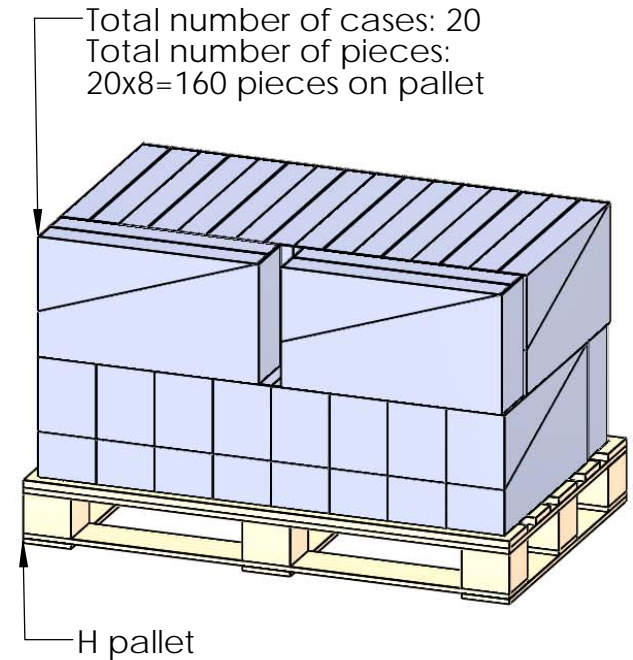
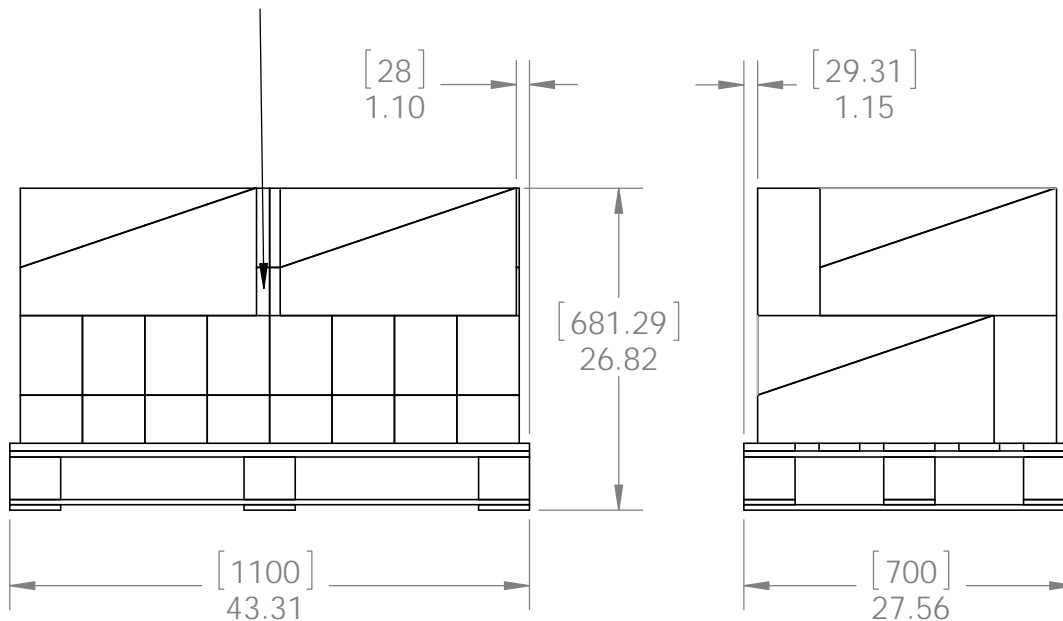

additional pallet packing instructions

- plywood on top layer
- strap to pallet
- clear wrap around boxes

Weight: 384 LBS
Scale: 1:16
Last updated: 9/12/2015

51717