

# RDY05B-T60

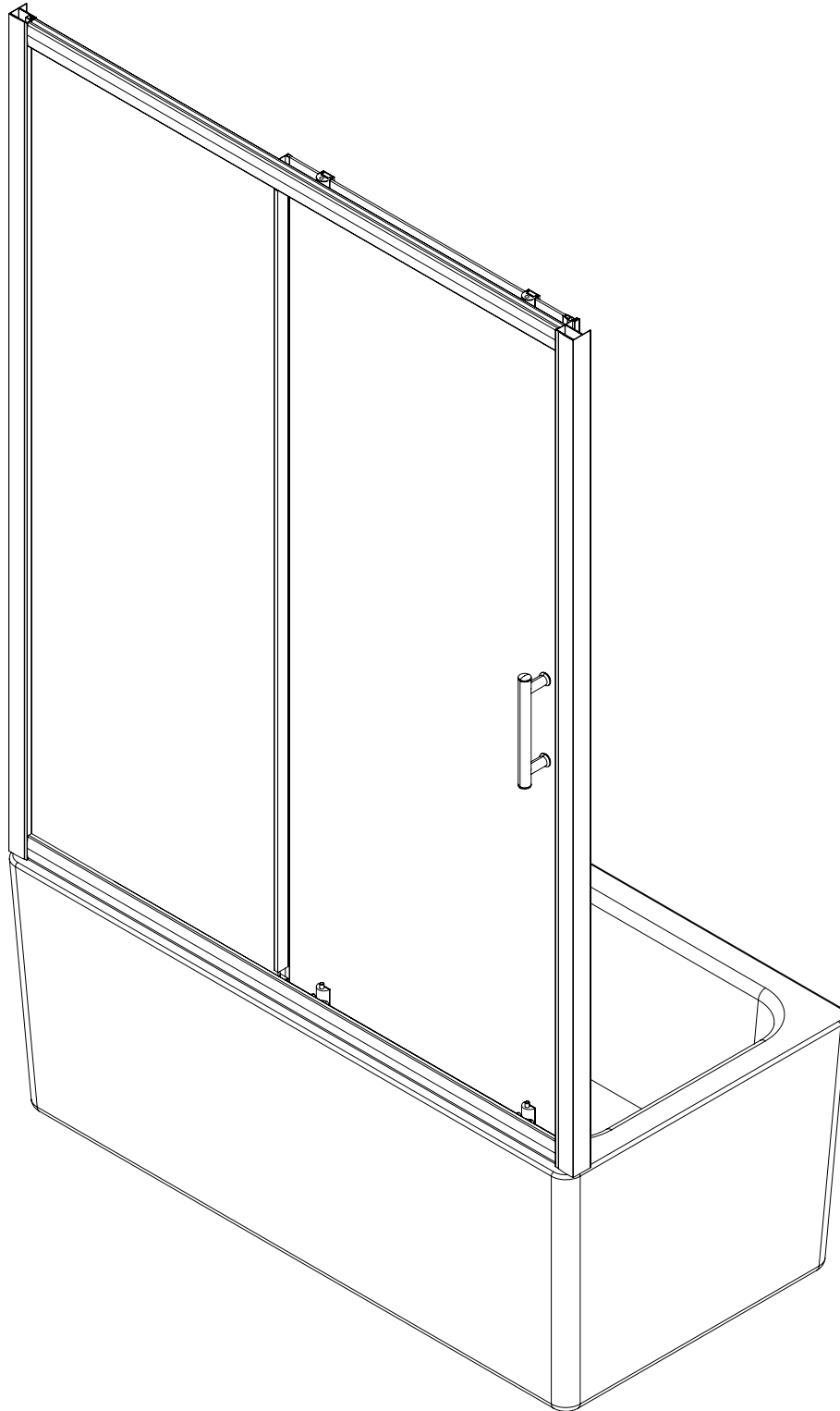

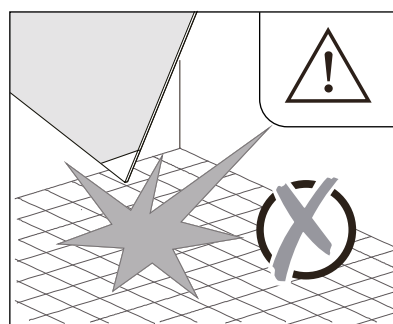
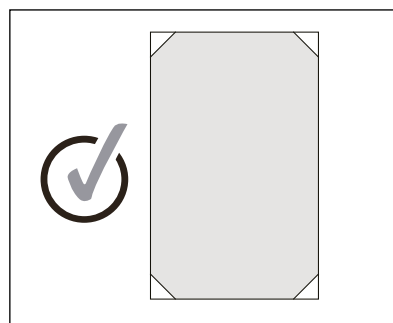
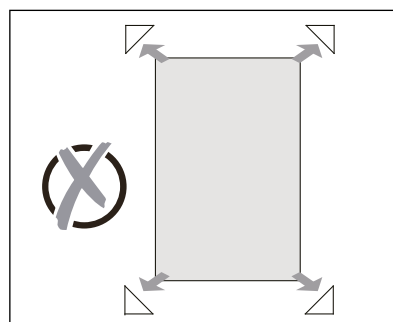
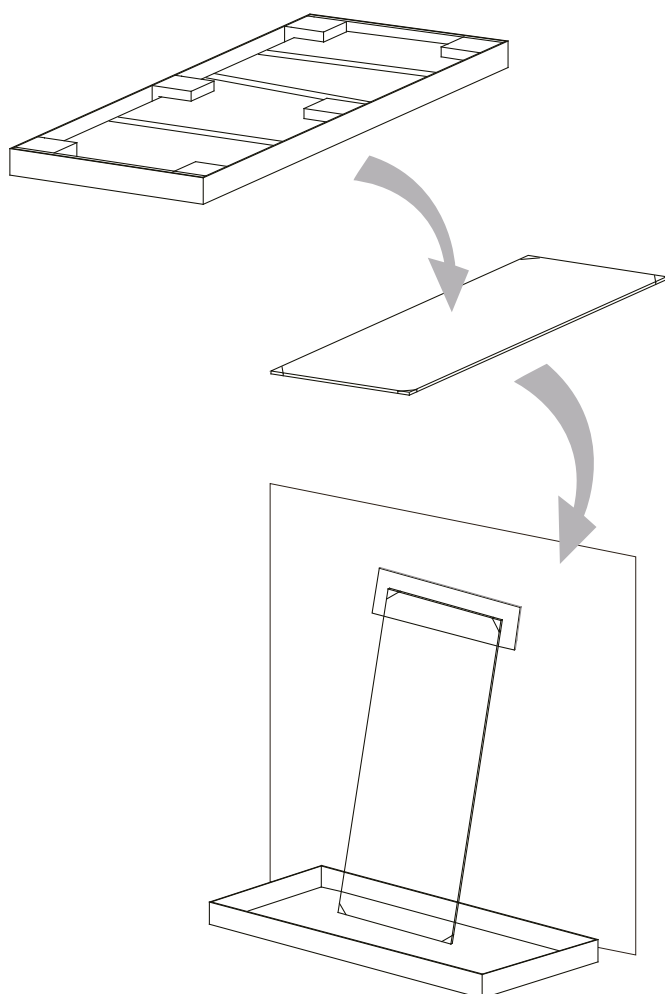
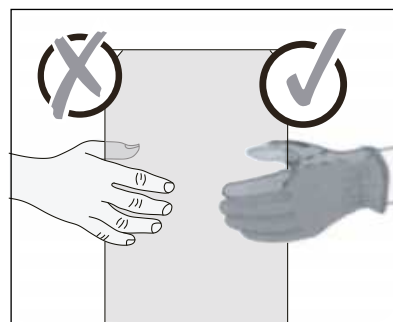
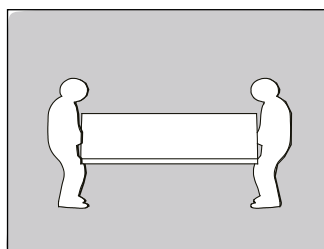
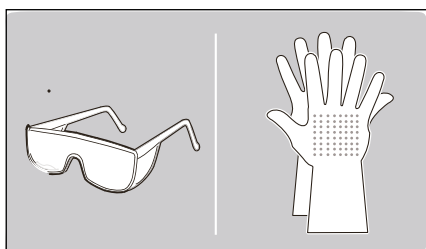
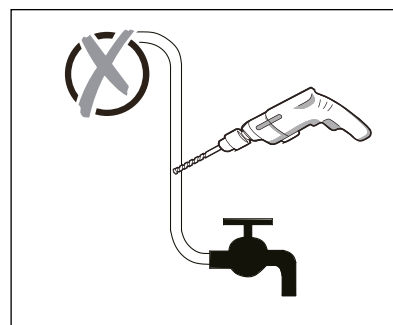
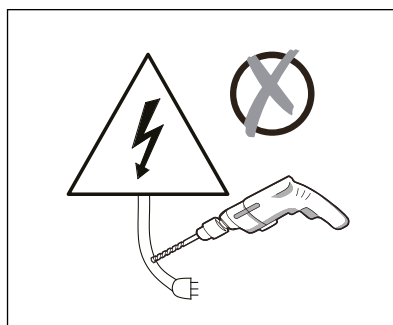
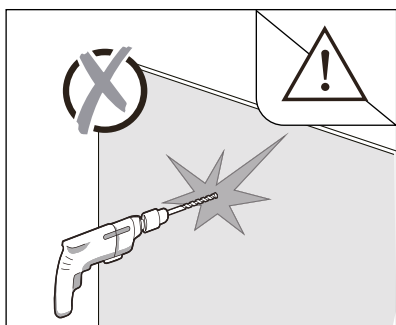

The default adjustable size is 0.6 inches on each side.

If cutting is required, only the movable door glass side can be cut, and it is recommended that the cutting size should not exceed 3 inches.

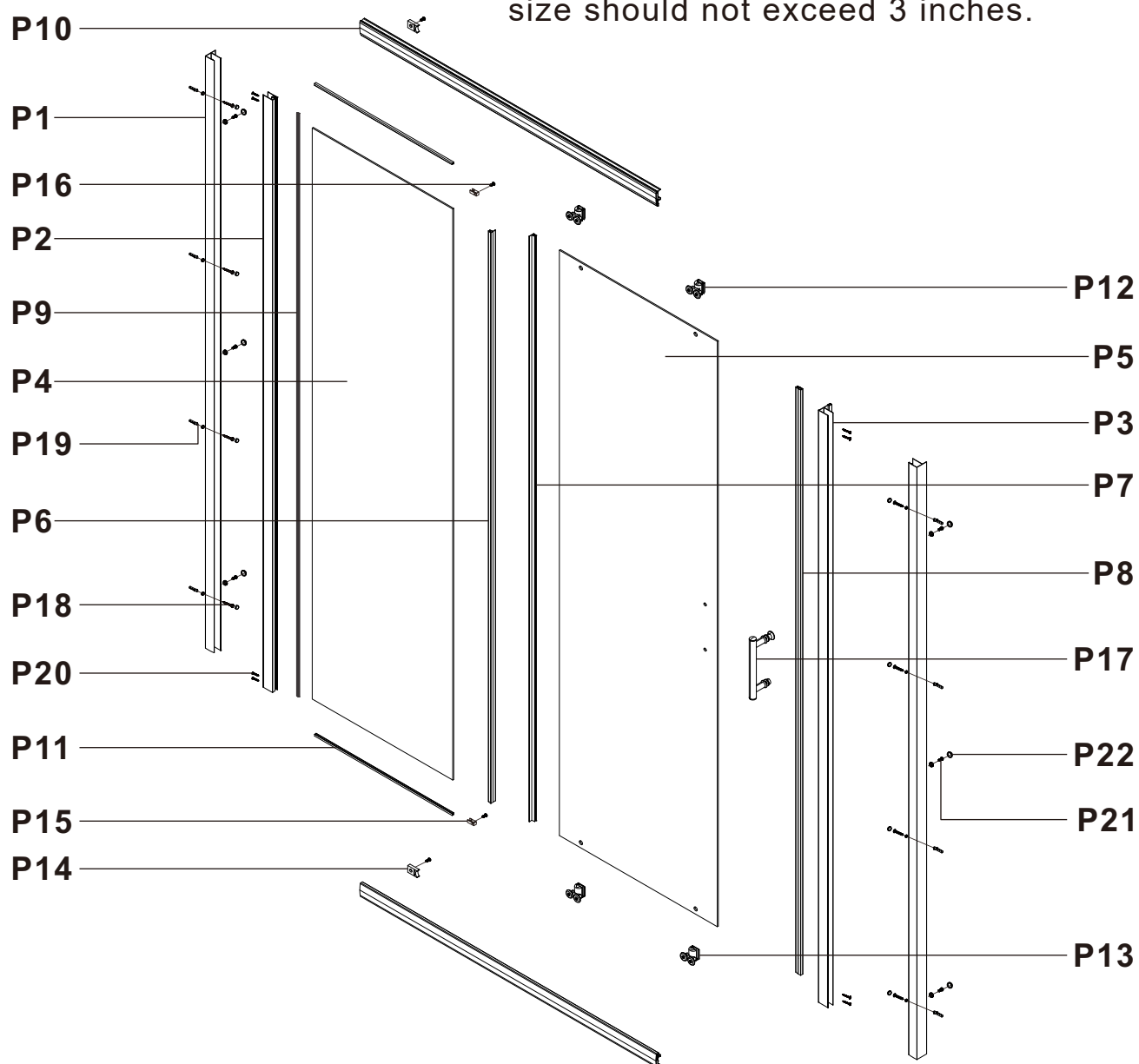

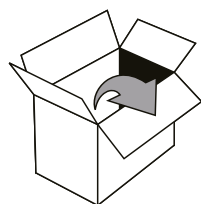

<b>P1</b>  X2	<b>P2</b>  X1	<b>P3</b>  X1	<b>P4</b>  X1
<b>P5</b>  X1	<b>P6</b>  X1	<b>P7</b>  X1	<b>P8</b>  X1
<b>P9</b>  X1	<b>P10</b>  X2	<b>P11</b>  X2	<b>P12</b>  X2
<b>P13</b>  X2	<b>P14</b>  X2	<b>P15</b>  X1	<b>P16</b> ST4x11MM  X2
<b>P17</b>  X1	<b>P18</b> ST3.5x30MM  X8	<b>P19</b>  X8	<b>P20</b> ST3.9x20MM  X8
<b>P21</b> ST4x10MM  X8	<b>P22</b>  X14		

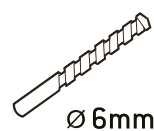
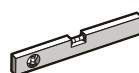
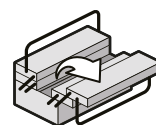

Ø 6mm



⊕ PH2

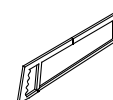

Ø3mm

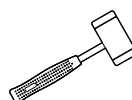

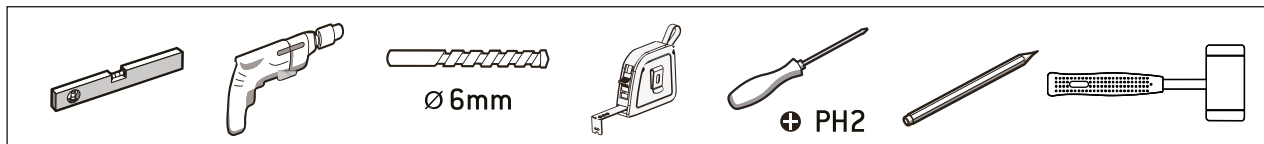

5

**1** Make sure the screws and screw holes are aligned during assembling the frames.

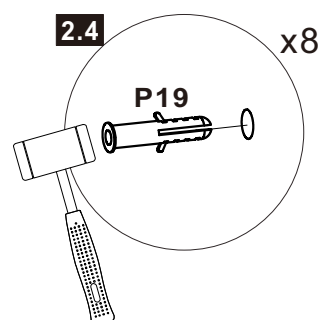
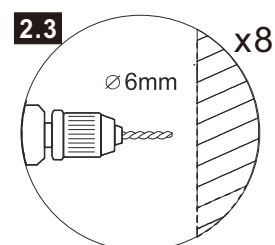
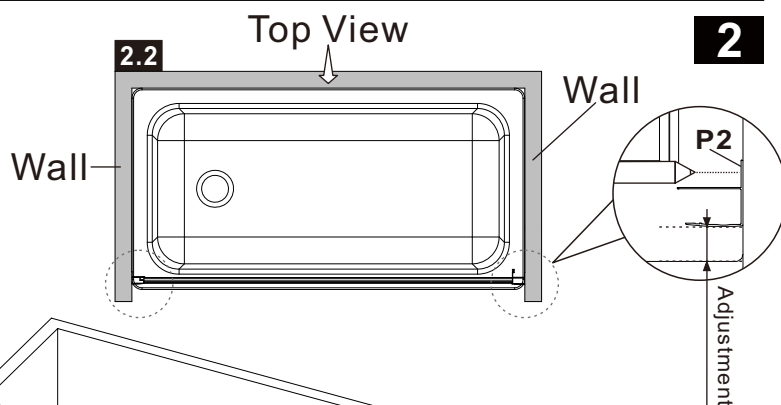
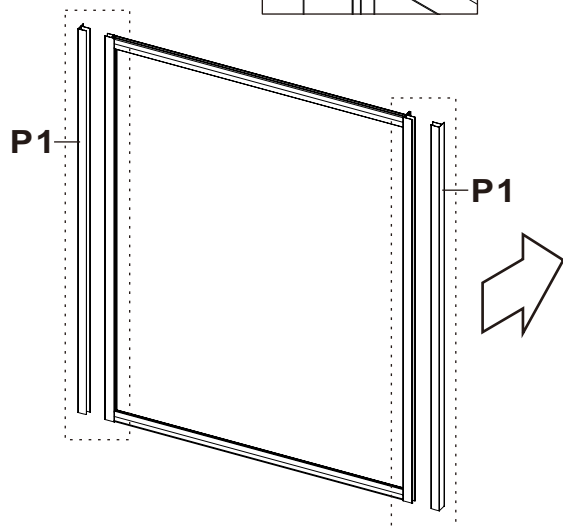
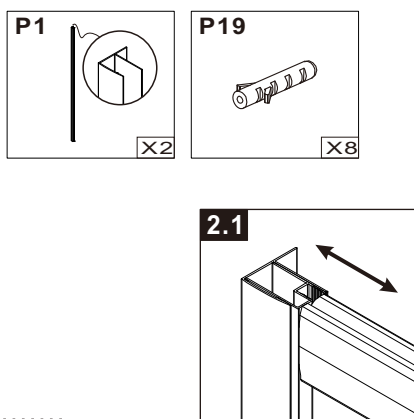
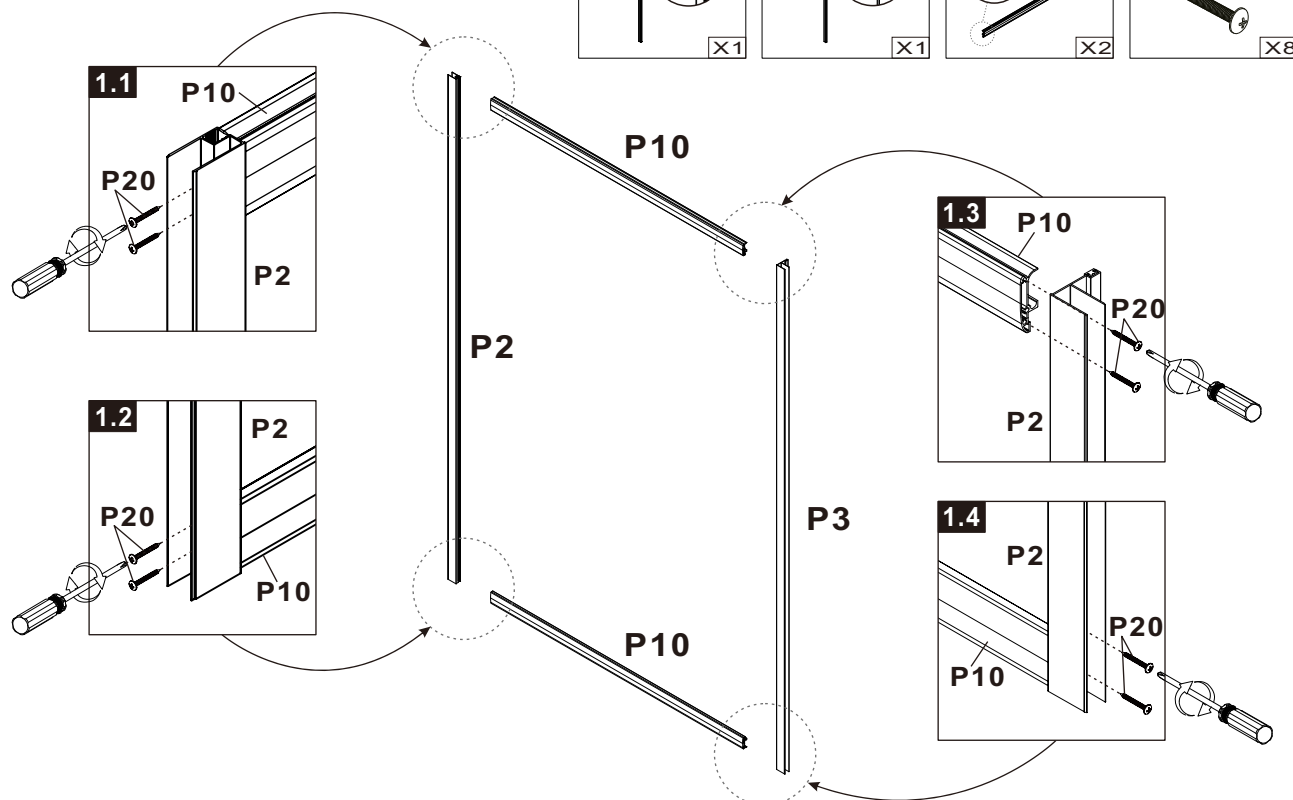

Assemble the frames and use a level to measure the left, right and bottom to ensure that the wall is flat. Then use a pencil to position P1 frame and the wall then install the expansion screws.



3

Screw the frames P1 with P22(gasket)+P18+P22(cap)

P18  
ST3.5x30MM



X8

P22

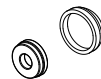

X8

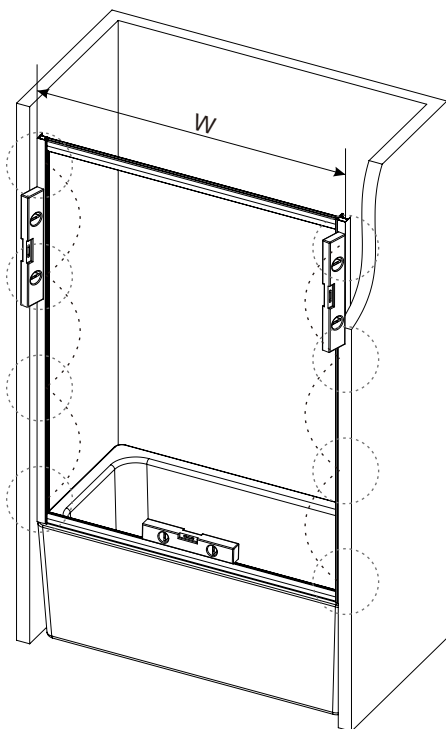

3.1

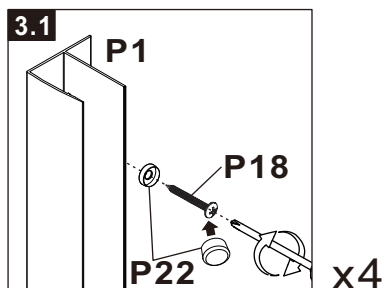

3.2

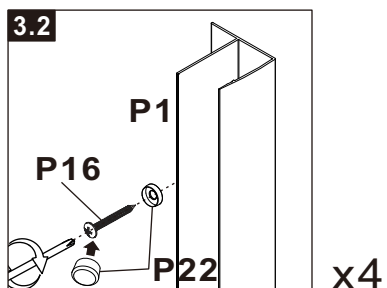

P4



X1

P11

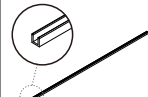

X2

P15

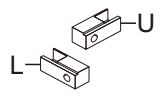

X2

P16

ST4x11MM



X2

4

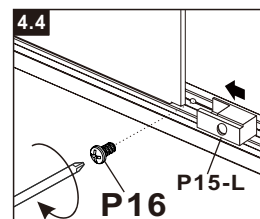
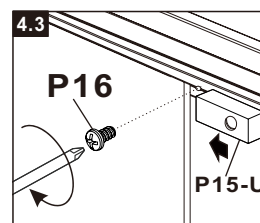
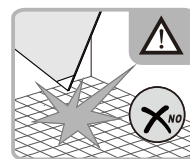
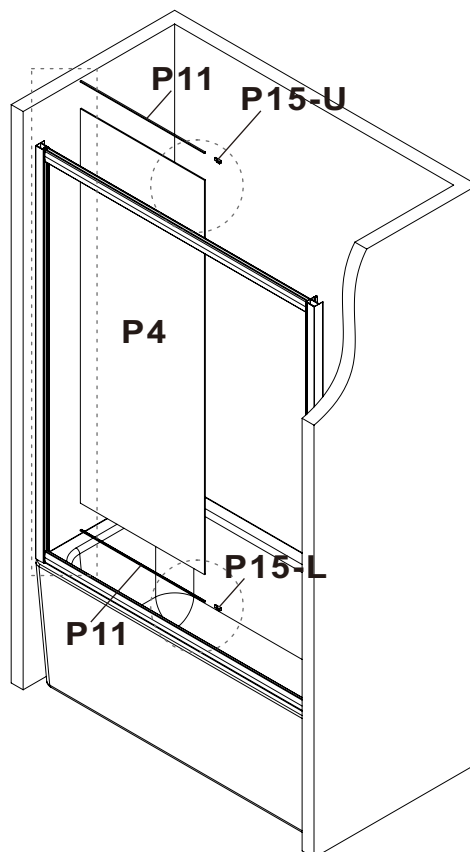
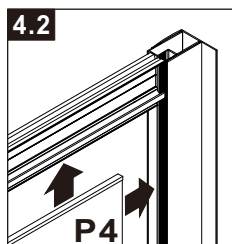
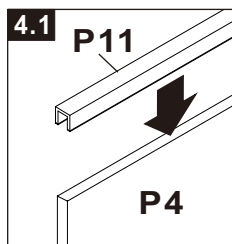

During installing the glass and the blocks(P15), be careful to avoid collision between the glass corners and the ground, which may cause the glass to break.



⊕ PH2

7

**5**

Assemble the sealing strip by pressing, and cut the excess sealing strip after adjustment; then assemble the strip P6 and the positioning block P14.

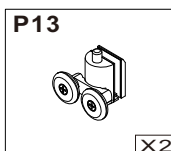
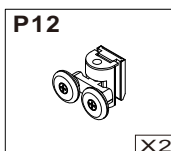
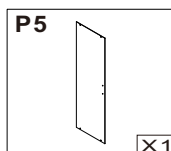
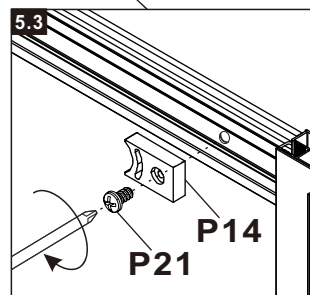
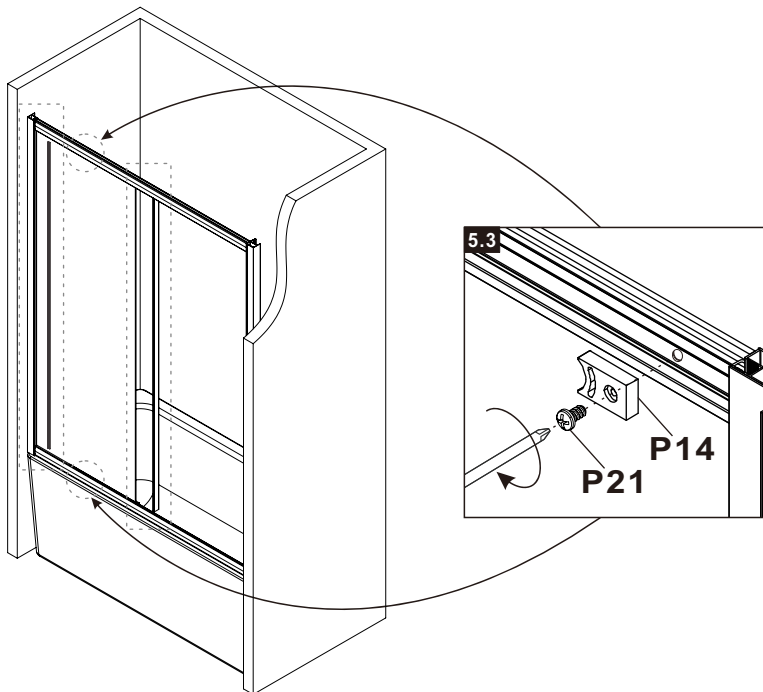
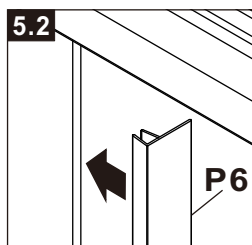
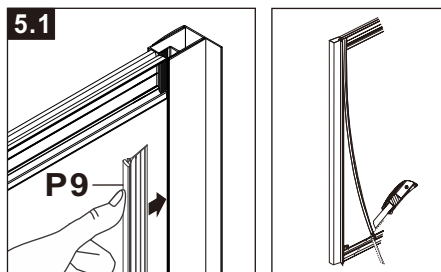
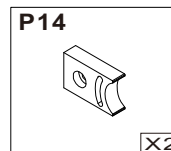
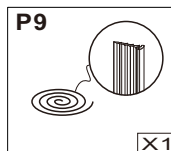
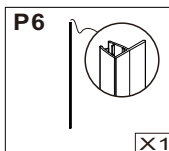

Assemble the wheels.  
Note that P12 is the upper wheel  
and P13 is the lower wheel (with  
adjustment buttons).

**6**

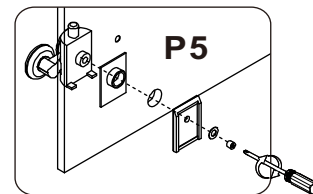
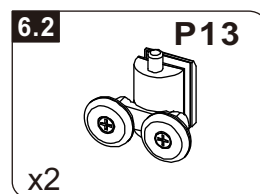
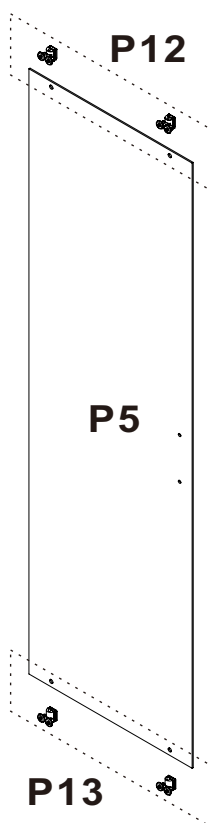
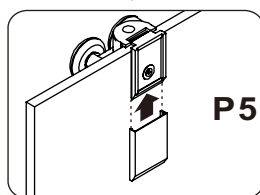
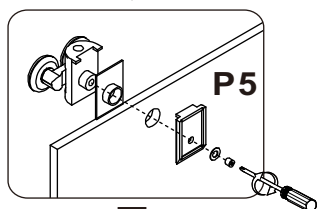
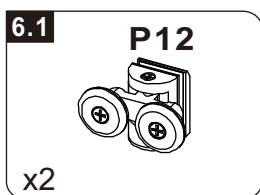
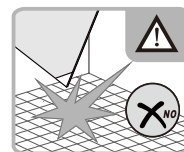



# 7

Install sealing strip P7 and magnetic strip P8

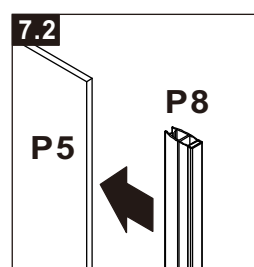
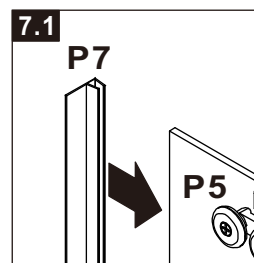
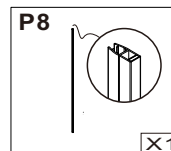
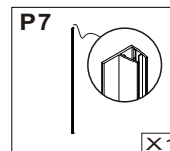
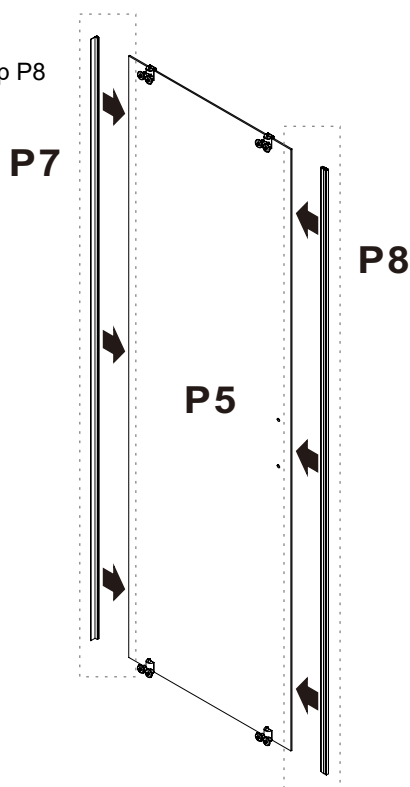
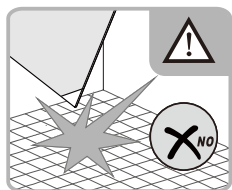

Assemble the sliding door: first hang the upper rollers P12, then hang the lower rollers P13. The lower rollers need to press the button to snap in place.

# 8

## Bottom

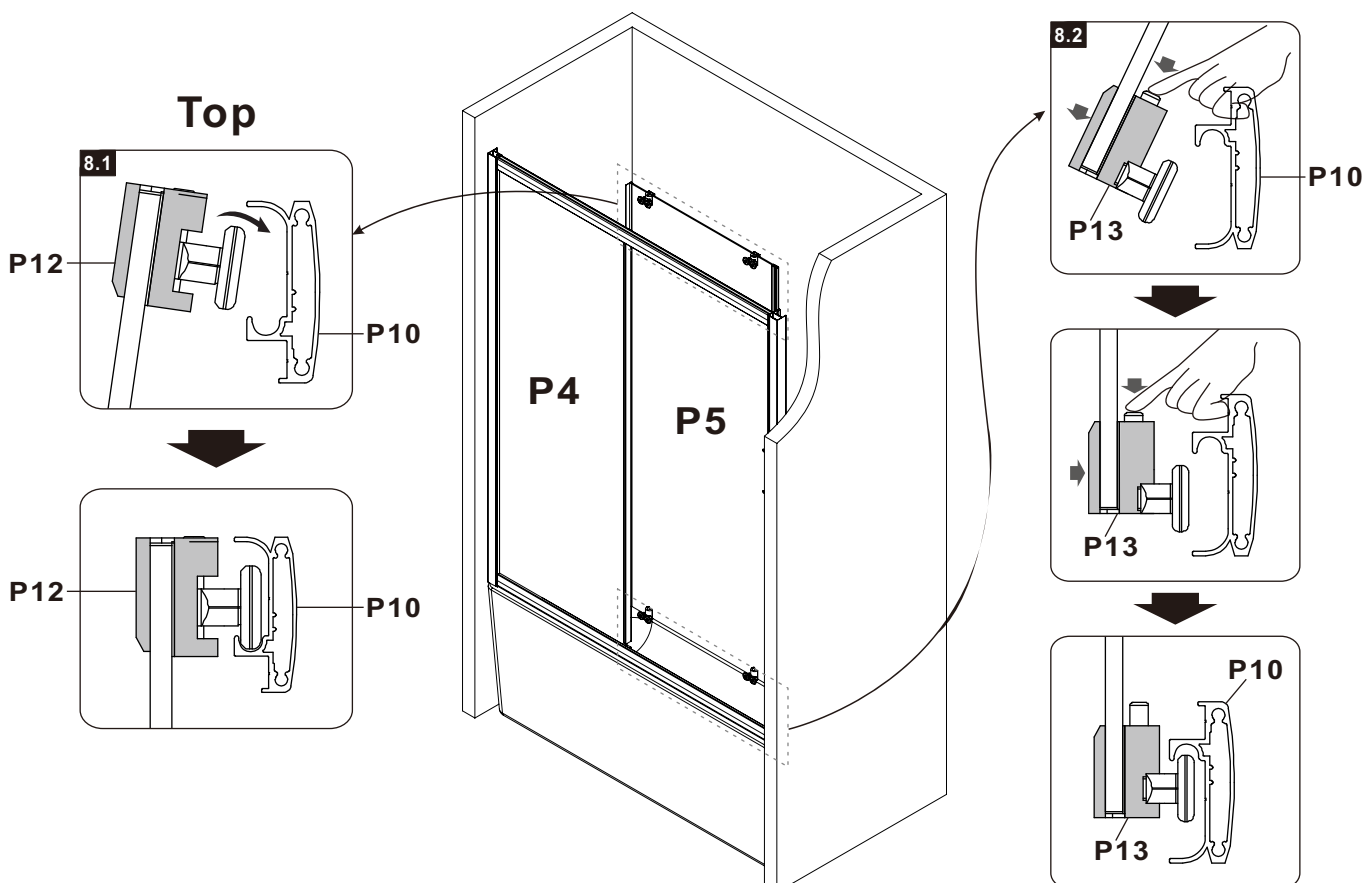





Ø3mm



⊕ PH2

9

9

The sliding door can be adjusted by adjusting P12 and P10.  
After adjustment, install the handle.

P17



X1

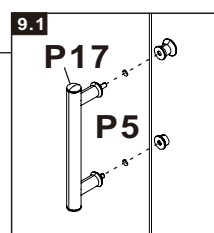
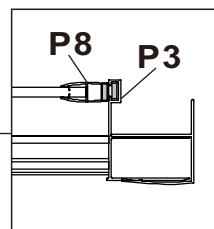
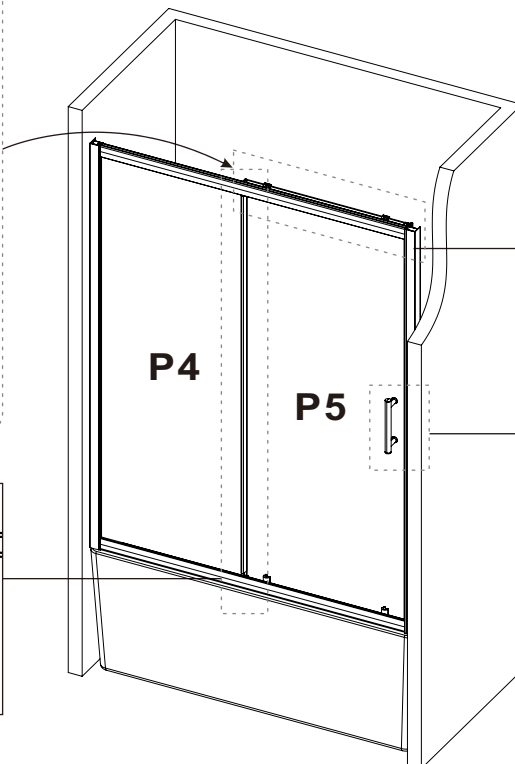
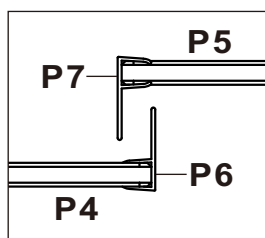
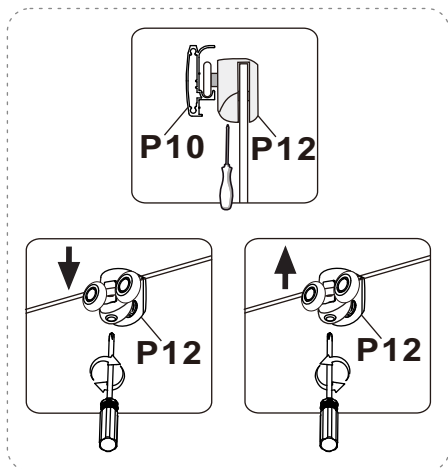

P21  
ST4x10MM



X6

P22



X6

Use self-tapping screws P22(gasket)+P21+P22(cap) to fix the frame, and do not drill into the glass !

10

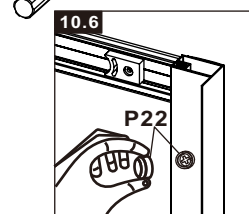
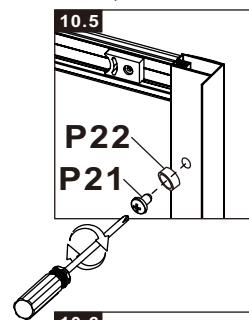
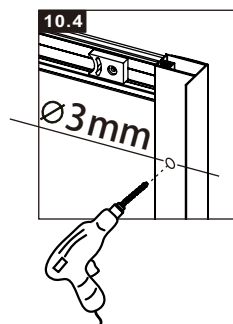
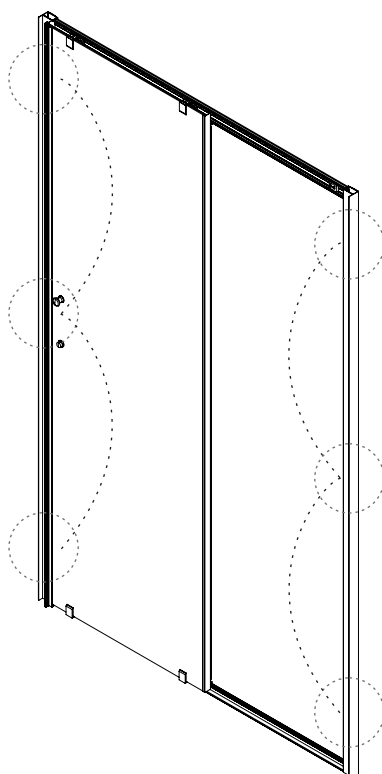
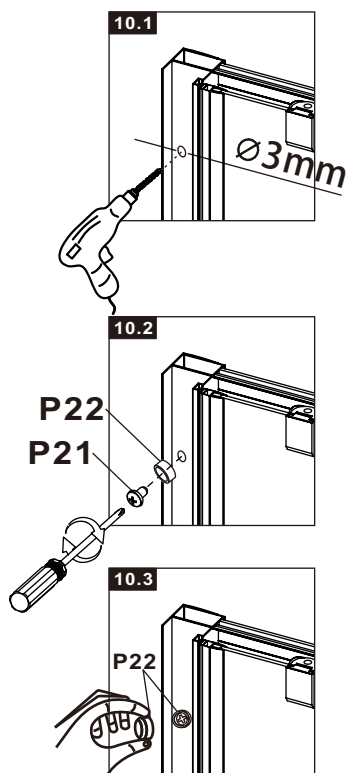

**11**

Apply waterproof silicone caulk sealant and keep it still for 24 hours before use.

