

Thank you very much  
for purchasing our *Patio chaise lounge set*.

## OWNER'S MANUAL

# PAMAPIC

# Patio chaise lounge set

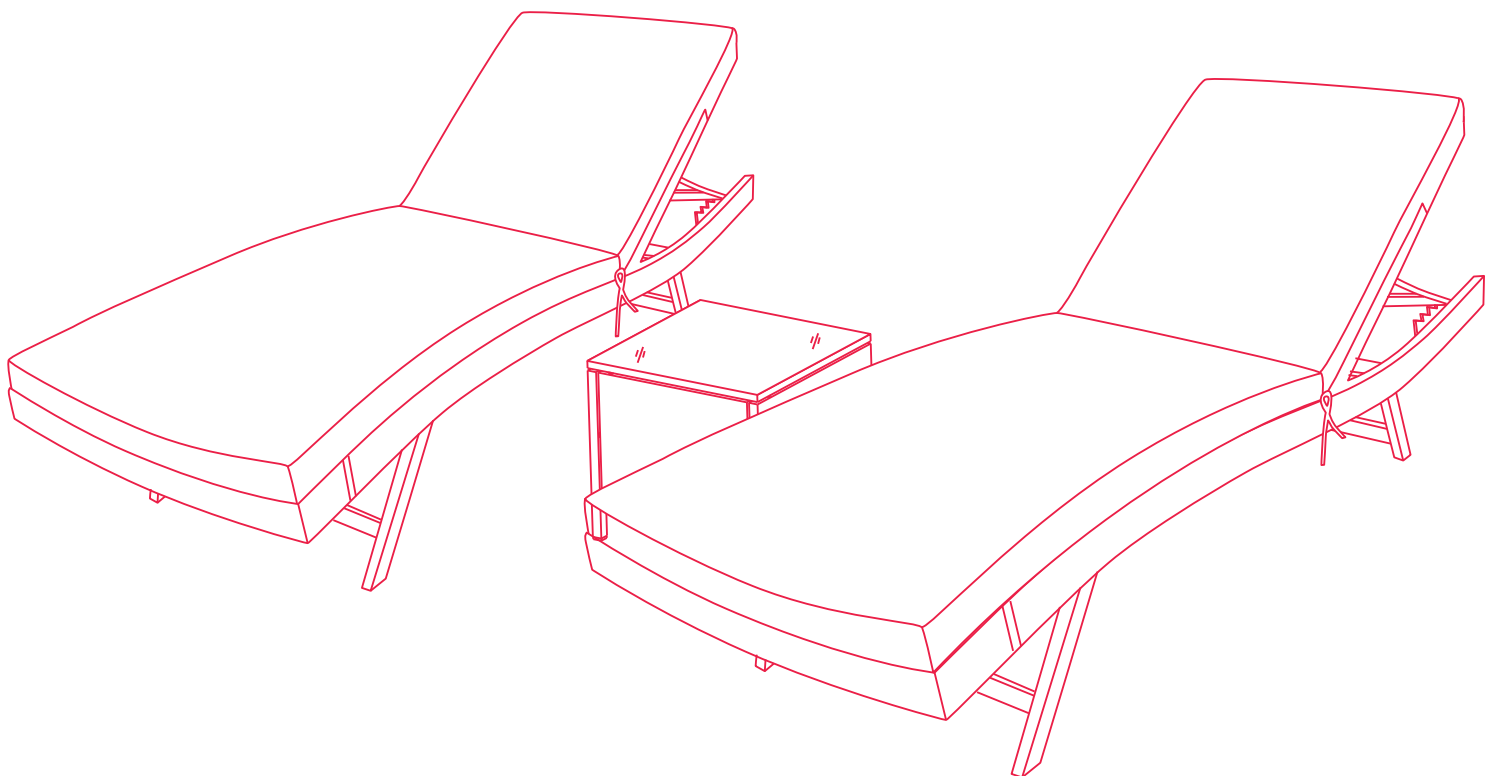

If you have any questions,  
please contact customer service:  
**E-mail: [Pamapic@hotmail.com](mailto:Pamapic@hotmail.com).**  
**Facebook: [@Pamapic.Official](https://www.facebook.com/Pamapic.Official)**





## Safety precautions

### ⚠ WARNING

- Please read and understand this entire manual before attempting to assemble or install the product.
- Some parts may contain sharp edges. Please wear protective gloves when assemble or install the product.
- Assemble the item on a soft, non-abrasive surface such as carpeting to avoid damage.
- Keep all children and pets away from assembly area. Children and pets should be supervised when they are in the area of the sofa set construction.
- Item is heavy. Please handle with care. Two or more people are required for this assembly.

### CAUTION

- Chair is for seating purpose only. Do not stand on or use any part of this item as a step ladder.
- Recommended maximum sitting weight for the chair set is 286lbs/130kgs. Please do not exceed the weight limitations of this item.
- Firmly secure all bolts, screws and knobs before use.
- Reconfirm that all bolts, screws, and knobs are secure every 90 days.
- Do not use or store this item in the proximity of open flame or flammable/combustible chemicals.
- If any parts are missing, broken, damaged, or worn, stop using this product until repairs are made and/or factory replacement parts are installed.

### ATTENTION

- Before assembling of product, compare every part with parts list. If any part is missing or damaged, do not attempt to assemble the product and contact us immediately.
- We care about every customer's using experience, please feel free to chat us if have some advice, efficient solution would be offered soon.
- Recommend to use waterproof furniture cover for entire Patio chaise lounge Set when out of use to keep them longer performance.
- Chair cushion cover can be removable and clean up by cleaner when have stains.

### Warranty Coverage Requirements:

- Pictures of the damaged parts.
- The name or MODLE number of your product.
- Please gather all of this information BEFORE you contact us.
- Do not use this item in a way inconsistent with the manufacturer's instructions as this could void the product warranty.

## Instructions

## Patio lounge chair and patio table

- The patio chaise lounge set is delivered with two boxes. there are one patio lounge chair and patio table in one box, and one patio lounge chair in another box.
- The accessories list and installation instructions of one patio lounge chair and patio table are as follows.

## Number

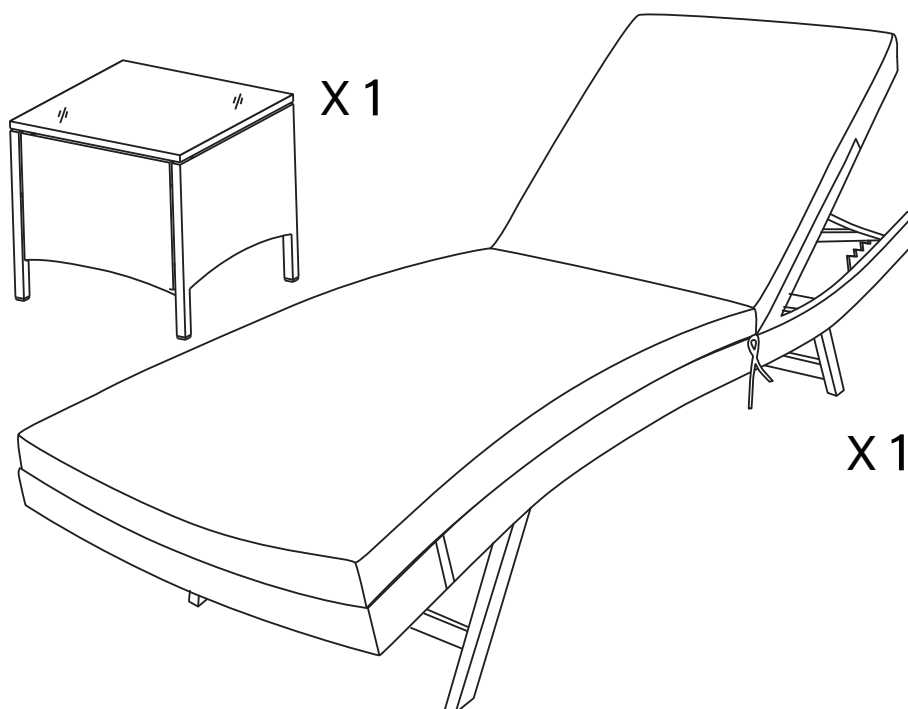

## Parts

(A1) 1PCS

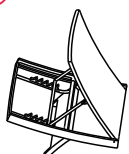

(B1) 1PCS

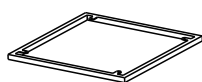

M6\*25 4/PC



(A2) 1PCS



(B2) 2PCS

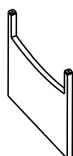

14/PC



(A3) 2PCS



(B3) 2PCS

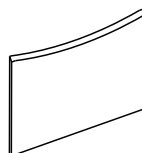

1/PC



(A4) 1PCS

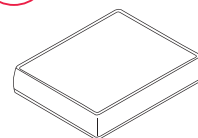

(B4) 1PCS



M6\*40 12/PC





### Step1

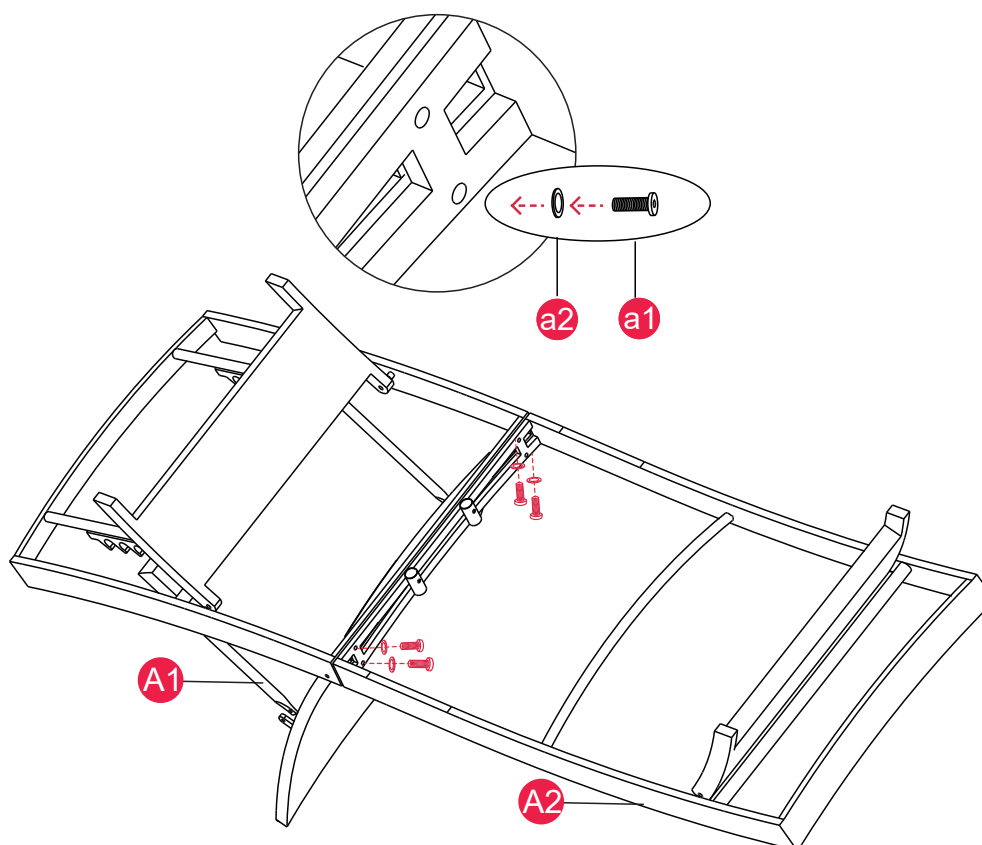

NOTICE: Please assemble the item on a soft, non-abrasive surface such as carpeting to avoid damage.

### Step2

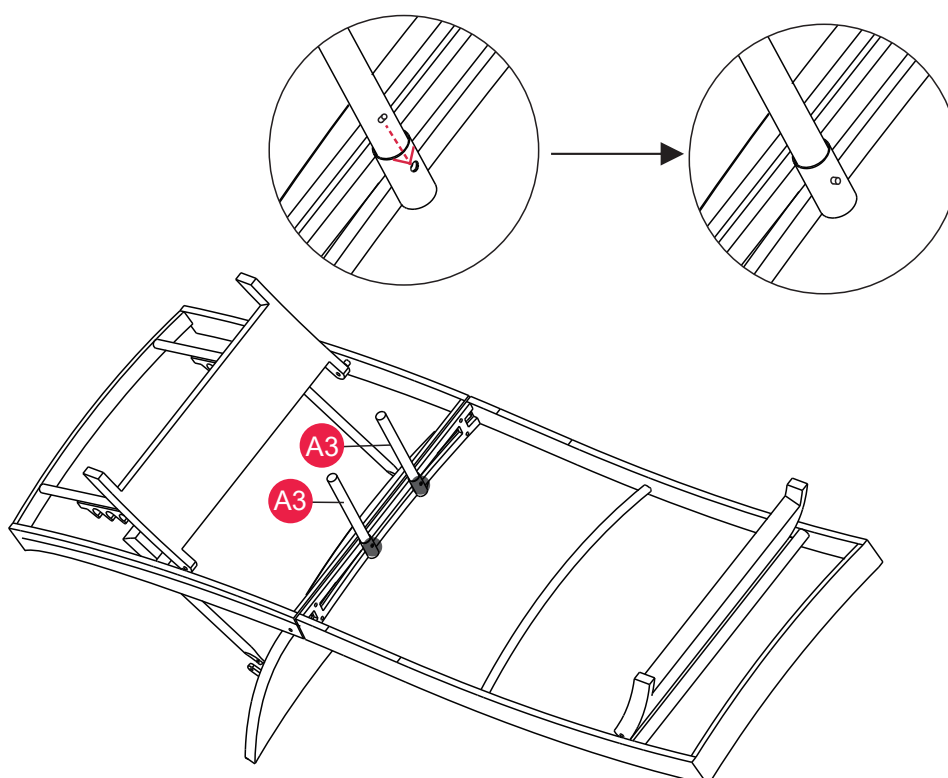

### ■ Step3

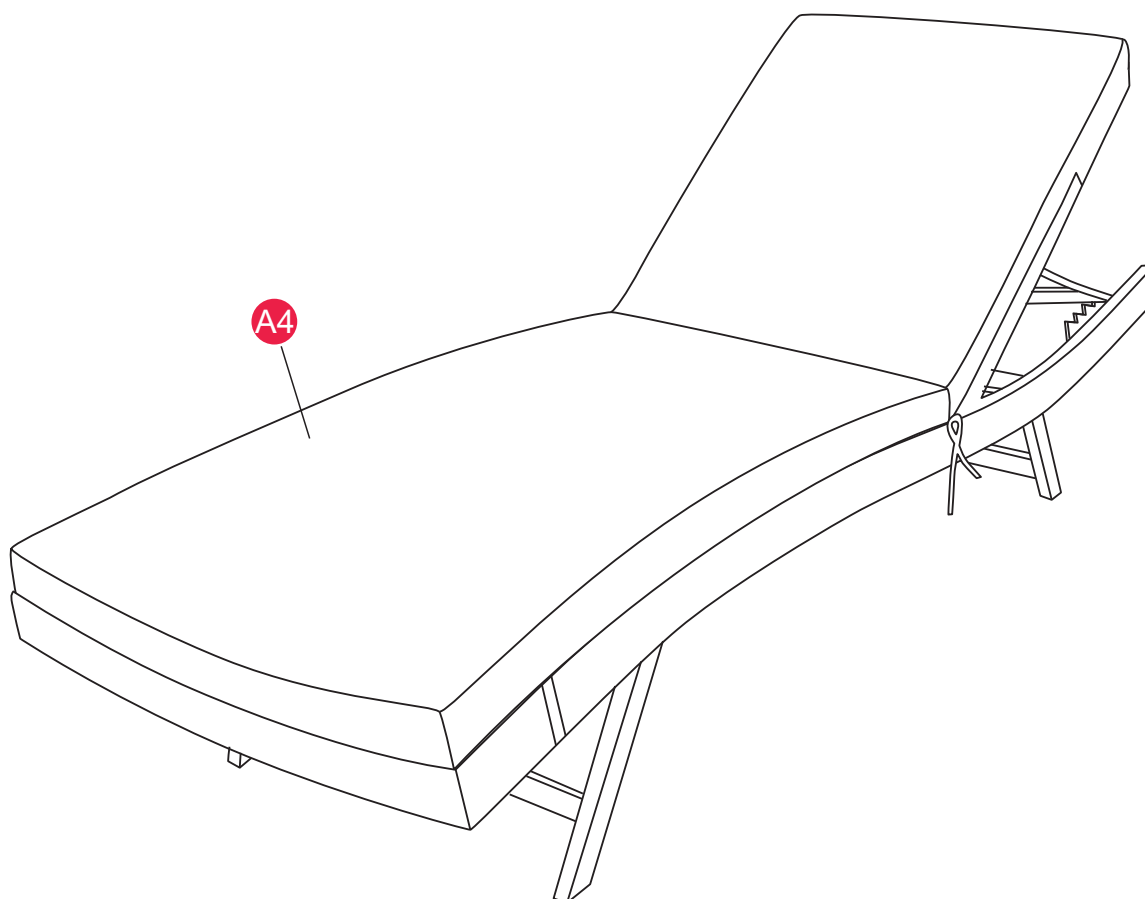

NOTICE: You can fix the cushion through the band.

Instructions **patio table**

**Step1**

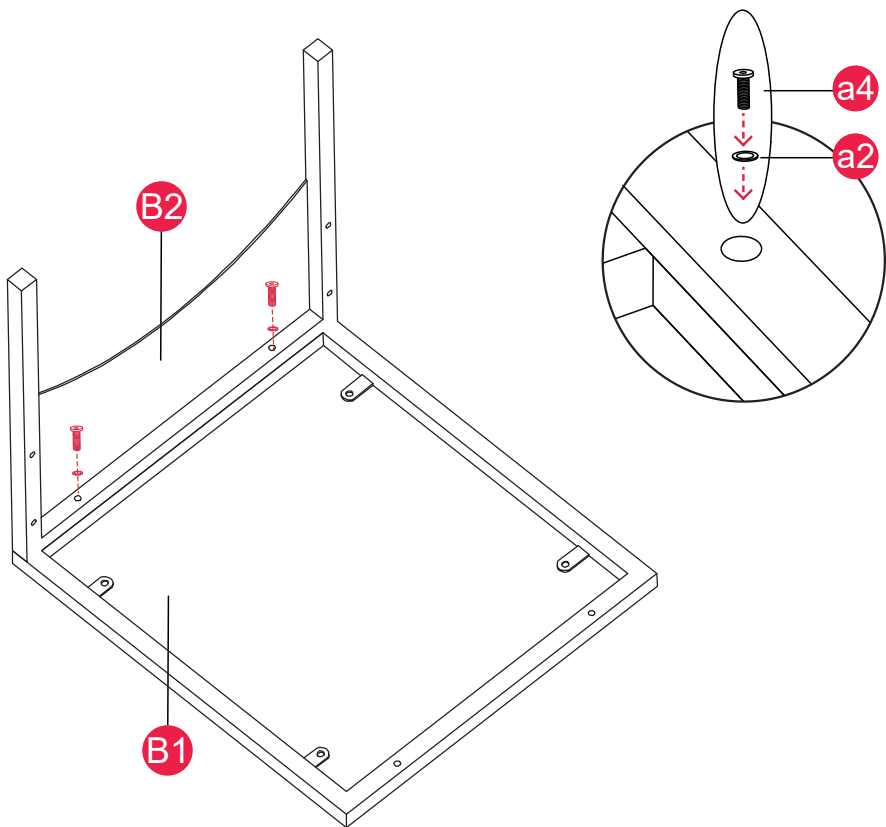

**Step2**

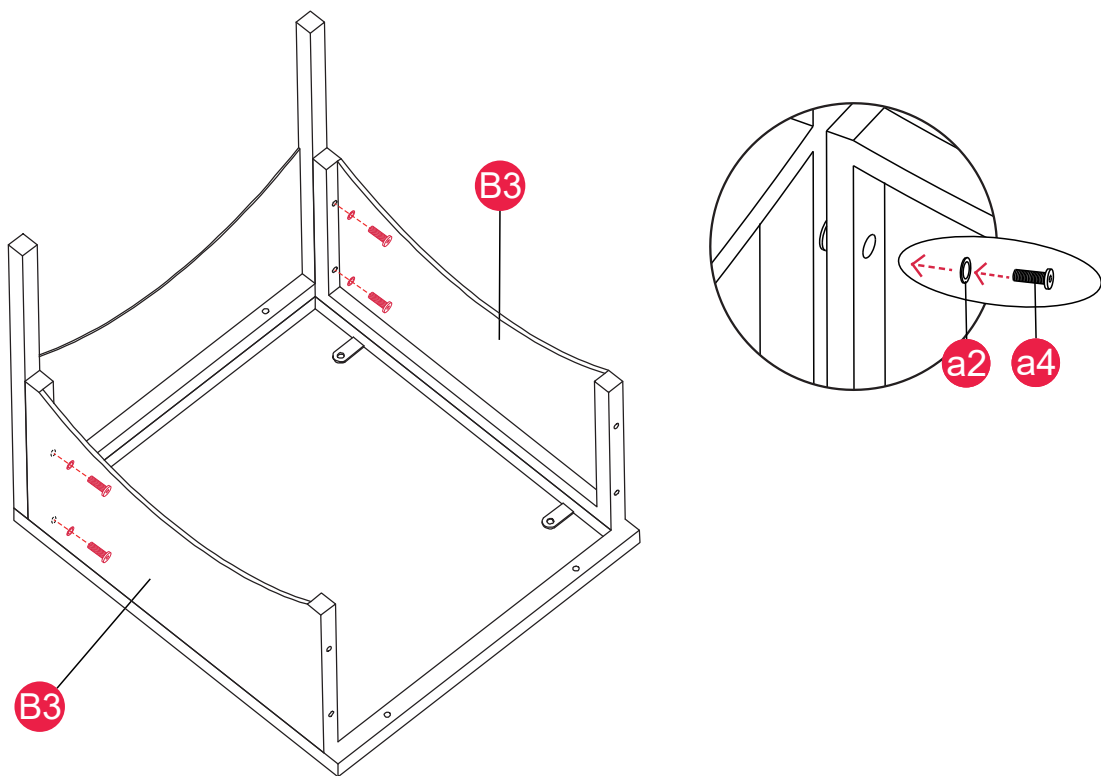

Instructions **patio table**

**Step3**

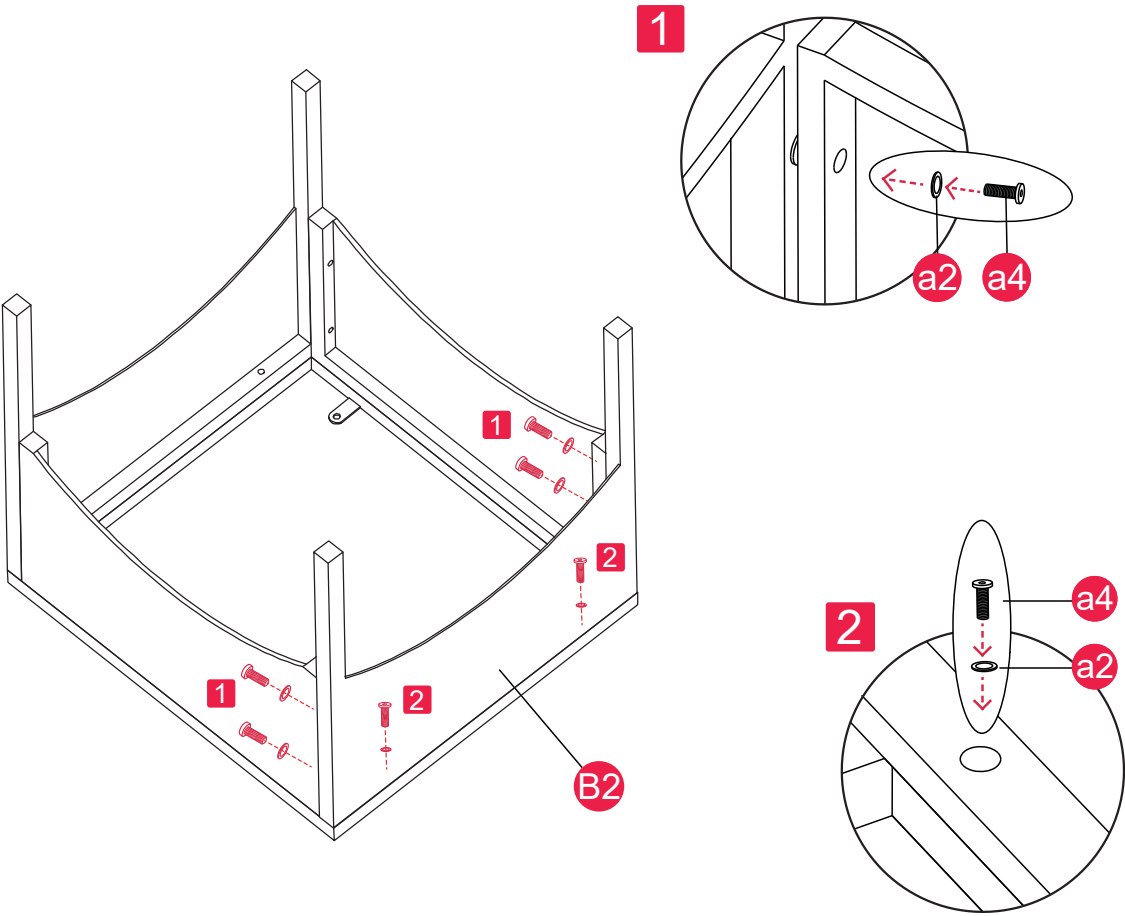

**Step4**

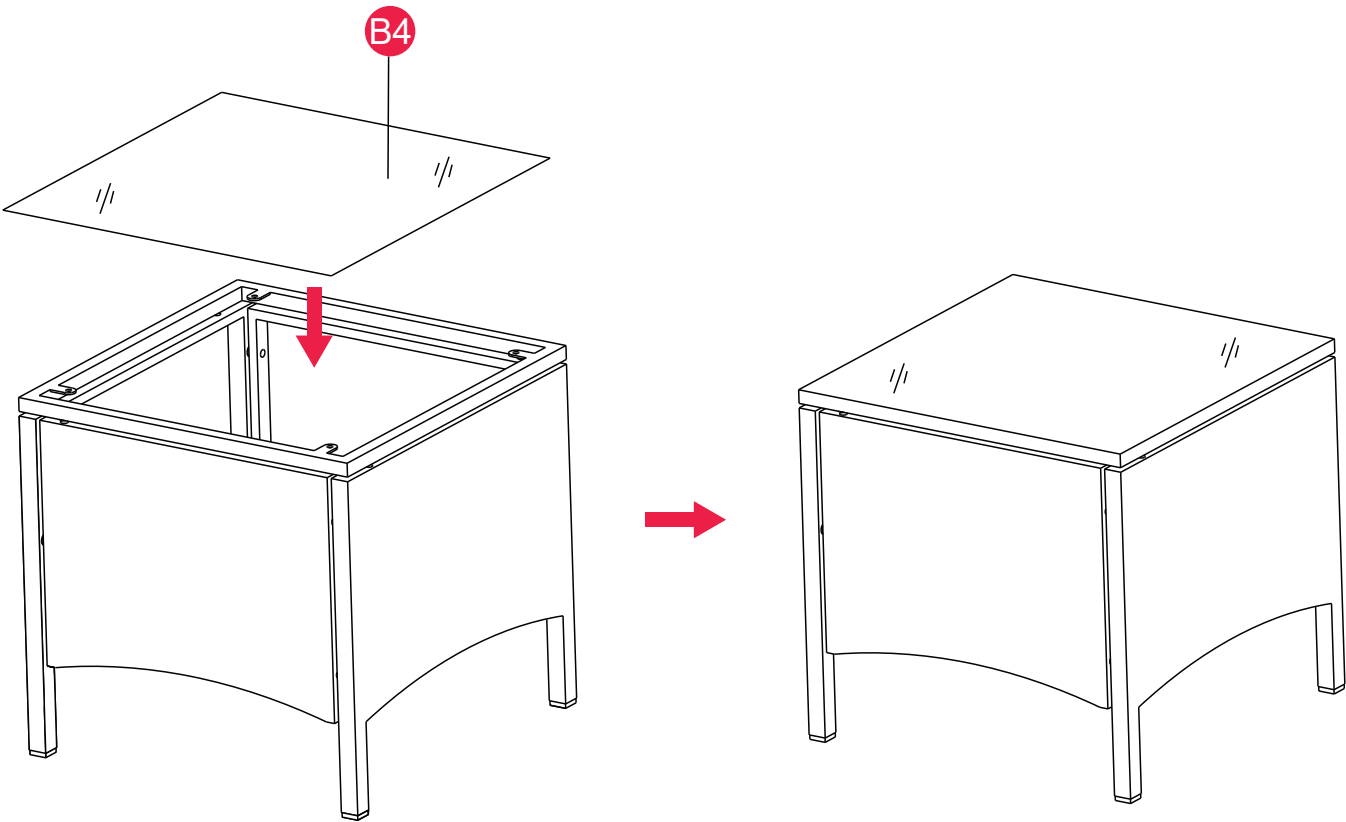



If you have any questions,  
please contact customer service:  
***E-mail: [Pamapic@hotmail.com](mailto:Pamapic@hotmail.com).***  
***Facebook: [@Pamapic.Official](https://www.facebook.com/Pamapic.Official)***

