

GE LED Recessed Downlight

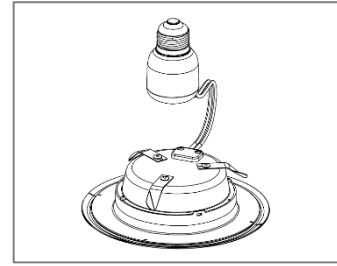

BEFORE YOU BEGIN

Read these instructions completely and carefully.



WARNING

- Risk of fire or electric shock. LED Retrofit installation requires knowledge of luminaires electrical systems. If not qualified, do not attempt installation. Contact a qualified electrician.
- Risk of fire or electric shock. Install this kit only in the luminaires that have the construction features and dimensions shown in the photographs and/or drawings and where the input rating of the retrofit kit does not exceed the input rating of the luminaire.
- Do not make or alter any open holes in an enclosure of wiring or electrical components during kit installation.
- To prevent wiring damage or abrasion, do not expose wiring to edges of sheet metal or other sharp objects.
- This device is not intended for use with emergency exits.
- This retrofit kit is accepted as a component of a luminaire where the suitability of the combination shall be determined by authorities having jurisdiction.

The units covered in this report are intended to retrofit Type IC or Non-IC recessed Listed luminaires with instructions to remove the existing trim. These products are intended to be used in dry or damp locations. These products are classified as to FIRE and SHOCK hazards only.

This device complies with Part 15 of the FCC Rules. Operations is subject to the following two conditions: (1) This device may not cause harmful interference. And (2) this device must accept any interference received, including interference that may cause undesired operation. This device complies with CAN ICES-005 B.

Note: This equipment has been tested and found to comply with the limits for a Class B digital device, pursuant to part 15 of the FCC Rules. These limits are designed to provide reasonable protection against harmful interference when the equipment is operated in a commercial environment. This equipment generates, uses, and can radiate radio frequency energy and, if not installed and used in accordance with the instruction manual, may cause harmful interference to radio communications. Operation of this equipment in a residential area is likely to cause harmful interference in which case the user will be required to correct the interference at his own expense.

Save These Instructions

Use only in the manner intended by the manufacturer. If you have any questions, contact the manufacturer.

Components Supplied

One LED retrofit

One installation instruction sheet

Prepare Electrical Wiring



Electrical Requirements

The LED downlights must be supplied with 120VAC 60Hz.



Grounding Instructions

The grounding and bonding of the overall system shall be done in accordance with National Electric Code(NEC) Article 600 and local codes.

Installation

The fixture is suitable for 4inch Recessed Can with minimum depth of 145mm.

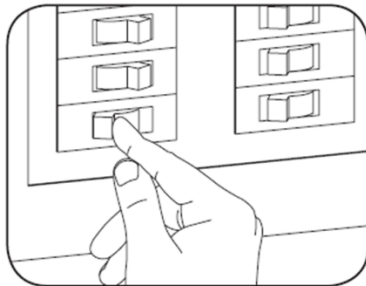

Figure 1

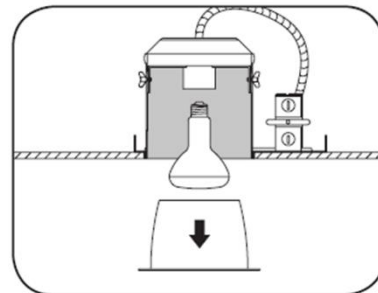

Figure 2

1 Turn off power at the source to the recessed housing(s) that you are installing the fixture(s) in.

2 Remove existing trim and bulb, revealing the housing and the existing socket inside.

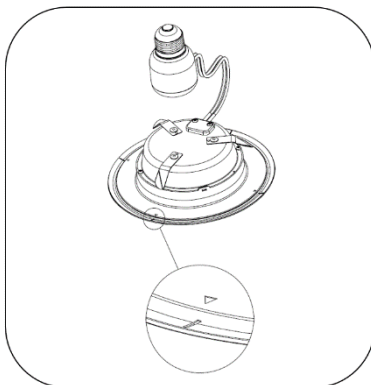
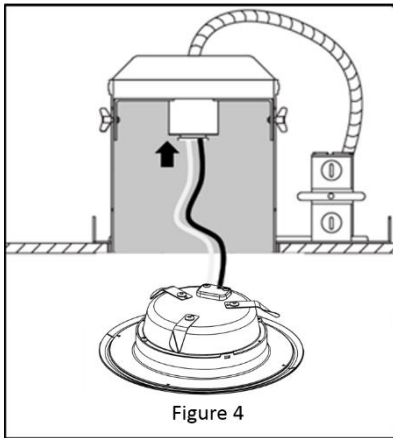
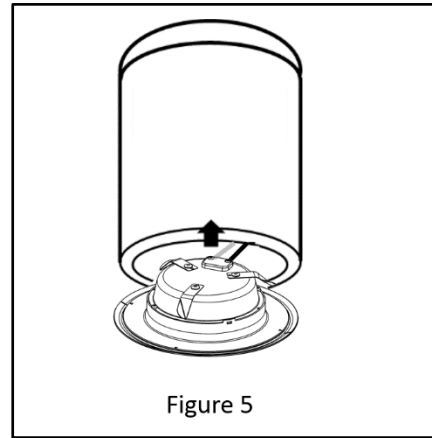

Figure 3

3 Check backside of RS recessed downlight, ensure marks aligned with between trim and trim plate.



④ Screw medium base LED driver into the existing socket inside the housing.



⑤ Guide fixture into the housing and gently push up until with the ceiling.

⑥ Restore power to the lighting system.

Trim Replacement

The fixture is designed as trim replacement option. Compatible with GE interchangeable trim part only (Figure 6.1).

Before trim replacement, ensure the fixture is out of housing with power off.

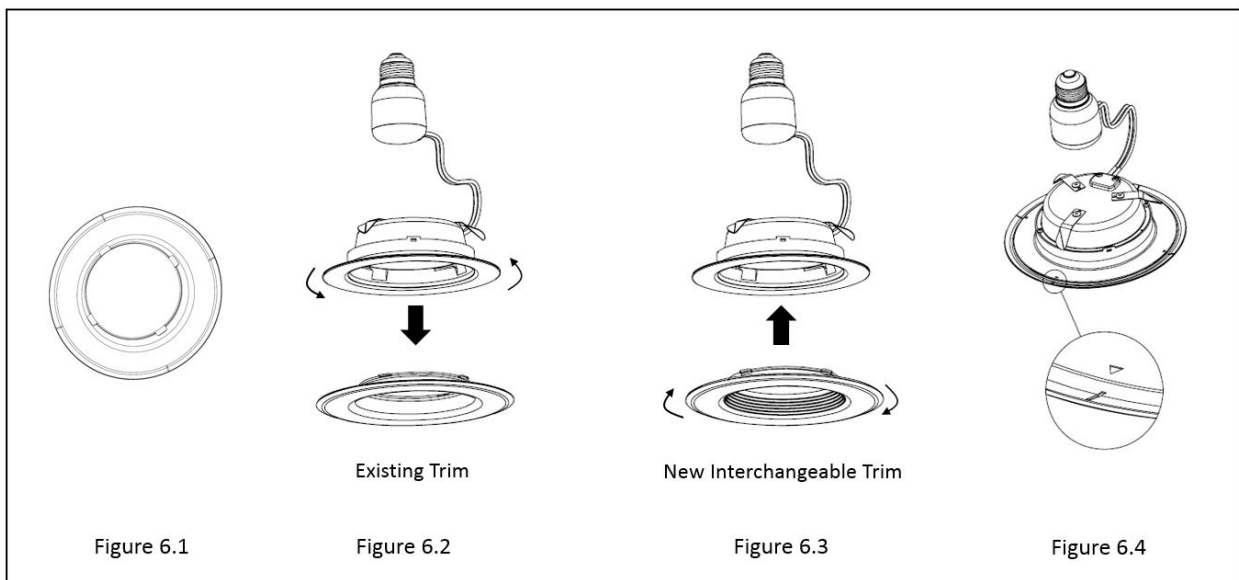

7 Remove existing trim (Figure 6.2) and install new interchangeable trim (Figure 6.3), ensure marks aligned with between trim and trim plate (Figure 6.4).

8 Follow 4 - 6 to finish installation.