



#### EN

With your inspiring rating, COSTWAY will be more consistent to offer you EASY SHOPPING EXPERIENCE, GOOD PRODUCTS and EFFICIENT SERVICE!

#### DE

Mit Ihrer inspirierenden Bewertung wird COSTWAY konsistenter sein, um Ihnen EIN SCHÖNES EINKAUFSERLEBNIS, GUTE PRODUKTE und EFFIZIENTEN SERVICE zu bieten!

#### FR

Avec votre évaluation inspirante, COSTWAY continuera à fournir une EXPÉRIENCE D'ACHAT PRATIQUE, des PRODUITS DE QUALITÉ et un SERVICE EFFICACE !

#### ES

Con su calificación inspiradora, COSTWAY será más consistente para ofrecerle EXPERIENCIA DE COMPRA FÁCIL, BUENOS PRODUCTOS y SERVICIO EFICIENTE.

#### IT

Con la tua valutazione incoraggiante, COSTWAY sarà più coerente per offrirti ESPERIENZA DI ACQUISTO FACILE, BUONI PRODOTTI e SERVIZIO EFFICIENTE!

#### PL

Dzięki twojej opinii COSTWAY będzie mógł oferować jeszcze WYGODNIEJSZE ZAKUPY, LEPSZE PRODUKTY i SPRAWNIEJSZĄ OBSŁUGĘ KLIENTA.

**US** office: Fontana

**UK** office: Ipswich

**AU** office: Truganina

**DE** office: Hamburg

**FR** office: Saint Vigor d'Ymonville

**PL** office: Gdańsk

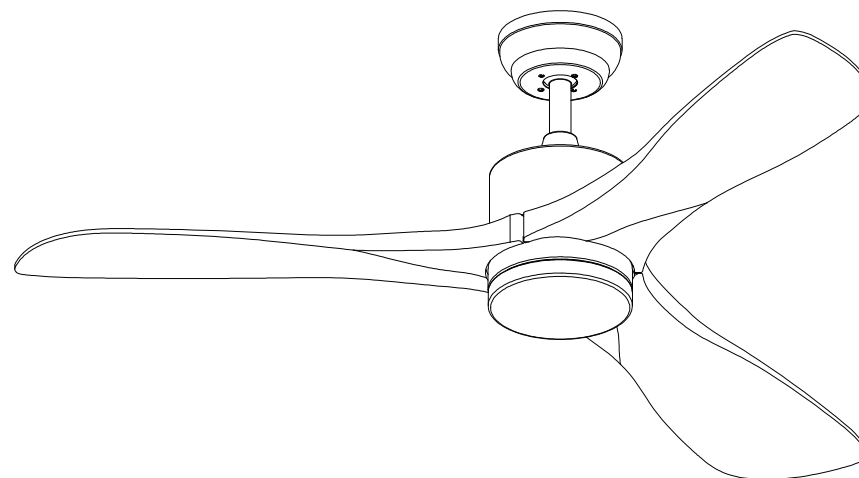

## USER'S MANUAL

### 52-Inch Ceiling Fan ES10118US

THIS INSTRUCTION BOOKLET CONTAINS **IMPORTANT** SAFETY INFORMATION. PLEASE READ AND KEEP FOR FUTURE REFERENCE.

## Safety Information

- 1.To reduce the risk of electric shock,the electricity has been turned off at the circuit breaker or fuse box before begin.
- 2.The outlet box and support structure must be securely mounted and capable of reliably supporting 35 lbs.
- 3.The fan must be mounted with a minimum of 7.5ft clearance from the trailing edge of the blades to the floor.
- 4.Do not operate the reversing switch while the fan blades are in motion. You must turn the fan off and stop the blades before you reverse the blade direction.
- 5.Do not place objects in the path of the blades.
- 6.To avoid personal injury or damage to the fan and other items, please be careful when walking around or cleaning the fan.
- 7.After making electrical connections, spliced conductors should be turned upward and pushed carefully up into the outlet box. The wires should be spread apart with the grounded conductor and the equipment-grounding conductor on one side of the outlet box.
- 8.All setscrews must be checked and retightened where necessary before installation.



### WARNING:

To reduce the risk of personal injury, do not bend the blade brackets (also referred to as flanges) during assembly or after installation. Do not insert objects in the path of the blades.

Remove the rubber motor stops on the bottom of the fan before installing the blades or testing the motor.

To reduce the risk of fire or electric shock,do not use this fan with any solid-state speed control device.

To avoid possible electric shock, turn the electricity off at the main fuse box before wiring. If you feel you do not have enough electrical wiring knowledge or experience, contact a licensed electrician.

To reduce the risk of fire, electric shock, or personal injury, mount to outlet box marked "Acceptable for fan support of 35 lbs or less" and use the screws provided with the outletbox.

## Pre-Installation

### SPECIFICATION

Size	Speed	Volts	Amps	Watts	RPM	CFM	Net Weight	Gross Weight	Cubic Feet
52-Inch	Level 1	120	0.10	12.6	103	2408	12.12LBS 5.5KG	14.99LBS 6.8KG	2.57 cu. ft
	Level 2		0.12	15.6	122	3360			
	Level 3		0.18	22.4	135	4200			
	Level 4		0.27	32.1	153	5152			
	Level 5		0.30	39.6	175	5694			
	Level 6		0.35	48.8	185	5992			

The above data are for reference only, actually the motor speed of each ceiling fan is a little different. Any product is subject to actual products as standard.



**NOTE:** These are a pproximate measures. They do not include the amps and wattage used by the light kit.

Specifications & measurements shown are subject to± 5% variations.

### TOOLS REQUIRED



Phillips  
screwdriver



Flat blade  
screwdriver

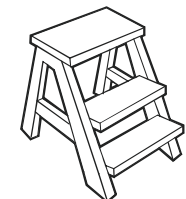

Step ladder

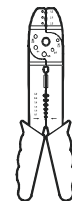

Wire stripper



Electrical tape

## Pre-Installation (continued)

### HARDWARE INCLUDED

components table

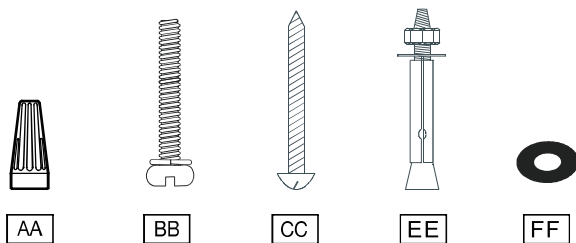

NOTE: Hardware not shown to actual size

AA	Plastic wire nut (not to scale)	3
BB	Blade arm screw and lock washer	7
CC	Mounting screws	4
EE	Expansion Bolts	2
FF	Washers	7

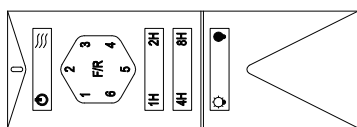

Remote control (Transmitter)x1

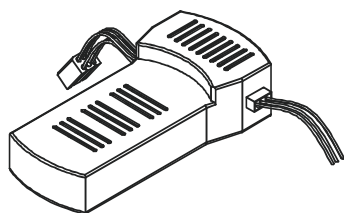

Remote control (receiver)x1

## Pre-Installation (continued)

### PACKAGE CONTENTS

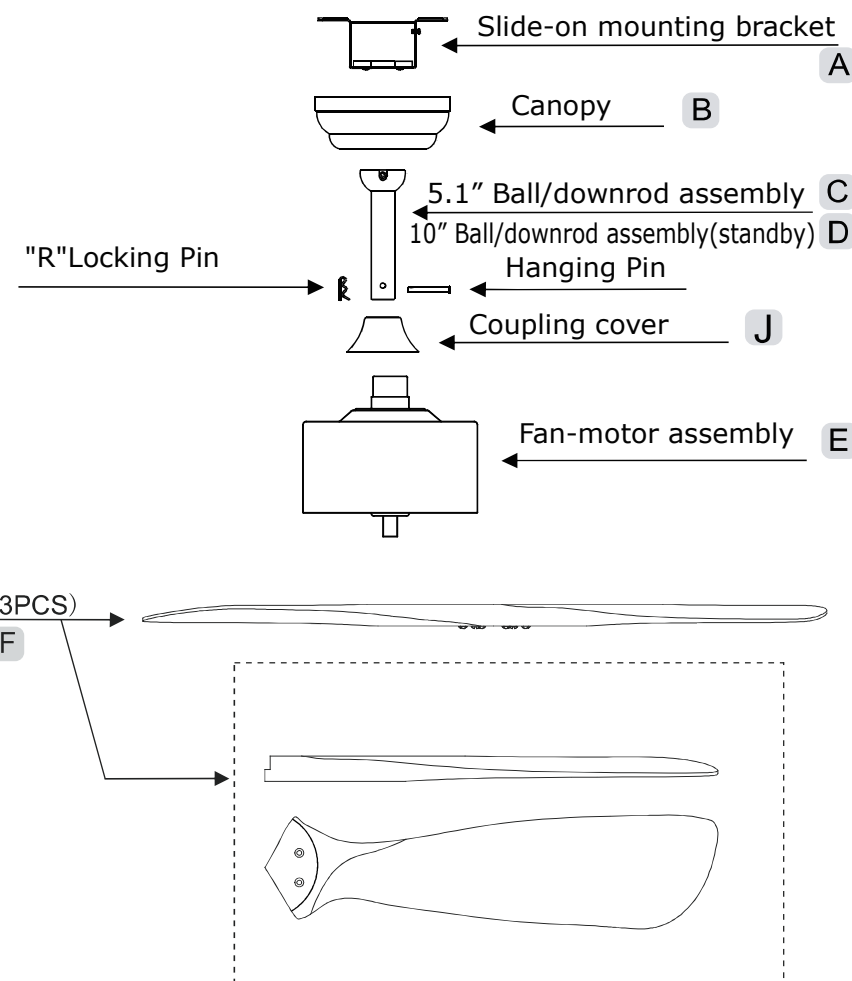

Please check whether above accessories are completed or not?Yes,and install.

## Installation of the hanging bracket (suspension part)

### WOODEN CEILING

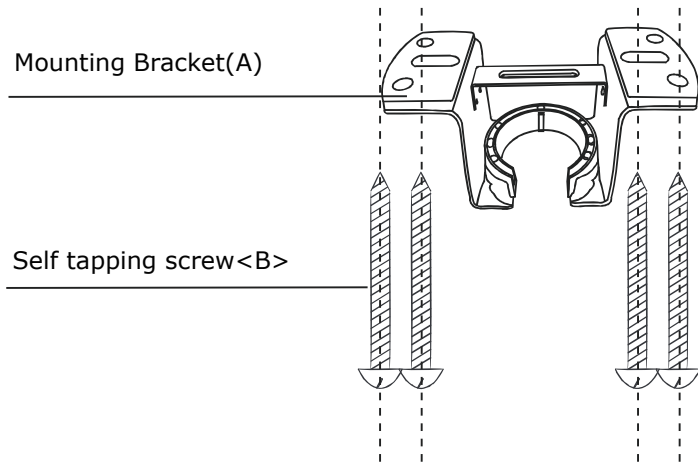

For wooden ceiling, use wood screw to drill on the wooden beam or the "junction box" to fix the hanging bracket (selection is made according to actual requirements of the customers).

#### STEP 1 A-WOODEN CEILING

SWITCH OFF THE ELECTRICAL MAINS AT THE CIRCUIT BREAKER FUSE Box

- 1) Use the Mounting Bracket (A) as a guide, mark the spots where the 4 Self Tapping Screws (B) will be drilled.
- 2) Remove the Mounting Bracket (A), drill 4 holes for 3MM diameter, install the mounting bracket onto wooden ceiling with the 4 Self Tapping Screws (B).

**⚠ IMPORTANT: SCREWS MUST BE TIGHTENED TILL SNUG**

## Installation of the hanging bracket (suspension part)

### CONCRETE CEILING

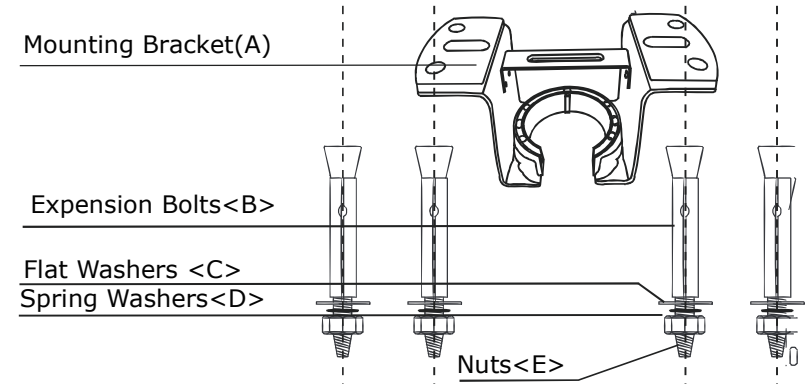

Note: According to the ceiling of different materials, use different screws to fix the hanging bracket. Don't fix the hanging bracket on the wood ceiling less than 0.5" to prevent danger caused by loosening of screws.  
After the hanging bracket is completed, ensure that it can withstand the tension test of more than 150 LBS for safety.

For concrete ceiling, use the percussion bit with diameter 0.3" to drill holes according to the length of expansion screws. Then use the attached expansion screws to fix the hanging bracket onto the ceiling (selection is made according to actual requirements of the customers).

#### STEP 2 A-CONCRETE CEILING

SWITCH OFF THE ELECTRICAL MAINS AT THE CIRCUIT BREAKER FUSE BOX.

- 1) Use the Mounting Bracket (A) as a guide, mark the spots where the 4 Expansion Bolts (B) will be drilled.
- 2) Remove the Mounting Bracket (A), drill 4 holes and insert 4 Expansion Bolts (B) into the concrete ceiling, install the mounting bracket and secure with Flat Washers (C), Spring Washers (D) and Nuts (E)

**⚠ IMPORTANT: SCREWS MUST BE TIGHTENED TILL SNUG**

## Install the hanging part of the ceiling fan

### Making the electrical connections

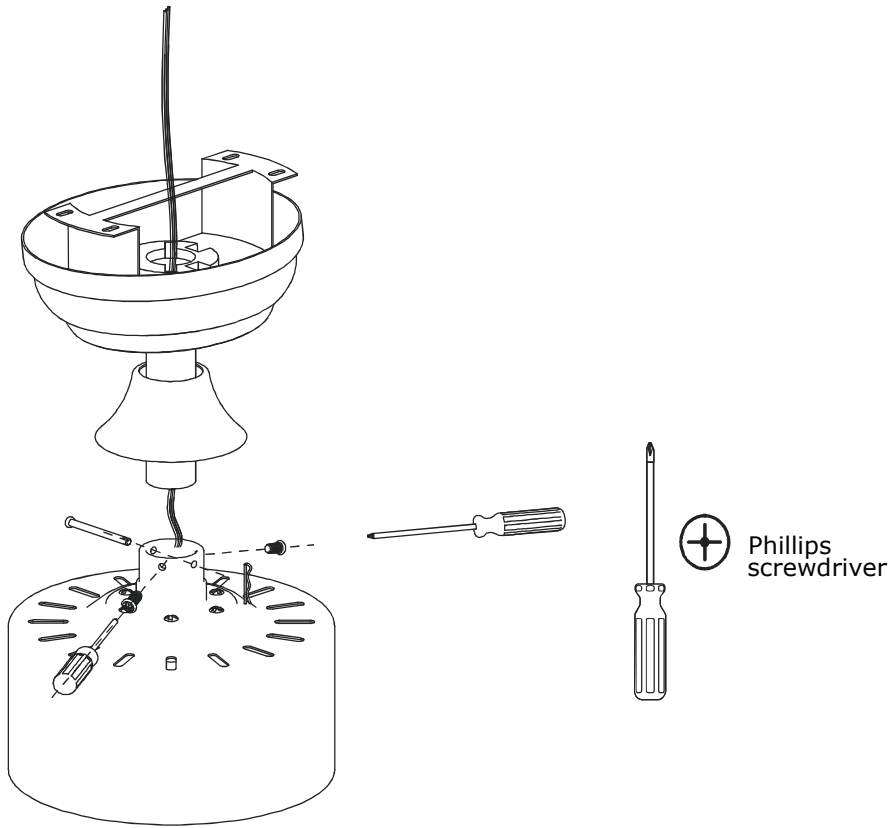

1. Thread the suspender through the suspended clock and coupling cover.
2. Then insert the tail of the suspender from the lifting head of the motor.
3. After the lateral pin is threaded out from the suspended head position, insert R type pin.
4. Tighten the lifting head screws.
5. Hang the fan of the hanging pipe into the hanger.

## Assembly - Hanging the Fan(continued)

### Make wire connections



**WARNING:** Each wire not supplied with this fan is designed to accept up to one 12-gauge house wire and two wires from the fan. If you have larger than 12-gauge house wiring or more than one house wire to connect to the fan wiring, consult an electrician for the proper size wire nuts to use.



**WARNING:** Remove the rubber motor stops on the bottom of fan before installing the blades or testing the motor.



**IMPORTANT:** Use the plastic wire connectors supplied with your fan. Secure the connectors with electrical tape and ensure there are no loose strands or connections.



**WARNING:** Ensure that the wires are firmly connected without looseness.

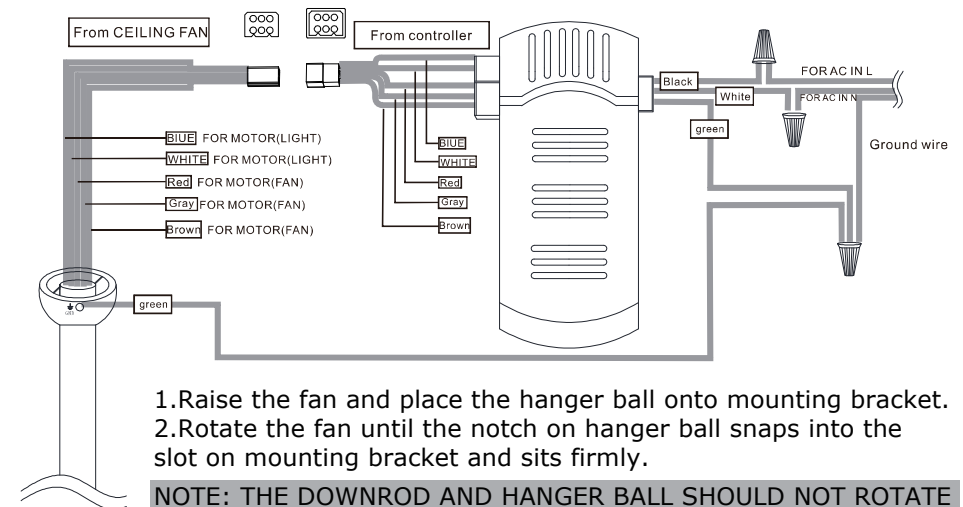

3. Loose the safety wire clamp.
4. Route the safety wire through the side fan hole on the mounting bracket, and retighten the safety wire with safety wire clamp.
5. Connect the wire connector plugs correctly. The wire connector plugs design with misplug-proof device, please don't force to plug. Otherwise it may affect the normal use of the light fan or burn the fan motor.

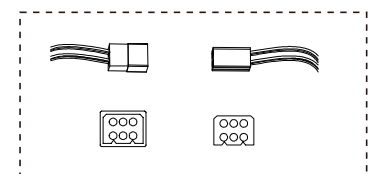

## Assembly - Hanging the Fan (continued)

### Preparing for mounting

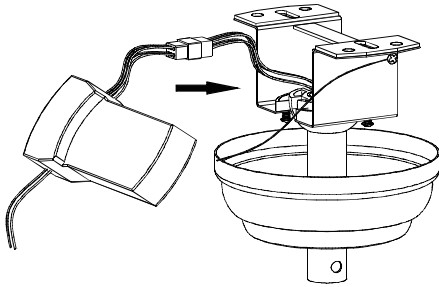

Install remote control

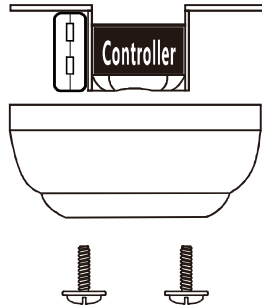

Preparing for mounting

1. Carefully push the canopy to the bottom of the mounting bracket, make two sliding holes aligned to the two prominent screws on the mounting bracket, and then turn clockwise until tight.
2. Push the canopy ring to the bottom of the canopy, slide the inner holes aligned to the two prominent screws on the mounting bracket again, and turn the canopy ring clockwise until tight.

1. Remove the mounting bracket from the canopy by loosening the two canopy screws located in the L shaped slots.
2. Remove and save the two canopy screws in the round holes. This will enable you to remove the mounting bracket

## Assembly - Attaching the Fan Blades

### 1. Attaching the blades to the arms

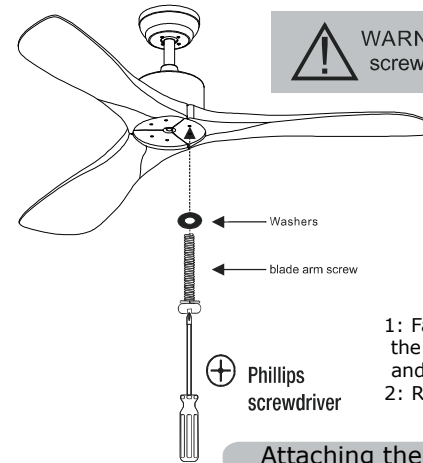

**WARNING:** When installing the fan blade, the fan blade screw must be fitted into the gasket before installation!

- 1: Fasten the arm to the fan-motor assembly by inserting the alignment post into the slot on the bottom of the motor and tightening the pre-installed arm screws.
- 2: Repeat this step for the remaining blade assemblies.

Attaching the blades to the arms

### Assembly - Attaching the Lights

#### Install light source

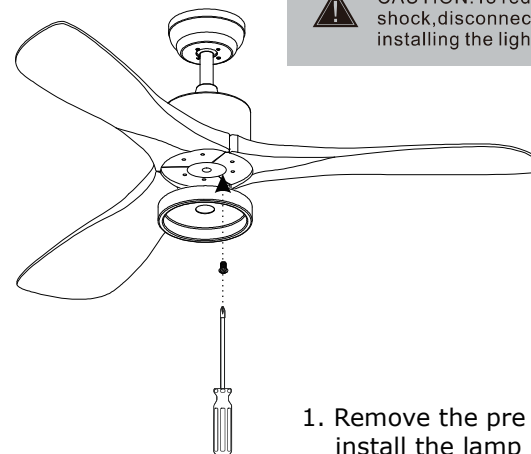

**CAUTION:** To reduce the risk of electric shock, disconnect the electrical circuit to the fan before installing the light fixture.

1. Remove the pre installed screws and install the lamp panel to the specified position

Fastening the blade arms to the motor

## Assembly - Attaching the Lights (continued)

### Install light source

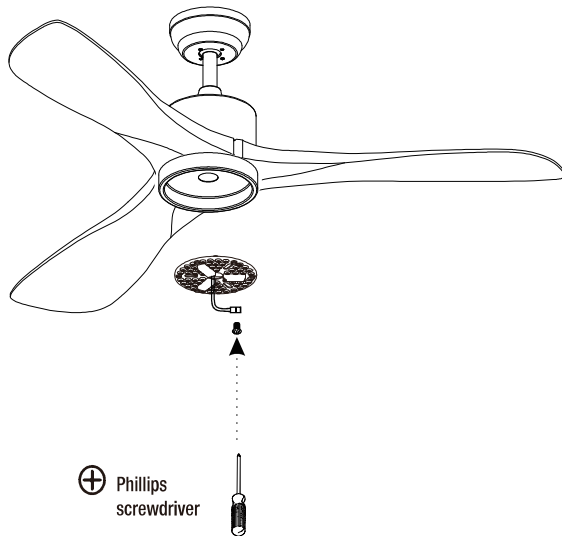

1. Remove the pre installed screws and install the lamp at the specified position

### Connecting lamp wire

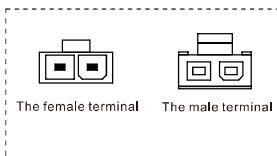
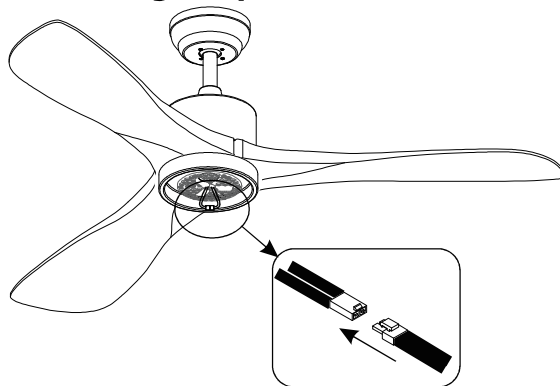

1: Put the LED light source into the disc (the LED light source has a magnet, which can be directly magnetized on the disc)  
2: Pass the LED lead of the motor through the hole in the middle of the LED light source.  
3: Then plug the male terminal of LED lead into the female terminal of LED light source, (as shown in figure)

## Assembly - Attaching the Lights



**WARNING:** Allow the shatter resistant bowl to cool completely before removing.



**CAUTION:** Make sure the power is off before attaching or removing the shatter resistant bowl.



**CAUTION:** Do not over tighten the hex nut, overtightening the hex nut may cause the shatter resistant bowl to break.

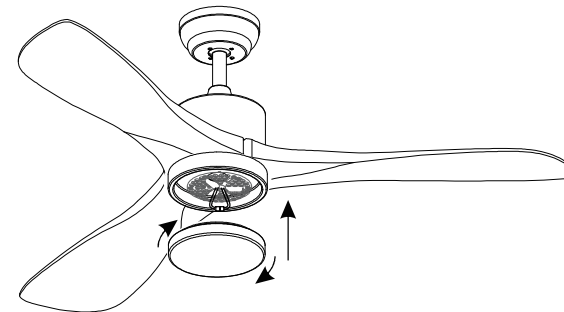

1. Rotate and install the glass lamp cover to the fan.

## Operation

### OPERATING YOUR FAN

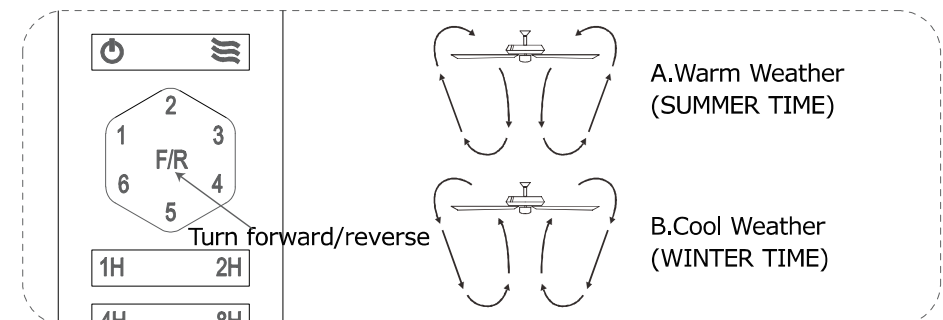

**NOTE:** Wait for the fan to stop before reversing the direction of the blade rotation

## Use of Remote Control

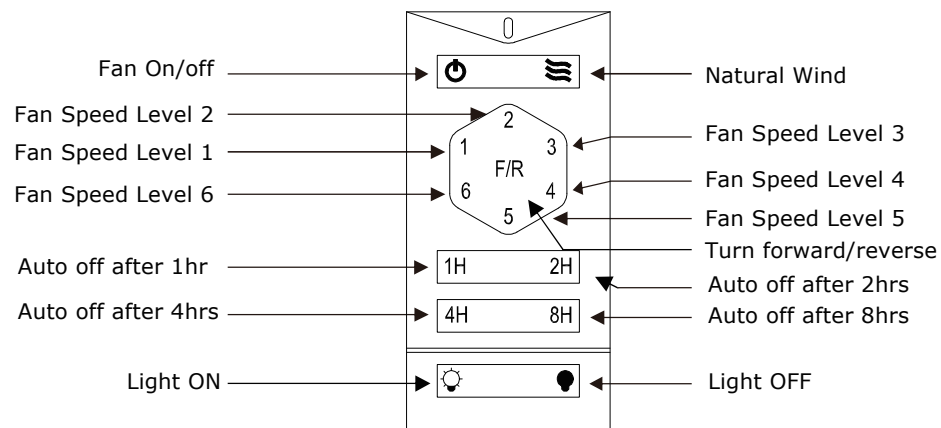

## Care and Cleaning



**WARNING:** Make sure the power is off before cleaning your fan.

- Because of the fan's natural movement, some connections may become loose. Check the support connections, brackets, and blade attachments twice a year. Make sure they are secure. It is not necessary to remove the fan from the ceiling.
- Clean your fan periodically to help maintain its new appearance over the years. Do not use water when cleaning, as this could damage the motor or the wood, or possibly cause an electrical shock. Use only a soft brush or lint-free cloth to avoid scratching the finish. The plating is sealed with a lacquer to minimize discoloration or tarnishing.
- You can apply a light coat of furniture polish to the wood for additional protection and enhanced beauty. Cover small scratches with a light application of shoe polish.
- You do not need to oil your fan. The motor has permanently-lubricated sealed ball bearings.

## TROUBLESHOOTING

### Problem

### Solution

The fan will not start

- Check the main and branch circuit fuses or breakers.
- Check the line wire connections to the fan and switch wire connections in the switch housing.

- Ensure all motor housing screws are snug.
- Ensure the screws that attach the fan blade bracket to the motor hub are tight.
- Ensure the wire nut connections are not ratting against each other or the interior wall of the switch housing.
- Allow a 24-hour "breaking in" period. Most noises associated with a new fan disappear during this time.
- If you are using the Ceiling Fan light kit, ensure the screws securing the glassware are tight. Check that the light bulbs are also secure.
- Ensure the canopy is a short distance from the ceiling. It should not touch the ceiling.
- Ensure your outlet box is secure and rubber isolator pads were used between the mounting plate and outlet box.

The fan wobbles

- Check that all blades and blade arm screws are secure.
- Most fan wobble problems are caused when blade levels are unequal.
- Check this level by selecting a point on the ceiling above the tip of the blades.
- Measure from a point on the center of each blade to the point on the ceiling. Measure this distance. Rotate the fan until the next blade is positioned for measurement.
- Repeat for each blade. Any measurement deviation should be within 1/8 inch.
- Run the fan for ten minutes. If the fan continues to wobble, please contact the qualified technician.