

Outdoor Post Light Installation Instructions

⚠ WARNING:

1. To avoid fire, shock, or death, disconnect power at circuit breaker or fuse before the installation.
2. If you are unsure about the installation or maintenance of the Outdoor Lights, please consult a qualified electrician.

⚠ SAFETY:

1. Please read all warnings and instructions before installation.
2. The fixture must be wired in accordance with the National Electric Code and applicable local codes or ordinances.
3. To insure personal safety, proper grounding is required.

INSTALLATION NOTES:

1. This fixture should not be used in areas with limited ventilation or high ambient temperature exceeding 113°F (45°C).
2. Fixture cannot be used with a dimmer switch.

INSTALLATION LOCATION:

This fixture must only be post mounted. Be certain that the receiving junction box is well secured and can support the weight of the lamp.

PRODUCT DIMENSIONS:

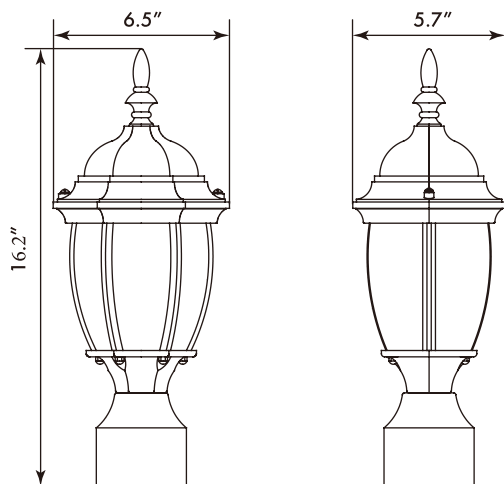

PRODUCT SPECIFICATION:

Part Number: MEL-17125W
Input Voltage: 120 VAC
Frequency: 60 Hz
Rated Power: 17W
Suitable for: Wet Locations

THREE YEAR WARRANTY:

Maxxima extends a 3 year limited warranty to the original purchase that the products listed are free from defects in material and/or workmanship only. Maxxima will replace any warranted product to the original consumer/purchaser if the product fails because of defects due to workmanship and/or materials within the limited warranty period. Limited warranty is not transferable and applies to the original installation of the Maxxima product. This offer does not constitute in any way a product guarantee and Maxxima does not hereby assume any obligation whatsoever beyond sending a free replacement product.

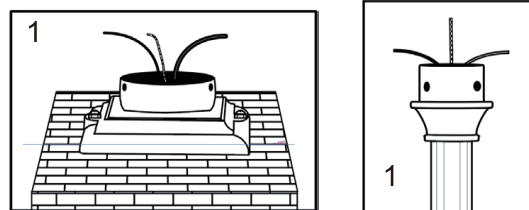

- 1 - Post Mount (not included)
- 2 - Post Mounting Screws (3 pcs)
- 3 - Wire Nuts (3 pcs)
- 4 - Fixture

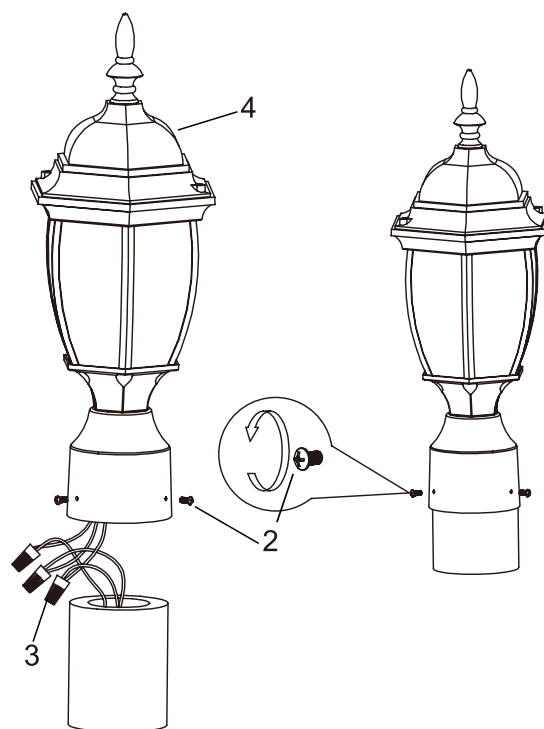

INSTALLATION INSTRUCTION:

CAUTION: Read WARNING and SAFETY Notes before beginning installation

Please refer to Figure 1 and Figure 2 while following installation instructions.

1. Make sure POWER is turned OFF at the circuit breaker box or remove fuse.
2. Carefully disconnect and remove the old light fixture if applicable.
3. Locate and retrieve the supply wires from the JUNCTION BOX.
 - a. Connect the white wire from the fixture to the NEUTRAL wire in the JUNCTION BOX (typically white).
 - b. Connect the black wire from the fixture to the HOT wire in the JUNCTION BOX (typically black).
 - c. Connect the Yellow/Green wire to the GROUND wire in the JUNCTION BOX (typically bare).
4. Tuck electrical wiring into post and place the fixture onto the post mount. Tighten the fixture onto the post mount with the post mounting screws provided.
5. Turn power ON at circuit breaker (or replace fuse) and confirm that the fixture is functioning properly.
6. Once functionality is confirmed, consider use of waterproof glue or silicone caulk to seal the FIXTURE BASE to the wall surface to ensure that the fixture is completely waterproof. If water enters the junction box, it may damage the fixture and/or building/residence.