



QUICK START GUIDE

AS1000 Series

THANK YOU FOR PURCHASING YOUR NEW EUREKA VACUUM!

Please take a few moments to read this Quick Start Guide. It is designed to help you assemble your vacuum easily.

To view our "How to Assemble" demo, visit www.eureka.com/airspeed/assembly

If you have questions about your new vacuum, please contact our customer service helpline at **1-800-282-2886**. We're here to help!

Helpline Hours:

8 a.m. to 7:30 p.m. (CST), Monday - Friday

10 a.m. to 6:30 p.m. (CST), Saturday - Sunday

eureka!
Invented for the way you clean™

STEP 1

What's in the carton

No screws
or tools
required!

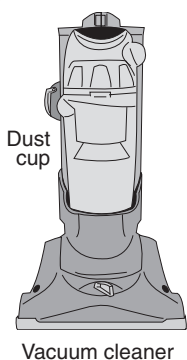

Dust cup
Vacuum cleaner



OWNER'S
GUIDE
REGISTRATION
Important Safeguards

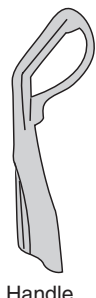

Handle

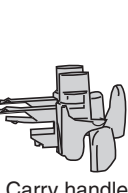
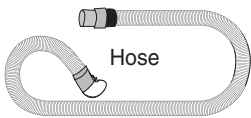

Hose
Carry handle



Extra belt



Turbo nozzle



Filter cleaning
brush



Dusting
brush

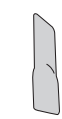

Crevice
tool



Hose release wand **A**
and wand **B**

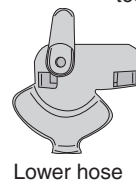

Lower hose
retainer



Upper hose
retainer

STEP 2

Easy assembly



PLEASE READ ALL INSTRUCTIONS BEFORE USING THIS VACUUM CLEANER.
Moving parts! Assemble the vacuum cleaner before using.

Follow
1-12
in order
to ensure
proper
assembly.

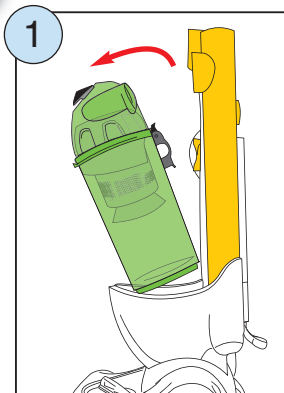

1 Remove dust cup.

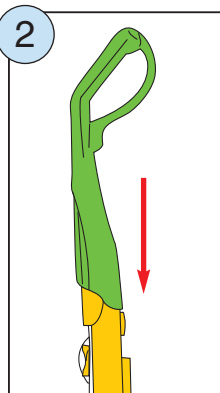

2 Place handle on vacuum; push down to snap in place.

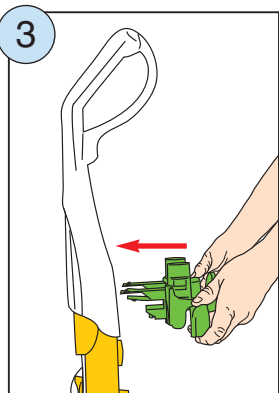

3 Slide carry handle into back of handle. Snap into place.

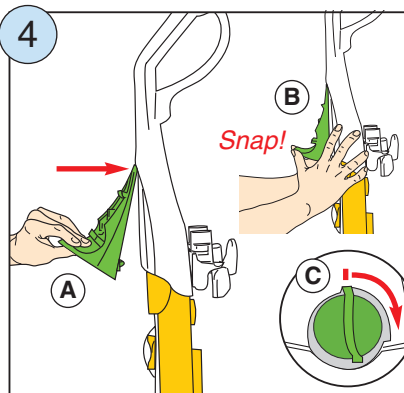

4 Insert top tab of turbo holder into handle. Place thumbs on each side and snap bottom corners into place. Turn knob to lock.

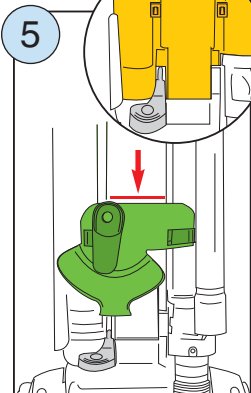

5 Place lower hose retainer in slots on back of vacuum. Push down past rib.

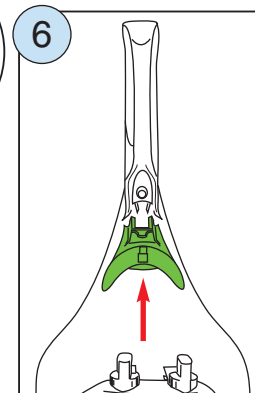

6 Place upper hose retainer on back of handle. Push up to snap into place.

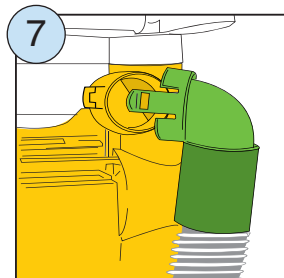

7 To install hose connector, align tab at right and snap on at left.

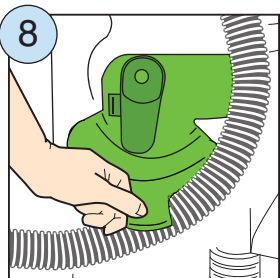

8 Pull out bottom of lower hose retainer and position hose.

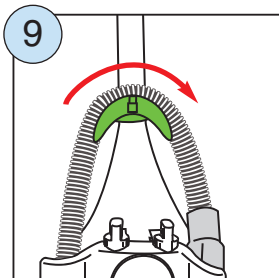

9 Place hose over upper hose retainer.

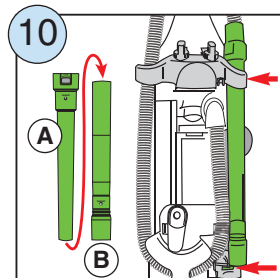

10 Push **A** onto end of hose; slide **B** over **A**. Place over bottom hook; snap in at top.

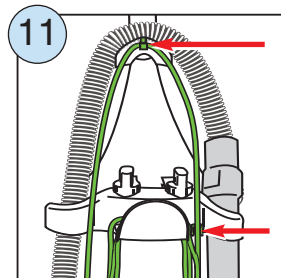

11 Push cord into carry handle and upper cord retainer. Wrap cord.

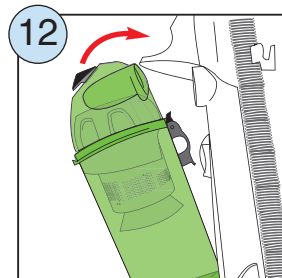

12 Place dust cup on vacuum. Push back to latch.

STEP 3

Get ready to vacuum

Power
switch is
marked
① for
on-off.

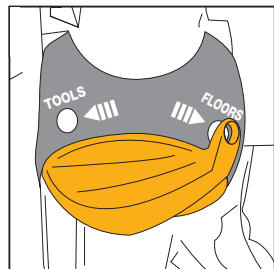

1 To vacuum floors, turn air path knob to 'floors.'

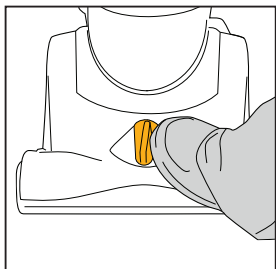

2 Adjust height for carpet or bare floors.

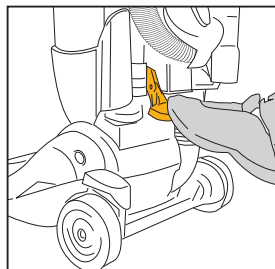

3 Step on power switch to turn on; step on again to turn off.

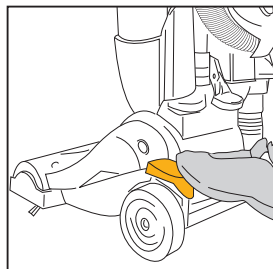

4 Step on handle release to lower handle into position.

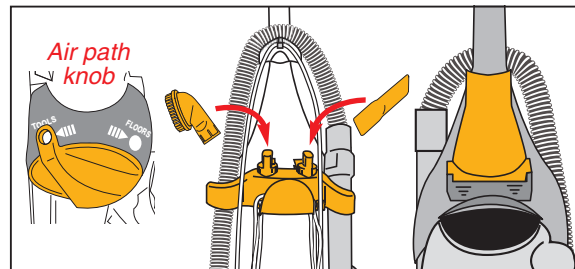

5 Attach tool to end of wand. Turn air path knob to 'tools.' Store tools on carry handle and turbo nozzle in holder.

STEP 4

Clean and assemble dust cup

Empty dust
cup after
each use.

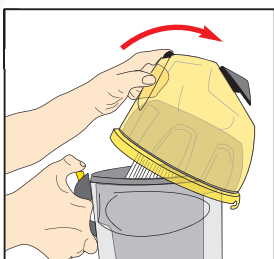

1 Pull back latch to lift off lid.

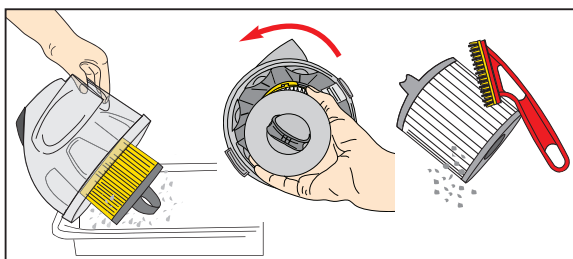

2 For quick clean: tap filter. To clean thoroughly: grasp filter and twist to remove from lid. Brush off debris.

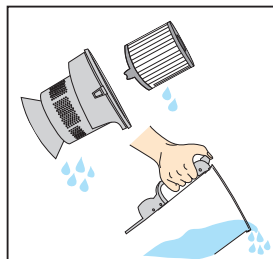

3 Remove screen. Rinse screen, filter and dust cup. Dry thoroughly.

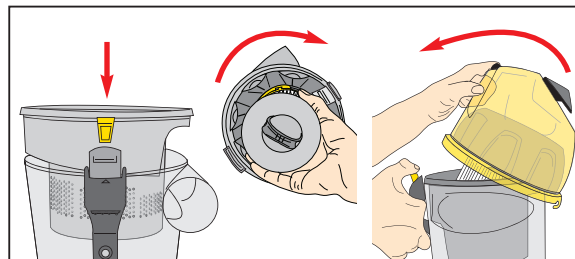

4 Align tab with slot to reinstall screen. Grasp filter and twist in lid to reinstall. Align lid at front; press down until lid snaps.