

BOSMA

EX PRO



Installation Instruction

1. Buttons



2. In the box

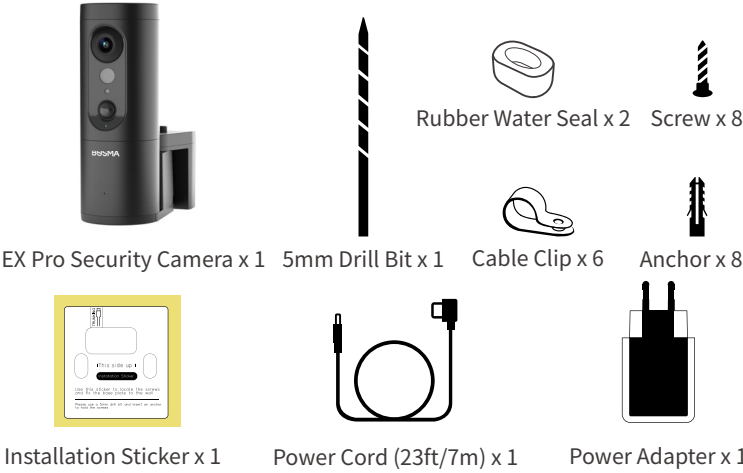

Warning: Longer power cords may cause significant voltage drop, causing the camera to not power up or malfunction. We highly recommend only using the included power adapter and power cord.

3. Tools you may need

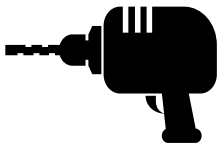

Drill

(May need a hammer drill for brick or concrete walls)



Hammer



Pencil



Screwdriver

4. Installation - EX PRO

Requirements:

Power Source: AC 100-240V, 50/60Hz

Note: While the EX Pro has a backup battery that can power the camera for a short period of time after it is unplugged, the EX Pro is NOT a battery operated camera, and it needs to be wired to a power outlet.

Helpful Resources:

1. For a video installation guide, and other resources, please visit EX Pro's support page: <https://www.bosmasmarthome.com/support/ex/>
2. For more troubleshooting steps and general questions, please visit EX Pro's FAQ page: <https://www.bosmasmarthome.com/faqs/ex/>

4.1 In-app Setup

It is highly recommended to add the camera in the Bosma app prior to installation. Please follow the steps below to set up the camera in the app.

1. Download "BOSMA" from Google Play or App Store.



BOSMA



2. Move your EX Pro close to the router, and connect it to power. Wait for about 30s until it says "waiting for connection".
 - If you did not hear the voice prompt, please reset the camera. To reset, quickly press the SYNC button at the bottom of the camera 5 times. You should hear the camera say "system reset".
3. Log in to BOSMA or create a new account.
4. Tap the "+" button at the top right corner of the screen.
5. Select "EX Pro" and follow the instructions on screen to complete the setup.

4.2 Installation Steps

Please make sure that the Wi-Fi signal is strong at the camera's installation location. You can check the Wi-Fi signal strength in the app after you have added EX Pro in the app.

1. Peel off the installation sticker. Stick the Installation Sticker on the wall. If you are routing the power cable through the wall to an indoor outlet, make sure that the cable hole is within the rectangular hole on the sticker.

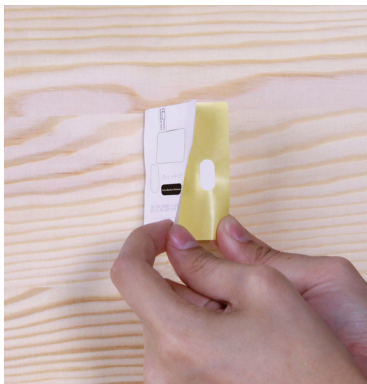

2. Use the 5mm drill bit to drill 2 holes at the marked spots on the sticker.



3. Insert the plastic anchors into the 2 holes. If necessary, use a hammer to gently tap them in until they're flush with the wall.



4. Connect the power cable to the power adapter's extension connector.

Note: The connector shown below is waterproof. However, please make sure that the power adapter is properly covered to avoid water damage.

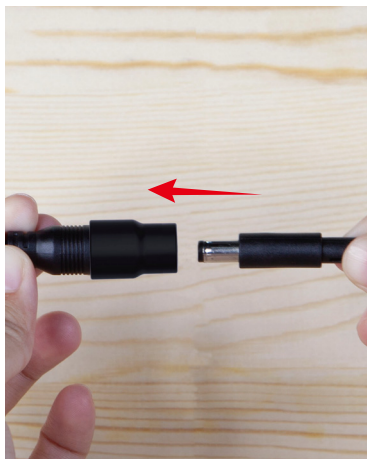

5. Press down the clip at the bottom and slide down to remove the mounting plate.



(1) Installation Option 1: If you are routing the power cable to an outdoor power outlet, follow steps 6-9 below.

6. Place the mounting plate on the wall. Use the screws to secure the mounting plate on the wall.



7. Mount the camera over the mounting plate, and slide down to lock it into the mounting plate.



8. Plug the power cable into the camera. It is recommended to plan the route of the cable from the power outlet to the camera so that it leaves some slack at both ends.



9. Use the cable clips to secure the cable to the wall. To install a cable clip, use the provided drill bit to drill a hole, insert a plastic anchor, wrap the cable clip around the cable, and use a screw to secure the clip.



(2) Installation Option 2: If you are routing the power cable through the wall to an indoor power outlet, follow steps 10-14 below.

10. If you are routing the power cable through the wall, before installing the mounting plate, make sure to leave a segment of the cable long enough to connect to the camera on the exterior side of the wall.



11. Place the mounting plate against the wall. Make sure the cable fits in the groove on the mounting plate.

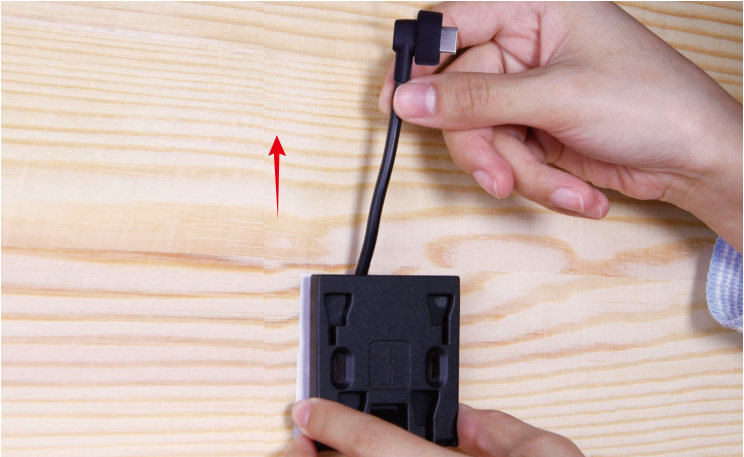

12. Make sure the direction of the cable groove matches that on the sticker. Use the screws to secure the mounting plate on the wall.

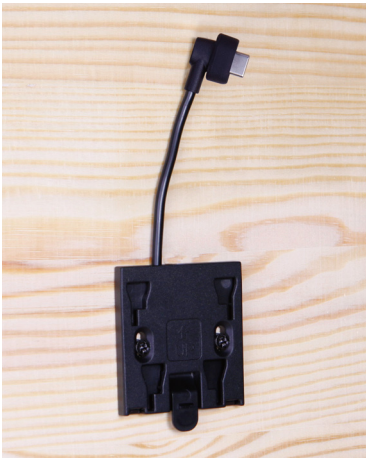

13. Mount the camera over the mounting plate, and slide down to lock it into the mounting plate.



14. Finally, plug the cable into the camera.



Warning: Make sure that the camera is installed upright. If installed upside down or horizontally, the camera may fail to be weatherproof and certain features may not work properly.

Correct



Incorrect



Incorrect





Customer Service

✉ support@bosmasmarthome.com

☎ 1(800)-976-0881

🌐 www.bosmasmarthome.com

* The Installation Instruction is subject to change without notice, please find the latest version on www.bosmasmarthome.com