

PRODUCT OVERVIEW

The **MSX12** fixture mount occupancy sensor provides reliable and versatile solutions for commercial and industrial lighting control applications. The sensor utilizes passive infrared (PIR) detection and features interchangeable lenses, providing flexibility for multiple mounting height and coverage pattern requirements.

SENSOR OPERATION

The sensor detects changes in the infrared energy given off by occupants as they move within the field-of-view. When occupancy is detected, a self-contained relay switches the connected lighting load on. No initial field calibration or sensitivity adjustments are required. The MSX12 is designed to switch both LED and fluorescent lighting loads. Robust relay protection makes MSX12 units capable of enduring the extreme inrush conditions often encountered with LED loads.

A standard occupancy time delay is also present to ensure lights turn off (once minimum on timer has also elapsed) if no occupancy is detected. This timer is factory set at 15 minutes to promote energy savings, but is adjustable between 30 seconds and 30 minutes. These adjustments may be done through the unit's push-button.

FEATURES

- Two interchangeable lenses included – high mount 360° and low mount 360°
- Integrated mounting bracket drops lens down 3" from chase nipple - no bracket accessory required
- 100% digital PIR detection - provides excellent RF immunity
- Operates single or multiple LED and fluorescent bay lights, strips or wraps
- Up to 60' detection range on the floor
- Mounting heights up to 45'
- Green LED indicator
- Default 15 minute occupancy time delay
- Mounts to standard 1/2" knockout on fixture or J-box
- Operating temperature 14° to 160°F



<http://bit.ly/Z3qcWD>

Catalog Number
Notes
Type

Contractor Select

Motion Sensor



Physical Specifications

Size (w/ Mounting Flange): 3.75" H x 2.50" W x 4.00" D (9.5 cm x 6.4 cm x 10.2 cm)

WEIGHT: 6 oz

MOUNTING: 1/2" knockout (7/8" hole) on fixture

COLOR: White

SILICONE FREE

ROHS COMPLIANT

Electrical Specifications

MAXIMUM LOAD: 800 W @ 120 VAC; 1200 W @ 277 VAC

MINIMUM LOAD: None

MOTOR LOAD: 1/4 HP

FREQUENCY: 50/60 Hz

Environmental Specifications

OPERATING TEMP: 14° to 160° F (-10° to 71° C)

RELATIVE HUMIDITY: 20 to 75% non-condensing
(electronics coated for corrosion resistance)

ORDERING INFORMATION

Catalog number	UPC	Description
MSX12	820476851148	Fixture Mounted Motion Sensor

Motion Sensor

MSX12 INSTRUCTIONS

LENS TYPES

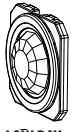

LOW BAY

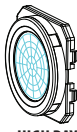

HIGH BAY

REMOVING THE LENS

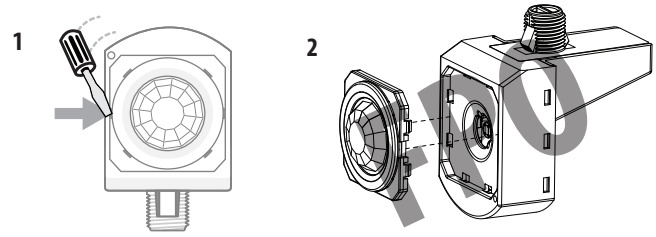

INSTALLING TO A FIXTURE USING BALLAST DISCONNECT

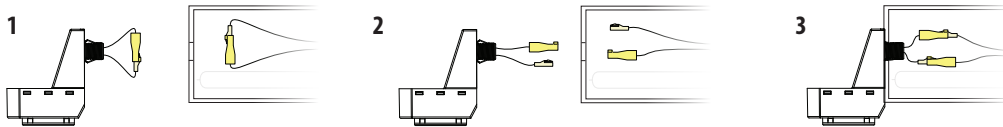

INSTALLING TO FIXTURE USING SUPPLIED BALLAST DISCONNECT

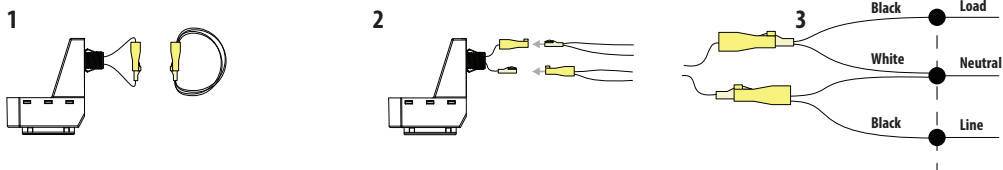

NOTE: If ballast disconnect plugs are cut, white wire with red stripe is Neutral. Cap off plain white wire.

COVERAGE PATTERN

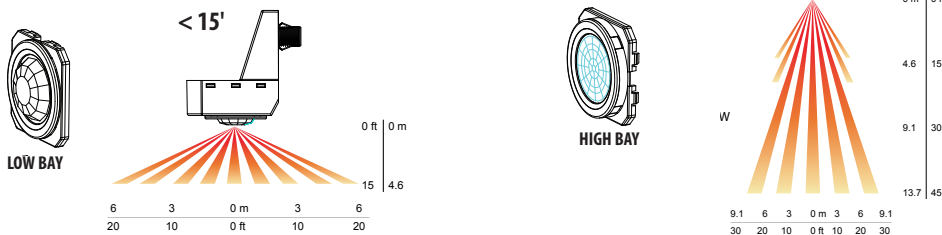

SUGGESTED:

LED Fixtures:
Time delay 10 min or less

Fluorescent Fixtures:
Time delay 15 min or greater

CHANGING THE TIME DELAY

