

# ASSEMBLY AND INSTALLATION INSTRUCTIONS

T0274 / T0275

**WARNING:** TO AVOID RISK OF ELECTRICAL SHOCK, BE SURE TO SHUT OFF POWER BEFORE INSTALLING OR SERVICING THIS FIXTURE.

**NOTES:** 1. Before installing, consult local electrical codes for wiring and grounding requirements.  
2. READ AND SAVE THESE INSTRUCTIONS.

## Hardware Package (included):

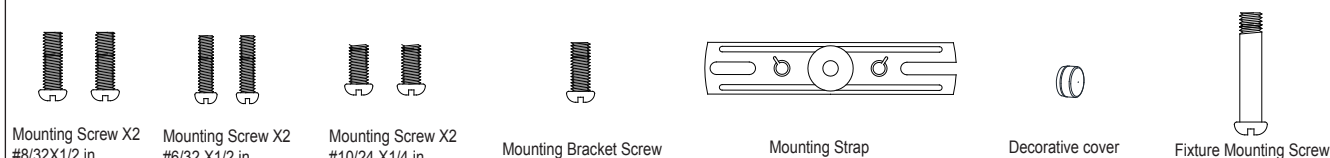

## Important to Know:

1. If you are not familiar with state and local electrical codes, it is recommended that you consult with a qualified electrician.
2. This fixture requires a 120 VAC, 60 Hz power source.
3. For general safety and to avoid any possible damage to the sensor, be sure the power is switched "off" before adjustment.

**Maximum Wattage: 29 W**

**Working Temperature Range: -4°F ~ 113°F**

## Features:

1. Energy saving LED fixture.
2. Motion sensor: turns light ON automatically when motion is detected and turns light OFF automatically when motion stops.
3. Photocell keeps the light OFF during daylight hours.

**Note:** Fixture can be wall mounted or eave mounted.

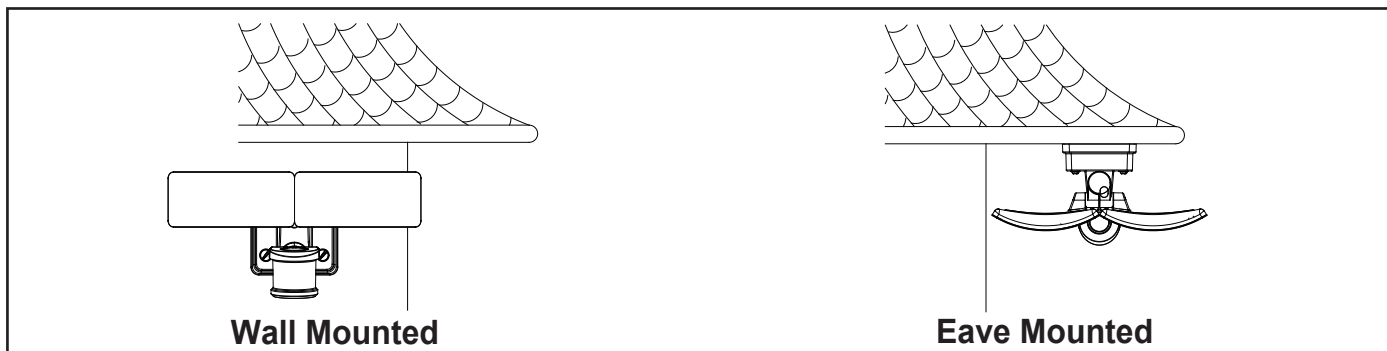

Read notes section on page 4 for additional information about mounting location of fixture.

Light fixture and sensor should be mounted as shown above when installed (depending upon type of installation)

Before installing the light fixture under an eave, the sensor head must be rotated as shown in the next two steps for proper operation and to avoid the risk of electrical shock.

For eave mounted only:

- Swing the sensor head towards the mounting bracket.

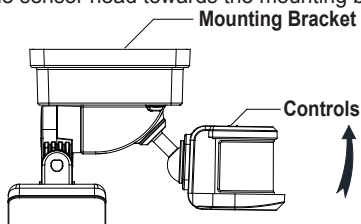

- Rotate the sensor head clockwise 180° so the controls face down

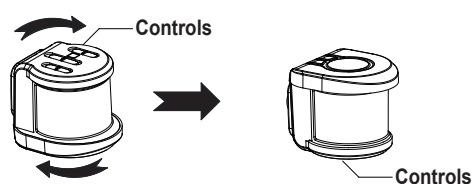

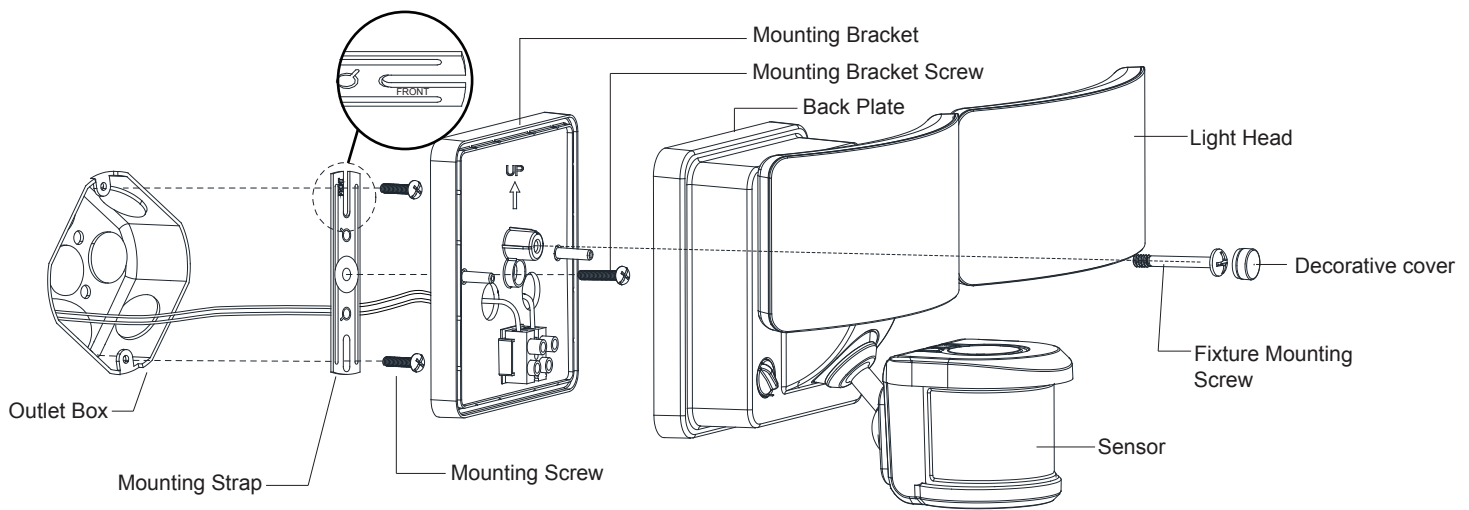

## Installation Steps

Turn off the power at fuse or circuit box.

1. The fixture mounting bracket is pre-assembled on the light fixture. Unscrew both the decorative cover and the fixture mounting screw in order to remove the mounting bracket.
2. Install the mounting strap to the outlet box with the stamped word "FRONT" facing away from the outlet box, using two mounting screws that best fit the outlet box. Mounting bracket should sit flush against wall surface when secured. (Choose one matching pair of suitable mounting screws from the 3 pairs provided)
3. Pull out the source wires from the outlet box. Unscrew the screws from the terminal station. And connect the black wire from the outlet box to the "L" interface of the terminal station on the mounting bracket. Connect the white wire from the outlet box to the "N" interface of the terminal station on the mounting bracket. Then tighten the screws back to screw the wires in place. Carefully tuck the wires back into the outlet box.
4. Place mounting bracket against the outlet box, insert the mounting bracket screw through the mounting bracket hole, thread mounting bracket screw into the center hole of the mounting strap. Tighten the mounting bracket screw securely.
  - ▲ When mounting to a wall, the "UP" arrow must point upward. (See Fig. 1)
  - ▲ When mounting to an eave, the "UP" arrow must point toward the building.
5. Attach the back plate of the light fixture to the mounting bracket, secure it with the fixture mounting screw.
6. Push the decorative cover firmly into the fixture mounting screw hole on the light fixture.
7. With silicone caulking compound, caulk completely around where the mounting bracket meets the wall surface.
 

**CAUTION: Be sure to caulk completely where the mounting bracket meets the wall surface to prevent water from seeping into the outlet box.**

**Fig. 1**

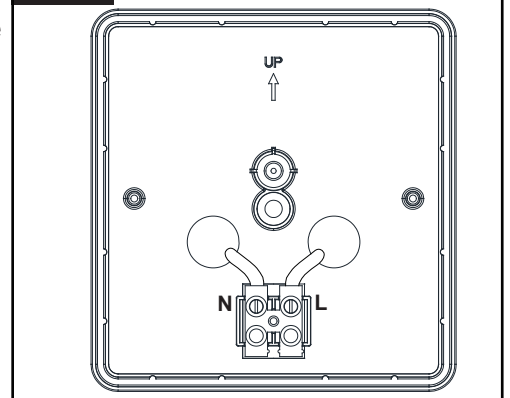

Turn on the power at fuse or circuit box.

## Adjusting the Sensor Head:

1. Aim sensor head toward desired detection area, maintaining a 5° - 40° downward angle to allow moisture to drain.
 

Note: Make sure sensor head is positioned with control knob facing towards the ground.

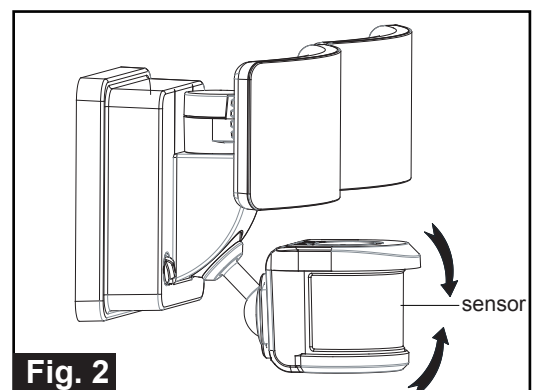

**Fig. 2**

2. You can rotate the sensor head up and down to change the coverage area (See Fig. 2). Walk through the detection zone at the farthest distance you wish to detect motion.

**Note: Range set too high may increase false triggering.** (See Fig. 3 and Fig. 4)

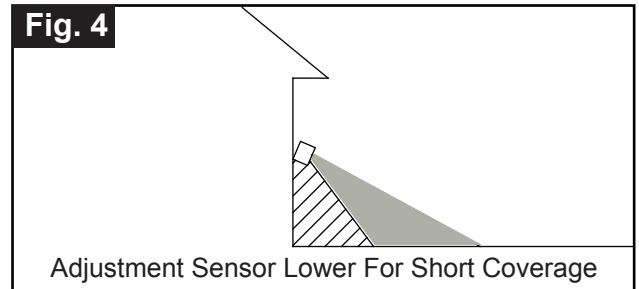
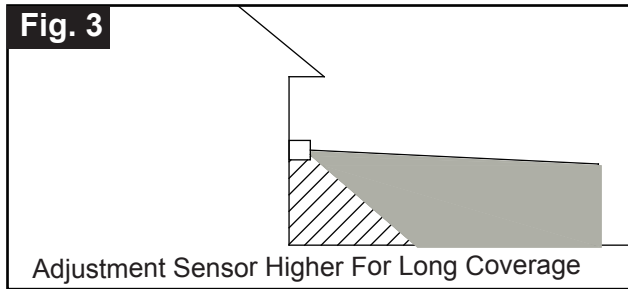

#### Sensitivity of Motion Sensor

- You can adjust the sensitivity of the motion sensor by using the “SENSITIVITY” selector located on the right side of the bottom surface of the sensor. (See Fig. 6)
- Adjust motion sensor sensitivity to HIGH (H), MEDIUM (M), or LOW (L) to achieve desired performance.
- Approximate range for each setting: 25 ft. (L), 45 ft. (M), 70 ft. (H).

#### **Adjusting the Light Head:**

1. Gently grasp the light heads and tilt them up or down, left or right to adjust the light coverage area. Keep the light heads at least 1" (25mm) away from the sensor. (See Fig. 5)
2. Keep the light heads 30° below horizontal to avoid water damage and electrical shock.

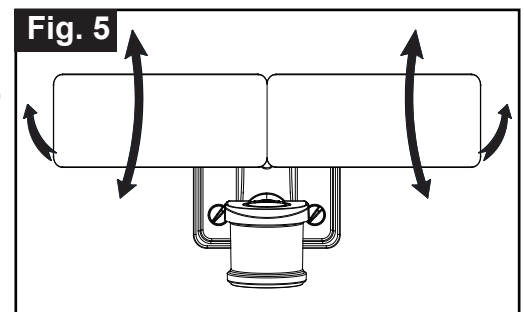

#### **Function and Operation**

Choose a mode by sliding the switch on the bottom of the sensor. (See Fig.6)

**Note: When power is first applied, the light will turn on to 100% brightness. The sensor will take 30 seconds to warm up.**

1. Test mode (daytime or nighttime operation )
  - Slide the switch on the left side of the sensor to the “TEST” position. (See Fig.6)
  - With the power on, the light turns to low-level brightness automatically.
  - The light turns to high-level brightness when motion is detected, and stays on as long as the motion continues. Then it reverts back to low-level brightness about 5 seconds after motion is no longer detected.

**Note: You can adjust the low-level (0~50%) and high-level (50~100%) brightness by using the brightness switch on the back plate. (See Fig. 7)**

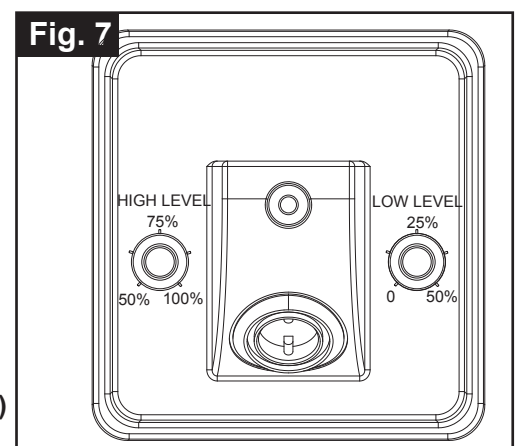
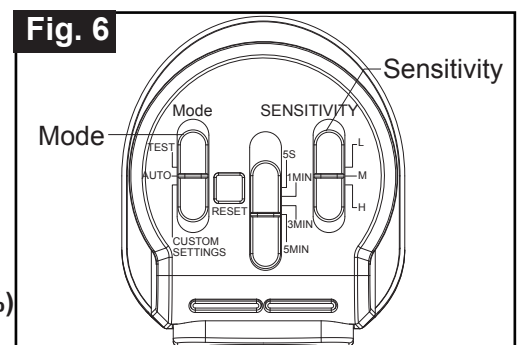

2. AUTO MODE (nighttime operation only)

- To shift to “AUTO” mode, slide Time Delay switch to the desired time setting (between 5 seconds and 5 minutes). At dusk, the light turns on to pre-selected low-level brightness. When motion is detected, the light turns to pre-selected high-level brightness and stays on as long as motion continues. When the motion is no longer detected, the light at high-level brightness remains on for the predetermined time you set (5s ~ 5min), and then switches back to low level automatically.
- The light turns off automatically at dawn.

**Note: You can adjust the low-level (0~50%) and high-level (50~100%) brightness by using the brightness switch on the back plate. (See Fig. 7)**

### 3. CUSTOM SETTINGS MODE (nighttime operation only)

- Set motion-sensor operation to go on at a specified time, turn the wall switch “OFF” and then turn it “ON” within 3 seconds at that time. The light will go into motion-sensor operation at the specified time every night. The light turns off automatically at dawn.
- For example, a homeowner wants to have the light stay on high-level brightness from dusk to 8pm. At 8pm, the homeowner would like the light to go into motion sensor mode. To achieve this, the homeowner will, at 8pm, turn wall switch on and off within 3 seconds. This sets the light such that every day, the light will behave the same way.
- To revert back to Default, turn the wall switch “OFF” and then turn it “ON” over 5 seconds again.

**Note:** You can adjust the low-level (0~50%) and high-level (50~100%) brightness by using the brightness switch on the back plate. (See Fig. 7)

#### **Notes:**

1. The sensitivity of the motion sensor will increase as the environmental temperature gets cooler. You may wish to make adjustments when the season changes. For best performance, gently clean the lens with a soft cloth every 1 or 2 months to assure maximum sensitivity.
2. For best performance, install fixture at least 8 feet above the ground. At such a height, the fixture will provide a detection distance of up to 70 feet at 77 degrees Fahrenheit. (See Fig.8)
3. The sensor detects movement across a detection range of 240 degrees. (See Fig.9)
4. The sensor will be more sensitive to motion across its detection path than motion directly towards it. (See Fig.10)
5. To reduce possible nuisances, do not mount the fixture near a heat source like an air conditioner, vent or furnace exhaust, or in a direction facing any reflecting object or other light source.

#### **Where you install your fixture is important:**

Be sure the light is mounted straight on the wall or eave; otherwise, the detection distance may be limited.

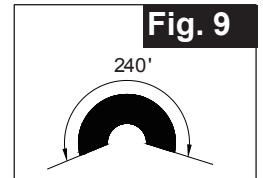
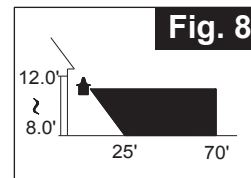

**Fig. 10**

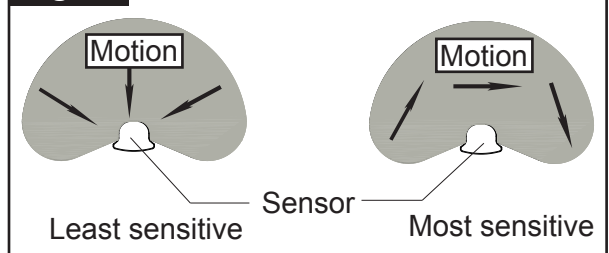



# User Guide

## Setting for single light through mobile device (Take iOS for example as below. Android will be slightly different).

### Before you start

- Turn on bluetooth on mobile device.
- Turn light switch controlling the light to "ON".

1. Search "Dualux BT" at Apple store or Android Google Play. Download the "Dualux BT" APP onto the device.



Fig.1

4. If there is a light in the bluetooth cover range, the new light will be shown in light list. Click the "Light 1", it will go to the step 5 for choosing mode. And click "✕" icon, it will go to the step 8.

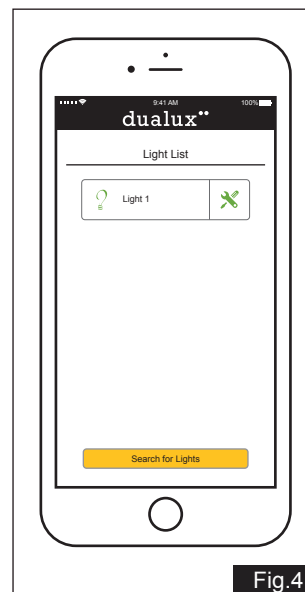

Fig.4

### Add a light

2. Start the APP.

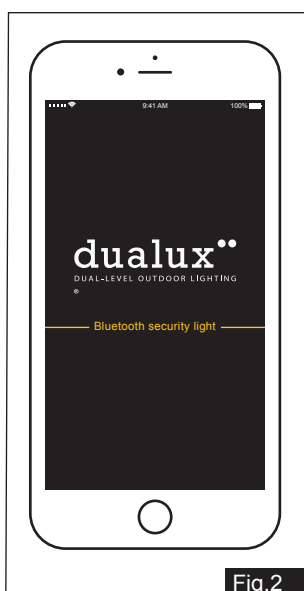

Fig.2

### Use light in "Test" mode

5. Select "Test" in Manual override and adjust "Detection Distance" and "Brightness" as desired. Then click "Save".

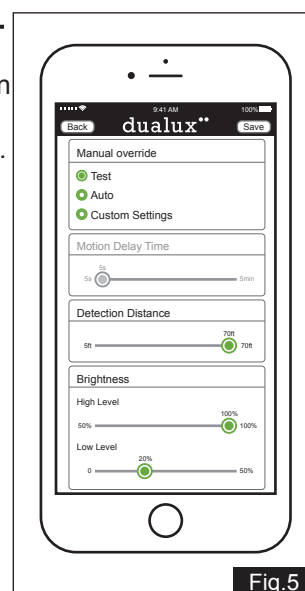

Fig.5

### Use light in "Auto" mode

6. Select "Auto" in Manual override and adjust "Motion Delay Time", "Detection Distance" and "Brightness" as desired. Then click "Save".

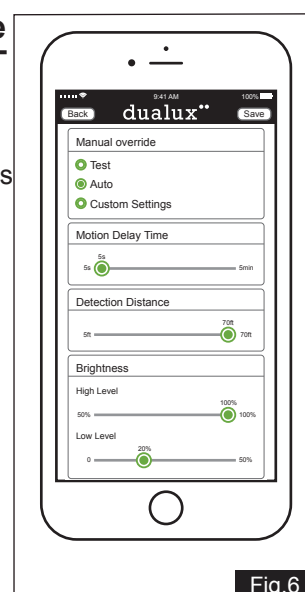

Fig.6

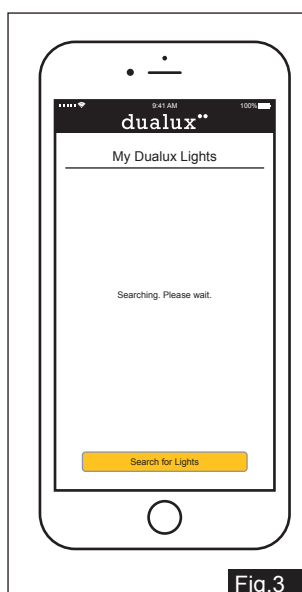

Fig.3

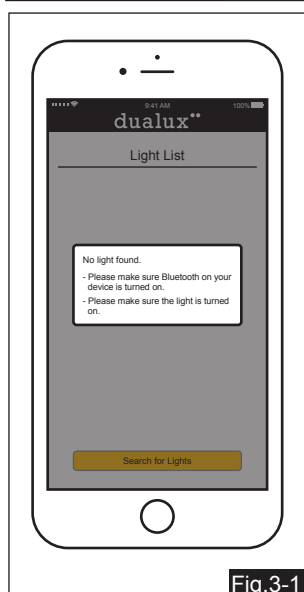

Fig.3-1

3. Click "Search for Lights" to search for existing lights.

## Use light in “Custom settings” mode

7. Select “Custom Settings” in Manual Override for Customize Early Evening Mode setting, and choose option between “Duration” or “Clock Time (End Time)” to set the continuous bright light illumination duration. Within “Duration”, you may set from 0 to 12 hours for continuous bright light once lamp is activated at night. In “Clock Time (End Time)”, is the time you set to deactivate the continuous bright light according to the actual hour in the mobile device after the lamp is activated. Both option settings will return to motion-sensor operation after the continuous bright light is deactivate. 9:00 P.M. is the default in “Clock Time(End Time)”.
- Note: "Duration" setting will only work once per setting, it automatically go into “Clock Time (End Time)” on the next day. Also if you do not click save for either option, then the settings will follow according to the switch control on the actual lamp.

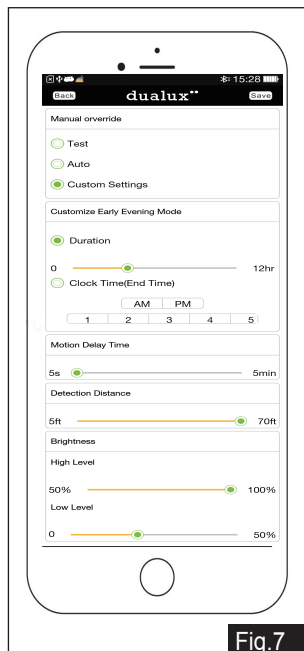

Fig.7

## Choose mode

8. Click Fig.4 “ ” icon, select “Functions”, you can choose “Test”, “Auto”, or “Custom Setting”, which are the same as the step 5,6,7.

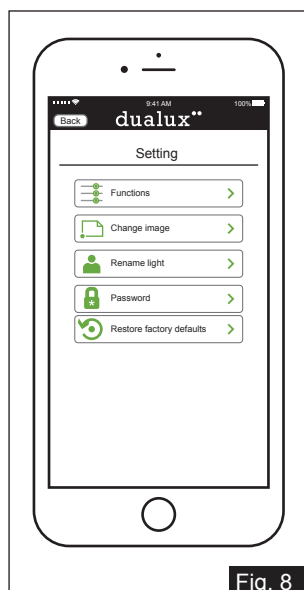

Fig. 8

## Set picture for light

9. Click Fig.8 “Change image”. And click “take photo” to take a photo.

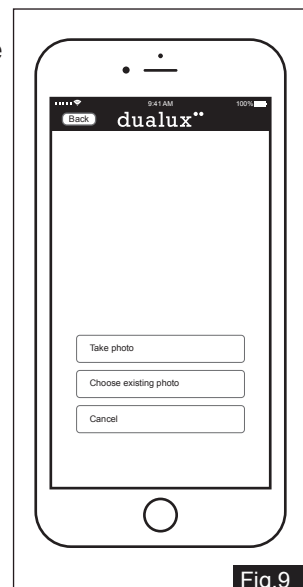

Fig.9

- 9.1 Android: Click “ ” to grasp a your desired view.  
iOS: Click “ ” to grasp a your desired view.



Fig.9-1

iOS

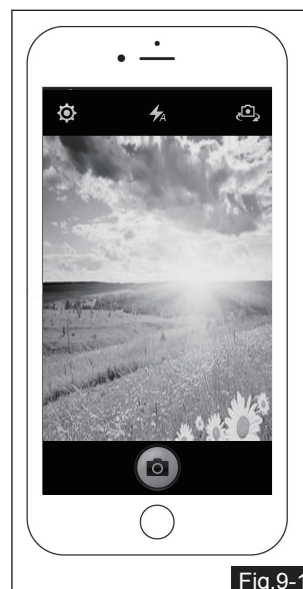

Fig.9-1

Android

- 9.2 Android: Click “ ” to take a photo. The iOS system does not have this step.

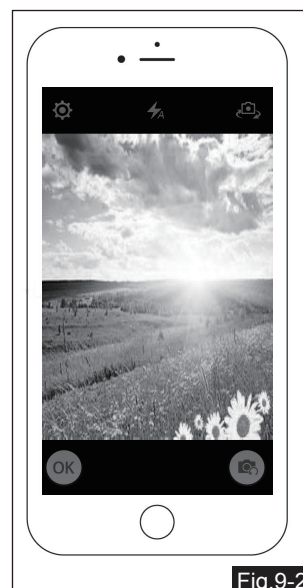

Fig.9-2

- 9.3. Android: Adjust the photo to trim the photo's desired size. Then click "✓".  
 iOS: Click "Done" to take a photo.



Fig.9-3

iOS



Fig.9-3

Android

- 9.4. It will turn to "change image"  
 The photo will show on it.  
 (Android will be slightly different from the iOS system)

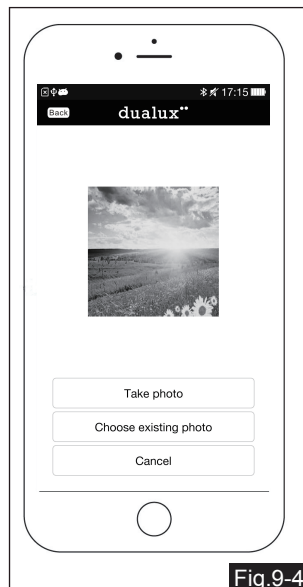

Fig.9-4

- 9.5. Go back to "Light list", the photo will show on the left of "Light 1".

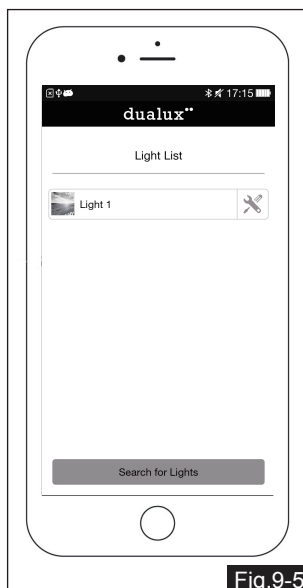

Fig.9-5

10. Click fig.9 "Change existing photo" to choose a desired image on your device. Then click "Cancel" back to "Setting" menu list.

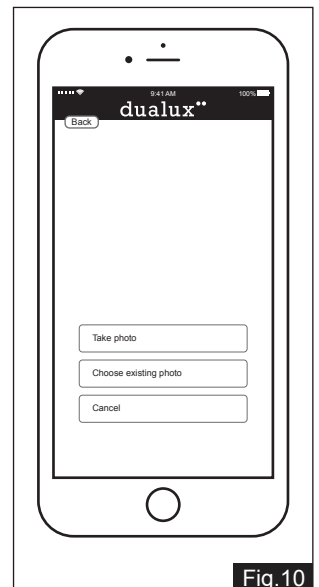

Fig.10

### Set name for light

11. Click fig.8 "Rename light" to enter a name for the light, then click "Save".

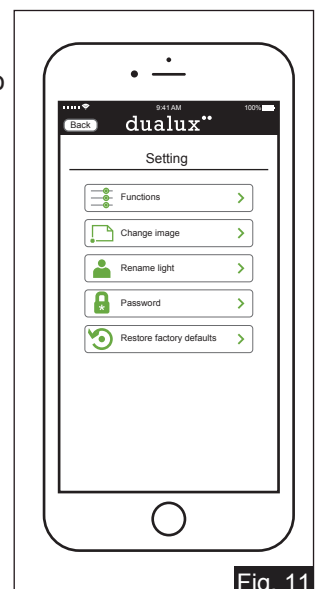

Fig.11

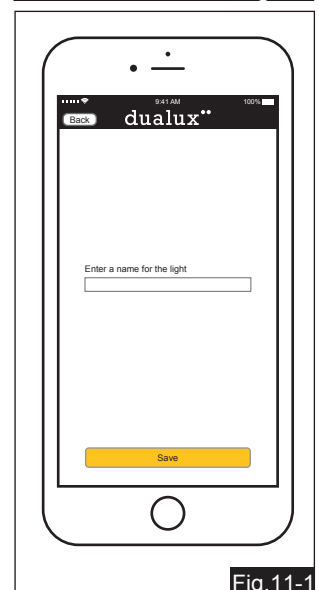

Fig.11-1

## Set password for light

12. Click fig.8 “Password” to set a password for bluetooth device so that others need password to connect this lamp.

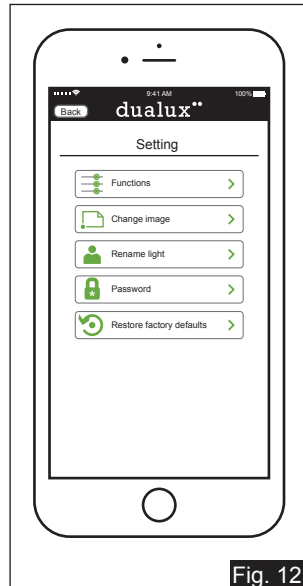

Fig. 12

12. 1 The password must be 4 to 6 alpha-numeric characters. Enter new password and verify it then press “Save”.

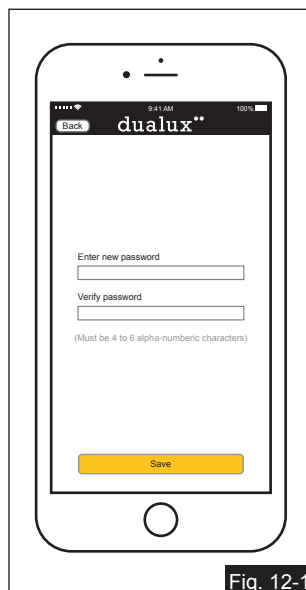

Fig. 12-1

## Restore factory defaults

13. Click fig.8 “Restore factory defaults” to restore your settings (only the light name and password) to the original conditions.

**Note: The photo's settings can't be restored by using this function.**

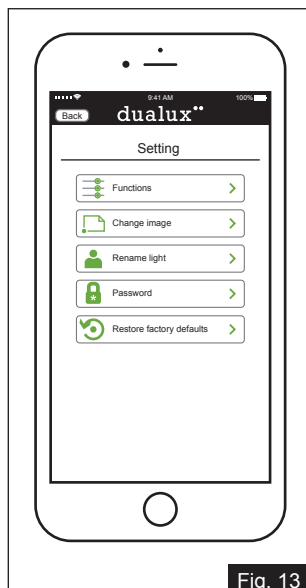

Fig. 13

13.1 Keep pressing the “reset” button on the light for 5 seconds, the light will flash three times. Then press “Back” button.

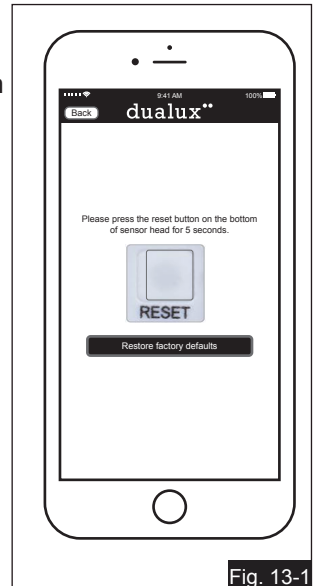

Fig. 13-1

**Note: 1. Manual control and App control independently.**

**2. The function which is executed is the latest settings.**

**3. After a power cut or power outage, the function of the light will revert back to the actual settings of the switches on the fixture. App settings will also revert back to the factory default.**

**4. For achieving the best performance, make sure the wall switch is in “ON” state (daytime and nighttime).**





Range	Up to 70ft. (Varies with surrounding temperature)
Sensing angle	Up to 240°
Electrical load - LED	29W
Lumens	2600lm
Power requirements	120 VAC, 60Hz
Operating modes	Test, Auto, Custom setting
Time delay	5s, 1min, 3min, 5min
Mobile device requirements	Iphone 4S or newer running IOS 8.0 x or later. Android v4.4 or later Phone must also have Bluetooth version 4.0 or later

## Troubleshooting

Problem	Possible Cause	Solution
The light will not come on.	The light switch is turned off.	Turn the light switch on.
	The fuse is blown or the circuit breaker is turned off.	Replace the fuse or turn the circuit breaker on.
	Daylight turn-off (photocell) is in effect.	Recheck after dark.
	The circuit wiring is incorrect (if this is a new installation).	Verify the wiring is correct.
	The motion sensor is aimed in the wrong direction.	Re-aim the motion sensor to cover the desired area.
	The outside air temperature is close to the same as a person's body heat.	Increase the "Sensitivity" setting.
The light comes on during the day.	The motion sensor may be installed in a relatively dark location.	The light fixture is operating normally under these circumstances.

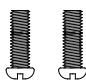
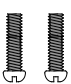
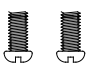
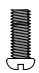
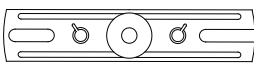
The following parts are available for re-order if damaged or missing.

### Spare Parts List:

						
Mounting Screw X2 #8/32X1/2 in	Mounting Screw X2 #6/32 X1/2 in	Mounting Screw X2 #10/24 X1/4 in	Mounting Bracket Screw	Mounting Strap	Decorative cover	Fixture Mounting Screw
 <p>Assembly Kit 5569MM (1 SET) for T0274 5570MM (1 SET) for T0275</p>						

## 5-YEAR LIMITED WARRANTY:

All products are warranted to be free of defects in material and workmanship for five (5) years from date of purchase. This warranty is limited to the correction of any such defect, or the replacement of any such defective item(s), provided that: (a) we are properly notified and consent to return of the item(s) in question; (b) the item(s) is / are returned with proof of purchase date; and (c) it is found upon inspection by us that the item(s) is / are defective as noted above. This warranty does not cover labor costs, consequential damages, nor does it apply to any item(s) that have been improperly installed, overloaded, altered, or otherwise abused by the customer, its agent(s) or employee(s). Finishes are specially excluded from the terms of this warranty since they are subject to environmental maintenance deemed beyond our control. Other than the described obligation, we assume no further liability with respect to the sale or use of our products. We make no warranty, express or implied, and disclaim any warranty of merchantability or fitness for a particular purpose.

## FCC Statement

Any Changes or modifications not expressly approved by the party responsible for compliance could void the user's authority to operate the equipment.

This device complies with part 15 of the FCC Rules. Operation is subject to the following two conditions:

- (1) This device may not cause harmful interference, and
  - (2) this device must accept any interference received, including interference that may cause undesired operation.
- This equipment complies with FCC radiation exposure limits set forth for an uncontrolled environment .

This transmitter must not be co-located or operating in conjunction with any other antenna or transmitter.

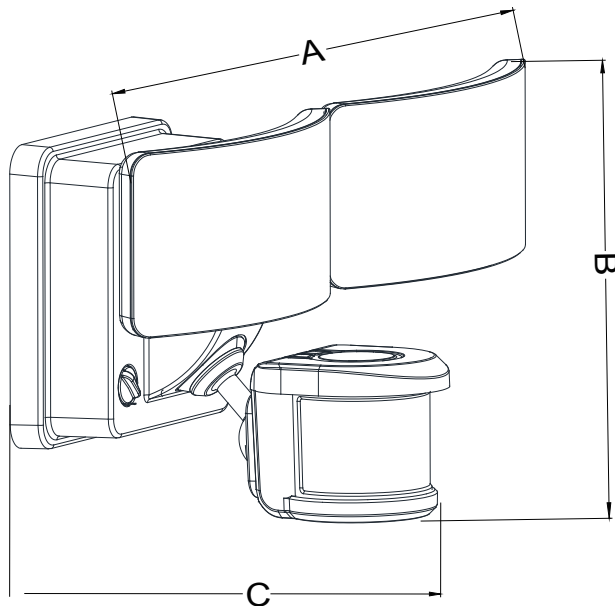

A: 13"  
B: 6-1/2"  
C: 5-3/4"