

## **BHI Indoor Ceiling Fan - Limited Warranty Statement**

**Best Houseware, Inc**  
**1269 W 9th Street, Upland, CA 91786 USA**  
**Phone : 1-626-427-3298 (Mon-Fri, 9am-5pm/PST)**  
**Email : support@bhiair.com**

1. **LIMITED FIVE (5) YEAR MOTOR WARRANTY-** If any part of your fan motor fails, due to defect in materials or workmanship during five (5) years from the original purchase date, BHI will provide the replacement part free of charge, when the defective fan is returned to BHI.
2. **LIMITED ONE (1) YEAR PARTS & ACCESSORY WARRANTY-** if any parts & accessory fails at any time within one (1) year from original purchase date, due to defects in materials or workmanship, parts & accessory will be provided free of charge. Purchaser will be responsible for labor charges for any repairs if need.
3. Because of varying climate conditions, this warranty does not cover any changes in the finish, including rusting, pitting, corroding, tarnishing or peeling.
4. This warranty is void due to improper installation, neglect, accident, misuse, exposure to extremes of heat or humidity, or as a result of any modification to the original product.
5. All costs of removal and reinstallation of the fan is the sole responsibility of the owner of the fan and not the retailers or BHI that sold the fan. Any attempt to service the fan by unauthorized persons or companies, this warranty will invalid & void.
6. BHI reserves the right to modify or discontinue any product at any time and may substitute any parts under this warranty coverage.
7. All return require to get "RA#, Return Authorization #" from BHI before returning. Authorized returns must be accompanied by the receipt of purchase and must be sent freight prepaid to BHI with all original parts & materials, packages. Any returning without RA#, all returning will be unacceptable.
8. It is understood that any repair or replacement is the exclusive remedy from BHI. There is no other expressed or implied warranty. BHI hereby disclaims any and all implied warranties, including, but not limited to those of merchantability and fitness for a particular purpose to the extent permitted by law. Some States do not allow limitations on implied warranties. BHI will not be liable for incidental, consequential or special damages arising out of or in conjunction with product use or performance, except as may otherwise be accorded by Law. This warranty gives you special legal rights and you may also have other rights which vary from State to State.
9. A certain amount of wobble is normal and should not be considered a problem or defect.

Purchase Date : \_\_\_\_\_ Model Name : \_\_\_\_\_

Purchased Retailer : \_\_\_\_\_

# **BHI**

## **Instruction Manual**

---

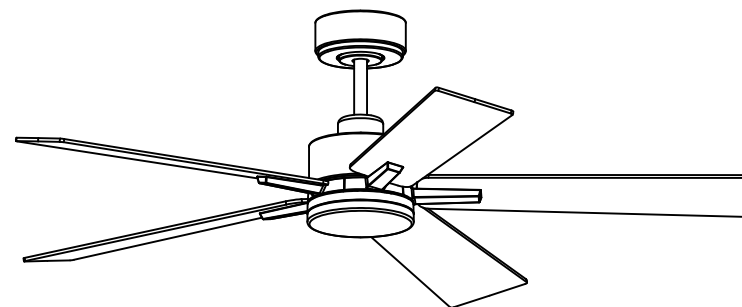

### **BHI – 52 Inch Indoor Ceiling Fan**

**MODEL # : BHI-52-YJ617**

**Best Houseware, Inc**  
**1269 W 9th Street, Upland, CA 91786 USA**  
**Phone : 1-626-427-3298 (Mon-Fri, 9am-5pm/PST)**  
**Email : support@bhiair.com**

## SAFETY INFORMATION



### WARNING

- Before connecting the power supply, make sure turn off the Electrical Main Switch at the circuit breaker fuse box.
- Using power supply 120V/60Hz.
- All wiring must comply with national and local electrical codes ANSI/NFPA70.
- MAKE SURE THE POWER IS SWITCH OFF AT THE ELECTRICAL PANEL BOX BEFORE YOU ATTEMPT TO ANY REPAIRS (REFER TO THIS SECTION), MAKING ELECTRICAL CONNECTIONS.
- ASSUREZ-VOUS QUE L'ALIMENTATION EST COUPÉE AU NIVEAU DU BOÎTIER ÉLECTRIQUE AVANT DE TENTER DES RÉPARATIONS (VOIR CETTE SECTION), EN FAISANT DES CONNEXIONS ÉLECTRIQUES.
- To reduce the risk of fire or electric shock, turn off the power to the fuse box or circuit breaker before installing the fan. To reduce the risk of personal injury, attach the fan directly to the building's support structure. Make sure that the installation location allows the fan blades to rotate without obstacles.

## TOOLS THAT MAY BE USED DURING INSTALLATION

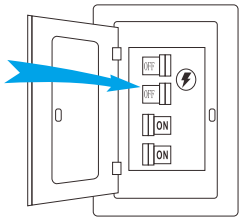

BEFORE YOU START  
SWITCH OFF

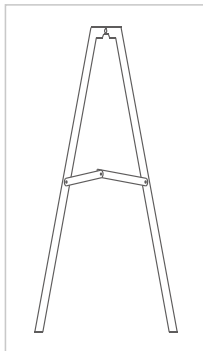

Ladder



17/14spanner

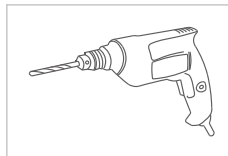

Drill

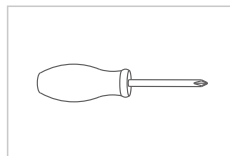

Screwdriver

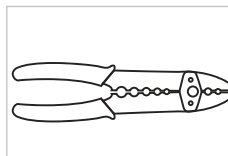

Wire Strippers

## TROUBLESHOOTING - 2

### Some function not works

- Light cannot adjust brightness
  - Try to press and hold the dimming button
- Fan cannot reverse
  - After press the reverse button, wait for about 20 seconds to reverse.
- If other function is normal and the operation is correct, it needs to change a new remote and receiver.

### Fan noisy

- Tighten all screws.
- Make sure no objects insert in the fan.
- Separate & store neatly all the wire nut connections.

### Fan shaking

- Check the screws on the hanger bracket are secure.
- Make sure the concave groove of the hanger ball is positioned on the hanger lug of the hanger bracket.
- Check the screws of hanger ball, downrod and connector are secure.

## MAINTENANCE TIPS



### WARNING

• **WARNING:** To Reduce The Risk Of Fire, Electric Shock, Or Personal Injury, Mount To Outlet Box Marked "Acceptable for Fan Support of 15.9 kg (35 lbs) or less" And Use Mounting Screws Provided With The Outlet Box. Most Outlet Boxes Commonly Used For The Support of Luminaires Are Not Acceptable For Fan Support And May Need To Be Replaced. Consult A Qualified Electrician If In Doubt.

- **CAUTION:** To Reduce The Risk Of Injury To Persons, Install Fan So That The Blade Is At Least 3.05 Meters (10 Feet) Above The Floor.
- Do not install the fan with wet hands.
- Do not insert foreign objects between the rotating fan blade.
- Do not bend the fan blades when installing or cleaning the fan.
- Do not disassemble or modify this product or use non-original parts without permission.
- Keep children away from your working area.
- **ATTENTION:** pour réduire le risque de blessures corporelles, installez le ventilateur de manière à ce que la lame se trouve à au moins 3,05 mètres (10 pieds) au-dessus du sol.
- **AVERTISSEMENT:** pour réduire le risque d'incendie, de choc électrique ou de blessure, montez sur la boîte de sortie marquée « Acceptable pour un support de ventilateur de 15,9 kg (35 lb) ou moins » et utilisez les vis de montage fournies avec la boîte de sortie. La plupart des boîtiers de sortie couramment utilisés pour le support des luminaires ne sont pas acceptables pour le support des ventilateurs et peuvent devoir être remplacés. Consultez un électricien qualifié en cas de doute.

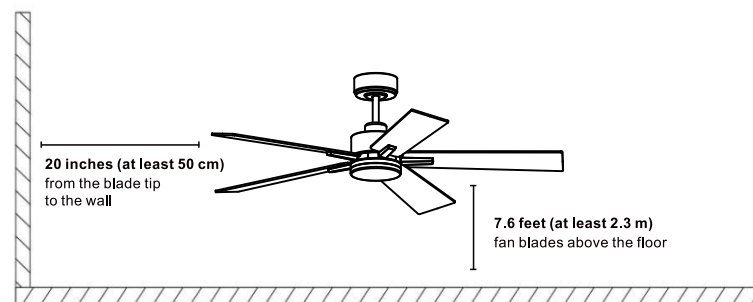

## FAN STRUCTURE DRAWING

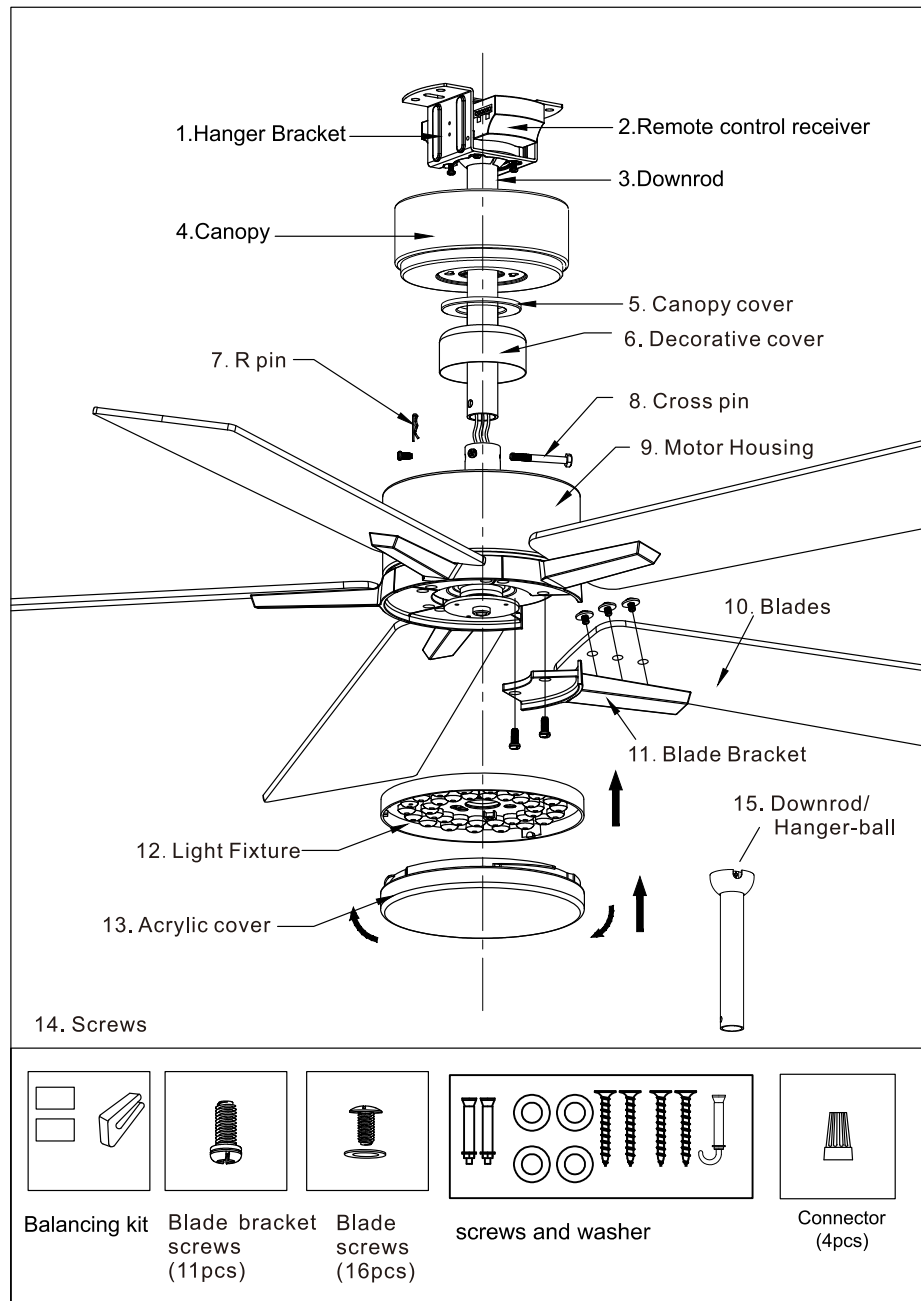

## TROUBLESHOOTING - 1

### Fan does not work, but light works

- Check all the connections are correct and secure, reconnect the motor wires.
  - Turn off the power at least 10 seconds, then turn on the power and repair the remote and receiver.
  - Turn off the power and turn on the power again
    - If you cannot hear a 'beep' sound, it means there is a problem with receiver and need to change a new one.
    - If you hear a continuous 'beep' sound, it means there is a problem with fan motor.
- Check the motor wires are secure and intact.  
Check the motor for resistance.

### Fan works, but light does not work

- Check the light wire connections are correct and secure, reconnect the light wires.
- Turn off the power at least 10 seconds, then turn on the power and repair the remote and receiver.
- Connect the light directly without receiver
  - If the light works, it means there is a problem with receiver and need to change a new one.
  - If the light not works, it means there is a problem with light and need to change a new one.

### Fan and light do not work

- Check all the connections are correct and secure, reconnect all the wires.
- Turn off the power at least 10 seconds, then turn on the power and repair the remote and receiver.
- Check the battery of remote control. Change a new battery.
- Turn off the power and turn on the power again
  - If you cannot hear a 'beep' sound, it means there is a problem with receiver and need to change a new one.



## Alexa/Google assistant Connection Instruction & Voice Command

### Connection Instruction

1. Make sure you have connected the device to the app and working normally.
2. Open "Tuya" app, click "Me", and choose "Alexa" or "Google Assistant" on "Third-Party Services".
3. Click "Link to Amazon Alexa" / "Link to Google Assistant".

### Note:

- (1) Connect the device to the App recommend to turn on WIFI and Bluetooth on your phone.
- (2) This ceiling fan needs to use 2.4Ghz WIFI to work when you connecting the device.

### Common Voice Command:

**Tips:** 1. Please use in English

2. Please name the lamp and the fan differently.

3. Please say the voice command clearly and slowly.

### Alexa Command:

Light Switch	"Alexa, turn on <Device Name-1> light" "Alexa, turn off <Device Name-1> light"
Color Temperature Setting	"Alexa, set/make/change the < Device Name-1 > light warmer/softer/whiter" "Alexa, set/make/change the < Device Name-1 > light to warm white / soft white /white / daylight white / cool white."
Brightness Setting	"Alexa, set/make/change the < Device Name-1 > light to 50%."(1-100%) "Alexa, brighten < Device Name-1 > light." "Alexa, dim < Device Name-1 > light."
Fan Power	"Alexa, turn on <DeviceName-2> fan" "Alexa, turn off <DeviceName-2> fan"
Wind Speed Level Setting	"Alexa, set/tum/change the < Device Name-2 > fan speed to (1-6)." "Alexa, set/tum/change the fan speed on the < Device Name-2 > fan to (1-6)." "Alexa, set/tum/change the fan speed on the < Device Name-2 > fan to maximum / minimum. "Alexa, what's the < Device Name-2> fan speed?"
Forward/ Reverse	"Alexa, set/change/turn the < Device Name-2 > fan direction to Forward / Reverse"

### Google Command:

Light Switch	"Hey Google/Ok Google, turn on <Device Name-1> light" "Hey Google/Ok Google, turn off <Device Name-1> light"
Color Temperature Setting	"Hey Google / Ok Google, set the <Device Name-1> light to ultrawarm white (CCT 0 ) /warm white (CCT 8) / cool white (CCT 34) / cool daylight (CCT 47) / daylight (CCT 61) /antique white (CCT 74) / coldsky (CCT 87) / bright daylight (CCT 100)"
Brightness Setting	"Hey Google / Ok Google, set the < Device Name-1> light to 50% brightness.(1-100%) "Hey Google / Ok Google, brighten < Device Name-1> light." "Hey Google / Ok Google, dim < Device Name-1>light." "Hey Google / Ok Google, what is the brightness of < Device Name-1> light"
Fan Power	"Hey Google / Ok Google, turn on <Device Name-2> fan" "Hey Google / Ok Google, turn off <Device Name-2> fan"
Wind Speed Level Setting	"Hey Google / Ok Google, set the < Device Name-2> fan speed to 5 (1-6)." "Hey Google / Ok Google, increase / decrease the < Device Name-2> fan." "Hey Google / Ok Google, set the < Device Name-2> fan speed to maximum / minimum / medium." "Hey Google / Ok Google, what's the < Device Name-2> fan speed?"
Forward/ Reverse	"Hey Google, set the < Device Name-2 > fan to Forward / Reverse" "Hey Google, set the wind direction to Forward / Reverse"

## 1. INSTALLATION OF HANGER BRACKET

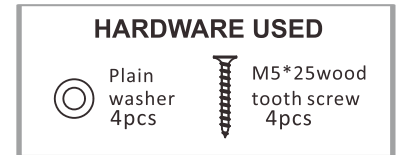
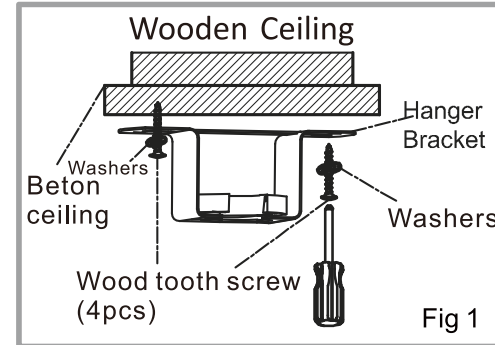

### 1) Wooden Ceiling:

Fasten the hanger bracket to the ceiling with 4 wood tooth screws.

(fig 1)

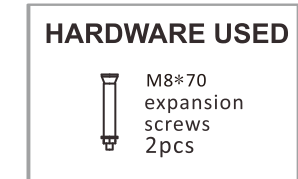
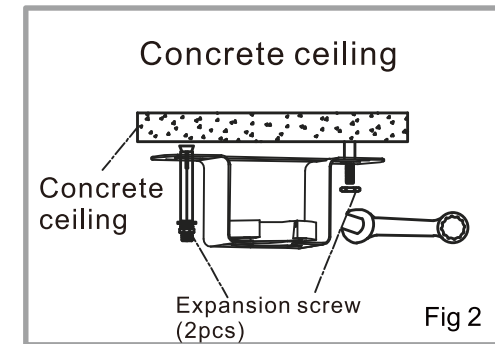

### 2) Concrete ceiling:

Use the expansion screw to fix the hanger bracket to the ceiling.

(fig 2)

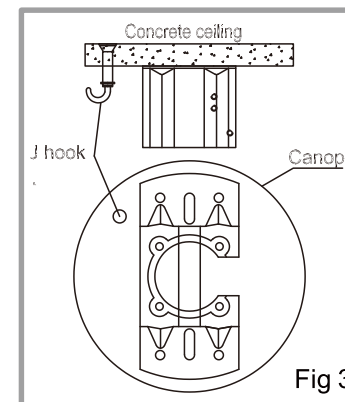

2) Install the 'J' hook onto the concrete ceiling and fasten firmly. Note the place of 'J' hook as (fig 3)

## 2. INSTALLATION OF FAN BLADES

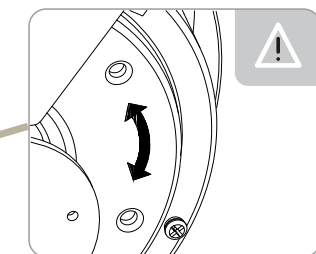
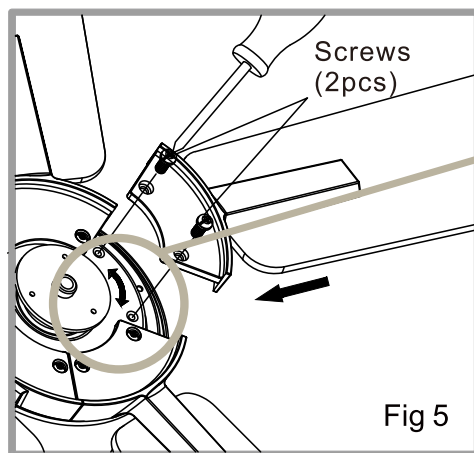
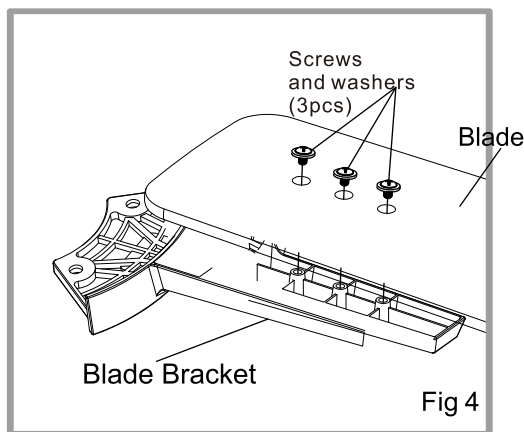

**NOTE:** Please install the blade bracket to two holes having mark first.

- 1) Install blade to blade bracket using the supplied screws and washers.  
Start a screw in to the bracket, repeat for the two remaining screws. (fig 4)
- 2) Tighten each screw securely.
- 3) Attach the blade bracket to the motor holes, then attach and tighten the screws. Repeat five times. (fig 5)

## APP CONTROL MANUAL

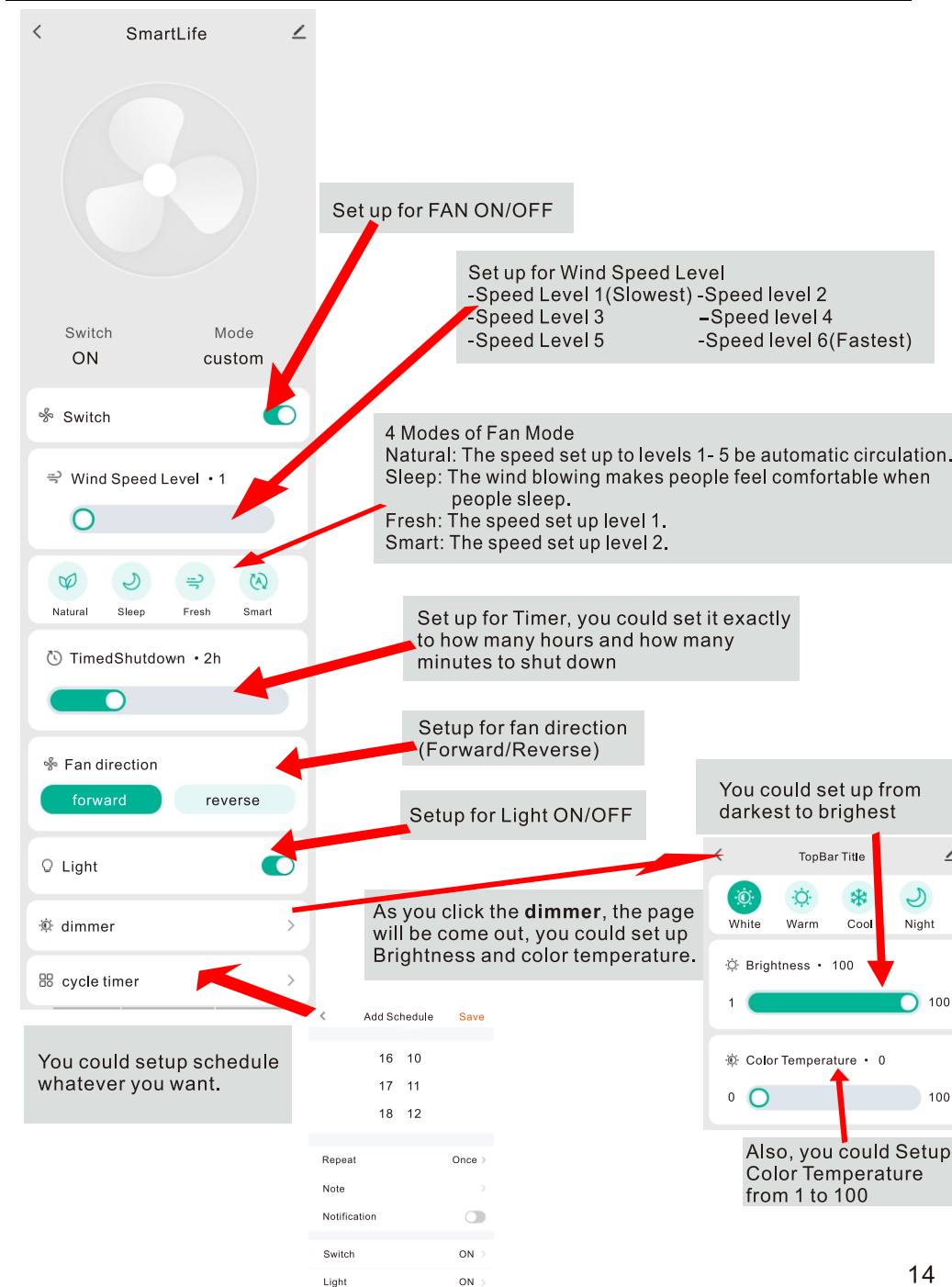

### 3. INSTALLATION OF LIGHTKIT

#### ADD MANUALLY (WIFI ON & BLUETOOTH OFF)

1. Open "TUYA" smart APP and then Click "Add device" on the APP Page
2. Then Under "Add Manually" SELECT "Small Home Appliances"
3. Then Select "Fan(WI-FI)" (Fig 4) and Type in your WIFI code & password (Fig 5)
4. Turn on the Fan power within 30 seconds, Press the "1H" key on the remote for at least 5 seconds.
5. Then Click "Confirm the indicator is blinking" on the APP page and then Select "Blink Quickly".
6. Waiting for connection and Clicking "Done" on the APP page.  
(Note: if the ceiling fan is not searched, please make sure the 2.4 Ghz WIFI & Bluetooth are on and the network is stable; if the ceiling fan is disconnected within 3 mins please retry to pair the fan by repeating step 1.
7. Then the following page shown (Fig 6) you could operate normally with the page.

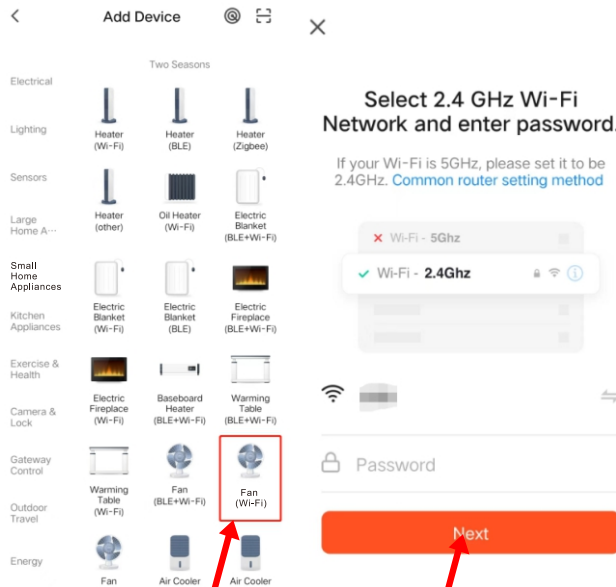

( Fig 4)

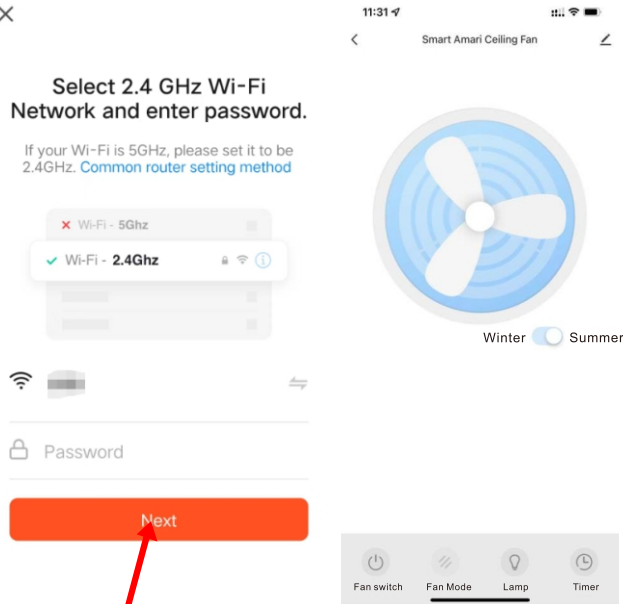

( Fig 5)

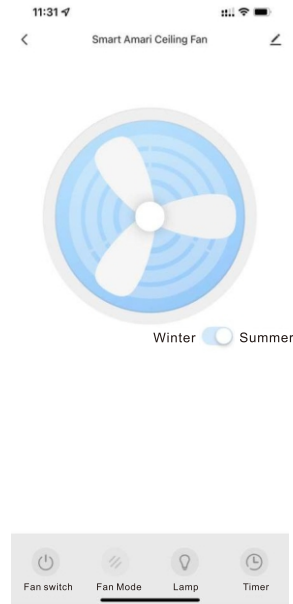

( Fig 6)

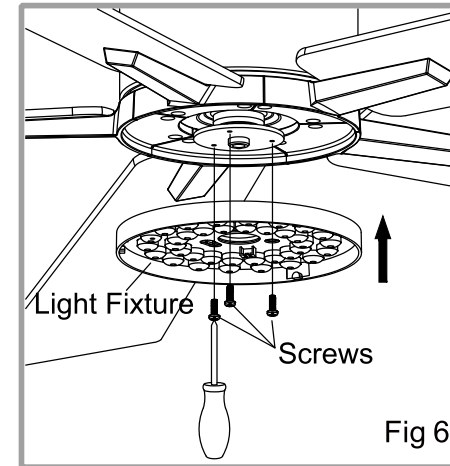

- 1) Remove three screw from the motor round piece. (fig 6)
- 2) Attach the lightkit to the fan, and tighten all the three screws firmly. (fig 6)

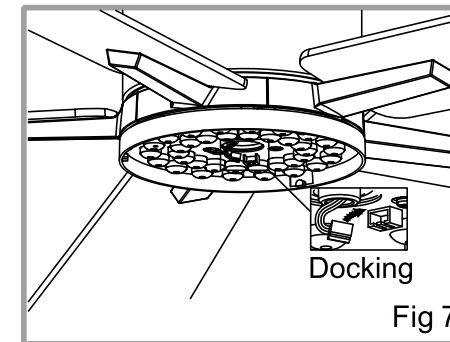

- 3) Direct plug in the wire to the lightkit docking(connector). (fig 7)

## 4. INSTALLATION OF DOWNROD/HANGER BALL

1. Remove the screw and pin from the hanger ball; Remove the "R" pin and cross pin from the downrod. (fig 8)

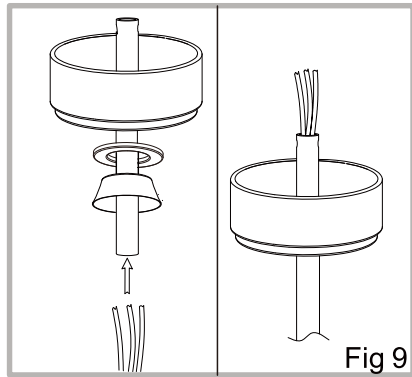
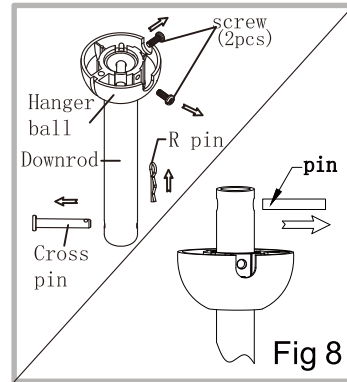

2. Choose a suitable downrod. Put the canopy, canopy cover and decorative cover into the downrod, then put the wire through the downrod. (fig 9)

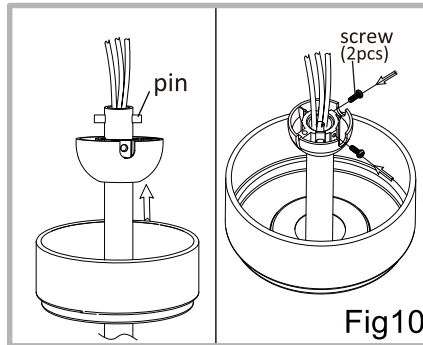

3. Install back the screws and pin to the hanger ball, ensure to fasten the screws. (fig 10)

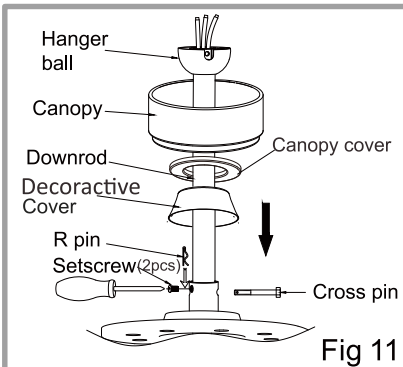

4. Loosen the two setscrews in the downrod support (NOTE: The two setscrews above are used to secure the downrod. The two screws below are used to secure the central spindle, please do not loosen), Insert the downrod into the connector. Install back the cross pin and secured with the "R" pin. (Note: The wire will block the cross pin slightly) Fasten back the two setscrews. (fig 11)

\*The "R" pin must be properly installed to prevent the cross pin from working loose.\*

## SMART APP CONNECTION INSTRUCTION



Scan the QR code and download "TUYA" smart APP.  
(The ceiling fan needs work at 2.4 GHz WIFI to connect the device)

[If you have any question, please refer to more detail about our APP & CEILING FAN CONNECTION INSTRUCTION]

### ADD automatically (WIFI & BLUETOOTH both on) --RECOMMENDED

1. Open TUYA smart APP & Turn on the Fan power supply within 30 seconds, Press the button of "1H" on the remote for at least 5 seconds until hearing 2 or more beep sounds.
2. Then Click "Add device"(Fig 1) on the APP Page.
3. Then click "Add" (Fig 2) and wait for the connection(Fig 2) (Note: if the ceiling fan is not searched, please make sure the 2.4 Ghz WIFI & Bluetooth are on and the network is stable; if the ceiling fan is disconnected within 3 mins please retry to pair the fan by repeating step 1.)
4. After connecting successfully, then click "next".
5. After that, then click "Finish" to enter the interface.
6. Then the following page is shown (Fig 3) you could operate normally with the page.

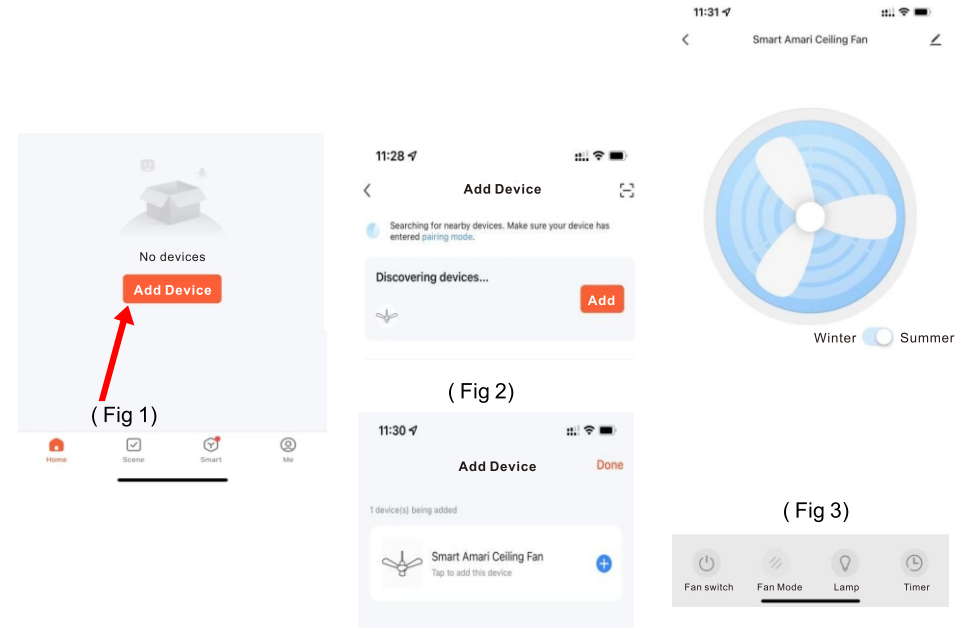

# REMOTE CONTROL MANUAL

- ① Led Indicator
- ② Speed Control
- ③ Natural wind
- ④ Fan Reverse/Forward  
Press and hold the button for seconds
- ⑤ Silent mode switch  
Press and hold the button for 2 seconds to cancel the Beep' sound
- ⑥ Fan Off  
(Long press to pair the emitter and receiver)
- ⑦ Light On/Off
- ⑧ Warm light (Yellow light)
- ⑨ Natural white light
- ⑩ Cool white light
- ⑪ 1/2/4/8H Timer  
WiFi connect (Long press 1H Timer button)
- ⑫ Brightness adjust

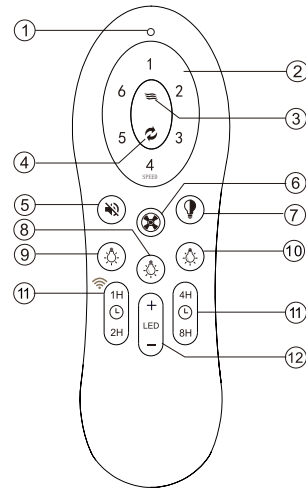

Use battery 2\* AAA

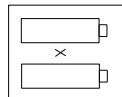

## IMPORTANT:

1. Insert two size AAA alkaline batteries by matching **+** and **-** on the batteries to the diagram inside the battery compartment of the remote control.
2. Steps to pair the Emitter and Receiver:
  - i. Turn 'ON' the supply power.
  - ii. Within 30 seconds, press and hold the Emitter button '  ' for 5 seconds until hearing a long 'beep' sound.
  - iii. Pairing successfully (learning mode is not acceptable after turn 'ON' the supply power for more than 30 seconds).
3. When the Emitter cannot control the Receiver, check surrounding for any existence of similar remote control products. Some interference might occur when similar radio waves being transmitted.
4. Replace the batteries when found low in voltage as it will affected the sensitivity of the Emitter.
5. Always remove the batteries from the Emitter when leaving unused for long period of time.

# 5. HANGING OF CEILING FAN

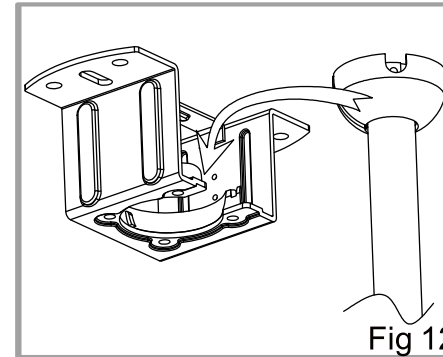

Fig 12

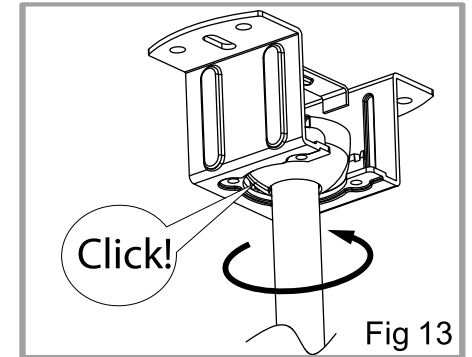

Fig 13

- 1) Lift the assembled fan onto the hanger bracket. (fig 12)
- 2) Ensure the concave groove of the hanger ball is positioned on the hanger lug of hanger bracket. (fig 13)

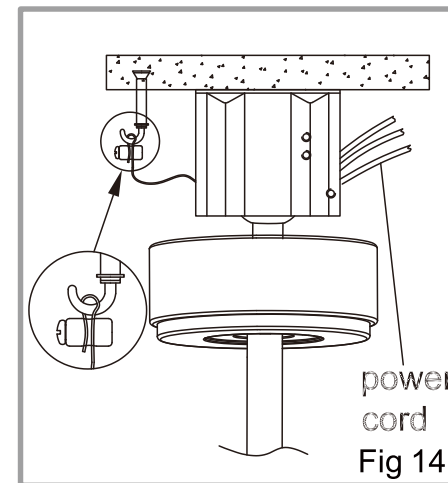

Fig 14

- 3) Attach the safety wire (cord) to the expansion 'J'hook for safety purposes.  
Tighten the nuts firmly. (fig 14)



## 6. WIRING OF CEILING FAN

Total six colors of wires connected from the top of the motor:

\* Black, White, Yellow wires - for light kit

\* Gray, Red, Yellow wires - live wire for fan  
Motor ground, downrod ground,  
receiver ground, hanger ground

\* Green/Yellow - ground wire

The installation is to be in accordance with the  
National Electrical Code ANSI/NFPA 70 and local codes.

### HARDWARE USED



wire  
connectors  
P2 3pcs  
P4H 1pcs

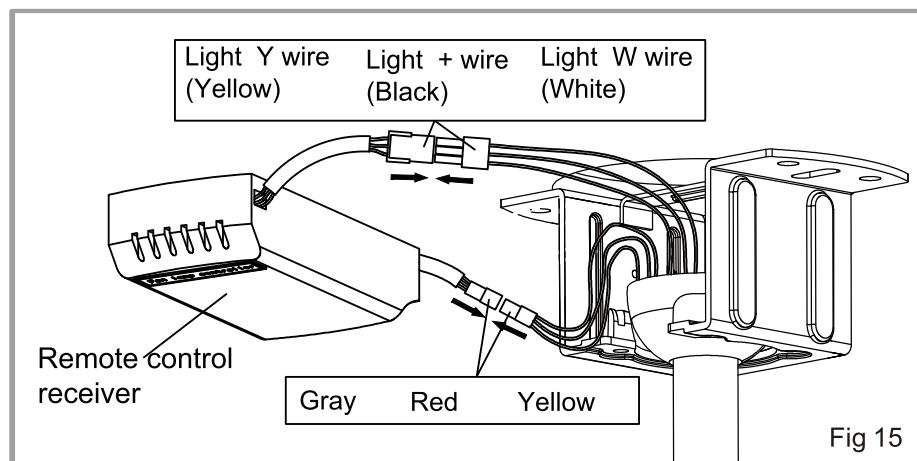
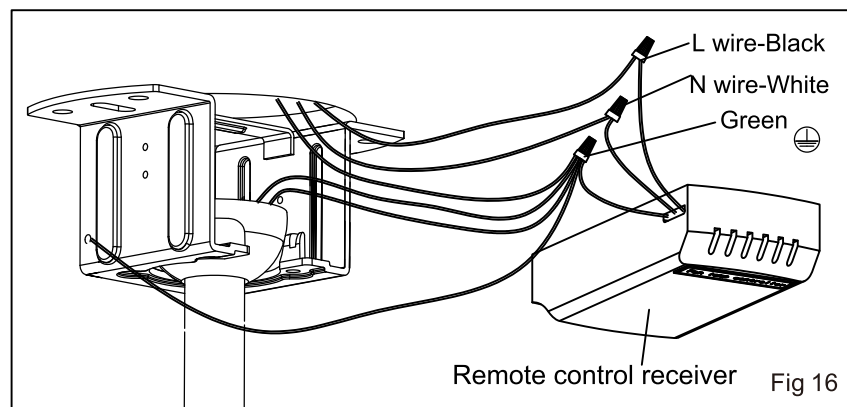

Fig 15

1) Connect the ceiling fan cord to the receiver.



2) Connect the wires of remote control receiver to AC wires  
(Household supply):

Green to Ground, White to Neutral, Black to Live.

## 7. INSTALLATION OF RECEIVER

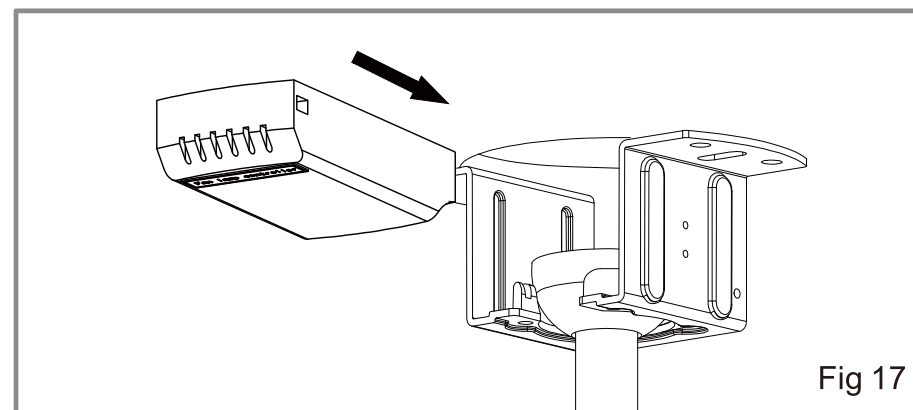

Fig 17

Tidy up the wire and put the receiver into the  
hanger bracket.

## 8. INSTALLATION OF CANOPY & LIGHTCOVER

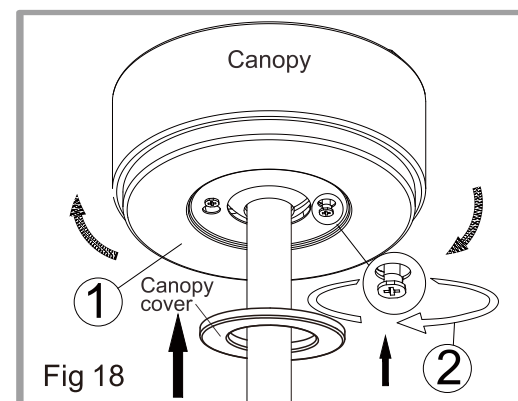

Fig 18

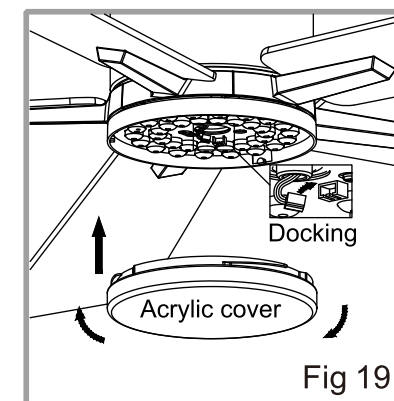

Fig 19

- 1) Please rotate all the wires around the hanger bracket in the same  
direction to tuck all wires into the canopy. Then, rotate the canopy  
and tighten the screws into two right holes. (Fig 18)
- 2) Attach the canopy cover with magnet to the canopy. (Fig 18)
- 3) Rotate the light cover until fixed. (Fig 19)