

**72 inch Painted Steel  
Professional Roller Cabinet  
with Professional Quick Release  
Drawer Pulls**

**Model:  
EX7217RCQ  
72" 17 Drawer Professional Triple Bank Roller Cabinet**

Extreme Tools, Inc.  
740 Frontenac Road  
Naperville, Illinois 60563  
630.369.9303  
[www.ExtremeTools.net](http://www.ExtremeTools.net)

# Professional Roller Cabinet with Pro Quick Release

## Parts List

### EX7217RCQ

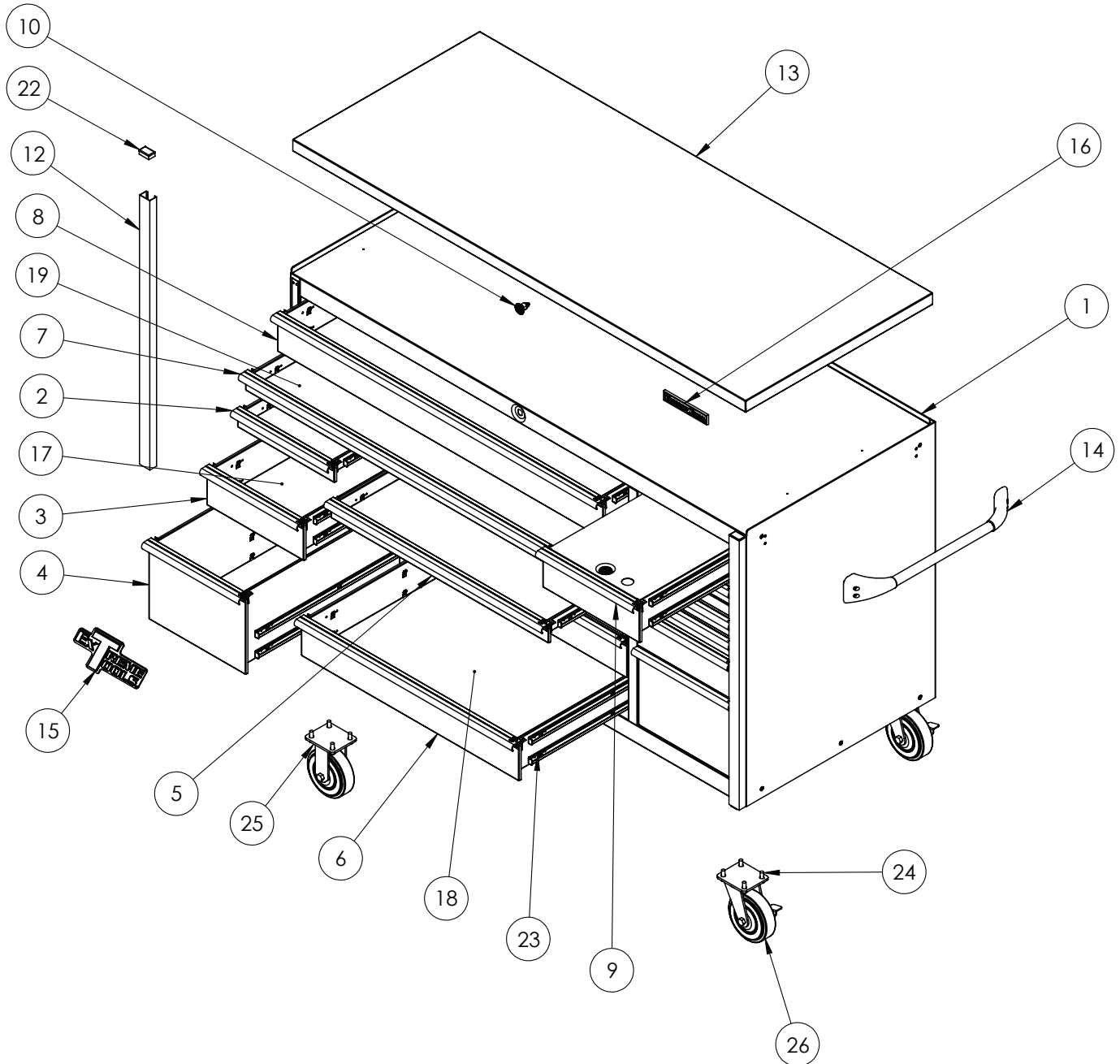

Replacement keys may be ordered using the code that appears on the face of the lock.

To order replacement parts, you will need the part number, tool box color and quantity.

If under warranty, the SERIAL NUMBER is REQUIRED to get replacement parts.

Not all parts are available under warranty and may be purchased separately.

**PARTS LIST - EX7217RCQ**  
**72" 17 DRAWER PROFESSIONAL ROLLER CABINET**  
**Pro Quick Release Drawer Pulls**

ITEM NO.	PART NUMBER	DESCRIPTION	QTY.
1	QR7217RC-01M	BODY WELDMENT	1
2	ZDRE389F1QY	QR DR 1 (MOD)	5
3	ZDRE389F2QY	QR DR 2 (MOD)	2
4	ZDRE389F4QY	QR DR 3 (MOD)	2
5	ZDRE873F1QY	QRDR 4 (MOD)	2
6	ZDRE873F2QY	QRDR 5 (MOD)	3
7	ZDRE1306F1QY	QRDR 6 (MOD)	1
8	ZDRE1306F2QY	QRDR 7 (MOD)	1
9	ZDRE389F2QYS	QRDR 8 (SECURITY)	1
10	Z-LK-000 SERIES	TUBULAR LOCK	1
11	QRCP-19A	KEYBAR ASSY.	1
12	Z-TR315020	AL VERT TRIM (V2)	2
13	ZSST723038MM	SS TOP	1
14	Z-HDGW7230	MOLDED CHROME ENDS	1
15	Z-LGL	EXTREMETOOLS LOGO	1
16	Z-LGS	EXTREME TOOLS NAMEPLATE	1
17	Z-DLEX72-S	DRAWER LINER-SMALL	10
18	Z-DLEX72-M	DRAWER LINER-MEDIUM	5
19	Z-DLEX72-L	DRAWER LINER-LARGE	2
20	Z-M3-0.5X22MS	M3-0.5 X 20mm MACHINE SCREW	24
22	Z-END CAP EX7217RCQ	PLASTIC END CAP (V2)	2
23	ZSLY701E695	250# BB SLIDE (SET)	26
24	Z-BTM10X25SHH	M10X25 SRRATED HEX BOLT	24
25	Z-CA6R	6x2 RIGID CASTER	2
26	Z-CA6SB	6 X 2 SWIVEL/BRAKE CASTER	4



Replacement keys may be ordered using the code that appears on the face of the lock.

To order replacement parts, you will need the part number, tool box color and quantity.

If under warranty, the SERIAL NUMBER is REQUIRED to get replacement parts.

Not all parts are available under warranty and may be purchased separately.

## ASSEMBLY

### Handle Installation

NOTE: Assemble the handle first to make it easier to move the tool cabinet.

Position the handle over the holes in the cabinet and attach with the provided (4) M6X35 socket head screws. Tighten securely.

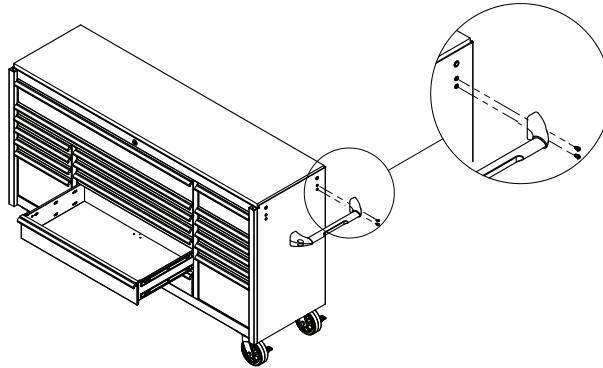

## OPERATING PROCEDURE

### Drawer Removal

Pull drawer out so that it is almost fully extended.

Push up on the black lever on one drawer slide and at the same time push down on the lever on the other side.

With the levers in these positions, pull the drawer out until it releases from the drawer slides.

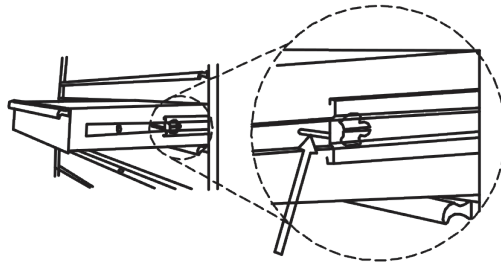

### Drawer Replacement

Extend the drawer slides.

Careful align the brackets on the sides of the drawers with the slots of the cabinet slides. Insert the brackets on the side of each drawer into the slots of the cabinet slides.

Once properly inserted, completely close the drawer to set the slides into their properly functioning positions.

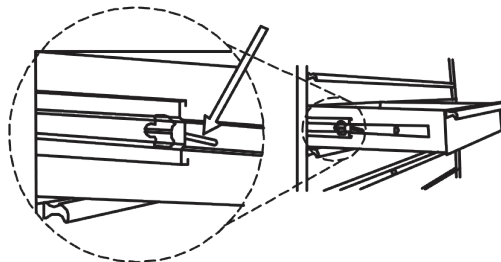

## **MAINTENANCE**

Lubricate the casters once a year with high quality ball bearing grease.

Lubricate the slides twice a year with high quality, petroleum-based lubricant. This may be required more often if operating the tool box in colder climates.

Use mild detergent/cleaner and water to clean drawer fronts, drawer trim and other surfaces.

Grease and oil can be removed with standard, non-abrasive, non-flammable cleaning products.

Auto wax will help preserve the unit's high gloss finish. Follow directions as provided with wax.

## SAFETY



### WARNING

Do not attempt to lift the cabinet by its side handle using chains, ropes or lifting device.

Side handle may fail resulting in personal injury or damage to the product!

Use a forklift or similar lifting device with forks placed under the bottom of the tool box to move if tool box cannot be moved by two people.

CLOSE THE DRAWERS AND LOCK THE TOOL BOX BEFORE MOVING THIS PRODUCT! If drawers are not locked they could open and make the product unstable and tip which may cause personal injury or damage to the product.

Do NOT stand on this product or lean on the drawer or work top.

Wear safety glasses when removing or repositioning the slides. The tool box could slip resulting in personal injury.

Do NOT mount this product on a truck bed or other moving object. This may cause personal injury or product damage. Mounting this product on any surface will void the warranty.

Do NOT tow with power equipment. The product could tip which may cause personal injury or product damage.

Do NOT alter this product in any manner or attach electrical equipment. This may cause personal injury or product damage and will void the warranty.

If using the combination top chest and roller cabinet, the top chest MUST be secured to the roller cabinet by following the directions provided. Not securing the top chest to the roller cabinet may cause the product to become unstable which may cause personal injury or damage to the product.



### CAUTION - IMPORTANT PRODUCT INFORMATION

#### **DRAWERS MUST BE CLOSED AND TOOL BOX LOCKED USING KEYS BEFORE MOVING!**

Do not exceed maximum load rating for drawer slides. Weight should be evenly distributed throughout the drawer.

Maximum overall weight should not exceed 4,050 lbs. (1,837 kg.)

Use caution when closing the chest lid. Remove hands from the area before closing to prevent personal injury.

Do NOT pull this product. Push the product to prevent personal injury.

ENGAGE THE BRAKES when not moving this product. Locked casters prevent the product from rolling which may result in personal injury or damage to the product.

This product may become unstable and tip if more than one drawer is open at a time. To prevent personal injury or damage to product, OPEN ONLY ONE DRAWER AT A TIME.

Lock product and properly secure before moving with a forklift or other device.

Keep the product on a level surface. The product could become unstable and tip if stored or moved on an uneven surface which may result in personal injury or product damage.

Remove the work surface from the roller cabinet before installing top chest.