

ABBINGDON CEILING FAN

Español p. 22

ATTACH YOUR RECEIPT HERE

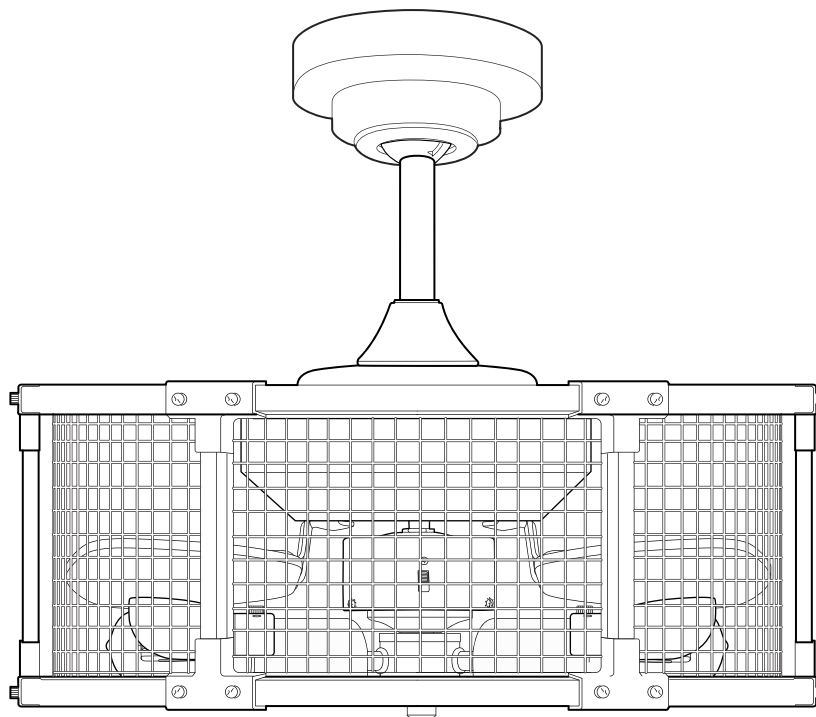

Purchase Date _____



Intertek
4007498

APPROVED FOR USE
IN DAMP LOCATIONS

Questions, problems, missing parts? Before returning, contact us on:
800-527-1292, 8:30 a.m. - 5 p.m., CST, Monday - Friday.

TABLE OF CONTENTS

Safety Information	2
Package Contents	5
Hardware Contents	6
Preparation	6
Initial Installation	6
Downrod-Style Fan Mounting	8
Closemount-Style Fan Mounting	10
Wiring	11
Final Installation	14
Installing Fan Without Light Kit.....	16
Operating Instructions	17
Care and Maintenance	19
Troubleshooting.....	20
Limited Lifetime Warranty	21
Replacement Parts List	21



SAFETY INFORMATION



CAUTION: Changes or modifications not approved by the party responsible for compliance could void the user's authority to operate the equipment.

***NOTE:** This equipment has been tested and found to comply with the limits for a Class B digital device, pursuant to Part 15 of the FCC Rules. These limits are designed to provide reasonable protection against harmful interference in a residential installation. This equipment generates, uses and can radiate radio frequency energy and, if not installed and used in accordance with the instructions, may cause harmful interference to radio communications. However, there is no guarantee that interference will not occur in a particular installation. If this equipment does cause harmful interference to radio or television reception, which can be determined by turning the equipment off and on, the user is encouraged to try to correct the interference by one or more of the following measures:

- * Reorient or relocate the receiving antenna.
- * Increase the separation between the equipment and receiver.
- * Connect the equipment into an outlet on a circuit different from that to which the receiver is connected.

Consult the dealer or an experienced radio/TV technician for help.

The device complies with Part 15 of the FCC Rules. Operation is subject to the following two conditions: (1) this device may not cause harmful interference, (2) this device must accept any interference received, including interference that may cause undesired operation.

Distributed by: Litex Industries Inc., P.O. Box 535639, Grand Prairie, TX, 75050; 800-527-1292

NOTE: Dimmable to 10%.



SAFETY INFORMATION

READ AND SAVE THESE INSTRUCTIONS

Please read and understand this entire manual before attempting to assemble, install or operate the product. Review the accompanying assembly diagrams.

- Do not discard fan carton or packing material. Should this fan need to be returned to the factory for repairs, it must be shipped in its original packaging to ensure proper protection against damage that might exceed the initial cause for return.
- Make sure all electrical connections comply with local codes, ordinances, the National Electrical Code and ANSI/NFPA 70-1999. Hire a qualified electrician or consult a do-it-yourself wiring handbook if you are unfamiliar with installing electrical wiring.
- Make sure the installation site you choose allows a minimum clearance of 7 ft. from the blades to the floor and at least 30 in. from the end of the blades to any obstruction.
- After you install the fan, make sure all connections are secure to prevent the fan from falling.
- The net weight of this fan including the light kit is: 16.98 lbs.

DANGER

When using an existing outlet box, make sure the outlet box is securely attached to the building structure and can support the full weight of the fan. Failure to do this can result in serious injury or death. The stability of the outlet box is essential in minimizing wobble and noise in the fan after installation is complete.

To reduce the risk of serious bodily injury, DO NOT use power tools to assemble any part of the fan, including the blades.

Before proceeding, be sure to shut off electricity at main switch or circuit breaker in order to avoid electrical shock.

WARNING



To reduce the risk of fire, electrical shock or personal injury, mount fan to outlet box marked "ACCEPTABLE FOR FAN SUPPORT OF 35 LBS. OR LESS" and use mounting screws provided with the outlet box. Most outlet boxes commonly used for the support of lighting fixtures are not acceptable for fan support and may need to be replaced. Consult a qualified electrician if in doubt.

When mounting fan to a ceiling outlet box, use a METAL octagonal outlet box; do NOT use a plastic outlet box. Secure the outlet box directly to the building structure. The outlet box and its support must be able to support the moving weight of the fan (at least 35 lbs.).

To reduce the risk of fire, electrical shock or personal injury, wire connectors provided with this fan are designed to accept only one 12-gauge house wire and two lead wires from the fan. If your house wire is larger than 12-gauge or there is more than one house wire to connect to the corresponding fan lead wires, consult an electrician for the proper size wire connectors to use.

WARNING

To reduce the risk of fire or electrical shock, do not use the fan with any solid state speed control device or control fan speed with a full range dimmer switch.

To avoid personal injury, the use of gloves may be necessary while handling fan parts with sharp edges.

To reduce the risk of fire, electrical shock or personal injury, do not bend the blades when installing them or when cleaning the fan. Do not insert objects between the rotating fan blades.

To reduce the risk of personal injury, use *ONLY* parts provided with this fan. The use of parts *OTHER* than those provided with this fan will void the warranty.

CAUTION

Be sure outlet box is properly grounded and that a ground wire (GREEN or BARE) is present.

Once installation is complete, carefully check all screws, bolts and nuts on fan motor assembly to ensure that they are secured.

PACKAGE CONTENTS

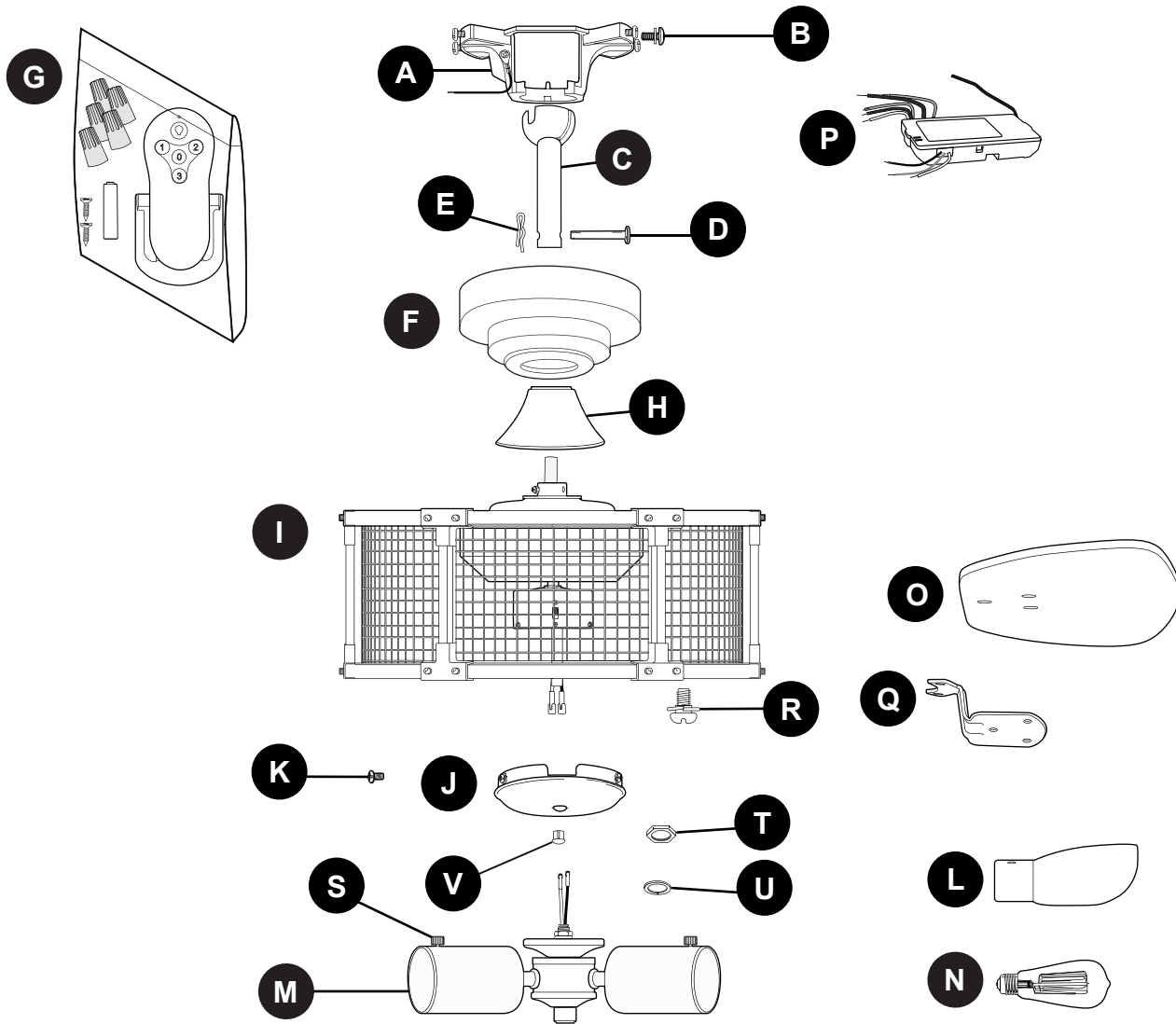

PART	DESCRIPTION	QUANTITY
A	Mounting Bracket	1
B	Canopy Mounting Screw/ Lock Washer (preassembled)	4
C	Downrod	1
D	Pin (preassembled)	1
E	Clip (preassembled)	1
F	Canopy	1
G	Remote Pack	1
H	Yoke Cover	1
I	Motor Housing Assembly	1
J	Switch Housing Cap	1
K	Switch Housing Cap Screw (preassembled)	3

PART	DESCRIPTION	QUANTITY
L	Bulb Shield	3
M	Light Kit Fitter	1
N	Bulb	3
O	Blade	3
P	Remote Control Receiver	1
Q	Blade Arm	3
R	Motor Screw/Lock Washer (preassembled)	6 + 1 extra
S	Bulb Shield Screw (preassembled)	3 + 1 extra
T	Hex Nut (preassembled)	1
U	Lock Washer (preassembled)	1
V	Cap (preassembled)	1

! IMPORTANT REMINDER: You must use the parts provided with this fan for proper installation and safety.

HARDWARE CONTENTS (shown actual size)

AA



Blade
Screw

Qty. 9
+ 1 extra

BB

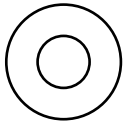

Fiber
Blade
Washer

Qty. 9
+ 1 extra

CC

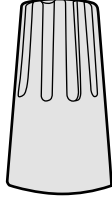

Wire
Connector

Qty. 4

DD



Decorative
Nut

Qty. 9
+ 1 extra

EE

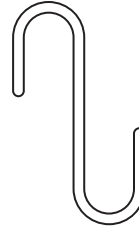

Hook

Qty. 1

PREPARATION

Before beginning assembly of product, make sure all parts are present. Place motor on carpet or on foam to avoid damage to finish. Compare parts with package contents list and hardware contents list. If any part is missing or damaged, do not attempt to assemble the product.

Estimated Assembly Time: 120 minutes

Tools Required for Assembly (not included): Electrical Tape, Phillips Screwdriver, Pliers, Safety Glasses, Stepladder, Wire Strippers and Precision Screwdriver (2 in.)

Helpful Tools (not included): AC Tester Light, Tape Measure, Do-It-Yourself Wiring Handbook and Wire Cutters

INITIAL INSTALLATION

1. Turn off circuit breakers and wall switch to the fan supply line leads.

⚠ DANGER: Failure to disconnect power supply prior to installation may result in serious injury or death.

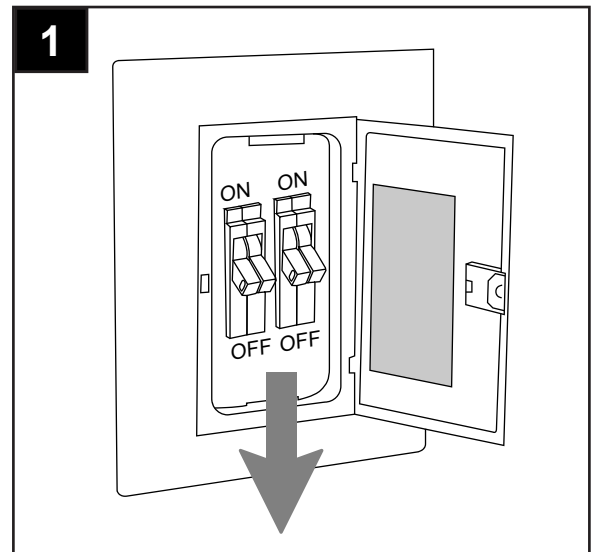

INITIAL INSTALLATION

2. If applicable, remove existing fan, including the mounting bracket, from outlet box and disconnect all electrical wiring.

⚠ WARNING: To reduce the risk of personal injury, use *ONLY* parts provided with your new fan. The use of parts *OTHER* than those provided with this fan will void the warranty.

Set aside screws, spring washers and flat washers (provided with the outlet box) to be used for fan installation.

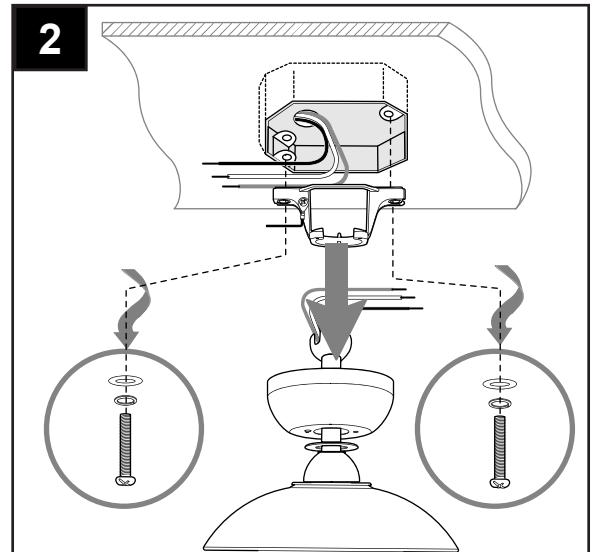

3. Determine mounting method to use.
 - A. Downrod mount (standard or angled ceiling)
 - B. Closemount (standard ceiling only)**IMPORTANT:** If using the angle mount, ensure the ceiling angle is not steeper than 20°.

***Helpful Hint:** Downrod-style mounting is best suited for ceilings 8 ft. or higher. For taller ceilings you may want to use a longer downrod (not included). Angle-style mounting is best suited for angled or vaulted ceilings. A longer downrod is sometimes necessary to ensure proper blade clearance. Closemount mounting is more suitable for ceilings lower than 8 ft. high.

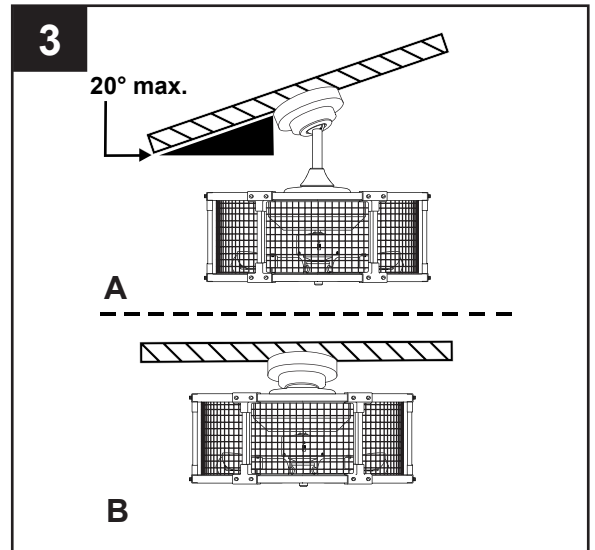

4. Check to make sure motor housing assembly (I) will be at least 7 ft. above the floor and at least 30 inches from any obstruction.

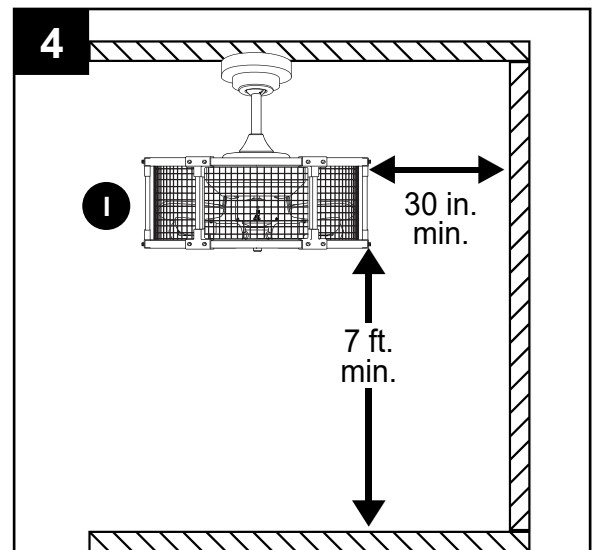

INITIAL INSTALLATION

- Secure mounting bracket (A) to outlet box (not included) using screws, spring washers and flat washers provided with the outlet box.

***NOTE:** It is very important you use the proper hardware when installing the mounting bracket (A) as this will support the fan.

IMPORTANT: If using the angle mount, make sure open end of mounting bracket (A) is installed facing the higher point of the ceiling, and ensure the ceiling angle is not steeper than 20°.

- Remove motor screws/lock washers (R) from underside of motor housing assembly (I) and save for blade plate attachment later on. [If there are plastic motor blocks installed with the motor screws/lock washers (R), discard the plastic motor blocks.]

For **DOWNROD-STYLE FAN MOUNTING**, proceed to step 1 below.

For **CLOSEMOUNT-STYLE FAN MOUNTING**, skip to page 10.

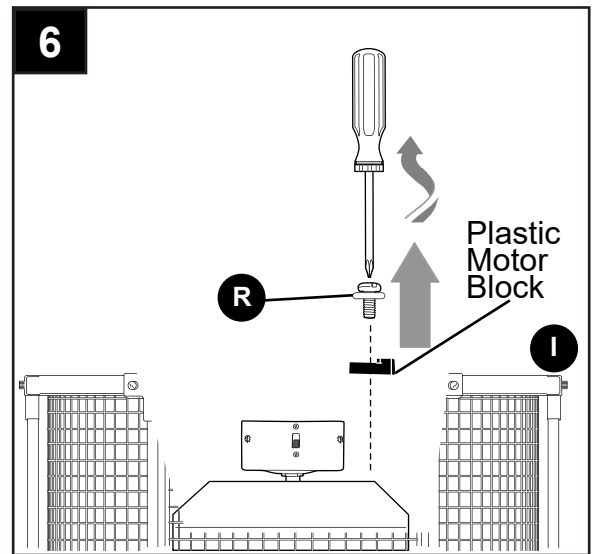
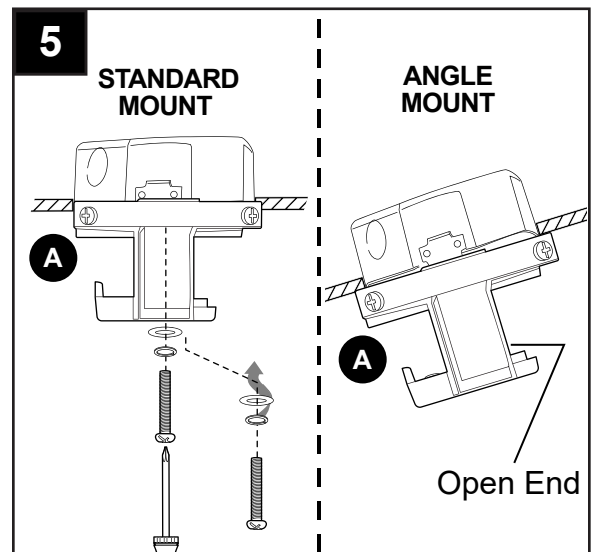

DOWNROD-STYLE FAN MOUNTING

- 1a. Remove pin (D) and clip (E) from downrod (C).
- 1b. Partially loosen preassembled set screws and nut in yoke at top of motor housing assembly (I).

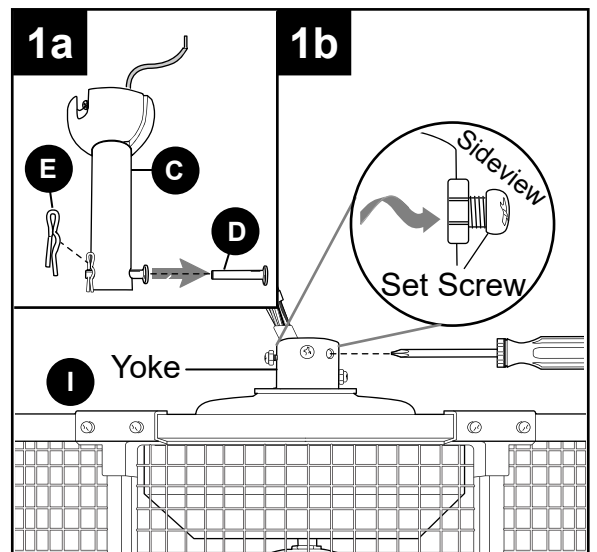

DOWNROD-STYLE FAN MOUNTING

2. Insert downrod (C) through canopy (F) and yoke cover (H).

Then, thread wiring from motor housing assembly (I) through downrod (C).

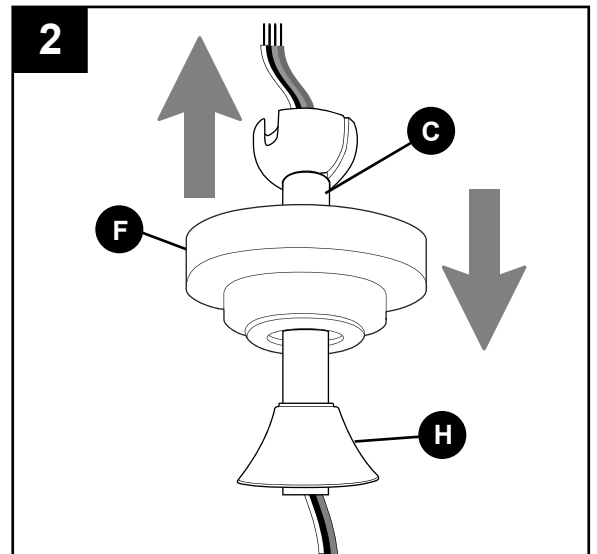

3. Slip downrod (C) into motor housing yoke, align holes and re-install pin (D) and clip (E). Tighten set screws in motor housing yoke and then tighten preassembled nut on one of the set screws. Then, slide yoke cover (H) and canopy (F) down until they rest on top of motor housing assembly (I).

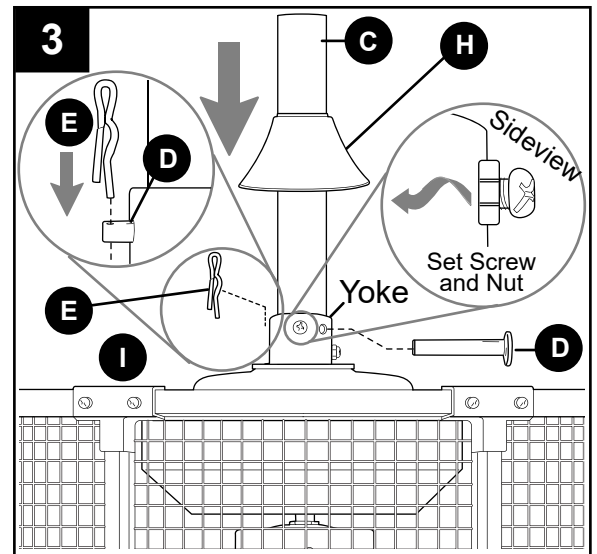

4. Depending on the length of downrod you use, you may need to cut the lead wires back to simplify the wiring. If you decide to cut back the lead wires, it is suggested you do so in the following manner:

Take the lead wires and make sure you have pulled them all the way through the top of the downrod. Start at the TOP of the hanging ball on the downrod and measure 8 in. of lead wire, then cut the excess wire off with wire cutters (not included).

NOTE: If you do *not* cut back the lead wires, **Steps 4 and 5 are not necessary and you may proceed to Step 6 instead.**

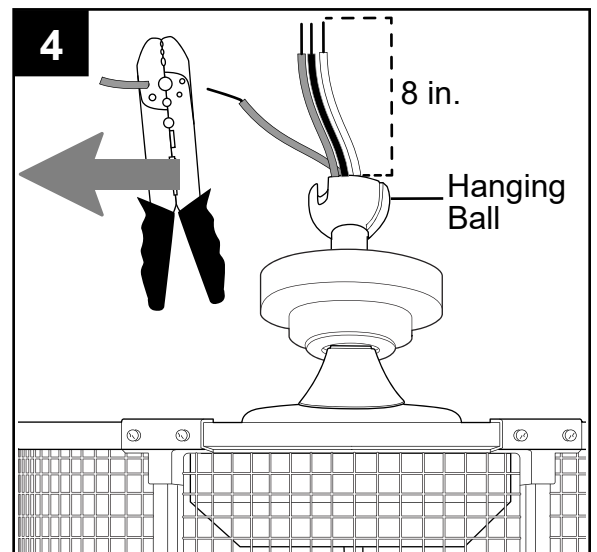

DOWNROD-STYLE FAN MOUNTING

5. If you decided to cut back the lead wires in Step 4, strip 1/2 in. of insulation from end of each wire -- WHITE, BLACK, GREEN and BLUE (if applicable). Twist stripped ends of each strand of wire within the insulation with pliers (not included).

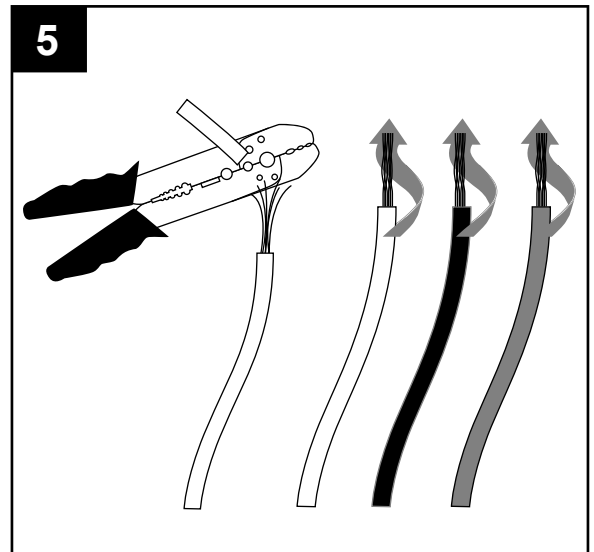

6. Install hanging ball of downrod (C) into opening of mounting bracket (A). Align slot in hanging ball with tab in mounting bracket (A).

⚠ DANGER: Failure to align slot in the ball with the tab may result in serious injury or death.

Continue to **WIRING** on page 11.

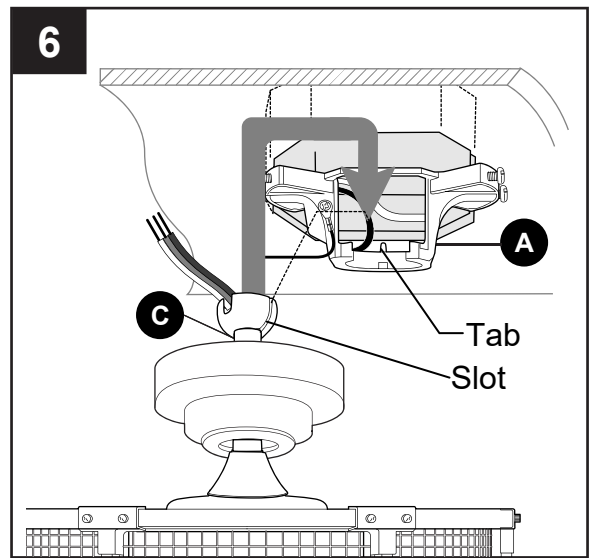

CLOSEMOUNT-STYLE FAN MOUNTING

1. Remove preassembled canopy cover from bottom of canopy (F).

NOTE: To remove canopy cover, twist canopy cover until the two small protrusions on the inner lip of the canopy cover align with the two notches on the bottom of the canopy (F). Pull on canopy cover to remove.

NOTE: The downrod (C) yoke cover (H) and canopy cover are not used in this type of installation.

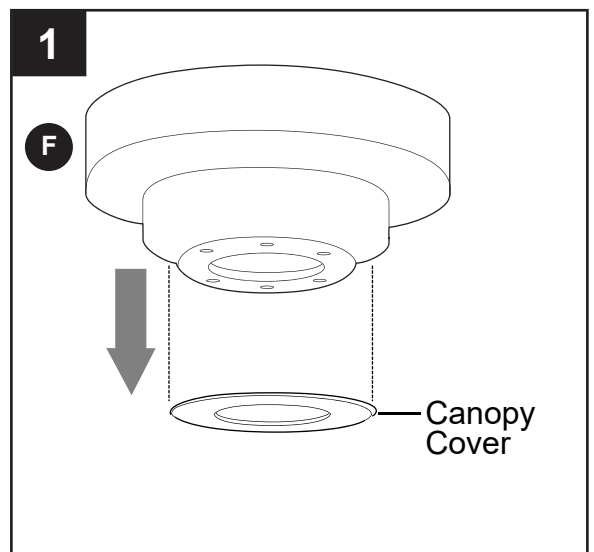

CLOSEMOUNT-STYLE FAN MOUNTING

2. Locate the three raised, preassembled screw/lock washers at top of motor housing assembly (I) and remove each one.

Pull wires up through hole in the middle of the canopy (F) and attach canopy (F) to motor housing assembly (I) using the three previously removed screws/lock washers.

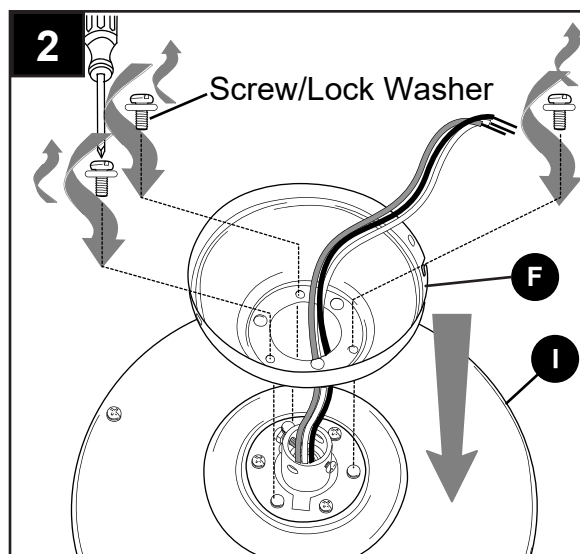

3. Temporarily hang fan on the mounting bracket (A) with the hook (EE) provided using one of the NON-SLOTTED holes in the canopy (F).

Hardware Used

EE

Hook



x1

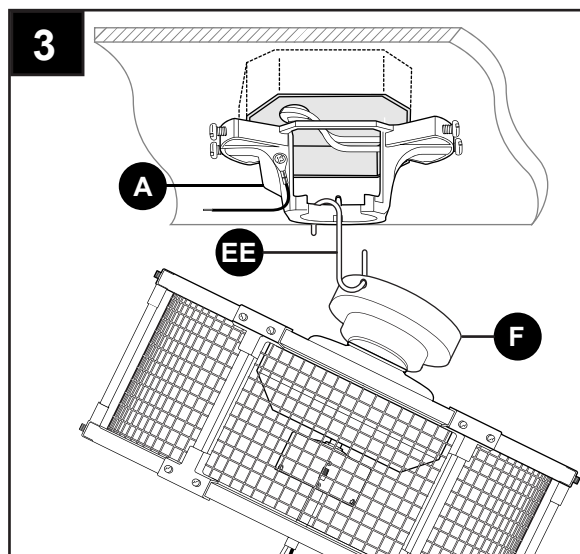

WIRING

⚠ WARNING: To reduce the risk of fire, electrical shock or personal injury, wire connectors provided with this fan are designed to accept only one 12-gauge house wire and two lead wires from the fan. If your house wire is larger than 12-gauge or there is more than one house wire to connect to the corresponding fan lead wires, consult an electrician for the proper size wire connectors to use.

⚠ CAUTION: Be sure outlet box is properly grounded and that a ground (GREEN or BARE) wire is present.

⚠ WARNING: If house wires are different colors than referred to in the following steps, stop immediately. A professional electrician is recommended to determine wiring.

⚠ WARNING: Using a full range dimmer switch (not included) to control fan speed will cause a loud humming noise from fan. To reduce the risk of fire or electrical shock, do NOT use a full range dimmer switch to control fan speed.

WIRING

- 1a. **IMPORTANT:** Make the necessary wiring connections for remote control operation as detailed in Step 1b below. For each wire connection, use one of the wire connectors from the remote pack (G), making sure to screw wire connector on in a clockwise direction.

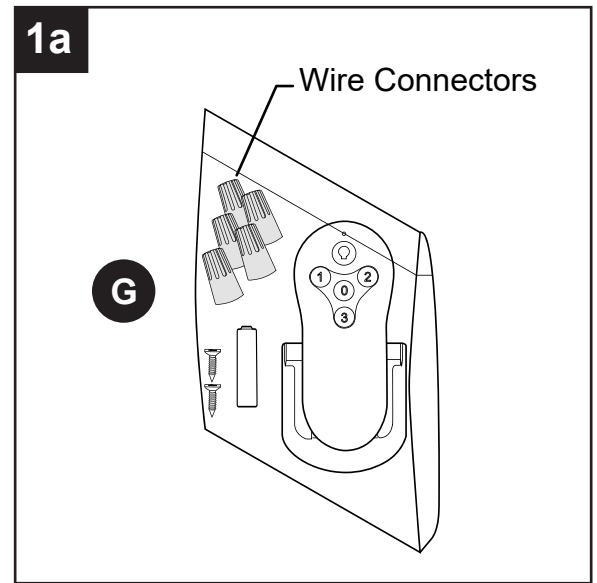

- 1b. Connect all GROUND (GREEN) wires from fan (on downrod (C), if applicable, and mounting bracket (A)) to BARE/GREEN supply wire from ceiling.

Connect BLACK wire (labeled AC IN L) from remote control receiver (P) to BLACK supply wire from ceiling.

Connect WHITE wire (labeled AC IN N) from remote control receiver (P) to WHITE supply wire from ceiling.

Connect BLUE wire (labeled FOR LIGHT) from remote control receiver (P) to BLUE wire from motor housing assembly (I).

Connect BLACK wire (labeled TO MOTOR L) from remote control receiver (P) to BLACK wire from motor housing assembly (I).

Connect WHITE wire (labeled TO MOTOR N) from remote control receiver (P) to WHITE wire from motor housing assembly (I).

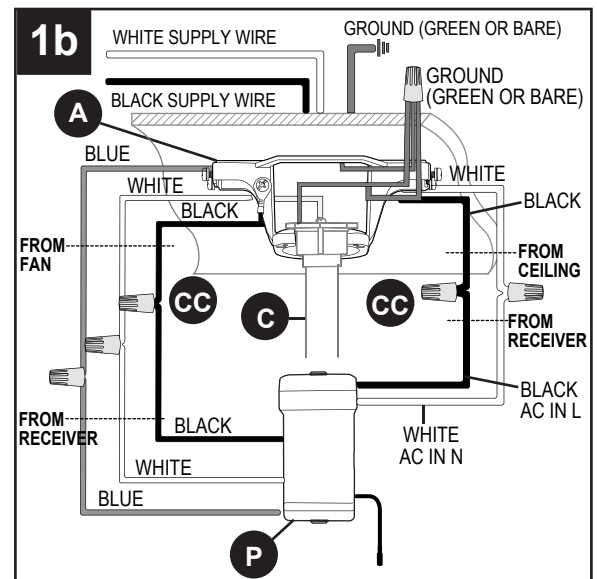

WIRING

2. Wrap electrical tape (not included) around each individual wire connector (CC) down to the wire.

⚠ WARNING: Make sure no bare wire or wire strands are visible after making connections. Place GREEN and WHITE connections on opposite side of the outlet box from the BLACK and BLUE (if applicable) connections.

Hardware Used

CC

Wire Connector

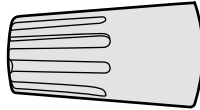

x 4

3. Gently slide remote control receiver (P) flat-side up into mounting bracket (A). Turn spliced/taped wires upward and gently push wires and wire connectors into outlet box. Let antenna from remote control receiver (P) hang to the side.

NOTE: The remote control included with this fan meets the following requirements:

- a. Not for use with solid state fans.
- b. Electrical rating: 120V / 60 Hz;
motor amps: 1.25 MAX.

Should you choose to use a different remote control with this fan, it must also meet these same requirements.

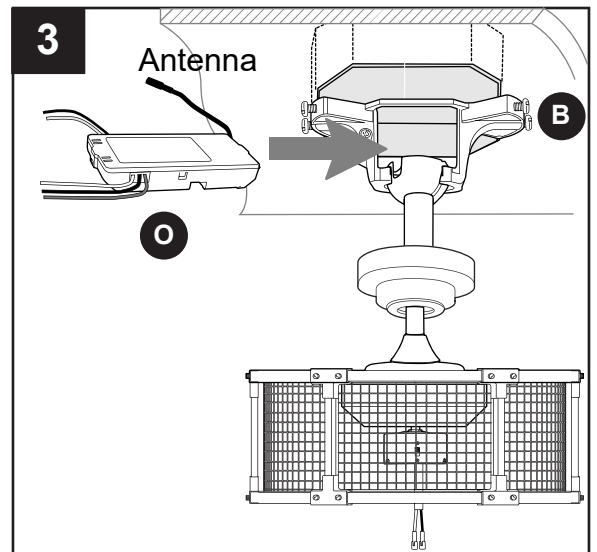
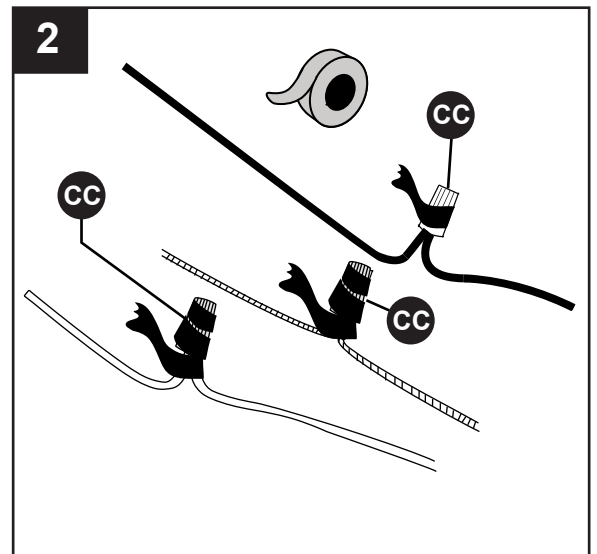

FINAL INSTALLATION

1. Remove motor housing assembly (I) from mounting bracket (A) and, if necessary, remove hook (EE) from canopy (F).

Temporarily lift canopy (F) to mounting bracket (A) to determine which two canopy mounting screws/lock washers (B) in mounting bracket (A) align with slotted holes in canopy (F) and partially loosen these two canopy mounting screws/lock washers (B). Remove the other two canopy mounting screws/lock washers (B). Now, lift canopy (F) to mounting bracket (A) again, aligning slotted holes in canopy (F) with loosened canopy mounting screws/lock washers (B) in mounting bracket (A). Twist canopy (F) clockwise to lock. Re-insert the two canopy mounting screws/lock washers (B) that were just removed and tighten all canopy mounting screws/lock washers (B) securely.

⚠ CAUTION: Assistance from another person is recommended for this step.



2. **⚠ DANGER:** To reduce the risk of serious bodily injury, DO NOT use power tools to assemble the blades (O). If screws are overtightened, blades (O) may crack and break.

Align holes in blade arm (Q) with holes on topside of blade (O). Push one decorative nut (DD) through blade hole from underside of blade (O). Insert blade screws (AA) with fiber blade washers (BB) from topside of blade (O) into the decorative nut (DD). Partially tighten blade screw (AA). Repeat to attach remaining decorative nuts (DD), blade screws (AA) and fiber blade washers (BB).

Tighten all blade screws (AA) securely.

Repeat Step 2 for remaining blades (O).

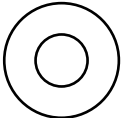
Hardware Used

AA Blade Screw		x 9
BB Fiber Blade Washer		x 9
DD Decorative Screw		x 9

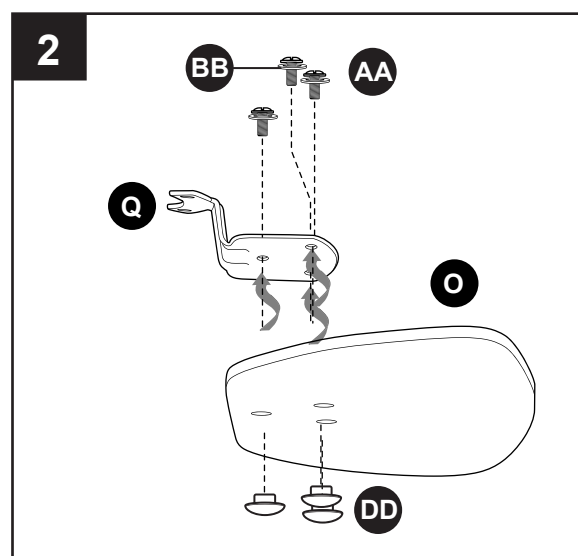
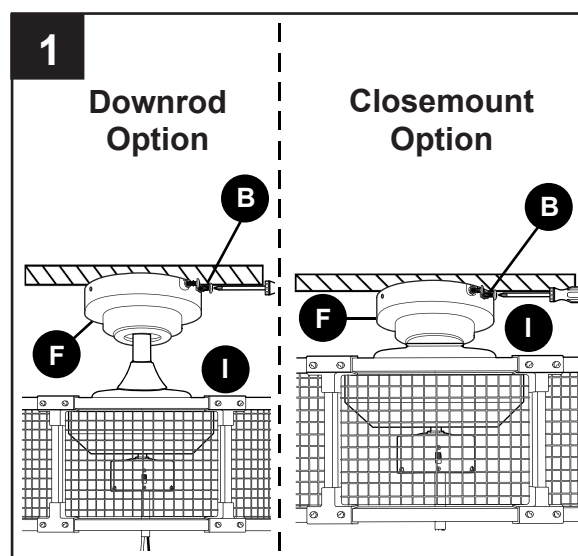

FINAL INSTALLATION

3. Align holes in blade plate (Q) with corresponding holes on bottom of motor housing assembly (I). Re-insert the motor plate screws/lock washers (R) that was previously removed (Step 6, page 8) and securely tighten motor plate screws/lock washers (R). Repeat for remaining blades (O) and blade arms (Q).

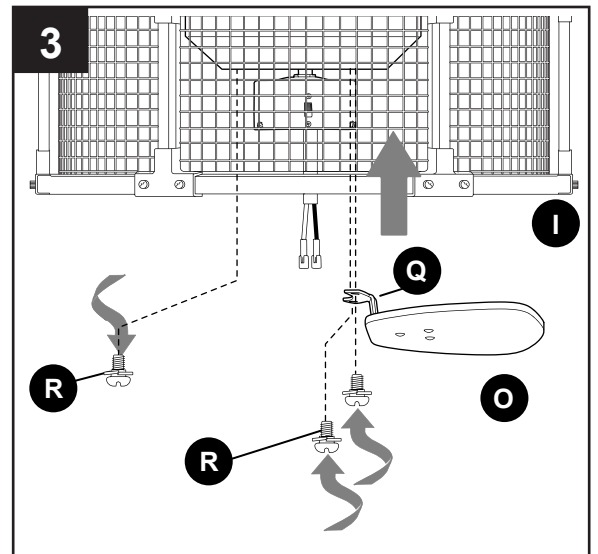

4. **To install the fan with the light kit**, remove bulb shield screws (S) from each end of socket cover on light kit fitter (M). Align hole in bulb shield (L) with hole in one of the socket cover. Re-insert bulb shield screw (S) and tighten until secure. Repeat with two remaining bulb shields (L).

If you do not wish to use the light kit, skip to **INSTALLING FAN WITHOUT A LIGHT KIT** on page 16.

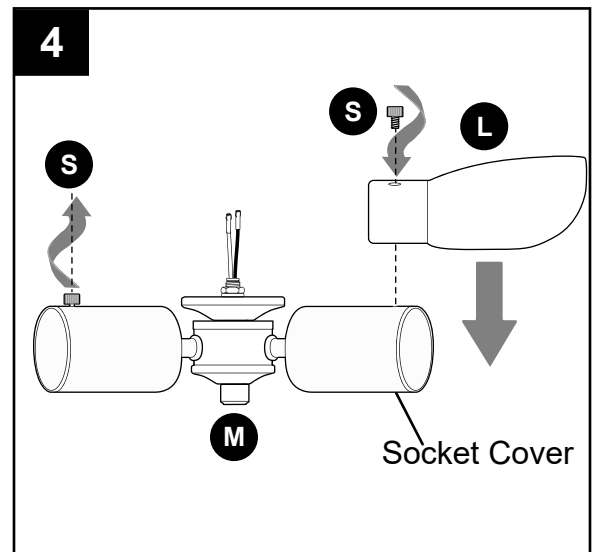

5. Remove preassembled switch housing cap screws (K) from switch housing cap (J) and save for later use.

Remove preassembled hex nut (T) and lock washer (U) from threaded rod at top of light kit fitter (M). Punch center cap (V) out of switch housing cap (J) with the handle end of a screwdriver (not included). Gently feed molex connections (one wire at a time) from light kit fitter (M) through hole in middle of switch housing cap (J), and then screw switch housing cap (J) onto threaded rod at top of light kit fitter (M). Replace lock washer (U) and then tighten hex nut (T) over lock washer (U) for a secure fit.

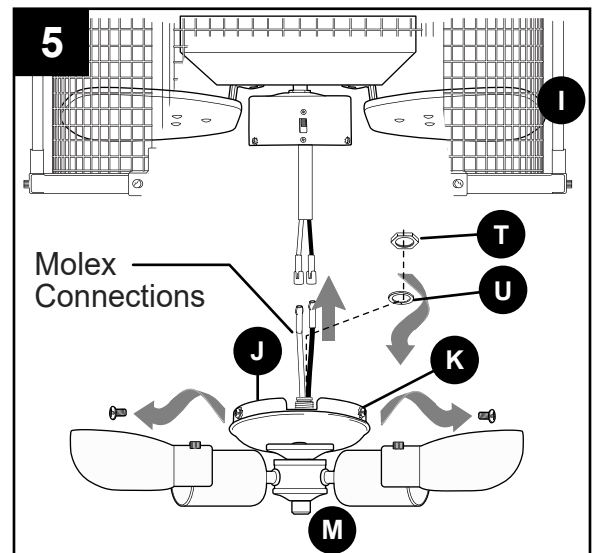

FINAL INSTALLATION

6. Locate BLUE and WHITE wires in switch housing on underside of motor housing assembly (I).

Connect WHITE wire from light kit fitter (M) to WHITE wire from switch housing. Connect BLUE wire from light kit fitter (M) to BLUE (or BLACK) wire from switch housing. Make sure molex connections are secure.

7. Carefully arrange wiring within switch housing on underside of motor housing assembly (I).

Align holes in switch housing cap (J) with holes in switch housing. Re-insert switch housing cap screws (K) previously removed (Step 5, page 15) and tighten until secure.

NOTE: Make sure to align gap on switch housing cap (J) with the reverse switch on switch housing for correct fit.

Insert light bulbs (N) into light kit fitter (M) sockets and tighten until secure.

⚠ WARNING: When you need to replace bulb please allow the bulb, (N) and bulb shield (L) to cool down before touching it.

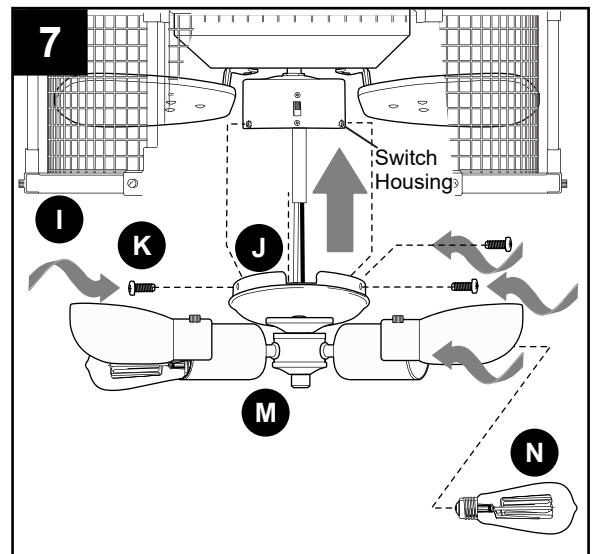
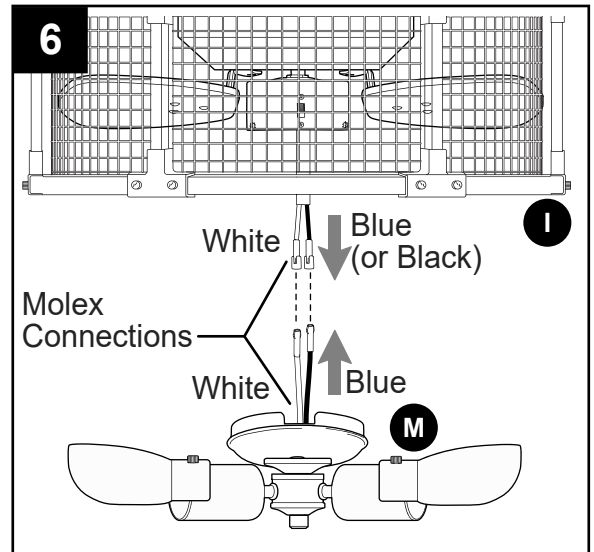

INSTALLING FAN WITHOUT LIGHT KIT

1. If you do NOT wish to use the light kit, remove three switch housing cap screws (K) from switch housing cap (J). Carefully arrange wires inside switch housing. Align holes in switch housing cap (J) with holes in switch housing and secure switch housing cap (J) with three switch housing cap screws (K) previously removed (Step 5, page 15). Tighten all switch housing cap screws (K) securely.

NOTE: Make sure to align gap on switch housing cap (J) with the reverse switch on switch housing for correct fit.

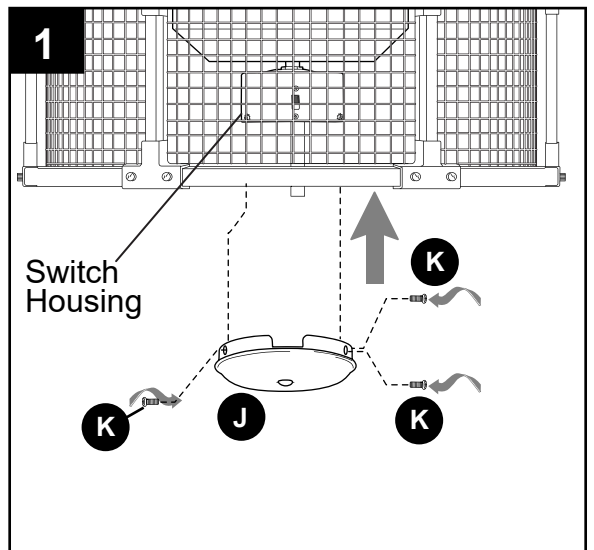

OPERATING INSTRUCTIONS

⚠ CAUTION: The remote control transmitter can be programmed to multiple receivers or fans. If this is not desired, turn wall switch off to any other programmable receiver or fan.

FCC Compliance Notice for Remote Control and LED Light Kit

⚠ CAUTION: Changes or modifications not approved by the party responsible for compliance could void the user's authority to operate the equipment.

This device complies with Part 15 of the FCC Rules. Operation is subject to the following two conditions: (1) this device may not cause harmful interference, (2) this device must accept any interference received, including interference that may cause undesired operation.

***NOTE:** This equipment has been tested and found to comply with the limits for a Class B digital device, pursuant to Part 15 of the FCC Rules. These limits are designed to provide reasonable protection against harmful interference in a residential installation. This equipment generates, uses and can radiate radio frequency energy and, if not installed and used in accordance with the instructions, may cause harmful interference to radio communications. However, there is no guarantee that interference will not occur in a particular installation. If this equipment does cause harmful interference to radio or television reception, which can be determined by turning the equipment off and on, the user is encouraged to try to correct the interference by one or more of the following measures:

- * Reorient or relocate the receiving antenna.
- * Increase the separation between the equipment and receiver.
- * Connect the equipment into an outlet on a circuit different from that to which the receiver is connected.

Consult the dealer or an experienced radio/TV technician for help.

Distributed by: Litex Industries Inc., P.O. Box 535639, Grand Prairie, TX, 75050; 800-527-1292

1. **NOTE:** Remove protective covering from front of remote control transmitter and discard.

Remove battery cover from back of remote control transmitter in remote pack (G). Install battery from remote pack (G) with positive (+) end toward top of remote control transmitter.

⚠ WARNING: Battery is to be inserted with correct polarity.

Replace battery cover on remote control transmitter.

⚠ WARNING: Choking/Ingestion Hazard - Small parts. Keep battery away from children.

NOTE: Battery is NOT rechargeable. Remove battery with low or no charge and dispose of properly.

⚠ CAUTION: "DO NOT DISPOSE OF BATTERIES IN FIRE, BATTERIES MAY EXPLODE OR LEAK." - When disposing of household alkaline batteries, it is best to check with your local and state recycling or household hazardous waste coordinators concerning the specifics of the program in your area. You may also locate a recycling center by calling 1-800-8-BATTERY or 1-877-2-RECYCLE or visit www.epa.gov/epawaste/index.htm or www.earth911.org for more information.

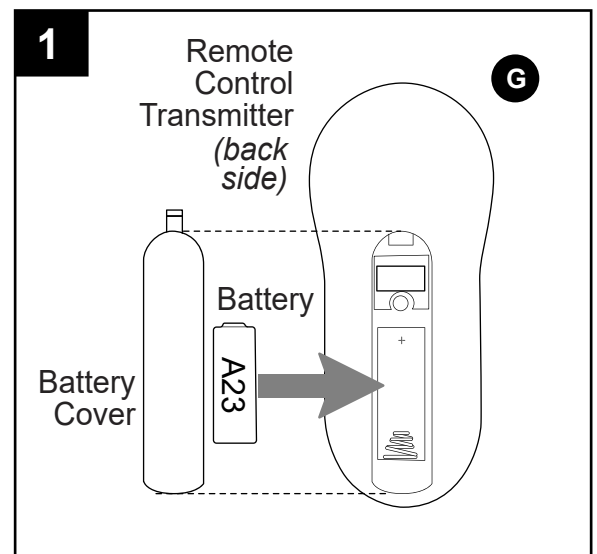

OPERATING INSTRUCTIONS

2. Restore electrical power.

IMPORTANT: To prevent damage to remote control transmitter, remove the battery if not used for long periods. Store the remote control transmitter away from excess heat or humidity.

NOTE: If fan and/or remote control fail(s) to operate or you have purchased a new remote control transmitter, make sure to turn the power off first. Restore electrical power. Within 30 seconds of restoring electrical power, press and hold the ON/OFF button (0) on the remote control transmitter for 5 seconds until light on the fan blinks twice. Use the remote control transmitter to test the light and fan functions to confirm the learning process is complete.

3. Operation buttons on the panel of the remote control transmitter:

3 button	for <u>fan</u> HIGH speed
2 button	for <u>fan</u> MEDIUM speed
1 button	for <u>fan</u> LOW speed
0 button	to turn <u>fan</u> OFF
💡 button	to turn <u>light</u> ON or OFF

Tap 💡 button quickly to turn lights off or on. Hold 💡 button down to increase or decrease lights. If you press 💡 button in excess of 0.7 seconds, it becomes a dimmer. The lights vary cyclically in 8 seconds. The light button has an auto resume function, which keeps the light at the same brightness as the last time it was turned off.

4. Use the fan reverse switch, located on the bottom of the motor housing assembly (I), to optimize the fan for seasonal performance. A ceiling fan will allow you to raise your thermostat setting in summer and lower your thermostat setting in winter without feeling a difference in your comfort.

⚠ CAUTION: Turn fan off at wall switch and let blades (O) come to a complete stop before manually activating the reverse switch.

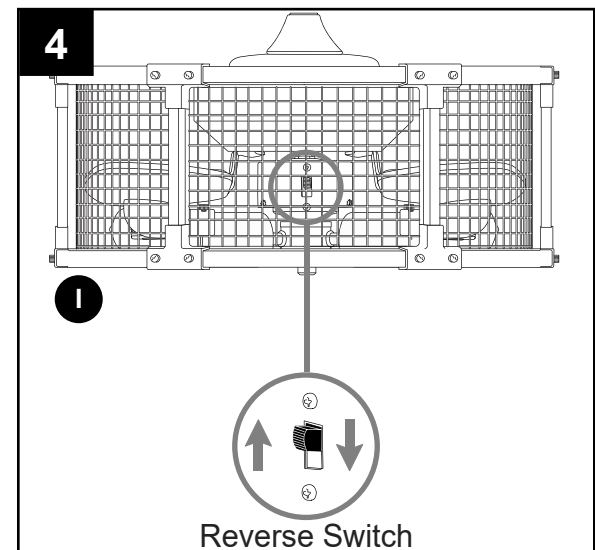
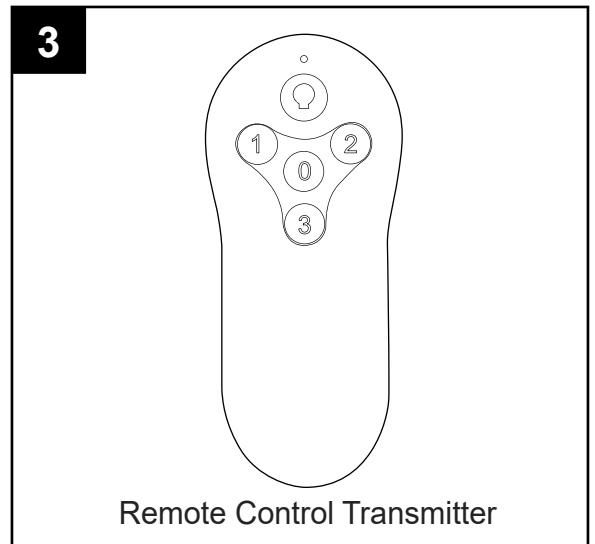
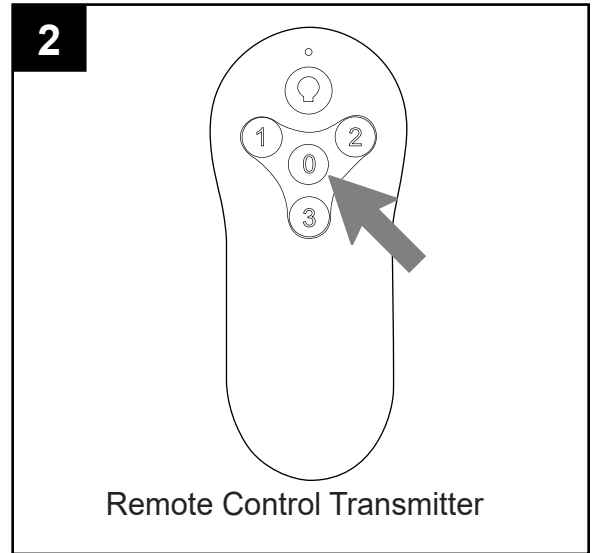

OPERATING INSTRUCTIONS

- 5a. In **warmer** weather, setting the reverse switch in the DOWN position will result in downward airflow creating a wind chill effect.
- 5b. In **cooler** weather, setting the reverse switch in the UP position will result in upward airflow that can help move stagnant, hot air off the ceiling area.
- 5c. **IMPORTANT:** Reverse switch must be set either **completely** UP or **completely** DOWN for fan to function. If the reverse switch is set in the middle position, fan will not operate.

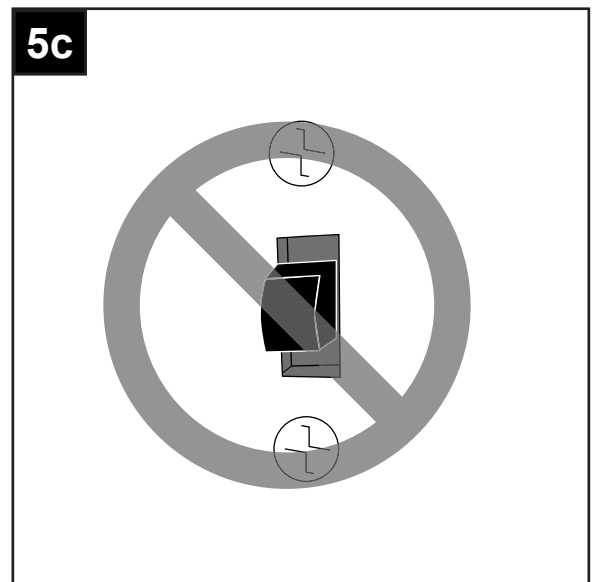
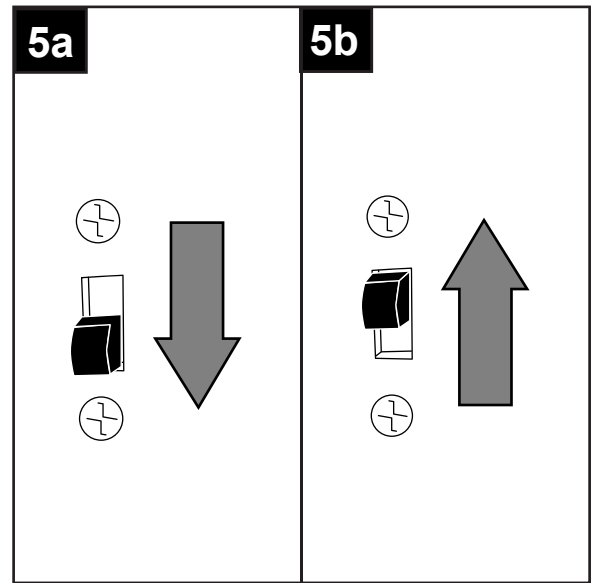

CARE AND MAINTENANCE

At least twice each year, lower canopy (F) to check downrod (C) assembly, and then tighten all screws on fan. Clean motor housing assembly (I) with only a soft brush or lint-free cloth to avoid scratching the finish. Clean blades (O) with a lint-free cloth. You may occasionally apply a light coat of furniture polish to wood blades (O) for added protection.

IMPORTANT: Shut off main power supply before beginning any maintenance. Do not use water or a damp cloth to clean the ceiling fan.

Bulb Replacement: Use three standard-base 4-watt LED bulbs or CFL/incandescent equivalent.

TROUBLESHOOTING

⚠ WARNING: Before beginning work, shut off the power supply to avoid electrical shock.

PROBLEM	POSSIBLE CAUSE	CORRECTIVE ACTION
Fan does not move.	<ol style="list-style-type: none"> 1. Power is off or fuse is blown. 2. Faulty wire connection. 3. Reverse switch not engaged. 4. Blades are not installed. 5. Learning code process between fan and remote control transmitter may not have been successful and learning code was not activated. 	<ol style="list-style-type: none"> 1. Turn power on or check fuse. 2. Turn power off. Loosen canopy and check all connections. 3. Push switch firmly either up or down. 4. Install all blades (see pages 14-15). 5. Turn off power and repeat instructions in Step 2 on page 18
Noisy operation.	<ol style="list-style-type: none"> 1. Blades are loose. 2. Cracked blade. 3. Full range dimmer switch 4. Fan is new. 	<ol style="list-style-type: none"> 1. Tighten all blade screws. 2. Replace blade. 3. Use only with included speed control device. 4. Allow fan a "break in" period of a few days, especially when running the fan at Medium and High speeds.
Excessive wobbling.	<ol style="list-style-type: none"> 1. Blades are loose. 2. Blade plates incorrectly attached. 3. Unbalanced blades. 4. Fan not securely mounted. 5. Fan too close to vaulted ceiling. 6. Set screw(s) on motor housing yoke is (are) not tightened properly. 7. Set screw on hanging ball is not tightened properly. 	<ol style="list-style-type: none"> 1. Tighten all blade screws. 2. Re-install blade plates. 3. Switch one blade with a blade from the opposite side. 4. Turn power off. Carefully loosen canopy and verify that mounting bracket is secure. 5. Use a longer downrod or move fan to another location. 6. Tighten yoke set screw(s) securely. 7. Carefully loosen and lower canopy and verify that set screw on hanging ball is tightened securely.
Fan operates but lights fail.	<ol style="list-style-type: none"> 1. Wires in canopy not wired properly. 2. Wall switch to fan is off. 3. Wires from light kit fitter not wired correctly. 	<ol style="list-style-type: none"> 1. Check wires in canopy and, if necessary, re-wire according to instructions on pages 12 - 13. 2. Make sure wall switch to fan is on. 3. Check that mox connections in light kit fitter are connected properly according to instructions on page 16.
Remote control fails to operate.	<ol style="list-style-type: none"> 1. Remote control transmitter not synced with fan. 2. Battery not installed correctly. 3. Battery no longer working. 	<ol style="list-style-type: none"> 1. Refer to instructions in Step 2 on page 18. 2. Check that battery has been installed with correct polarity. 3. Replace battery according to instructions on page 17.

NOTE: A small amount of "wobble" is normal and should not be considered a defect.

LIMITED LIFETIME WARRANTY

Set forth below, the manufacturer warrants the fan motor for this ceiling fan to be free from defects in workmanship and material for the life of the product. Also, subject to the limitations below, the manufacturer warrants all ceiling fan parts ("ceiling fan parts" excludes the motor and parts made in whole or in part with glass) to be free from defects in workmanship and material for a period of one year after the date of purchase by the original purchaser at retail.

All claims must be made by the original purchaser, whether such purchaser purchased the product through a store or contractor. Ceiling fan part defects must be reported within the first year from the date of purchase. Parts made in whole or in part with glass and the finishes of metal and other surfaces are not warranted.

Purchasers are responsible for all costs of removing and reinstalling the product. Any damage to any part caused by ordinary wear and tear, accident, misuse, or improper installation, is not covered by this warranty. The manufacturer assumes no responsibility whatsoever for fan installation. Any service performed by a non-licensed electrician will render the warranty invalid.

The manufacturer's sole responsibility shall be to repair or replace the motor, parts, or product within the terms stated above. The manufacturer shall not be liable for any loss or damage of any kind, including any incidental or consequential damages resulting directly or indirectly, from any breach of warranty, express or implied, or any other failure of this product. Some states do not allow the exclusion or limitation of incidental or consequential damages so this limitation may not apply to you.

If the original purchaser ceases to own the fan, this warranty is voided.

Should the purchaser encounter a problem with your fan related to defects in workmanship or materials within the warranty period associated with the defective part, the manufacturer agrees to replace the defective part without charge, or at its option, to replace the ceiling fan with a comparable or superior model.

The manufacturer's warranties are limited to the written warranties set out in this ceiling fan limited lifetime warranty. All other express and implied warranties, including, without limitation, the implied warranty of fitness for a particular purpose and the implied warranty of merchantability are disclaimed. Some states do not allow the disclaimer of implied warranties, so this disclaimer may not apply to you.

REPLACEMENT PARTS LIST

For replacement parts, call our customer service department at **800-527-1292**, 8:30 a.m. - 5 p.m., CST, Monday - Friday.

PART	DESCRIPTION	PART#
A	Mounting Bracket	5730160-A
C	Downrod	5730160-C
F	Canopy	5730160-F
M	Light Kit Fitter	5730160-M
O	Blade	5730160-O
Q	Blade Arm	5730160-Q

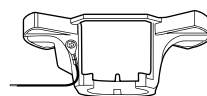

A



C

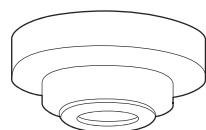

F

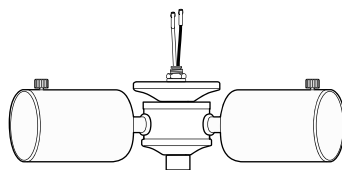

M



O



Q