

2 General Information

2.1 Product Specification

Model	WP800	WP1000
Part No.	WP800A1W	WP1000A1W
Daily Production Capacity	800 GPD	1000 GPD
Operating Water Temperatures	40-100 °F (5-38 °C)	
Operating Water Pressure	15-100 psi (0.1-0.7 MPa)	
Power Specifications	Input:100-240V AC Output:24V DC	
Feed Water Requirement	Municipal Tap Water	
pH Parameters	2-11	
TDS (Total Dissolved Solids)	< 1800 ppm	
Iron	< 0.2 ppm	
Turbidity	< 5 NTU	
Hardness	< 10 gpg (170 mg/L)	

Hardness: Recommended hardness not to exceed 10 grains per gallon, or 170 parts per million.

Note: System will operate with hardness over 10 grains but the membrane life may be shortened. The addition of a water softener may lengthen the membrane life.

Water Pressure: The operating water pressure in your home should be tested over a 24 hour period to attain the maximum pressure. If the incoming water pressure is above 80 psi then a water pressure regulator is required.

2.2 Product Overview and Installation Illustration

Product Overview

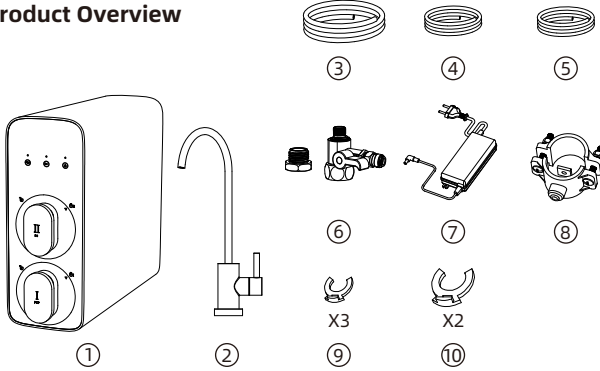

Installation Illustration

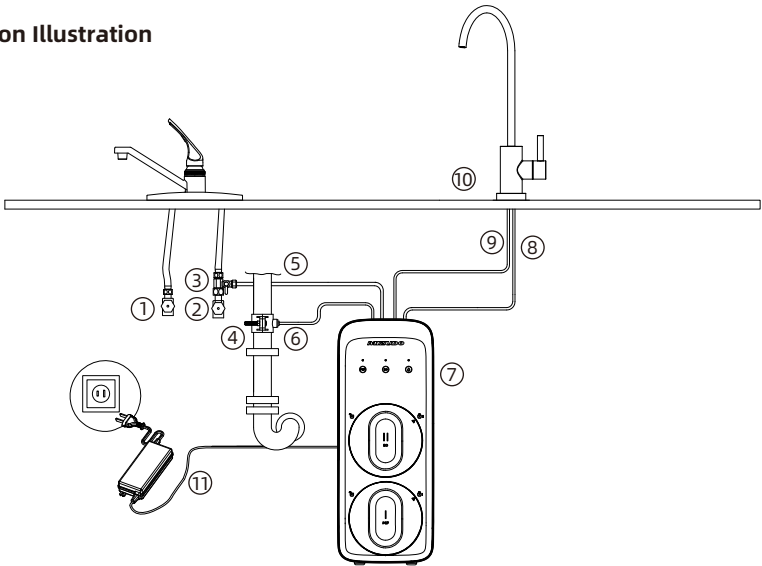

Tools and Materials Required

- Hand or electric drill(cordless preferred)
- Adjustable wrenches
- Slotted and Phillips screwdrivers
- Utility knife or scissors
- Safety glasses
- Drill bits: 1"(for faucet hole), 1/4"(for drain tubing)
- Safety mask



NOTICE

Not all tools may be necessary for installation. Read installation procedures before starting to determine what tools are required.

3 Installation

3.1 Installation Instructions

Read all installation and operating instructions before installing and using your RO system.



NOTICE

- Please check if there is sufficient space for installing the system itself, its accessories, connection.
- Under no circumstances should the system be installed outdoors.
- The environment where the system is installed should adhere to appropriate hygiene and sanitation conditions. Avoid any external dripping liquids from pipes or drains, etc, onto the system.
- This system should be placed on a stable and at the surface.
- Keep the system away from heat. It shall not be placed in a place that may have in-inflammable gas leakage.

How to use the quick-connector fitting

To connect

