

ITEM #5742515  
MODEL #CLLR12WW



# FLUSHMOUNT CEILING LIGHT

Español p. 11

# PROJECT SOURCE

PROJECT SOURCE and logo design are trademarks or registered trademarks of LF, LLC. All rights reserved.

ATTACH YOUR RECEIPT HERE

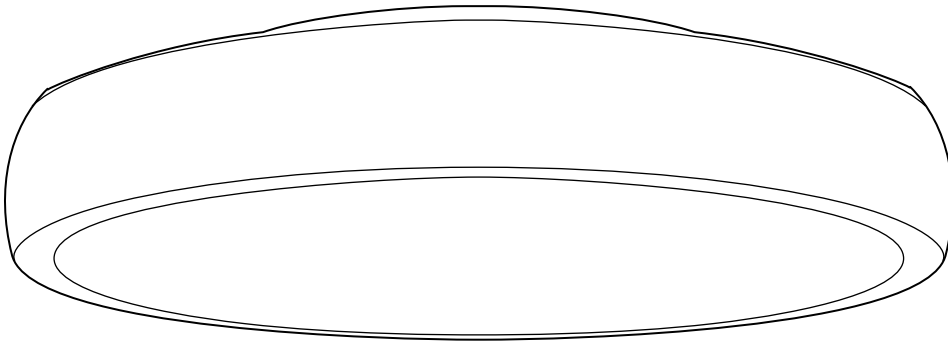

**Intertek**  
5005395

APPROVED FOR USE  
IN DAMP LOCATIONS

Purchase Date \_\_\_\_\_



Thank you for purchasing this PROJECT SOURCE product. Questions, problems, missing parts? Before returning, contact us on: **866-389-8827**, 8 a.m.-8 p.m., EST, Monday-Sunday or [ascs@lowes.com](mailto:ascs@lowes.com).

TABLE OF CONTENTS

Package Contents ..... 2

Hardware Contents ..... 3

Safety Information ..... 3

Preparation ..... 5

Assembly Instructions ..... 5

Remote Control Operation ..... 8

Care and Maintenance ..... 10

Troubleshooting ..... 10

Warranty ..... 10

PACKAGE CONTENTS

C

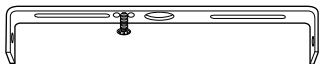

B

A

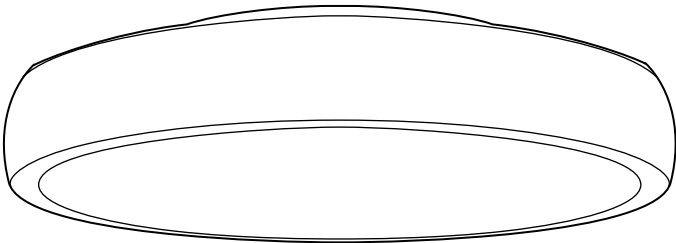

D

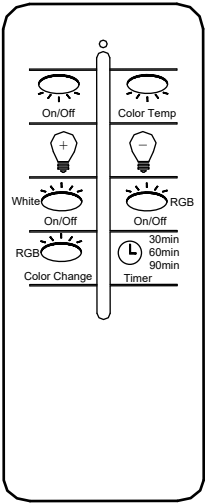

PART	DESCRIPTION	QUANTITY
A	Fixture	1
B	Mounting Strap (preassembled to fixture (A))	1
C	Mounting Strap Screw (preassembled to mounting strap (B))	2
D	Remote Control	1

## HARDWARE CONTENTS (shown actual size)

---

**AA**

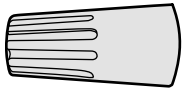

Wire  
Connector

Qty. 3

**BB**



Machine  
Screw

Qty. 2



### SAFETY INFORMATION

**READ AND SAVE THESE INSTRUCTIONS.**



### DANGER

- For your protection and safety, carefully read and understand the information provided in this manual completely before attempting to assemble, install or operate this product. Failure to do so could lead to fire, electrical shock or other injuries that could be hazardous or even fatal.
- DO NOT connect this fixture to an electrical system that does not provide a means for equipment grounding. Never use a fixture in a two-wire system that is not grounded. Installing a fixture into an electrical system not having a proper grounding means could cause metal parts of the fixture to carry electrical currents if any of the fixture wires, wire connections or splices were to become broken, cut or loose during the mounting or normal operation of the fixture. Under this condition, anyone coming in contact with the fixture would be subject to electrical shock, which could cause serious injury or death.
- DO NOT connect the bare or green insulation fixture ground wire to the black (HOT) current-carrying wire or the white (NEUTRAL) house wire. Connection of the bare or green fixture ground wire to the black or white house wires may cause metal parts of the fixture to carry electrical currents. Under this condition, anyone coming in contact with the fixture will receive electrical shock, which could cause serious injury or death.
- DO NOT damage or cut the wire insulation (covering) during installation of fixture. DO NOT permit wires to contact any surface having a sharp edge. To do so may damage or cut the wire insulation, which could cause serious injury or death from electrical shock.



### WARNING

- THIS PRODUCT MUST BE INSTALLED IN ACCORDANCE WITH THE APPLICABLE INSTALLATION CODE BY A PERSON FAMILIAR WITH THE CONSTRUCTION AND OPERATION OF THE PRODUCT AND THE HAZARDS INVOLVED.
- All electrical connections must be in agreement with local codes and ordinances, the National Electric Code (NEC) and ANSI/NFPA 70-1999. Contact your municipal building department to learn about your local codes, permits and/or inspections. Risk of fire - most dwellings built before 1985 have supply wire rated for 140 °F. Consult a qualified electrician before installation.
- To avoid personal injury, the use of gloves may be necessary while handling fixture parts with sharp edges.
- To reduce the risk of damage to the fixture, DO NOT use power tools to assemble any part of the fixture.

## SAFETY INFORMATION

---

### WARNING

- DO NOT suspend any fixture by the house wires. A fixture must always be mounted directly to an outlet box or to a mounting strap which is first attached to the outlet box. The outlet box must be supported by the building structure. Wire connectors will not support the weight of a fixture. Suspending a fixture by the house wires and wire connectors will result in the fixture falling, with the possibility of personal injury and the danger of electrical shock or fire.
- To reduce the risk of fire, electrical shock or personal injury, wire connectors provided with this light fixture are designed to accept only one 12-gauge house wire and two lead wires from the light fixture. If your house wire is larger than 12-gauge or there is more than one house wire to connect to the corresponding fixture lead wires, consult an electrician for the proper size wire connectors to use.

### CAUTION

- TURN OFF ELECTRICITY at main fuse box (or circuit breaker box) before beginning installation by removing the fuse (or switching the circuit breaker off).
- If you are not sure the lighting system has a grounding means, DO NOT attempt to install this fixture. Contact a qualified, licensed electrician for information regarding the proper grounding methods as required by the local electrical code in your area.
- All fixtures must be mounted to an outlet box that is supported by the building structure.
- If a dimmer control switch is used with this fixture, obtain professional advice to determine the correct type to use as well as the electrical rating required.
- Before installation is complete, carefully check all screws, bolts and nuts on fixture to ensure that they are secure.
- Do NOT tamper with or attempt to repair LED component of fixture. The light source is designed for this specific application and should not be serviced by untrained personnel. If any servicing is required, call our customer service department.
- The device complies with Part 15 of the FCC Rules. Operation is subject to the following two conditions: (1) this device may not cause harmful interference, (2) this device must accept any interference received, including interference that may cause undesired operation.
- Changes or modifications not approved by the party responsible for compliance could void the user's authority to operate the equipment.

**Note:** This equipment has been tested and found to comply with the limits for a Class B digital device, pursuant to Part 15 of the FCC Rules. These limits are designed to provide reasonable protection against harmful interference in a residential installation. This equipment generates, uses and can radiate radio frequency energy and, if not installed and used in accordance with the instructions, may cause harmful interference to radio communications. However, there is no guarantee that interference will not occur in a particular installation. If this equipment does cause harmful interference to radio or television reception, which can be determined by turning the equipment off and on, the user is encouraged to try to correct the interference by one or more of the following measures:

- \* Reorient or relocate the receiving antenna.
- \* Increase the separation between the equipment and receiver.
- \* Connect the equipment into an outlet on a circuit different from that to which the receiver is connected.

Consult the dealer or an experienced radio/TV technician for help.

Distributed by: Litex Industries Inc., P.O. Box 535639, Grand Prairie, TX, 75050; 800-527-1292

**NOTE:** Dimmable to 10% with select dimmers. See [Lowes.com](http://Lowes.com) for more information.

## PREPARATION

---

Before beginning assembly of product, make sure all parts are present. Compare parts with package contents list and hardware contents list. If any part is missing or damaged, do not attempt to install, operate or assemble the product.

**Estimated Assembly Time: 30 minutes**

Tools Required for Assembly (not included): Flathead Screwdriver, Phillips Screwdriver, Wire Strippers, Pliers, Wire Cutters, Safety Glasses, Stepladder, Electrical Tape, Silicone Weather Sealant (and tool to apply sealant)

Helpful Tools (not included): A/C Tester Light, Do-It-Yourself Guide, Soft Cloth

## ASSEMBLY INSTRUCTIONS

---

1. Turn off circuit breakers and wall switch to the fixture supply line leads.

**⚠ DANGER:** Failure to disconnect power supply prior to installation may result in serious injury or death.

2. Remove existing fixture and disconnect all electrical wiring.

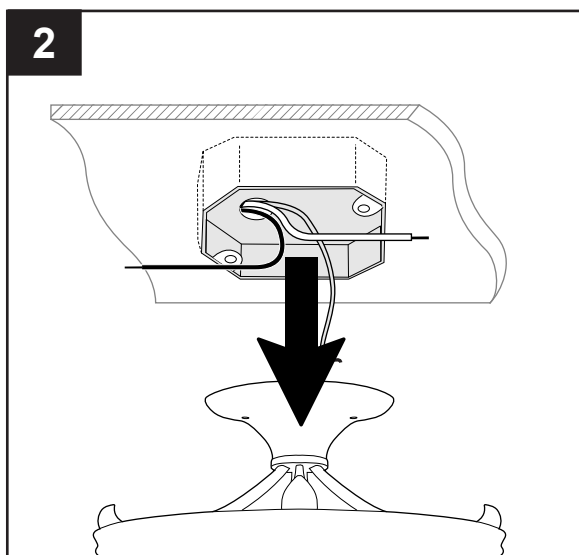
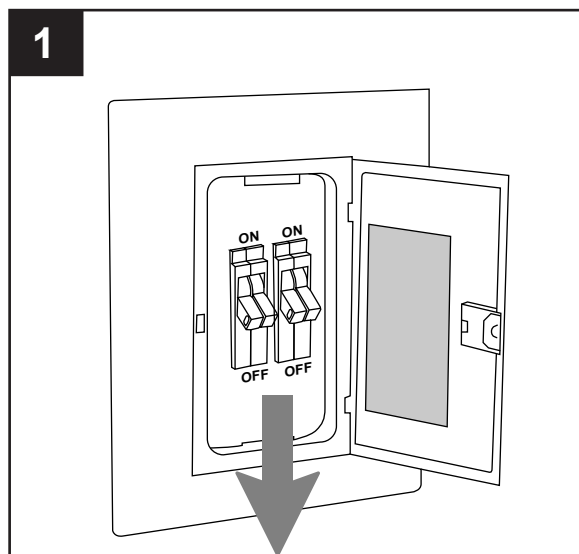

## ASSEMBLY INSTRUCTIONS

- Loosen (but do not remove) mounting strap screws (C) from the edges on the top of fixture (A). Twist mounting strap (B) to remove mounting strap (B) from fixture (A).

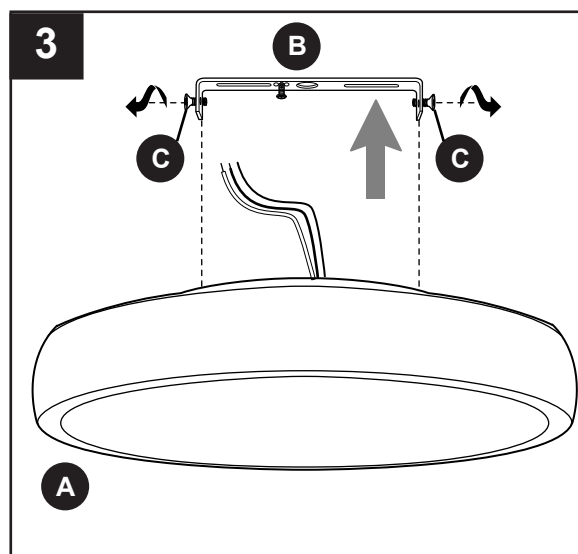

- Attach mounting strap (B) to outlet box (not included) using existing washers and outlet box screws or the machine screws (BB). **NOTE:** If the outlet box screws required for your outlet box are of a different size than the machine screws (BB), consult a licensed electrician before proceeding. Tighten machine screws (BB) to secure mounting strap (B).

**⚠ CAUTION:** Make sure the outlet box can support 35 lbs. hanging weight. Use metal outlet box; plastic outlet boxes are not recommended.

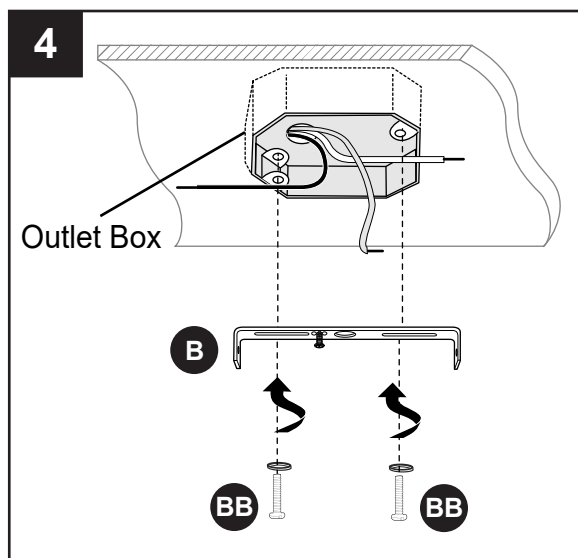

### Hardware Used

**BB** Machine Screw  x 2

## ASSEMBLY INSTRUCTIONS

5. Prepare wire by stripping 1/2 in. of insulation from wire ends using wire strippers (not included).

Unwrap BARE wire from BLACK and WHITE wires. Connect BARE/GREEN ground wire from outlet box to BARE wire from fixture (A) using existing wire connector or wire connector (AA). Connect WHITE wire from fixture (A) to WHITE wire from outlet box using existing wire connector or wire connector (AA). Connect BLACK wire from fixture (A) to BLACK wire from outlet box using existing wire connector or wire connector (AA).

**NOTE:** Screw wire connectors (AA) on in a clockwise direction.

**⚠ WARNING:** Never connect ground wire to WHITE or BLACK power supply wires.

**⚠ WARNING:** To reduce the risk of fire, electrical shock or personal injury, wire connectors (AA) provided with this light fixture are designed to accept only one 12-gauge house wire and two lead wires from the light fixture. If your house wire is larger than 12-gauge or there is more than one house wire to connect to the corresponding fixture lead wires, consult an electrician for the proper size wire connectors to use.

### Hardware Used

AA

Wire Connector

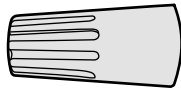

x 3

6. Wrap electrical tape (not included) around each individual wire connector (AA) down to the wire. Push wire connectors (AA) gently back into outlet box. Carefully push excess wiring into outlet box.

**⚠ WARNING:** Make sure no bare wire or wire strands are visible after making connections.

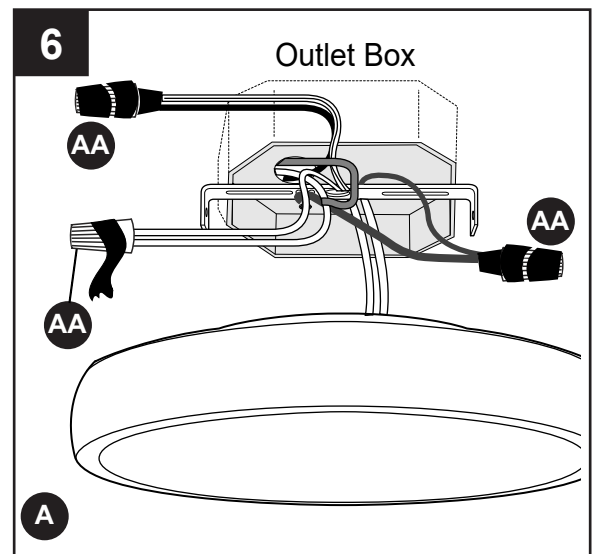
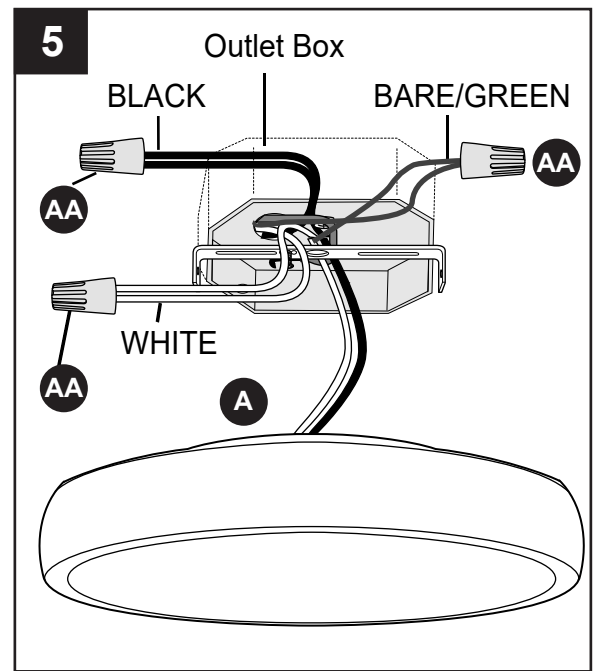

## ASSEMBLY INSTRUCTIONS

- Align loosened mounting strap screws (C) on the mounting strap (B) with notches on fixture (A). Twist mounting strap (B) clockwise until mounting strap (B) locks into place and is secure. Tighten both mounting strap screws (C) securely.

Restore power and test fixture (A) with remote instructions in following page.

If light does not function, please refer to TROUBLESHOOTING on page 10.

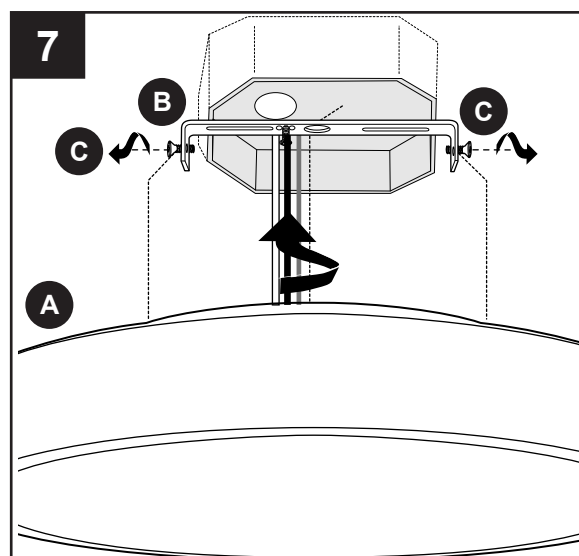

## REMOTE CONTROL OPERATION

- Remove battery cover from back of remote control (D). Install two AAA batteries (not included).

**⚠ WARNING:** Batteries are to be inserted with the correct polarity.

Replace battery cover on remote control (D).

**⚠ WARNING: Choking/Ingestion Hazard -**  
Small parts. Keep batteries away from children.

**NOTE:** Remove batteries with low or no charge and dispose of properly.

**NOTE:** DO NOT mix old and new batteries; DO NOT mix alkaline, standard (carbon - zinc) or rechargeable (nickel - cadmium) batteries or equivalent.

**⚠ CAUTION:** "DO NOT DISPOSE OF BATTERIES IN FIRE, BATTERIES MAY EXPLODE OR LEAK." - When disposing of household alkaline batteries, it is best to check with your local and state recycling or household hazardous waste coordinators concerning the specifics of the program in your area. You may also locate a recycling center by calling 1-800-8-BATTERY or 1-877-2-RECYCLE or visit [www.epa.gov/epawaste/index.htm](http://www.epa.gov/epawaste/index.htm) or [www.earth911.org](http://www.earth911.org) for more information.

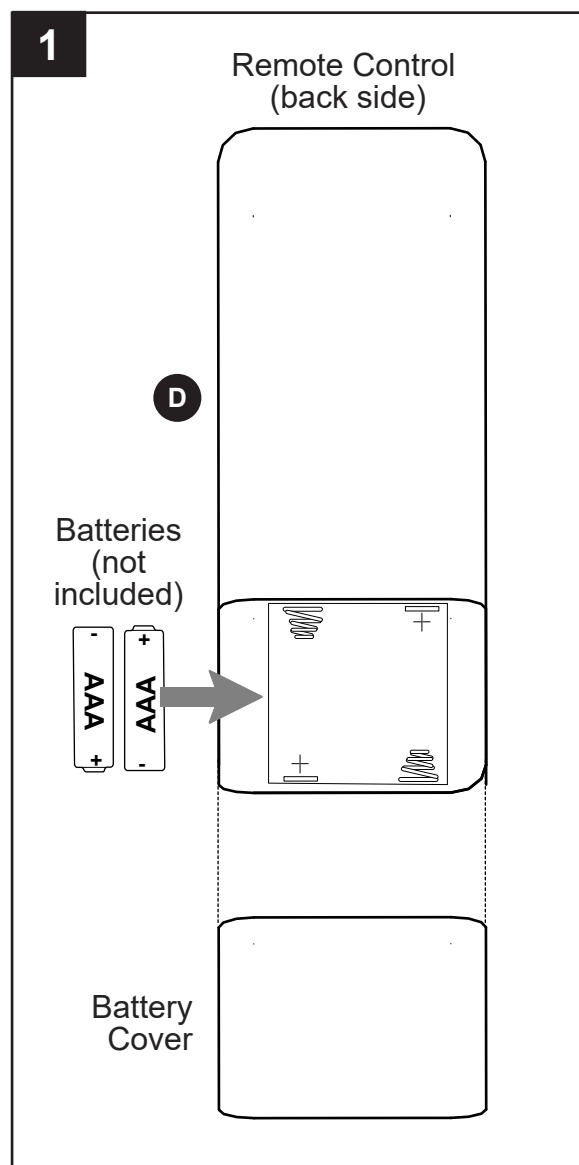



## REMOTE CONTROL OPERATION



2. **NOTE:** The remote control (D) is pre-paired to the fixture (A).  
If you wish to pair one remote to multiple fixtures that are in range, power them both on. Within 30 seconds hold down the “On/Off” button on one remote for 5 seconds. The lights will blink twice to confirm that each fixture has paired to the remote.

If you wish to un-pair a remote from one or both fixtures, power them both on. Within 30 seconds hold down the “RGB On/Off” button for 5 seconds. The lights will blink twice to confirm they have un-paired to the remote.

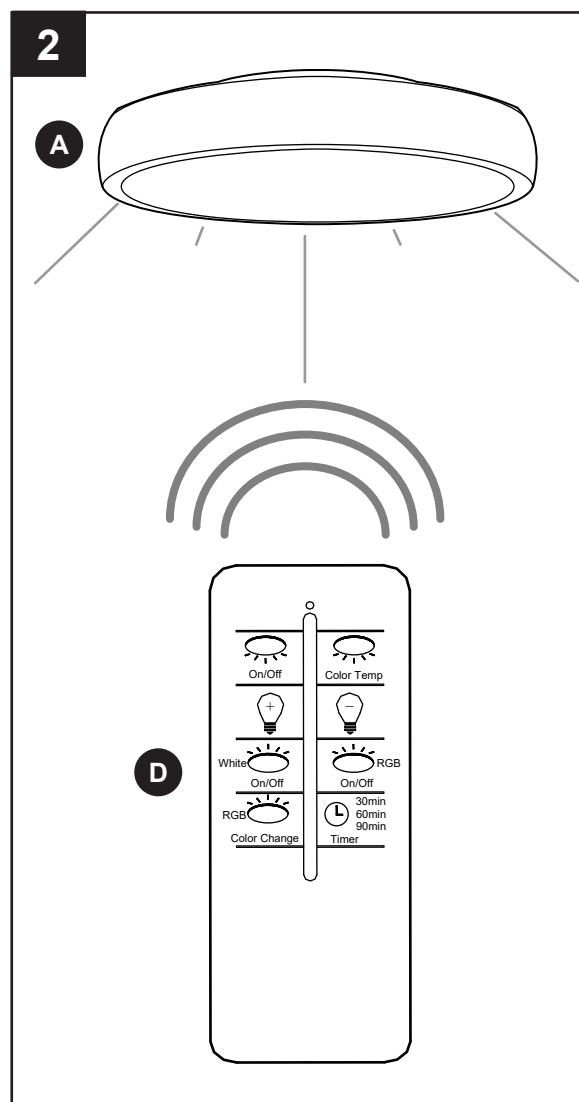
If you wish to pair one remote to one fixture, turn on fixture 1 and hold down the “On/Off” button for 5 seconds within the first 30 seconds on one remote. The light will blink twice to confirm that each fixture has paired to the remote. Then turn on fixture 2 and hold down the “On/Off” button for 5 seconds within the first 30 seconds on the other remote. The light will blink twice to confirm that each fixture has paired to the remote.



## REMOTE CONTROL OPERATION

3. 1 - On/Off button: turns light ON or OFF.
- 2 - Color Temp button: change/select mode:
  - soft white
  - warm white
  - cool white
  - daylight
  - cool daylight
- 3 -  button: increases main light brightness
- 4 -  button: decreases main light brightness
- 5 - White On/Off button: turns night light on/off
- 6 - RGB On/Off button: turns color light on/off
- 7 - RGB Color Change button: changes/select color mode
- 8 - Timer button: timer may be set to turn light on for 30, 60 or 90 minutes

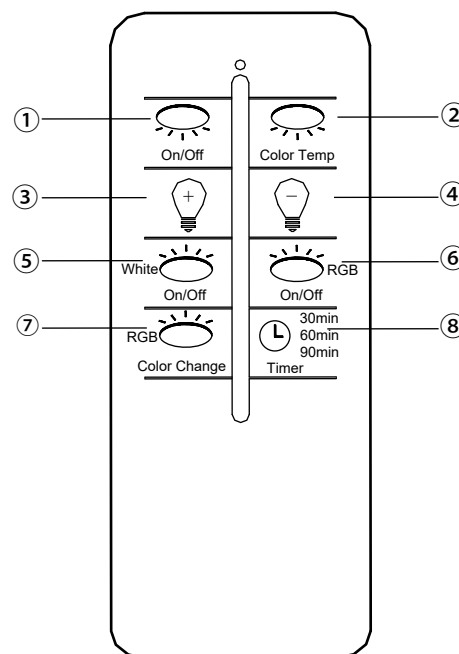

## CARE AND MAINTENANCE

- Shut off main power supply. Wipe fixture with soft cloth. Do not use an abrasive cleaner on fixture.
- Total wattage for this fixture is 18.5 watts; do not attempt to replace the LEDs.

## TROUBLESHOOTING

**⚠ WARNING:** Before beginning work, shut off the power supply to avoid electrical shock.

PROBLEM	POSSIBLE CAUSE	CORRECTIVE ACTION
Light does not come on initially or no longer comes on.	1. Power is OFF. 2. Faulty connection. 3. LED component is not working properly.	1. Make sure power supply is ON. 2. Check wiring and all connections. 3. Contact Customer Service.
Fuse blows out or circuit breaker trips.	1. Crossed wires. 2. Power wire is grounding out.	1. Check wiring. 2. Check all connections.

## WARRANTY

The distributor warrants all of its lighting fixtures against defects in materials and workmanship for five (5) years from the date of purchase. If within this period the product is found to be defective, take a copy of the bill of sale as a proof of purchase and the product in its original carton to the place of purchase. The distributor will, at its option, repair, replace or refund the purchase price to the consumer. All costs of installation and removal of the fixture is the responsibility of the consumer. This warranty does not cover fixtures becoming defective due to misuse, accidental damage or improper handling and/or installation and specifically excludes liability for direct, incidental or consequential damages, improper packaging of returned products and acts of God. As some states do not allow exclusions of limitations on an implied warranty, the above exclusion and limitation may not apply. This warranty gives you specific rights and you may also have other rights which may vary from state to state.