

HILLMAN™ Decorative Sliding Door Hardware

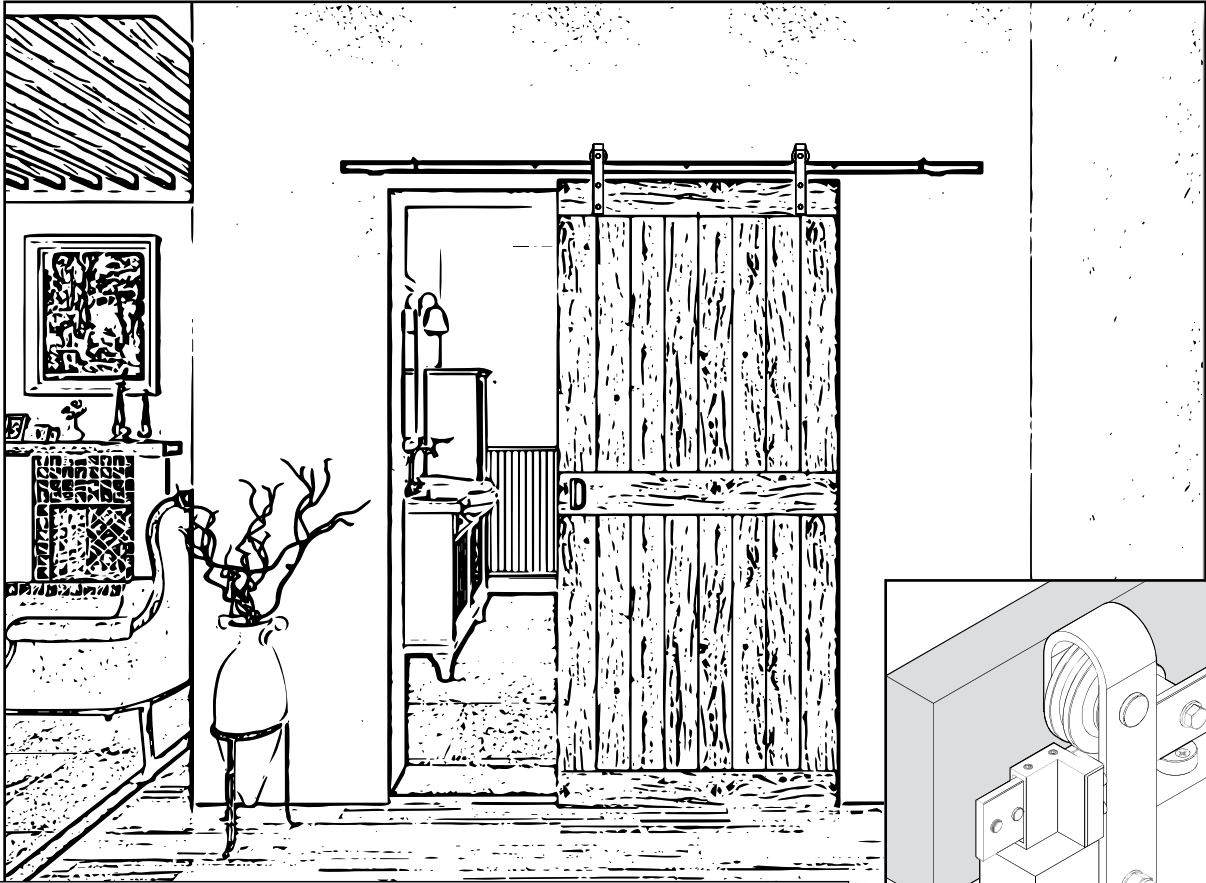

Installation Manual



Tools Required

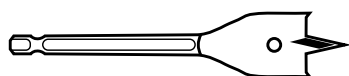
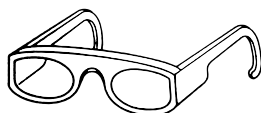
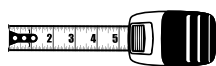
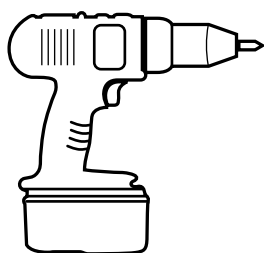

Ø 10 (3/8")



Ø 10 (3/8")



Ø 8 (5/16")



Ø 6 (1/4")



Ø 5 (7/32")

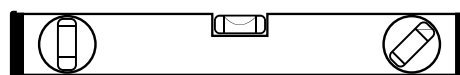
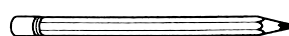
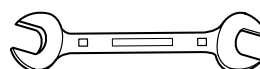
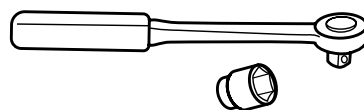

Hardware Included

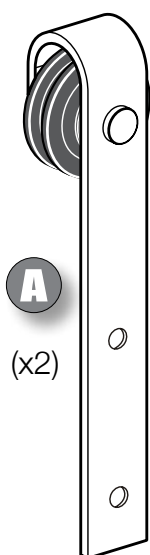

A

(x2)

C (x1)

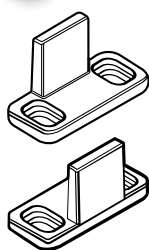

E

(x5)

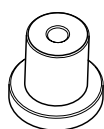

H

(x1)

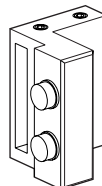

F

(x2)

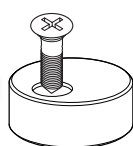

I

(x1)

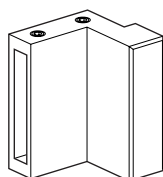

D (x1)

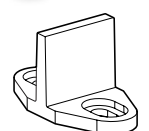

G

(x1)



J

(x4)

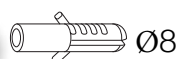

Ø8

B (x1)

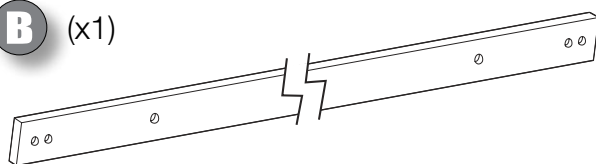

K

(x4)



L

M8x90 (x5)



M

ST4.2x25 (x4)

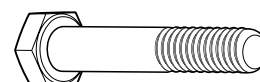

N

M10x60 (x4)
bolts for 1 3/4"
(40-45 mm) door

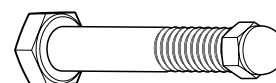

O

M10x55 (x4)
bolts for 1 3/8"
(35-40 mm) door

Required Dimensions

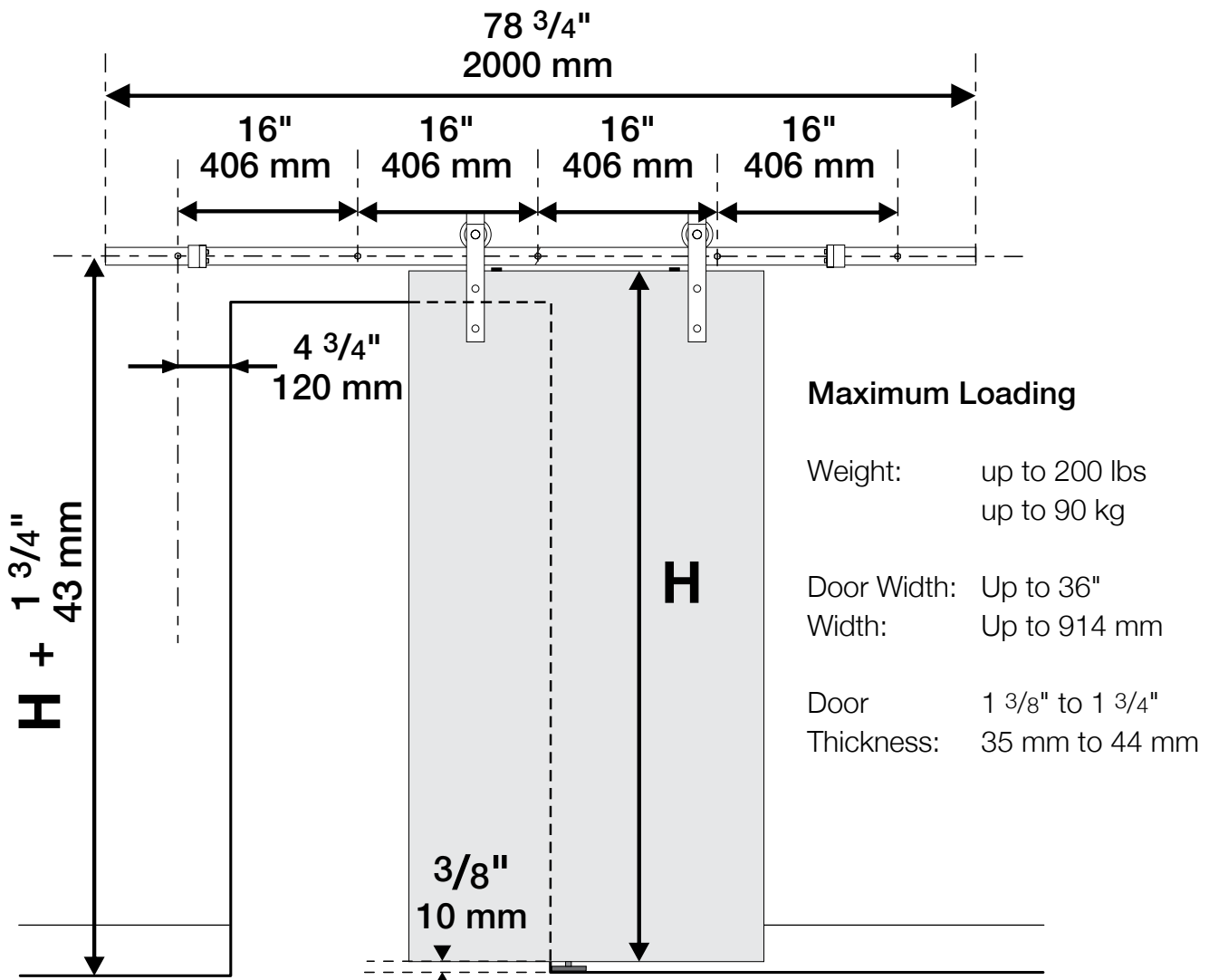

Pre-Installation

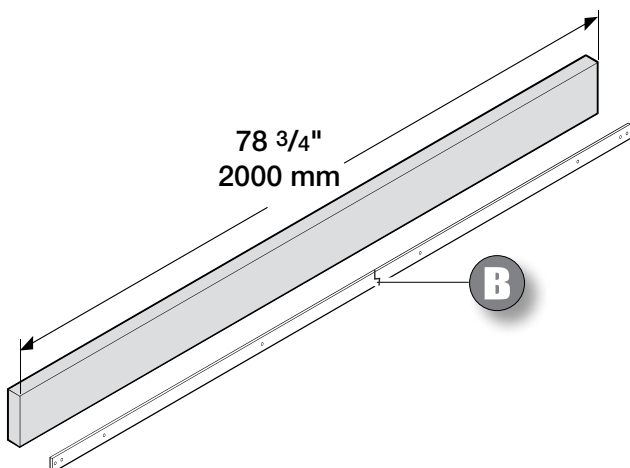

Required Parts (not included)



WARNING: Install a header board above the door opening to secure the rail.

Installation - Step 1

Installing the header board

- Determine the height of your door and position the header board at the desired location above.
- Use a level to ensure the board is even.
- Use interior screws (not included) to secure the header board to the wall studs.

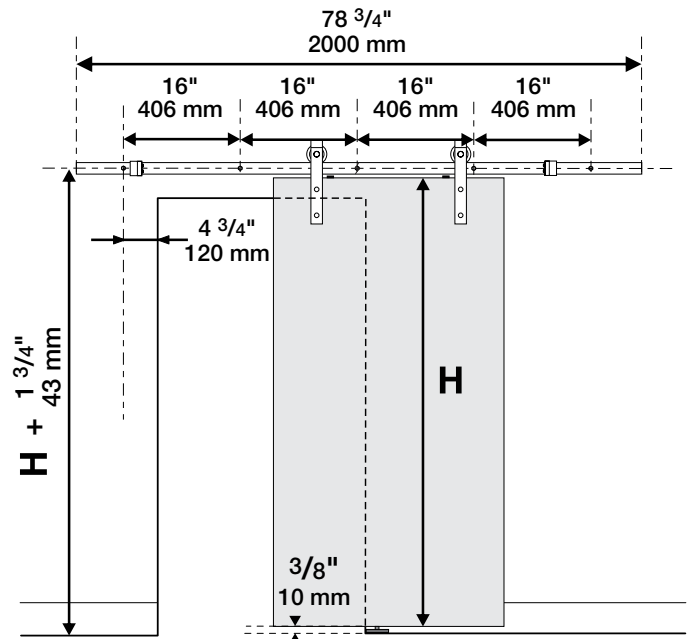

Installation - Step 2

Installing the rail

- Center the rail **B** on the header board using a level and mark the 5 holes.

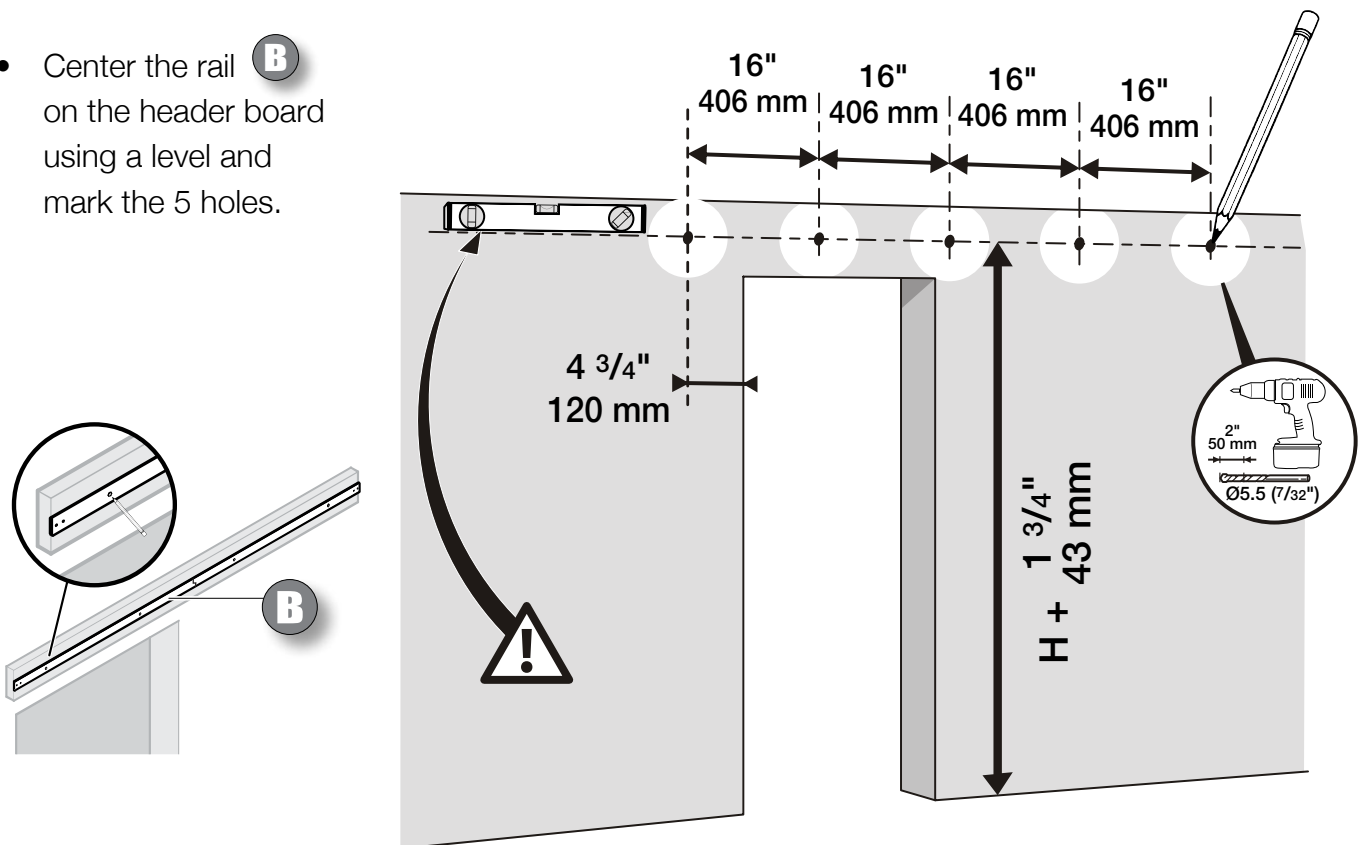

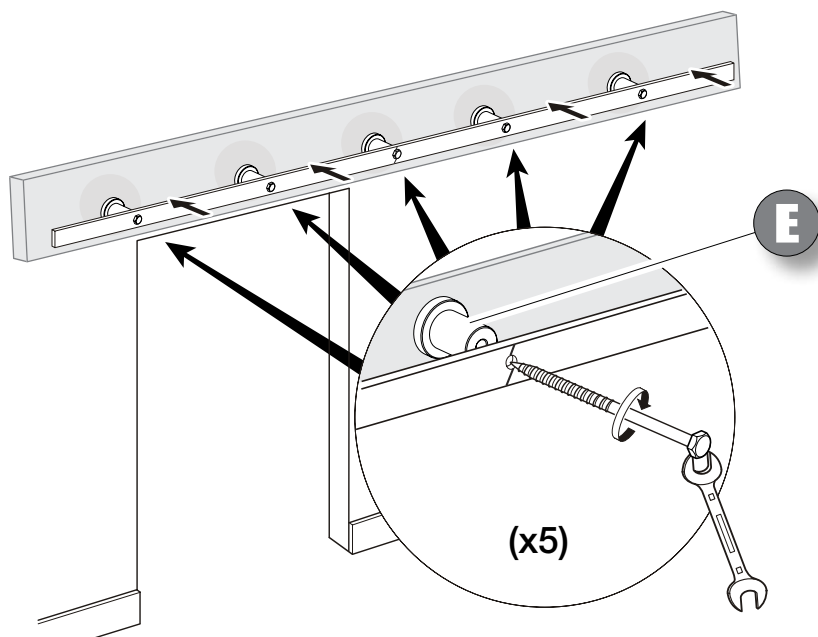

- Snap the two rail **B** pieces together and secure to the header board using the **L** fasteners and spacers **E**. Use the spacers between the rail and the header board.

Installation - Step 3

Installing the Hangers

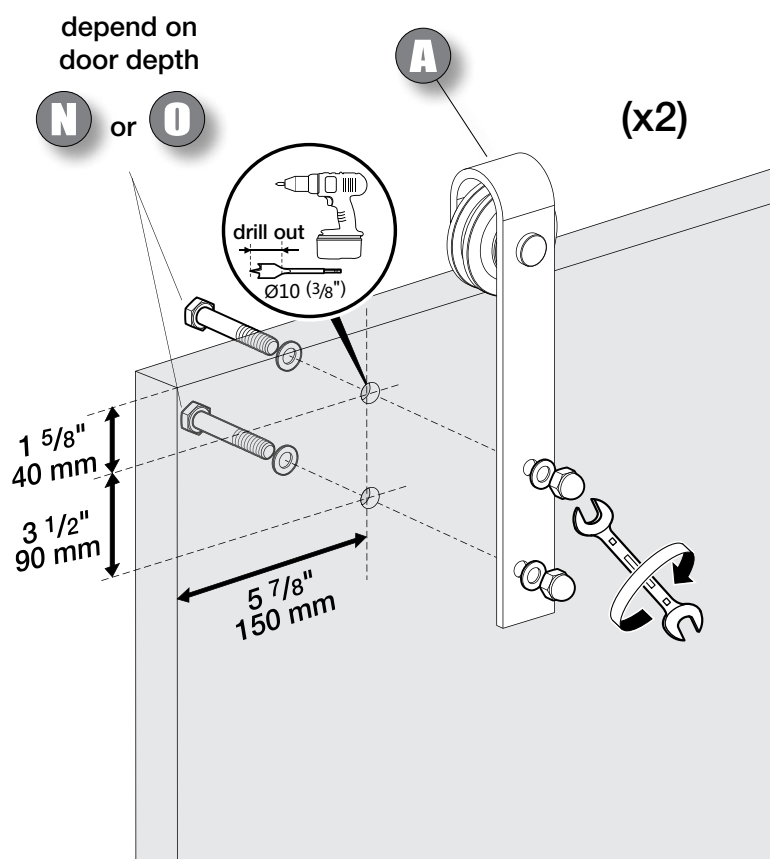

- Measure the holes for the first hanger **A** approximately $5 \frac{7}{8}$ " (150 mm) from the edge of the door and approximately $1 \frac{5}{8}$ " (40 mm) from the top.
- Once holes are determined, mark the door with a pencil and proceed to drill.
- Proceed to install the hanger by first determining the thickness of the door. If the door is approximately $1 \frac{3}{8}$ " (35 mm) thick use the shorter screws **O**. If the door is approximately $1 \frac{3}{4}$ " (44 mm), use the longer screws **N**.
- Repeat the step on the other side for the second hanger.

Installation - Step 4

Installing the anti-jump discs

- Place the anti-jump discs **F** a minimum of 2" (51 mm) away from the inside edge of the hanger on top of the door. The hole of the anti-jump disc should be closer to the front of the door
- Repeat this step on the opposite side

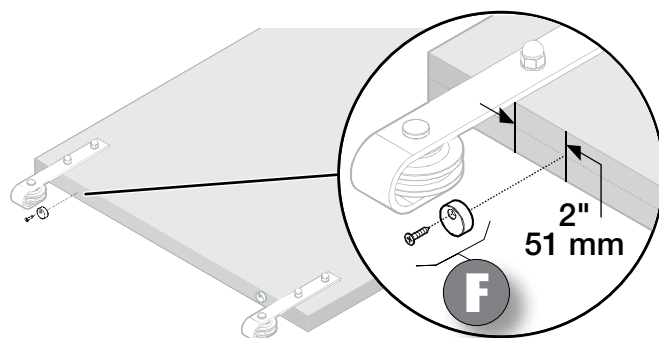
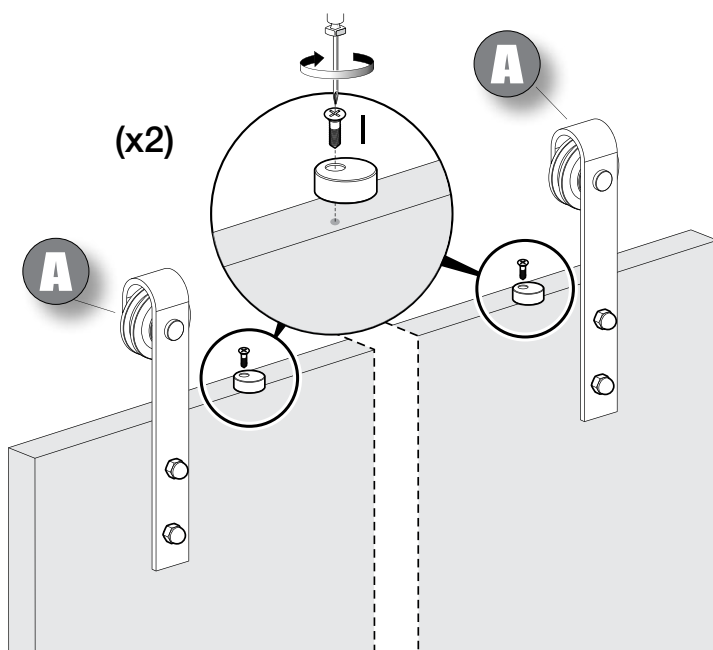

Installation - Step 5

Door Preparation Guide (If required)

- When using the single floor guide **D** ensure the bottom of the door has a mortise groove. If the bottom of the door is not centrally mortised, use a router to complete this task. This will help the door travel smoothly and prevent the door from swinging in and out.

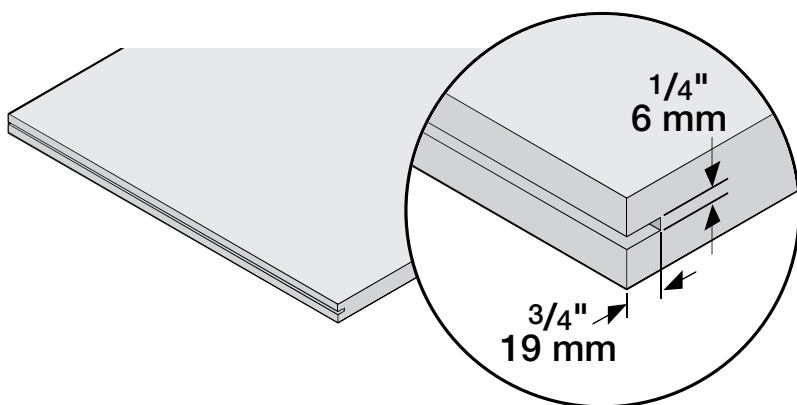
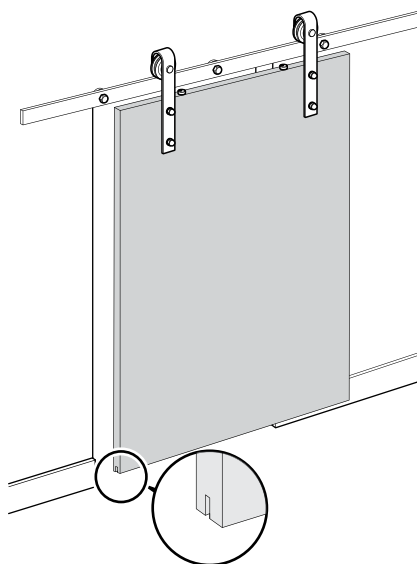

Installation - Step 6

Placing the door on the rail

- Rotate the anti-jump discs **F** out of the way and place the door with hangers installed on the rail. Ensure the door is level on the rail when installed. Test the door by sliding it. Once tested, rotate the anti-jump discs back into the original spot.

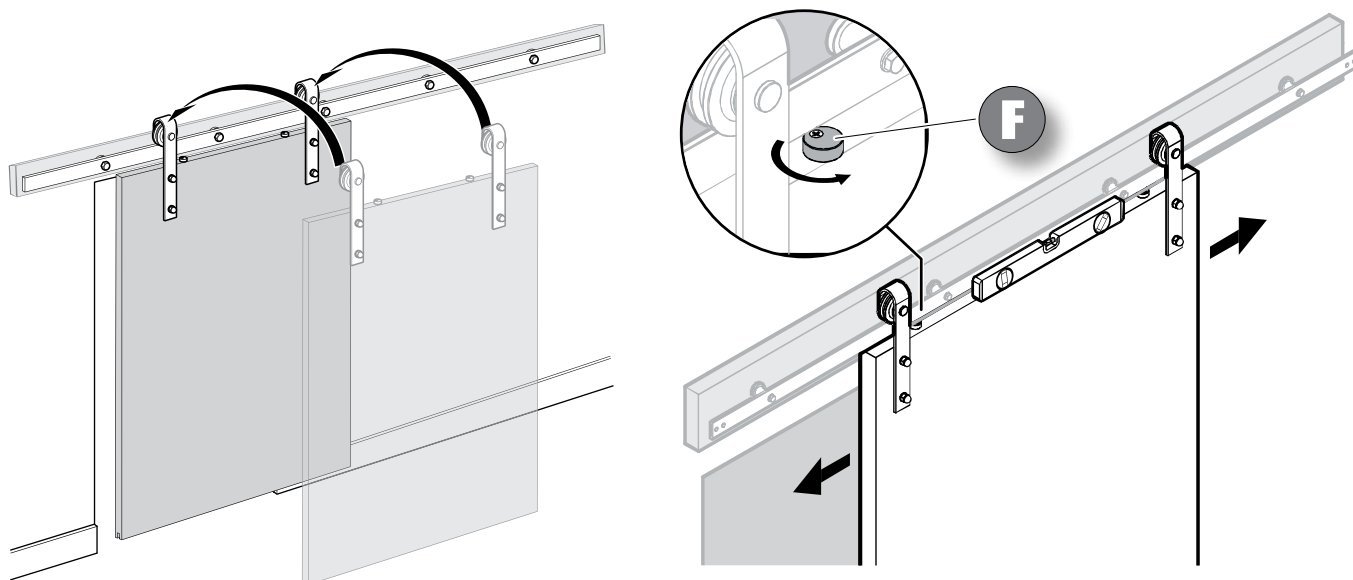

Installation - Step 7

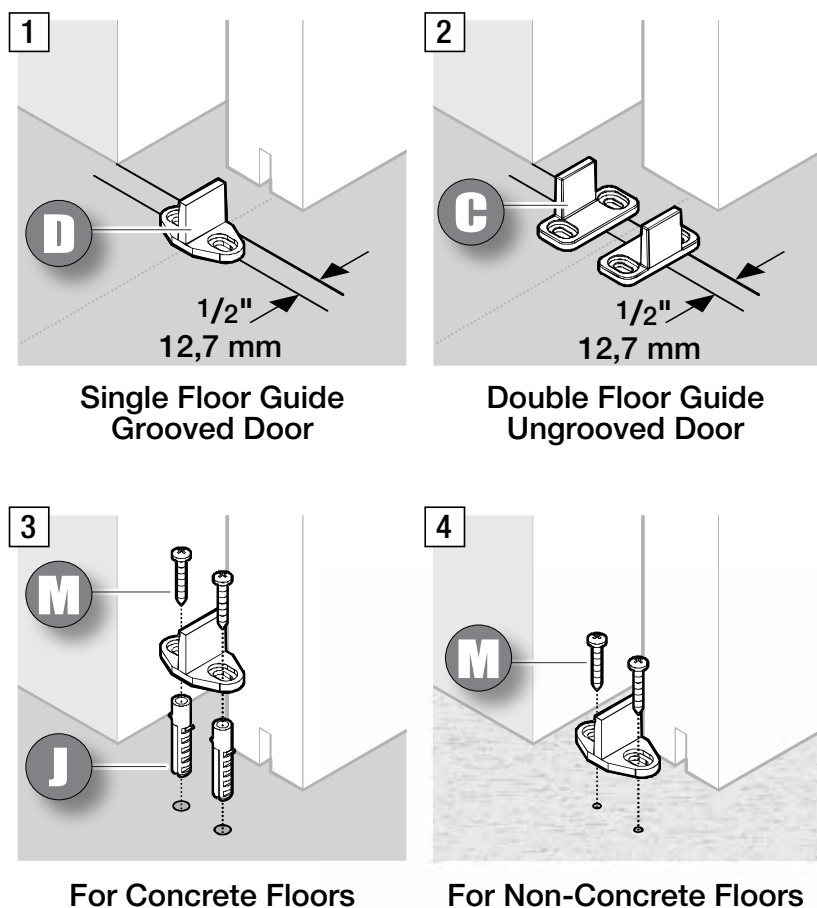

Installing the floor guide(s)

- Slide the door into an open position without it falling off the rail.
- Measure approximately $\frac{1}{2}$ " (12,7mm) from the edge of the opening and center the floor guide(s) on the floor and align with the door.
- Drill holes in the floor and secure the floor guide(s) with fasteners.

Installation - Step 8

Installing the door stops

- Slide the door to the closed position overlapping the opening by 1" (25 mm) on both sides.
- Slide the door stop **H** onto the rail ensuring it touches the hanger. Using the Allen Key **G**, tighten the screws to secure the door stop.
- Move the door to the open position and repeat the same steps for the other door stop **I**.
- Install the hole caps **K** (if needed) in the holes at the end of the rail.

