

**NO
MEASURING
NEEDED!**



Non-Bypass Sliding Barn Door Hardware

Installation Manual



SAFETY PRECAUTIONS

⚠ WARNING!

Power tools can cause serious damage if not professionally used. Safety gear must be worn before and during installation to prevent unexpected injuries.

Pick an area free of hazardous condition before you start on the project. Please use tools and power tools responsibly. Accidents may occur due to abuse of tools.

Please make sure all hardware secured onto the door is sufficiently tight. Doors with loose hardware may result in serious injuries. To avoid any problems, make sure the hardware is secure before door is put on the track.

All hardware provided is for safety reasons. Anti-Jump systems are to prevent doors from falling off of the track while in use. Please follow each instruction carefully. Track must be installed on studs in order to keep the track and doors secure. All safety hardware and instructions included in this project must be used and followed specifically to prevent any serious problems.

!CAUTION!

- **Big objects required in this project are needed to be carefully and responsibly moved. Be sure to wear safety gloves and shoes to prevent any serious injury.**
- **Be extremely careful to not put any parts of your body against a moving part of the hardware. This may cause bruising, punctures, and other results of injuries, for example when fingers are caught in the closing area of the doors.**
- **Precautions should be taken when opening or closing the door(s). Handles should be used when attempting to slide the doors. Always keep you and children aware and safe from any unexpected situations.**
- **Any extreme uncontrolled pressure opening or closing the door(s) can damage the hardware gradually. Use handle(s) to open and close the door(s) with care at all times.**

PRE-INSTALL NOTICE

DOOR THICKNESS

Make sure the door you use is within the thickness of 1-1/4" ~ 1-3/4". If your door is thicker than 2" you will have to add a header board according to how much thicker it is to 2". Let's say your door is 2-1/2" then that is 1/2" more than 2". Then header board thickness should be 1/2" or more. The thicker header you choose the more gap you create between the inner door to the wall. The maximum thickness this hardware kit can go is 1-7/8". We suggest 1-3/4" to be in a safe range. Second to consider is getting different size hex bolts for the front faced rollers since the one provided in the box may only fit the range 1-1/4" ~ 1-3/4". You can search "hex bolt" on our website and select the size and color according to the size chart in the description of the hex bolt.

HEADER BOARD

Header is suggested when the studs do not line up with the track. It is also suggested if you have a door trim and if the door thickness and the door trim added up to be more than 1-3/4".

DRILL BIT SIZES

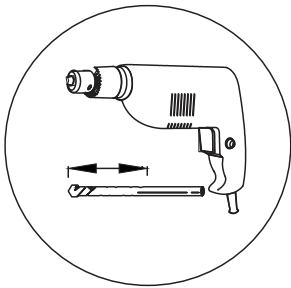

Lag Bolt Drill Bit

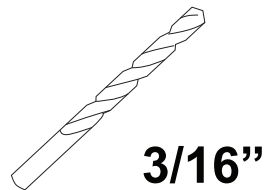

T-shape Anchor Drill Bit

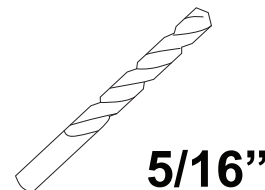

Hex Bolt Drill Bit

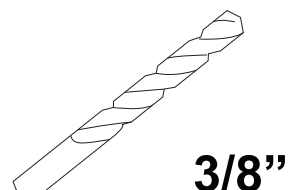

DOOR WEIGHT

This hardware total weight capacity is 220lbs. If all the studs are attached to the track and installed properly the weight capacity may go up to 300lbs maximum in total for all doors combined.

HARDWARE INCLUDED

Different track length comes with different hardware quantity.
Please be sure to check the hardware you should have before installation.

Hanger/Roller Set

Hanger/Roller (2)

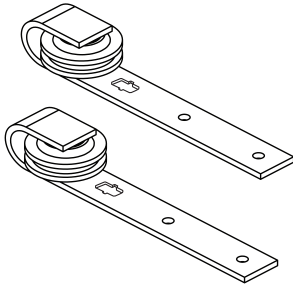

Hex Bolt Set (4)

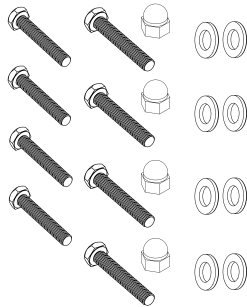

(2") (2.5")

Anti-Jump System (2)

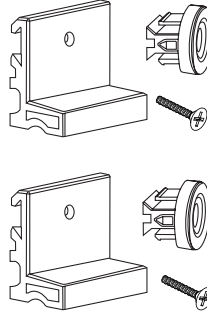

Floor Guide (2)

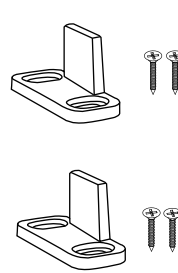

Door Stopper (2), Hex Wrench (1)



Rubber Hole Cover (4)
(for end of track)



Junction Plate

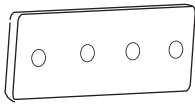

Please check the Hardware Checklist below, for this item you may not need any.

Spacer Set

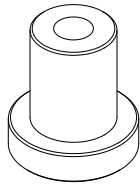

Spacer (1)

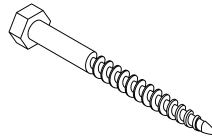

Lag Bolt (1)



Washer (1)

Flat Track

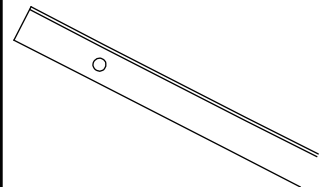

HARDWARE CHECKLIST

Track Measurement	Hanger/Roller Set for Single Door Kit	Hanger/Roller Set for Double Door Kit	Flat Track	Spacer Set	Junction Plate
4FT	1	2	1	3	0
4.5FT	1	2	1	3	0
5FT	1	2	1	4	0
5.5FT	1	2	1	4	0
6FT	1	2	1	5	0
6.6FT	1	2	1	5	0
7FT	1	2	1	5	0
7.5FT	1	2	1	6	0
8FT	1	2	1	6	0
9FT	1	2	2	6	1
10FT	1	2	2	8	1
11FT	1	2	2	8	1
12FT	1	2	2	10	1
13FT	1	2	2	10	1
14FT	1	2	2	10	1
15FT	1	2	2	12	1
16FT	1	2	2	12	1
18FT	1	2	3	15	2
20FT	1	2	3	15	2

TYPE OF HANGERS

Please follow the measurement stated below, measuring from the top of the door to the center of the first hole.

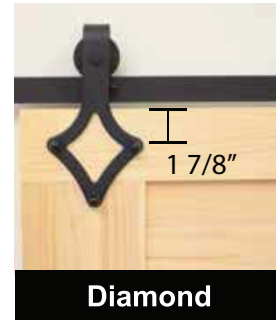

If you purchased the T-shape roller design, please refer to the below checklist for cross checking all the hardware in your roller set box.



Follow step-1 to step-3 for installing the track; then jump to page 12 for mounting the T-shape roller; follow the rest of the manual to finish the installation.

T-Shape Hanger/Roller Set

Steel Hanger/Roller (4)

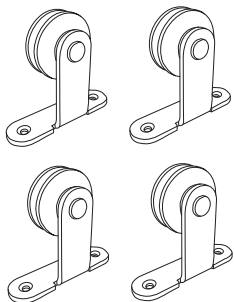

Screw (8), Anchor (8), Hex Wrench (2)

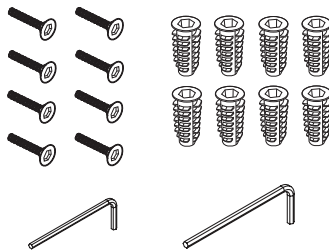

Anti-Jump Pad (4), Floor Guide (2)

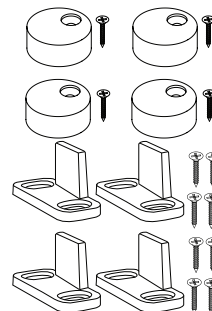

Door Stopper (4), Hex Wrench (2)

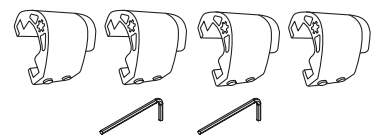

Rubber Hole Cover (4)
(for end of track)



ADJUSTABLE SPACER SET

Different track length comes with different hardware quantity.
Please be sure to check the hardware you should have before installation.

Adjustable Spacer Set

Each adjustable spacer set comes with one of each below.
Quantity below depends on how many sets you have ordered.

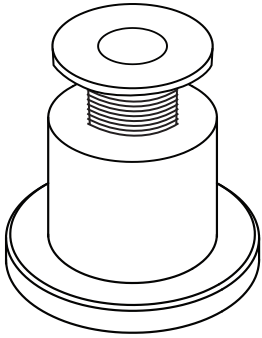

Adjustable Spacer (1)

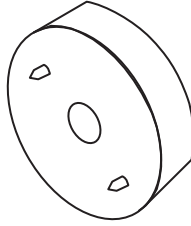

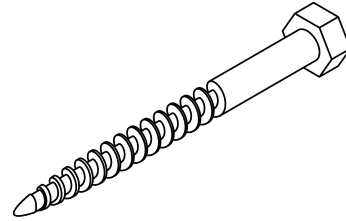

Extension Cap (1)



Lag Bolt (1)

Washer (1)

Types of Door thickness Chart

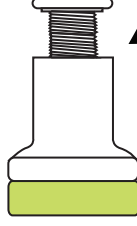
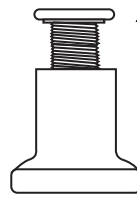
Ways Adjustable Spacer are assembled	Retract 	Retract 	Extend 	Extend 
Height of Spacer	1in	1-3/8in	1-13/16in	1-1/2in
Max Door Thickness	$\leq 1-5/8$ in	≤ 2 in	$\leq 2-7/16$ in	$\leq 2-1/8$ in

If you have a door trim, please add the trim's thickness into your door thickness according to the below formula:

For example: your door is 1-3/8" in and your trim is 1/2", then you should add them together and use the sum as the "door thickness" that we refer in the below pictures!

E.g: For Door Thickness 1-1/8in + trim thickness 1/2in = 1-5/8in, this is $\leq 1-5/8$ ", so you should adjust the spacer set like this according to our previous chart!

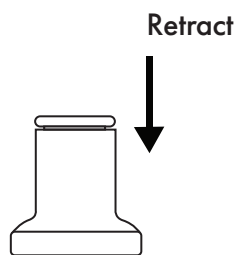

INSTRUCTIONS

For
Door Thickness

1-1/8in ~ 2-7/16in

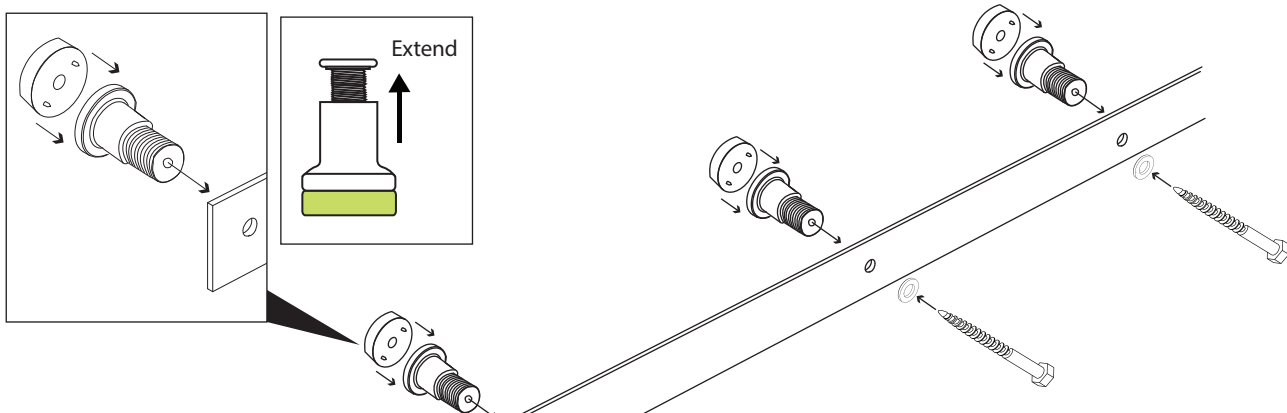

For
Door Thickness

1-1/8in ~ 2-1/8in

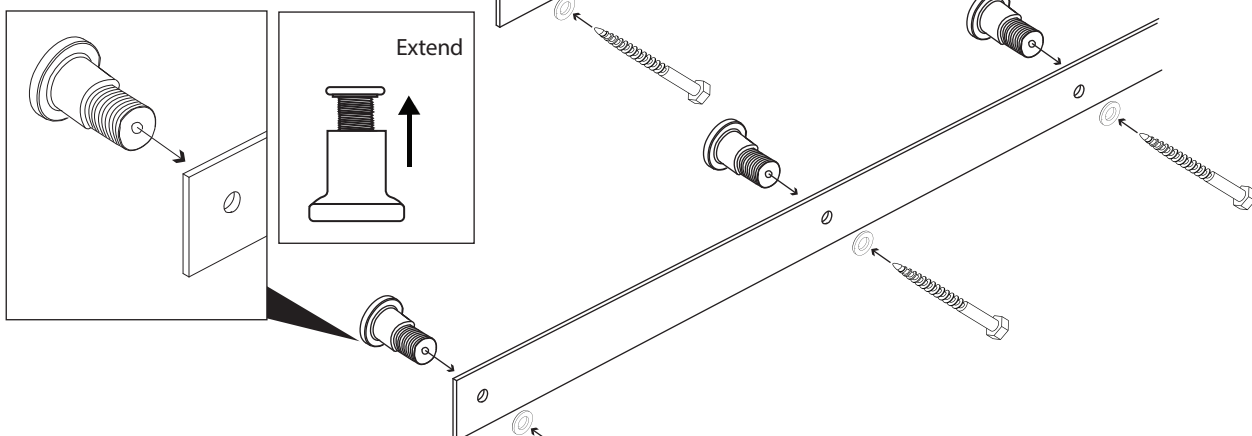

For
Door Thickness

1-1/8in ~ 2in

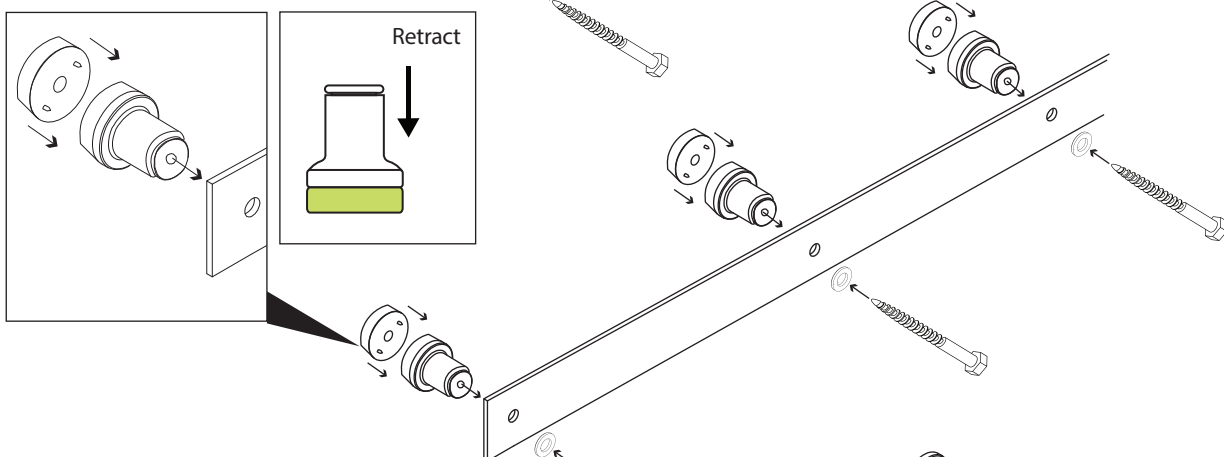

For
Door Thickness

1-1/8in ~ 1-5/8in

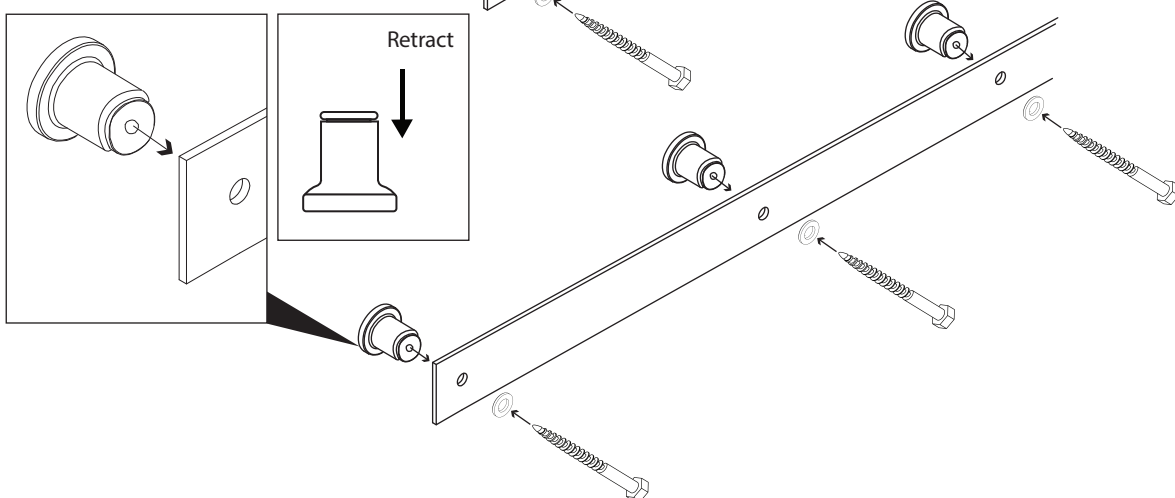

INSTRUCTIONS

REMINDER: Please check the formula on page if you have a door trim or if your door is on the thicker side; please adjust the adjustable spacer set accordingly to accommodate your space!

Drawing the horizontal reference line:

Place your door in your open space. Position the C-shape door stopper on top of the door (like shown), then draw a horizontal line on top of the stopper. This line will be the center line for your track's mounting holes.

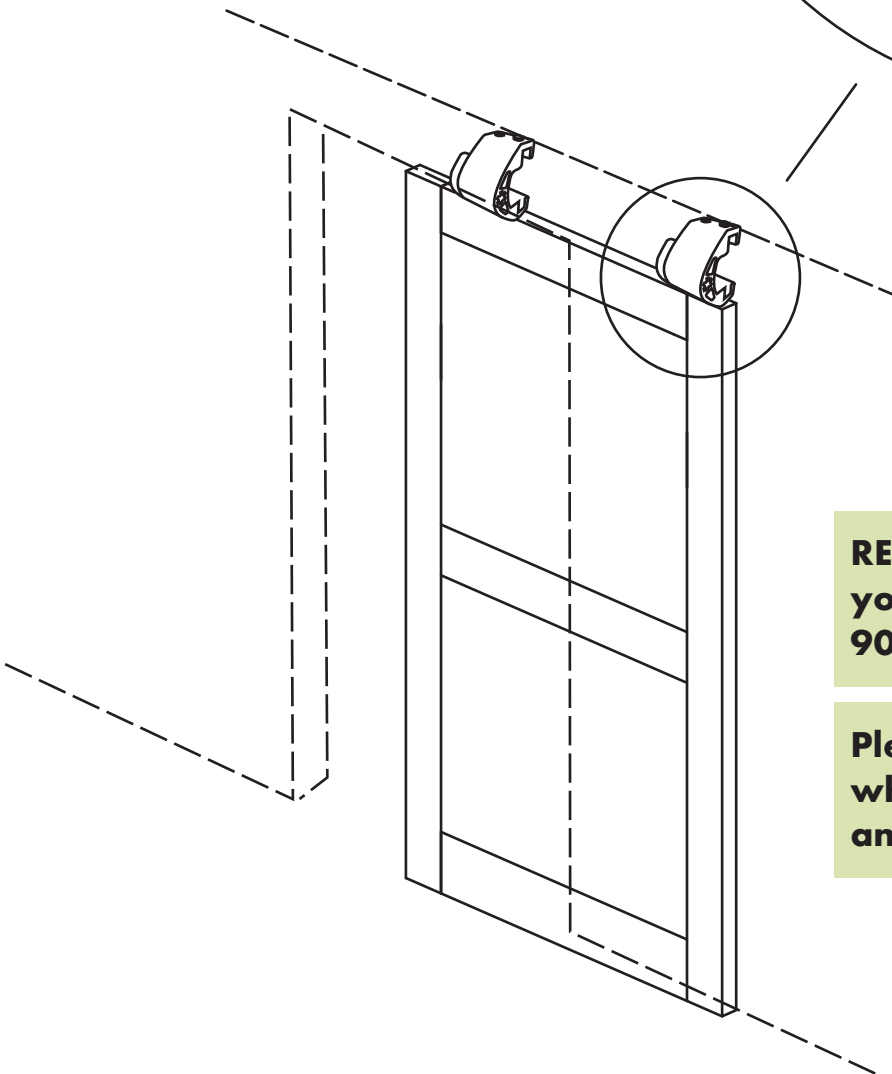
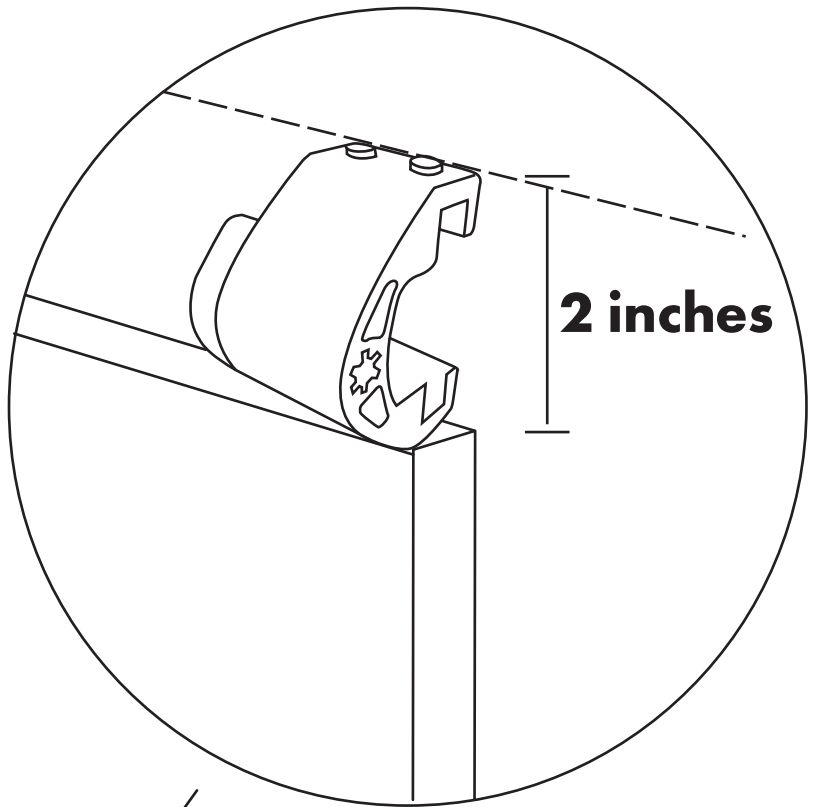

REMINDER: Please make sure your door is positioned at a 90-degree angle to the floor.

Please be careful at all times while moving your door to avoid any possible injuries.

Step-1

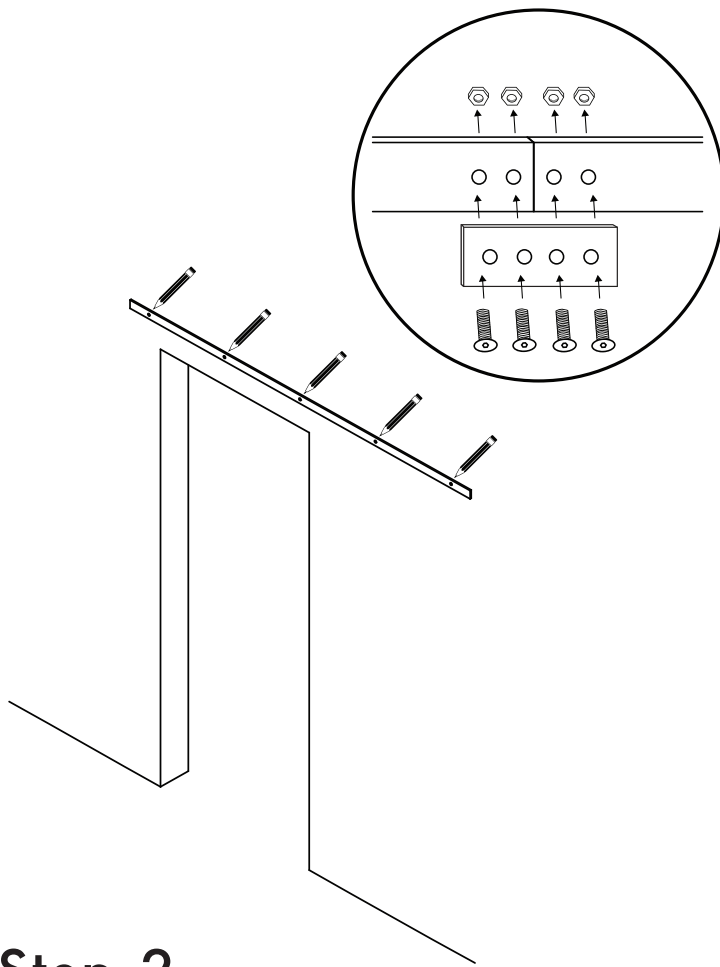

If your track comes in 2 pieces or more, install the junction plate onto each 2 tracks (like the diagram shown here).

Find all the studs, lay the track on the wall, align the center line of your track horizontally with the previously drawn line, ensure each hole is on a stud, and mark the hole positions.

Step-2

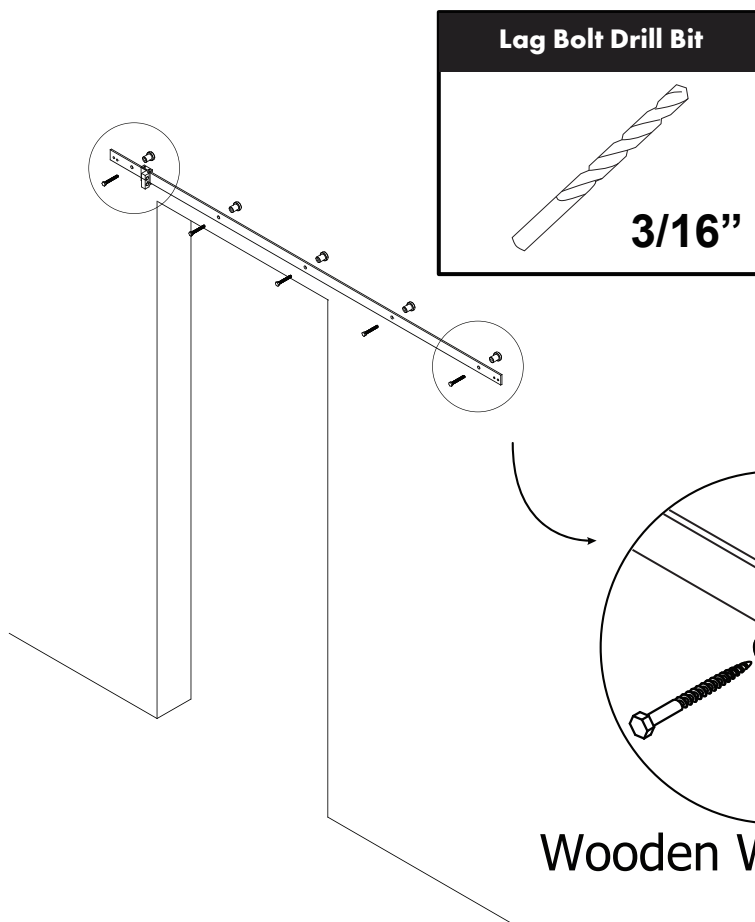

Lag Bolt Drill Bit

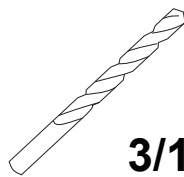

3/16"

Drill the previously marked holes and install the lag bolt and spacer onto the first hole and the last hole first as show in the picture. Repeat the same process for the remaining holes.

CAUTION: Do not over tighten when installing the track on any drywall surfaces or you may damage your drywall.

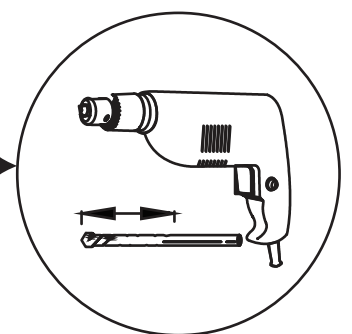
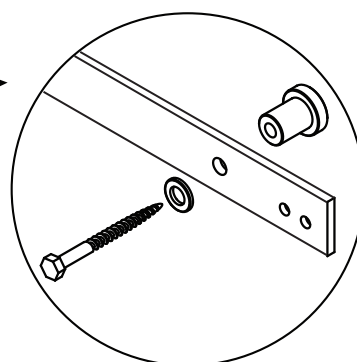

Wooden Wall/Drywall

Step-3

**Roller Installation instructions
(NO MEASUREMENT NEEDED):**

1. Place ① into the square slot on the roller.
2. Slide ② onto the back of ①

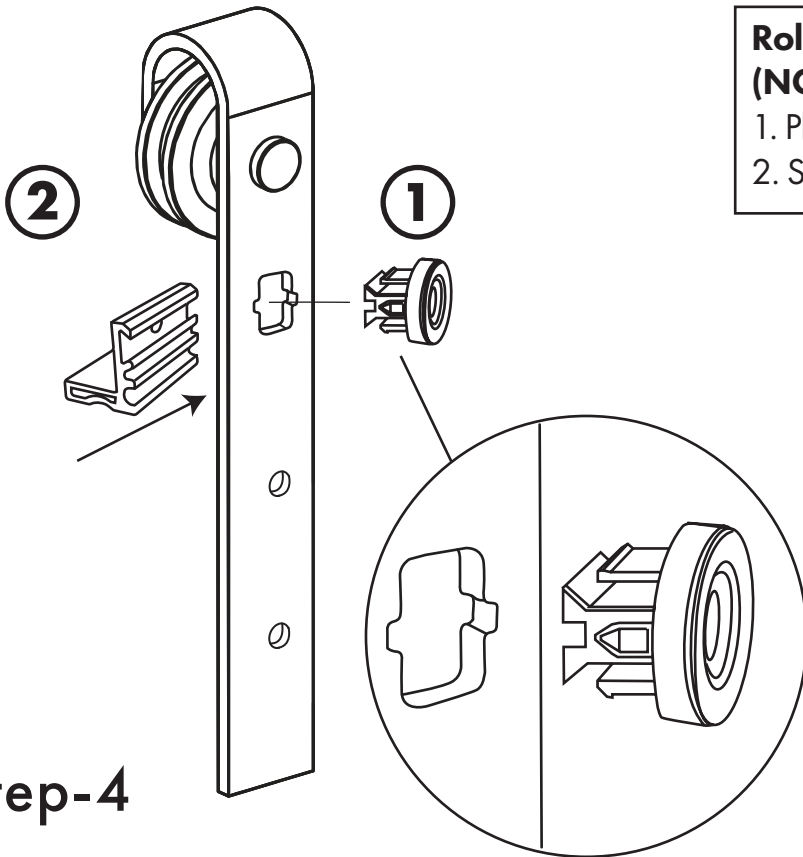

IMPORTANT:
PLEASE KEEP ② UPRIGHT LIKE SHOWN IN PICTURE WHEN INSERTING INTO THE SQUARE SLOT, OR YOU MAY DAMAGE THE PART.

Step-4

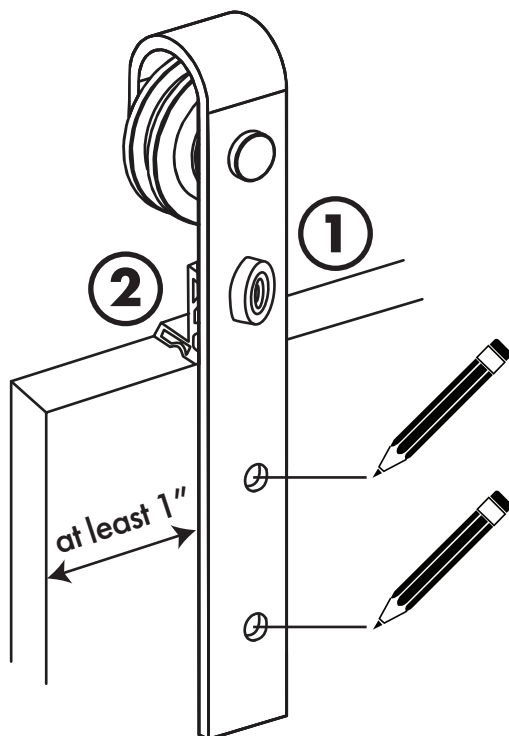

cont.

3. Place the roller with the anti-jump system on top of your door (make sure the bottom flat part of ② is on top of the door). The distance between the side edge of the door and the hanger should at least be 1" to prevent any damage to your doors. Then draw the drill holes onto your door.

Step-5

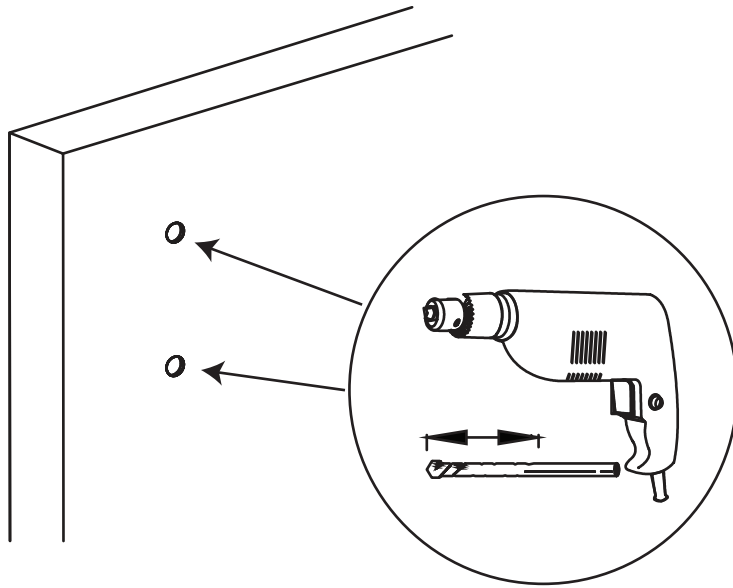

Step-6

Hex Bolt Drill Bit

Drill Bit

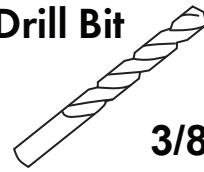

3/8"

cont.

4. Take your roller off of your door. Drill the holes for the hanger according to your previously drawn holes from step-5.

WARNING:

REMEMBER NOT TO DRILL HOLES INTO YOUR DOOR WHILE THE ROLLER IS STILL ON THE DOOR.

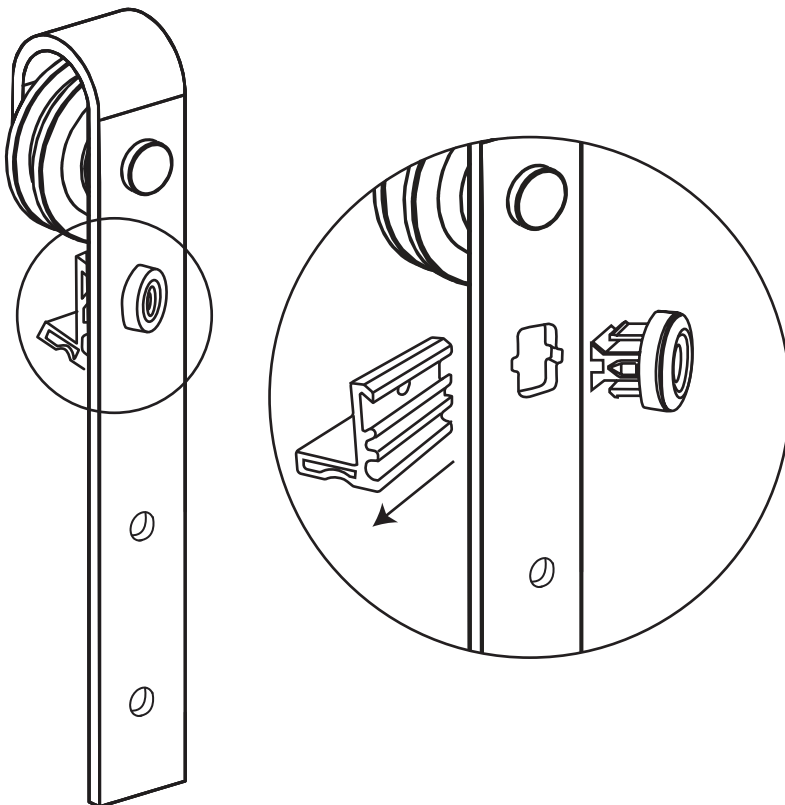

Step-7

IMPORTANT:

Please remember to take your anti-jump system off of your rollers before mounting your roller onto your door.

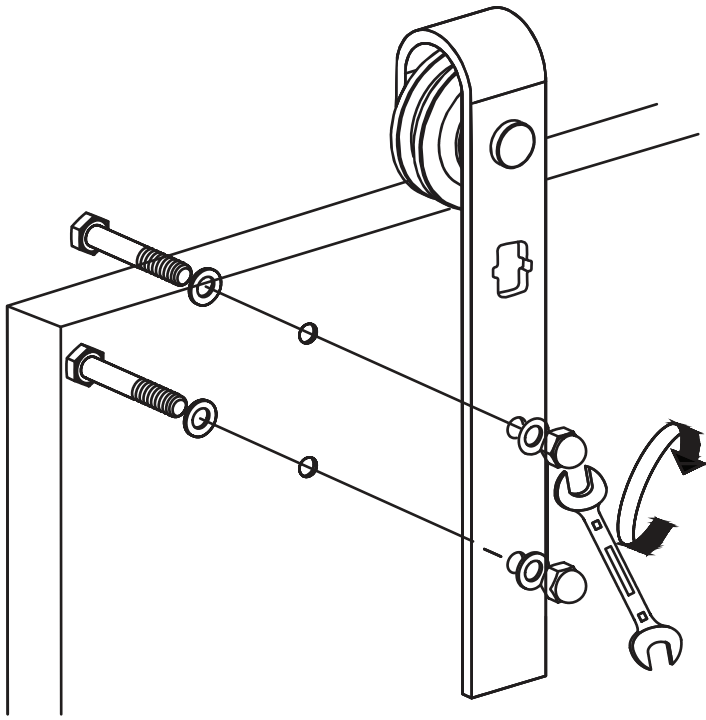

cont.

5. Finally, mount the roller onto your door by installing the hex bolts and the acorn nuts.

WARNING:

PLEASE DO NOT USE A POWER DRILL FOR THESE BOLTS

Step-8

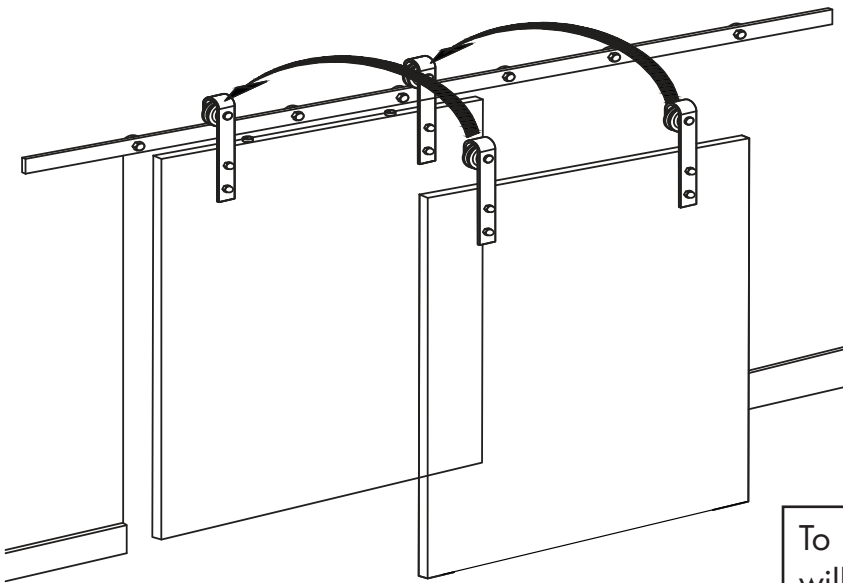

To mount your doors onto the track, you will have to lift your door at a slight angle and rest both wheel grooves onto the top of the track carefully.

Step-9

If you do not have the T-shape roller, please jump to the next page.
!!! This page is for T-shape roller ONLY !!!

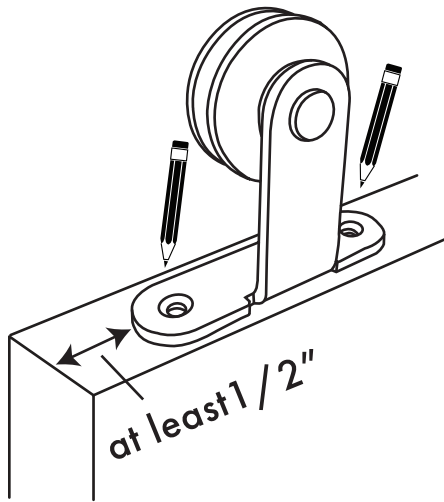

Roller Installation instructions

1. Place the T-shape roller onto the top of your door, the edge of the roller must be at least $1/2''$ away from the edge of your door; the roller should be placed at the center of the door thickness.
2. Use a pencil to draw the drill holes according to how the roller is placed.

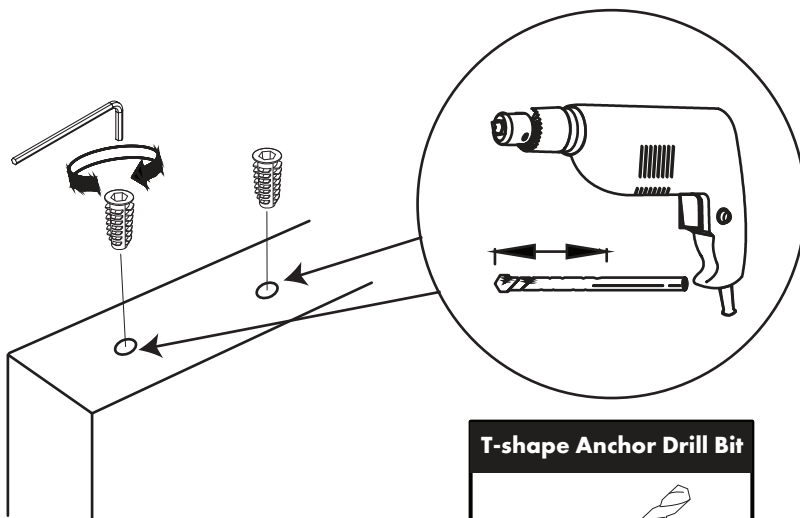

T-shape Anchor Drill Bit

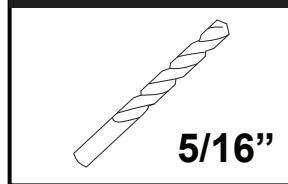

cont.

3. Take your roller off of your door. Drill the holes for the hanger according to your previously drawn holes.
4. Use the biggest hex wrench to screw the anchor into the holes you just drilled.

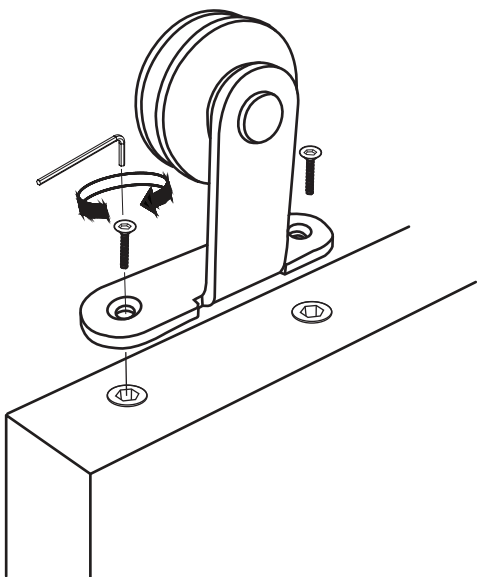

cont.

5. Finally, put your roller back onto the top of your door. Use the medium size hex wrench to add the screws into the anchor and lock it in tightly.

ANTI-JUMP SYSTEM

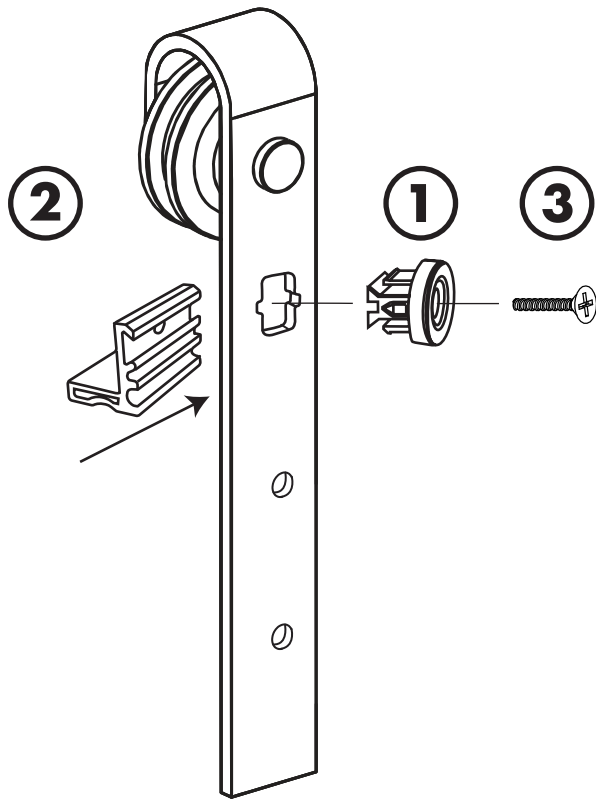

IMPORTANT:

After hanging your door to the track, please remember to add the anti-jump system back onto your roller by repeating step-4.

Then, insert the screw into the hole and tighten it by using a screw-driver.

(ATTN: DO NOT USE A POWER DRILL AS IT WILL DAMAGE THE PLASTIC PART.)

Step-10

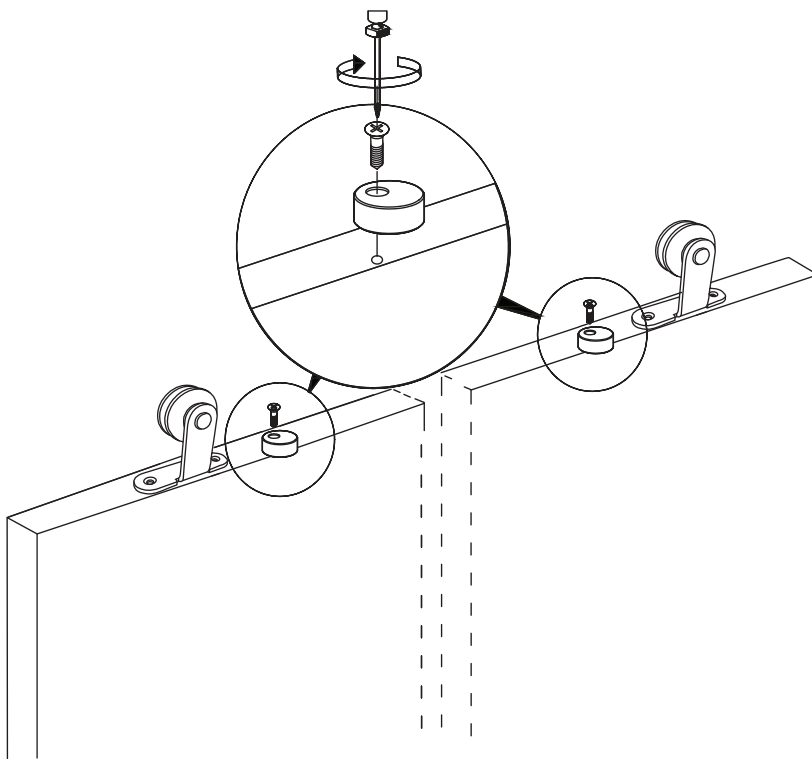

Install the anti-jump pads on top of the doors as shown on the picture, it is suggested to mount them right below the track.

This step is only for T-shape design rollers, please disregard this step if you have any other kind of roller design!

T-shape design only Step-10

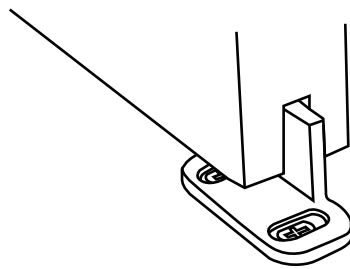

Groove Door

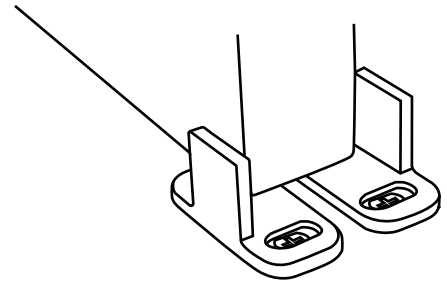

Non-Groove Door

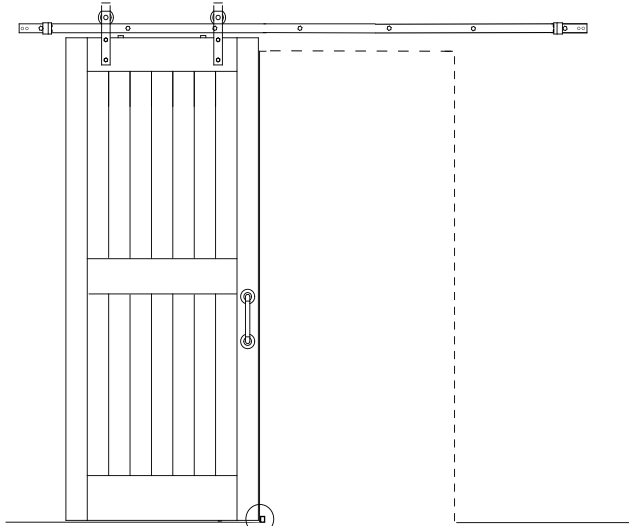

Our preferred location of the floor guide

Install the floor guide on the edge of the opening where the door sits or slides over to. Here above is a diagram of the 2 ways you can use our given floor guide in the hardware kit.

If you are looking for different floor guides please check out our website. Type in "Floor Guide" in the search bar and you will be able to find different designs.

Step-11

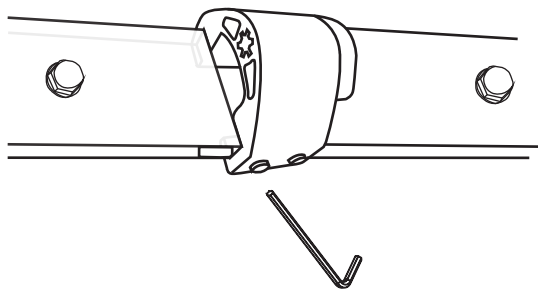

Step-12 Turn clockwise

Install the door stoppers on each end of the track, like shown in diagram with hex wrench.

This door stopper is adjustable. You can change its position however you like by just sliding it on the track and tightening it where you need it to be. It slides over all lag bolt head.

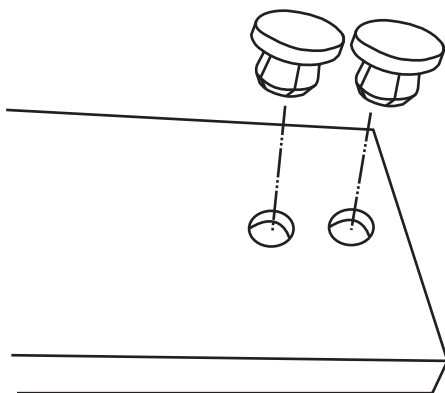

Step-13

Finally, you can place the rubber covers onto the holes at the end of your track if you want to cover them up.

Feel free to place these from the backside of your track if you want a less conspicuous look!

YOUR INSTALLATION IS COMPLETE!



SLIDING HARDWARE / BARN DOORS

High Quality • Exquisite Design • Outstanding Services

ABOUT US

At Homacer, our goal is to provide the finest sliding barn door hardware products and services for our valued customers. We keep polishing our products to make their quality better, prices lower and installation easier. We make it possible for you to get everything you need from us when you think about installing sliding barn doors.

CONTACT US

Bulk Membership Program

To learn more about bulk / dropship order program you may contact us at

Office #: 1(770)-559-5849

Website: www.homacer.com/pages/membership-program

Email us: sales@homacer.com

CUSTOMER SERVICE TECH SUPPORT

Office #: 1(770) 864-5437

Website: www.homacer.com

Email us: info@homacer.com

LOCATION

1885 Beaver Ridge Cir, Ste A
Norcross, GA 30071

For additional hardware and accessories such as floor guide, soft close, and door handles, they can all be found on our website at www.homacer.com. If you have any other inquiries you can always contact us through phone or emails.