



Harbor Breeze® is a registered trademark of LF, LLC.
All rights reserved.

ITEM #0745364
**CEILING FAN
WALL CONTROL**

MODEL #41177

ATTACH YOUR RECEIPT HERE

Serial Number _____

Purchase Date _____

Questions? Call our customer service department
at 1-800-643-0067, 8 a.m. - 6 p.m., EST, Monday -
Thursday, 8 a.m. - 5 p.m., EST, Friday.

PACKAGE CONTENTS

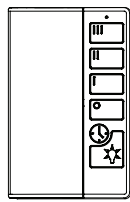

A

Wall Control
Qty. 1

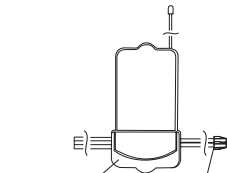

B

Receiver
Qty. 1

C

Push-on
Connector
Qty. 2



D

Battery
Qty. 1



E

Decor
Plate
Qty. 1

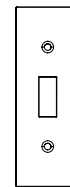

F

Standard
Plate
Qty. 1

HARDWARE CONTENTS



AA

Wire Connector
Qty. 3



BB

Plate Screw
Qty. 2

PREPARATION

Tools required for assembly (not included): Electrical Tape and Phillips Screwdriver

SAFETY INFORMATION

Read instructions completely before installing the remote.

⚠ WARNING: If the color of the household supply wires is different than what is referred to in the instructions below, a professional electrician should determine proper wiring.

CAUTION:

- Do not install in damp locations. For indoor use only.
- Do not use with fans that have integrated remote controls.
- Be sure the outlet box is properly grounded or that a green or bare (ground) wire is present.
- This unit is intended to control a ceiling fan with electrical source of AC 110/120V, 60Hz.
- To reduce the risk of fire or electric shock, do NOT use a full-range dimmer switch to control the fan speed.
- This equipment has been tested and found to comply with the limits for a Class B digital device, pursuant to Part 15 of the FCC Rules. These limits are designed to provide reasonable protection against harmful interference in a residential installation. This equipment generates, uses and can radiate radio frequency energy and, if not installed and used in accordance with the instructions, may cause harmful interference to radio communications.

However, there is no guarantee that interference will not occur in a particular installation. If this equipment does cause harmful interference to radio or television reception, which can be determined by turning the equipment off and on, the user is encouraged to try to correct the interference by one or more of the following measures: Reorient or relocate the receiving antenna. --Increase the separation between the equipment and receiver. --Connect the equipment into an outlet on a circuit different from that to which the receiver is connected. --Consult the dealer or an experienced radio/TV technician for help. Any changes or modifications not expressly approved by the grantee of this device could void the user's authority to operate the equipment. FCC ID: KUJCE 10409

XXXXXX

ASSEMBLY INSTRUCTIONS

1. Use existing pull chains on the desired fan to set fan speed to high and to turn the light on.

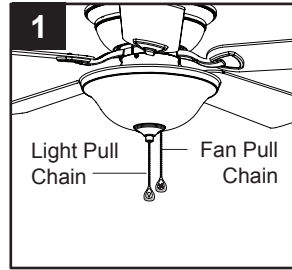

2. Turn off circuit breakers and wall switch to the fan.

⚠ DANGER: Failure to disconnect power supply prior to installation may result in serious injury or death.

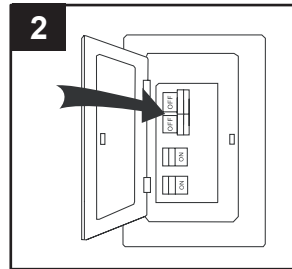

3. Lower the canopy of the previously assembled fan and insert receiver (B). **Note:** If installing this product with a new fan, insert the receiver (B) in the mounting bracket before wiring the fan; wire the fan according to these instructions, then continue fan assembly as directed in the fan's instruction manual.

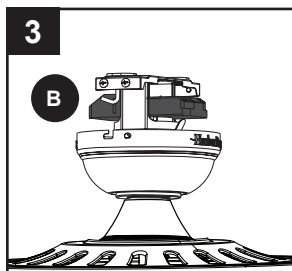

4. Disconnect existing wire connections, then secure all wire connections with wire connectors (AA) and push-on connectors (C) according to diagram and these steps:

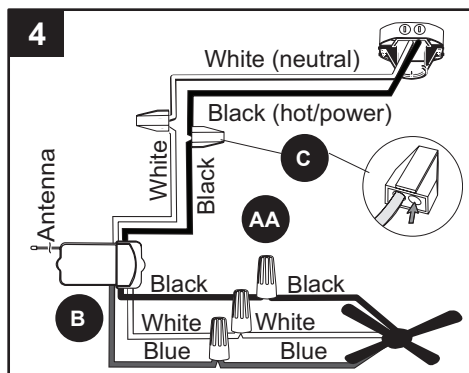

- Connect the Blue wire with white label from the receiver (B) to the Blue fan wire.
- Connect the Black wire with white label from the receiver (B) to the Black fan wire.
- Connect the White wire with white label from the receiver (B) to the White fan wire.
- Connect the Black wire with red label from the receiver (B) to the Black (hot/power) supply wire.
- Connect the White wire with red label from the receiver (B) to the White (neutral) supply wire.

5. Wrap electrical tape (not included) around each wire connector (AA) down to the wire. Then, push wire connections into the outlet box. Place the White wire connections on the opposite side of the outlet box from the Black and Blue wire connections.

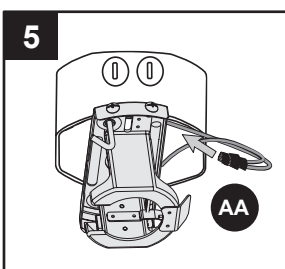

6. Reinstall the canopy.

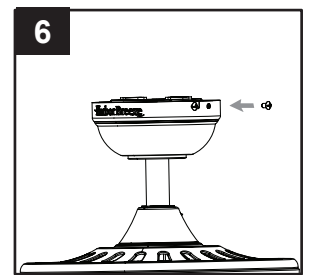

7. Select the adapter plate that corresponds to the style of wall switch to which the wall control (A) will be mounted -- decor plate (E) or standard plate (F). Then snap the plate into the back of the wall control (A).

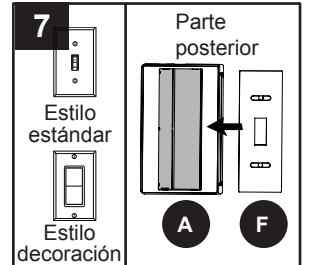

8. Remove the two screws from the wall switch to which the wall control (A) will be mounted. With door to wall control (A) open, use the two plate screws (BB) to attach the wall control (A) to the switch plate.

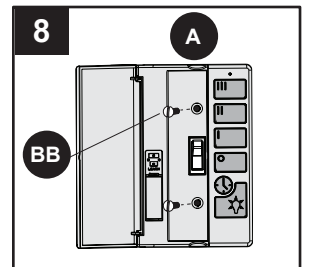

9. Turn on power to wall control (A) and ceiling fan. Then, insert the A23 12-volt battery (C) into the battery compartment of wall control (A). Press the High button to ensure the LED indicator illuminates and the fan turns on.

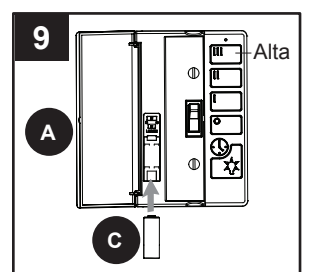

OPERATING INSTRUCTIONS

1. To operate the fan using the wall control (A), press and release the following buttons:

High - Turns fan on high speed.

Medium - Turns fan on medium speed.

Low - Turns fan on low speed.

Fan Off - Turns fan off.

Walk Away Light Delay™ - Tap once will turn fan light off after 1 minute. **Note:** Light blinks to confirm that Walk Away Light Delay is active. Press any other button to cancel.

Light Control -

Incandescent Bulbs - Press light control to turn lights off and on. Press and hold light control to dim or brighten the lights.

CFL - Turns the lights on and off. **Note:** The dimmer function does not work with CFL.

Home Shield™ - Press and hold Light and Delay buttons for 3 seconds. Lights cycle on for 5-20 minutes and off for 60 minutes, simulating occupancy. Cycle repeats continuously until any other button is pushed to discontinue Home Shield mode.

D/O - Switch should be set to "O" for CFLs, which disables the dimming function. Flip to "D" for incandescent and other dimmable bulbs.

Learn - Syncs remote control to receiver. The remote was synced at the factory. Should it become necessary to re-sync the remote, turn off the main power, then turn it back on. Within 30 seconds, use a small screwdriver to press and hold the learn button on the remote for 3 seconds. The fan will turn on and light (if applicable) will blink three times, signaling a successful synchronization.

