

ASSEMBLY INSTRUCTION

PLEASE READ BEFORE ASSEMBLING!

Tip #1: Make sure you've taken all the pieces and hardware out of its packaging before discarding the box.

Tip #2: Using page 2 and/or page 3 of instruction manual make sure all pieces and hardware are accounted for.

Tip #3: Read manual before assembling, it helps!

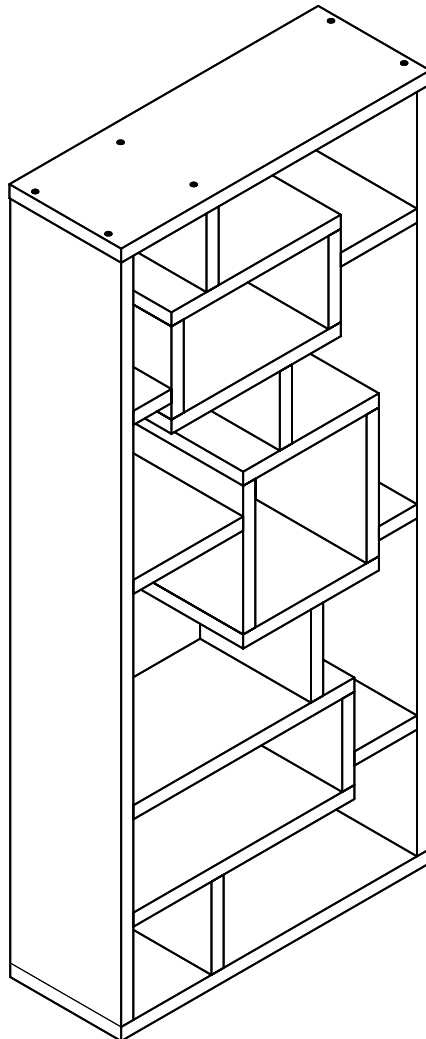

PARTS IDENTIFICATION

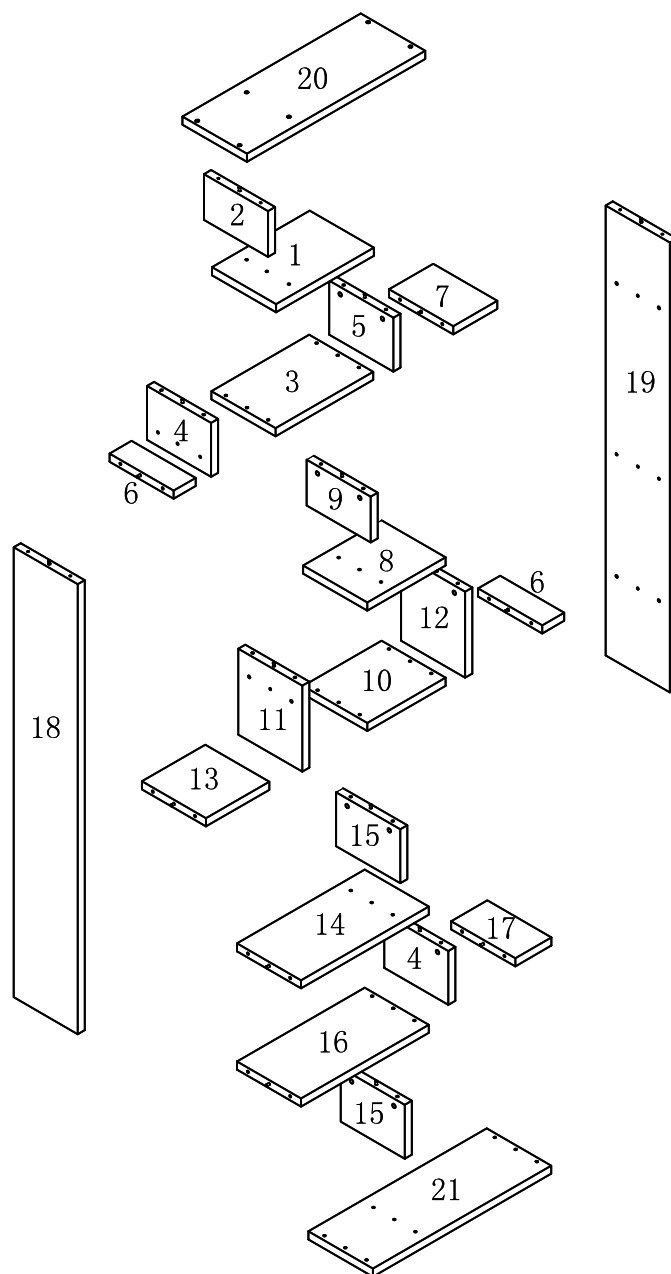

(1)	1pc	(8)	1pc	(15)	2pcs
(2)	1pc	(9)	1pc	(16)	1pc
(3)	1pc	(10)	1pc	(17)	1pc
(4)	2pcs	(11)	1pc	(18)	1pc
(5)	1pc	(12)	1pc	(19)	1pc
(6)	2pcs	(13)	1pc	(20)	1pc
(7)	1pc	(14)	1pc	(21)	1pc

HARDWARE IDENTIFICATION

A



$\phi 7 \times 58$

28pcs

B



$\phi 15$

40pcs

C

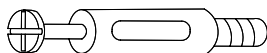

L29

40pcs

D

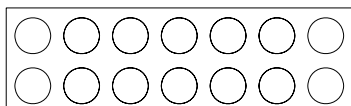

68pcs

E

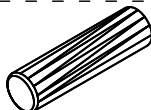

$\phi 8 \times 25$

34pcs

F



It's used for stick the stopper to the connecting hole firmly

1pc

ASSEMBLY INSTRUCTION

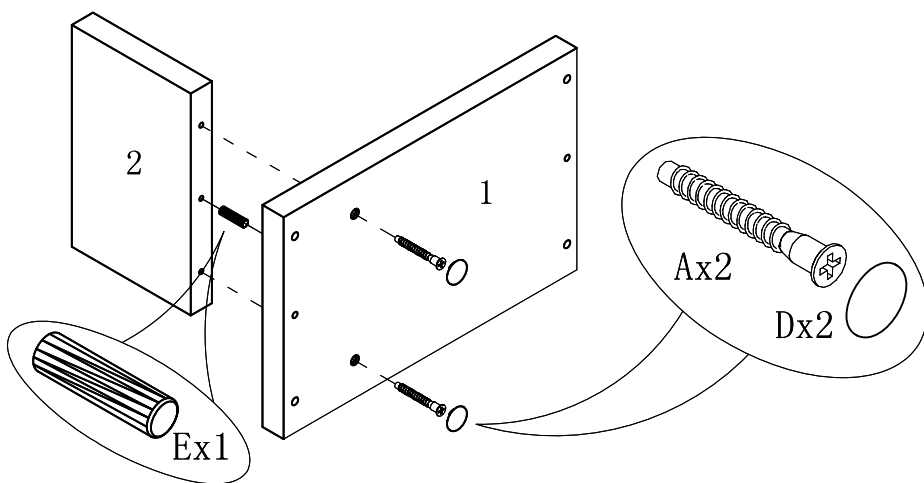

ASSEMBLY INSTRUCTION

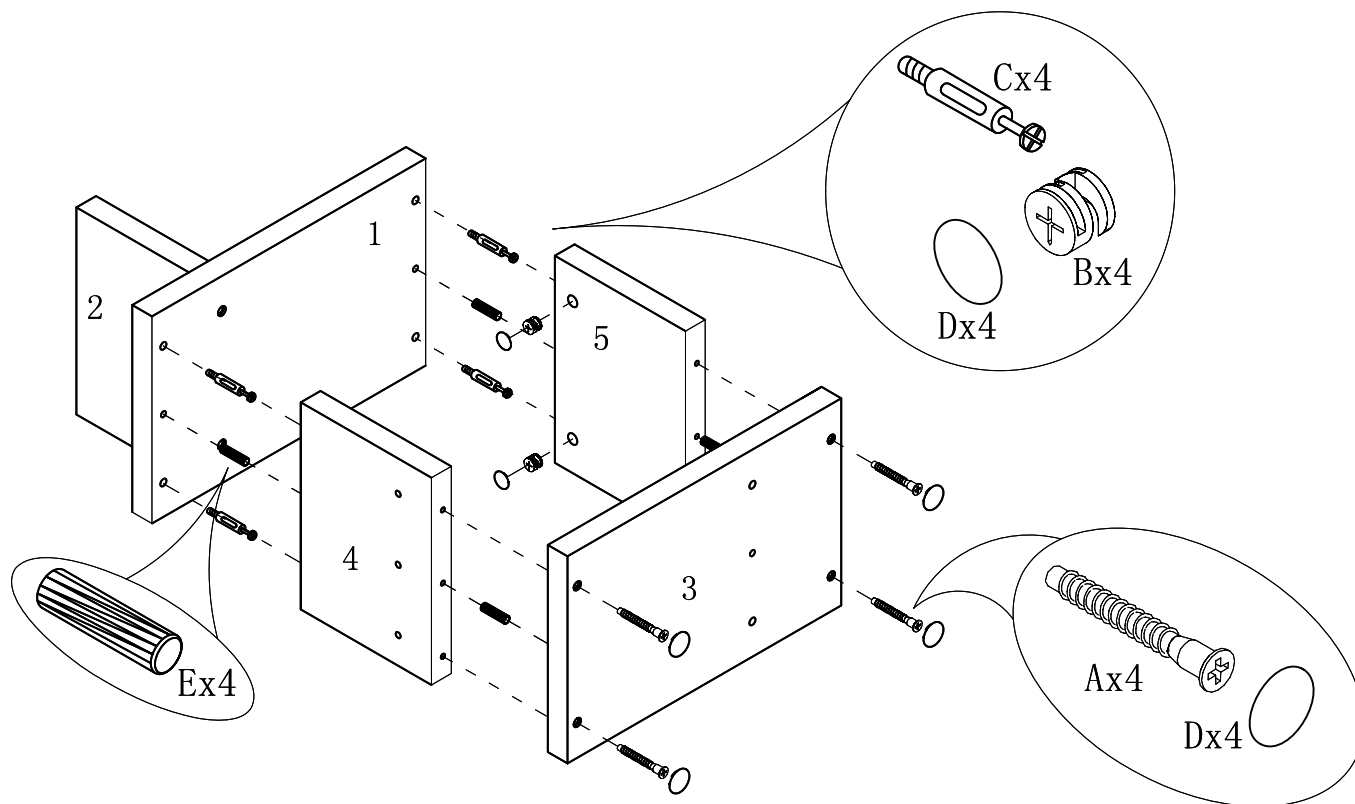

STEP2

STEP3

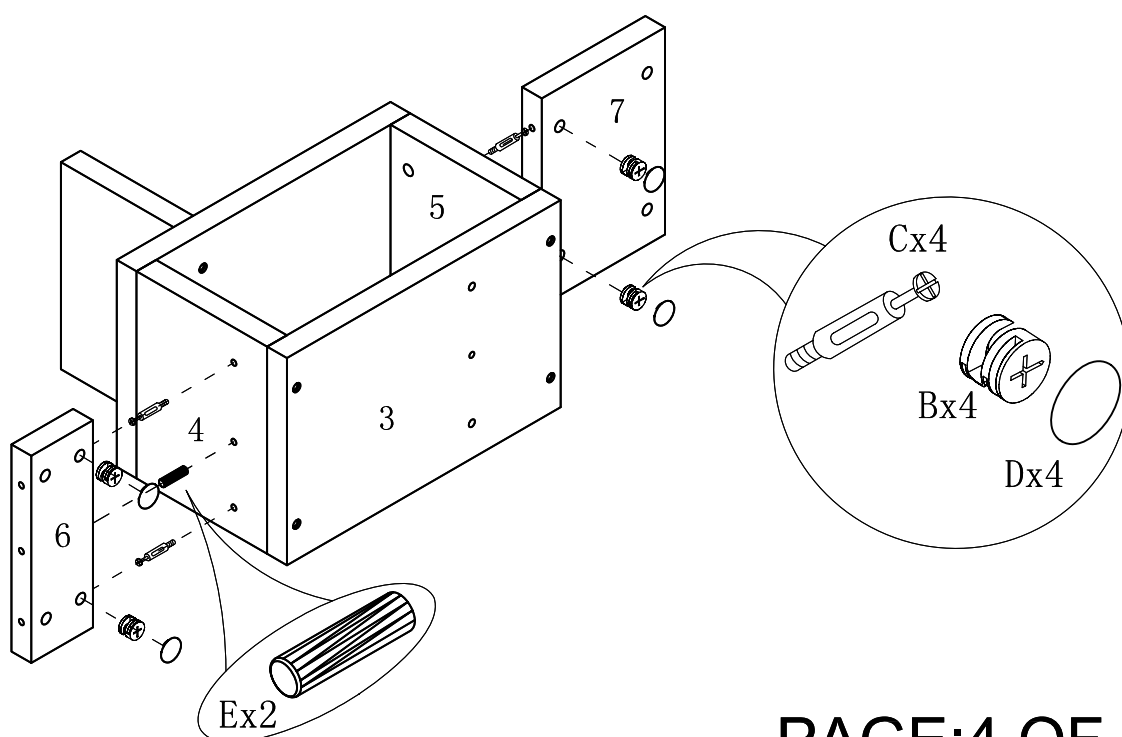

ASSEMBLY INSTRUCTION

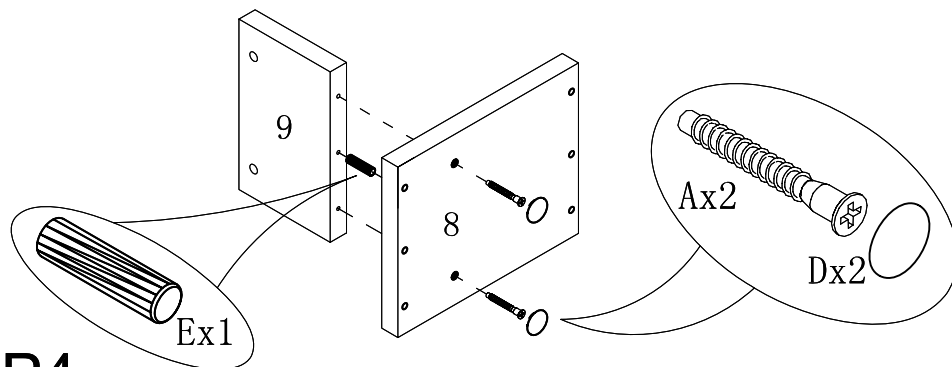

STEP4

STEP5

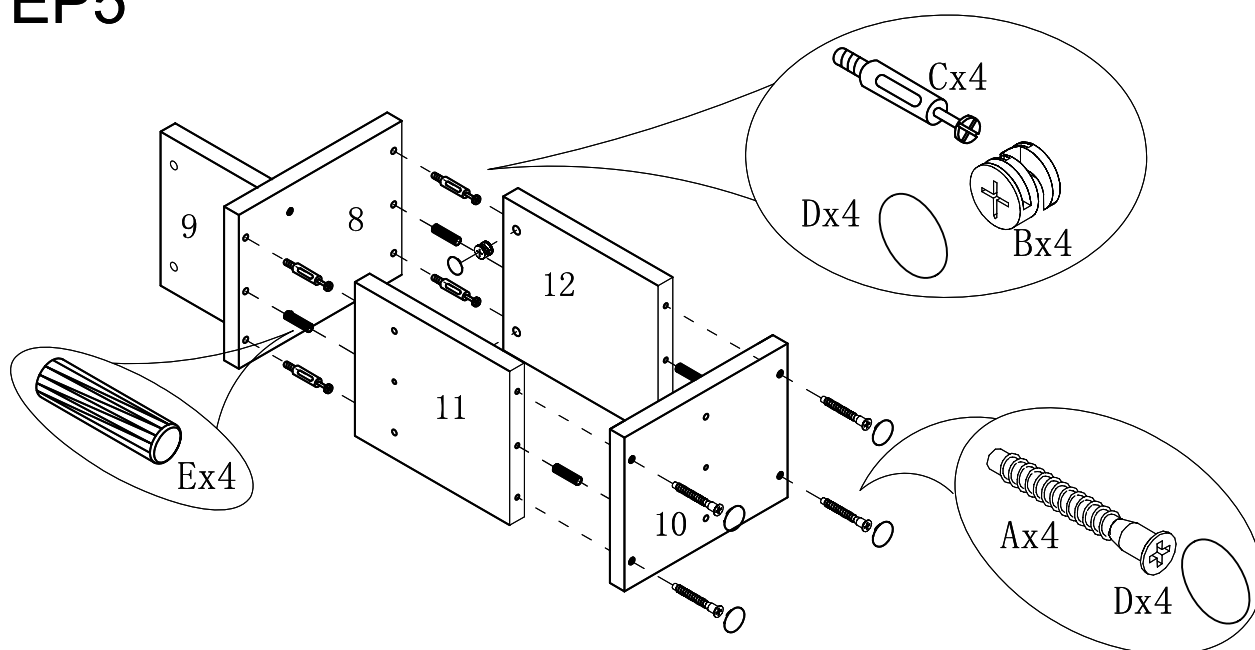

STEP6

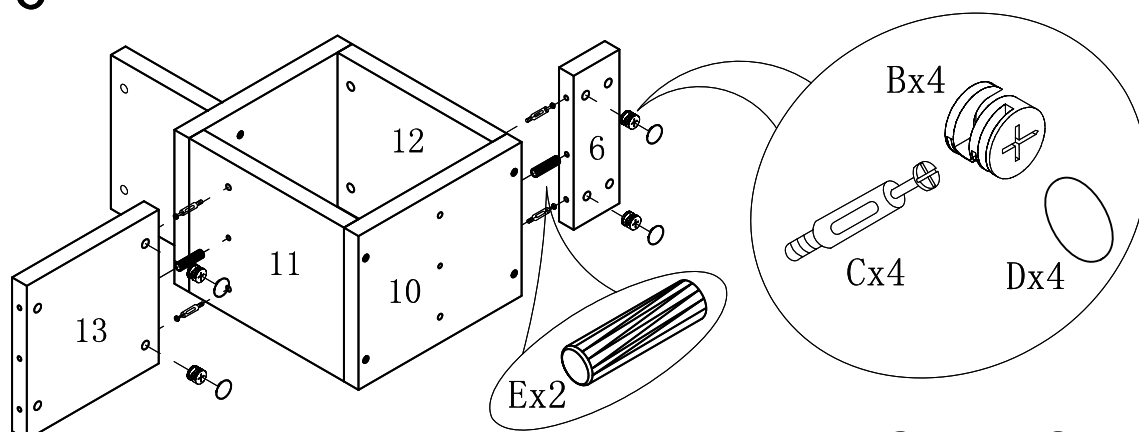

ASSEMBLY INSTRUCTION

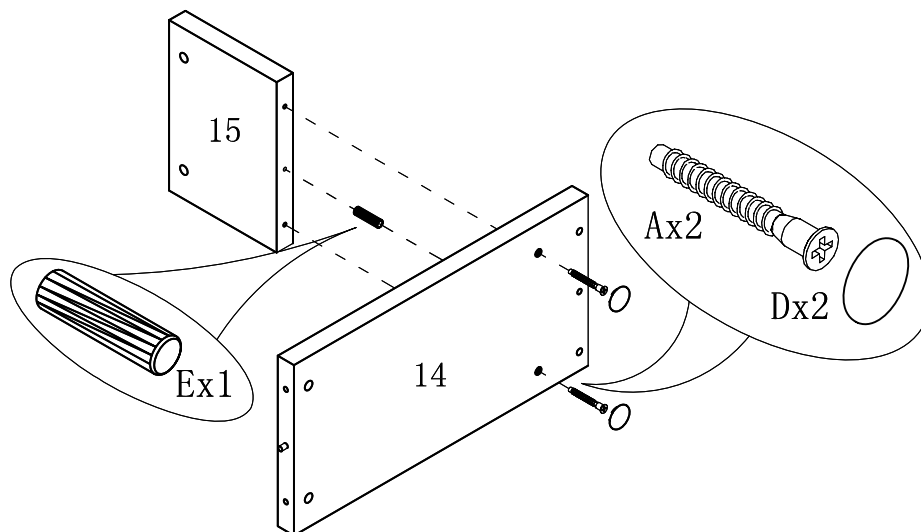

STEP7

STEP8

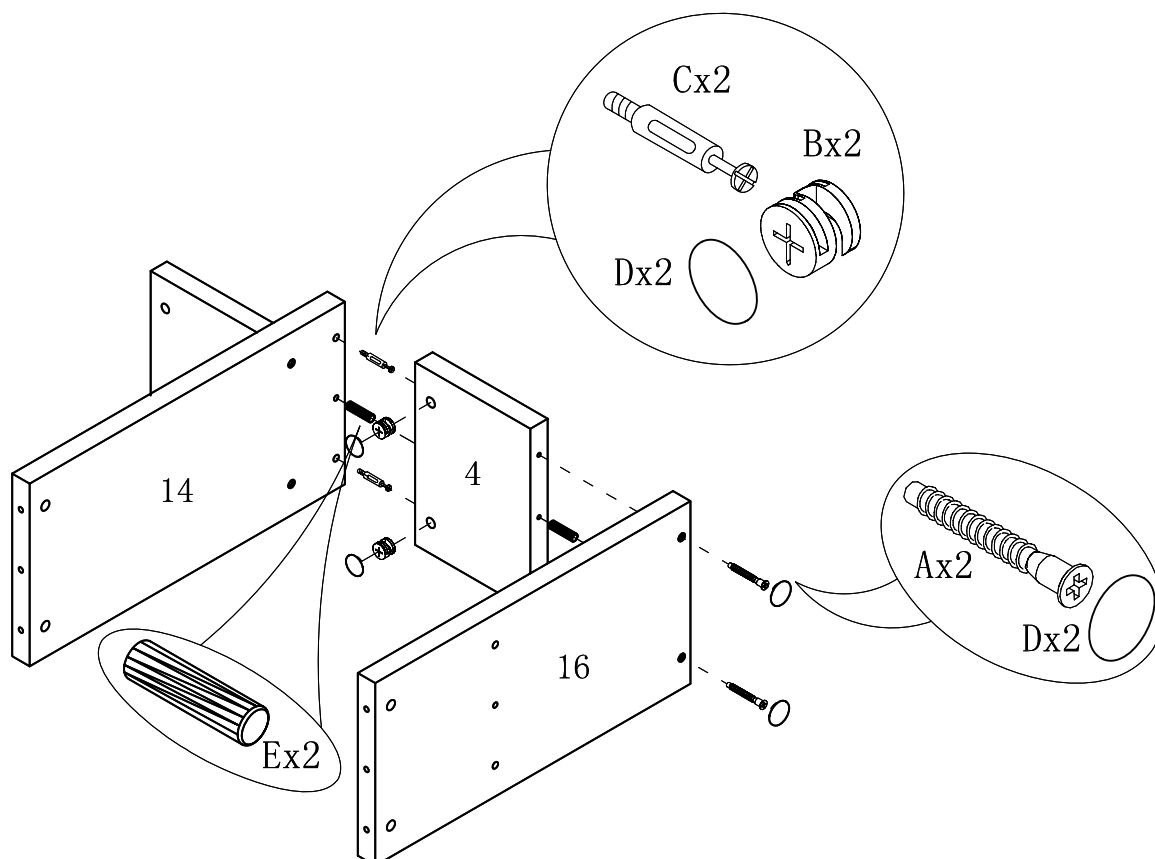

ASSEMBLY INSTRUCTION

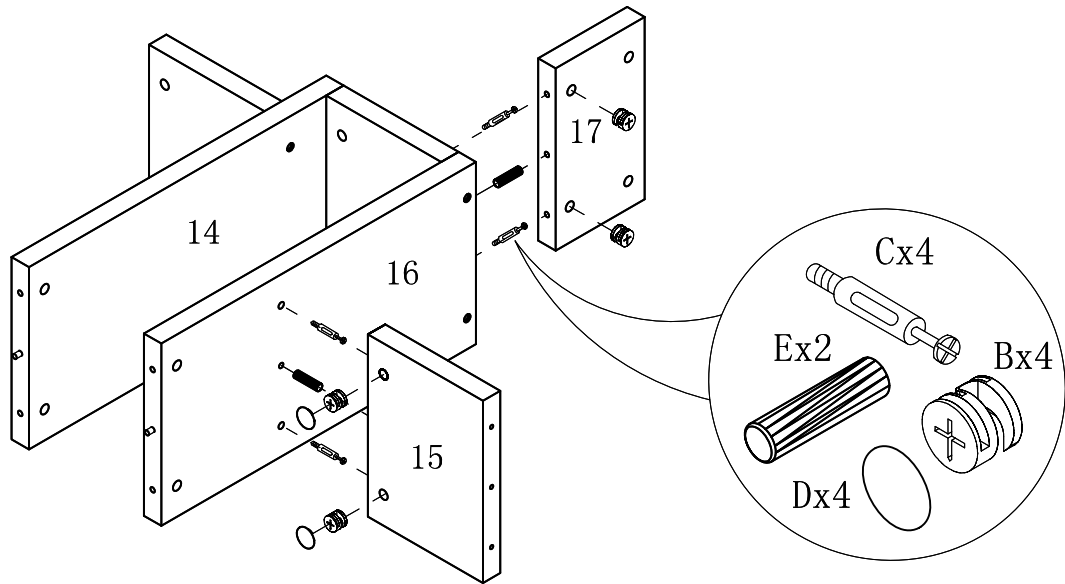

STEP9

STEP10

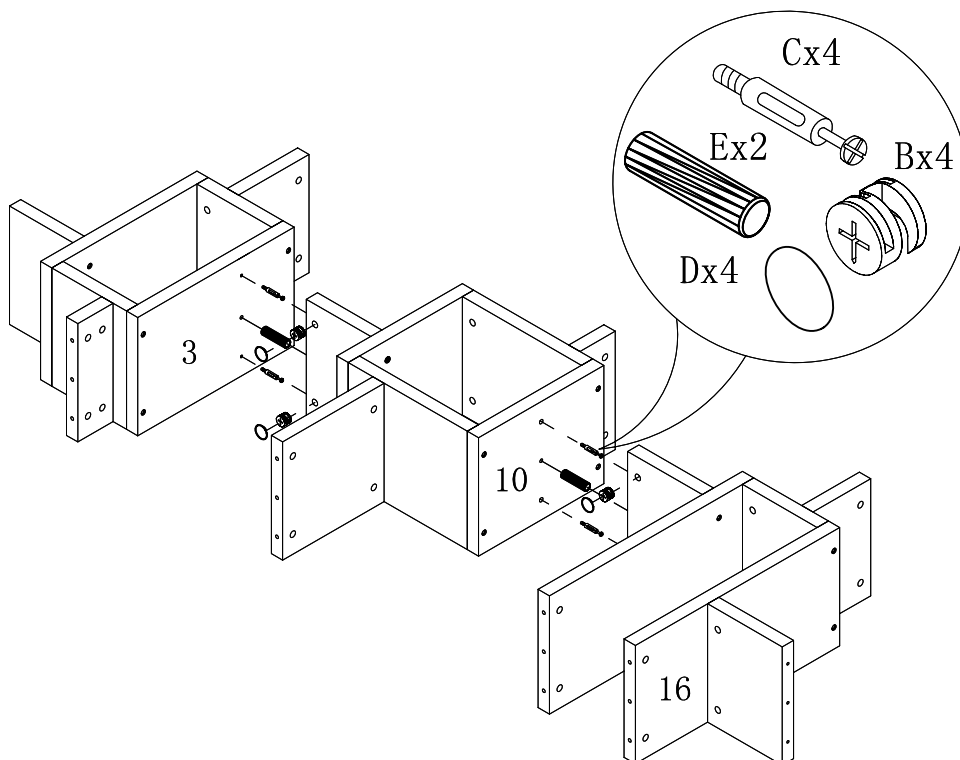

ASSEMBLY INSTRUCTION

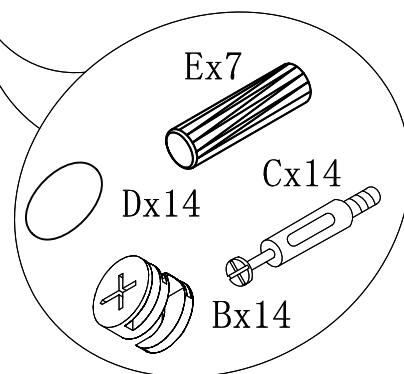
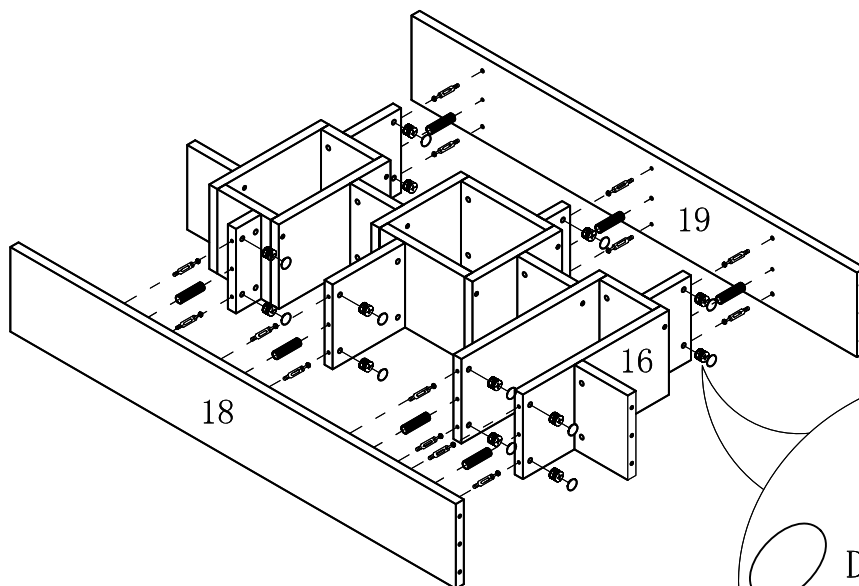

STEP11

STEP12

