

# Ceilingfan Light manual

## To the user

Thank you for purchasing fan lighting products. For your safety, please entrust a professional to install it.



**Warning** please follow the instructions , improper installation, easy to cause electric shock and other accidents.

- All power sources shall not exceed the specified range
- Do not install the luminaire on outdoor or unstable objects.
- Do not install the luminaire above the same temperature object.
- Do not use in series with dimmer.
- In case of abnormality, please cut off the power and contact the seller.

**Note:** the product warranty is one year from the date of purchase.

1. In order to use the product safely and efficiently, please clean and inspect it regularly (once every 6 months).
2. When the lamp is very dirty and needs to be swabbed, please wring it dry with soft cloth soapy water and wipe it off, and then wipe it clean with a soft cloth.
3. Otherwise, can make chassis inside return light layer damage or become angry, bring about lamps and lanterns to change color thereby, attain.

## Remote function diagram

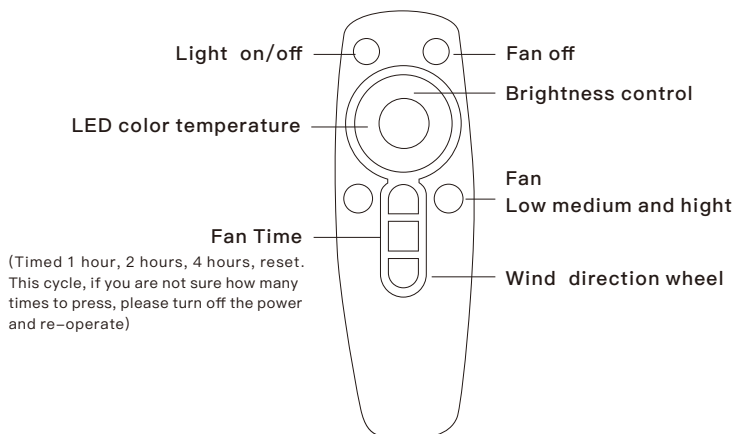

Note: be sure to cut off the power before installation to avoid electric shock

## Parts List



Hanging plate screw



Expansion bolt  
Hanging plate screw



Power Terminal



Hanging plate

## Installation steps

1. Cut four holes in the ceiling, and put the yellow screw (expansion bolt) into the hole

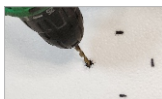

P1

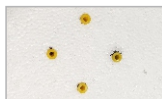

P2

2. Screw the hanging plate screw onto the hanging plate (check the picture3)



P3

3. Fix the hanging plate in the yellow screw with the self tapping screw.



P4



P5

4. Wire Connections: N(brown) and L wire(blue) is respectively connected to the left and right holes at one end of the terminal, Jone E/Gnd to middle. Then connect the wire of light. late have a test.(Turn on the power first to see if the lamp is working properly. If not, please rewire)



P6



P7

5. Clip the lamp shade into the hanging plate screw and fix it.



P8

## APP control

Note: No need to connect, only open the app, open Bluetooth.



①Download the app

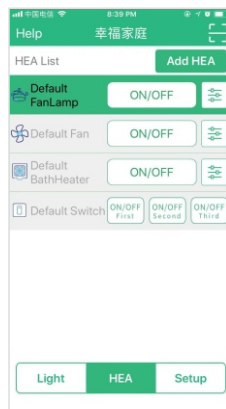

②Enter the list of home appliances, add home appliances.

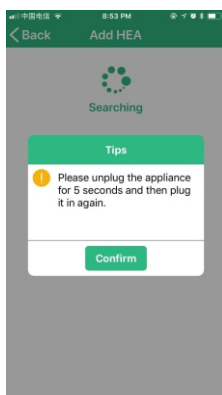

③According to the prompt, power off after 5 seconds of power failure.

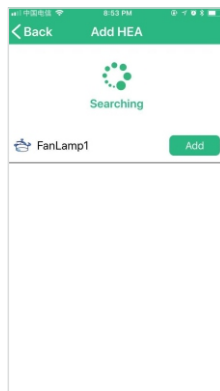

④Add a device, the light flashes 2 to indicate that the addition is successful.

## Bluetooth connection

**Note:** If the fan light you bought does not contain Bluetooth music function, it will be invalid

1. Before using BT speaker, pls power on the product, and the BT speaker will sound "dingdong", which means that the BT speaker is waiting for pairing .
2. Touch the "Settings" icon of the phone, and then touch the "BT" icon to enter the BT settings interface. The phone will automatically search for BT products and find the "Speaker Light". Touch the "Speaker Light" icon to pair when you listen to "ding dong", you can use BT speakers.

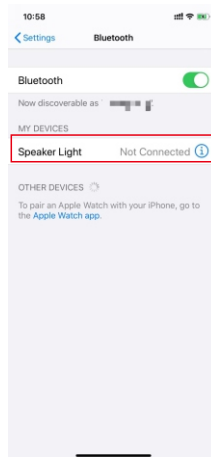

3. Normal use BT Speaker  
**Note:** If you need to use the Bluetooth speaker alone, please use the remote control Turn off the lights and fans. Never turn off the wall power switch.