

# OD774100TX BRISTOW DEEP SEATING-SOFA

## Assembly Instructions



**Southern**  
ENTERPRISES

For assistance with assembly contact:  
Southern Enterprises Inc.  
Customer Service 1-800-633-5096  
[service@seidal.com](mailto:service@seidal.com)  
[www.seidal.com](http://www.seidal.com)

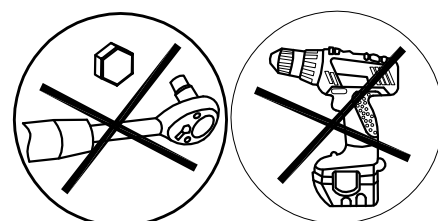
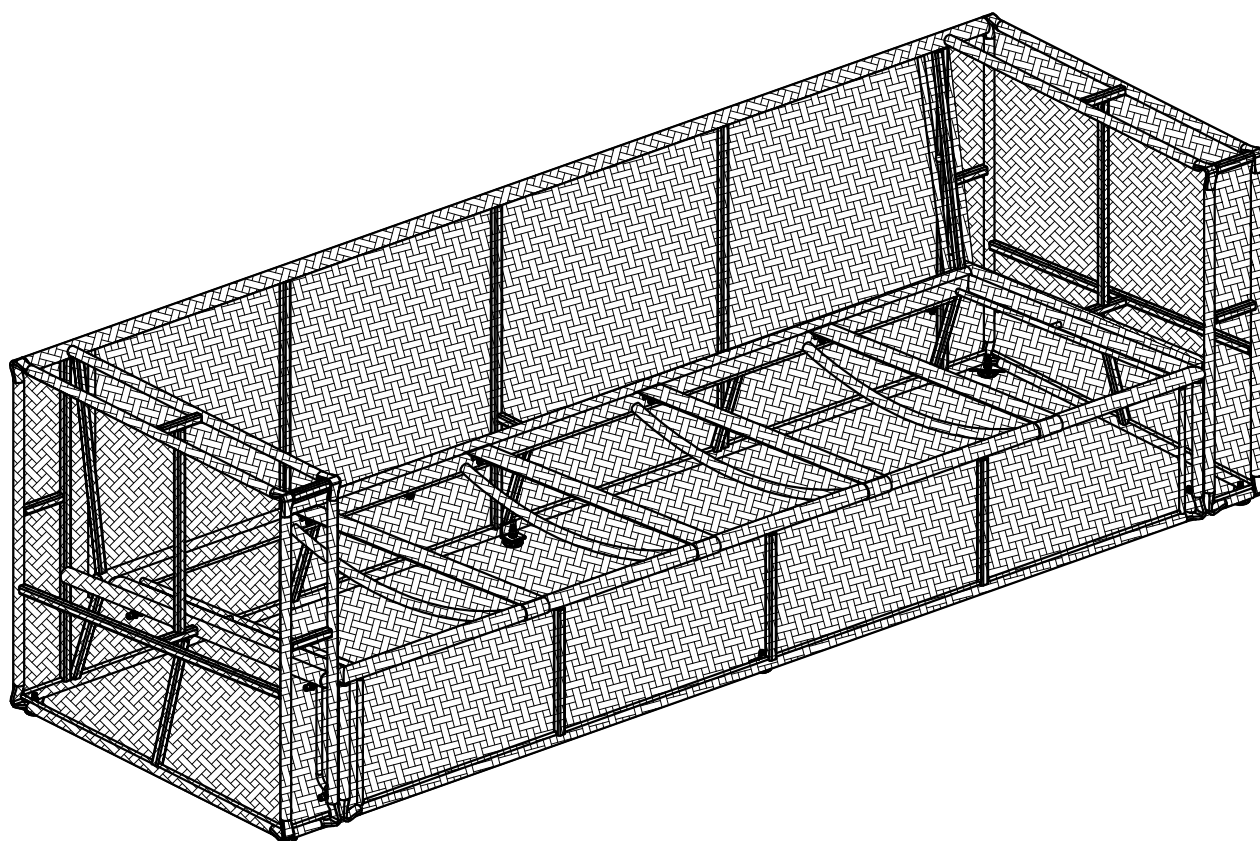

# OD774100TX - BRISTOW DEEP SEATING-SOFA

## Parts List

Please review all parts and hardware before disposing of any packaging. Call Customer Service if missing hardware. Screws shown in actual size. Using a screw that is too long will cause damage. Before beginning assembly, separate each type of screw. Carefully study the screw diagrams below (SHOWN ACTUAL SIZE). You may receive extra hardware with your unit.

**A.**

Quantity  
of 1

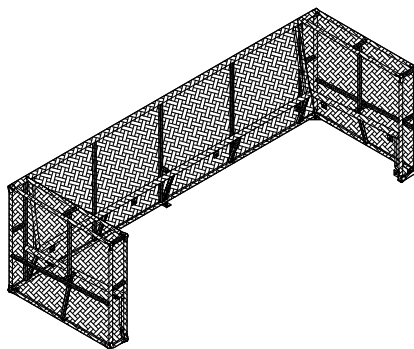

Main Frame

**B.**

Quantity  
of 1

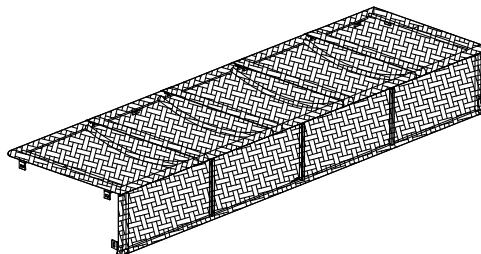

Seat Frame

**1.**

Quantity  
of 10



Hex Nut

**2.**

Quantity  
of 20



Washer

**3.**

Quantity  
of 10

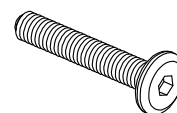

Bolt 0.23"x 1.57"L

**4.**

Quantity  
of 6



Foot

**5.**

Quantity  
of 2

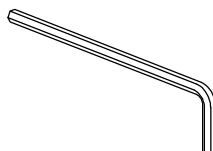

Allen Key

**6.**

Quantity  
of 2

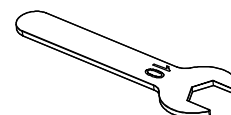

Spanner

### Care and Cleaning Instructions:

Before using, wipe with a clean, dry cloth. Periodically apply furniture wax to renew the finish. Avoid rubbing or scratching the surface with rough or abrasive objects.

For replacement parts or questions, please Call Customer Service at 1-800-633-5096 Do not return product to store, please call Manufacturer for assistance, questions or Parts.

# OD774100TX - BRISTOW DEEP SEATING-SOFA

## Assembly Instructions

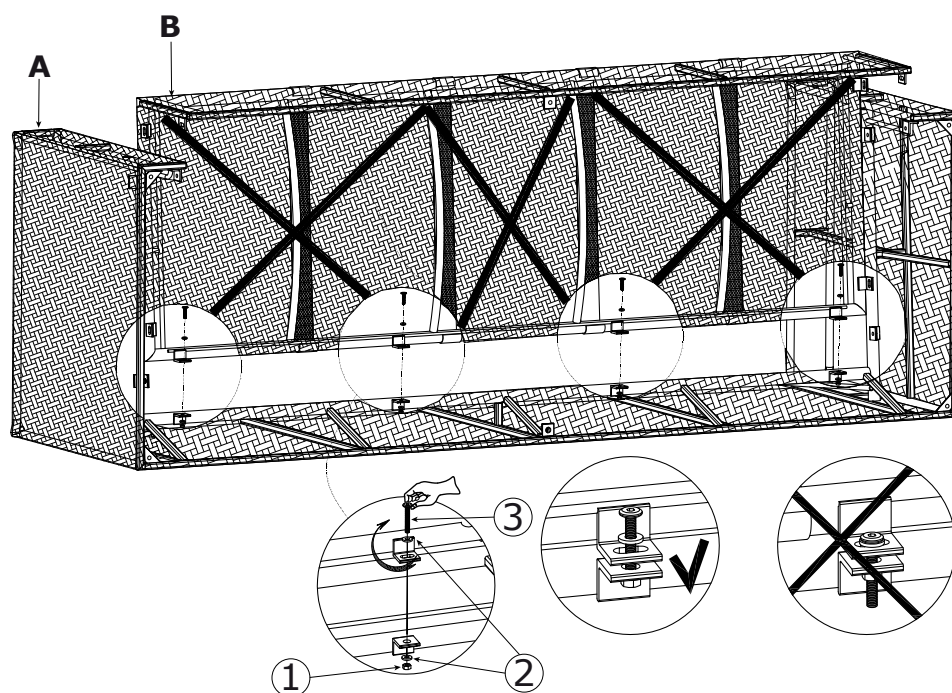

**Figure 1**

Attach the seat frame **B** into the main frame **A** by using Bolt **3**, washer **2**, Hex nut **1**

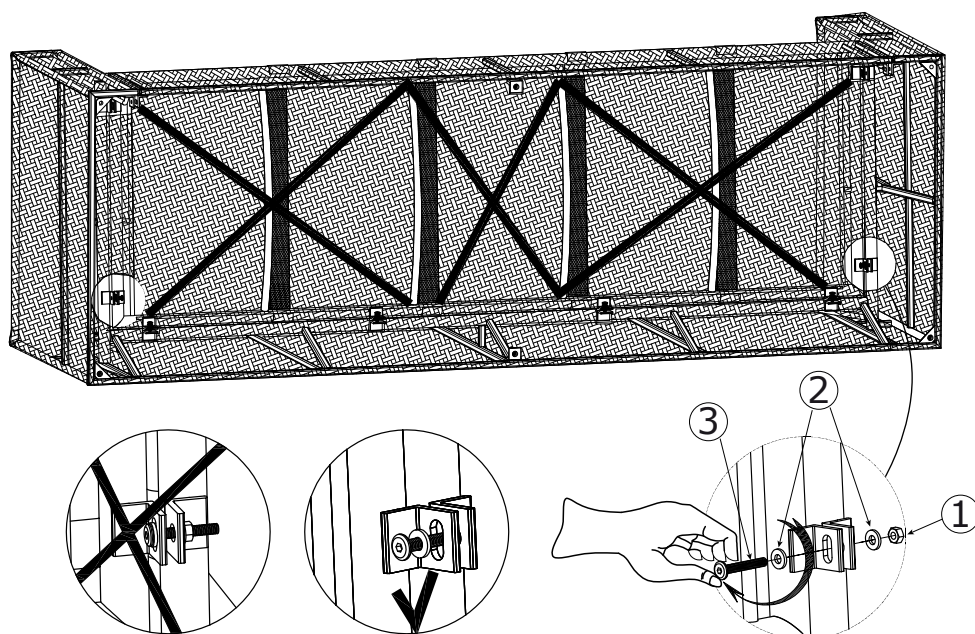

**Figure 2**

To continue to use Bolt **3**, washer **2** , Hex nut **1** to fix the seat frame **B** into the main frame **A**



# OD774100TX - BRISTOW DEEP SEATING-SOFA

## Assembly Instructions

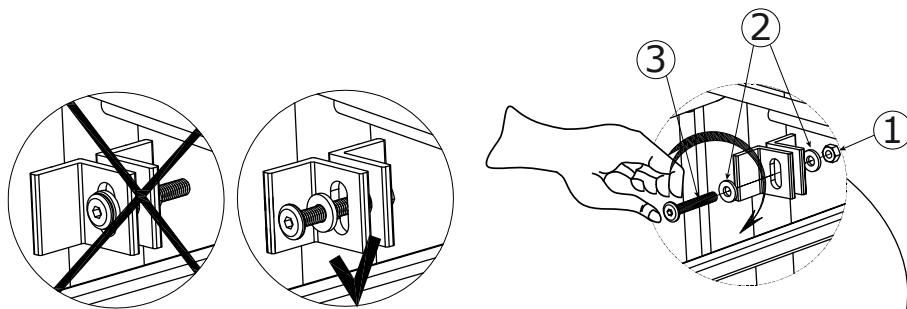

To continue to use Bolt **3**, washer **2**, Hex nut **1** to fix the seat frame **B** into the main frame **A**

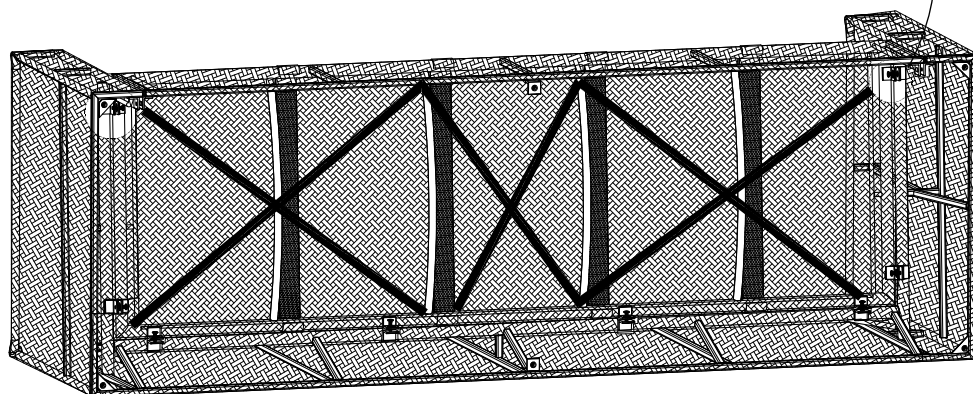

**Figure 3**

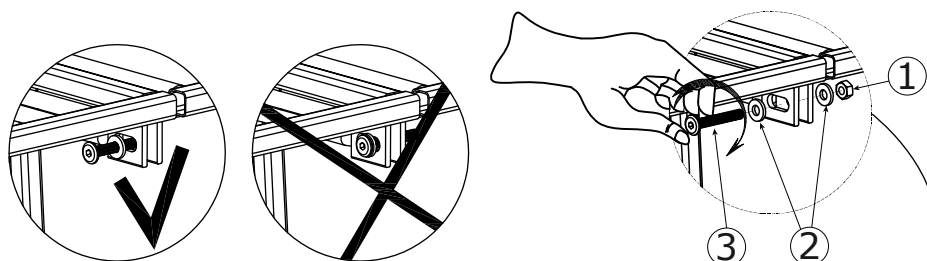

To continue to use Bolt **3**, washer **2**, Hex nut **1** to fix the seat frame **B** into the main frame **A**

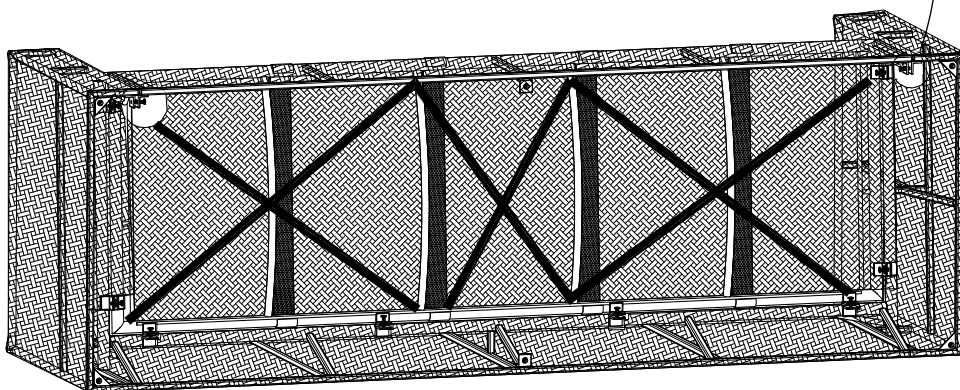

**Figure 4**

# OD774100TX - BRISTOW DEEP SEATING-SOFA

## Assembly Instructions

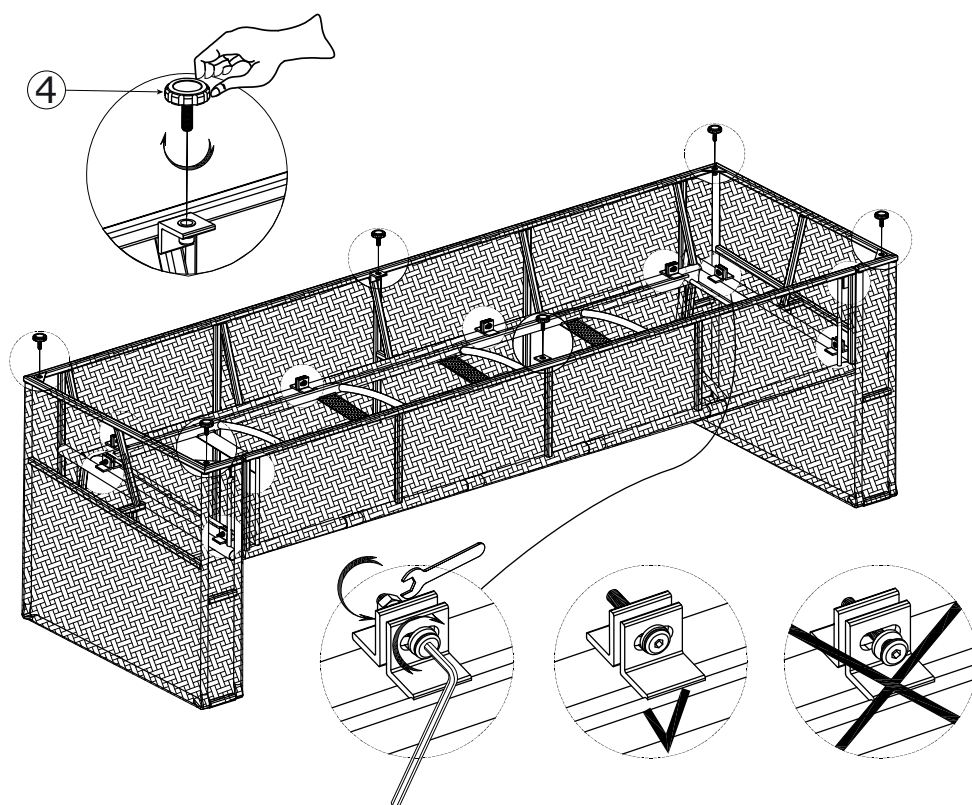

**Figure 5**

Attach the foot **4** into the sofa and tighten all bolts and hex nuts once again by using allen key **5** , Spanner **6**

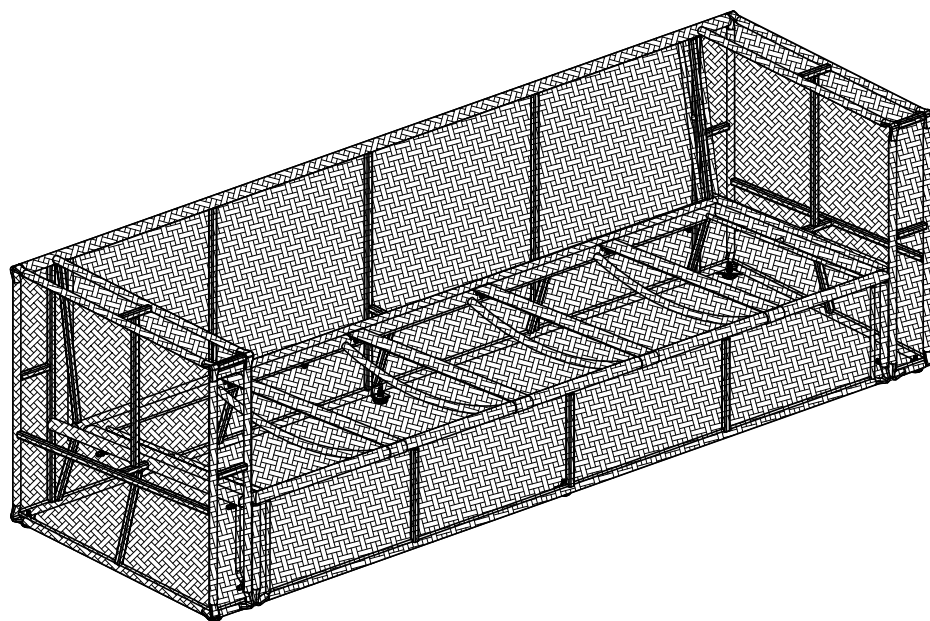

**Figure 6**

Turn up the sofa 180 . The sofa is ready to use now.

# Parts Replacement Form

## Customer Information

Name \_\_\_\_\_

Address \_\_\_\_\_

City/State/Zip Code \_\_\_\_\_

Phone Number \_\_\_\_\_

Please indicate where you purchased this item: Store/Website/Catalog

\_\_\_\_\_

Please indicate color/size/style number:

\_\_\_\_\_

Style No	Parts Letter	Parts Description	Quantity Needed
----------	--------------	-------------------	-----------------

_____	_____	_____	_____
-------	-------	-------	-------

_____	_____	_____	_____
-------	-------	-------	-------

_____	_____	_____	_____
-------	-------	-------	-------

Please immediately examine this product carefully. Any request for missing parts or damage replacement must be received within 90 days of your receipt of the product. Replacement, if available, will be honored within this time frame. Parts will not be available for items arriving fully assembled. We do not recommend modifying product(s) and we are not responsible for any damages due to product modification(s). If damages or missing parts are not reported within 90 days of your receipt, we are under no obligation to provide parts or replacement merchandise.

Please contact Southern Enterprises at 800-633-5096 or in Dallas 972-869-0111/ 9am – 4pm Mon-Fri Central time if you have product issues or email us at [service@seidal.com](mailto:service@seidal.com). Please ask for customer service representative for issues involving damages or replacement parts. Please ask for technical assistance representative for any issues with product and assembly/construction.

Please contact the retailer that you purchased from for returns.



**Southern**  
ENTERPRISES

Customer Service 1-800-633-5096

[service@seidal.com](mailto:service@seidal.com)

Southern Enterprises, Inc.

600 Freeport Parkway, Suite 200

Coppell, Texas 75019