

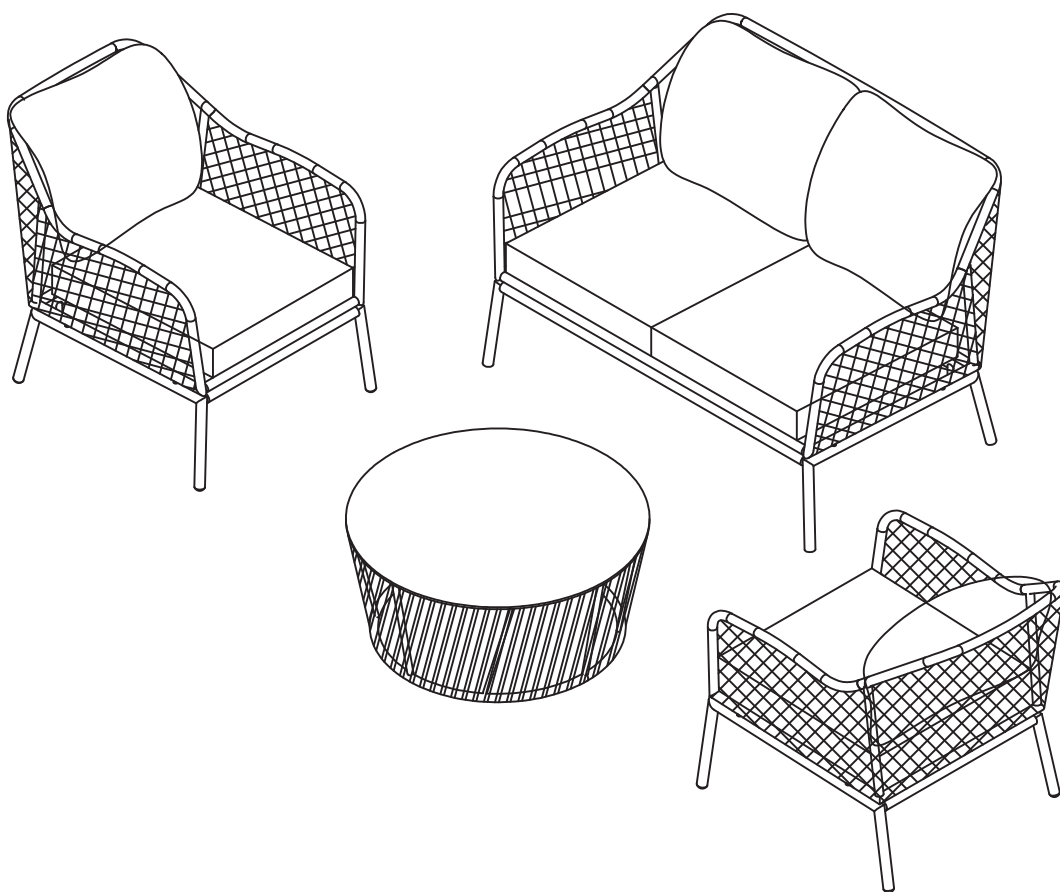

Item # 199625

## TERRELL 4PC SEATING ASSEMBLY INSTRUCTIONS



### ATTACH YOUR RECEIPT HERE

Order Number \_\_\_\_\_ Purchase Date \_\_\_\_\_



**Questions, problems, missing parts?** Before returning to your retailer, email our customer service department directly at [HELLO@LEISUREMADE.COM](mailto:HELLO@LEISUREMADE.COM) or call us at (888) 682-3012 8am-4pm EST, Monday-Friday.

## PACKAGE CONTENTS

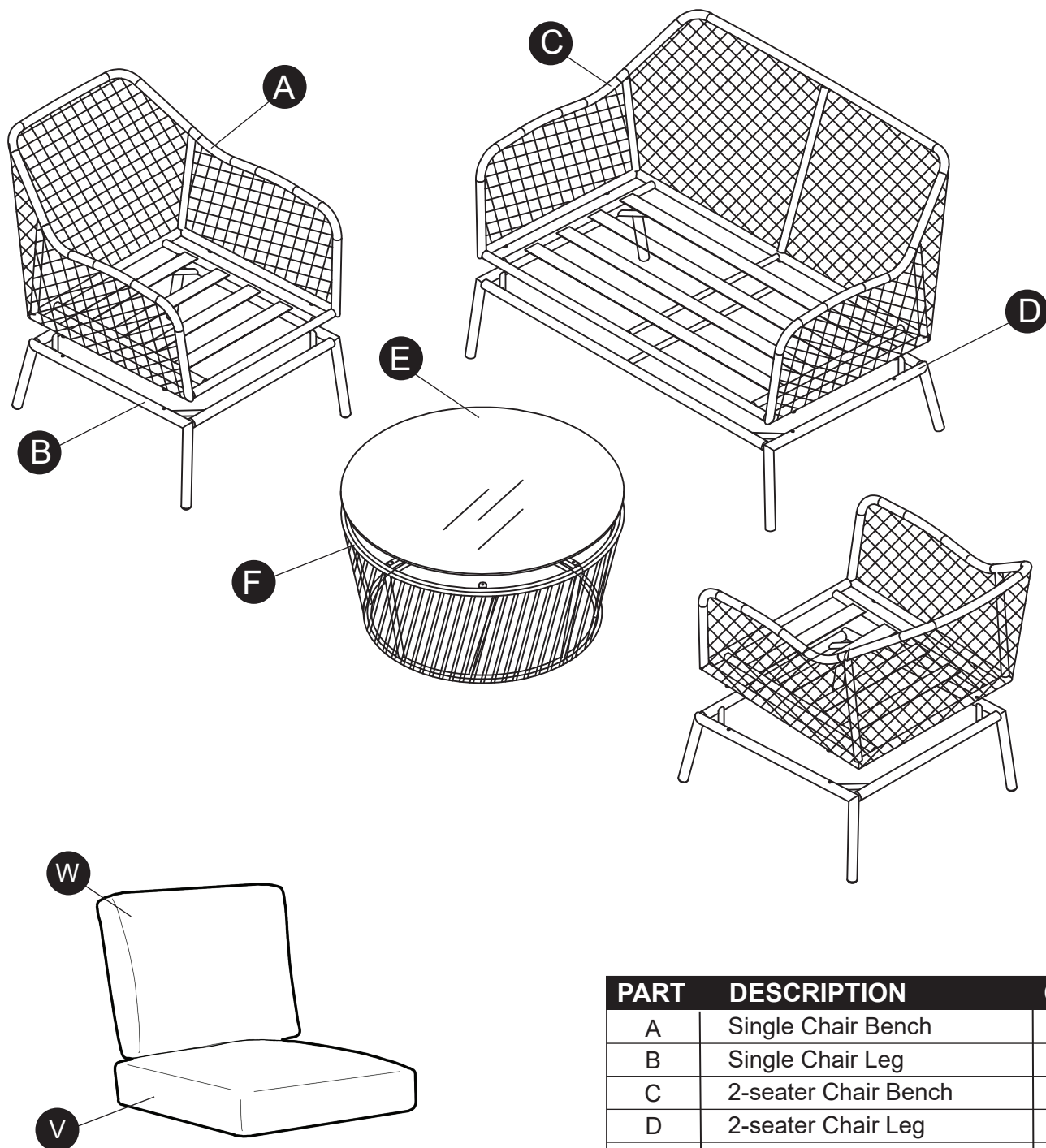

PART	DESCRIPTION	QTY
A	Single Chair Bench	2
B	Single Chair Leg	2
C	2-seater Chair Bench	1
D	2-seater Chair Leg	1
E	Glass	1
F	Table Frame	1
V	Standard Seat Bottom	4
W	Standard Back Cushion	4

## HARDWARE CONTENTS

---

AA

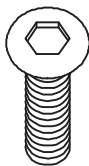

M6 Bolt x 40mm  
Qty: 8

BB

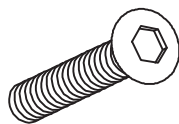

M6 Bolt x 35mm  
Qty: 2

CC



Washer  
Qty: 10

DD

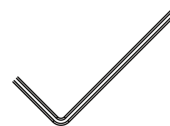

Allen Key  
Qty: 1

## SAFETY INFORMATION

---

Please read and understand this entire manual before attempting to assemble, operate or install the product.

 **CAUTION:** Assemble on a soft, non-abrasive surface.

## PREPARATION

---

Before beginning assembly of product, make sure all parts are present. Compare parts with the package contents list and hardware contents list. If any part is missing or damaged, do not attempt to assemble the product.

If you find a missing or damaged part, please look through all pieces to make sure nothing else is missing or damaged. Compile a comprehensive list and give us a call. We will send out all parts in a single shipment. Ensuring you have all missing parts identified at the time you call will ensure a faster delivery to complete your beautiful patio furniture.

**Please call us directly, not your retailer. As the manufacturer we can walk you through any issues you may have. We are here to help: (888) 682-3012**

## CUSHION ASSEMBLY

Before beginning, make sure all cushions and covers are present. Make sure you have identified the difference in the seat bottoms and seat backs before pulling on the fabric covers.

PART	DESCRIPTION	QTY
V	Standard Seat Bottom	4
W	Standard Back Cushion	4

STANDARD CUSHION

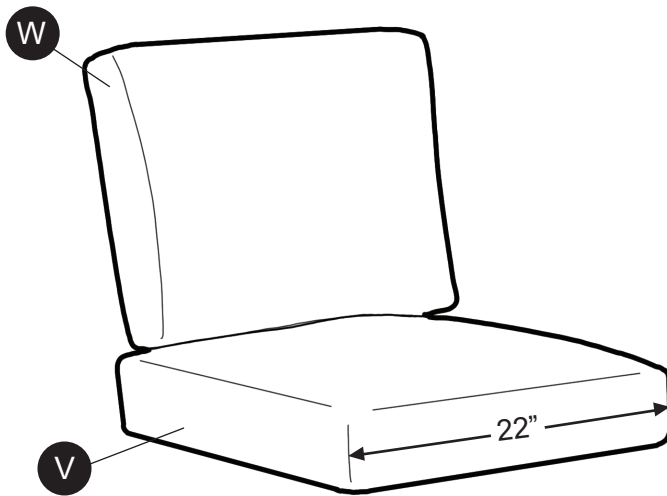

HELPFUL TIP: we call this the 'Taco Method'. Place the cushion between your knees and squeeze together to form a taco. This makes it much easier to pull on the cushion cover.



## ASSEMBLY INSTRUCTIONS

1. Single person sofa assembly, fasten the single chair bench (A) to the legs (B) with four screws (AA) and four washers (CC) by using allen key (DD).

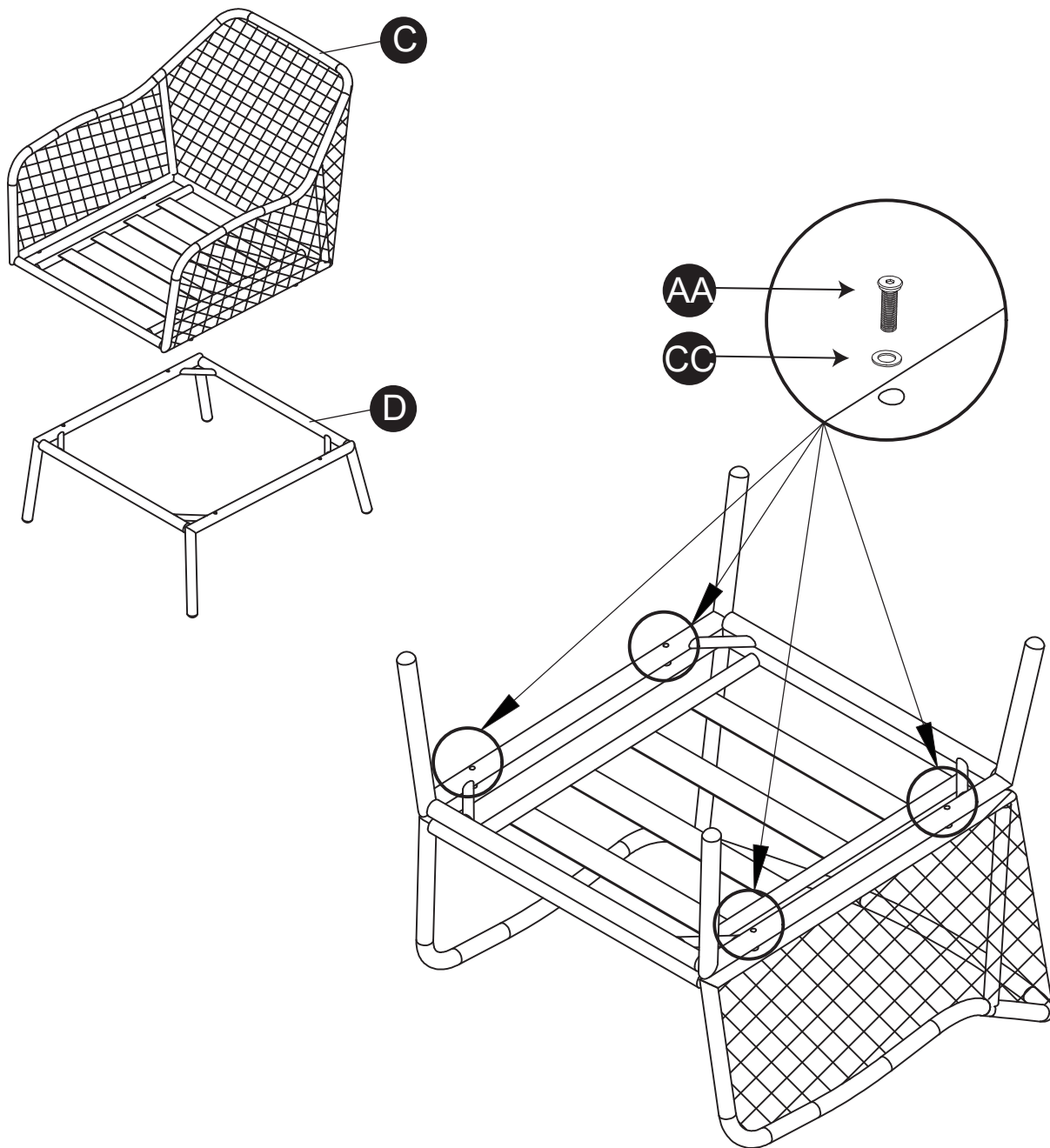

## ASSEMBLY INSTRUCTIONS

2. Love seat assembly, fasten the 2-seater chair bench (C) to the legs (D) with four screws (AA) and four washers (CC), also with two screws (BB) and two washers (CC) by using allen key (DD).

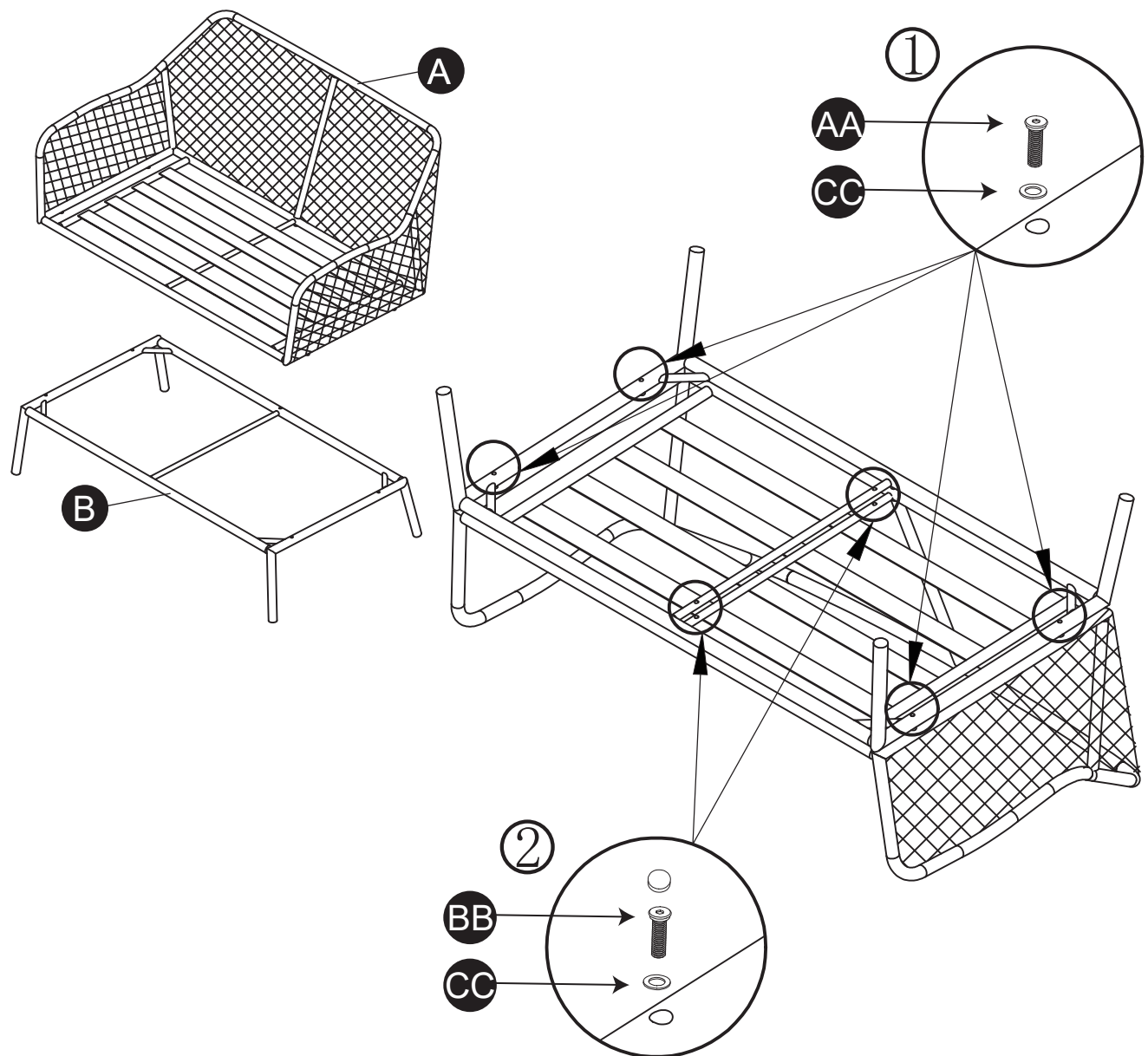

## ASSEMBLY INSTRUCTIONS

---

3. Put the glass (E) on the table rim (F).  
Add the cushions on it, and enjoy your beautiful furniture!  
If you have any issues please call (888) 682-3012 directly.

