

lawn mower

Product ID. 7LQ56

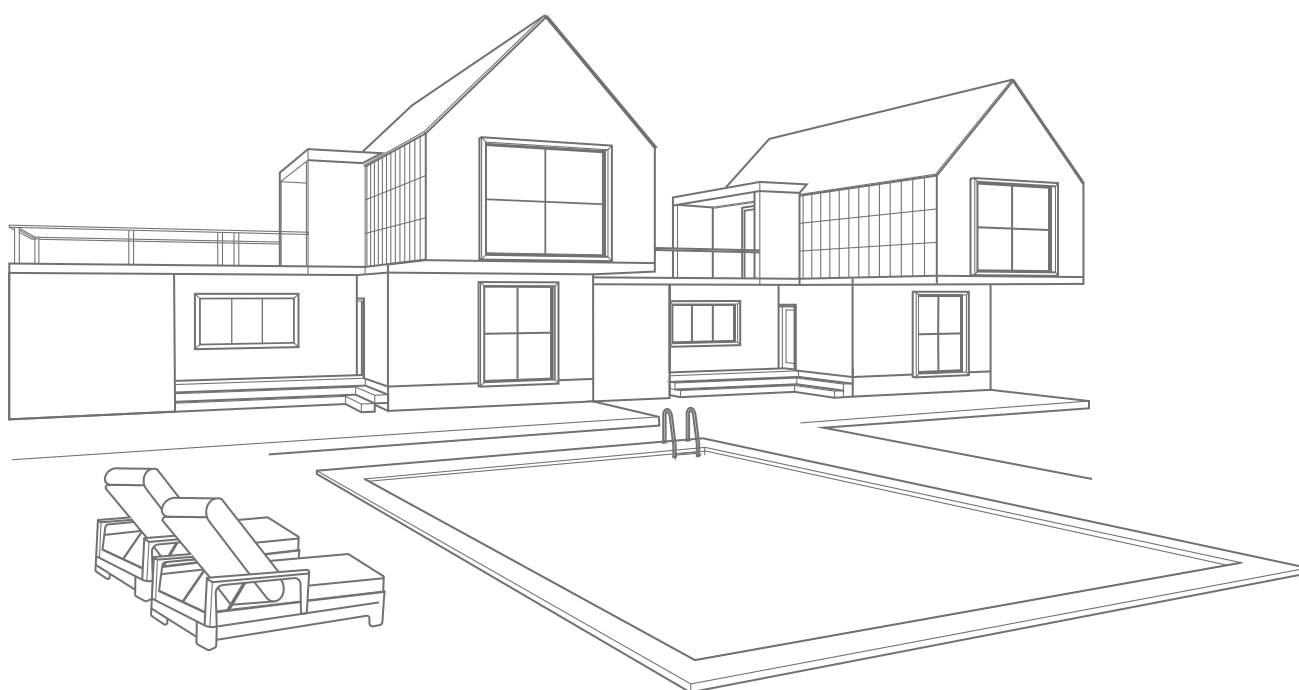

Scan for Support
support@garvee.com



Distributed by
GARVEE.com

USER MANUAL

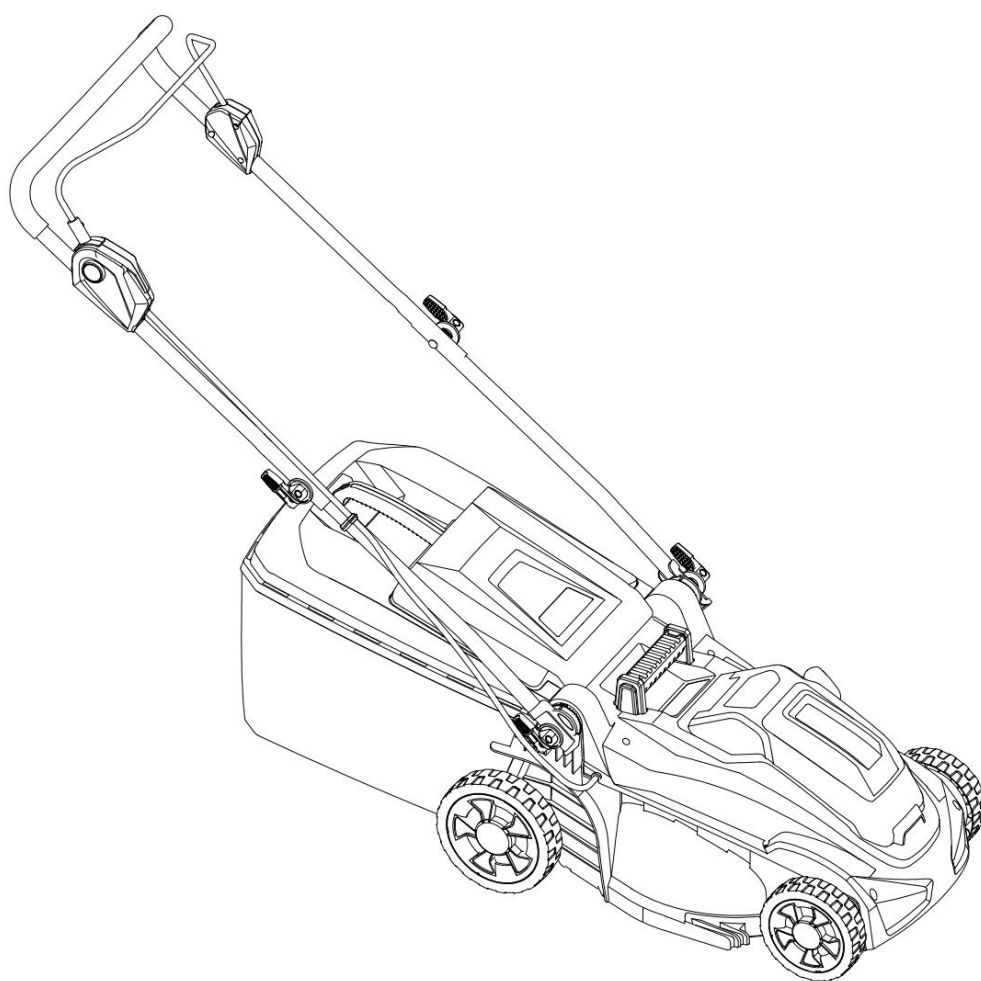

Model:	ML-LM17-200MAK
Rated voltage	D.C. 40 V
Trimming width (blade diameter)	17 inch
No-load speed	2800 rpm
Maximum speed	3300 rpm
Cutting Height	0.984" to 2.95"
Grass Collector	40L
Net weight	30.2 lbs









- The manufacturer reserves the right to change specifications without prior notice.
- Specifications may vary depending on country of sale.
- Weight varies with accessories (including battery pack).
- **Please only use GARVEE Brand battery packs and chargers.**

⚠ Warning: Please use only the battery packs and chargers listed above. Use of other types of battery packs or chargers may result in personal injury and/or fire.

⚠ Warning: Do not use corded power sources, such as battery-to-battery adapters or portable power supplies, with this machine. Such power cables may impede operation and cause personal injury.

Symbol

The following show symbols that may be used on this device. Before using a tool, be sure to understand its meaning.

 take special care and attention.	 Never put your hands or feet near the blades underneath your lawn mower. The blade will continue to rotate after the motor is turned off.
 Read the instruction manual.	 Do not flush.
 Danger: watch for thrown objects.	 Ni-MH Li-ion EU countries only Do not dispose of electrical equipment or battery packs with normal household waste! It is important to comply with the European Directives on Waste Electrical and Electronic Equipment, Batteries and Accumulators and Waste Batteries and Accumulators and to implement them in accordance with the laws and regulations. Electrical equipment and battery packs that have reached the end of their service life must be sorted and recycled to recycling facilities that comply with environmental protection regulations.
 The distance between tools and bystanders should be at least 15 meters.	
 Electrical Hazards. Contact with water may cause electric shock.	

Use:

This machine is used for mowing lawns.

Warning

Important safety precautions :

Save all warnings and instructions for future reference.

 Warning: Read all warnings and all instructions. Failure to follow the following warnings and instructions can result in electric shock, fire and/or serious injury.

Training

1. Please read the instructions carefully. Be familiar with the correct operation process of this lawn mower.
2. Never allow children or persons unfamiliar with these instructions to use this lawn mower. Local regulations may limit operator age.
3. Never operate this lawn mower with people (especially children) or pets nearby.
4. Always remember when operating that the operator or user will be responsible for any damage caused to others and their property.
5. Children should be supervised and not allowed to play with this tool.
6. Physical Condition - Do not operate your lawn mower while under the influence of drugs, alcohol, or other medical conditions.

Preparation

1. Always wear thick shoes and long pants when operating this lawn mower. Do not operate this lawnmower while barefoot or wearing open-toed sandals. Avoid wearing or wearing loose or stringy clothing or jewelry. They can get caught in moving parts.
2. Before use, be sure to observe whether the lawn mower is damaged and whether the protective cover or isolation cover is missing or misplaced.
3. Before mowing the lawn, make sure there are no other people in the work area. Stop the lawnmower if anyone enters the work area.
4. Always wear protective goggles when using power tools to avoid eye damage.

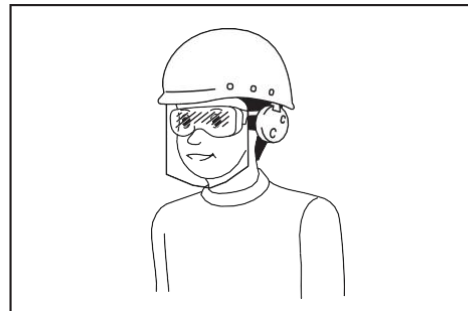

Employers are responsible for ensuring that tool operators and other personnel near the work area wear appropriate safety protective equipment.

5. Before operation, carefully inspect the blade or blade bolt for cracks or damage. Cracked or damaged blades or blade bolts should be replaced immediately.
6. Before mowing the lawn,

please remove foreign objects such as stones, wires, bottles, bones, and large branches from the working area to prevent personal injury or damage to the lawn mower.

7. A lawn mower blade striking a foreign object can cause serious personal injury. Before each mowing, be sure to carefully inspect your lawn and remove any foreign matter.
8. Look for holes, potholes, bulges, rocks or other hidden objects. Uneven floors can cause slips and falls. Tall grass can hide obstacles.
9. Use personal protective equipment. Always wear safety goggles. Protective equipment such as dust masks, non-slip safety shoes, hard hats, and hearing protection used under appropriate conditions can reduce personal injuries.

Operation

1. Do not stretch your hands too long during operation. Always maintain balance. When on a slope, make sure your footing is solid. Please walk and do not run during operation.
2. After stopping the lawn mower, make sure all moving parts have come to a complete stop:
 - -When placing the lawn mower;
 - Before clearing blockages or unclogging chutes;
 - - Before inspecting, cleaning or handling the machine;
 - -After hitting a foreign object.
3. Do not operate the lawn mower if the protective cover or isolation cover is damaged, or if safety devices (such as spark guards and/or straw baskets) are not in place.
4. Please avoid using the lawn mower in bad weather (especially lightning weather).
5. Always wear eye protection and sturdy shoes when operating a lawn mower.
6. Only operate this lawn mower in adequate or well-lit conditions.
7. Turn on the lawn mower carefully according to the operating instructions and keep your feet away from the blades.
8. Be careful to avoid injuring your feet and hands with the lawn mower blades.
9. Make sure the vents are clear of any debris.
10. When mowing sloped lawns, do not move up and down. Always use caution when changing direction on an incline. Do not mow steep slopes.
11. Always use caution when reversing or pulling the lawn mower toward itself.
12. Stop the blades if you must tilt the mower to move the mower over non-turf surfaces and when entering or exiting the work area.
13. Except when it is necessary to

Inspect the lawn mower for damage and repair it before restarting and operating the machine.

- -When the lawn mower starts to vibrate abnormally.

tilt the lawn mower to start, do not tilt the lawn mower when turning on the motor. When it is necessary to tilt the lawn mower, do not tilt it any more than necessary and only lift the part that is far away from the operator. When placing this lawn mower back on the ground, be sure to keep your hands in the operating position.

14. Keep hands and feet away from or under rotating parts. Do not stand in direct line with the discharge opening at any time.
15. Do not carry the lawn mower when it is on.
16. Avoid operating the lawn mower on wet grass.
17. Be sure to hold the handle tightly.
18. When moving or holding the lawn mower, do not grasp the exposed blades or cutting edges.
19. Keep hands and feet away from rotating blades.
20. If you find any abnormality, please stop the operation immediately. Turn off the lawn mower. Then check the lawn mower.
21. If your lawn mower has a cutting height adjustment feature, do not adjust the cutting height while the mower is running.
22. Before crossing a driveway, sidewalk, road, or any gravel-covered surface, release the switch lever and wait for the blades to stop spinning. Always stop the lawn mower when positioning it, picking up foreign objects in the mowing path, or in any situation that may cause distraction.
23. If the lawn mower hits a foreign object, please perform the following steps:
 - Stop the lawnmower, release the switch handle and wait for the blades to come to a complete stop.
 - Remove the battery pack.
 - Check the lawn mower thoroughly for damage.
 - If the blade is damaged in any way, replace it. Repair any damage before restarting and continuing to operate your lawn mower.
24. Do not start the lawn mower while standing in front of the discharge outlet.
25. If your lawn mower starts vibrating abnormally (check immediately)
 - Check for damage;
 - Replace or repair any damaged parts;
 - Check and tighten loose parts.
26. Never direct discharged material at anyone. Avoid discharging material into walls or obstructions. Material may rebound toward the operator. Stop the blade when passing through gravel surfaces.
27. Do not pull the trimmer back unless absolutely necessary. When you have to pull the lawn mower from behind a fence or other similar obstacle, watch your feet and behind you before and during the move.
28. Before removing the grass collector, turn off the motor and

wait for the blades to come to a complete stop. Be careful as the blade will still rotate after shutting down.

29. When using the machine on muddy ground, wet slopes or slippery areas, be sure to have a firm footing.
30. Avoid working in harsh environments that may increase user fatigue.
31. Do not use the machine in inclement weather with limited visibility. Otherwise, poor vision may lead to falls or incorrect operation.
32. Please do not immerse the machine in puddles
33. When wet leaves or dirt stick to the nozzle (ventilation window) due to rain, remove them.
34. Do not use the machine in the snow.
35. If the cut grass becomes wet, it may become clogged inside the machine. Check the condition of the machine regularly and remove adhering grass if necessary.
36. Be aware of pipes and wires when operating the machine.
37. Do not use corded power sources, such as battery-to-battery adapters or portable power supplies, with this machine. Such power cables may impede operation and cause personal injury.

Storage

1. For safety reasons, replace worn or damaged parts. Use only original genuine

replacement parts and accessories.

2. Regularly inspect and maintain your lawn mower.
3. When not in use, store the lawn mower out of the reach of children.
4. Make sure all nuts, bolts and screws are tightened and the equipment is in safe working condition.
5. Check the straw basket frequently for wear or deterioration. Always make sure to empty the straw basket when storing. For safety reasons, please replace worn straw baskets with new original factory replacement straw baskets.
6. Please use only genuine blades specified in this manual.
7. Use caution when adjusting the lawn mower to prevent fingers from getting caught between the moving blades and the fixed parts of the lawn mower.
8. Check the blade mounting bolts frequently to ensure they are properly tightened.
9. Be sure to allow the lawn mower to cool down sufficiently before storing.
10. Please note that when servicing the blade, the blade can still move even if the power is turned off.
11. It is strictly prohibited to remove or modify safety devices. Check regularly for proper operation. It is strictly prohibited to interfere with the intended functions of safety devices or reduce their protective capabilities.

12. Do not leave the machine unattended outdoors on rainy days.
13. Do not use high-pressure water to clean the machine.
14. When cleaning the machine, be sure to remove the battery and lock key, close the battery cover, and then flush water toward the bottom of the machine where the blades are installed.
15. When storing the machine, keep it out of direct sunlight and rain, and store it in a location where it will not get hot or humid.
16. Perform inspection or maintenance in a location where you will not be exposed to rain.
17. After using the machine, remove stuck dirt and dry the machine thoroughly before storing. Depending on the season or region, there is a possibility of malfunction due to freezing.

Battery tools usage and precautions

1. Only use the charger specified by the manufacturer. A fire hazard may occur when a charger designed for one type of battery pack is used with another battery pack.
2. Only use power tools with dedicated battery packs. Use of other battery packs may create an injury and fire hazard.
3. When the battery pack is not in use, keep it away from other metal objects such as paper clips, coins, keys, nails, screws, or other small metal objects that could prevent one end of the battery pack from connecting to the other. A short circuit at the battery pack terminal may cause

burning or fire.

4. Under conditions of abuse, liquid may spill from the battery pack; contact should be avoided. If liquid accidentally comes into contact, rinse with water. Also seek medical help if liquid contacts eyes. Liquids spilled from the battery may corrode or ignite.
5. Do not use damaged or modified battery packs or tools. Damaged or modified battery packs may behave unpredictably, resulting in fire, explosion, or injury.
6. Do not expose battery pack to fire or high temperatures. Battery packs may explode if exposed to fire or temperatures above 130°C.
7. Follow all charging instructions. Do not charge the battery pack or power tool outside the temperature range specified in the instructions. Charging incorrectly or outside the specified temperature range may damage the battery and increase the risk of fire.

Electrical and battery safety

1. Do not dispose of batteries in fire. Otherwise it may cause the battery to explode. Please check local regulations for appropriate special handling instructions.
2. Do not open or disassemble the battery. Spilled electrolyte is corrosive and may cause damage to eyes or skin. There is a risk of poisoning if

swallowed.

3. Do not charge in the rain or humid places.
4. Do not charge the battery outdoors.
5. Do not handle the charger, including the charger plug and charger terminals, with wet hands.
6. Do not replace batteries in the rain.
7. Do not wet the battery terminals with water or other liquids, or immerse the battery in water. Do not expose the battery to rain, and do not charge, use, or store the battery in a wet location. If the battery terminals become wet or liquid enters the battery, the battery may short circuit, resulting in overheating, fire, or explosion hazard.
8. After removing the battery from the machine or charger, be sure to install the battery cover on the battery and store it in a dry place.
9. Do not replace batteries with wet hands.

Repair

1. Have your power tools serviced by a professional repairman using the same spare parts. This will keep the power tool being repaired safe.
2. Never repair a damaged battery pack. The battery pack may only be repaired by the manufacturer or its authorized service provider.

Keep this manual

 **WARNING:** Do not refrain from strictly following relevant product safety rules for the sake of convenience or due to sufficient familiarity with the product (experience gained due to repeated use).

Improper use or failure to follow the safety rules in the instruction manual can result in serious personal injury.

Important safety precautions for battery

1. Please read all instructions carefully before using the battery pack.
2. Never disassemble or modify the battery pack. Otherwise it may cause fire, overheating or explosion.
3. If the machine running time becomes too short, stop using it immediately. Failure to do so may result in overheating, fire or even explosion.
4. If electrolyte gets into your eyes, rinse them with clean water and seek medical attention immediately. Failure to do so may result in visual impairment.
5. Do not short circuit the battery pack:
 - (1) Do not allow any conductive material to come into contact with the terminals.
 - (2) Avoid placing battery packs in the same container with other metal objects such as nails, coins, etc..

- (3) Do not place the battery pack in water or expose it to rain.

A short circuit in the battery will produce a large current, causing overheating and possibly fire or even breakdown.

6. Do not store or use tools and battery packs in locations where temperatures may reach or exceed 50°C (122°F).
7. Do not incinerate the battery pack even if it is severely damaged or completely worn out. Battery packs can explode in fire.
8. Do not shoot nails into the battery pack, or cut, squeeze, throw, drop the battery pack, or hit the battery pack with hard objects. Otherwise it may cause fire, overheating or explosion.
9. Do not use damaged batteries.
10. The lithium-ion battery included with this tool is required to comply with hazardous materials regulations.

When commercial transportation is carried out by third parties or forwarding agents, special requirements for packaging and labeling should be followed. Consult a hazardous materials professional regarding preparations for your transportation project. Also, please comply with state regulations that may be more detailed.

Please use tape to protect and not cover the contact information on the surface, and seal the battery securely so that the battery cannot move within the

package.

11. When discarding the battery pack, remove it from the tool and dispose of it in a safe area. Please follow local regulations on how to dispose of used batteries.
12. Use batteries only with designated products. Installing batteries into incompatible products can cause fire, overheating, explosion, or electrolyte leakage.
13. If the tool is not used for a long time, the battery must be removed from the tool.
14. During and after use of the tool, the battery pack may become hot and may cause burns or low-temperature burns. Use caution when handling hot battery packs.
15. Do not touch the tool's terminals immediately after using the tool, as this may cause burns.
16. Avoid getting sawdust, dust, or dirt into the terminals, holes, and grooves of the battery pack. Failure to do so may result in reduced performance or malfunction of the tool or battery pack.
17. Do not use the battery pack near high-voltage power lines unless the tool is supported for use near high-voltage power lines. Failure to do so may cause tool or battery pack failure or malfunction.
18. Keep batteries away from children.

⚠ CAUTION: Use only original batteries. Use of non-original batteries or modified batteries may cause the battery to explode, causing fire, personal injury, or property damage.

Keep this manual

Tips for maintaining maximum battery life

1. Charge the battery pack promptly before it is completely depleted. When you find that the power of the tool is low, stop operating the tool and recharge the battery pack.
2. Do not recharge a fully charged battery pack. Overcharging will shorten the battery life.
3. Please charge the battery pack at room temperature between 10 °C - 40 °C (50 °F - 104°F). Please wait for the hot battery pack to cool down before charging.
4. When the battery pack is not in use, remove it from the tool or charger.
5. If the battery pack has not been used for a long time (more than six months), recharge it.

Assembly

⚠ WARNING: Always remove the battery pack before performing any assembly on the lawn mower. Failure to remove the battery pack may cause unexpected start-up, resulting in serious personal injury.

⚠ WARNING: Only start the lawnmower after complete assembly. Operating the machine partially assembled may result in serious personal injury due to accidental start-up.

Install handrails

1. Thread the lower push rod assembly and the locking washer onto the screw in sequence, then install the cylindrical nut into the locking trigger, and finally use the locking trigger to thread the stud and tighten it clockwise (you need to hold the lower part when tightening Push rod), install the other side after one side is installed.

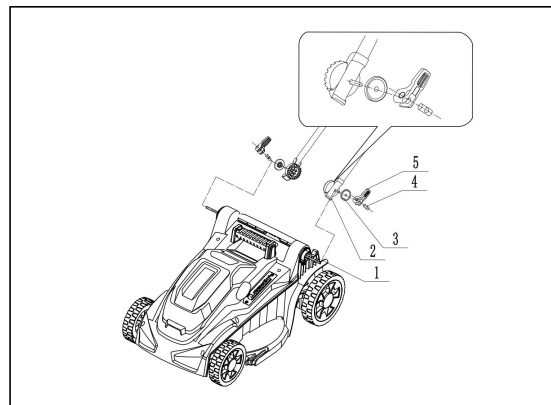

- 1. Screw 2. Lower push rod assembly 3. Locking washer
4. Cylindrical nut 5. Locking trigger

2. Install the upper armrest assembly into the inside of the lower armrest, align it with the mounting holes, pass the round-head studs through the mounting holes, then insert the locking washers from the outside, and finally use the locking trigger to thread the round-head studs and secure them. Tighten clockwise and install the other side after one side is installed.

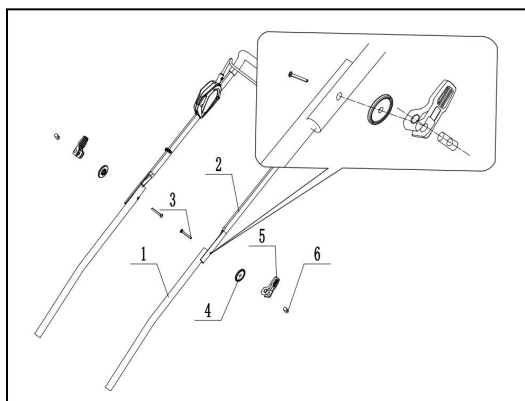

- ▶ 1. Lower push rod 2. Handrail assembly 3. Round head stud
- 4. Locking washer 5. Locking trigger 6. Cylindrical nut

CAUTION: Hold the upper handle firmly to prevent the lawn mower from slipping out of your hands. Otherwise the handle may fall and cause personal injury.

3. Install the mounting bracket to the handle.

Align the tab on the mount with the hole in the handle, making sure the tab fits into the hole.

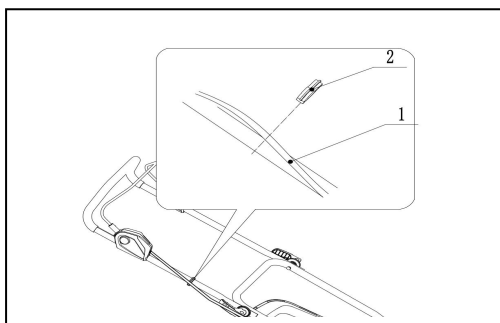

Install or remove straw basket

Please follow the steps below to install the straw basket.

1. Install the grass collecting frame into the grass collecting box cover bracket slot according to the arrow card and place it flat in place, then insert the screw into the flat washer and use a screwdriver to screw the screw into the column until it is tightened.

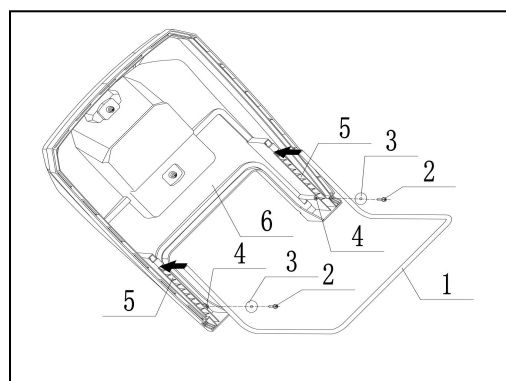

- ▶ 1. Grass collecting rack 2. Screw
- 3. Flat washer 4. Screw column 5. Bracket slot 6. Grass collecting box cover.

1. Hang the three hooks of the straw collection bag on the iron frame of the straw collection basket respectively.

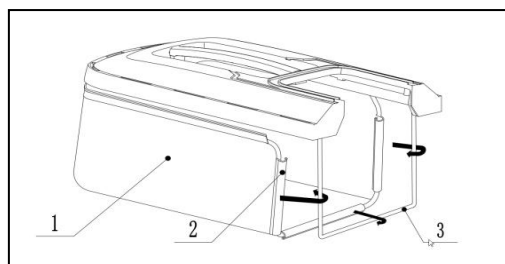

- ▶ 1. Grass collection bag 2. Hook 3. Grass collection basket iron frame
2. Completely install the grass collection bag clip into the grass collection cover slot in the direction

of the arrow.

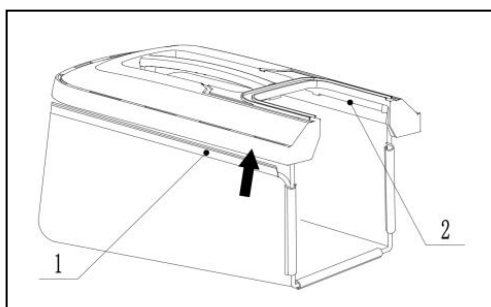

3. Open the back cover

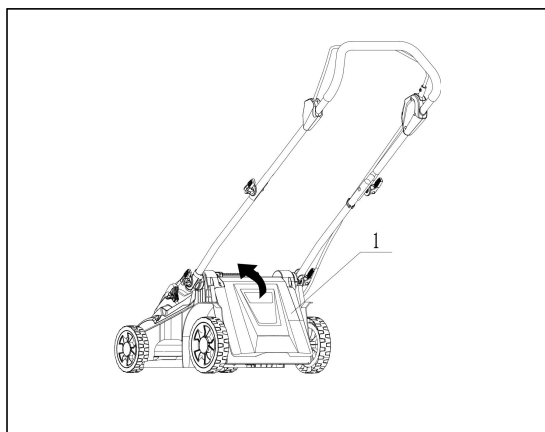

► **1. Back cover**

4. As shown in the picture, hold the handle of the grass basket, and then hang the grass basket hook on the pole of the lawn mower body.

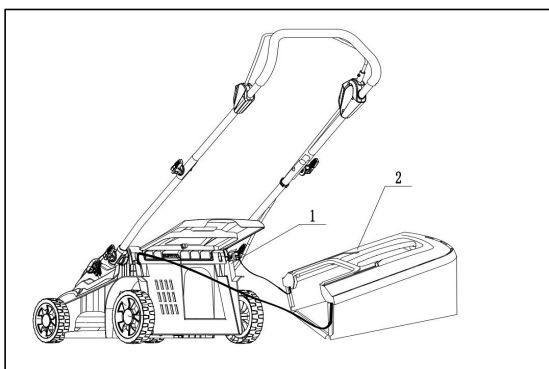

NOTE: If you use a grass collection basket, you need to remove the grass blocking head first. For instructions, please refer to **Installing and Removing the Grass Blocking Head**.

► 1. handle 2. straw basket
If you need to remove the straw

basket, please open the back cover first, then hold the handle to remove the straw basket.

Install or remove grass blocking head

Please follow the steps below to install the grass blocking head

1. Open the back cover.

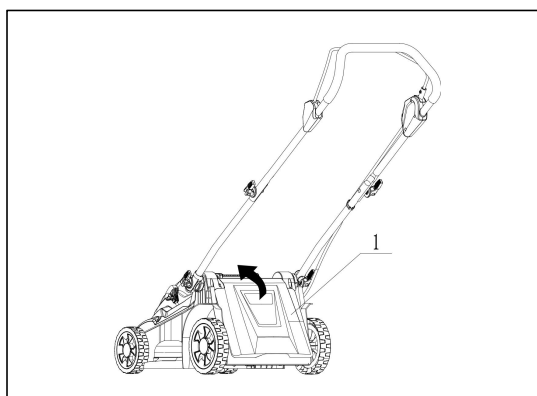

► **1. Back cover**

2. As shown in the picture, hold the handle of the grass blocking head, and then install the grass blocking head on the lawn mower according to the holes and slots on the body.

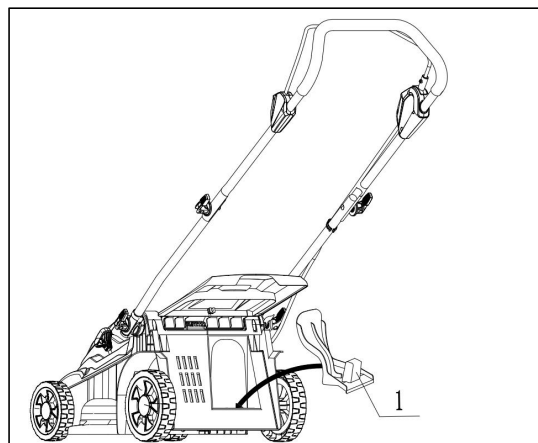

► **1. Grass blocking head 2. Body holes and card slots**

If you need to remove the grass-blocking head, please open the back cover first, then hold the handle of the grass-blocking head and remove the grass-blocking head.

Function

Installing or removing battery packs

⚠ CAUTION: Always turn off the power to the machine before installing or removing the battery pack.

⚠ CAUTION: Hold the machine and battery pack firmly when installing or removing the battery pack. Otherwise they may slip from your hands, causing damage to the machine and battery pack, or even personal injury.

⚠ CAUTION: Always lock the battery cover before use. Prevent mud, dust or water from entering and causing damage to the product or battery pack.

⚠ CAUTION: Be sure to insert the battery pack completely until the red indicator light is no longer visible. Otherwise, it may accidentally become detached from the machine, causing injury to yourself or others.

⚠ CAUTION: Do not force the battery pack to install. If the battery pack is difficult to insert, it may be inserted incorrectly.

Note: The machine will not work when only a single battery pack is installed.

Install battery pack:

1. Pull the battery cover handle, and then open the battery cover.

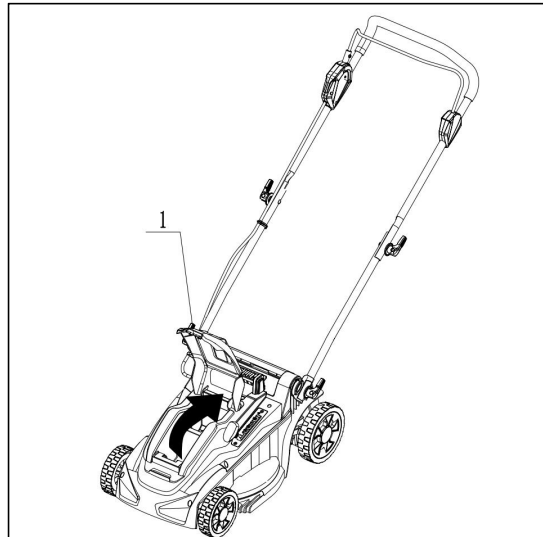

► 1. Battery cover handle

2. Align the slot on the battery pack with the slot on the rear battery compartment of the machine (the front battery compartment is the spare battery compartment), and then slide the battery pack until the battery pack is locked in place and makes a click sound.

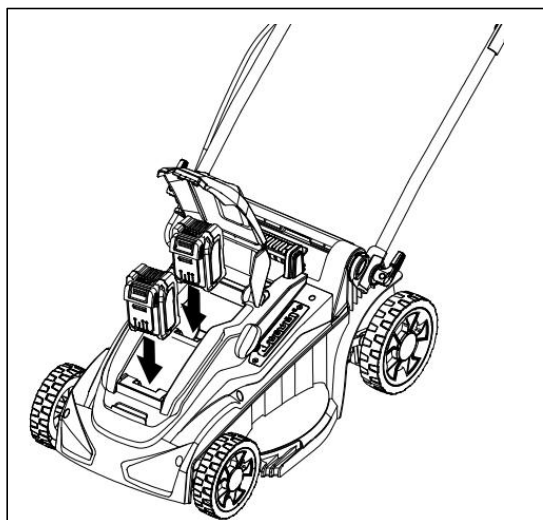

► 1. Battery pack 2. Battery port
3. Close the battery cover.

Remove the battery pack:

1. Open the battery cover.
2. Press the button on the front of the battery pack and pull the battery pack out of the machine at the same time.
3. Close the battery cover.

Display remaining battery power

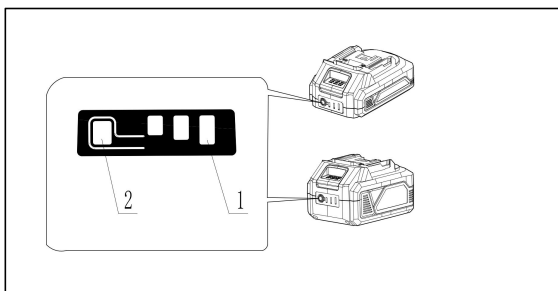

► 1. Indicator 2. CHECK button

Press the CHECK button on the battery pack to display remaining battery power. The lights will light up sequentially for a few seconds.

Indicator light			Remaining
light up	light off	flashing	
■	□	▧	80% to 100%
■ ■ ■			
■ ■ ■	□		50% to 75%
■	□ □		25% to 50%
▧	□ □		Need charge
▧ ▧ ▧			The battery may have problem

	<p>The battery may have problem</p>
--	-------------------------------------

NOTE: Under different usage conditions and ambient temperature, the power indicated by the indicator light may be slightly different from the actual situation.

NOTE: When the battery protection system is activated, the first (leftmost) indicator light will flash.

Machine/battery protection system

This machine is equipped with a machine/battery protection system. This system automatically cuts power to the motor to extend machine and battery life. When working, if the machine or battery is in any of the following conditions, the tool will automatically stop running:

Overload Protection

If the operation of the battery causes the current to be abnormally high, the machine will automatically stop running and the main power indicator light will flash green. In this case, shut down the machine and stop the application that is overloading the machine. Then turn on the machine and restart.

Overheating Protection

When the machine or battery overheats, the machine will automatically stop and the main power indicator will light up red. In this case, please wait for the machine and battery to cool down

before turning the machine back on.

Over Discharge Protection

When the battery power is low, the machine will automatically stop running and the main power indicator light will flash red. In this case, remove the battery from the machine and charge the battery pack, or replace it with a fully charged battery pack.

Switch Operation

⚠ Warning: Before installing the battery pack, be sure to check whether the switch handle can be pulled freely and whether it can return to its original position when released. If the switch on the machine does not work properly, it may cause the machine to lose control and cause serious personal injury.

Note: When the switch button is not pressed, the lawn mower will not start even if the switch handle is pulled.

Note: Attempting to mow grass that is too long or too thick at once may cause the lawnmower to overload and not start. In this case, increase the trimming height.

The lawn mower is equipped with a handle switch. If you notice any abnormality with the switch, stop operation immediately and have the tool inspected by an authorized service center.

1. Install the battery and close the battery cover.
2. While pressing the switch button, pull the switch handle toward you. Release the switch button when the motor starts running.

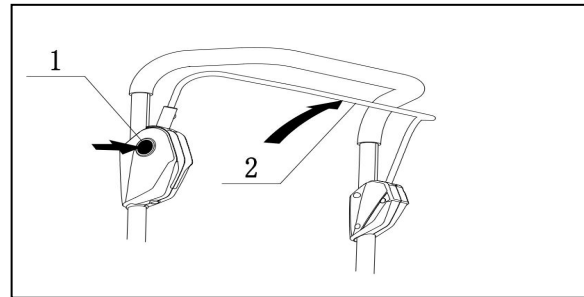

- 1. Switch button 2. Switch handle

3. Release the switch handle to stop the machine.

Adjust trimming height

⚠ WARNING: Never put your hands and legs under the mower body when adjusting the mowing height.

Warning: Please make sure the adjustment handle is correctly placed in the groove before operation.

You can adjust the trimming height from 0.984" to 2.95". Pull the mowing height adjustment handle toward the outside of the lawn mower and move it to the desired mowing height.

Note: 1st gear is the lowest gear, and 6th gear is the highest gear.

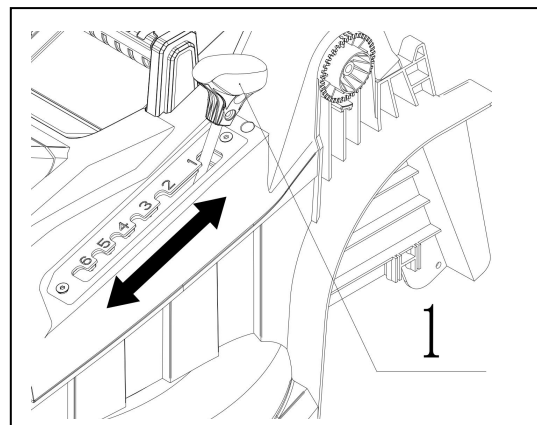

- 1. Trim height adjustment handle

Note: Please perform test trimming in an inconspicuous location to obtain the ideal trimming height.

Adjust handle height

The handle has three height adjustment positions.

1. Loosen the locking triggers on both sides counterclockwise.
2. Turn the push rod assembly in the direction of the arrow so that the arrow on the lower push rod assembly corresponds to the gear mark on the chassis to adjust the height of the handle.

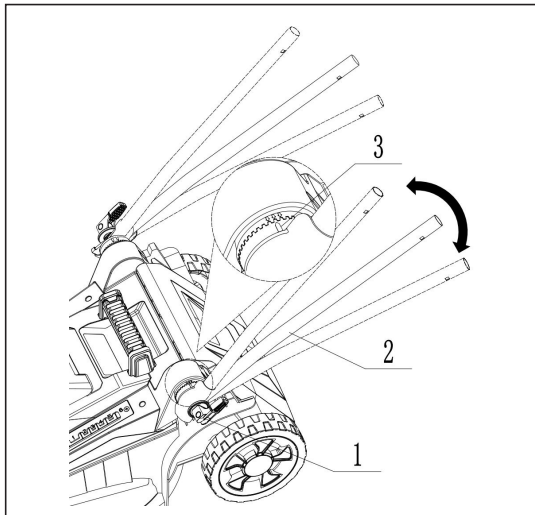

- 1. Lock trigger 2. Lower push rod 3. Gear mark

Grass mulching function

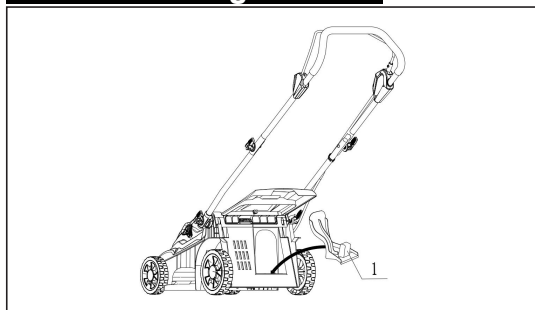

► grass blocking head

Remove the grass collection bag and install the grass blocking head. At this time, you can mow the grass

after installing the grass blocking head and cover the cut grass on the lawn.

Operation

Prune

⚠ WARNING: Before starting a pruning operation, clear the pruning area of branches and rocks. Also, remove any weeds from the mowing area beforehand.

⚠ WARNING: Always wear goggles with side shields or safety glasses before operating your lawn mower.

⚠ CAUTION: If cut grass or foreign objects become clogged inside the lawn mower, be sure to remove the battery pack and wear gloves before removing the grass and foreign objects.

Note: This machine is for lawn mowing only. Do not use this machine to mow weeds.



When mowing the lawn, always hold the handle firmly with both hands. The recommended mowing speed is about 7 to 14 meters per 10 seconds.

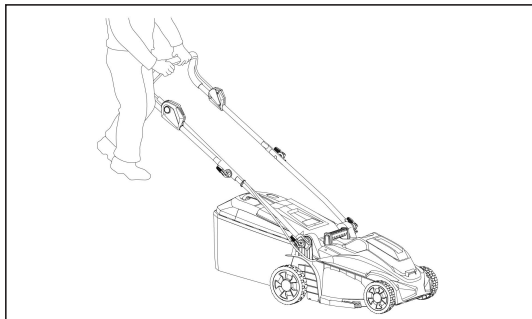

The center-line of the front caster is used as a reference line for trim width. Use these two center lines as a reference to perform long strip trimming. When mowing the next row, continue mowing from 1/2 to 1/3 of the width of the last mowing to evenly trim the lawn.

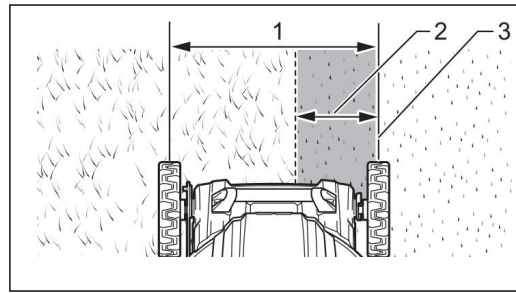

► 1. Trim width 2. Overlap area 3. Center-line

Check the grass in the grass basket regularly. Empty it before it is full. Before each scheduled inspection, be sure to stop the lawn mower, remove the lock key and remove the battery pack.

NOTE: Using the lawn mower with a full grass basket will prevent the blades from rotating and place additional load on the motor, which may cause the tool to break.

Mowing long grass lawn

Do not attempt to mow longer sections of grass in one go. Instead, mow your lawn in stages. Mowing can be done at intervals of one or two days until the lawn is of uniform height.

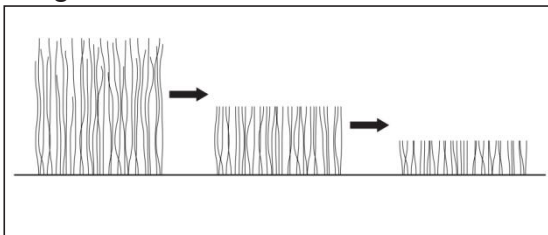

Note: Cutting longer grass shorter in one go may cause the grass to wilt. Cut grass may also clog the inside of the lawn mower body.

Empty straw basket

⚠ WARNING: To reduce the risk of accidents, regularly inspect the straw basket for damage or weakening. Replace if necessary.

1. Release the switch handle.
2. Remove the battery.
3. Open the back cover, hold the handle and take out the straw basket.

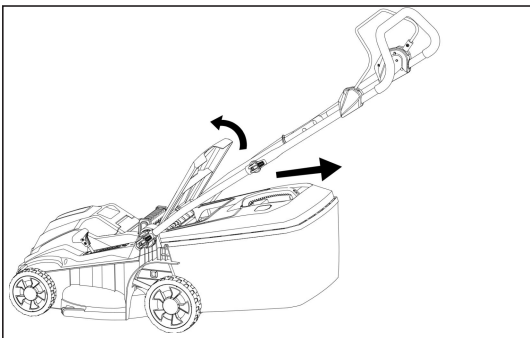

4. Empty the straw basket.

Maintenance

⚠ WARNING: Always remove the battery pack before storing, transporting the lawn mower, or attempting to perform inspection or maintenance.

⚠ WARNING: Wear gloves when performing inspection and maintenance operations.

⚠ WARNING: Always wear goggles or safety glasses with side shields when performing inspection or maintenance.

NOTE: Never use benzine, benzene, thinner, alcohol or similar materials to clean tools. Failure to do so may cause discoloration, deformation, or cracks in the tool.

In order to ensure the safety and reliability of the product, repairs and any other maintenance or adjustments must be completed by a service center. Always use original replacement parts.

Storage

1. Take out the battery pack and close the battery cover.
2. Place the lawn mower sideways so that the cutting height adjustment handle is on the upper side. Remove tangled grass that collects under the lawn mower fender.
3. Wipe and clean the bottom of the machine where the blade is installed.
4. Check and ensure that all nuts, bolts, screws, etc. are fully tightened.
5. Check the moving parts for damage, cracks and wear. Damaged or missing parts should be repaired or replaced.
6. Store the lawn mower in a safe place out of the reach of children.

Moving lawn mower

When transporting the lawn mower, hold the rear grip and the front grip under the front of the machine and lift the machine.

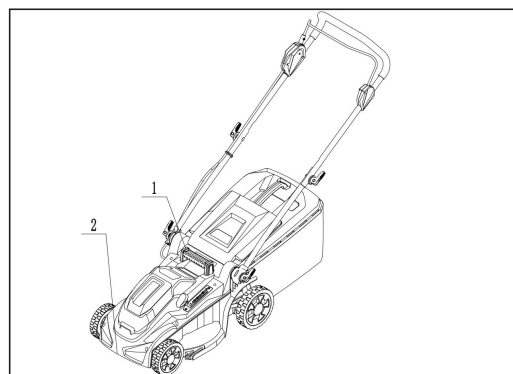

- ▶ 1. Rear grip 2. Front grip

Storage

Please store the lawn mower indoors in a cool, dry and locked place. Do not store the lawn mower and charger in places where temperatures may reach or exceed 40 °C.

Removing or installing lawn mower blades

⚠ WARNING: The blade will still spin for a few seconds after the switch is released. Never perform any operation until the blade has come to a complete stop.

⚠ WARNING: Always remove the battery pack when removing or installing the blade. Failure to remove the battery pack may cause serious personal injury.

⚠ WARNING: Always wear gloves when handling blades.

Remove lawn mower blades

1. Place the lawn mower sideways so that the cutting height adjustment handle is on the upper side.
2. Lock the blade and use the socket wrench 16 to turn the bolt counterclockwise.

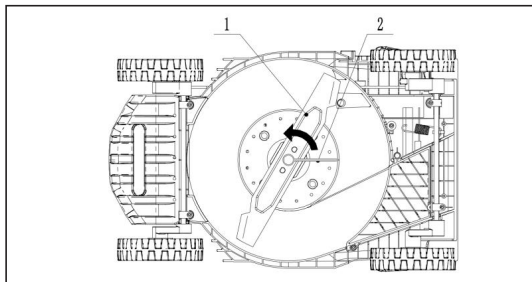

- ▶ 1. Blade 2. Socket wrench
- 3. Remove the bolts and then remove the lawn mower blade.

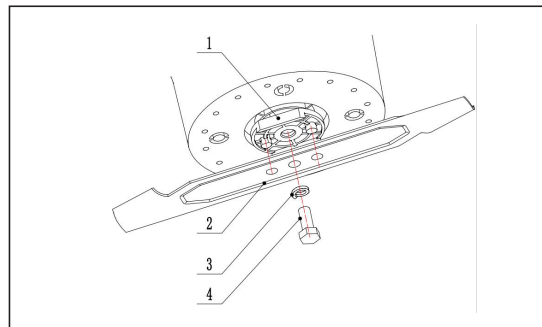

- ▶ 1. Knife holder 2. Blade 3. Spring washer 4. Bolt

Install lawn mower blades

⚠ WARNING: Use caution when installing lawn mower blades. Make sure it has the correct upper/lower orientation.

⚠ WARNING: Tighten the bolt clockwise to secure the blade.

⚠ WARNING: Make sure the lawn mower blades and all fasteners are properly installed and tightened.

⚠ WARNING: When replacing blades, always follow the instructions in this manual.

To install the lawn mower blade, follow the reverse steps to disassembly.

Troubleshooting

Please do your own inspection before requesting repairs. If you find a problem that is not explained in this manual, do not attempt to disassemble the machine. Please contact an authorized service center to use original replacement parts for repair.

Abnormal state	Possible cause (fault)	Corrective Action
Lawn mower won't start	The battery pack is not installed.	Install a fully charged battery pack
	Battery failure (under voltage)	Please charge the battery pack. If charging is ineffective, replace the battery pack
	Battery compartment is installed incorrectly	Use the compartment where the battery port of the battery pack is installed (rear compartment of the machine)
The motor does not rotate after being used for a period of time	battery is low	Please charge the battery pack. If charging is ineffective, replace the battery pack
	Cutting height is too low	Increase cutting height
	Cut grass clippings are clogged inside the lawn mower	Remove clogged grass clippings from your lawn mower
The motor does not reach the maximum speed	Improperly installed battery pack	Install the battery pack as described in this manual
	Battery power dropped	Please charge the battery pack. If charging is ineffective, replace the battery pack
	The drive system is not working properly	Please go to the local authorized service center for repair
Lawn mower blades not rotating: ⇒ Please stop the lawn mower immediately!	Foreign objects (such as tree branches) get caught next to the blade	Remove foreign matter
	The drive system is not working properly	Please go to the local authorized service center for repair
Abnormal vibration: ⇒ Please stop the lawn mower immediately!	The blade is unbalanced and has excessive or uneven wear	Replace the blade

GARVEE
support@garvee.com