

# ASSEMBLY INSTRUCTIONS

---

If you have any questions, please feel free to contact us.  
Email: [lowes.team@qualfurn.net](mailto:lowes.team@qualfurn.net)

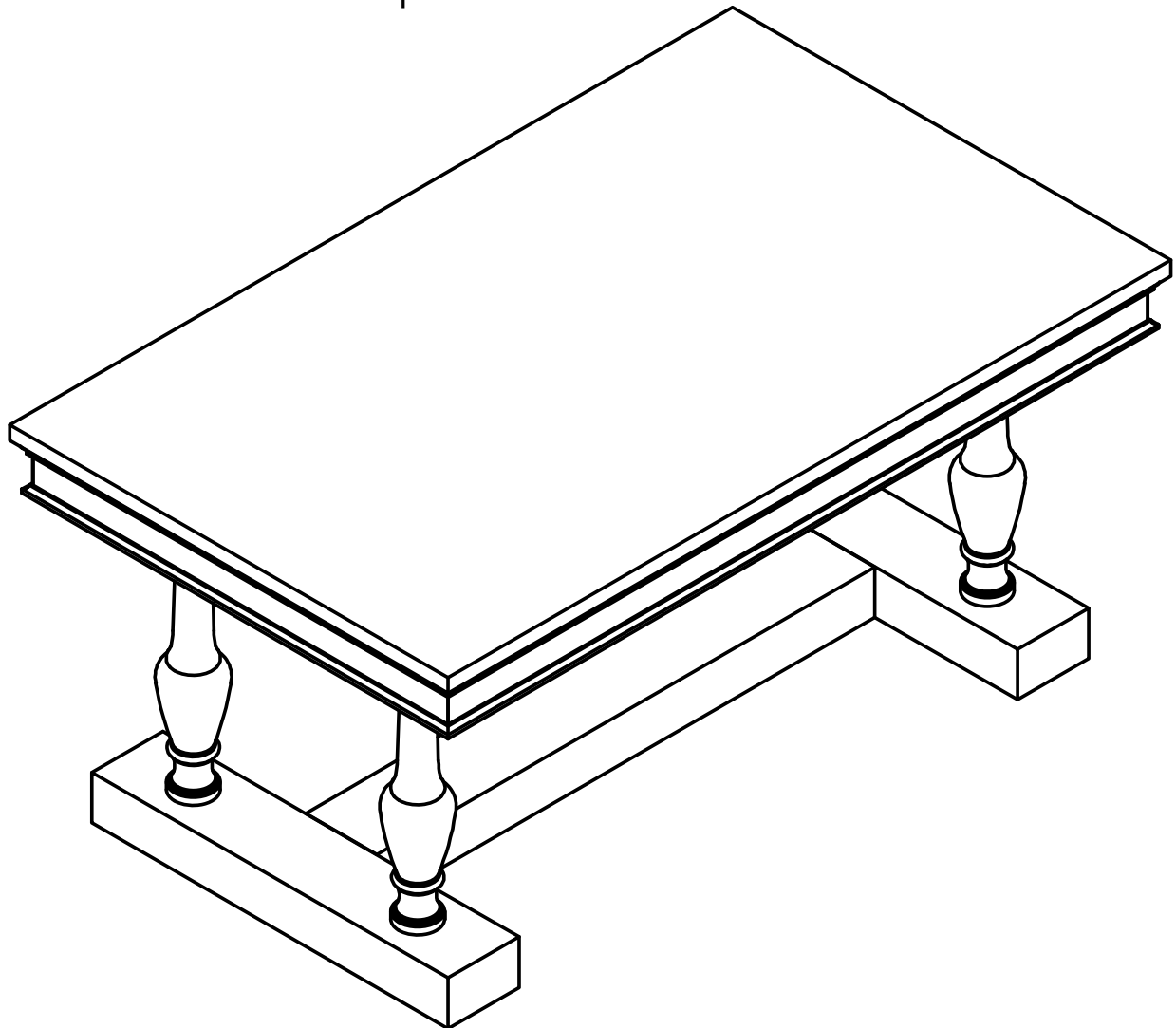

**WF315034AAB**  
**WF315034AAE**

# PRE ASSEMBLY INTRODUCTION

We understand building ready-to-assemble furniture can be a challenging experience for some. To help avoid confusion, we have provided some helpful tips that may speed up the process.

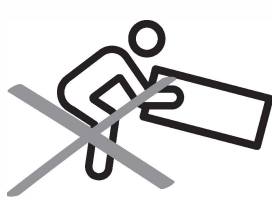

## Teamwork

ALWAYS have at least two people to help with transporting and assembling the product to avoid potential injury and/or damage.

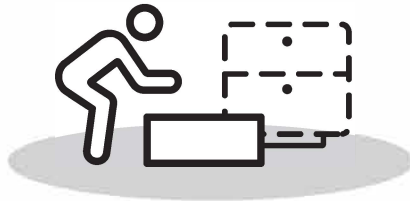
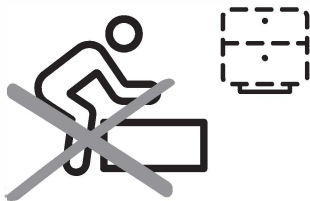

## Suitable Location

Assembling near the area of the intended location is highly recommended.



## Sufficient Space

Make sure you have enough space to move around during the assembly.



## Avoid Scratches

Use cardboard, blankets or a carpeted area while assembling furniture to prevent scratches.

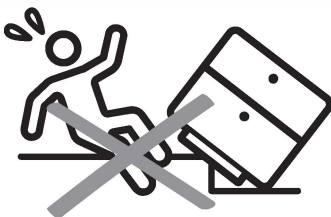

## Flat Surface

Make sure the furniture rests on a flat and level surface with each leg evenly touching the floor.

## PARTS

#A 1pc

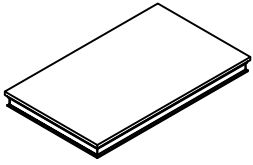
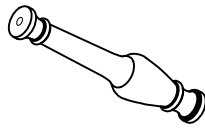

Table Top

#B 4pcs



Pedestal

#C 2pcs

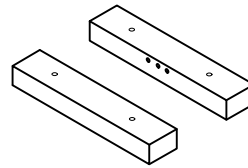
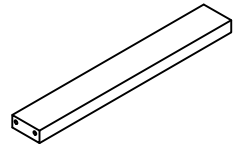

Table Base

#D 1pc



Cross Bar

#E 2pcs

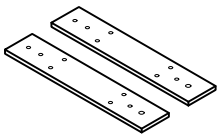

Mounting Plate

## HARDWARE

#1

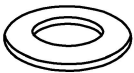

Flat Washer Ø5/16" x 24pcs

#2



Lock Washer Ø5/16" x 24pcs

#3



Bolt Ø5/16" x 2" x 24pcs

#4



Allen Key 4mm x 1pc

# ASSEMBLY INSTRUCTIONS

## Step 1

Part (#E) 2pcs

Part (#B) 4pcs

Hardware (#1) 4pcs

Hardware (#2) 4pcs

Hardware (#3) 4pcs

Attach Mounting plate (#E) on the Pedestal (#B) by using Flat washer (#1), Lock washer (#2), Bolt (#3) with Allen key (#4).

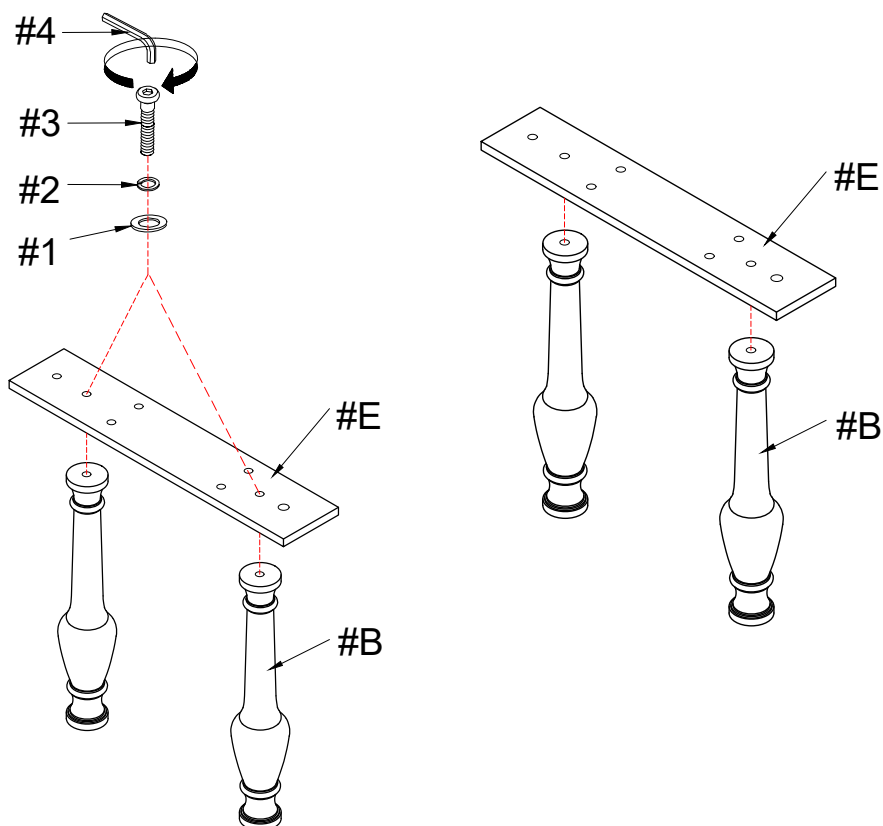

## Step 2

Part (#C) 2pcs

Part (#D) 1pc

Hardware (#1) 4pcs

Hardware (#2) 4pcs

Hardware (#3) 4pcs

Attach Cross bar (#D) on the Table base (#C) by using Flat washer (#1), Lock washer (#2), Bolt (#3) with Allen key (#4).

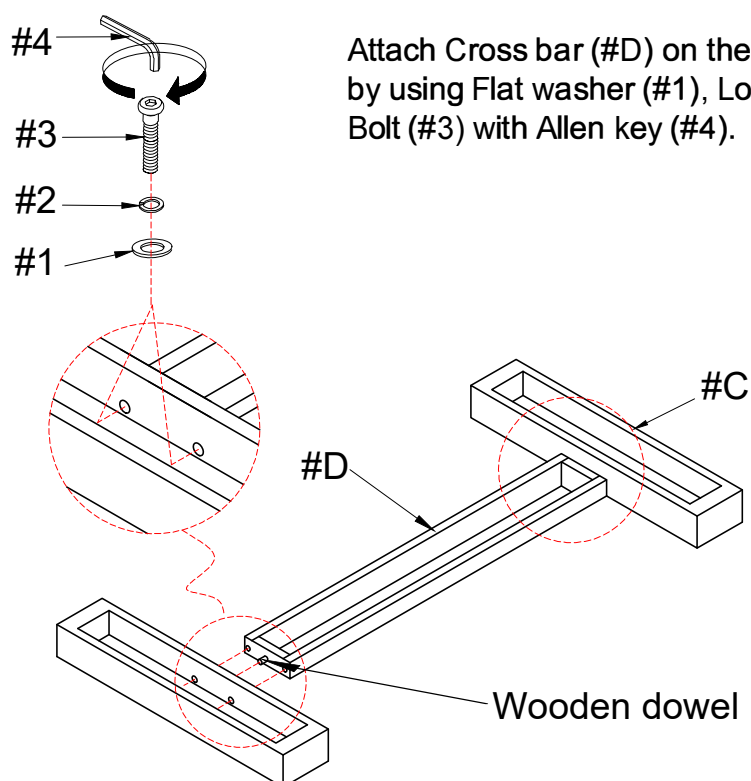

# ASSEMBLY INSTRUCTIONS

## Step 3

Part **#A** 1pc

Hardware **#1** 12pcs

Hardware **#2** 12pcs

Hardware **#3** 12pcs

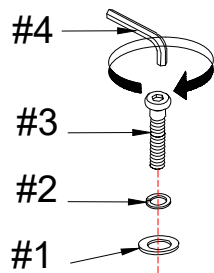

Attach Mounting plate (**#E**) with the Pedestal (**#B**) on the Table top (**#A**) by using Flat washer (**#1**), Lock washer (**#2**), Bolt (**#3**) with Allen key (**#4**).

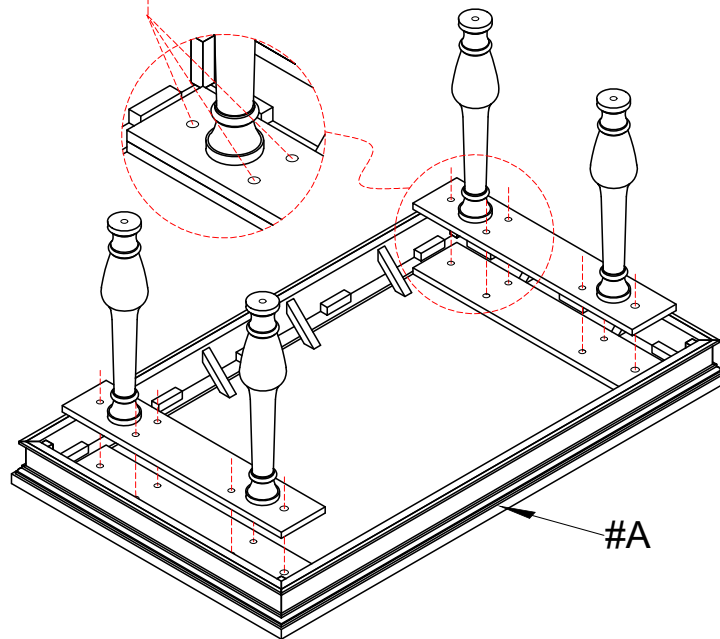

## Step 4

Hardware **#1** 4pcs

Hardware **#2** 4pcs

Hardware **#3** 4pcs

Attach Cross bar (**#D**) with the Table base (**#C**) on the Pedestal (**#B**) by using Flat washer (**#1**), Lock washer (**#2**), Bolt (**#3**) with Allen key (**#4**).

