

Troubleshooting:

Your fan may occasionally jerk forward and backward upon start up. This is normal and does not affect fan operation.

Try these troubleshooting steps before contacting Customer Service.

Issue	Solution
<p>The fan will not start.</p>	<ol style="list-style-type: none"> 1. Make sure the fan is receiving power. 2. Check your circuit breaker or fuse panel and wall switch for functionality. 3. Make sure the fan is properly wired and grounded. Check all connections for any damaged, broken, or frayed wires. 4. Make sure the plastic film in the remote's battery tray has been removed. 5. Remote control must be paired within 10 mins of connecting ceiling fan to power source. 6. Check to make sure remote control is correctly paired. 7. Any wires connecting ceiling fan to power source must be in ON position. app, check to see if the app is able to find the fan. 9. If you have paired the remote or the app and the fan still does not start, then try to reset the fan: To reset the fan, cut the power for 10 minutes, then turn the power on and press the pairing button  on the remote for 5 seconds until "beep", then pair the app again to reconnect.
<p>The fan wobbles and noisy</p>	<ol style="list-style-type: none"> 1. Blade screws with the plastic round part against the motor or not. 2. Check all the pin wire connect against the moving part. 3. Check the down fan cup hit the motor. 4. The light kit slanting. 5. Check the down rod slanting or not. 6. Make sure the colour sticker on the motor and blades match each other. 7. Turn off the fan then make the fan running by hand and listen still have noise or not. 8. Take out the middle black cover on the light kit and check the middle big nut loose or not. 9. When the fan running, touch the light kit by hand, try to make the light kit stable. 10. Check the downrod and pivot ball hanging on the bracket if it is seated correctly and in the retention slot. 11. Check all mounting points and bracket to see if there are any screws loose. 12. The ceiling beam must meet the tensile test strength of 30KG for installation. 13. Make sure the airfoils or brackets have not been bent or deformed.
<p>LED OFF</p>	<ol style="list-style-type: none"> 1. Make sure LED wires connect with the controller. 2. Make sure the whole fan is powered. 3. Make sure the remote control code is matching.
<p>Unable to pair remote and app</p>	<ol style="list-style-type: none"> 1. Check if the wires are connected in the right position or not. 2. Check the batteries on the remote. 3. Disconnect the power for 10 minutes, then reconnect the power and pair the remote with the fan again within 5 seconds. Also try to pair the app again to reconnect.
<p>Try these troubleshooting steps before contacting Customer Service. For additional operation, maintenance, and troubleshooting information, please contact our service center directly.</p>	

Ceiling Fan Installation Instructions

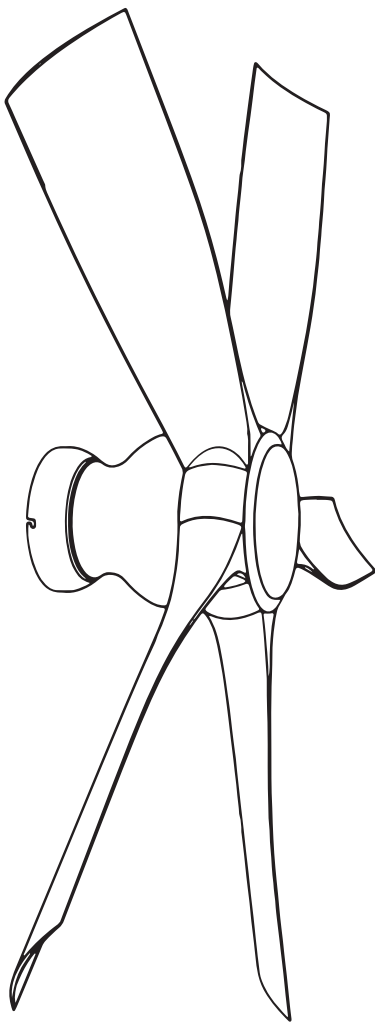

Five-leaf fan light

HQ98001

SAFETY PRECAUTION:

IMPORTANT: PLEASE READ BEFORE INSTALLATION:

1. Before you begin installing the fan, shut power off at the circuit breaker of the fuse box.
2. **CAUTION:** Read all instructions and safety information before installing your new fan. Review accompanying assembly diagrams.
3. Make sure that all electrical connections are in accordance with National Electrical Code, Hire a licensed electrician if you are unfamiliar with installing electrical wiring.
4. Make sure the installation site you choose allows the fan blades to rotate without any obstructions. Allow a minimum clearance of 2.1m (7 feet) from the floor and 18 inches from the tip of the blades to the wall.
5. **WARNING:** To reduce the risk of fire, electric shock, or personal injury, mount to outlet box marked "Acceptable for Fan Support of 22.7 kg (50 lbs) or less" and use mounting screws provided with the outlet box.
6. **CAUTION:** To reduce the risk of injury, use only the screws provided with the outlet box in conjunction with the lock washers provided with the fan.
7. The outlet box and support structure must be securely mounted and capable of reliably supporting a minimum of 35 pounds.
8. After you install the fan, make sure that all mounting components are secured to prevent the fan from falling.
9. Do not insert anything into the fan blades while the fan is operating.
10. To change the direction of the rotation of the blades the fan must be in operation mode.
11. All set screws must be checked and retightened where necessary before installation.

12. **WARNING:** To reduce the risk of personal injury, do not bend the blade bracket when installing the brackets, balancing the blades, or cleaning the fan. Do not insert foreign objects in between rotating fan blades.
13. **CAUTION:** To reduce the risk of electric shock, disconnect the electrical supply circuit to the fan before installing light kit.

14. After making the wire connections, the wires should be spread apart with the grounded conductor and the equipment-grounding conductor on one side of the outlet box and the ungrounded conductor on the other side of the outlet box.

15. The splices after being made should be turned upward and pushed carefully up into the outlet box. Conductor wiring identified as grounded is to be connected to a grounded conductor of power supply. Conductor wiring identified as ungrounded conductor is to be connected to an ungrounded conductor. Conductor wiring identified for equipment grounding is to be connected to an equipment-grounding conductor.

16. This device complies with part 15 of the FCC Rules. Operation is subject to the following two conditions: (1) This device may not cause harmful interference, and (2) this device must accept any interference received, including interference that may cause undesired operation.

WARNING: To reduce the risk of fire or electric shock, this fan must be installed with a general use, isolating wall control/switch.

WARNING: To reduce the risk of fire or electric shock, do not use this fan with any solid-state speed control device.

NOTE: The important safeguards and instructions appearing in this manual are not meant to cover all possible conditions and situations that may occur. It must be understood that common sense, caution and care are factors which cannot be built into this product. These factors must be supplied by the person (s) installing, caring for and operating the unit.

CAUTION: The light source is designed for this specific application and can overheat if serviced by untrained personnel. If any servicing is required, the product should be returned to an authorized service facility for examination or repair.

Remote control (Transmitter) operation

Plug the fan into the power supply, press the main off button "⏻", the pairing success will trigger the buzzer alarm. Button for 5 seconds. Pairing remote

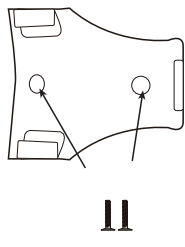
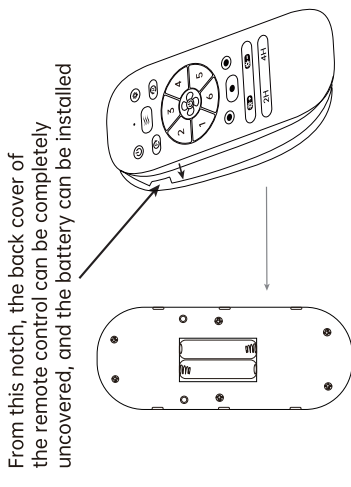
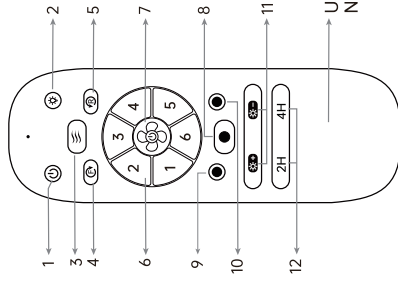

1. Main off button
2. Light switch
3. Natural wind
4. Forward rotation
5. Reverse rotation
6. Fan speed
7. Turn off the fan
8. Neutral light
9. Yellow light
10. White light
11. Brightness adjustment
12. 2/4 hour timer

Trouble Shooting

Fan does not work :

1. Check all fuses or circuit breakers if disconnecting the power supply to the fan.
2. Turn off electrical power and check all wire connections to fan and in switch housing. It must be carried out by a electrician.

Fan is noisy :

1. Assure that the screws fastening blade arm to motor are tight and the lock washers provided for that purpose have been used.
2. Lower the upper canopy to ensure a separation from the ceiling of no less than 3mm to reduce noisy.
3. Check to see if any of the blades are cracked. If so, replace all of the blades.
4. If this is the first use, leave the fan on for at least 8 hours. In the event that mechanical noise continues after this period, contact certified electrician.

CONNECT THE CABLES AND THE RECEIVER

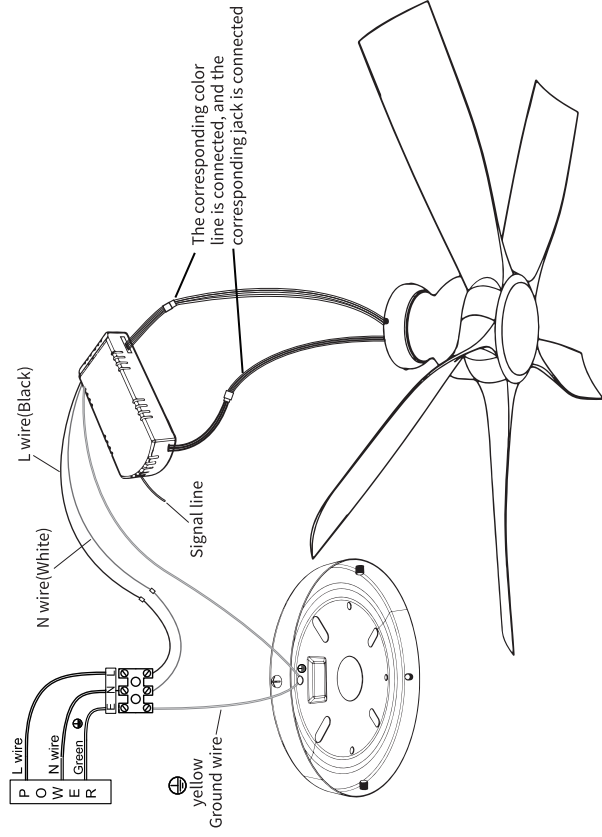

Installation is now complete. Turn on the power switch as **Fig 4.4**. Then the fan lights are on. Test and pair your fan immediately using the remote control.

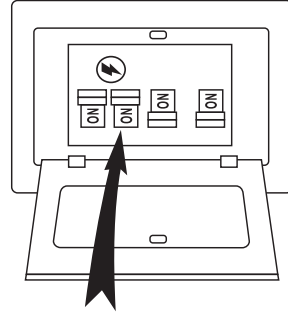
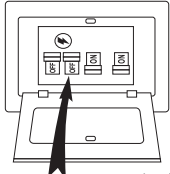

Fig 4.4

BEFORE YOU START

Contact a licensed electrician if you are uncomfortable performing electrical work. A licensed electrician must install the fan if required by local code. Do not use the fan with a dimmer switch. Turn off power at breaker.



Tools and Materials Required



Step ladder



Phillips screwdriver

Product instruction:

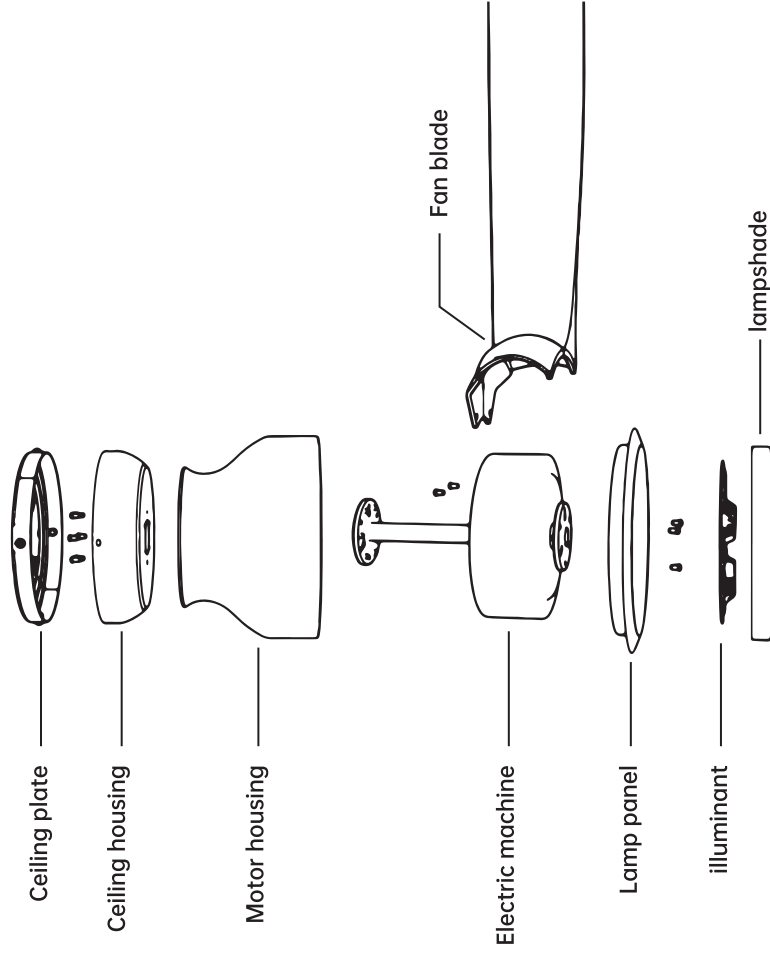

Screws bag

	1 pcs		3 pcs		2 pcs		2 pcs
	1 pcs		4 pcs		2 pcs		2 pcs

Installation:

1 Install fan blades

- 1.1 Remove motor housing and ceiling housing
- 1.2 Then fasten the fan blade with screws

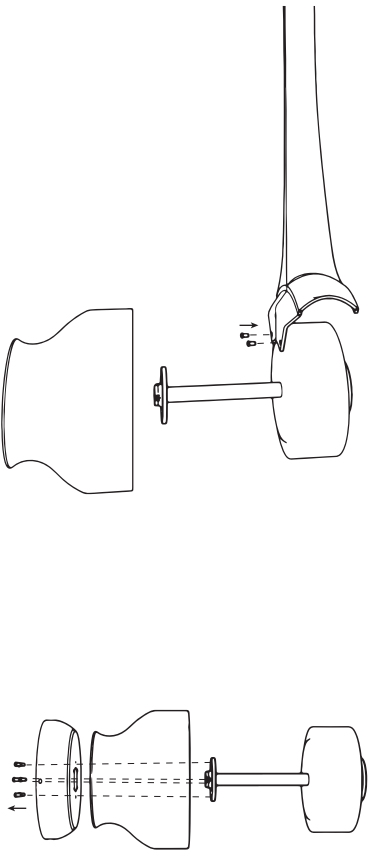

Fig 1.1

Fig 1.2

2 Install the fixing housing and light fixing panel

- 2.1 Secure the housing and motor with six screws
- 2.2 Three screws are required to install the lamp mounting panel

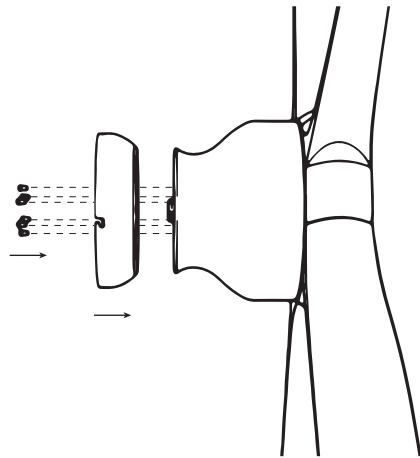

Fig 2.1

Fig 2.2

3 Installation of light sources and lampshades

- 3.1 Use a magnet to draw the light source to the lower part of the lamp panel
- 3.2 After the light source is installed, rotate the lampshade and snap it into the lamp tray

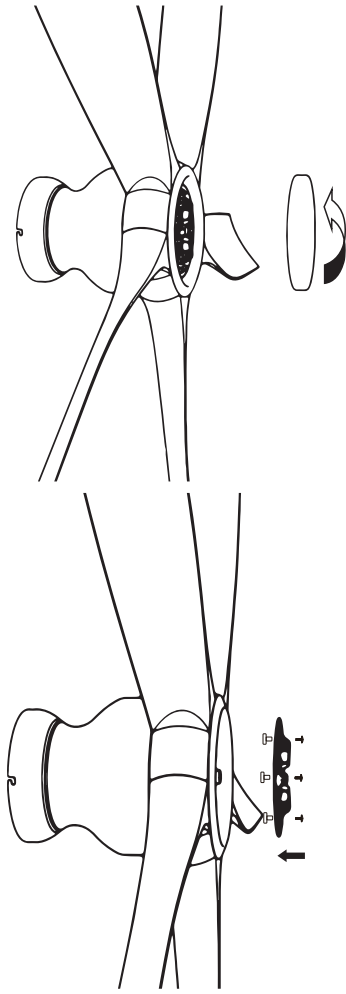

Fig 3.1

Fig 3.2

4 Fixing of the fan

- 4.1 Secure the ceiling bracket with screws
- 4.2 The rotating fixing alignment hole is fixed with screws

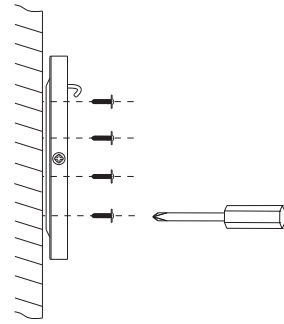

Fig 4.1

Fig 4.2