

# Installation Guide

## ONE-PIECE PEDESTAL SINK



### Tools and Materials



Safety  
Glasses



Pencil



Caulk

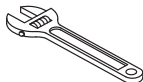

Wrench

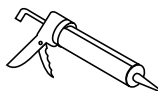

Construction  
Adhesive

### Prior to Installation



**Read the following instructions thoroughly before installation of the sink:**

1. Unpack the sink and inspect it for damage.
2. Observe all local plumbing and building codes.
3. Additional preparations on the floor and wall may be necessary to avoid product damage.
4. Confirm that the sink will fit in the intended location and that plumbing fixtures are located where legally required prior to installation.
5. Make sure to measure the actual dimensions of the sink prior to installation.
6. It's recommended that the sink be installed by two people.

### Installation Procedures



#### **STEP I.** Verify Sink Location

- Mark the location on the floor with a pencil where the sink is intended to be installed.

### STEP II. Install Plumbing

- Install the faucet as per the manufacturer's instructions. (faucet not included)
- Connect the plumbing pipes in the wall with the pedestal sink. (plumbing pipes not included)
- Test fit the pedestal sink before proceeding with the next step.

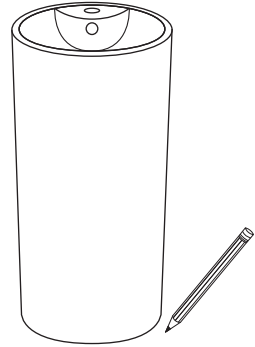

### STEP III. Seal Sink (2 People Required)

- Person 1 - Tilt the sink backward slightly so the pedestal sink partly lifts off ground.
- Person 2 - Apply construction adhesive underneath the sink.
- Lower the sink back to its standing position with care and apply a bead of silicone sealant between the floor and the sink.

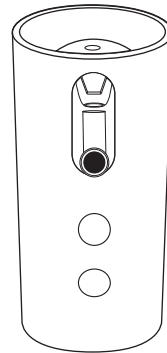

**NOTE** Allow the silicone up to 24 hours to fully dry before using the pedestal sink.

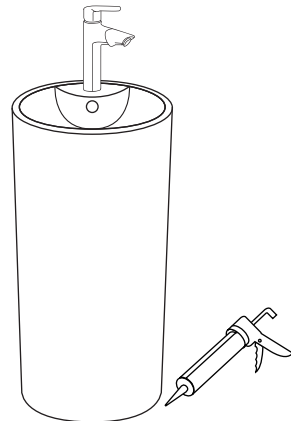
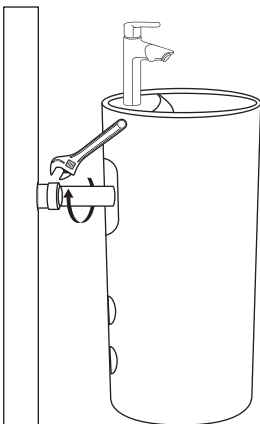

# Installation Guide