

版式设计要求：

1. 字体：标题为Myriad Pro Bold，内容为 Myriad Pro Regular；
2. 标注包装盒长宽高等尺寸，单位mm.

140mm

Waterdrøp

Pitcher replacement filter installation instructions

Model: WD-PF-01A Plus (indicator)

Filter life: Up to 200-gallon capacity. The actual result may vary according to the local water quality.



Tested and Certified by NSF International against **NSF/ANSI Standard 42** in model WD-PT-05P for the reduction of the claims specified on the Performance Data Sheet, and to **NSF/ANSI 372 (≤0.25% lead)**.

Installation instructions

- Step 1** Remove the old filter cartridge.
Step 2 Take out the new filter cartridge from the package. Soak the filter in cold water for 10 minutes. **[figure 1]**
Step 3 Install the new filter cartridge into the reservoir to ensure a tight seal. **[figure 2]**
Step 4 Fill the reservoir with cold tap water. Discard the first two pitchers of filtered water.
Step 5 Hold the button for 5 seconds until the blue light flashes to activate the filter life indicator.

NOTE: Repeat this step after each new filter replacement.

Tips: How to install the new filter life indicator?

1. Remove the old filter life indicator from the back of the lid. **[figure 3]**
2. Make sure to put the indicator in right position and keep the claws fully mounted in the clamping slot.
3. Hold the button for 5 seconds **[figure 4]**

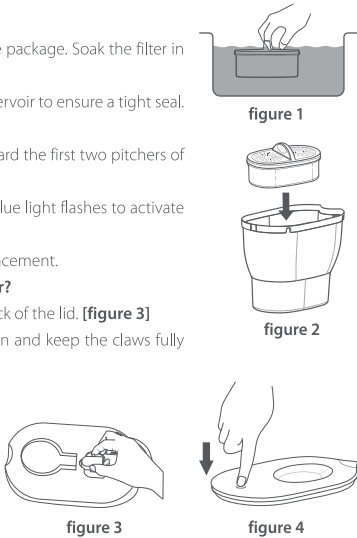

If you have filtered water to the maximum or the filter life indicator red light is on, whichever comes first, you should change your filter.

Status	Indication light	Remaining life(day)
Good	● Blue stay on for 5 seconds	> 10
Red Replace soon	● Red flash 6 times	≤10
Red Replace now	● Red stay on for 10 seconds	≤0

⚠ Warning

1. To reduce the risk of property damage due to water leakage, this filter **MUST** be installed in accordance with the manufacturer's specifications and instructions.
2. The operating temperature of this pitcher filtration system is 5-38°C/41-100°F.
3. Failure to follow instructions and operating specifications will void your warranty. Further, manufacturer assumes no responsibility or liability for damages arising out of misuse of the product.

Frequently asked questions:

Q: Why does the water flow get slow?

A: Please check the indicator to see if it's time to change the filter cartridge. If yes, please replace the cartridge immediately. If not, please try the following steps to slove the problem.



Option 1: Remove the filter and shake it horizontally in order to shift the granules inside.

Option 2: Remove the filter. Flush under flowing water for about 30 seconds to eliminate blockage of water outlets of the filter. Stop flushing and shake the filter horizontally. Then put the filter back in the pitcher.

210mm

Q: Why does the water taste bad?

A: The product is unclean, or the filter cartridge is not installed properly. It could also be time to change the filter cartridge. Please clean the pitcher and install the cartridge correctly or replace the filter cartridge.

Q: Why are there fine particles on the surface of the filter cartridge?

A: Fine particles are part of the filter material, which may leak out during long distance transportation due to shaking and other reasons. These particles will not have a negative impact on heath. In order to remove these fine particles, please follow the using steps of our products. Soak the filter in cold water for 10 minutes. Flush the filter twice. After flushing the filter, the pitcher can be used normally.

Performance data sheet

System Model No.: **WD-PT-05P**

Substance reduction:

The system has been tested and certified by the NSF International according to NSF/ANSI Standards 42, and 372. The concentration of the indicated substances in water entering the system was reduced to a concentration less than or equal to the permissible limit for the water leaving the system, as specified by NSF/ANSI Standards 42. While testing was performed under standard laboratory conditions, actual performance may vary.

Substance	Inf. Average	NSF Specified Challenge Concentration	Ave. % Reduction(%)	Average Product Water Concentration	Max Permissible Product Water Concentration	NSF Reduction Requirements	NSF Test Report
Chlorine Taste and Odor	2.0 mg/L	2.0mg/L±10%	96.7%	0.05mg/L	N/A	≥50%	J-00355920

⚠ Do not use with water that is microbiologically unsafe or of unknown water quality without adequate disinfection before or after the system. Systems certified for cyst reduction may be used with disinfected water that may contain filterable cysts.

Manufacturer Technical Support

Tel: +1-888-352-3558 (U.S.)
E-mail: CT@waterdropfilter.com

Made in China V050
Qingdao Ecopure Filter Co., Ltd.



⚠ 图像颜色请依据数码稿印刷
请不要擅自变更来稿件，如须修改，请联系伊可普做有关决定

印刷品技术要求 IMPORTANT PRINTING CAUTION

1. 印刷要求 □覆光膜 □覆亚膜 □UV油 □吸塑油 □过油 □丝印
2. 材质要求 80g双胶纸，双面印刷
3. 颜色要求 单色印刷
4. 版面要求 印刷品文字线条印迹清晰、无重影；印刷品套印准确无偏色、溢墨、指痕等；印刷品上光层均匀、光亮、牢固无粘连；覆膜表面平整、无褶皱、光泽度好；纸张材质正确，切边整齐、压线深浅适中、洁净、无斑点和条痕。

伊可普		青岛伊可普电器有限公司包材设计图纸	
品牌 BRAND NAME.	Waterdrop	工厂型号 ITEM NO.	ECF-7021
物料编码 INNER CODE.	03070207021CTW	版本号 VERSION.	V003
包材文件名称 FILE NAME.	03070207021CTW WD-PF-01A-PLUS-42-说明书(indicator)-V003		
规格 MEASURE.	140*210mm	页数 PAGE.	4P
设计负责人 DWG.BY	张鑫龙	审核日期 VERIFY DATE.	2022.8.31
变更日期 REVISIONS.	2022.8.30		
描述 DESCRIPTION.	安装步骤Step 5修改，指示灯寿命更改		