



Product Submittal	
Name	
Date	
Architect/Owner	
Contractor	
Tag	
Notes	

Compression Straight Stop Specification Sheet

Description

Used to control and shut off water flow to fixtures or appliances for maintenance and repair. Compression inlet connection makes for quick installation and quarter-turn, full-port brass ball valve makes for easy operation.



Features And Benefits

- Sleek chrome finish for an attractive appearance.
- Quarter-turn, full-port brass ball valve.
- Compatible with copper pipe.
- Can be installed in wet lines.

Specification Data

Materials	
Valve body	DZR LF brass
Knurled Handle	ABS
Valve ball	DZR LF brass
Seat	PTFE

Temperature Performance

- Minimum working temperature 33°F
- Maximum working temperature 160°F
- Maximum working pressure 125 psi

Flow Rate

- 3/8" Compression 4.0 GPM at 20 psi

Part Listing

- ☐ COMPS3838Z 3/8 in. OD compression x 3/8 in. OD compression
- ☐ COMPS1238Z 1/2 in. compression x 3/8 in. OD compression

Dimensions

Part Number	DIM A (IN)	DIM B (IN)
COMPS3838Z	1.00	2.09
CCOMPS1238Z	1.00	2.20

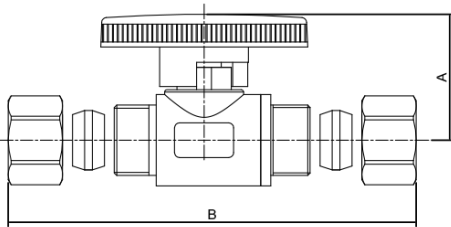

Codes and Listing

cUPC
 ASME A112.18.1
 CSA B125.1
 NSF/ANSI/CAN 61
 NSF/ANSI 372

