

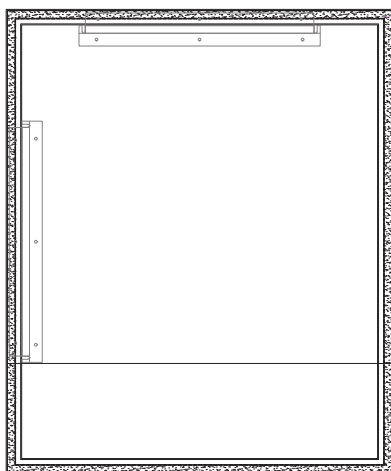

LED Backlit Mirror

Sizes: 24" W x 60" H (horizontal or vertical)
30" W x 36" H (horizontal or vertical)
48" W x 36" H (horizontal or vertical)
60" W x 35" H (horizontal)

Model: Solar M18AT, Maxwell M19AT/CAT

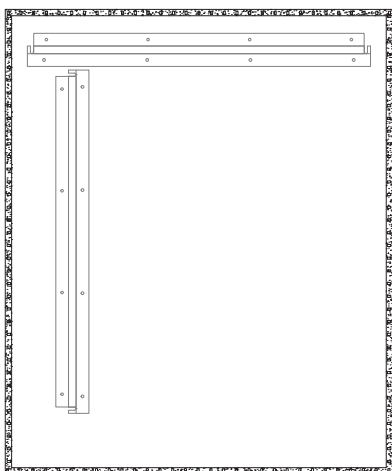

For easy installation of your Dyconn Mirror please do the following:
Thoroughly read all instructions before installing the enclosed product.
Read and take note of all safety, care, and maintenance information.

PLEASE KEEP THIS INSTRUCTION MANUAL FOR FUTURE REFERENCE FOR PRODUCT OPERATION AND MAINTENANCE.

Warning: Please read!!

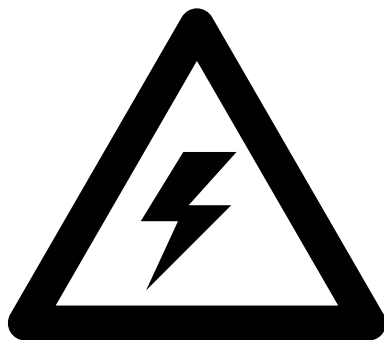

1. Dyconn Faucet LED mirrors should only be installed by a certified electrician.
2. During installation please make sure the circuit breaker or the power source switch has been turned off. Never install the mirror with a live line on.
3. It is recommended to have at least two people available to install the mirror. Remember to wear proper protective gear during installation. All mirror glass is non-tempered glass and can result in sharp shards if the glass is shattered.
4. Please use a certified licensed installer to hang the mirror to the wall. Using the proper anchor and screws for securing the unit to the wall is crucial. Screwing to the stud is recommended.

Feel free to contact us at 855-239-2666 or info@dyconnfaucet.com

Product Description & Information

Product Features:

- Acrylic Diffuser
- 3000K LED Light Temperature
- Aluminum Frame
- UL Certified

Package Content:

- LED backlit Mirror
- Screws
- Studs
- Mounting bracket

Model: Solar M18AT

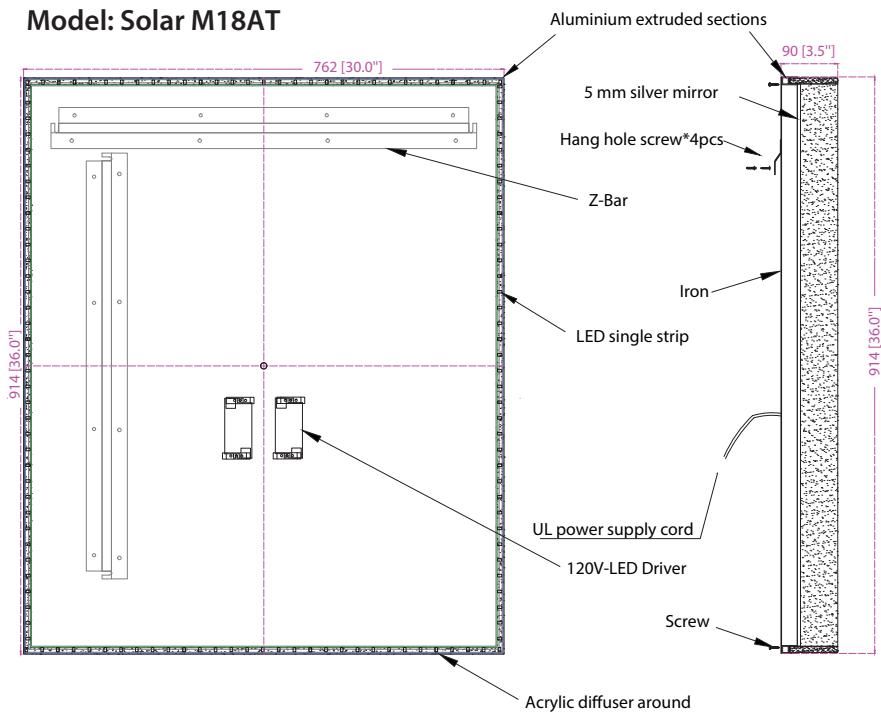

Note: Only one mounting bracket is available , please choose either vertical or horizontal Mounting

** All diagrams are for reference only. All model dimensions and proportions will vary.*

Product Description & Information

Product Features:

- Automatic Motion Sensor
- 3000K LED Light Temperature
- Frosted LED Light
- Aluminum Frame
- UL Certified

Package Content:

- LED backlit Mirror
- Screws
- Studs
- Mounting bracket

Model: Maxwell M19AT

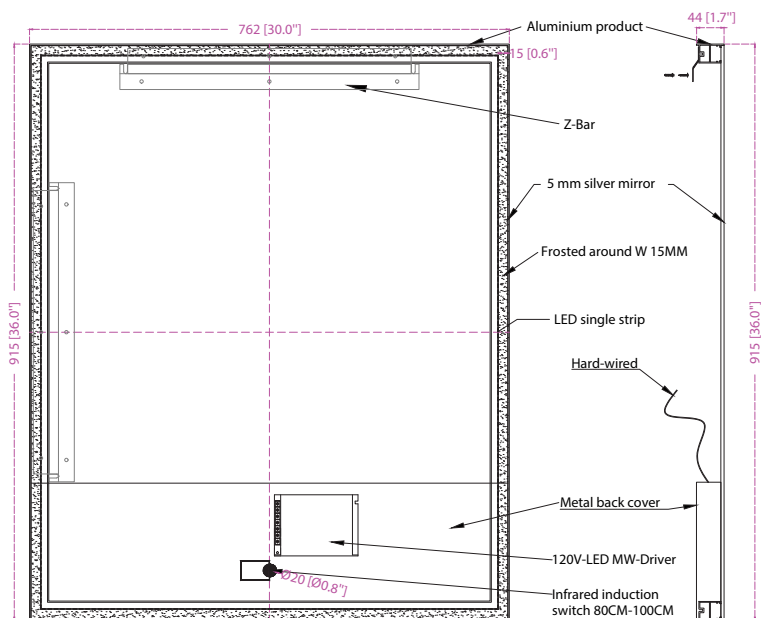

* All diagrams are for reference only. All model dimensions and proportions will vary.

Installation Steps

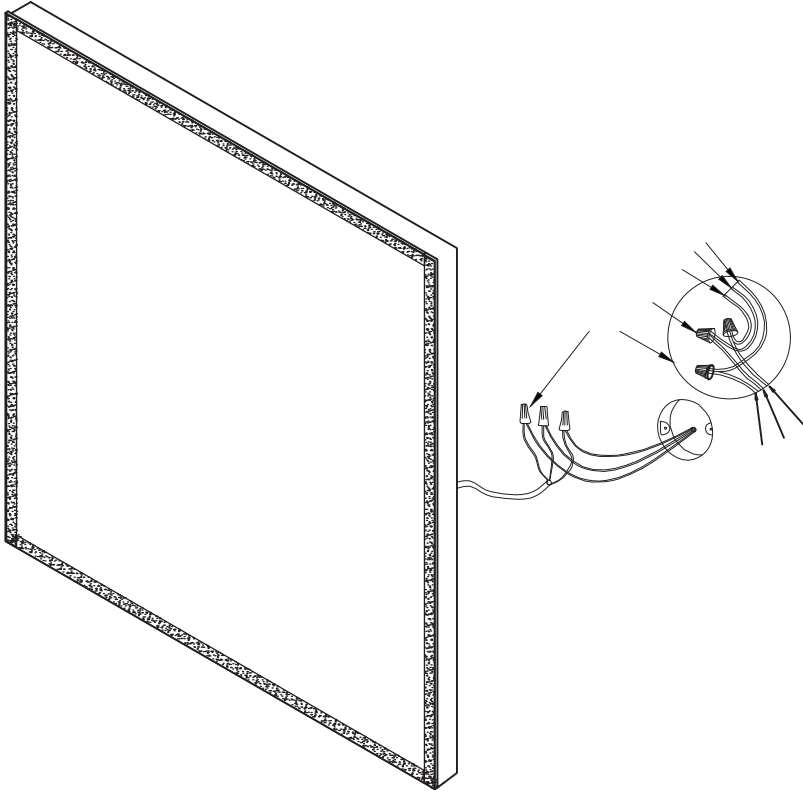

Step 1:

Using a I-Beam level to mount the included mounting bracket with 3 screws (using anchor when its installing on drywall, concrete or Tile surface).

Step 2:

Make sure the circuit breaker for the power source of the mirror is off. The connect the neutral (White), hot (black) and ground (copper wire or Green) wire between the mirror and the junction box.

Step 3:

Hang the mirror with desired placement (vertical or Horizontal) by placing the mirror's cut out on to the mounting bracket.

LED Mirror Power Source FAQ

Scenario 1 ✓

(Direct Wired)

This is the most common way to connect the mirror. The LED light & anti fog pad are both controlled by the built-in touch switch on the mirror.

**The LED light is dimmable.*

Internal Power Flow Diagram

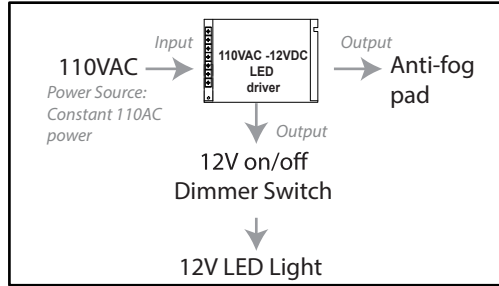

Scenario 2 ✓

(Wall Switch)

By doing so, the mirror is now bridged to the wall switch. In order to turn on the mirror, the wall switch needs to be on. The touch switch can be used to turn on the LED mirror and anti fog pad. The mirror shuts down once the wall switch is flipped to OFF.

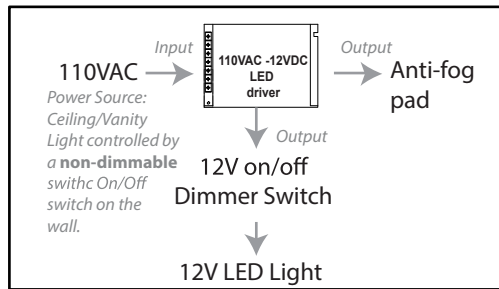

Scenario 3 ✓

(Wall Switch – No Dimmer)

By doing so, the mirror's light and anti-fog pad are now controlled by the wall switch. This is without the need to use the built-in touch switch. The touch switch is disabled. The LED and anti fog pad are now controlled only by the wall switch.

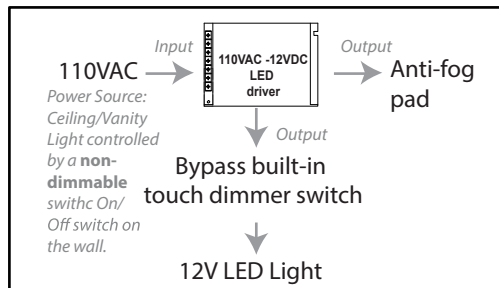

Scenario 4 ✗

(Wall Dimmer Switch – Not Accepted)

This is a scenario that is not acceptable. There is no work around for our mirror.

Do not try this way as it will damage the LED driver.

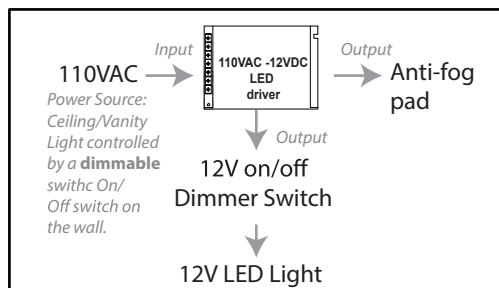

Introducing Tri-Color Mirrors and Additional Features

In the near future, Dyconn Faucet will be upgrading our mirror products to include tri-color options and additional features. Full feature list is listed below:

- Tri-color temperature options: 3000K, 4000K and 6400K
- Dimming Capability (except 72 Inch models)
- Onboard memory – If connected to a switch, the mirror will turn on with the settings last used
- Built-in touch Sensor
- Built-in anti-fog (except 12 x 16 size)
- UL certified

Some tri-color options are already available online via resellers and distributors. To easily recognize which items will include the newest colors and features, you need only to pay attention to the end character of the model number. If the model number ends with "T" (example: M16AT2432T), then the products will be tri-color and include the newest features.

Please note the following :

- Bypassing touch sensor: When connecting tri-color models and bypassing the touch sensor to a non-dimmable wall switch, the mirror will only enable 4000K and will no longer be able to select between all available color temperatures.
- Tri-color maximum brightness: The mirror can turn to its full brightness output at 4000K and half of maximum brightness when set at 3000K or 6400K.

Model Chart

Model	Description	# of LED strip	Lumens output	Watts
M09AT1216W	12"x16" 2 Frosted Strips	2	1456	13.44
M09AT2432W	24"x32" 2 Frosted Strips	2	2964	27.36
M09AT3036W	30"x36" 2 Frosted Strips	2	3328	30.72
M09AT4836W	48"x36" 2 Frosted Strips	2	3328	30.72
M09AT6035W	60"x35" 2 Frosted Strips	2	3224	29.76
M09AT7238W	72"x38" 2 Frosted Strips	2	3536	32.64
M10AT4836W	48"x36" 3 Frosted Strips	1	6448	59.52
M10AT6035W	60"x35" 3 Frosted Strips	1	6838	63.12
M10AT7238W	72"x38" 3 Frosted Strips	1	7956	73.44
All CAT22W (Round)	Round 22" LED Frosted Edge	1	1638	15.12
All CAT34W (Round)	Round 34" LED Frosted Edge	1	2600	24
All CAT42W (Round)	Round 42" LED Frosted Edge	1	3250	30
All VAT1824W (Oval)	18"x24" LED Frosted Edge - Oval	1	1456	13.44
All VAT2535W (Oval)	25"x34" LED Frosted Edge - Oval	1	1456	13.44
All VAT3042W (Oval)	30"x42" LED Frosted Edge - Oval	1	2184	20.16
All VAT3543W (Oval)	35"x43" LED Frosted Edge - Oval	1	2860	26.4
M12/M13/M14-AT1216W	12"x16" Frosted LED w/ Silver Edge	1	1040	10.2
M12/M13/M14/M16-AT2432W	24"x32" Frosted LED w/ Silver Edge	1	2,200	23.04
M12/M13/M14/M16-AT3036W	30"x36" Frosted LED w/ Silver Edge	1	2,604	27.84
M12/M13/M14/M16-AT4836W	48"x36" Frosted LED w/ Silver Edge	2	7072	72.96
M12/M13/M14/M16-AT6035W	60"x35" Frosted LED w/ Silver Edge	2	8,212	83.52
M12/M13/M14/M16-AT7238W	72"x38" Frosted LED w/ Silver Edge	2	9,768	97.92
M13AT1216WC	12"x16" Crystal Tri-color LED w/ Silver Edge	1	1,824	21.47
M13AT2432WC	24"x32" Crystal Tri-color LED w/ Silver Edge	1	3,856	45.36
M13AT3036WC	30"x36" Crystal Tri-color LED w/ Silver Edge	1	4,556	53.6
M13AT4836WC	24"x32" Crystal Tri-color LED w/ Silver Edge	1	6,188	72.81
M13AT6035WC	30"x36" Crystal Tri-color LED w/ Silver Edge	1	7,185	84.55
M15AT2432W	30"x36" Aluminum Frame, Blk Trim, Gold Foil - 3000K	1	3016	27.84
M15AT3036W	30"x36" Aluminum Frame, Blk Trim, Gold Foil - 3000K	1	3016	27.84
M15AT2864W	24"x68" Aluminum Frame, Blk Trim, Gold Foil - 3000K	1	4368	40.32

All # of LED strip, lumens output, and watts is the same with Bluetooth or TV option.

Dyconn Faucet LED Small Mirror

Frequently Asked Questions & Troubleshooting Guide

1. Can I connect to a dimmer on the wall to dim the mirror (ELV or non ELV dimmer)? **Answer:** Unfortunately, no, the mirror cannot be connected to an ELV dimmer or traditional non-ELV dimmer switch. All Dyconn Faucet mirrors contain low voltage LEDs and the power supply will not work properly if the source AC is altered through a wall AC dimmer.
2. Can I connect to a non-dimmer wall switch? **Answer:** Yes. Our mirrors can connect to a non-dimmable wall switch and use the on/off/dim touch sensor switch on the mirror regularly or you can bypass the touch sensor to allow the non-dimmable wall switch to control the LED mirror's light and defogger pad.
3. Can I bypass the mirror's touch sensor and control the unit with the wall switch? **Answer:** Please contact Dyconn Faucet customer service at 855-239-2666 or info@dyconnfaucet.com for touch sensor specific inquiries.
4. How far does the wiring extend from the back of the mirror? **Answer:** The wiring extends about 24-inches to connect to the j-box (j-box not included).
5. Where should the installer prepare the J-box for wiring? **Answer:** All mirror wire connections are located "dead center" of the back housing, regardless of the size of the mirror.
6. Can the LED Mirror be used as the only light source in the bathroom? According to its lumen output, it seems enough for lighting up a room? **Answer:** We do not recommend our mirrors to be the sole light source of any room. The lumens of our LED mirrors might seem high, but the LED mirror's light is partially confined behind the glass and sourced through the frosted strips (as it was designed to do). This will reduce the lumen output significantly if we are comparing with a recessed down light's lumen output.

FAQ for Tri-color (model # ending with T or WC)

7. Can I bypass the touch sensor and connect directly to the wall switch? **Answer:** Please contact Dyconn Faucet customer service at 855-239-2666 or info@dyconnfaucet.com for touch sensor specific inquiries.
8. If I connect the mirror to a non-dimmable wall switch can I set the desired light temperature and brightness level? **Answer:** Yes, the tri-color models have a memory function allowing the last light temperature and brightness setting to be recalled when you turn on the wall switch. To do so just turn on the light switch on the wall to initial the power to the mirror, press the touch sensor to select the light temperature, then press and hold the touch sensor switch to dim to the level you like. Once you have reached your desired light temperature and brightness, simply turn off the mirror using the wall switch (don't turn the mirror off by using touch sensor). The next time you use the mirror, turn on the wall switch and touch one time on the touch sensor and the mirror will turn on with the brightness and temperature settings you set last time.

Troubleshooting:

1. Right out of the box, we connected the AC power to the back of the mirror to see if the mirror functions properly (before hanging the mirror), but there is no light and touch sensor doesn't light up. Why is that? **Answer:** For the large mirrors (48-inch and up), there are wires that need to be connected in order for the mirror to function. The mirror glass is designed to be separated from its metal housing during installation. Installers would be required to disconnect any wiring inside when removing the mirror glass. We ship the mirrors without connecting these wires inside the unit to make installation more convenient.
2. Why does the touch sensor seem to be unresponsive? **Answer:** Do not use your fingertips on the touch sensor. Ensure that you are using the flat part of your finger/thumb (your fingerprint). Please make sure you are using your finger to tap/touch at a moderate speed (once per second). Do not tap/touch the mirror sensor switch at a speed faster than twice per second. This will cause the sensor CPU to malfunction. A circuit breaker reset will be required to reset the touch sensor.
3. Why is my mirror making humming/buzzing noise? **Answer:** Hearing a low buzzing/humming noise is normal as the touch sensor switch has a variable capacity built in. If the humming /buzzing noise is significant, then one of three components that may be defective. 1) The relay for the anti-fog pad 2) the touch sensor or 3) Power supply. Please contact Dyconn Faucet customer service at 855-239-2666 or info@dyconnfaucet.com.
4. Why is the LED flickering? **Answer:** If the LED is flickering, then one of two components might be defective. 1) The LED strip or 2) the power supply (AC to DC). Please contact Dyconn Faucet customer service at 855-239-2666 or info@dyconnfaucet.com.

Manufacturer Limited Warranty



All Dyconn Faucet products are manufactured and tested with the highest quality standards and rigorous quality control process. This warranty is limited to the non-commercial use of Dyconn Faucet products purchased and installed in the United States and Canada.

Dyconn Faucet Brand Limited Warranty on Faucets and Kitchen/Bath Accessories

Dyconn Faucet warrants its faucet products to be free from manufacturing defects in material and workmanship during the normal non-commercial use for a period of (3) three years for all non-electrical component items and (1) one year for all electronic component related items (such as, but are not limited to, products like the sensor faucet and bidet toilet) from the initial purchase date by the original owner/end-user for personal household use. Dyconn Faucet also warrants its part and accessory products to be free from manufacturing defects in material and workmanship during the normal non-commercial use for a period of one (1) year from the initial purchase date by the original owner/end-user for personal household use. This warranty is non-transferable between homes or owners and only applicable for residential use. Any commercial or industrial use of Dyconn Faucet products automatically void the warranty. Any warranty claim must include the original sales receipt as proof of purchase from an Authorized Dealer or Distributor of Dyconn Faucet products. (Authorized Dealers can be found on the Dyconn Faucet website).

Dyconn Faucet recommends installation of all Dyconn Faucet products by licensed professionals. Dyconn Faucet will not be held responsible for any damages or product failure due to improper installation, misuse or the failure to adequately utilize a licensed professional. Proper care and maintenance for all products is standard, like any other household appliances and fixtures to ensure proper function and a lasting product. Instructions are provided in your manual on the proper care and maintenance of Dyconn Faucet products.

This warranty will not cover any damages that might be caused by the product. (In some instances, specific states do not allow for such limitations, therefore, this may not apply to all owners).

Any and all warranty claims must include the original sales receipt as proof of purchase from an Authorized Dealer or Distributor of Dyconn Faucet products. Please contact Dyconn Faucet Support or Sales Department for assistance with the verification process. Any product reported to Dyconn Faucet as defective will be repaired or replaced (with a product of equal value) at the company's discretion. If Dyconn Faucet is not able to replace or repair the product, Dyconn Faucet may elect to refund the original purchase price to the original purchaser in exchange for the product's return. Dyconn Faucet has full rights to inspect any Dyconn Faucet product reported as defective prior to repair or replacement. Any repair and replacement costs EXCLUDE shipping, labor for removal or re-installation, and any consequential or special damages associated with the return, replacement, and installation of your product. To ease the duration and financial burdens of the warranty process for our customers, Dyconn Faucet may request images and/or videos of products to assess the product's condition and determine the necessary replacement parts. Replacement parts and warranty claims may be obtained by contacting us using one of the following methods:

Phone: 1-855-239-2666 (in the U.S. and Canada)

Email: info@dyconnfaucet.com

Write to us:
Dyconn Faucet Warranty
382 N. Lemon Avenue #122
Walnut, CA 91789

Dyconn Faucet reserves the right to modify the warranty at any time, it being understood that any such modifications will not supersede warranty conditions that are applicable at the time of the original sale of products in question.

Though Dyconn Faucet products are certified by various agencies, Dyconn Faucet makes no implication that products comply with any or all local building or plumbing codes. It is the consumer's responsibility to determine any code compliances when installing and using Dyconn Faucet products.

Limitations of Warranty:

The warranty shall not apply and be void for incorrect operating procedures, breakages and/or damages caused by fault through improper installation, carelessness, abuse, misuse, misapplication, improper maintenance and alteration of product; damages caused by chemicals, natural corrosion, accident, fire, flood, an act of God, or any casualty. Avoid abrasive cleaners, materials, steel wools and harsh chemicals as these will scratch, damage, and/or dull the products and/or finish of the products and void the warranty. The proper installation of product covered is the responsibility of the original owner/purchaser of the product. Dyconn Faucet neither installs nor supervises the installation nor hires contractors for this purpose; consequently, Dyconn Faucet cannot be held responsible for any default breakage, or damages caused thereby or resulting thereof, either directly or indirectly.

This warranty does not apply to products that have not been installed or operated in accordance with instructions supplied by Dyconn Faucet and all applicable rules, regulations, and legislation pertaining to such installations.

This warranty does not apply to commercial or industrial applications of Dyconn Faucet products.

Dyconn Faucet is not responsible or liable for personal injuries or deaths to any person for any direct, special, incidental, or consequential damage, loss of time, loss of profits, inconvenience, incidental expenses, labor or material charges, or any other cost resulting from the use of the product or equipment or pertaining to the application of the present warranty, or resulting from the removal or replacement of any product or element or part covered by this warranty.

In any case, Dyconn Faucet is not liable for any amount over and above the purchase price paid for the product by the original owner/end-user.

Cleaning and Care

Care should be exercised when cleaning this product. Although its finish is extremely durable, it can be damaged by harsh abrasives and cleaning pads. To clean, use a light, non-abrasive cleaning solution or cleaning polish.