

Do not tighten any bolts until it tells you to use the tool.
 Fingertip tight only. See the video first!
 It will save you one hour.
 You can looes all the screws, just little on the nuts
 Please assemble this item as follow the steps strictly
 Tips: single alphabet is bar, double alphabet is screws

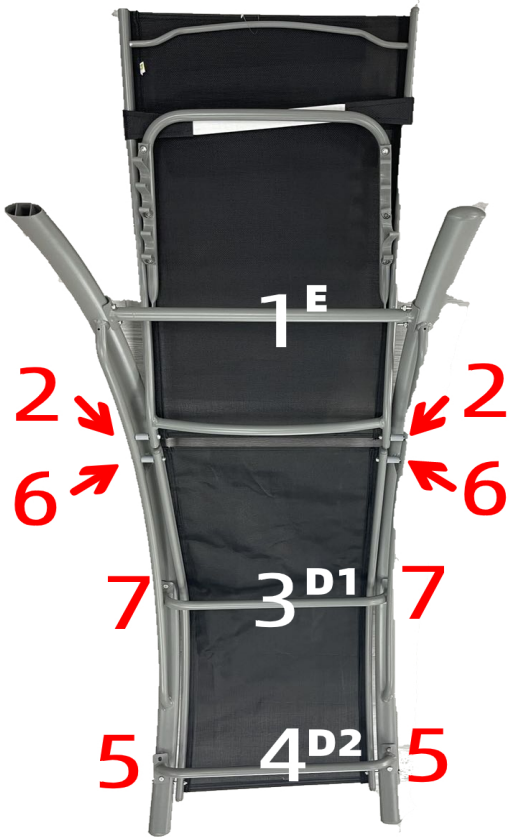

Please scan the QR code for the assembly video

Dear Customer,Thank you for your order.
 If you have questions or quality problems during the installation and use,
 please email us at first thought your order(or email to us: service@homezillions.com).
 we will reply you within 12 hours and solve your problem as soon as we can.
 We hope our products will give you a great shopping experience. Thank you!
 Here is the installation video on YOUTUBE for your referance.
 Not the same products. The Youtube code is Tu-6SAc_dGA
 You just search the code on YOUTUBE, the video will be there.

Part	Description	Qty	Part	Description	Qty	Part	Description	Qty
#1		1 pcs	#2		1 pcs	aa	M6*15mm	16 pcs
bb	M6*65mm	8 pcs	cc	M6*70mm	8 pcs	dd	M6*85mm	8 pcs
ee		8 pcs	ff		24 pcs	gg		64 pcs
hh		24 pcs						

Part	Description	Qty	Part	Description	Qty
A		4 pcs	B		2 pcs
C		2 pcs	D		4 pcs
E		2 pcs	F		2 pcs

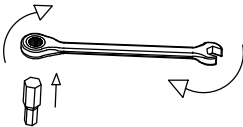

SCREW UP

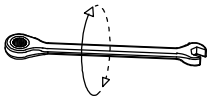

TURNOVER

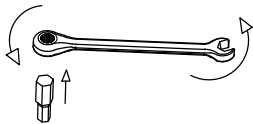

UNSCREW

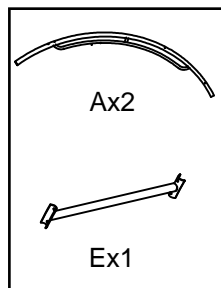

Step 1

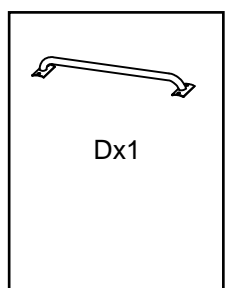
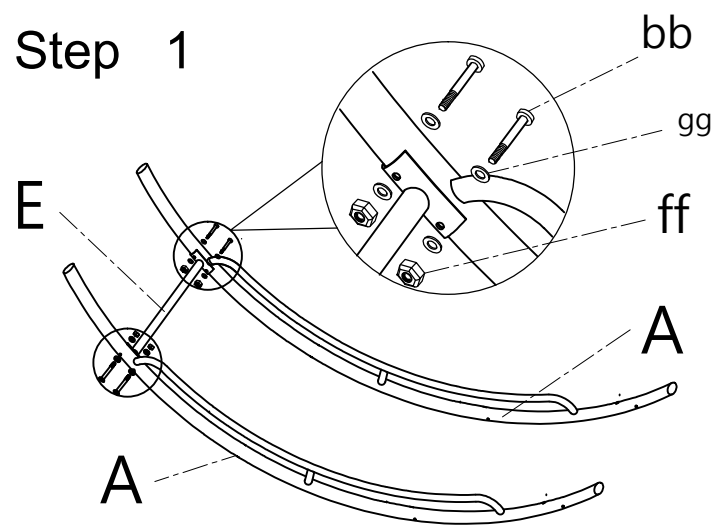

Step 3

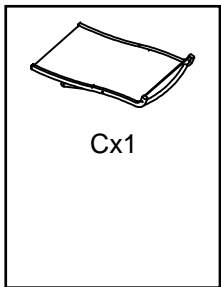
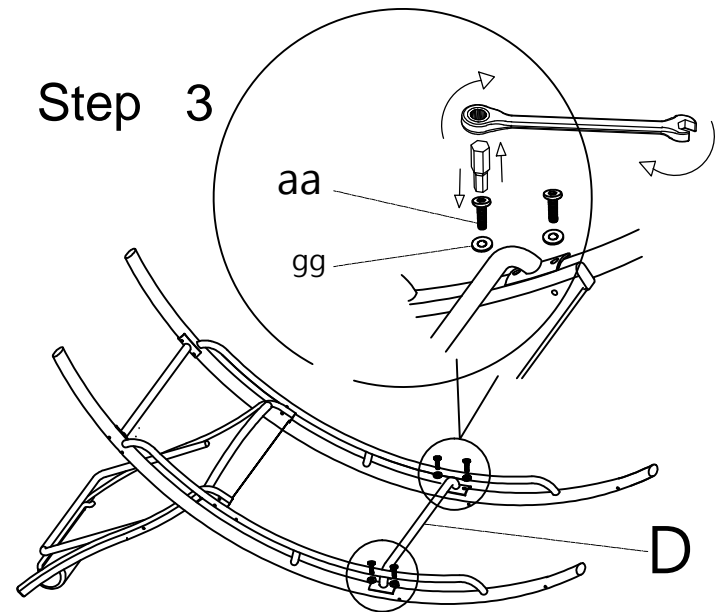

Step 2

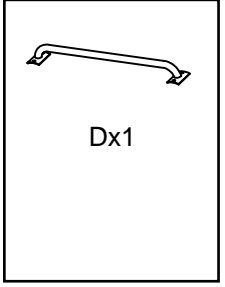
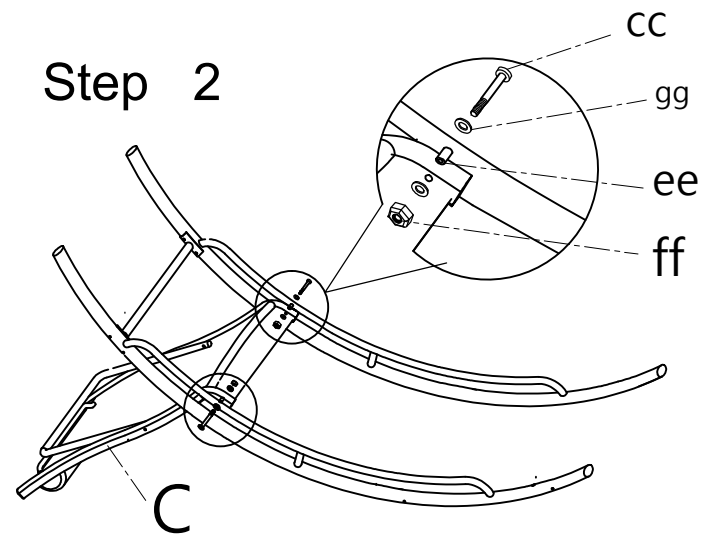

Step 4

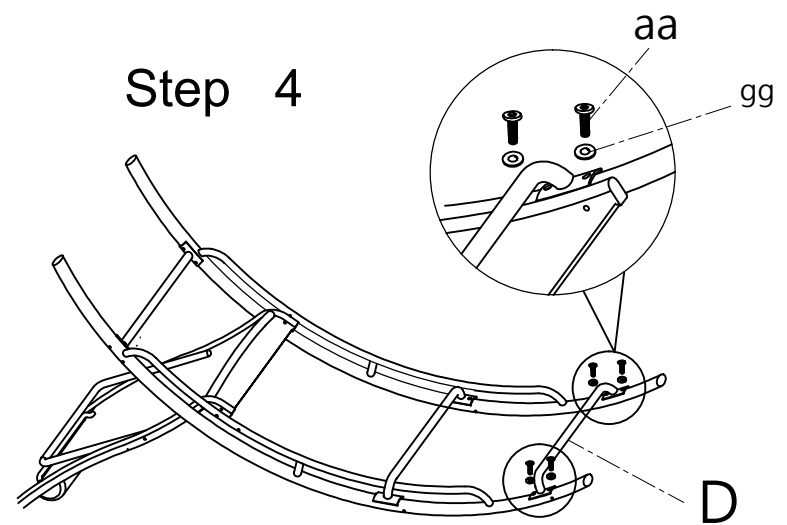

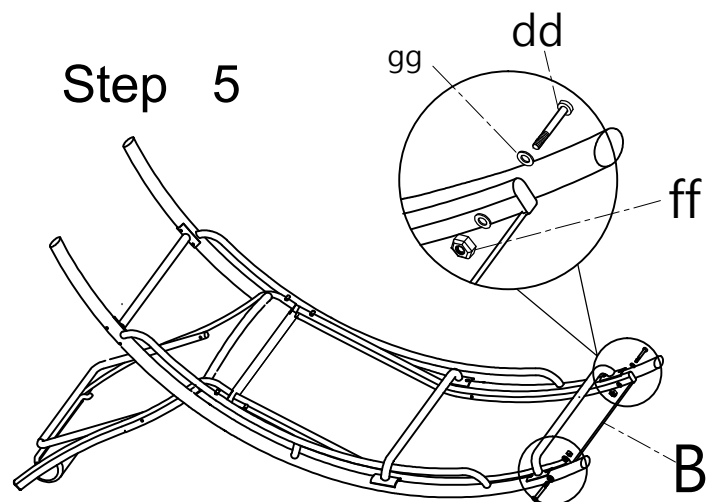
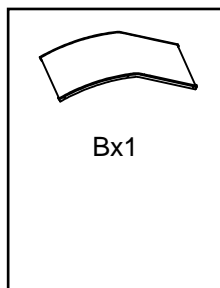

2Person assembly

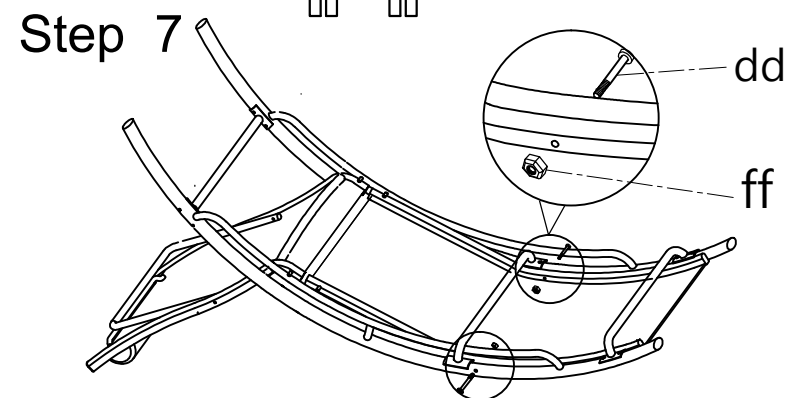
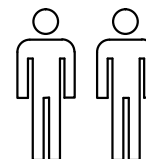

Dont use washers for this step

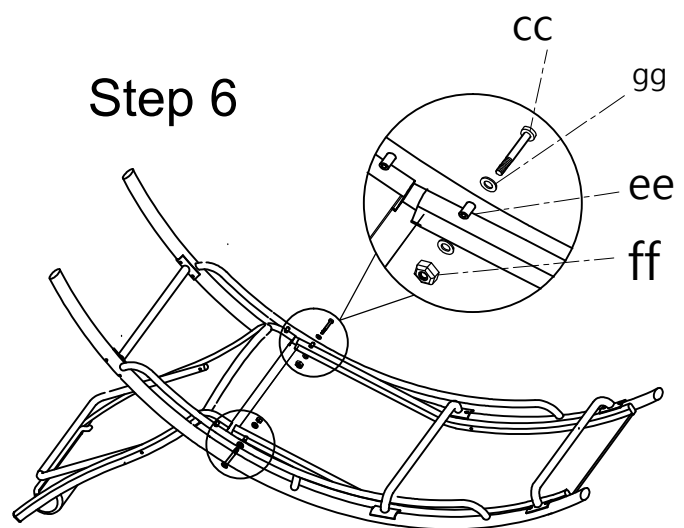

Step 8

Tighten all bolts & nuts

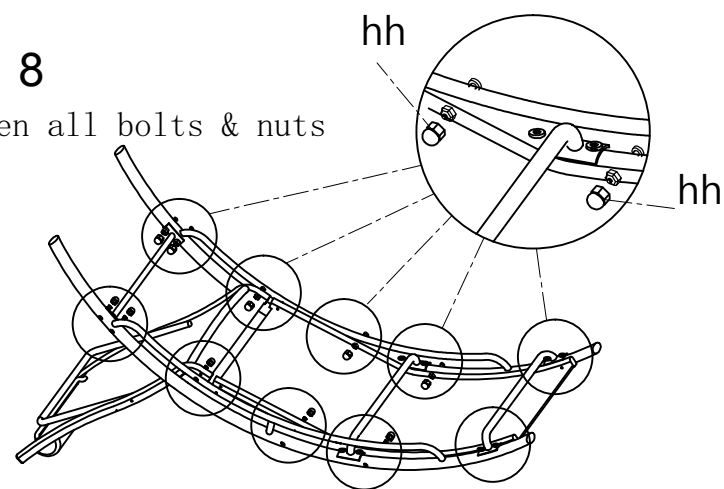

Dear Customer, Thank you for your order.

If you have questions or quality problems during the installation and use,

We hope our products will give you a great shopping experience. Thank you!

please email us at first thought your order (or email to us: service@homezillions.com).

we will reply you within 12 hours and solve your problem as soon as we can.

Q&A

Q1: Here is the installation video on YOUTUBE. The Youtube code is kp04Q5vkq1Y
you just search the code on YOUTUBE, the video will be there.

Just remind: Do not tighten too tightly when installing, You should just put the nuts thread to the screws, no more tight. Please tighten after installing. (This is the most important step.)

Q2: Why doesn't the hole position match my product? It Can't be installed.

A2: You can loose all the screws. Just little on the nuts thread. As the photo shows. And then adjust the shell frame. You will match the holes.



Q3: Why I can't fix the middle seat to the shell frame. It has a long distance.

Because we use high-quality Teslin cloth, based on the micro-elasticity of Teslin cloth.

To prevent for long time using, the cloth will be loosed and the fabric of the seat will sink, which will affect the appearance and comfort.

A3: Step 1: Loose all the screws. Just little on the nuts thread. As the up photo shows.

Step 2: Fix the shell frame as the instruction. And then put the two feet seat together first, Keep this Step about 12 hours. (make sure to Keep the seat fabric in a stretched state.)

Step 3: You can fix the middle seat nuts thread as the instruction shows.

Step 4: Youtube code is kp04Q5vkq1Y this is the YOUTUBE VEDIO show how to fix the seat.

Q4: The plastic part of my backrest is crooked. The location is incorrect.

A4: You can use the tool to loose the nuts thread of the plastic parts, and adjust the position to correct.



WHAT'S APP: HOMEZ