

## ASSEMBLY INSTRUCTIONS



### CAUTION

◆ Inspect the wire insulation for any cuts, abrasions, or exposed copper that may have resulted during shipping. If there is a defect in the wire, do not attempt installation.

◆ Before starting installation of this fixture or removal of a previous fixture, disconnect the power by turning off the circuit breaker or by removing the fuse at the fuse box.



If you need further assistance, please contact us by Email: [customersupport@superiordecorinc.com](mailto:customersupport@superiordecorinc.com)

## TOOLS REQUIRED



Ladder



Safety glasses



Electrical tape



Phillips screwdriver



Flat blade screwdriver



Pliers

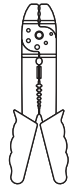

Wire strippers

## HARDWARE INCLUDED

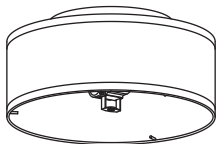

Fixture

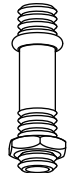

Stem and Hex Nut



Glass Panel



Rubber Ring



Washer



Cap



Ball Nut B

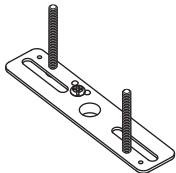

Mounting Unit



Ball Nuts A



Mounting Screws



Wire Nuts

**\*PARTS SHOWN MAY DIFFER SLIGHTLY PER LIGHT FIXTURE**

## EXPLODED PARTS

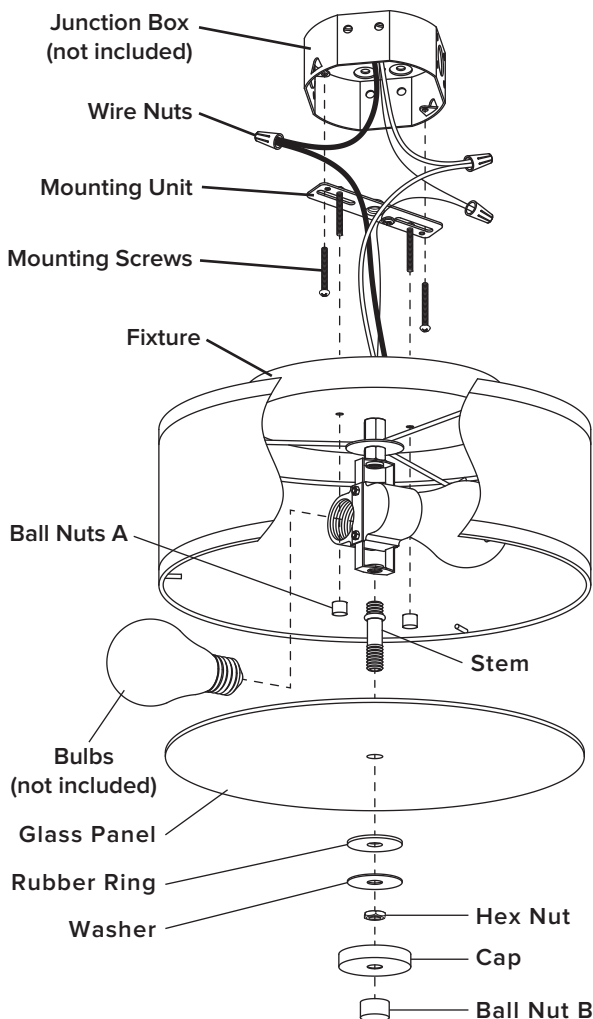

## INSTALLATION

### STEP 1

Unscrew the **ball nuts A** from the **mounting unit**. Use the **mounting screws** to attach the **mounting unit** to the junction box (not included).

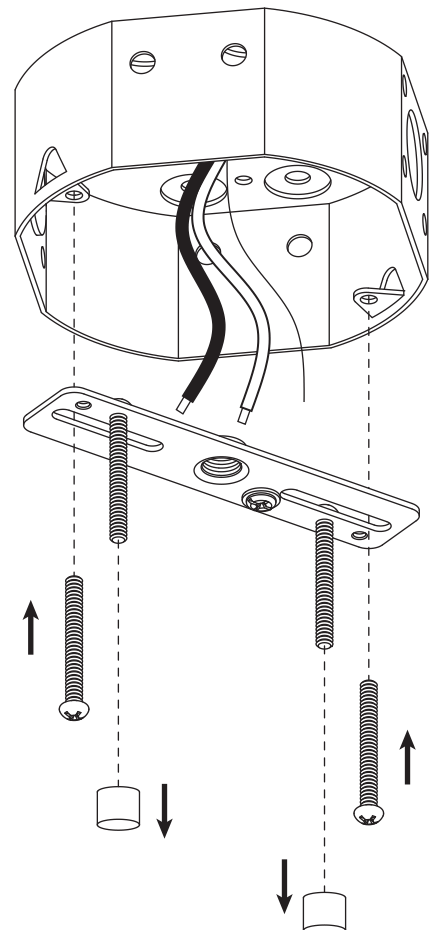

## ASSEMBLY INSTRUCTIONS (INSTALLATION)

### STEP 2

Make the electrical connection from the junction box (not included) to the **fixture**. Connect the ground wire to the **mounting unit** using the preinstalled green ground screw. Next, connect the live wire, neutral wire and ground wires with the supplied **wire nuts**. Secure with electrical tape.

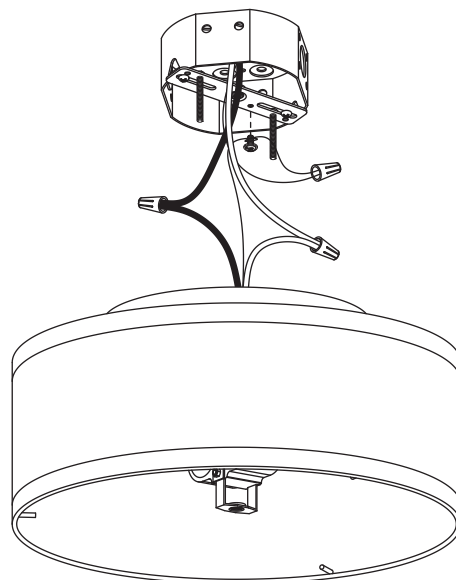
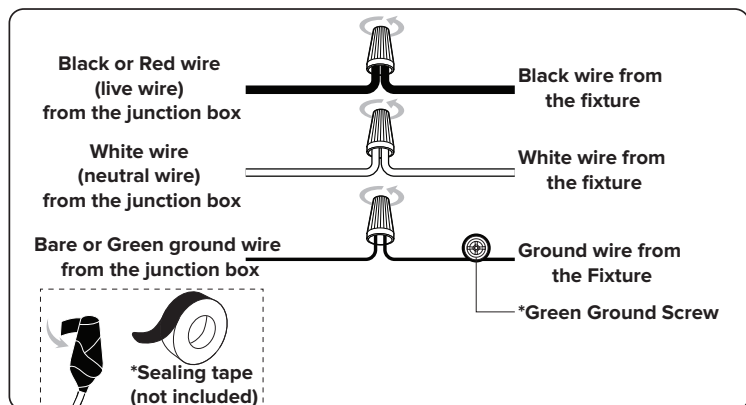

### STEP 3

Attach the **fixture** to the **mounting unit** through screws holes as shown, and secure it with **ball nuts A**.

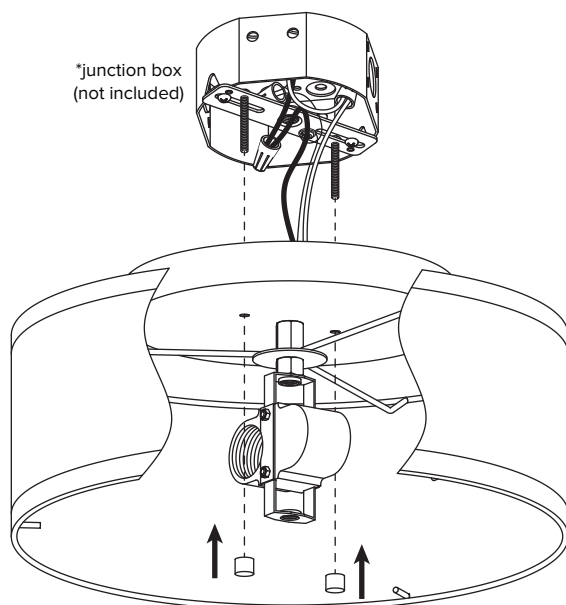

### STEP 4

Screw the **stem and hex nut** into the **fixture**.

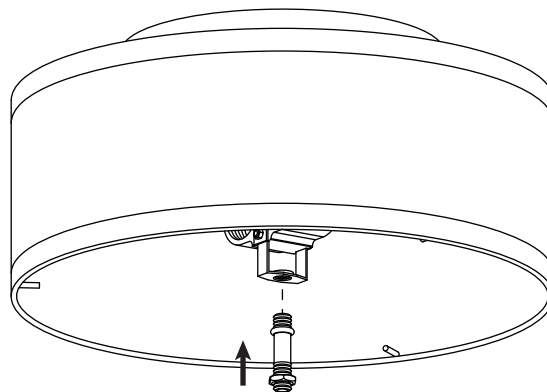

### STEP 6

1. Remove the **hex nut** from the **stem**.
2. Place the **glass panel**, **rubber ring**, and **washer** onto the **stem**, then secure with **hex nut**.
3. Place the **cap** onto the **stem**, tighten with **ball nut B**.

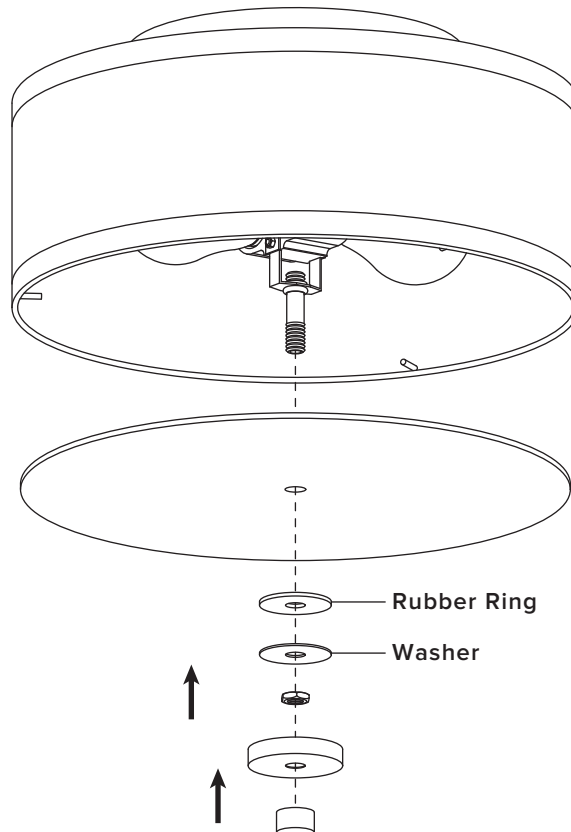

### STEP 5

Install bulbs (not included)

