



Please read these instructions carefully before beginning. You may want to watch the instructional video online at gilafilms.com for a thorough demonstration. We recommend practicing the steps with a small piece of film or on a smaller window. Application is easier with two people, especially on larger windows.

Tools Needed

(Sold in GILA Tool Kit)

- GILA® Window Film Application Solution – Ready to use for cleaning and application. Do not dilute or mix with water.
- Squeegee and squeegee card – For smoothing the film
- Utility knife – For trimming the film
- GILA Edging Tool – To ensure a clean edge
- Low-lint cloth – For cleaning the film and the glass

(Household items)

- Single-edged razor blade – For cleaning the glass
- Ruler or tape measure
- Transparent tape
- Scissors

1. CLEAN WINDOW

Generously spray the window with the Application Solution, use a razor blade to remove stubborn dirt or paint. Use special care cleaning the corners. Rewet the window, then squeegee downward. Wipe off accumulated dirt from the window gasket with a soft cloth. If possible, clean the outside of the window for the best clarity.

Hint!

Greasy or smoke-covered windows can be cleaned first with glass cleaner then rinsed thoroughly with the Application Solution. Apply film to cool shaded windows when glass temperature is between 45-90°F. For best results, do not apply in direct sunlight or freezing weather.

2. MEASURE AND CUT FILM

Unroll the film on a clean, flat surface. Carefully measure your window before cutting. Cut the film at least an inch larger than the glass on all four sides. The excess will be trimmed once film is applied.

Hint!

Try to use at least one of the factory edges. Work in a dust-free area. Turn off fans.

3. IDENTIFY CLEAR LINER

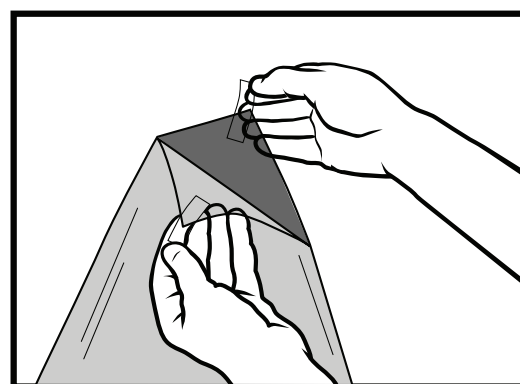

Leaving the film on a clean, flat surface, select one corner of the film and attach two small pieces of transparent tape (3-4 inches) to each side – one on

the film and one on the liner. Leave some tape hanging over the corner of the film (about 1 inch). Press the two pieces of tape firmly together, then quickly pull them apart to begin separating the clear liner away from the adhesive side of the film. You have identified the liner! Leave the tape in place and move to the next step.

Hint!

Usually the liner is on the outside surface of the film roll. You may want to fold the ends of the tape over themselves to keep the two pieces of tape from sticking together.

4. WET WINDOW AND FILM

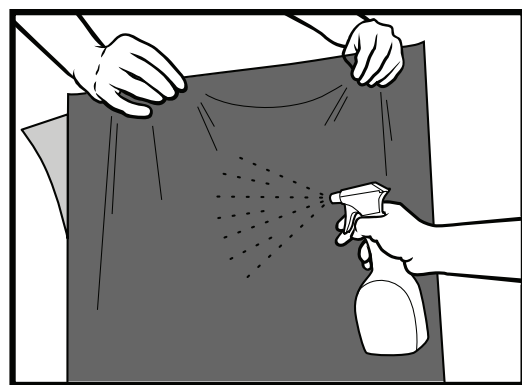

Generously spray the Application Solution onto the inside surface of the window and both sides of the film. This helps reduce film curl and static electricity.

Hint!

Have a helper hold the film by the edges while you spray. Flip the film over and repeat on the other side.

5. REMOVE CLEAR LINER

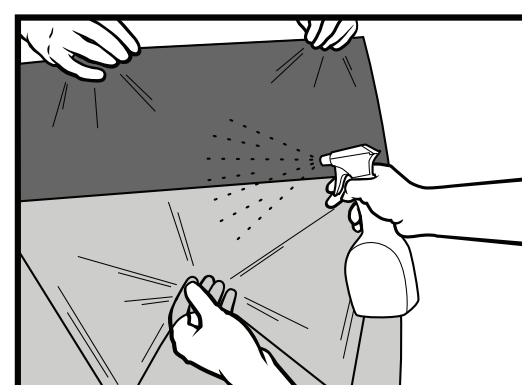

Peel the two strips of tape apart to release the liner from the corner. As you begin to pull away the liner, spray the exposed adhesive side of the film with the Application Solution until the clear liner is removed and the adhesive side is completely saturated. Try to keep the film from touching itself.

Hint!

Have a helper hold the film while you peel the clear liner away and spray the adhesive side of the film. Handle the film very carefully to prevent creasing.

6. APPLY FILM TO GLASS



Hold the film so that the adhesive side is facing the window and apply to the glass. Use your hands to smooth the film out and position it so that the excess 1" is overlapping the window on all four sides.

Hint!

If you're using a factory edge, line that up to the window edge. For larger pieces of film, leave some of the liner on the film while you apply it to the glass. Once the film is in place, remove the liner completely.

7. SMOOTH FILM

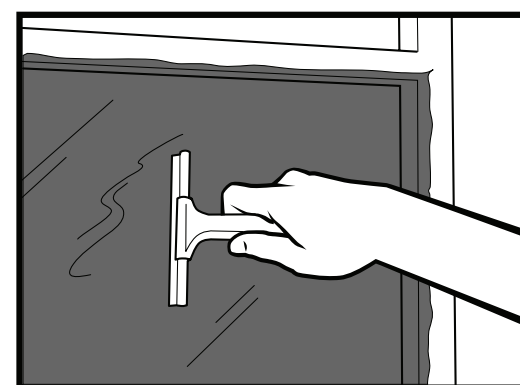

Spray the entire surface of the film facing you with the Application Solution. Lightly squeegee the centerline of the film from top to bottom to set it in place. Begin to smooth the film, starting at the top of the window. Squeegee from the center to the right side and work downward, leaving a 2" perimeter around the edges unsqueegeed. Repeat this process for the left side.

Hint!

If "fingers," or longer, larger bubbles, appear along any edge, wrap your squeegee with a low-lint cloth and carefully push the "fingers" toward the edge of the film. The cloth will absorb the excess water. The hard card squeegee works great for this.

8. TRIM FILM

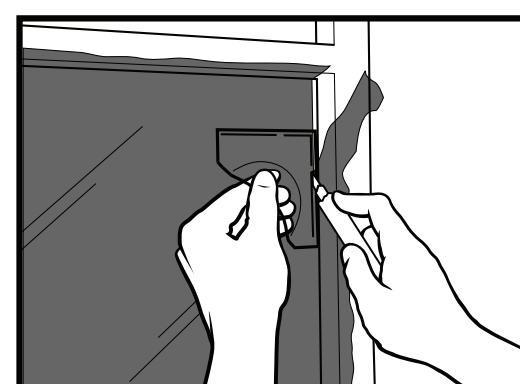

The GILA Edging Tool has a small slit along the edge. Place the utility knife in this slit and line knife and Edging Tool up to a top corner edge of the window. Slowly and firmly, pull the knife and Edging Tool down the window to trim the film. Re-position the knife and tools to get the corners. Gently pull the trimmed film away from the window. Repeat this process on all four edges of the film.

Hint!

The GILA Edging Tool leaves a 1/16" gap between the film and the edge of the window, this gap is essential for the proper thermal expansion of the glass. Use a new blade after every 10 feet of film you cut. Cutting film causes the blade to dull quickly, which can tear the film.

9. SQUEEGEE DRY

Rewet the film and squeegee from the center to the right side, working from the top down.

Repeat this process for the left side. Press firmly to remove all the water so that the adhesive can cure clearly. If air bubbles are present, squeegee them out. Any remaining small water bubbles should evaporate as the film cures.

Hint!

CORRECTING MISTAKES:

You may notice imperfections such as air bubbles or debris between the film and the glass. EZMount adhesive allows you to peel the film away from the glass, fix the problem, and re-apply for up to 24 hours. Simply peel the affected area of the film away from the glass and use your squeegee or knife to remove any debris or bubble. Respray the adhesive with the Application Solution and re-apply to the glass. Once applied, re-spray the outer surface of the film and re-squeegee.

10. ENJOY THE VIEW!

Great work. You have successfully applied your GILA Window Film. The film will fully "cure" over the next 7 to 10 days. Dry, sunny weather speeds curing. During curing, the film might appear hazy, this effect will disappear with time.

CLEANING AND CARE:

For best results, use the Application Solution. Wipe clean with a rubber squeegee or low-lint cloth. If using an ammonia-based glass cleaner, do not allow the cleaner to stay on the film for more than 2 minutes.

REMOVAL:

EZMount adhesive makes removal easy and clean. Removal is as easy as peeling the film away from the glass. However, depending on when you purchased your film, it may not contain EZMount adhesive. If your film has been installed for several years or it doesn't peel off the glass easily, please use GILA Film Removal Solution (which is sold at the GILA film display in most retail outlets) to facilitate removal. More detailed removal instructions can be found at gilafilms.com.

INTENDED USE:

GILA residential window film should only be applied as directed:

- Apply to the INSIDE surface of standard 1/8" single and dual panes. This includes single, dual, removable storm panes, all window shapes such as patio and French doors, and half-rounds.
- Apply to the INSIDE surface of exterior removable storm panes.

FOR WINDOWS LARGER THAN FILM SIZE

To cover larger windows, you may need to seam the film, as you would wallpaper. To obtain a perfect butt seam, vertically overlap two sides, then use a ruler as a straight edge to guide your knife as you cut through the center of both layers of film. After cutting the seam line, peel the loose sheet of film from the top, then lift the edge and slide the other waste piece from underneath. Rewet the glass, lay down the film, rewet the film, then squeegee from top to bottom in a slow, firm vertical motion. A week after installation, you should waterproof the seam with a coat of clear fingernail polish.

CAUTION:

Do not apply GILA residential films to plastic or Plexiglas surfaces or to motor vehicle windows. For information on products designed for these applications, visit gilafilms.com. Do not apply any film to frosted, etched, leaded, cracked, holed, or deeply scratched glass, or any otherwise flawed or defective glass or glass that is more than 40 years old.

CONSUMER SUPPORT:

For additional technical support or product inquiries, please write, call, or go online:

GILA Film Products
P.O. Box 5068 • Martinsville, VA 24115 USA
Consumer Service Hotline, 1-800-528-4481
Monday-Friday, 8am-5pm EST
web: www.gilafilms.com • gilahelp@cpfilms.com

SATISFACTION GUARANTEE:

Film may last up to 10 years, depending on exposure to the elements, handling, and care. GILA will gladly replace any product with a manufacturing defect. Send the original sales receipt, an explanation of the defect, a 4" x 4" sample of the defective film, and the product UPC code from the packaging to:

GILA Film Products • DIY/WAR
P.O. Box 5068 • Martinsville, VA 24115 USA
All claims must be submitted in writing.
Please allow 3-4 weeks for processing.

