

# ASSEMBLY INSTRUCTIONS

---

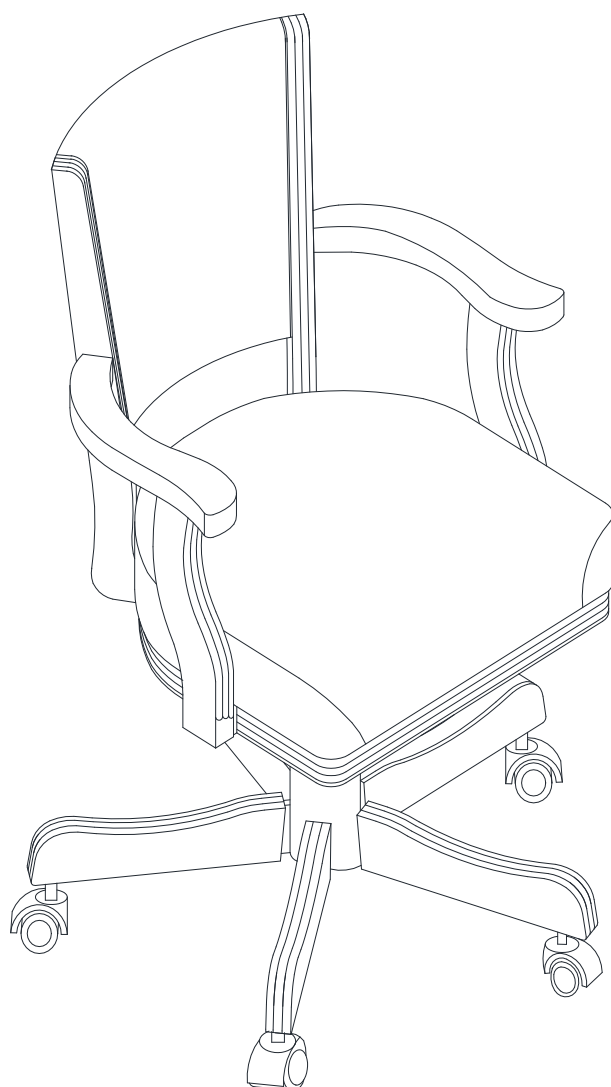

## TOOLS REQUIRED

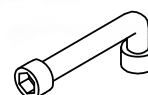

Wrench  
(Included)

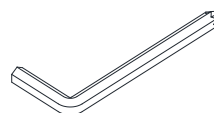

Allen Wrench  
(Included)



2 - Persons  
Recommended

## ASSEMBLY RATING



EASY —————> DIFFICULT

The Assembly Rating is a 5-point system showing the level of effort needed to assemble a specific product.



## **CHECK BEFORE STARTING**



### **Are you missing anything?**

Double-check all parts, hardware and accessories listed on Page 6 are accounted for.



### **Check out our Quick Tips!**

We recommend reviewing the pre-assembly handouts. Even experts need a refresher now and then!



### **Should we send any replacements?**

Are there any irregularities or flaws in the parts? We can send replacements!



### **Prep Time!**

Please review the assembly instructions and all diagrams prior to assembling. Set up your workspace by laying the parts and hardware out separately, then begin!

# PRE ASSEMBLY INTRODUCTION

We understand building ready-to-assemble furniture can be a challenging experience for some. To help avoid confusion, we have provided some helpful tips that may speed up the process.



## Teamwork

ALWAYS have at least two people to help with transporting and assembling the product to avoid potential injury and/or damage.

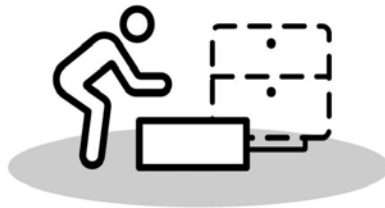

## Suitable Location

Assembling near the area of the intended location is highly recommended.



## Sufficient Space

Make sure you have enough space to move around during the assembly.



## Avoid Scratches

Use cardboard, blankets or a carpeted area while assembling furniture to prevent scratches.



## Flat Surface

Make sure the furniture rests on a flat and level surface with each leg evenly touching the floor.

# ASSEMBLY AND CARE ADVICE



**FAILURE TO FOLLOW THE GUIDELINES BELOW MAY  
RESULT IN INJURY AND/OR PROPERTY DAMAGE.**



Position each part correctly  
and insert screws or bolts into  
their respective holes.

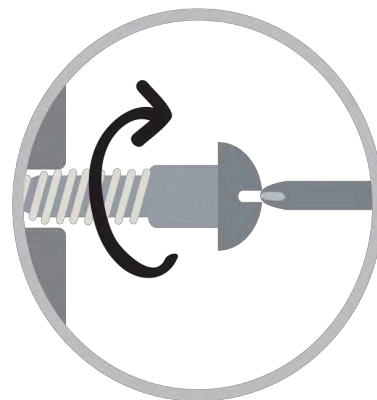

Turn clockwise to tighten and  
only tighten when step is  
completed or when instructed  
to do so.



Save the instructions and store  
any supplied tools for later  
maintenance.

Use the appropriate hand tools  
or power tools for assembly.  
Select steps, such as tightening  
screws and/or bolts, may require  
hand tools to avoid causing  
damage during assembly.

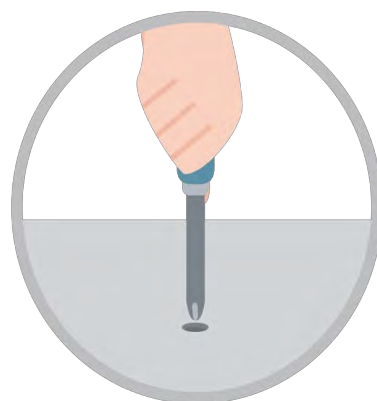

After two weeks, check and  
tighten any loose hardware and  
repeat again every six months  
thereafter.

**IT IS THE USER'S RESPONSIBILITY TO MAINTAIN THE FURNITURE. THE HARDWARE MAY LOOSEN  
OVER TIME AND MAY CAUSE THE FURNITURE TO BE WOBBLY AND UNABLE TO SUPPORT ITS  
INTENDED WEIGHT CAPACITY. THIS MAY LEAD TO COLLAPSE AND MAY CAUSE SERIOUS INJURY.**

# ARM CHAIR



- Please keep instructions for future reference.
- Check the quantity and irregularity of parts and hardware before you start.

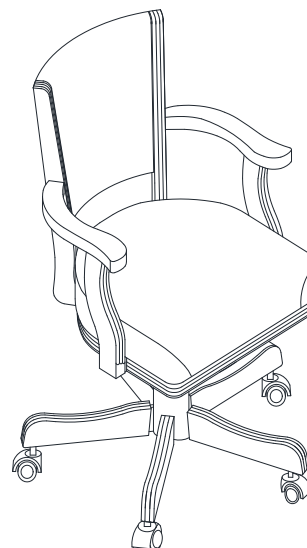

## PARTS

#1 1pc



Back Cushion

#2 1pc

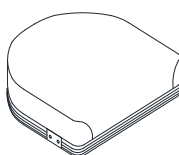

Seat

#3 1pc



Right Back Support Bar

#4 1pc

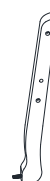

Left Back Support Bar

#5 1pc



Left Chair Arm

#6 1pc



Right Chair Arm

#7 1pc

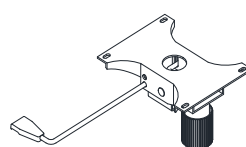

Seat Plate

#8 1pc



Gas Lift Cylinder

#9 1pc



Cylinder Cover

#10 1pc

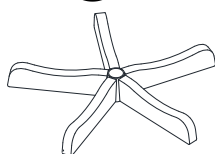

5-Star Base

# ARM CHAIR



- Please keep instructions for future reference.
- Check the quantity and irregularity of parts and hardware before you start.

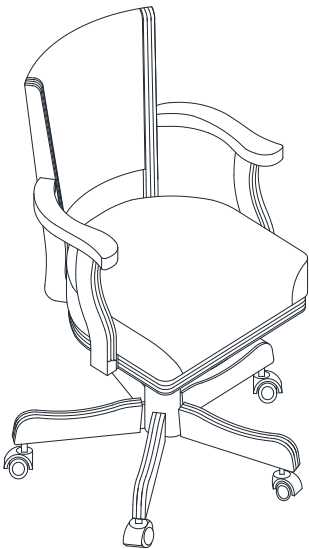

## HARDWARE

#A 4pcs

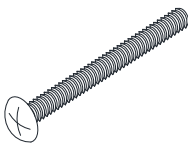

Bolt  $\varnothing$  1/4" x 40mm

#B 4pcs

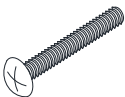

Bolt  $\varnothing$  1/4" x 25mm

#C 4pcs



Flat Washer  $\varnothing$  1/4" x 12mm

#D 12pcs



Flat Washer  $\varnothing$  5/16" x 16mm

#E 8pcs

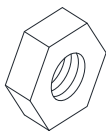

Hex Nut

#F 4pcs



Wood Plugs

#G 5pcs



Caster

#H 1pc

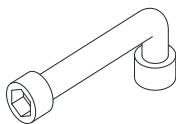

Allen Wrench

#I 1pc

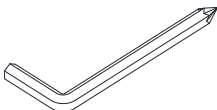

Allen Wrench

# ASSEMBLY INSTRUCTIONS

## 1

Part #3 x1pc  
 Part #4 x1pc  
 Part #5 x1pc  
 Part #6 x1pc  
 Hardware #D x2pcs  
 Hardware #E x2pcs

1. Insert the threaded end of the right chair arm (#5) into the right back support bar (#3).

2. Apply a washer (#D) then a hex nut (#E) onto the threaded end. Secure using the Allen wrench (#H).

3. Repeat the process with the left chair arm (#6) and left back support bar (#4).

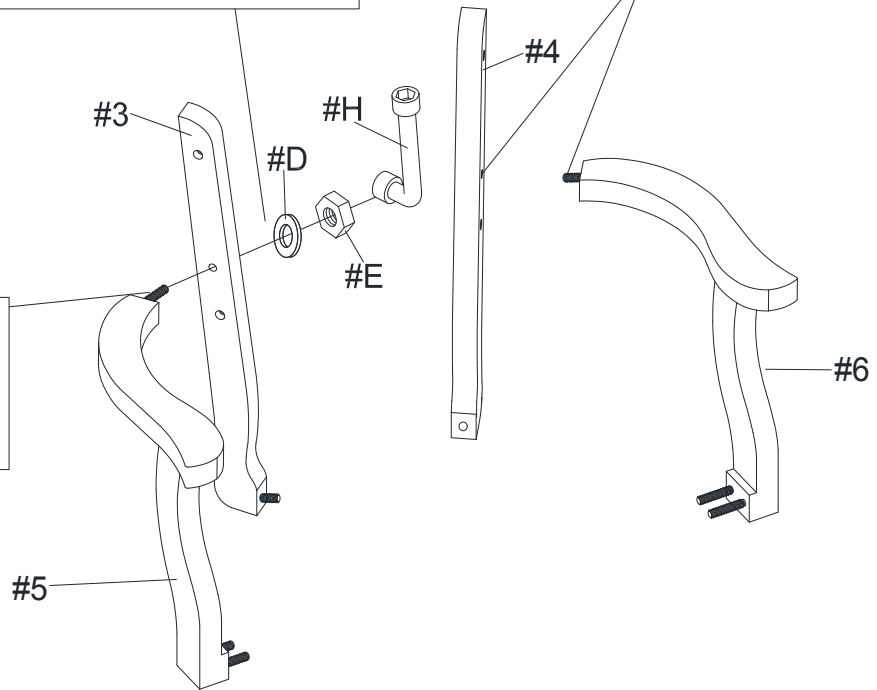

## 2

Part #2 x1pc  
 Hardware #D x6pcs  
 Hardware #E x6pcs

1. Insert the threaded ends along the bottom of the right back support bar (#3) and the right chair arm (#5) into the seat (#2).

3. Repeat the process with the left chair arm (#6) and left back support bar (#4).

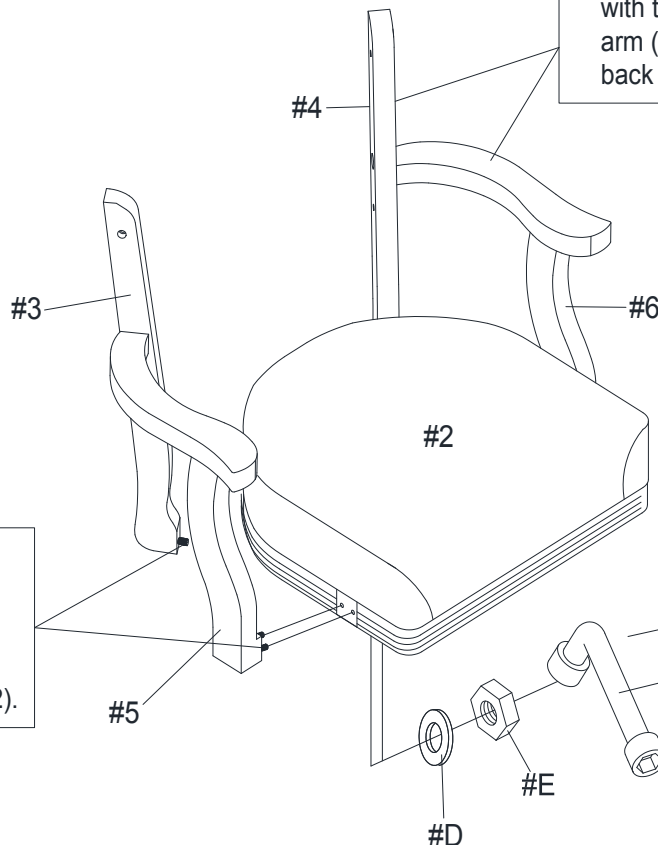

2. Apply a washer (#D) then a hex nut (#E) onto the threaded ends. Secure using the Allen wrench (#H).

# ASSEMBLY INSTRUCTIONS

## 3

- Part #1 x1pc  
 Hardware #A x4pcs  
 Hardware #C x4pcs  
 Hardware #F x4pcs

1. Slide the back cushion (#1) between the back supports.

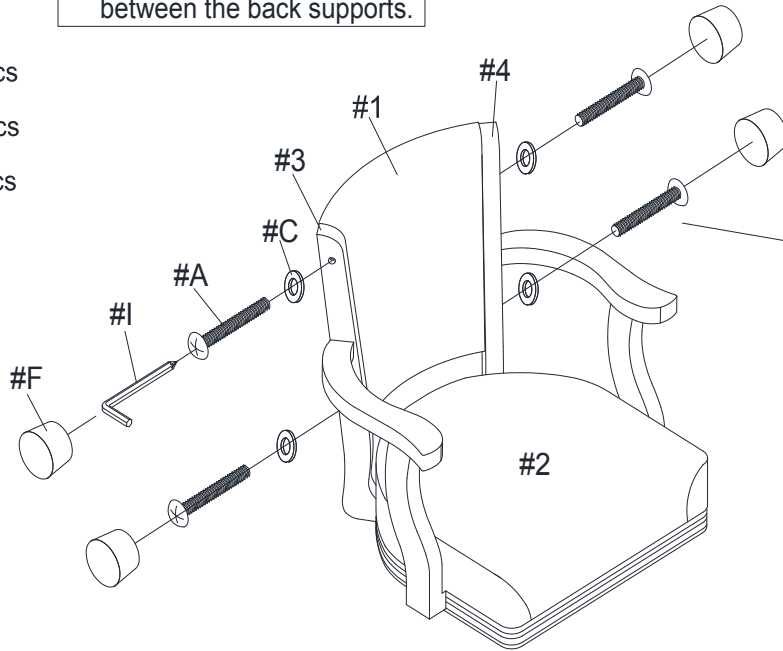

2. Prepare 4 bolts by inserting a washer (#C) onto the bolts (#A). Then insert the bolt assemblies into the holes along the sides of the back supports. Secure using a screwdriver.

3. Apply a wood plug (#F) into each hole.

## 4

- Part #7 x1pc  
 Part #8 x1pc  
 Part #9 x1pc  
 Part #10 x1pc  
 Hardware #B x4pcs  
 Hardware #D x4pcs  
 Hardware #G x5pcs

Remove cap on the tip of gas cylinder (#8) before assembly.

6. Prepare 4 bolts by inserting a washer (#D) onto the bolts (#B), then insert the bolts into the seat plate (#7). Secure using the Allen wrench (#I).

5. Place the seat (#2) onto the seat plate (#7).

4. Apply the seat plate (#7) onto the cylinder cover (#9).

3. Apply the cylinder cover (#9) onto the gas lift cylinder (#8).

2. Apply the gas lift cylinder (#8) onto the 5-star base (#10).

1. Insert a caster (#G) into each end of the 5-star base (#10).

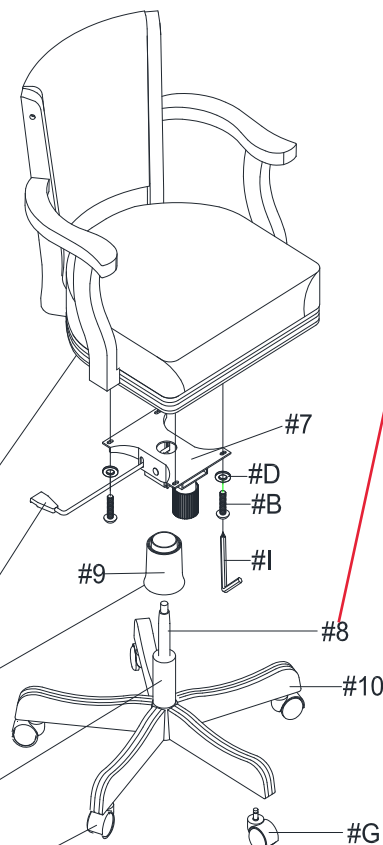

## ASSEMBLY COMPLETED



Please ensure the furniture rests on an even and flat surface. If the product wobbles or feels loose, double-check all bolts and/or screws are properly tightened and secured.

### ✓ Keep this handy!

Please retain this instruction manual and any order-related information for future reference.

### ✓ Lift, don't drag!

To avoid damage to product please always LIFT the product when transporting or adjusting the placement.