

Bumper car

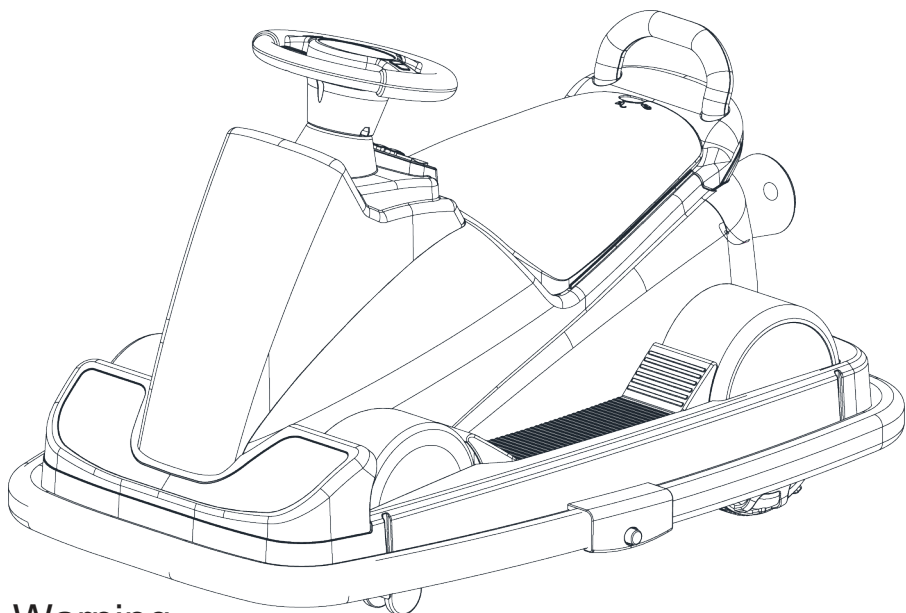

Warning :

Figure is only for reference.

- Age : 3-7 years old
- Maximum Loading weight: 35kg
- Assembly and each charge must be completed by an adult

ASSEMBLY INSTRUCTION

Please read this manual carefully before use.

This manual includes important information,
for future reference.

For the first use, it is recommended to charge for 4~6 hours.

WARNING



To prevent children suffocating from plastic big while playing, please keep it away with children.



Only allow to use this product on flat ground
(Not recommended to play on outdoor)

SPECIFICATION

Thank you for purchasing our products. We are always work hard to design comfortable and safe children's electric ride on toys to accompany your children through a lively and happy childhood.

A very important thing before using is to read this assembly instruction carefully. It will teach you the detailed installation procedures and the correct method of using. It can also guide you to avoid improper operations that damage the product or harm the kid. Especially, the important thing is that it will teach you a lot of safety precautions. Please memorize these contents and guide your children to use it. Please keep the assembly instruction properly and keep it in a place where it is easily to get.

Battery & fuse:	Two motors, 12V 4.5AH *1 (Fuse: 7A)		
Age:	3-7 years old	Size:	75.6*53.5*47.6CM
Loading weight:	Less than 35kg	Speed:	2.5 KM/H
Battery life:	300 times of charging	Charger:	Input: 100-240V Output: DC12V 500MA
Charging time:	8~12 hours		

Part List

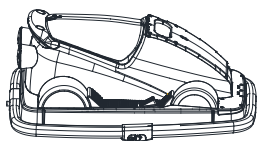

1、Body*1

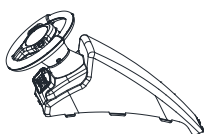

2、Front Cowling*1



3、Steering Wheel*1

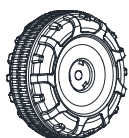

4、Wheel *2



5、Wheel cap*2



6、Front cover*1



7、Seat*1



8、Rear handle*1



9、Caster wheels*1

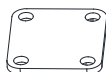

10、Axle fixed metal*2



11、Charger*1

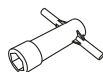

12、Allen wrench*2

ILLUSTRATION

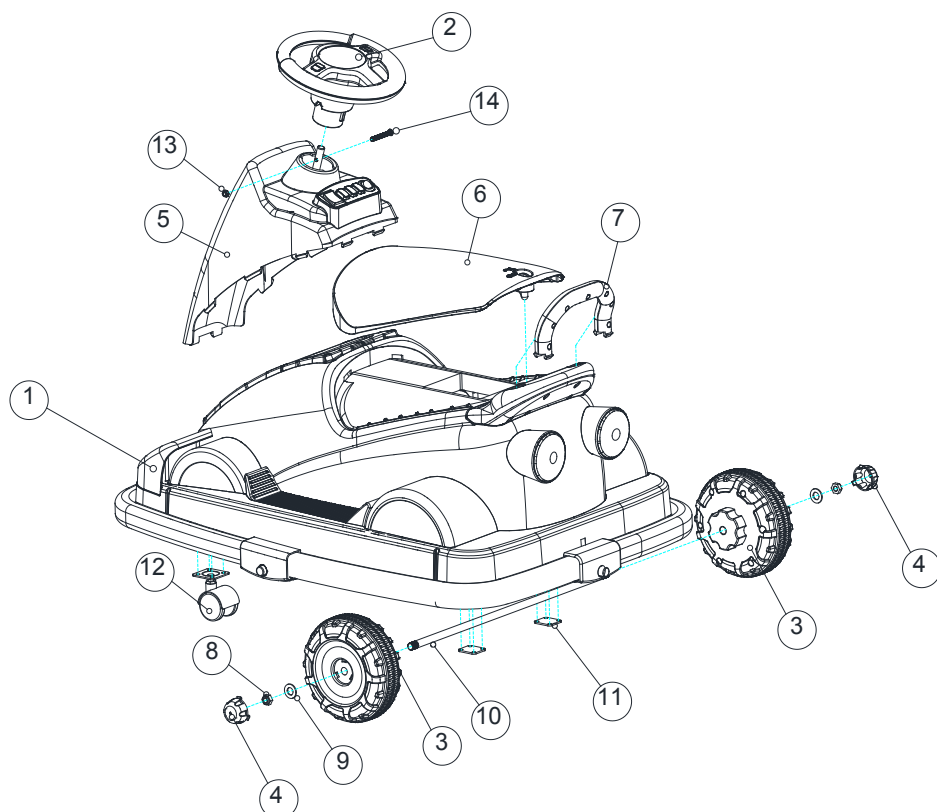

1	Body*1	8	M8 Locknut*2
2	Steering wheels*1	9	Ø10.5 washer*2
3	Wheel*4	10	Rear axle*1
4	Wheel cap*4	11	Axle fixed metal*2
5	Front cowling*1	12	Caster wheel*2
6	Seat*1	13	M5*40 Screw*1
7	Rear handle*1	14	M5 Locknut*1

ASSEMBLY STEPS

1. Assemble the vehicle before using, must be operated by an adult
2. Tools required for installation: screwdriver
3. Small parts would be the risk of choking, children are strictly prohibited to touch and play!
4. Please be carefully check the quantity of all parts before installation, and the packaging plastic bag, please keep it properly, children are strictly prohibited to play, there is a danger of suffocation!

1

1. First turn the car body over, with the bottom of the car facing up.
2. Cut off the ties on the gear boxes on both sides, and use a wrench to remove the screws and washers on the rear axle.
3. Lift the gear box up appropriately, and then insert the rear axle until the axle is the same length on both sides according to visual inspection. Then put the wheels on the axle from both sides. Put the spacers on the outside of the wheels first, and then twist the nuts by hand. Finally, use a wrench to tighten the nuts on both sides.

Tip: When twisting the nut with a wrench, only twist it until 1-2MM of the nut is exposed from the thread. Tightening it too tight will affect the next step of assembly.

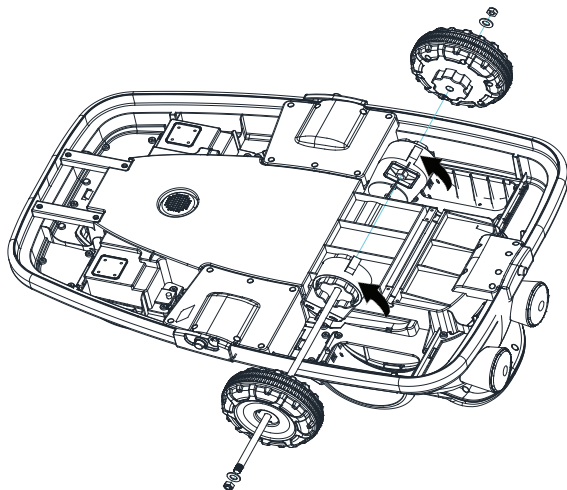

2

Install the rear axle group assembled in the previous step into the installation position on the chassis of the vehicle as shown in the figure. Note that if the installation is too tight, use a wrench to loosen the screws on both sides appropriately. If the rear wheel shakes too much after installation (It is too loose) and tighten the nuts on both sides appropriately.

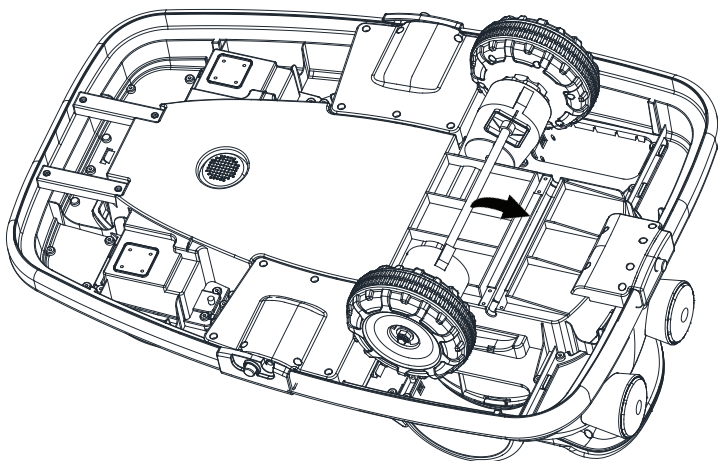

ASSEMBLY STEPS

3

1. Find two small metal pieces (axle fixed metal) and self-tapping screws in the accessory bag. Align the axle fixed metal with the screw holes to fix the rear axle group installed in the previous step.
2. Snap on the wheel cover

Auxiliary tools



Phillips screwdriver
(bring your own)

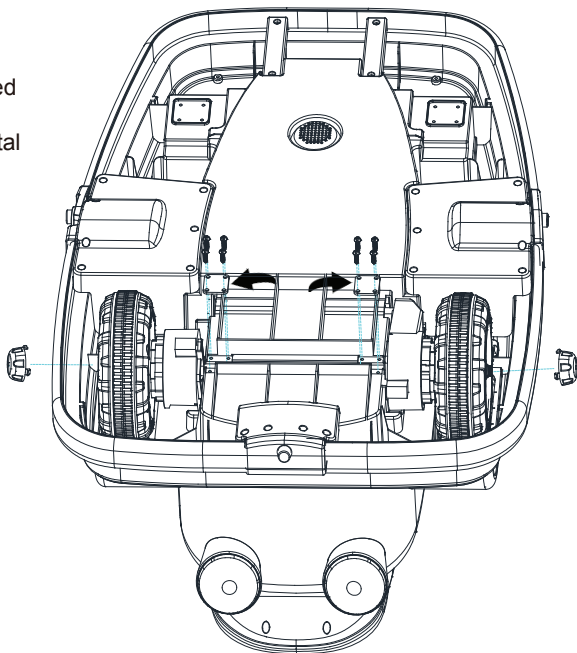

4

- Find two caster wheels in the accessory bag and fix them with self-tapping screws.

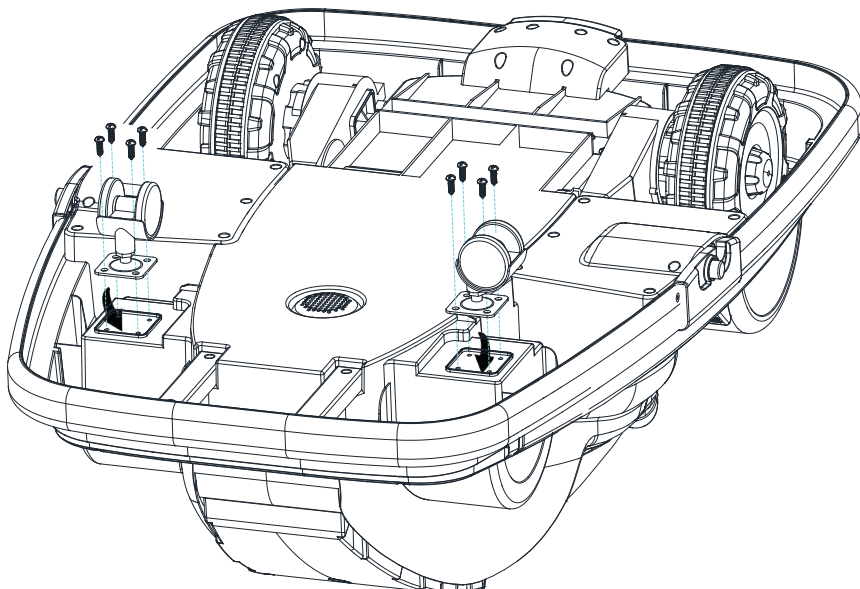

ASSEMBLY STEPS

5

1.First connect the connecting plug on the body, connect it with the connecting plug on the head unit, and then put the wire into the body.

2.Align the buckle on the head unit with the mounting buckle on the body, then hold it steady with one hand and press it firmly into place with the other hand (press until you hear the click sound)

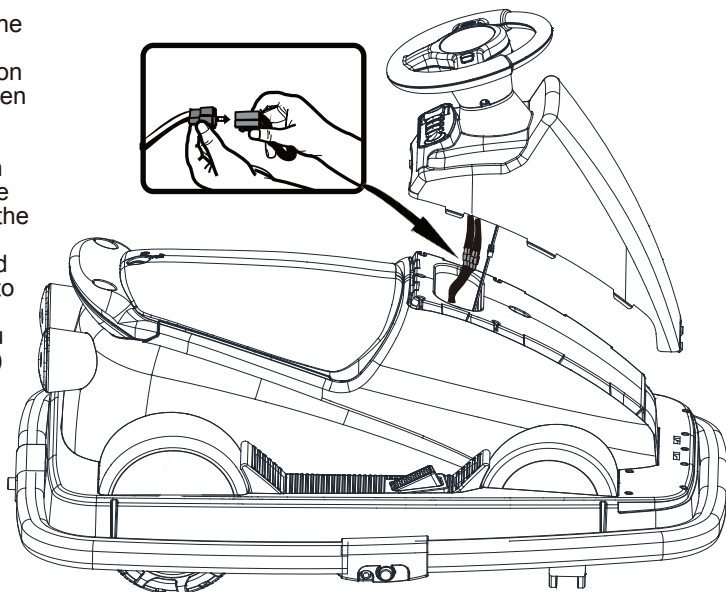

6 Insert the rear handle into the rear of the car body in the direction shown in the figure, and press it firmly into place.

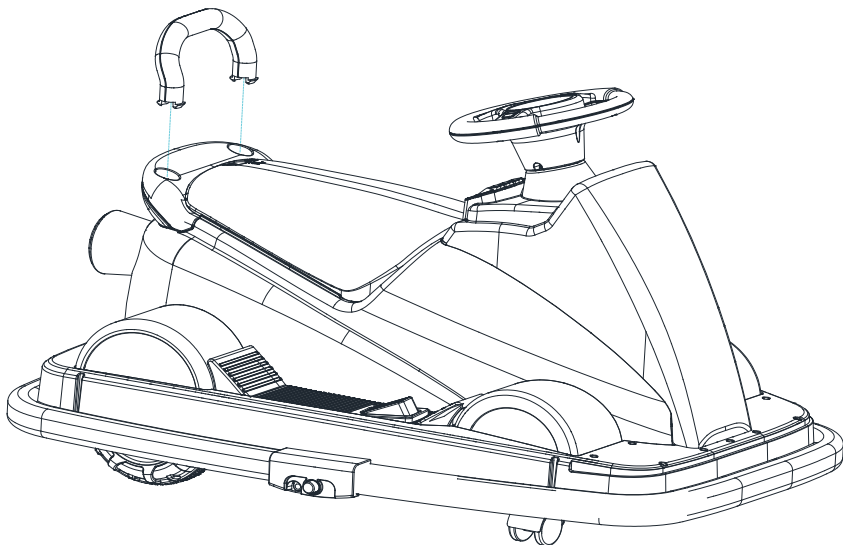

ASSEMBLY STEPS

- 7** First install the front cowling on the front of the car as shown in the figure (align the screw hole posts with the countersunk holes in the body)

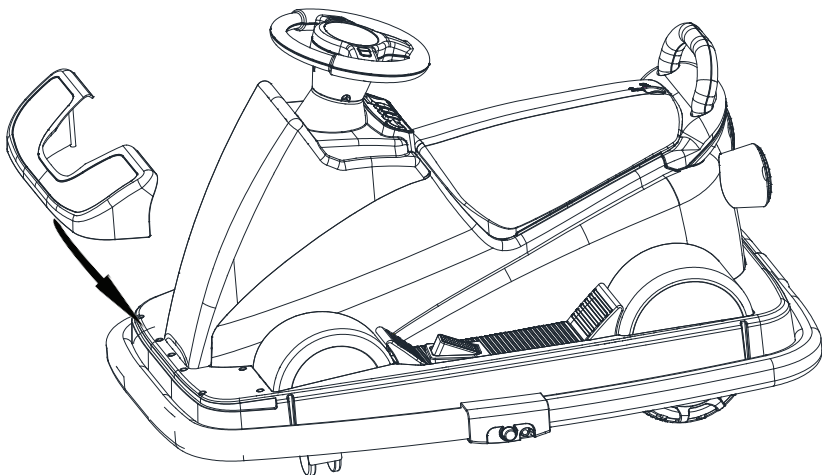

- 8** Turn the car body over with the bottom of the car facing up, and lock the front cowling with self-tapping screws.

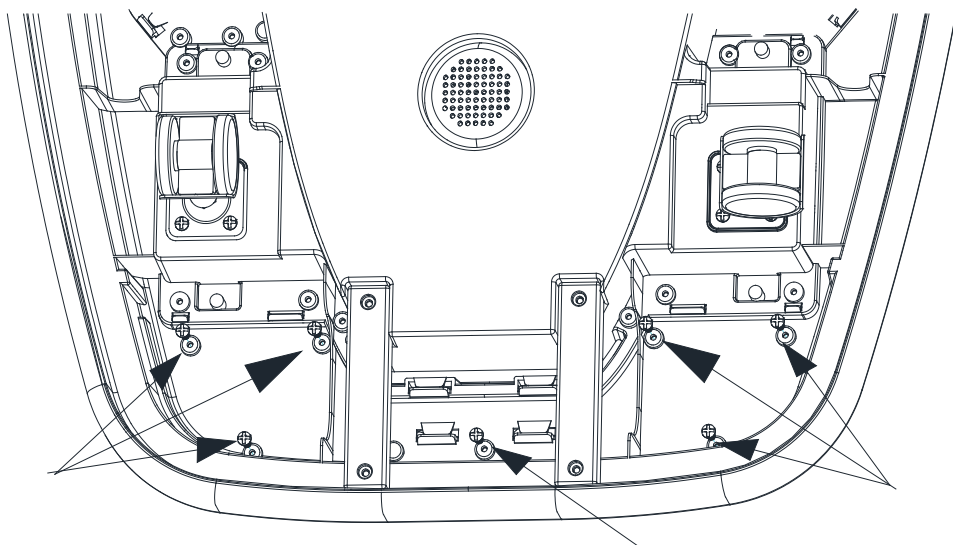

ASSEMBLY STEPS

9

1. Twist the seat lock to the open position as shown in the picture, and remove the seat from the car.

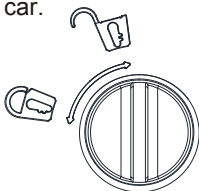

2. Insert the red wire end of the power supply inside the car body into the red terminal of the battery.

3. Install the seat and twist the lock to the closed position as shown in the picture.

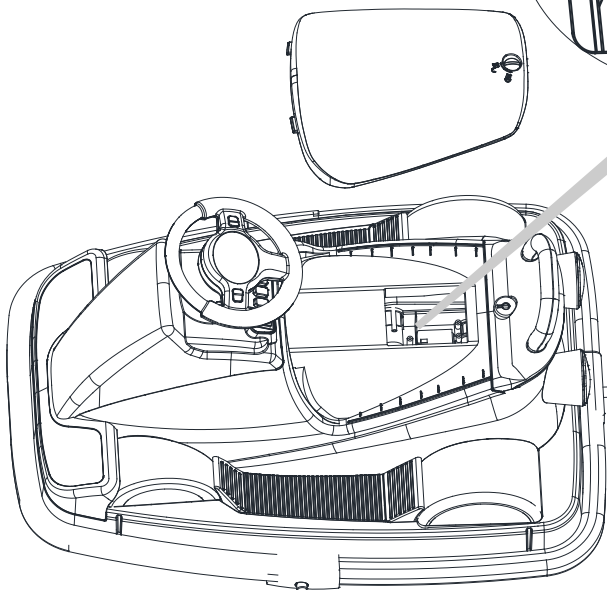
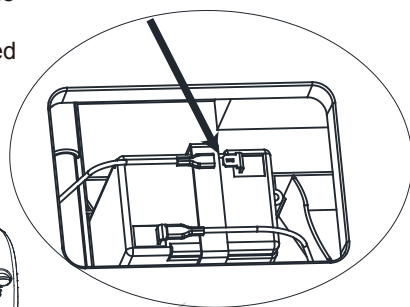

WARNING!

To prevent accident happend:

- When playing the car,it must be guided by adult or family to instruct,and adult should be accompanied with each other,keep your eye on your children all the time
- Don't play at dangerous place such as road,near car and stairs.
- It is necessary to wear a shoe.
- The applicable age range of this product:3-7 years old;The maximum load is 35kg.

Before using, noted to finish below process:

- **IMPORTANT!** First use, the battery needs to be charged for at least 4 - 6 hours, not more than 10 hours,and the charging can only be operated by adults.
- Follow the steps described in the instruction manual to complete the installation of the whole toy. The battery plug-in has been plugged in and the power supply has been switched on;
- All positions requiring screw fixation ensure that they are locked.

Safty Warning

Please teach your child and his playmates the following safety rules and make sure they understand them!

- Must be played under adult supervision.
- A protective helmet should be worn when playing the toy.
- When playing the toy, you must wear shoes.
- When playing the toy, you must sit on the seat.
- Make sure your child plays the toy in a safe playing environment, such as home, garden or playground.
- Note that the toy is only suitable for playing on a hard and flat road surface. In order to ensure safety, it is prohibited to play in the following unsafe environments:

A Ditch pits, riversides, lawns, slopes or uneven ground;

B Roads or other vehicle forms, places where pedestrians walk;

C Possible to hit an obstacle that may cause injury;

D Other Unsafe places.

- Avoid children playing in the dark. Children will not deal with unexpected obstacles or accidents. Only during the day or in bright areas.
- Do not use this product outdoors when it rains or snows.
- When shifting gears, make sure the toy has stopped moving completely.
- Please confirm that the users of this product meet the applicable age range of this product and shall not exceed the maximum load capacity.
- Do not change the structure and wiring system of this product without authorization.
- Regularly check whether the electric wire plug-in of the toy is aging or falling off.
- To avoid accidents, please make sure the toy is safe before driving.
- Please don't let any children approach the moving toy and don't let them touch the wheels.

FUNCTION ILLUSTRATION

Function diagram

(please check whether the power switch is turned on correctly first)

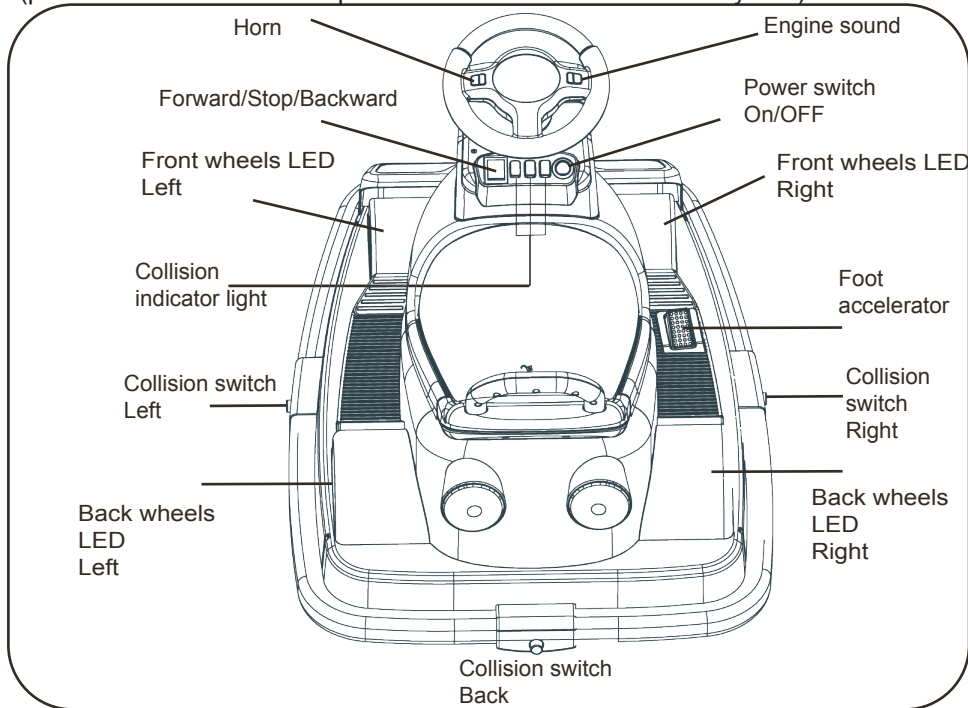

Music/Light:

1. Turn the "power switch" to the "I" position, All four wheel LED lights are on.
2. There are two music buttons on the steering wheel. Each button has 3 built-in music. Press it to switch to one music.

Riding Mode:

1. Forward: Move the "Forward/Stop/Reverse switch" to the "Forward" position; gently press the "foot switch" and the vehicle will move forward.
2. Stop: Lift your foot and release the "foot switch", the vehicle will stop moving. Or move the "forward/stop/reverse switch" to the "stop" position;
3. Reverse: Move the "forward and reverse switch" to the "reverse" position; lightly press the "foot switch" and the vehicle will move backward.

Interactive Crash Game Mode:

1. When two children each drive a car and play with each other, when the car behind collides with any of the three collision switches of the car in front (left/right/rear), the car that is hit will sound "hit". The sound, the lights will flash for a few seconds, the car will vibrate, and one of the front collision lights will light up; the second time it hits, the car will have the same reaction, and the second collision light will light up.
2. After being hit twice (after the second collision light comes on), children should pay attention to protect their car from being hit a third time, because if it is hit a third time, a collision sound will be made and the car will continue to be hit. After a collision, all functions will be temporarily lost and the car game will fail. Wait for about 15 seconds for the car to restore all functions before entering the next collision game.



WARNING!

This car is fast (the maximum speed is about 2.5KM/H) Before use, make sure that the driver is able to manipulate the vehicle proficiently to avoid accidents due to excessive speed!

CHARGING

Charging must be done by an adult

WARNING!

- **Prevent fire and electric shock:**

- Only the charger and battery specified by the manufacturer are allowed to be used, and other brands of chargers and batteries are prohibited. Otherwise, it may cause fire and explosion.
- Do not use this charger and battery on other products, otherwise overheating may lead to fire and explosion.
- Do not change the wiring structure of the product without authorization, otherwise it may cause fire and explosion and may cause permanent damage to the product.
- Do not connect the positive and negative poles of the battery with tools, otherwise it may cause fire and explosion
- Always keep the battery dry and do not expose it to fresh or salt water.
- When the battery is charged, it will generate harmful gases and have pungent odor.
- Smoking is strictly prohibited near the charged storage battery, and any fire or spark is strictly prohibited to prevent causing explosion and other accidents
- The toy must be charged in a well-ventilated and dry area.

- Do not open the battery and charger.
- Do not reverse the battery.
- Before charging, please check whether the charger, battery and plug are damaged. If any damage is found, stop using it until it is repaired and reused.
- It is normal for the battery to generate heat during the charging process, but if the temperature is too high, it is necessary to check whether the charging current is too high or whether the battery is short-circuited.
- The battery must be fixed with a pressing plate. If the car overturned, the battery might fall out and hurt children.
- If the product is stored or not used for a long time, it must be fully charged and charged once a month to ensure the battery life.
- Chargers and batteries are not toys and children are not allowed to play.

- When charging, power switch must be turned off.
- It is recommended to charge for 4-6 hours before the first use, and less than 10 hours.
- When the normal running speed of the toy obviously slows down, it means the battery power is low. Please charge it in time.
- Every time use, please charge for 8-12 hours, but not more than 20 hours.

CHARGING

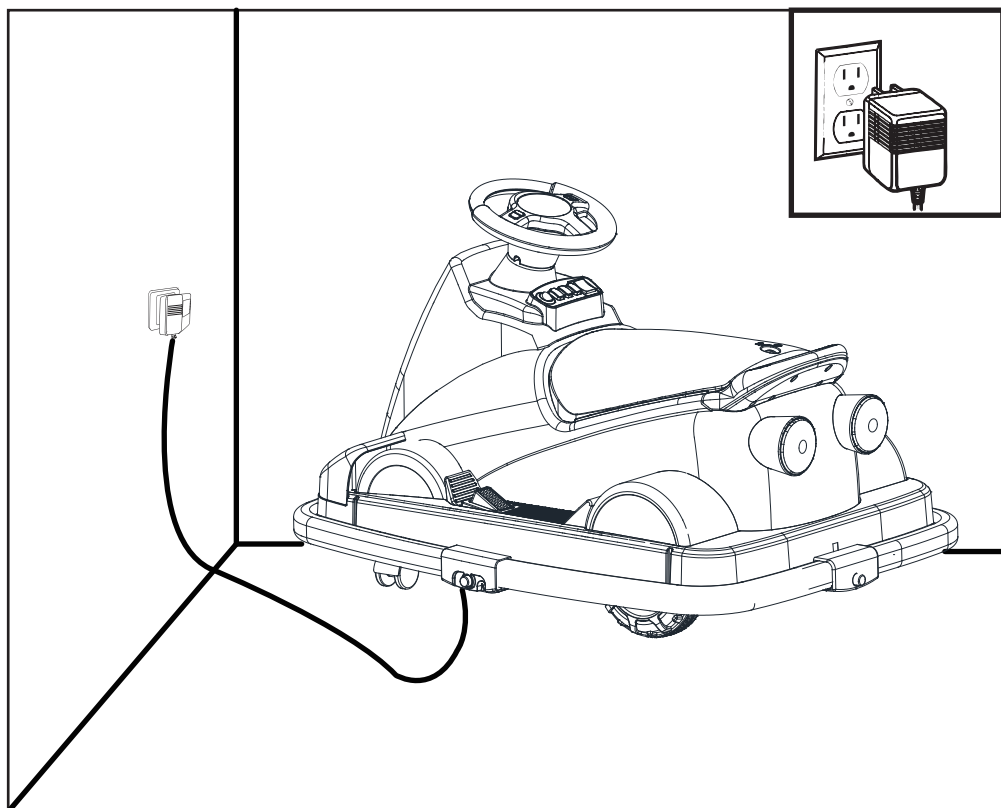

- 1.The charging hole is located on the side of the body
- 2.Insert the charger plug into the charging hole
- 3.Plug the charger into the power outlet.



WARNING !

This product has a charging protection function:when charging,all functions of the vehicle are not available.

Problems & Solutions

■ Problems: Car can't move.

Reason: Battery's power is low.

After each use, please charge for 8-12 hours, but not more than 20 hours.

Reason: Overloaded.

This car is equipped with a self-reset fuse, which will automatically cut off the power supply for 5-20 seconds and then restart when overloaded or not in use. The self-reset fuse of this car is installed under the seat (as shown in the photo).

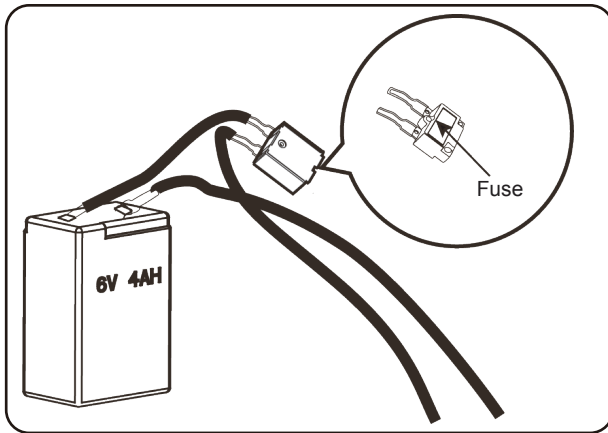

To prevent the fuse from cutting off the power supply:

- This product can not be overloaded. The maximum load is 35kg.
- Do not drag and drop anything behind this product.
- Do not let water or other liquids soak into electrical components such as circuits and batteries.
- Don't change the wiring system and structure of this product without authorization.

Reason: Nut in drive wheel is loose.

If the nut of the driving wheel is not locked, the motor will not be able to drive the driving wheel and the toy will not be able to travel. Please lock the nut with a spanner.

Reason: The battery plug-in or wire is loose.

Make sure the battery plug-in is properly connected and there is no loose wire.

Reason: The battery is broken.

Please contact your agent or manufacturer.

Reason: Body wiring is damaged.

Please contact your agent or manufacturer.

Reason: Motor is broken.

Please contact your agent or manufacturer.

■ Problem : Charged but still no power

Reason: The battery plug-in is loose.

Make sure that the battery terminals and wires are firmly connected together.

Reason: The charger is not plugged in.

Make sure the charger is properly plugged into the power outlet.

(If the power outlet has a switch, make sure the switch is turned on.)

Reason: The charger does not work properly.

Does the charger feel slightly hot when charging? If not, it is likely that the charger has been damaged. Please contact your agent or manufacturer.

Problems & Solutions

■ Problem: The playing time of the car is very short.

Reason: The battery is under-charged.

The battery charge time is not enough.

Please charge it in time after each use and at least once a month.

It is recommended that the charge time should be 8~12 hours, not exceed 20 hours.

Reason: Battery aging.

The battery is a fragile and consumable part. Its service life mainly depends on the timeliness and correctness of its charging and maintenance operation. Therefore, the service life of the battery is 1~3 years. If it exceeds its service life, it is recommended to replace a new battery.

■ Problem: The charger is buzzing while charging.

This is a normal phenomenon.

■ Problem : The charger has a heating phenomenon during charging

This is a normal phenomenon, but if the temperature is too high, you should check whether the charging current is too high or the battery is short-circuited.

Maintenance

- Before using, parents should check whether the main components are in good condition and whether the battery, charger, wire, plug, housing and other components are damaged. Whether the screw is loose or not; Whether there is a potential safety hazard or not, stop using it when it is found damaged until it is completely repaired.
 - After a period of use, lubricate the iron parts of the vehicle with a small amount of lubricating oil to prevent wear and rust.
 - Toy should be placed far away from the fire source and avoid long-term illumination. They should be placed flat up and not upside down or tilted. In wet weather, the car should be parked indoors or covered with waterproof cloth.
 - Toy should be kept away from hotter objects such as stoves and heaters. Plastic parts may melt. Keep away from flammable objects when charging to prevent fire.
 - Please charge in time after use. Charging must be done by an adult. If it is stored or not used for a long time, it must be fully charged first and then charged at least once a month to prolong the battery life.
 - Wipe the toy with a dry soft cloth. You can also use a non-wax furniture polish instead of a soft cloth to wipe the plastic parts to achieve the surface clean effect. Do not use chemical solvents to wipe the plastic parts of toys. Do not clean the toy with soap and water. Do not drive the toy in rainy or snowy weather. Water will damage the motor, the vehicle's electrical system and the battery.
 - When you stop using or placing the product, please cut off the power supply of the product and turn all switches to the stop "or off" position.
 - Do not use fuses that do not conform to the specifications of this product.
 - Do not change the structure and wiring system of this product without authorization.
- Maintenance work must be carried out by professionals or under the guidance of technicians.