

HOW TO INSTALL YOUR STAIR PARTS

BALUSTER WITH DOWEL

IMPORTANT - PLEASE READ ALL INSTRUCTIONS BEFORE YOU BEGIN INSTALLATION.

- These instructions are for wood baluster with dowel installation.
- Refer to your local building code for current regulations.

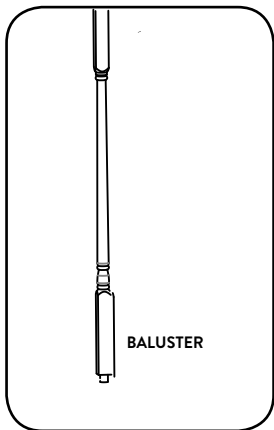

Part included

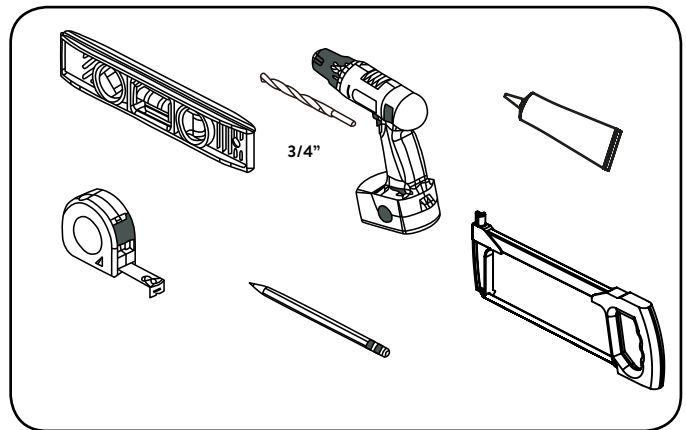

Recommended tools

1. Baluster installation

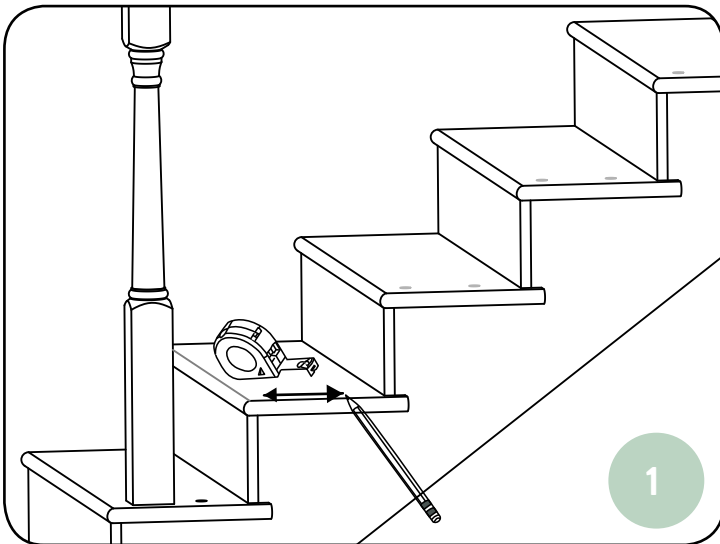

Mark the location of each baluster at an equal distance from one another in accordance with your local building code.

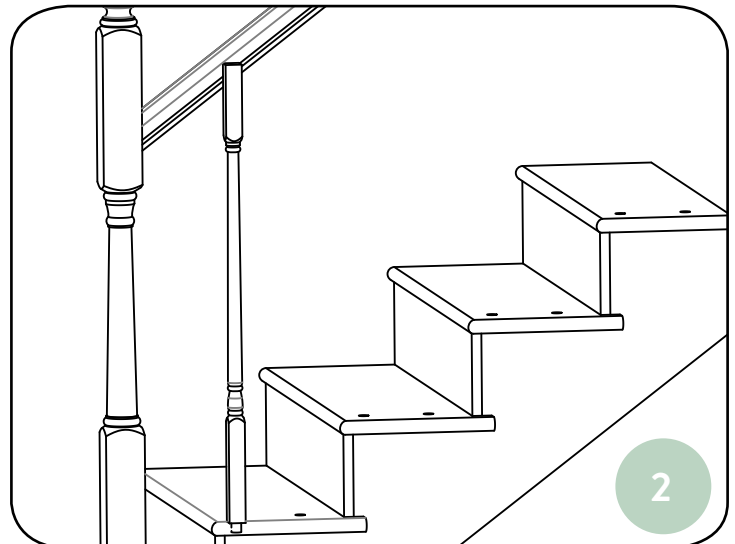

Align a baluster against the handrail, for each baluster location, then trace the angle of the handrail on the baluster.

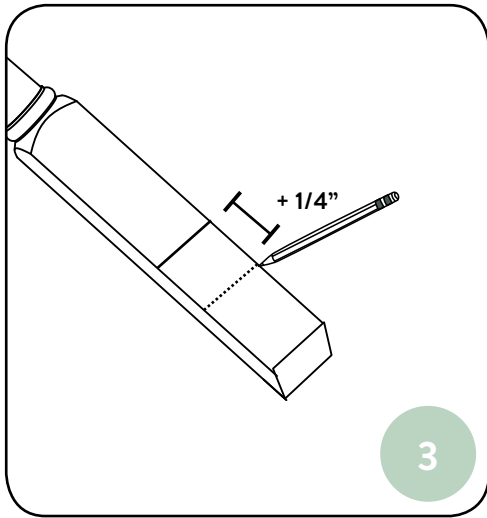

Add a 1/4" to your mark to take in consideration the depth of the handrail plow.

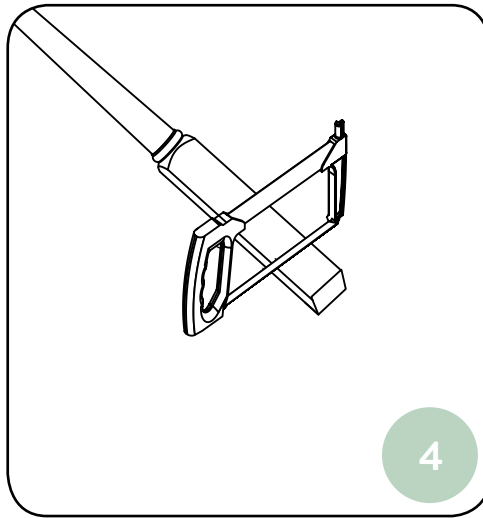

Cut your baluster

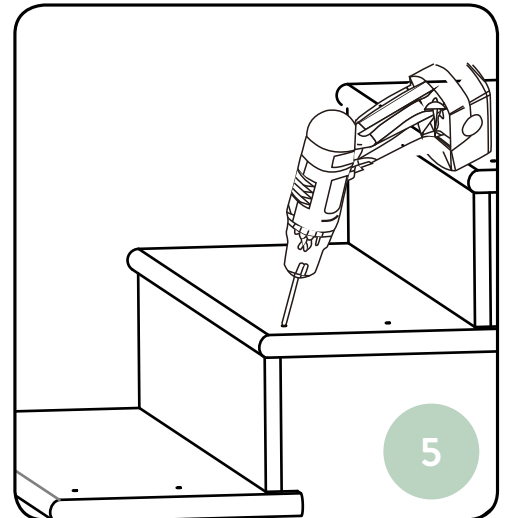

Drill 3/4" holes at each mark, 1" deep.

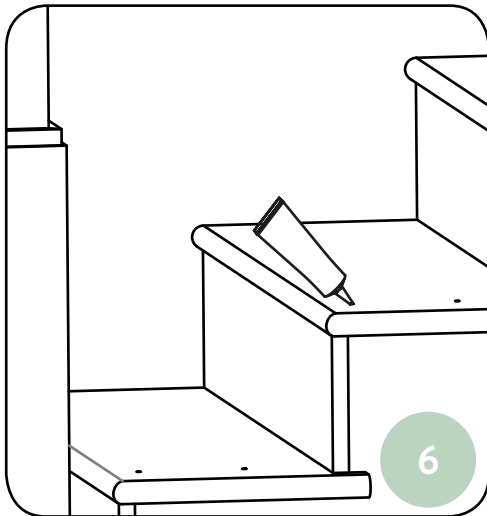

Add glue in each hole.

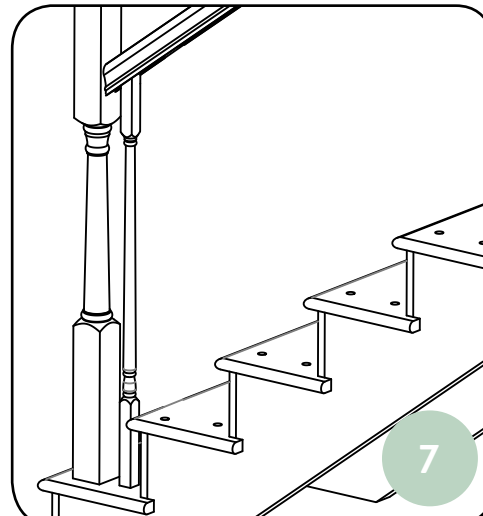

Put baluster in place.

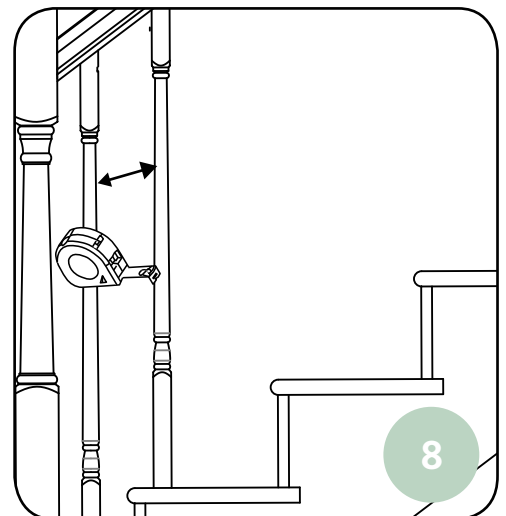

Measure the distance between each baluster at the base.

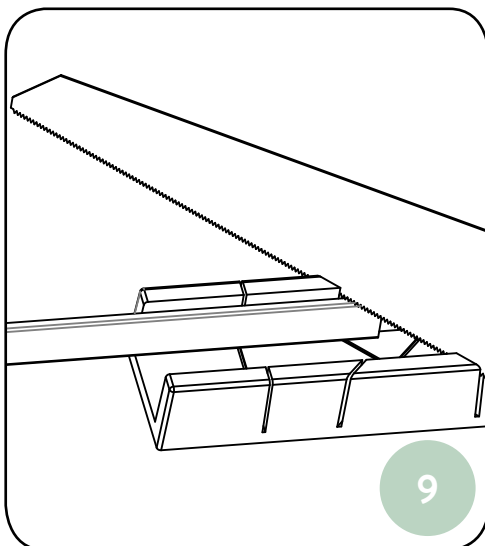

Mark and cut the fillet.

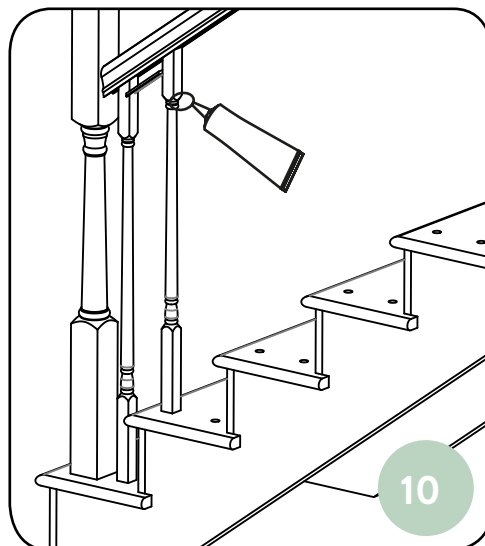

Apply wood glue and secure the fillet in place using finish nails.

DO NOT RETURN TO RETAILER

If you have any questions, please contact our customer service at:

info@colonialelegance.com or call toll free at: 1-800-361-2030