



5 Panels Folding Door Installation Manual

Door Panel

Located in the woodcrate

5 total Door Panels can be
find in the woodcrate

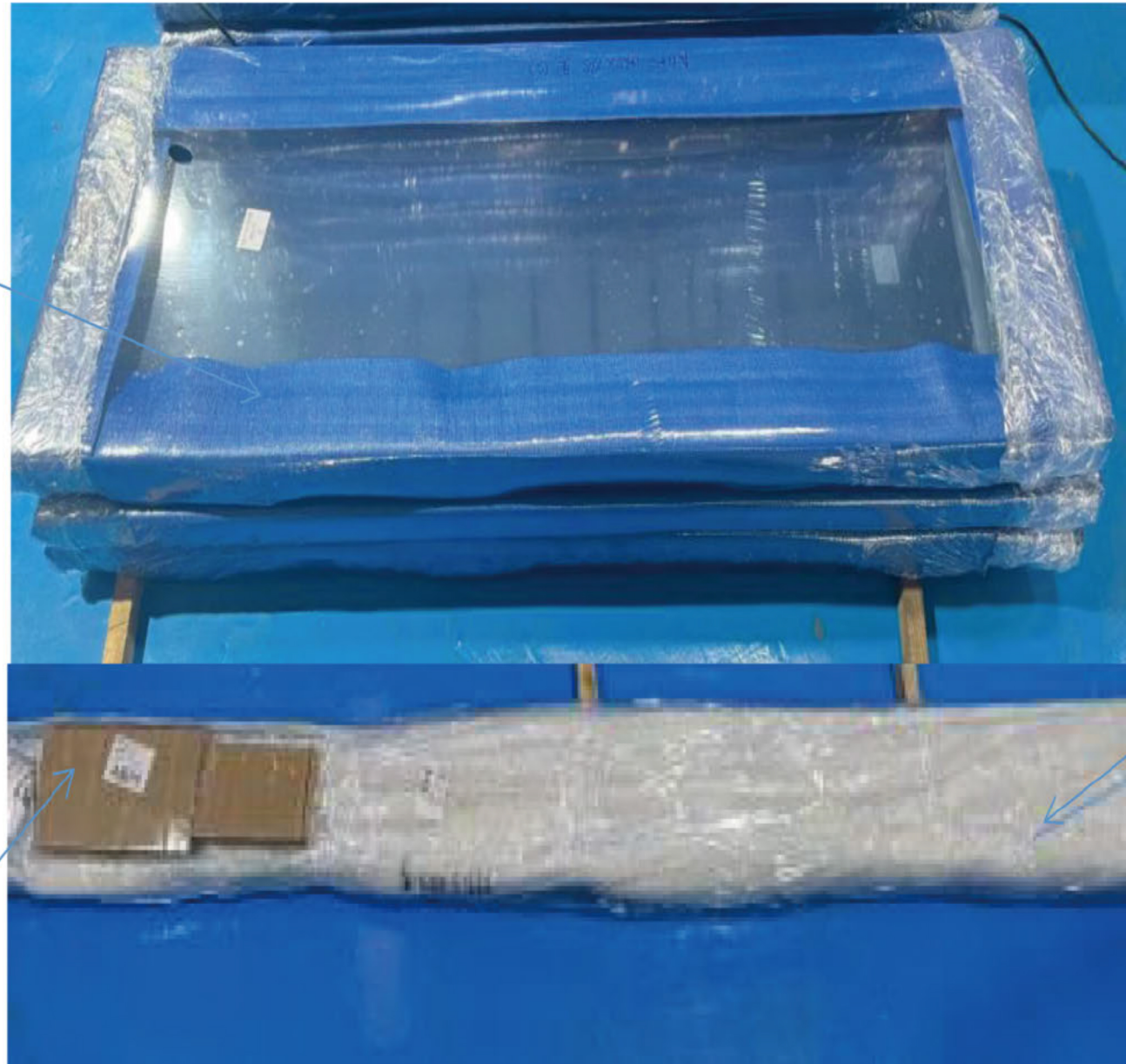

Door Frame

Accessories

The accesories is located in
the door frame carton

Tools Needed



Hand drill



Impact drill



Allen wrench



Spanner



Spirit level



Ladder



Gloves



Helmet

Assembled Product

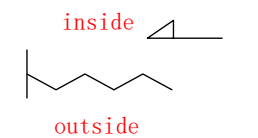
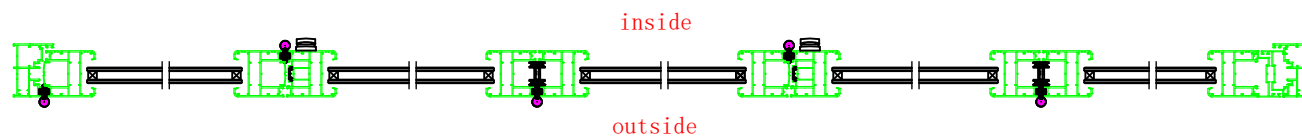
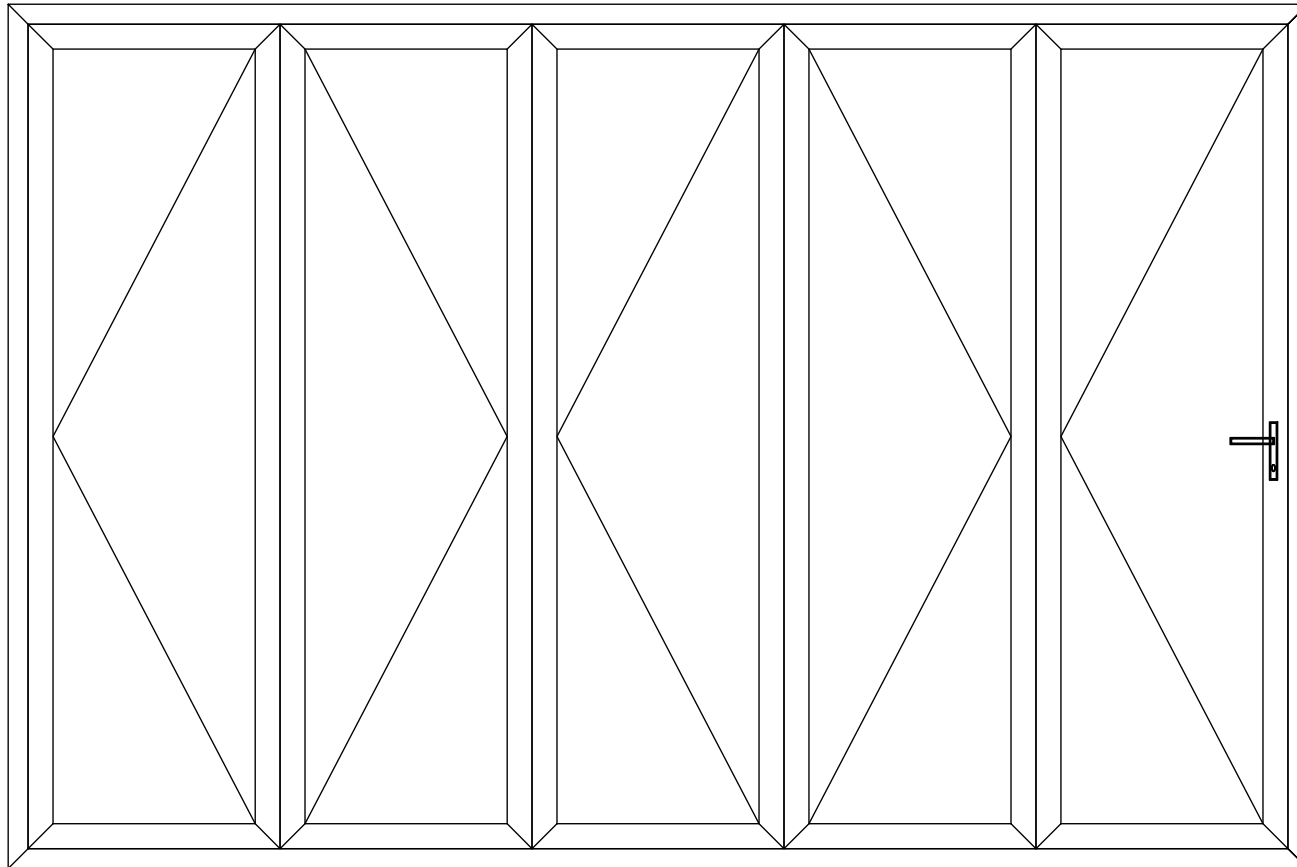

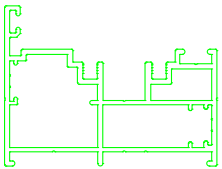

Outer
frames

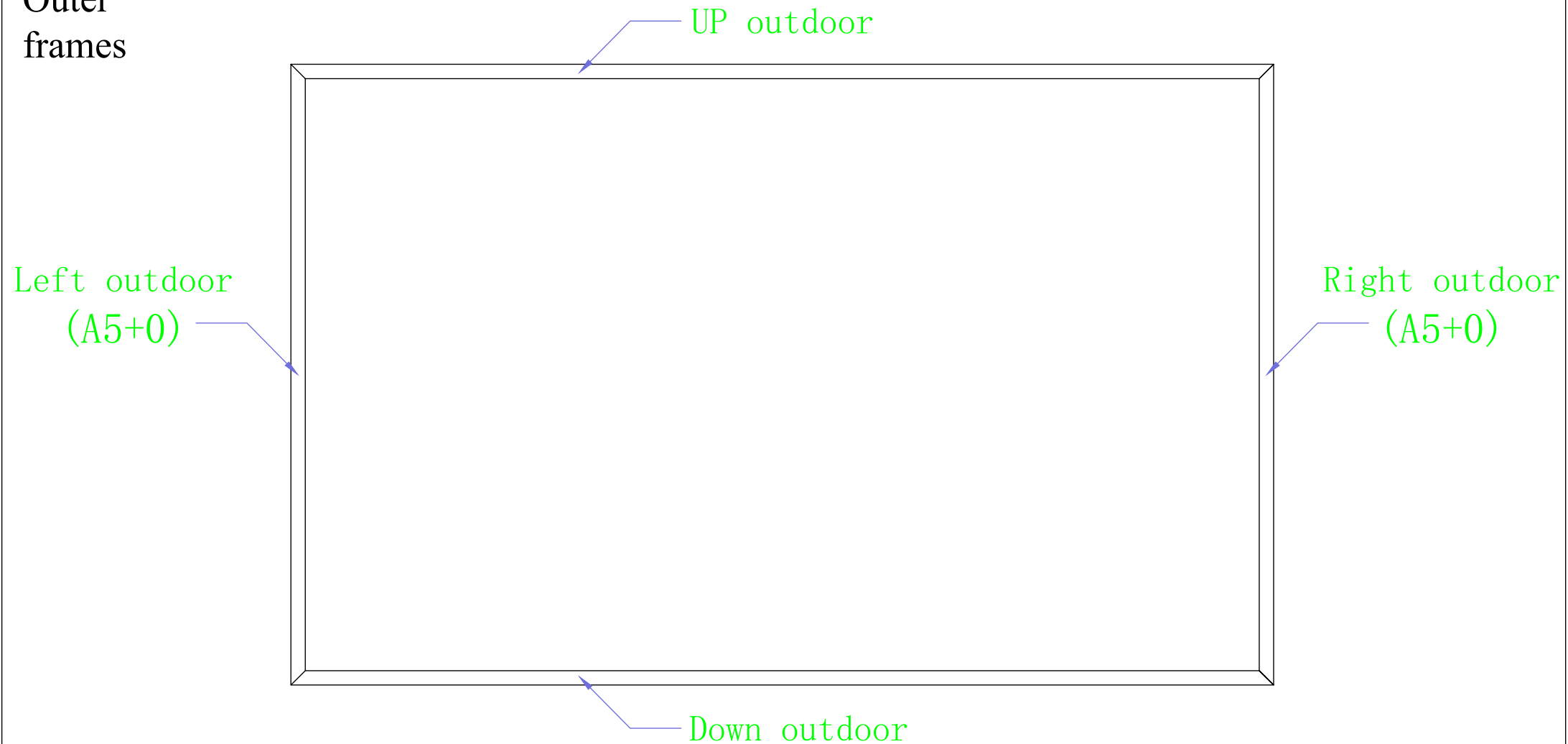

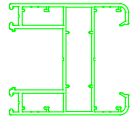

Door panels

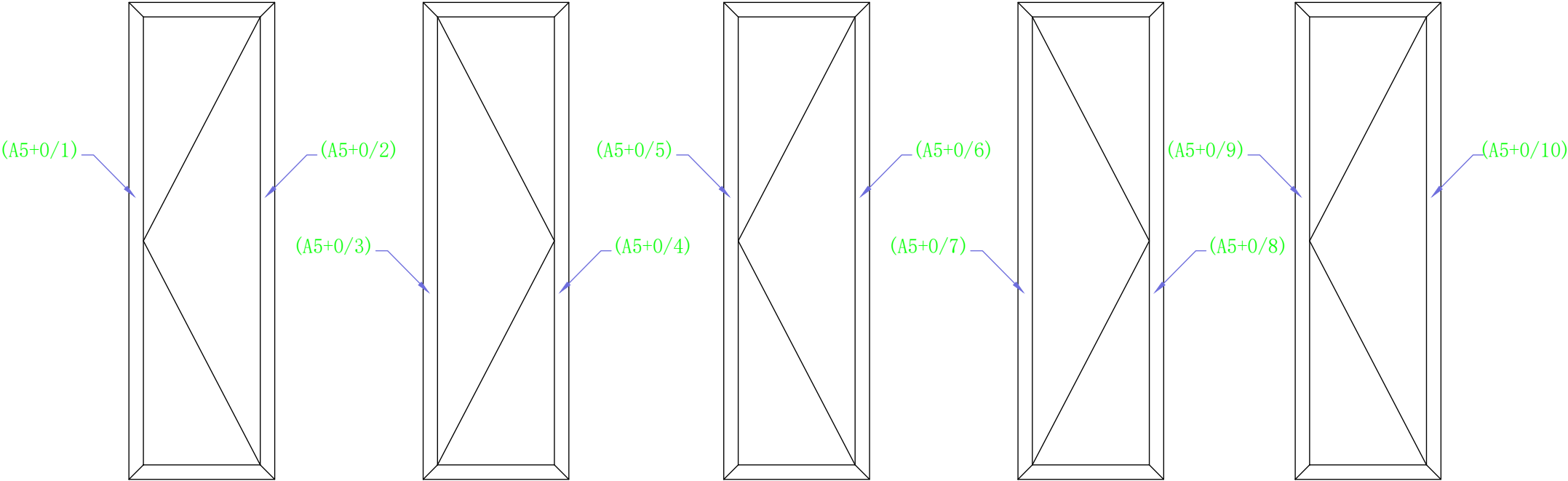

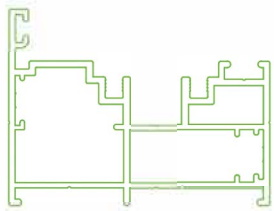

Outer frames

Assembly of the outer frame: Use conner joint to assemble the outer frames.

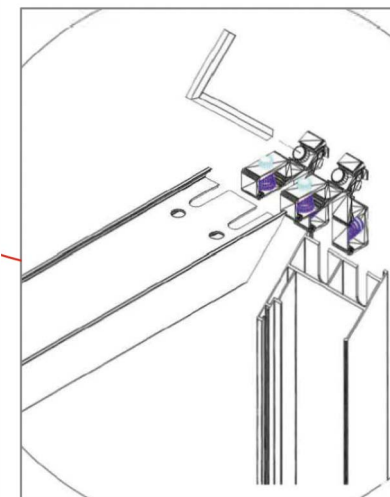
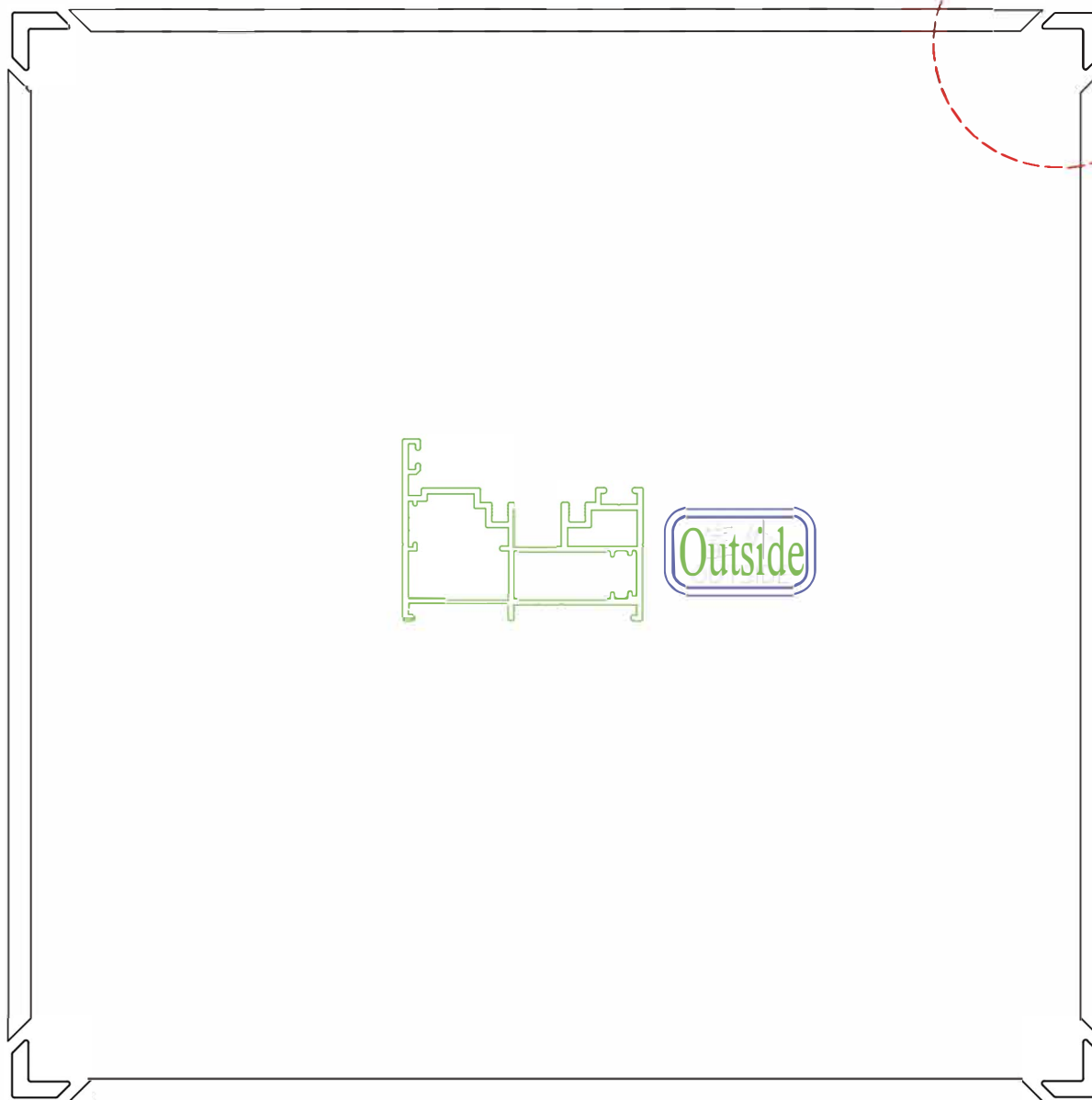

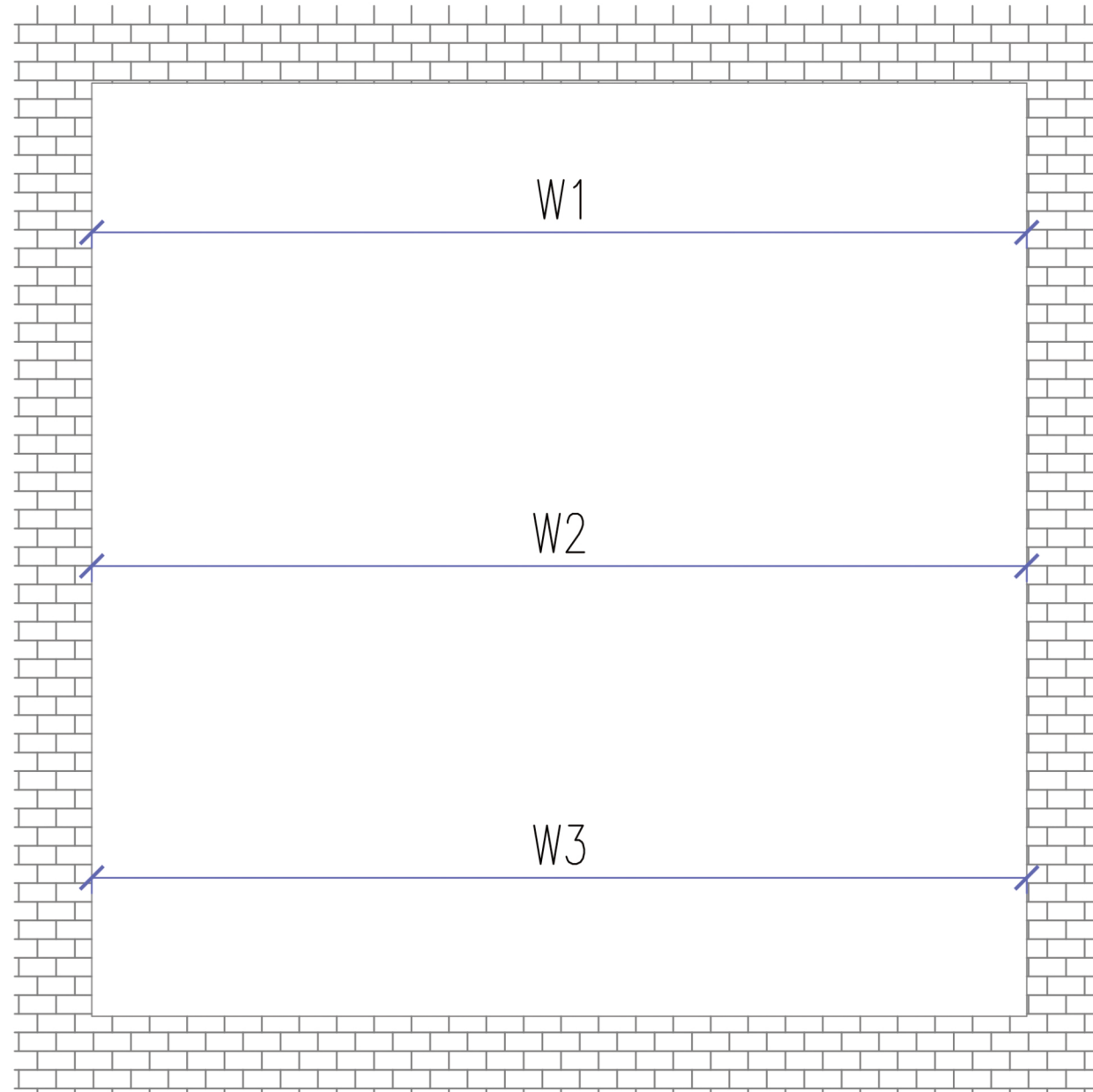

Measure the width of the door opening before installing the outer frame: Choose three different horizontal lines on the door opening to measure separately, and then take the average of the three measurements.

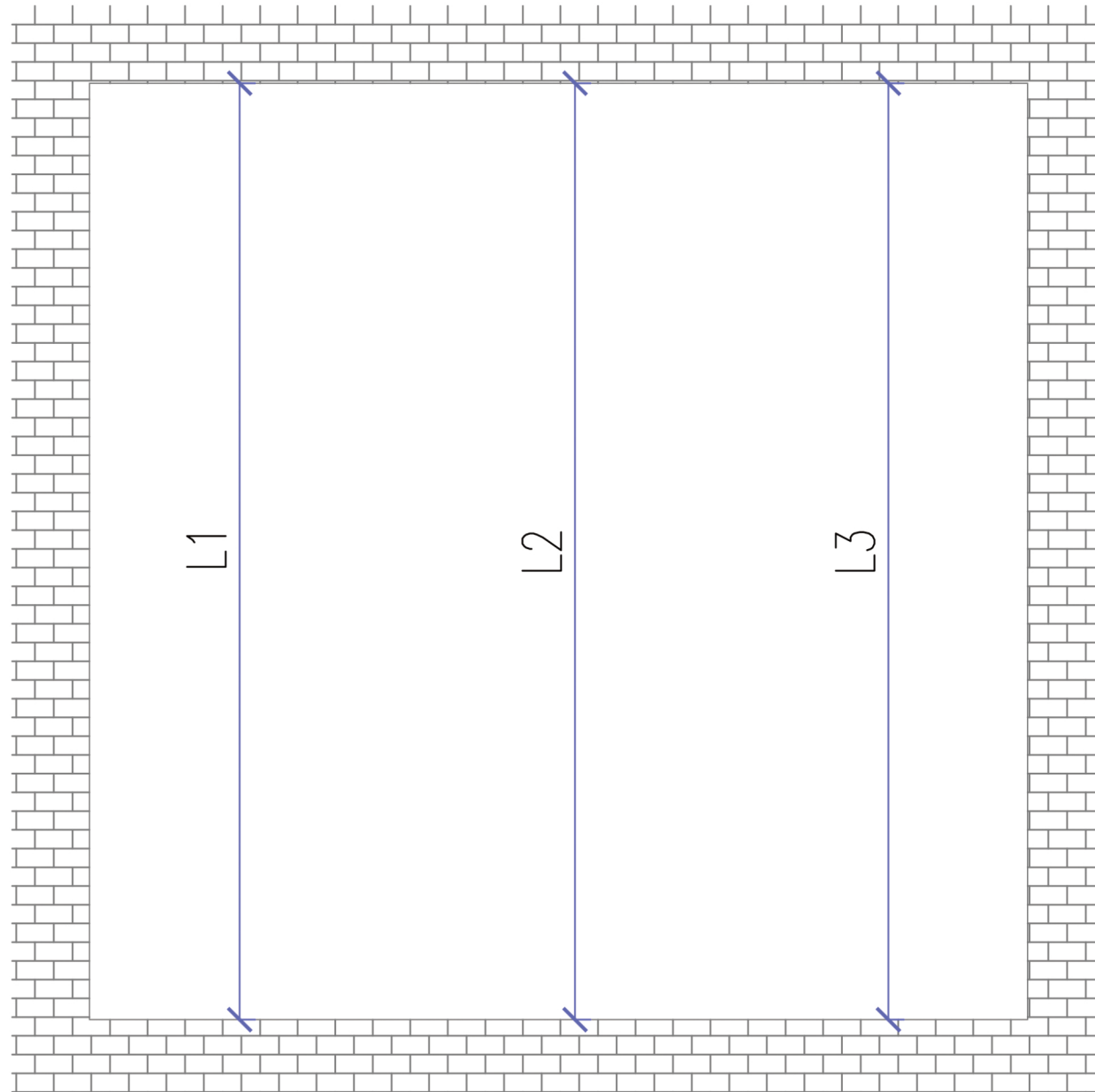

Measure the height of the door opening before installing the outer frame: Choose three different vertical line on the door opening to measure separately, and then take the average of the three measurements.

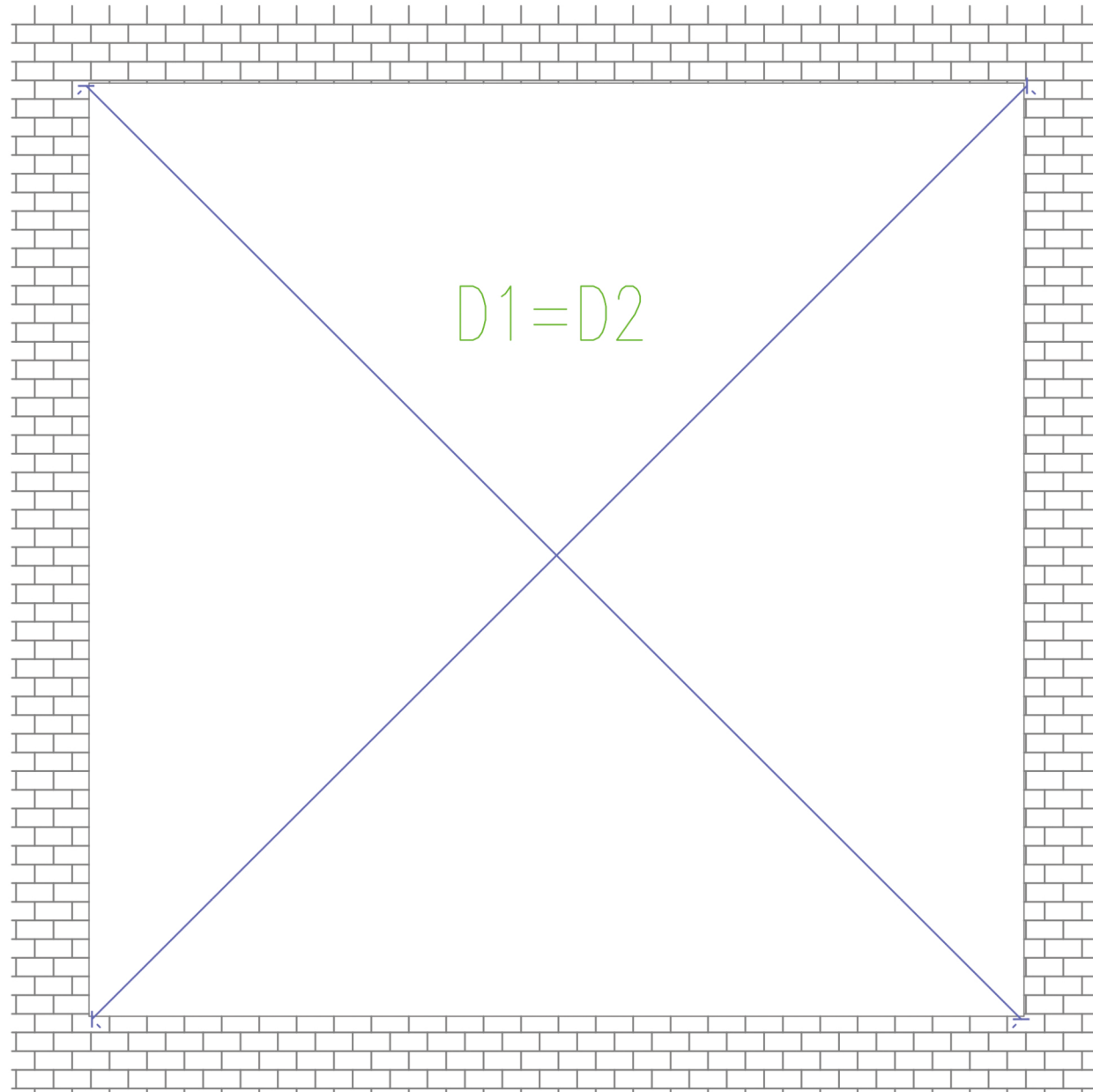

Measure the two diagonals of the door opening to make sure they are equal in length.

Please screw the screws on the outer frame according to the position shown in the picture to fix the outer frame

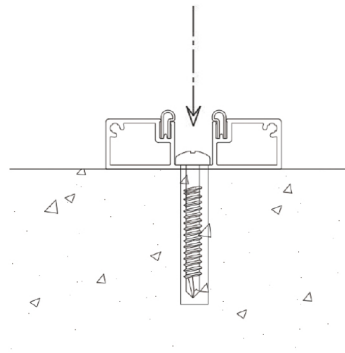
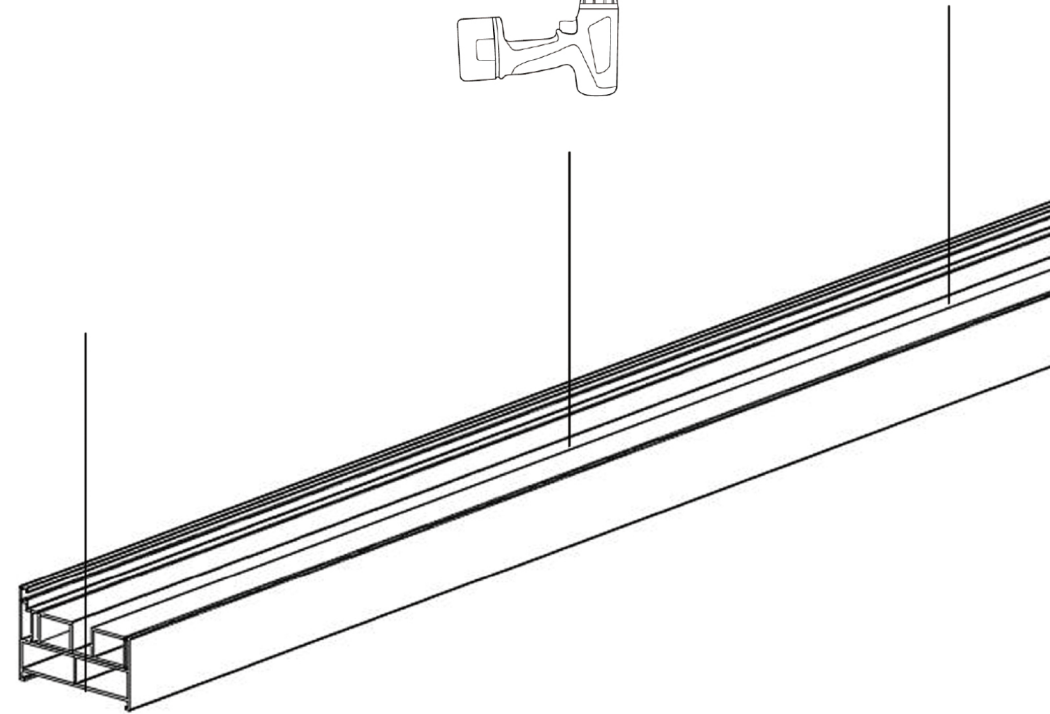
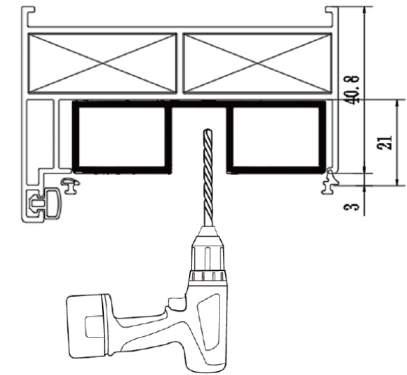
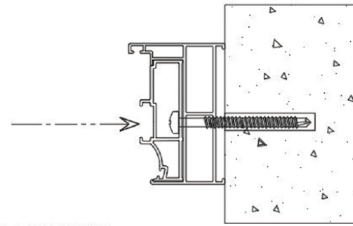
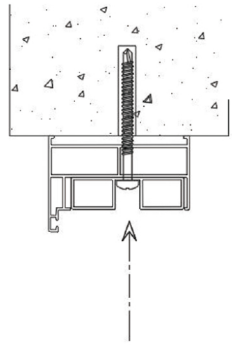

Use self-tapping screws to fix the 1st door panel on the left to the outer frame. Then use screws to connect the 2nd panel next to it.

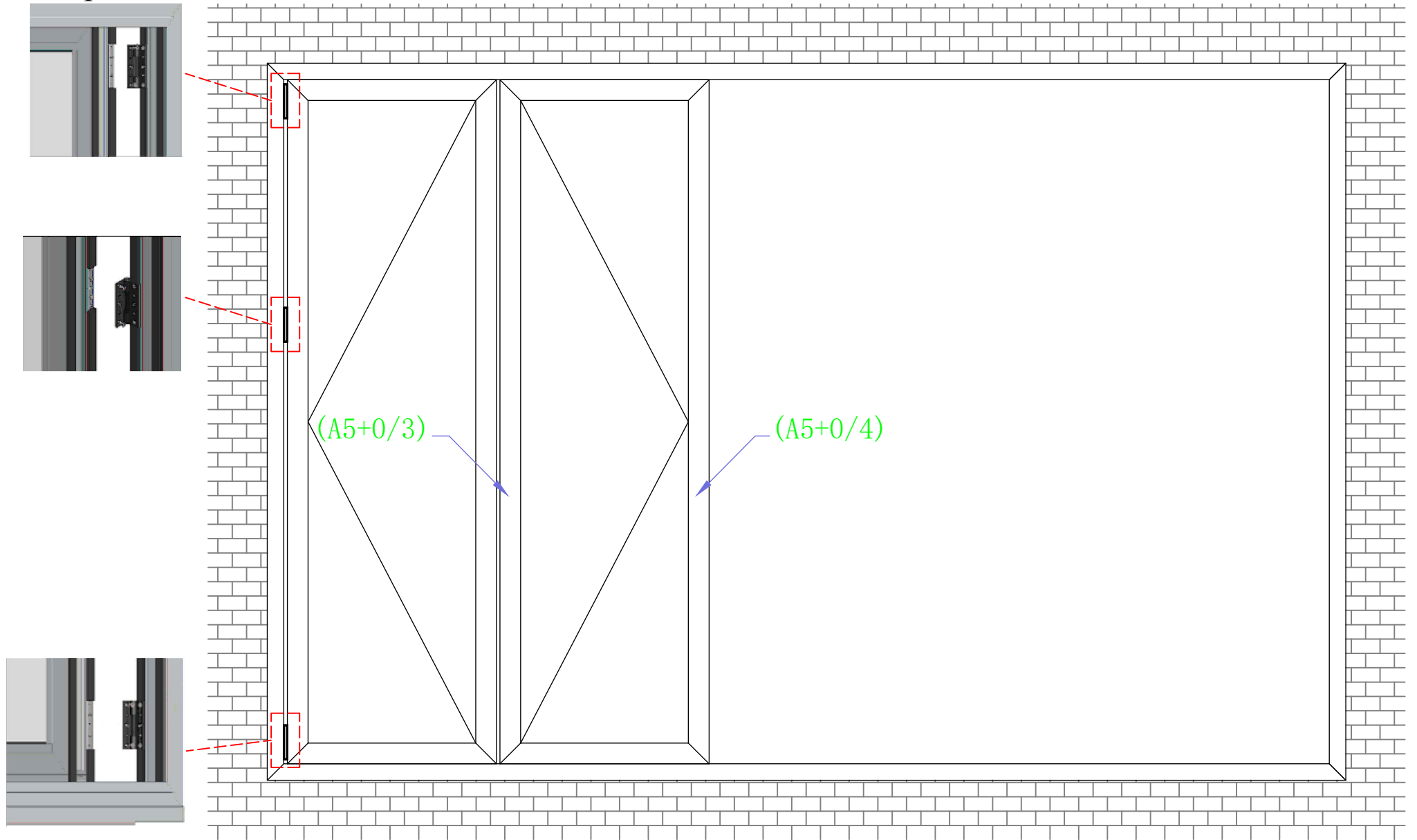

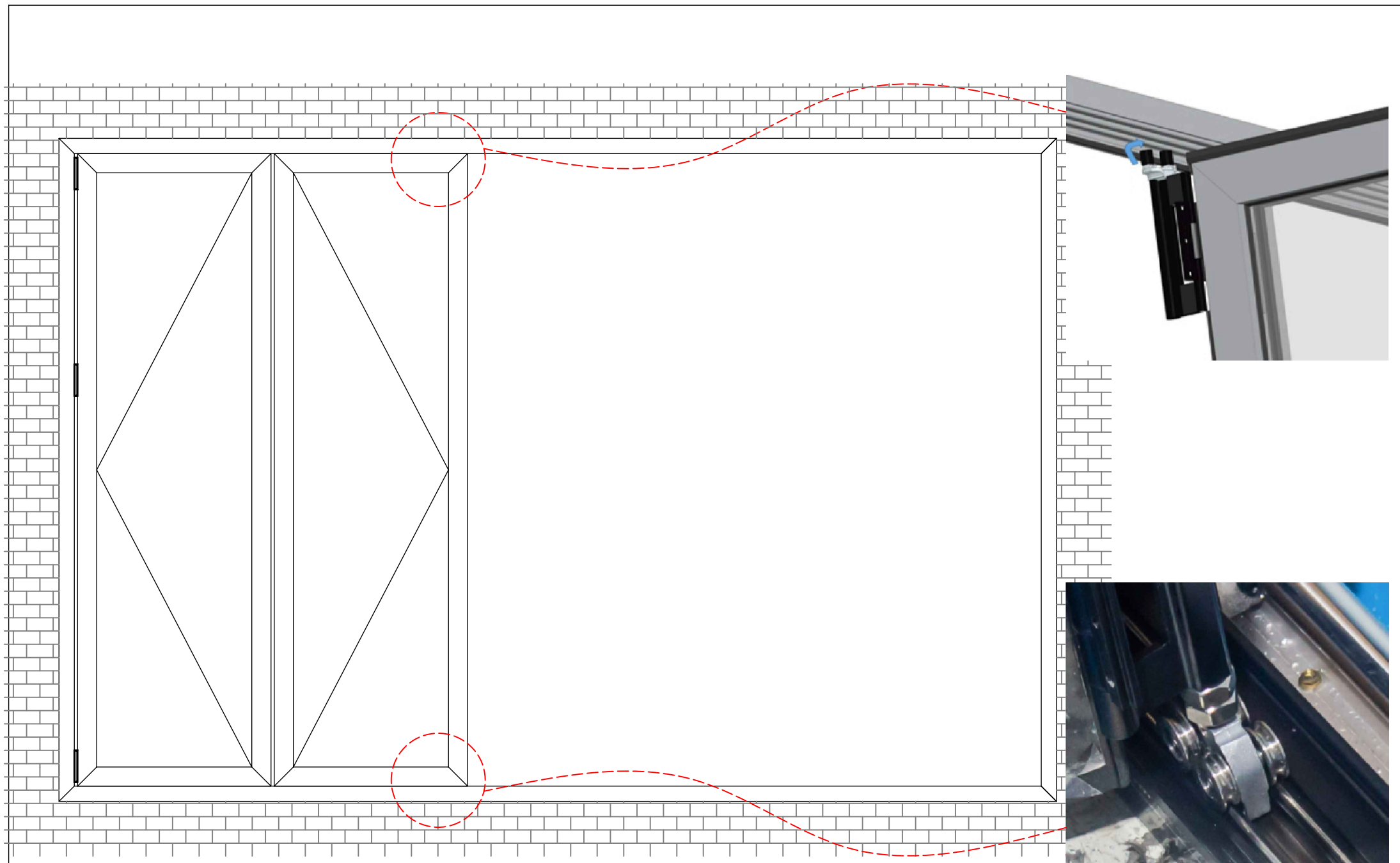

The first door panel needs to be opened when placing the 2nd door panel.

Tilt the 2nd panel on the indoor side and place the bottom load-bearing wheels on the bottom track then place the guide wheels in the top track.

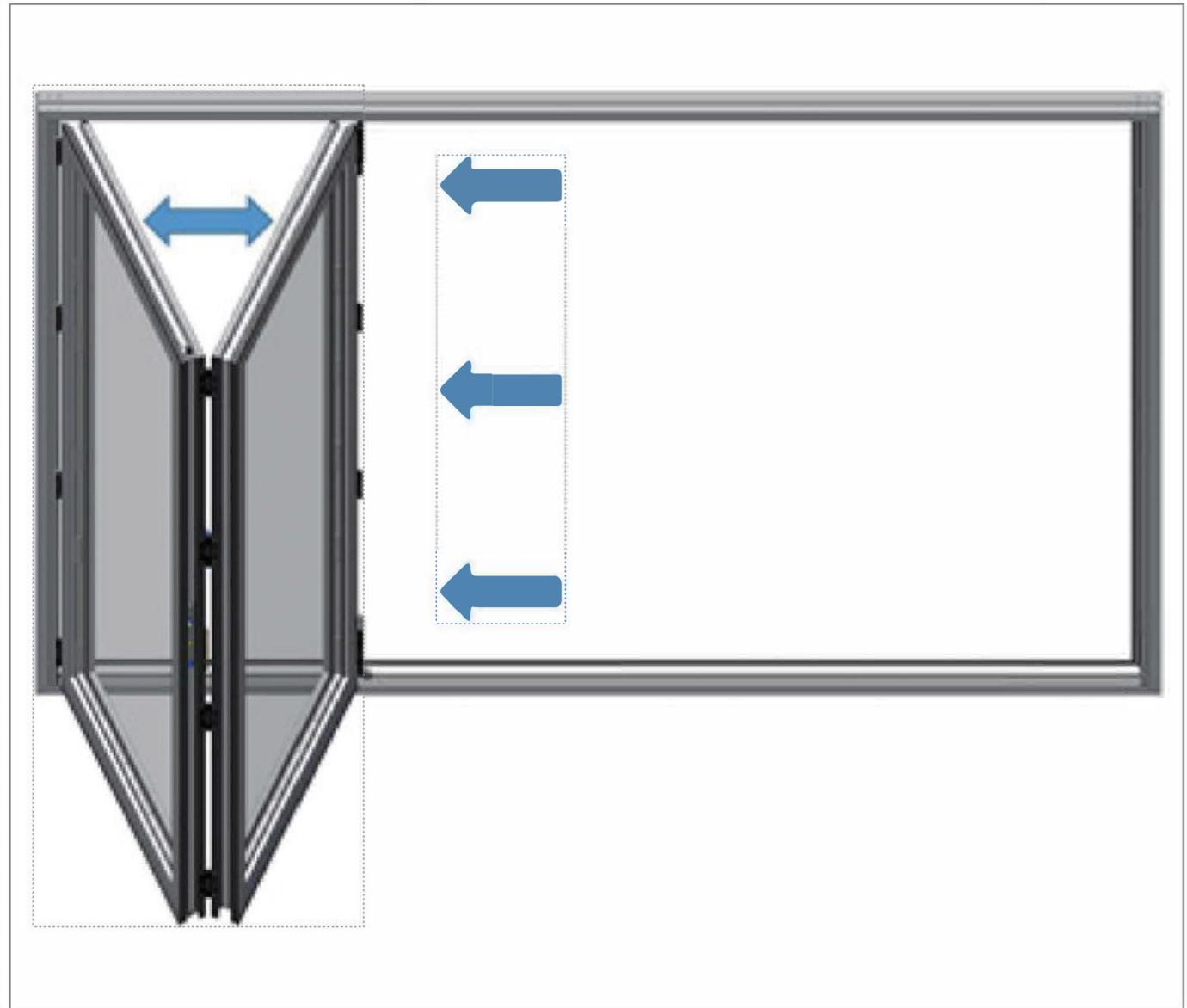
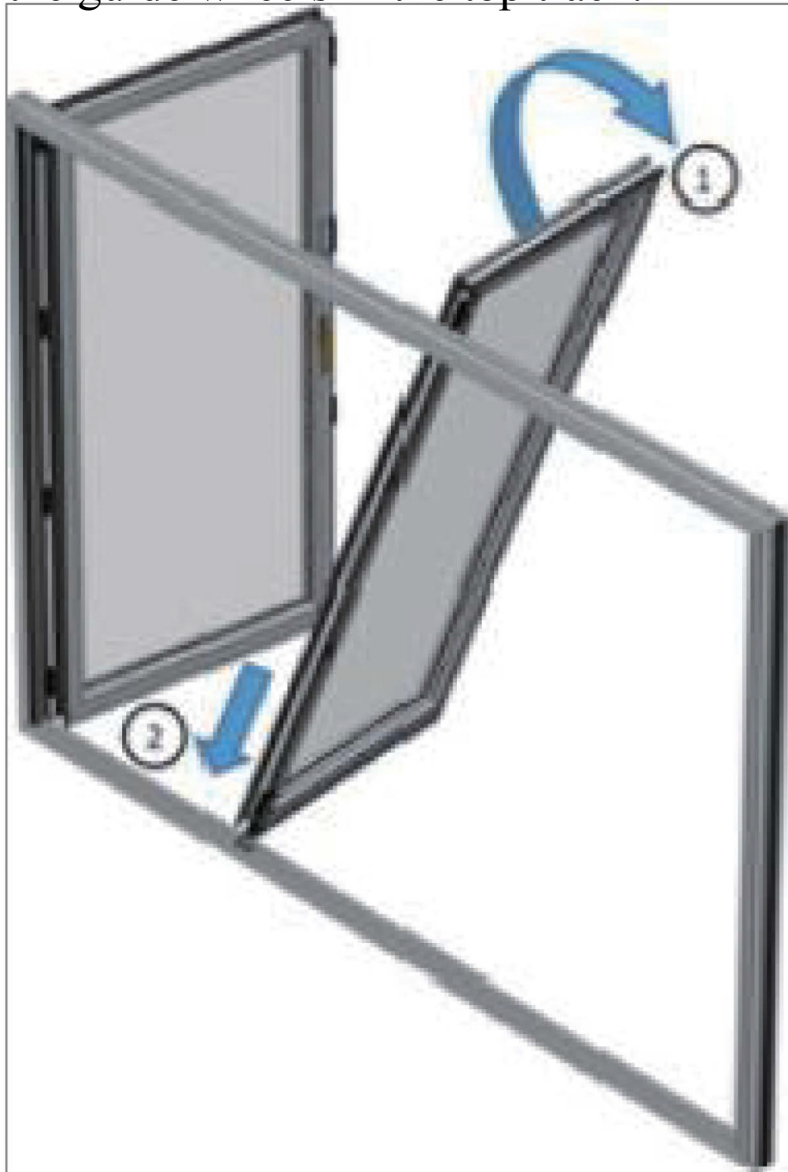

Slide the 2nd panel next to the 1st panel on the interior side and secure the hinges on the 2nd panel using self-tapping screws.

Install other door panels in the same way.

Use screws to secure door handles and locks.

