

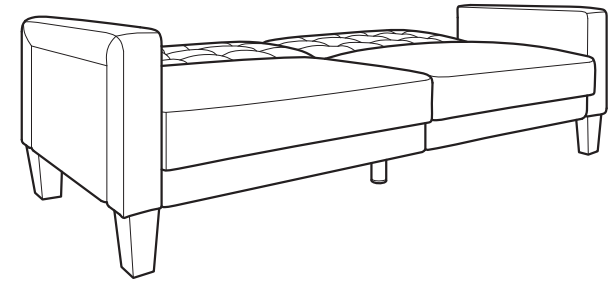

Dream Convertibles®

OXFORD

ASSEMBLY INSTRUCTIONS

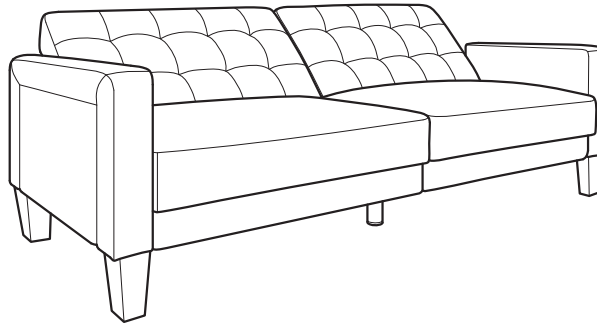
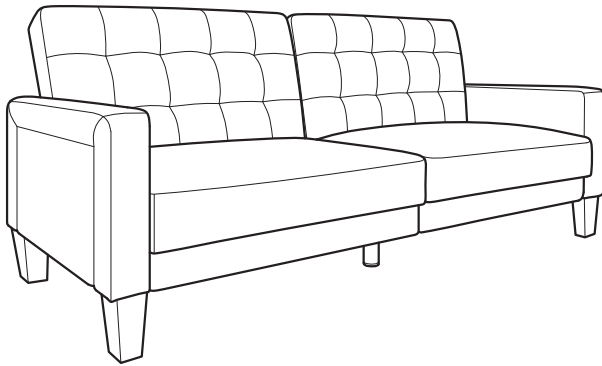

WARNING

- This product has been designed for seating three (3) average adults. To prevent injury and damage to this unit, PROHIBIT jumping on it.
- This product is designed for home use and not intended for commercial use.
- Children under the age of 5, small infants and babies should not sleep alone on this product for safety reasons.
- Recommended # of people needed for handling: 2 (however it is always better to have an extra hand.)
- THIS INSTRUCTION BOOKLET CONTAINS **IMPORTANT** SAFETY INFORMATION. PLEASE READ AND KEEP FOR FUTURE REFERENCE.

PARTS

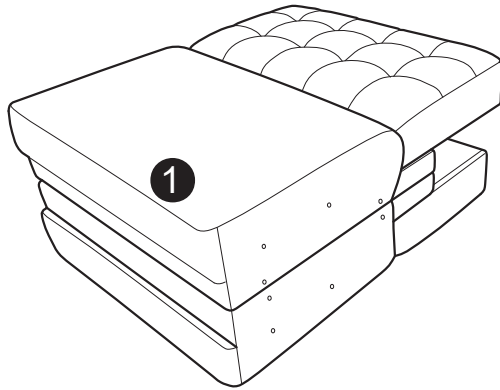

Sofa Body
QTY:1

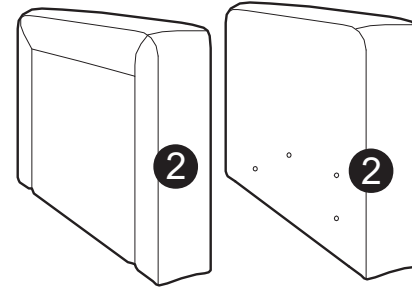

Arm
QTY:1 Pair

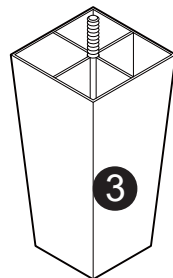

Leg
QTY:4

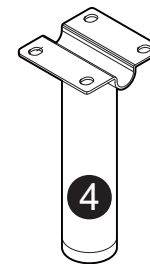

Center Leg
QTY:2

HARDWARE

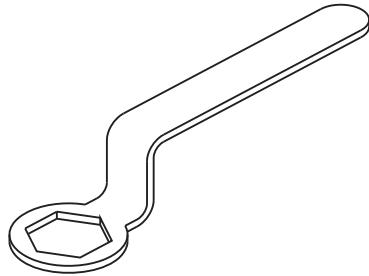

A
Spanner
M14
QTY : 1 PC

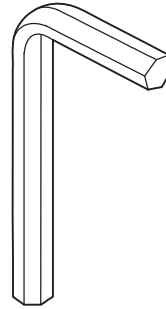

B
Hex Key
M4 x 21 x 57mm
QTY : 1 PC



C
Threaded Rod
M8 x 90mm
QTY : 8 PCS

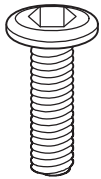

D
Bolt
M0.25" x 0.5"
QTY : 8 PCS



E
Washer
M0.25" x 16 x 1.2mm
QTY : 8 PCS



F
Washer
M8 x19 x 1.2mm
QTY : 8 PCS

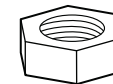

G
Nut
M8
QTY : 8 PCS

Step 1 :

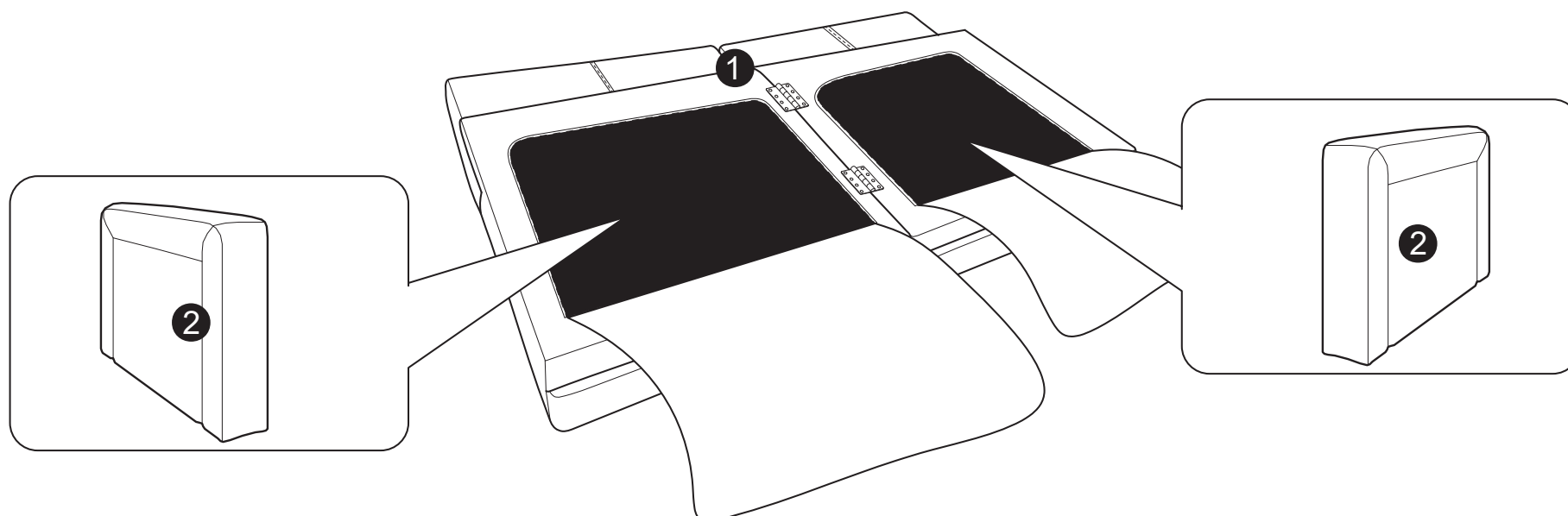
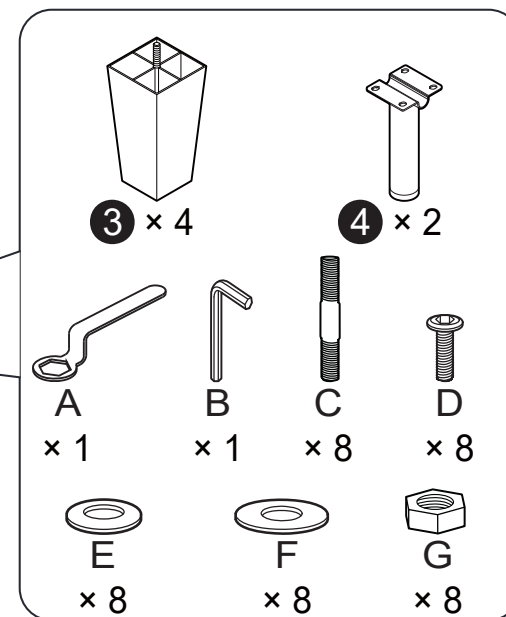
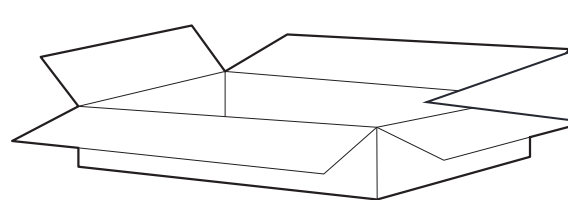
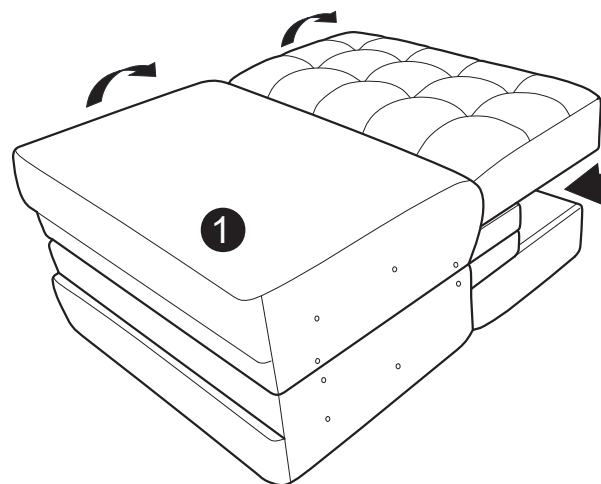

Step 2 :

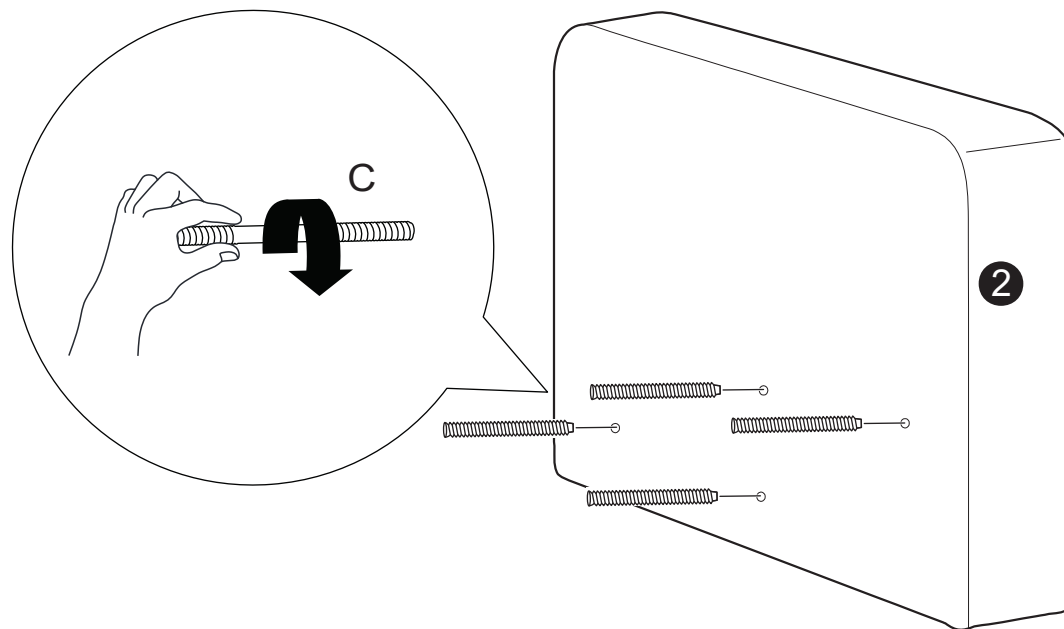
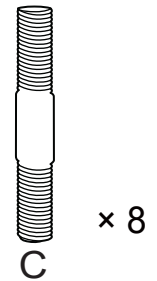

Step 3 :

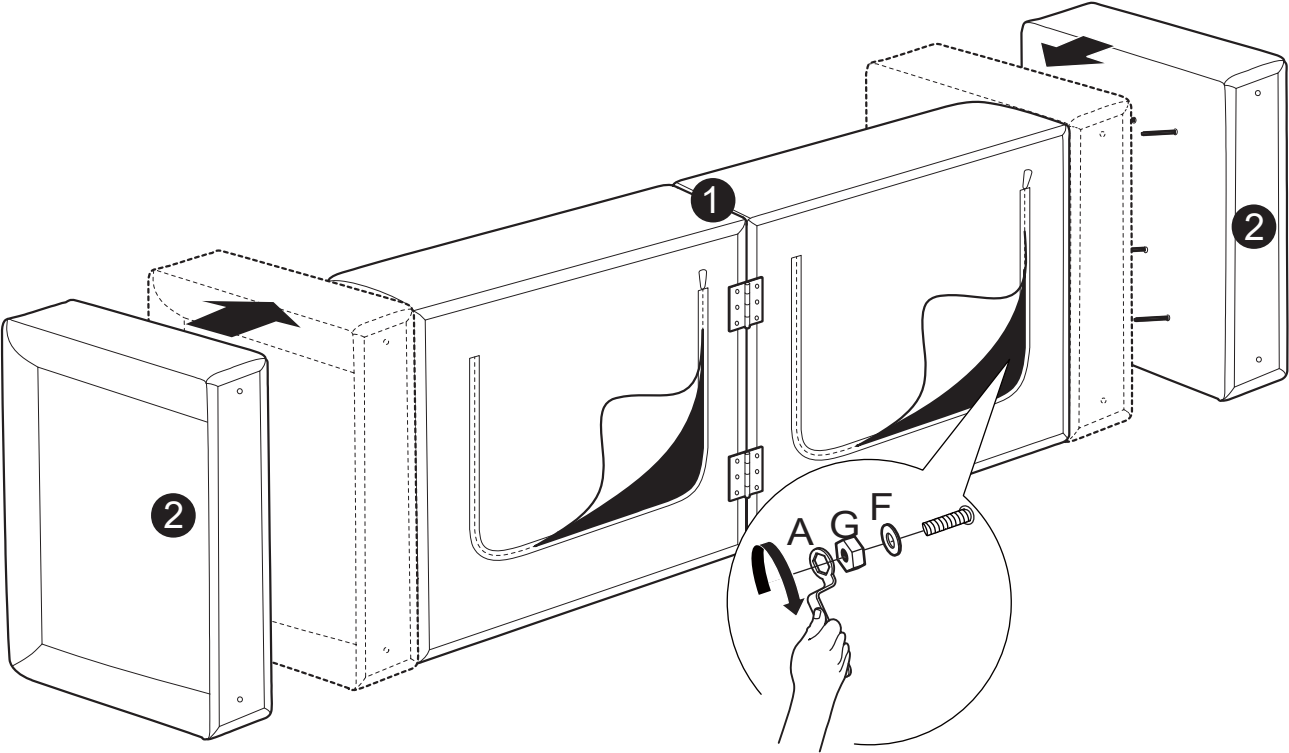
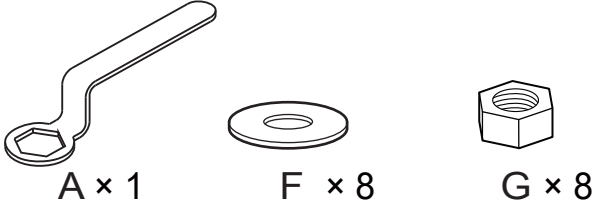

Step 4 :

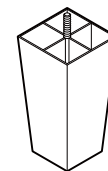

3 × 4

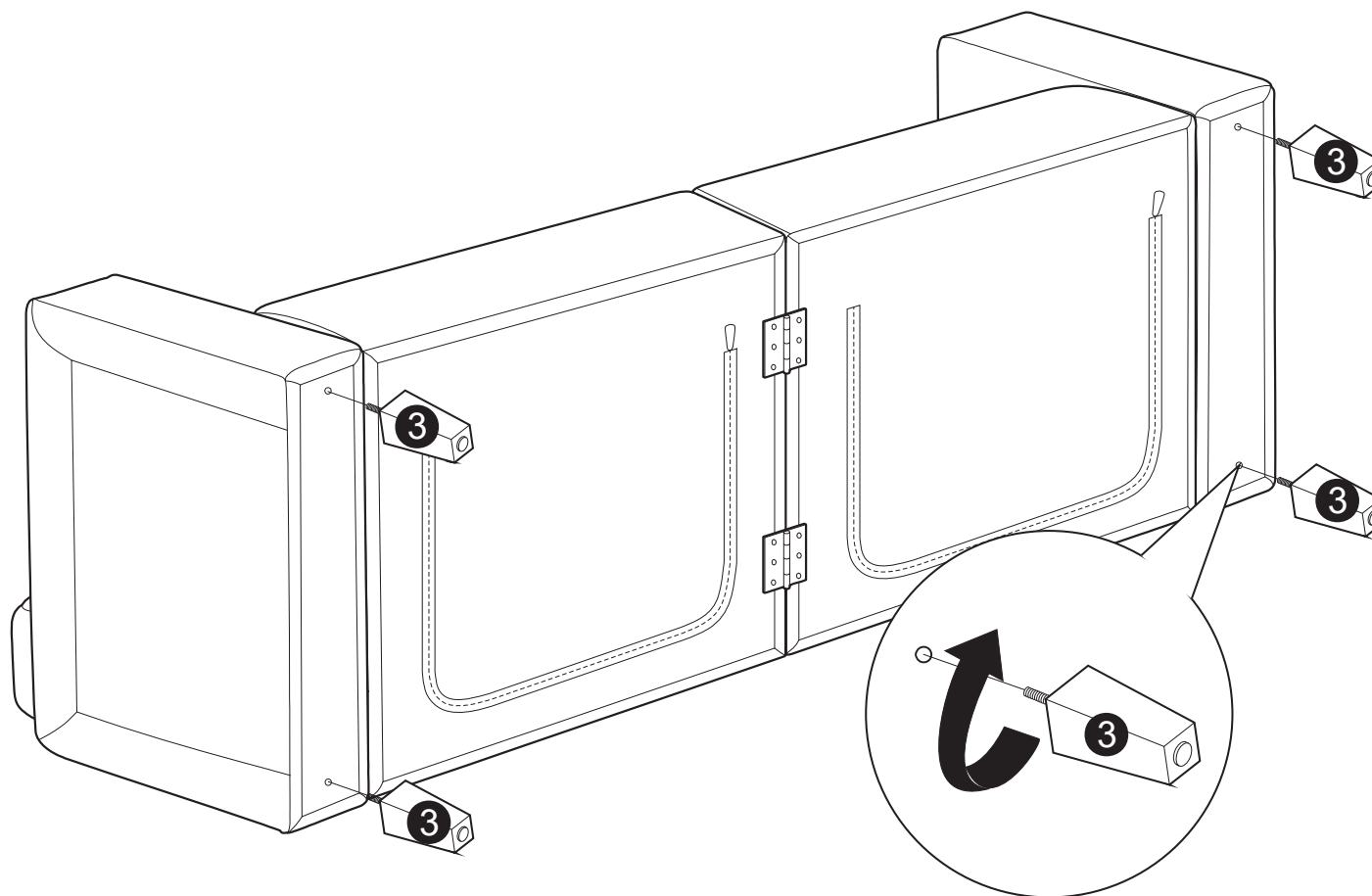

Step 5 :

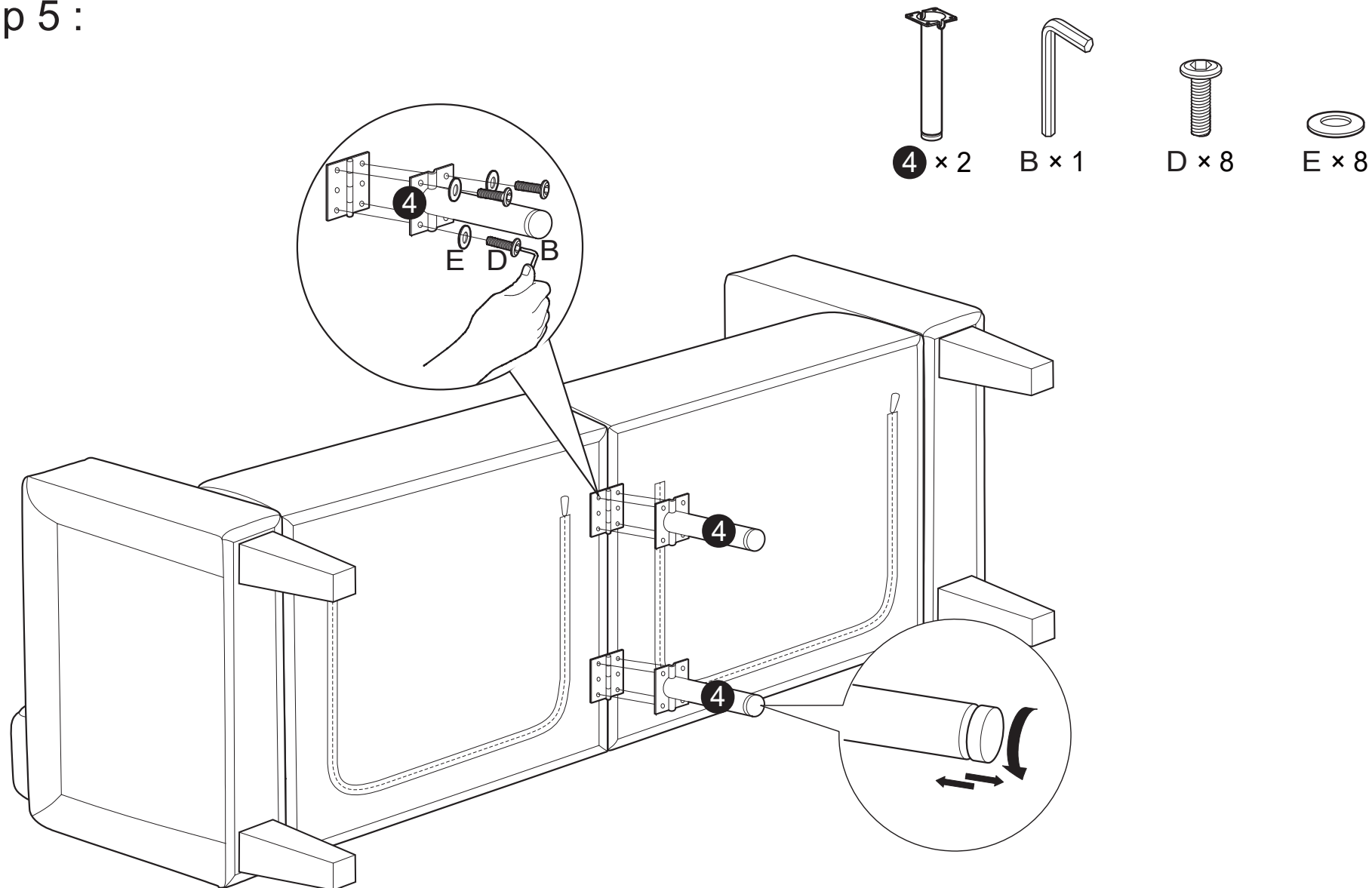

FUNCTIONS :

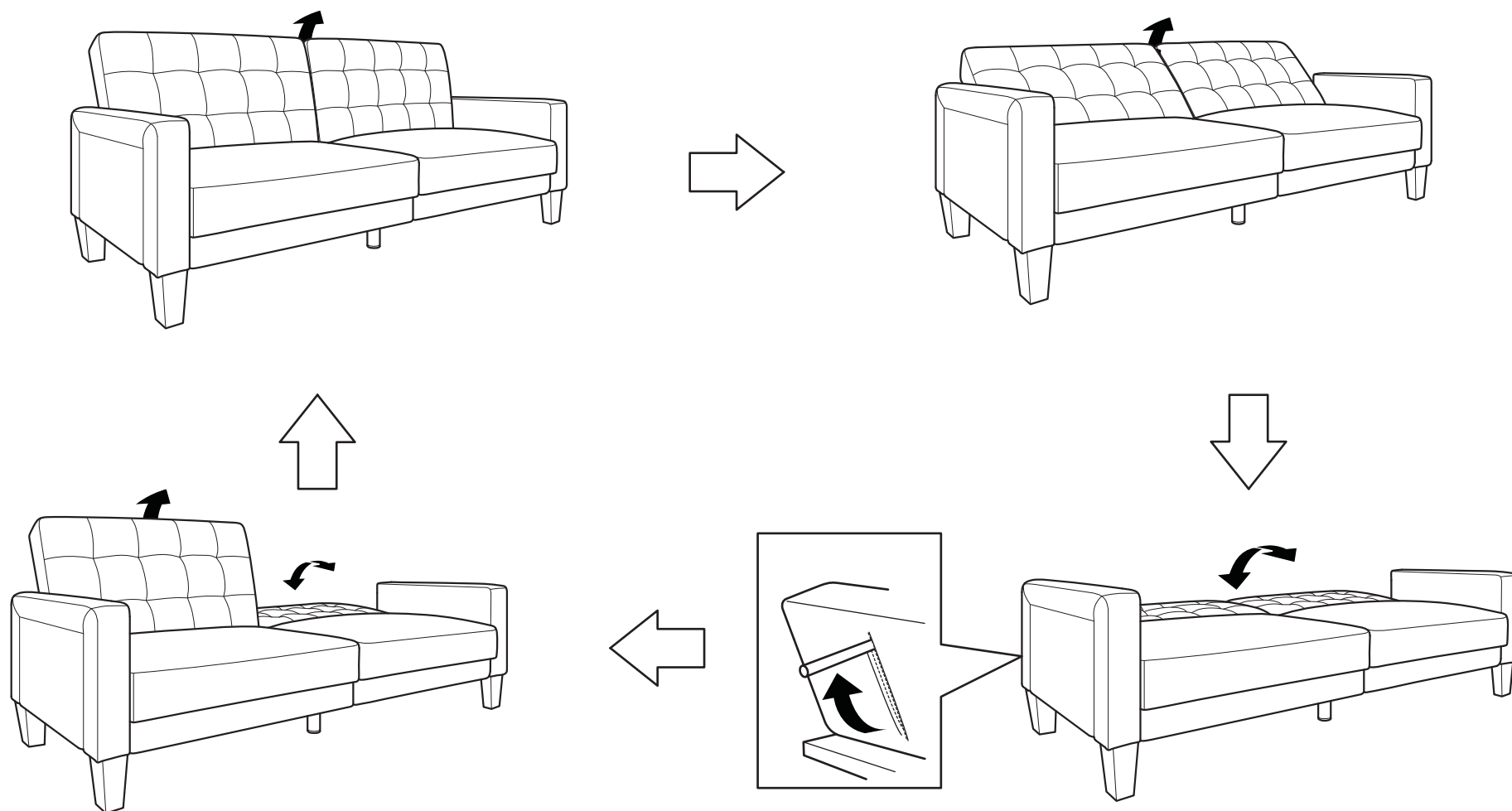

Need assistance?

Please call :

866-626-7826

For prompt, reliable service; please have your assembly manual ready.