



10 : 00

estimated  
installation time



1 or more

people required

Ok, let's  
get started!



- Put on mood music!
- To prevent damage to product, use the clean side of package carton or rug as working surface for assembly.
- In the event of missing or damaged parts, delivery problems etc., please reach out to our team.  
We will be happy to fix the problem!

# care guide

- Clean regularly with a soft and dry cloth.
- To protect finish, avoid use of abrasive cleaners.
- Wipe up spills immediately. Please!



# product parts

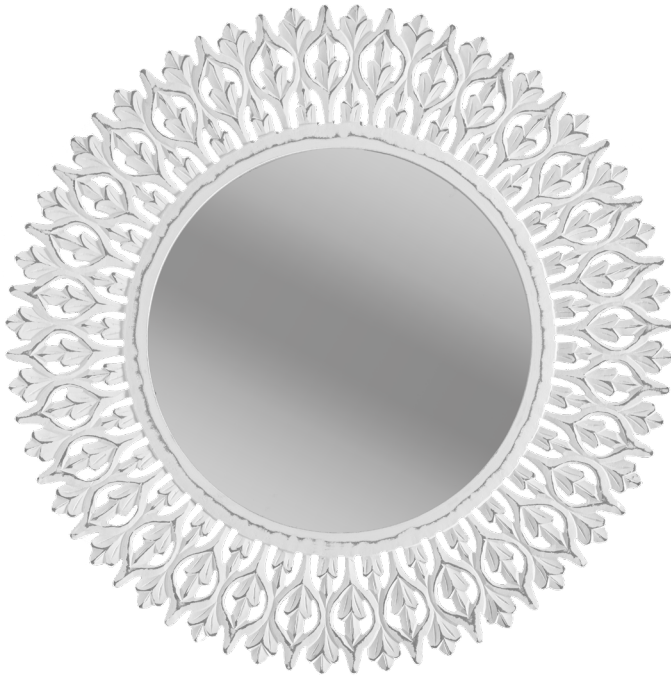

(A)  
Mirror  
x1

# what's included

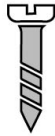

(B)- Screw  
x1



(C) - Wall Plug  
x1

## installation instructions

Friendly Tip: Take a deep breath going in. This is easy even if you are not used to tools. Just follow these steps to the T, and the outcome will be worth it!



step 1:

Make a mark on the wall where you want to hang the mirror (A).

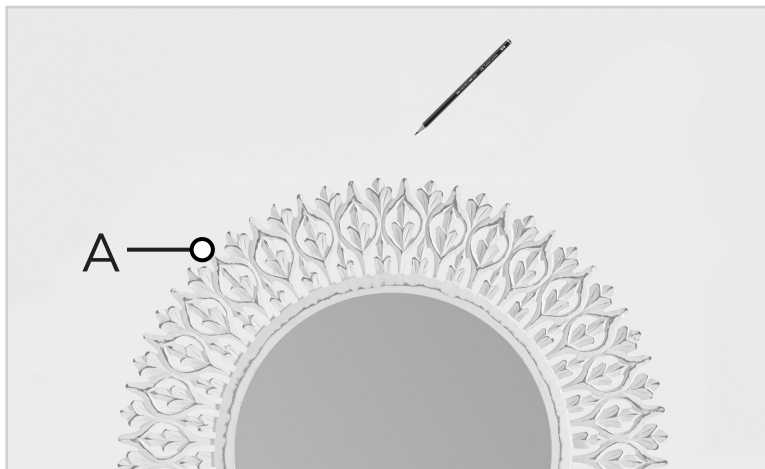

step 2:

Drill a hole at the point you just marked.



step 3:

Using a hammer, insert the wall plug (C) inside the hole.

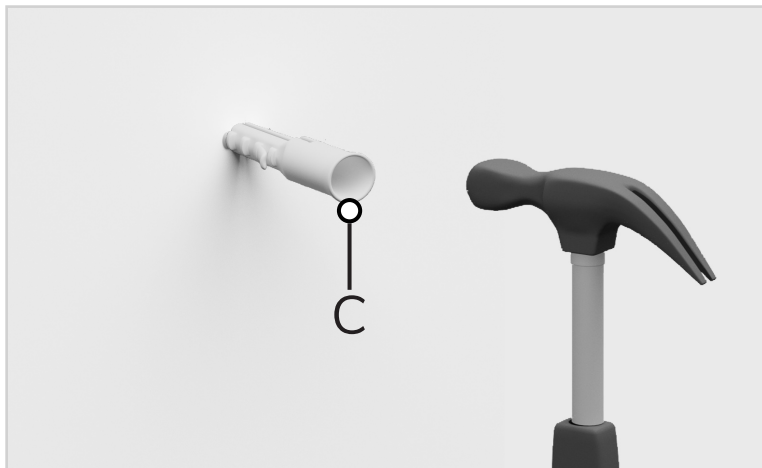

step 4:

Fix the screw (B) into the wall plug (C). Use a screwdriver to make sure it is secure.

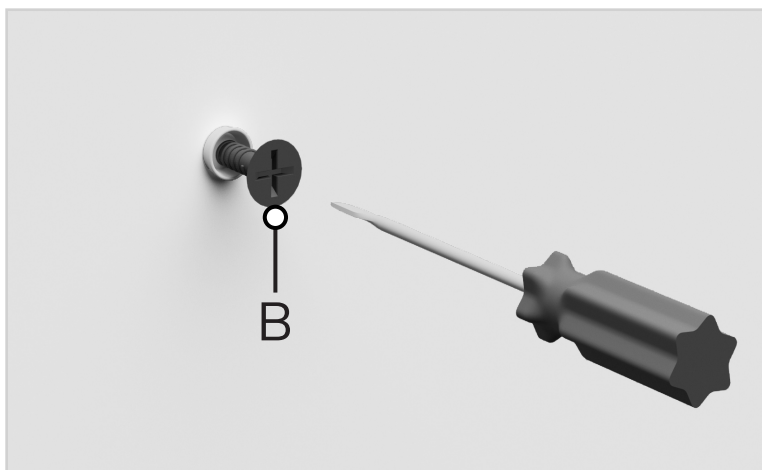

step 5:

Place the sawtooth over the screw.

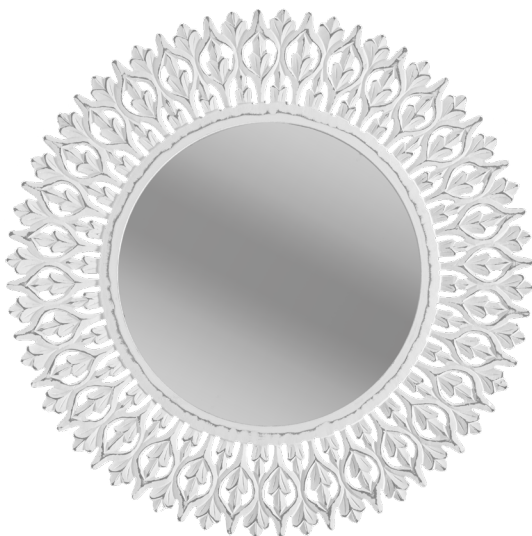
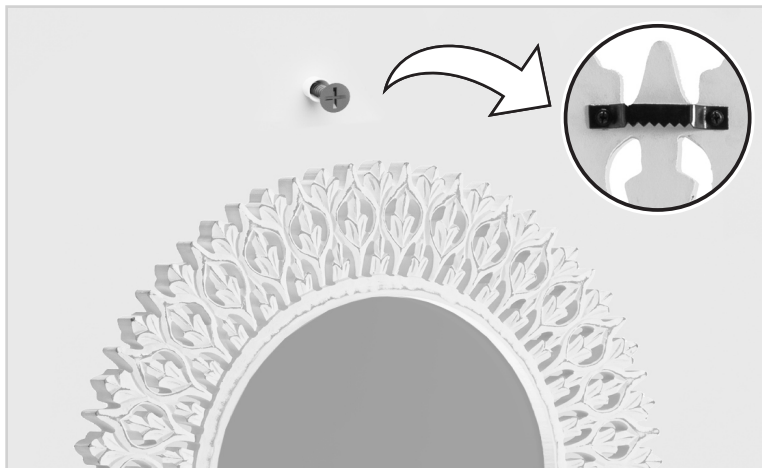

---

**Voila! Your mirror is now installed and secure!**

you've  
got  
a home  
with us

