

**BUNN**<sup>®</sup>  
BREW BETTER, NOT BITTER.<sup>®</sup>

**MY CAFÉ**<sup>®</sup>  
SINGLE CUP MULTI-USE BREWER



USE & CARE MANUAL MCU

Inside cover is intentionally blank

# TABLE OF CONTENTS

Get To Know Your Brewer .....	1	Drawer Format Compatibility .....	8
Important Safeguards.....	2	More Uses .....	9
Initial Setup.....	3	Energy Saving Functions.....	9
Four Drawer System.....	4	Cleaning & Maintenance.....	10, 11
Brewing With Cup Drawer .....	5	Troubleshooting.....	12, 13
Brewing With Ground Coffee Drawer..	6	Authorized Service.....	13
Brewing With Pod Drawer.....	7	Limited Warranty.....	14
Dispensing Hot Water .....	8		

## GET TO KNOW YOUR BREWER

### BUNN MY CAFÉ® SINGLE CUP MULTI-USE BREWER

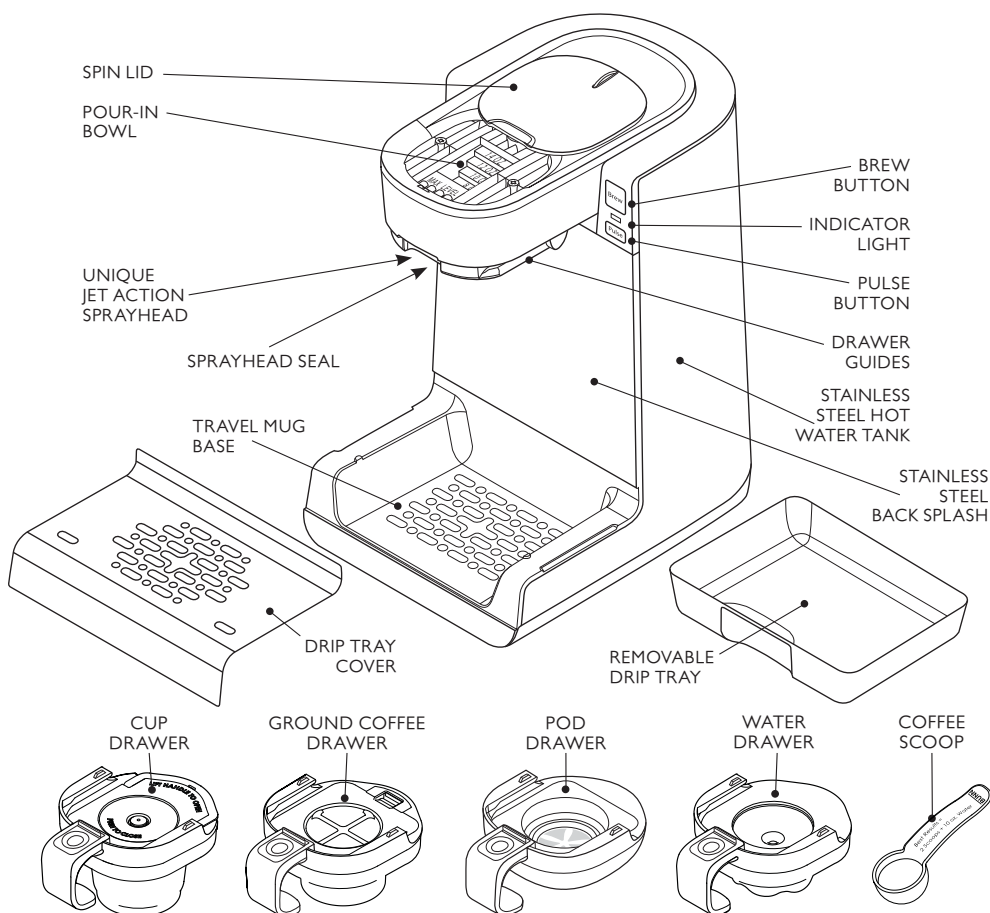

## SPECIFICATIONS

**ELECTRICAL:** UL Listed for Household Use Only. Brewer has an attached, 3-prong grounded cord set and requires 2-wire service with ground, rated 120 volts AC, 11.9 amps, single phase, 60 Hz. Total watts 1425.

**BREW CAPACITY:** 4 to 14 oz. cup.

**HIGH ALTITUDE PROGRAMMING:** Water boils at a lower temperature in high altitude environments (over 4,000 feet). To program My Café brewer for use at high altitude, push the Pulse Button 5 times (in under 10 seconds). The Indicator Light will flash green 5 times, indicating that the brewer is programmed for high altitude use. To return My Café brewer to normal operation, push the Pulse Button 5 times (in under 10 seconds). The Indicator Light will now flash red 5 times, indicating that the brewer is programmed for normal use.

# IMPORTANT SAFEGUARDS

Follow basic safety precautions when using electrical appliances to reduce the risk of fire, electric shock, and/or personal injury:

- READ ALL INSTRUCTIONS.
- Do not touch hot surfaces. Use handles.
- Do not place cord, plugs, or brewer in water or other liquids.
- Do not open lid during brewing.
- Close supervision is necessary when brewer is used by or around children.
- Unplug brewer when not in use for extended periods and before cleaning.
- Let brewer cool before removing or replacing parts, and before cleaning.
- Do not operate brewer with a damaged cord or plug or if the brewer malfunctions or is damaged in any way. Return brewer to an Authorized Service Facility for examination, adjustment or repair (see page 13).
- Using an accessory not evaluated for use with this brewer may cause injury.
- For indoor household use only.
- Do not let cord hang over edge of table or counter or touch hot surfaces.
- Do not place brewer on or near a hot gas or electric burner or in a heated oven.
- Do not use brewer for any purpose other than its intended use.
- Use each Drawer for only its intended format as specified in the Drawer Format Compatibility section (page 8) in this manual.
- Do not insert or remove any Drawer while brewing. Press Brew Button to stop or cancel a brew cycle.
- Do not pour any liquid into the water tank other than water or vinegar for cleaning, as specified in this manual.
- Do not clean brewer with cleansers, steel wool pads, or other abrasive materials.
- When brewer is not in use, keep lid in the closed position.
- To avoid cup overflow, empty cup before each brew cycle.
- Never place hands directly under any Drawer. Hot water and steam can be present.
- Always use a cup that is larger than the amount of water poured into the brewer.
- Keep hands away if cup overflows.
- Use caution when removing any Drawer after the brew cycle as the contents may still be hot.
- Pour in cold water only.
- Store Drawers in clean, dry place. Avoid excessive heat.

**NOTE:** The short power-supply cord supplied reduces the risk of becoming entangled in or tripping over a longer cord. If an extension cord is used, its marked electrical rating must be at least as great as the electrical rating of the brewer. Make sure the extension cord does not hang over the edge of a table or counter and that it cannot be pulled on by children or tripped over. The extension cord must be a 3-wire cord of the 3-prong, 3-socketed, grounding type (including grounding conductor).

## SAVE THESE INSTRUCTIONS

Record the Date Code before using  
(Located on a sticker on the lower back of  
the machines).

DATE CODE: \_\_\_\_\_

### Questions?

Visit [www.bunnathome.com](http://www.bunnathome.com) or call

USA 1-800-352-BUNN (2866)

Canada 1-800-263-2256

Please have your Model and Date Code  
ready when calling for service.

**WARNING**  
**RISK OF FIRE OR ELECTRICAL SHOCK**

TO REDUCE RISK OF FIRE OR ELECTRIC SHOCK  
DO NOT DISASSEMBLE THE BREWER  
NO USER-SERVICEABLE PARTS INSIDE  
REPAIR SHOULD BE DONE BY AUTHORIZED  
SERVICE PERSONNEL ONLY



This symbol alerts  
you to important  
operating and  
service instructions.



This symbol alerts  
you to the risk of fire  
or electric shock in the  
accompanying message.

# INITIAL SET UP

---

## MY CAFÉ® SINGLE CUP MULTI-USE BREWER

**IMPORTANT:** My Café brewer has an internal Hot Water Tank that must be filled with water before brewing for the first time. Fill the Pour-in Bowl and run 2-3 brew cycles. The machine will begin to heat and be ready to brew in a few minutes.

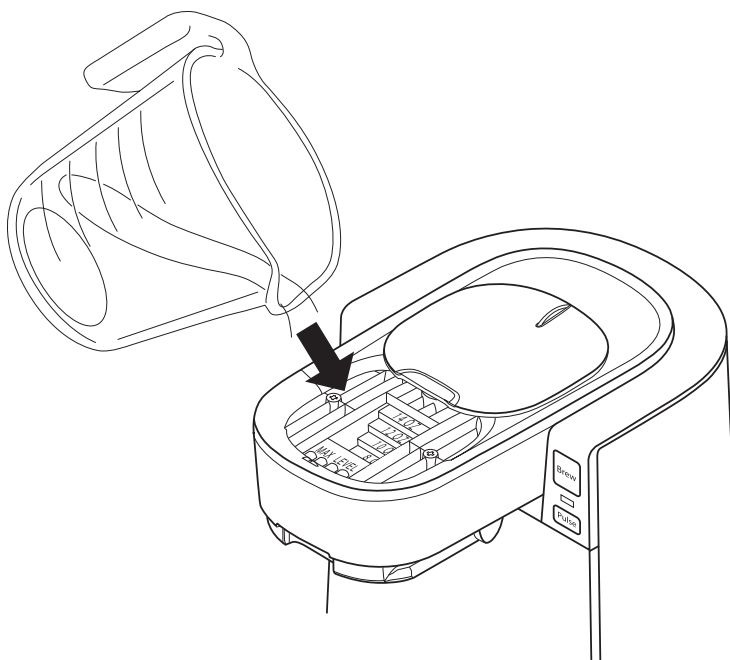

- 1. Plug in brewer.** The Brew Button will flash red, indicating that water is needed and the brewer is ready for set-up.
- 2. Position cup (14 oz. or larger) on Drip Tray under Drawer.**  
Do not brew directly into untempered glass or plastic cups/glasses. Use only heat-resistant vessels.
- 3. Place any empty Drawer into Drawer Guides and push in to lock into place.** The Drawer must be locked into place before brewer will operate.
- 4. Fill a container with 14 oz. of cold water.\***
- 5. Open Spin Lid on top of brewer.**
- 6. Fill Pour-in Bowl with water.**
- 7. Close Spin Lid.**
- 8. Push Brew Button.** Wait for water to be drawn into the internal Hot Water Tank. You may hear some squeaking as the pump primes. This is perfectly normal and will only occur during setup.
- 9. Empty cup if any water is present, then place cup on Drip Tray under Drawer.**
- 10. Repeat steps 4 through 7.**
- 11. Push Brew Button.** Wait for water to be drawn into internal Hot Water Tank. Excess water will flow into the cup. If the Brew Button is still flashing red, repeat steps 4 through 7 and push Brew Button again.

When brew button stops flashing red, and stays red, My Café brewer is now heating the water. Wait 2 to 3 minutes for the Indicator Light to turn from red to green. You are now ready to brew!

**\*IMPORTANT:** Distilled water is not recommended for brewing coffee as it lacks the minerals to bring out the natural flavors of coffee. Some common bottled water may also be too purified. If you want to use bottled water, look for words like “filtered”, “spring water”, “mineral water” or “drinking water”. Avoid using bottled water with words like “purified”, “distilled” or “mineral free”. Your BUNN My Café Brewer may not function with water that has insufficient mineral content.

# FOUR DRAWER SYSTEM

BUNN My Café® Multi-Use Brewer comes with four separate Drawers. Each Drawer is designed to work with different formats so you decide what and how you want to brew!

Please reference page 8 for the format compatibility specifications for each Drawer.

## CUP DRAWER

works with all K-Cup® cartridges and K-Cup® compatible cartridges including coffee, tea, and hot cocoa.

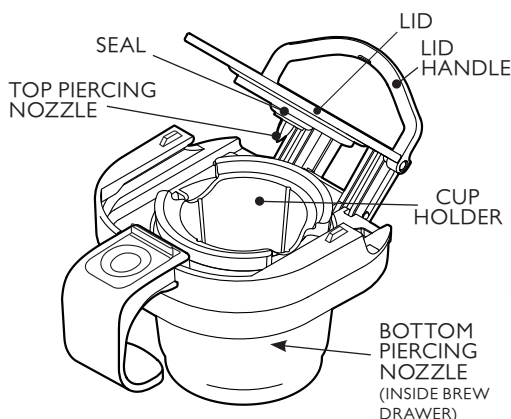

## GROUND COFFEE DRAWER

allows you to brew any ground coffee one cup at a time. Also use loose tea leaves to brew hot tea!

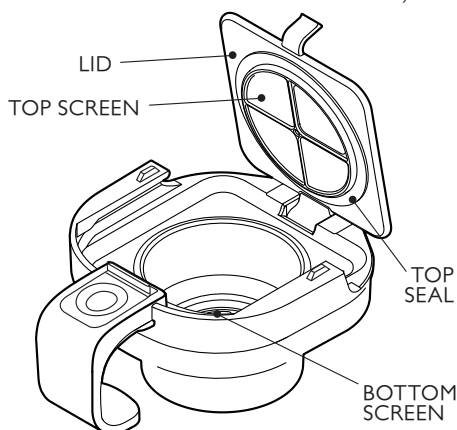

Ground Coffee



## POD DRAWER

works with soft coffee/tea pods and tea bags.

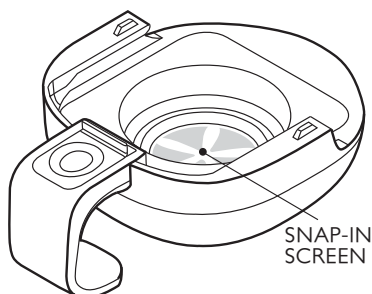

Soft Pods & Tea Bags



## WATER DRAWER

for dispensing hot water on demand to prepare instant coffee, oatmeal, hot cocoa, soup, warm baby bottles and so much more!

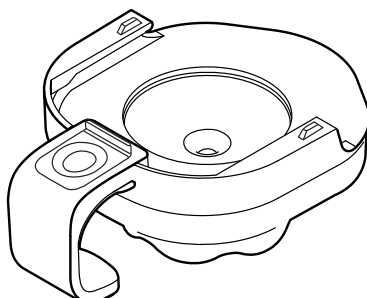

Hot Water



K-Cup® and K-Cups® are registered trademarks of Keurig, Incorporated.  
BUNN is not affiliated with Keurig, Incorporated.

# BREWING WITH THE CUP DRAWER

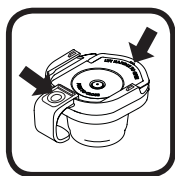

1. To open the Cup Drawer Lid, hold the Drawer handle and lift the Lid Handle to release the Lid. As you lift the Lid, it will pivot away to allow access to the Cup Holder.



2. Insert K-Cup® cartridge into the Cup Holder.

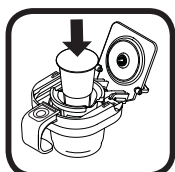

3. Close Lid and push down firmly on the Lid to properly puncture the cartridge.

Make sure you snap the Lid Handle down into place.



**CAUTION:** The Cup Drawer has two sharp points to pierce the cartridge for brewing. Caution should be used when using or cleaning the Drawer to prevent injury.



4. Slide Cup Drawer into Drawer Guides and push in to lock into place.

Cup Drawer must be locked into place before brewer will operate.

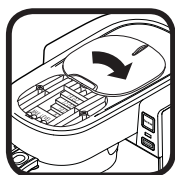

5. Open Spin Lid on top of brewer.



6. Using your preferred cup or measuring device, fill Pour-In Bowl with desired amount of water (minimum 4 oz., maximum 14 oz.).

Note: the cup positioned on Drip Tray and under the Cup Drawer must be larger than the amount of water you pour inside.

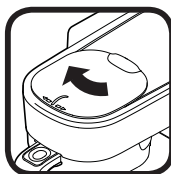

7. Close Spin Lid on top of brewer and position cup on Drip Tray under Cup Drawer.

Note: be sure cup is heat resistant.



8. For regular brew, push the Brew Button.

For bolder brew or for tea, push the Pulse Button to activate and then push the Brew Button. Pulse starts and stops the flow of water several times during the brew cycle and extends the contact time for a bolder beverage.



9. At end of brew cycle, remove cup from Drip Tray.

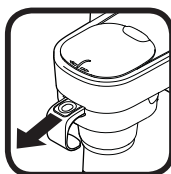

10. Remove Cup Drawer and dispose of used cartridge.

**CAUTION:** A small amount of hot water may pool on top of the Cup Drawer Lid during brew, so remove slowly.

To remove the Cup Drawer press down on the button located on the top of the Cup Drawer handle and pull Cup Drawer out along the Drawer Guides. Use the Lid Handle to lift and pivot the Lid out of the way so you can carefully remove the used cartridge from the Cup Holder. Dispose of used cartridge in a waste container.



# BREWING WITH THE GROUND COFFEE DRAWER

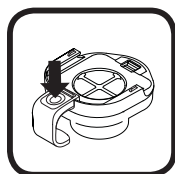

1. To open the Ground Coffee Drawer Lid, push the button on the Drawer Handle.



2. Use coffee scoop (one included) to carefully place ground coffee into the bowl.

We recommend 2 scoops per 10 ounces of water for best results. Do not overfill the bowl. If any coffee grounds get on the edges above the bowl, clean off the coffee grounds before closing the Drawer Lid.

NOTE: The drawer holds up to 20 grams (1 scoop = approx. 10 g).

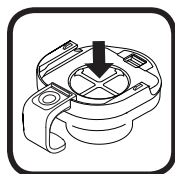

3. Push down the Lid on Ground Coffee Drawer to close.



4. Slide Ground Coffee Drawer into Drawer Guides and push in to lock into place.

Ground Coffee Drawer must be locked into place before brewer will operate.

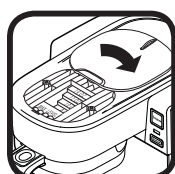

5. Open Spin Lid on top of brewer.



6. Using your preferred cup or measuring device, fill Pour-In Bowl with desired amount of water (minimum 4 oz., maximum 14 oz.).

Note: the cup positioned on Drip Tray and under the Ground Coffee Drawer must be larger than the amount of water you pour inside.

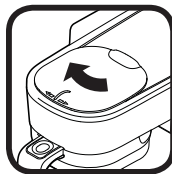

7. Close Spin Lid on top of brewer and position cup on Drip Tray under Ground Coffee Drawer.

Note: be sure cup is heat resistant.

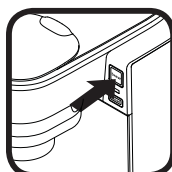

8. For regular brew, push the Brew Button.

**For bolder brew** or for tea, push the Pulse Button to activate and then push the Brew Button. Pulse starts and stops the flow of water several times during the brew cycle and extends the contact time for a bolder beverage.

NOTE: For best results with the Ground Coffee Drawer, we recommend using the Pulse Button.



9. At end of brew cycle, remove cup from Drip Tray.



10. Remove the Ground Coffee Drawer and dispose of used grounds.

Remove the Drawer by pressing down on the button located on the top of the Drawer handle and pull the Drawer out along the Drawer Guides. For easiest removal of used coffee grounds, knock the used grounds out of the bowl over a waste container or compost bin right after brewing. Rinse Drawer thoroughly.

NOTE: The Top Screen is not meant to be removed. Removing the Top Screen will cause the Ground Coffee Drawer to be inoperable.



# BREWING WITH THE POD DRAWER

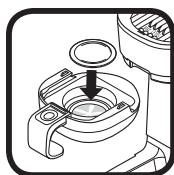

1. Place soft pod or tea bag in Pod Drawer Cavity.

Center pod or tea bag in Drawer and gently press the pod or tea bag fully into the Pod Drawer cavity. Ensure that the pod or tea bag is fully inserted.

Note: Do not place torn or damaged pods in Pod Drawer.

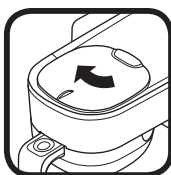

5. Close Spin Lid on top of brewer and position cup on Drip Tray under Pod Drawer.

Note: be sure cup is heat resistant.

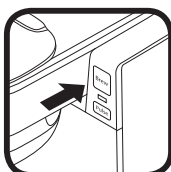

6. For regular brew, push the Brew Button.

For bolder brew or for tea, push the Pulse Button to activate the pulse feature and then push the Brew Button. Pulse starts and stops the flow of water several times during the brew cycle and extends the contact time for a bolder beverage.



2. Slide Pod Drawer into Drawer Guides and push in to lock into place.

Pod Drawer must be locked into place before brewer will operate.

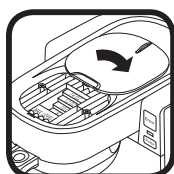

3. Open Spin Lid on top of brewer.



7. At end of brew cycle, remove cup from Drip Tray.

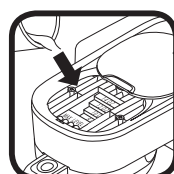

4. Using your preferred cup or a measuring device, fill Pour-In Bowl with desired amount of water (minimum 4 oz., maximum 14 oz.).

Note: the cup positioned on Drip Tray and under the Pod Drawer must be larger than the amount of water you pour inside.



8. Remove Pod Drawer and dispose of used pod or tea bag.

To remove the Pod Drawer press down on the button located on the top of the Pod Drawer handle and pull Pod Drawer out along the Drawer Guides. Dispose of used pod or tea bag by flipping the Pod Drawer over to knock pod or tea bag into a waste container or compost bin. Do not touch the hot pod or tea bag.

# DISPENSING HOT WATER WITH WATER DRAWER

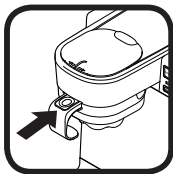

**1. Insert Water Drawer into Drawer Guides.**

Water Drawer must be locked into place before brewer will operate.

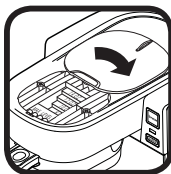

**2. Open Spin Lid on top of brewer.**



**3. Using your preferred cup or measuring device, fill Pour-In Bowl with desired amount of water (minimum 4 oz., maximum 14 oz.).**

Note: the cup positioned on Drip Tray and under the Water Drawer must be larger than the amount of water you pour inside.

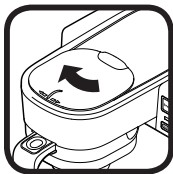

**4. Close Spin Lid on top of brewer and position cup on Drip Tray under Water Drawer.**

Note: be sure cup is heat resistant.



**5. Push Brew Button.**



**6. At end of brew cycle, remove cup from Drip Tray.**

To remove the Water Drawer, press down on the button located on the top of the Water Drawer handle and pull Water Drawer out along the Drawer Guides.

## DRAWER FORMAT COMPATIBILITY

Each Drawer is designed to brew with specific coffee or tea formats. Do not insert any other format or objects in the Drawer other than those listed here.

	<b>Cup Drawer</b> K-Cup® Cartridges K-Cup® Compatible Cartridges	 K-Cups®
	<b>Ground Coffee Drawer</b> Ground Coffee Loose Tea	 Ground Coffee
	<b>Pod Drawer</b> Soft Coffee Pods Soft Tea Pods Tea Bags	 Soft Pods & Tea Bags
	<b>Water Drawer</b> Use to dispense hot water instantly to prepare a wide variety of beverages, food and more. <b>Do not insert any coffee or tea format.</b>	 Hot Water

K-Cup® and K-Cups® are registered trademarks of Keurig, Incorporated.  
BUNN is not affiliated with Keurig, Incorporated.

## BREWING BETTER

---

My Café® Single Cup Multi-Use Brewer precisely controls brewing temperature and time to extract superior flavor from your favorite coffee and tea. Here are some tips for single cup brewing:

- Start with your favorite coffee or tea and 8 ounces of water.
- For a bolder cup, use less water, or more coffee/tea.
- For a weaker cup, use more water or less coffee or tea with the same amount of water.

**NOTE:** Too much water and too little coffee can lead to over-extraction of the grounds and a bitter taste.

- Use the Pulse Button to steep tea or to extract bolder coffee flavor.

## MORE USES

---

- Use My Café brewer to dispense hot water for hot cocoa, instant coffee, oatmeal, soup, to warm baby bottles, kick-start cooking and more. Insert the Water Drawer and press Brew. Use caution, the dispensed water will be very hot, as the hot water tank holds water at approximately 200°F.
- Brew iced coffee and tea by brewing over a cup filled with ice (make sure cup is resistant to both hot and cold). After brewing, add milk and/or your favorite sweetener.

## ENERGY SAVING FUNCTIONS

---

- After 6 hours idle, the temperature inside the Stainless Steel Hot Water Tank drops to 140°F. It takes about 1 minute to get back to an optimal brewing temperature of about 200°F.
- After 26 hours idle, My Café brewer enters sleep mode. It takes about 2 minutes to return to optimal brewing temperature (about 200°F).
- When a Drawer is removed or inserted, or if any button is pushed, the brewer begins to heat up to optimal brewing temperature. When the Indicator Light is green, My Café brewer is ready to use.

# CLEANING & MAINTENANCE

---

## BASIC CLEANING

Rinse the Drawer(s) after each use. Drawers, Drip Tray and Drip Tray Cover are top rack dishwasher safe. Occasionally wipe outside of the brewer, including the Drip Tray and Drip Tray Cover, with a mild, no citrus added dish soap and a damp cloth.

## DEEP CLEANING

Deep clean your brewer at least every 3 months. Mineral deposits may accumulate due to impurities in the water used to brew. If deposits are not removed, they can impair the operation of the brewer and reduce product life. The frequency of cleaning depends on the mineral content of your water (the higher the mineral content, the more often you should deep clean).

1. Insert any Drawer.
2. Open Spin Lid on top of brewer.
3. Fill Pour-in Bowl with 14 oz. white vinegar.
4. Close Spin Lid.
5. Place empty cup (greater than 14 oz.) on the Travel Mug Base or Drip Tray Cover.
6. Push Brew Button to cycle vinegar through brewer.
7. Run three or more additional 14 oz. cycles of water through brewer to flush remaining vinegar from brewer.
8. Follow the steps below to clean the Sprayhead.

## CLEANING THE SPRAYHEAD

Mineral deposits and loose coffee or tea granules may clog the Sprayhead, causing the brew cycle to slow.

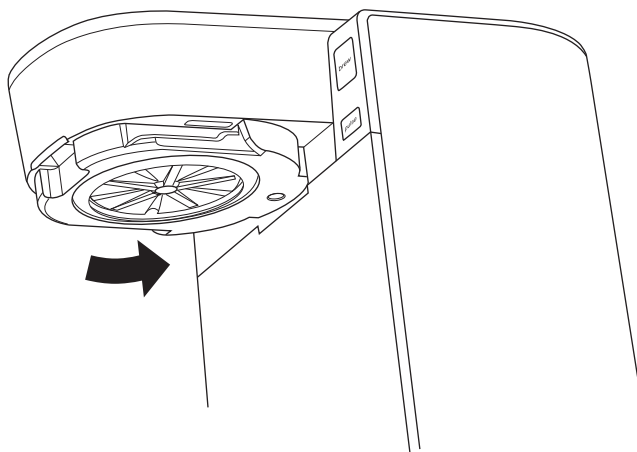

1. Unplug the brewer and allow it to cool (minimum 1 hour).
2. Remove Drawer.
3. Facing the brewer, rotate the Sprayhead assembly clockwise (using your fingers) until the Sprayhead and seal are removed.
4. Clean Sprayhead and seal with mild detergent and rinse thoroughly. A toothpick may also be used to clear debris from Sprayhead holes.  
**CAUTION:** If the Sprayhead and
5. With your fingers, rotate Sprayhead counter-clockwise until finger tight.
6. Replace Drawer.
7. Plug in brewer to restore power.



Sprayhead Seal are separated, they must be reassembled. Improper reassembly could result in injury from scalding water

# CLEANING & MAINTENANCE

---

## REASSEMBLING THE SPRAYHEAD/SEAL

If Sprayhead and Seal are separated during removal or cleaning, they must be reassembled properly for My Café® brewer to function.

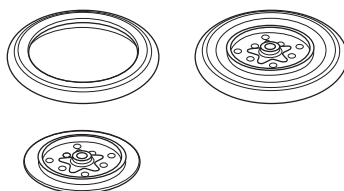

1. Identify the top of the Seal – it will have rough ridges while the bottom is smooth
2. Identify the top of the Sprayhead – it has a star pattern and a threaded hole where the Sprayhead attaches to the brewer.
3. Guide the Sprayhead into the channel of the Seal. Gently stretch the Seal if needed. Make sure it is completely in the channel.

When properly assembled, the Sprayhead will slide easily into the channel of the Seal and will not cause any buckles in the surface of the Seal.



**CAUTION:** Improper reassembly could result in personal injury from hot water.

## INSPECTING THE SPRAYHEAD SEAL

When disassembling your brewer for cleaning, inspect the Sprayhead Seal for cracks, tears and holes. Although the Seal should last for an extended period of time, damage can occur through handling.



**CAUTION:** To prevent injury from hot water, do not use the unit if the Seal is damaged. If damaged, call Customer Service at 800-352-2866 or visit [www.bunnathome.com](http://www.bunnathome.com) to obtain a replacement Seal.

## STORING THE BREWER

Unplug the brewer and wait for it to cool. It must be stored above 40°F/4°C to prevent damage to the internal Hot Water Tank. If you do not use your brewer for an extended period of time, we recommend running two to three cycles of water through prior to brewing coffee or tea.

**NOTE:** After Initial Set Up, water will remain in the internal Hot Water Tank.

# TROUBLESHOOTING

---

PROBLEM	SUGGESTIONS
<b>Brew Button Flashes Red</b>	<ul style="list-style-type: none"><li>• Internal Hot Water Tank must be filled with water. See Initial Set Up on page 3.</li></ul>
<b>Brew Button is Red</b>	<ul style="list-style-type: none"><li>• Your machine is brewing. Press the Brew Button again to stop the brew process.</li></ul>
<b>Indicator Light is Green</b>	<ul style="list-style-type: none"><li>• Water is hot and ready to brew.</li></ul>
<b>Indicator Light is Red</b>	<ul style="list-style-type: none"><li>• Water is heating.</li></ul>
<b>Indicator Light Flashes Red</b>	<ul style="list-style-type: none"><li>• The Brew Button was pressed but the water is heating. Wait for Indicator Light to turn green and press Brew Button again.</li></ul>
<b>Indicator Light Flashes Green</b>	<ul style="list-style-type: none"><li>• Add water. NOTE: Make sure that a cup is positioned on the Drip Tray under the Drawer prior to pushing Brew Button.</li><li>• If water with low mineral content such as distilled water is used, the sensors may not detect the water. Tip the brewer to drain the water out of the Pour-In Bowl and add tap water, drinking water or bottled water with a higher mineral content. Refer to page 3 for more information on water used for brewing.</li></ul>
<b>Indicator Light Flashes Red and Green</b>	<ul style="list-style-type: none"><li>• Drawer is not fully inserted. Press in the Drawer to lock into place.</li></ul>
<b>Water is not exiting Drawer</b>	<ul style="list-style-type: none"><li>• Make sure brewer is plugged into a working outlet.</li><li>• Make sure brewer is filled with water. The Hot Water Tank needs to be filled to begin brewing (Indicator Light will flash green). See Initial Setup on page 3.</li><li>• Make sure Drawer is fully inserted (the Indicator Light will alternately flash red and green if the Drawer is not fully inserted).</li><li>• If Indicator Light flashes red, brewer is heating water to proper brew temperature in approximately 2 minutes. When the light is green, press Brew Button.</li><li>• Press Brew Button to begin brew (Brew Button will be illuminated).</li></ul>
<b>I wish my beverage was stronger</b>	<ul style="list-style-type: none"><li>• Pod should be fully seated in Pod Drawer cavity for maximum flavor extraction.</li><li>• The amount of water used for brewing may be too large for the weight of coffee used. Try using a heavier pod, more ground coffee, or less water.</li><li>• Try a finer grind for your coffee if brewing with the Ground Coffee Drawer.</li><li>• Try using the Pulse Button to extend the water to coffee contact time. NOTE: Pulse Brew is the recommended setting when brewing with the Ground Coffee Drawer.</li></ul>
<b>Pulse Button is Red</b>	<ul style="list-style-type: none"><li>• The Pulse option is activated. Press the Pulse Button again to deactivate.</li></ul>
<b>Brewer doesn't turn on</b>	<ul style="list-style-type: none"><li>• Make sure brewer is plugged into a working outlet.</li><li>• Press Brew Button to begin brew (Brew Button will be illuminated).</li></ul>

# TROUBLESHOOTING

---

PROBLEM	SUGGESTIONS
<b>Takes too long to brew</b>	<ul style="list-style-type: none"><li>• Mineral deposits may be present in your brewer. See Deep Cleaning and Cleaning the Sprayhead on page 10.</li></ul>
<b>Brewer only brews water</b>	<ul style="list-style-type: none"><li>• Make sure coffee or tea is in the Drawer.</li></ul>
<b>Water speed varies during brew</b>	<ul style="list-style-type: none"><li>• The Pulse Brew Button has been pressed. During the brew, water flow will vary to properly steep tea or for stronger coffee.</li></ul>
<b>Water leaks out around the Sprayhead</b>	<ul style="list-style-type: none"><li>• The Sprayhead may be clogged, loose or the Seal may be damaged. Please refer to Cleaning the Sprayhead, Reassembling the Sprayhead/Seal and Inspecting the Sprayhead Seal on pages 10 and 11.</li></ul>
<b>The Drawer will not come out of the brewer</b>	<ul style="list-style-type: none"><li>• At the end of a brew cycle some pressure may remain trapped in the Drawer. Wait 10 minutes for the pressure to drop and try carefully removing the Drawer again.</li></ul>
<b>Water leaks out around a Drawer</b>	<ul style="list-style-type: none"><li>• Inspect the seal near the Sprayhead on the brewer for damage and foreign material.</li></ul> <p><b>Cup Drawer</b></p> <ul style="list-style-type: none"><li>• Inspect the top and bottom Piercing Nozzles and Seals on Cup Drawer to ensure they are in place and not damaged.</li></ul> <p><b>Ground Coffee Drawer</b></p> <ul style="list-style-type: none"><li>• Make sure you have not overfilled the Ground Coffee Drawer. (Maximum 20 grams)</li><li>• Make sure grounds are only in the bowl of the Grounds Coffee Drawer.</li><li>• Inspect Top Seal near the Top Screen of Ground Coffee Drawer to ensure it is in place and free of damage.</li></ul> <p><b>Pod Drawer</b></p> <ul style="list-style-type: none"><li>• Make sure the pod is fully inserted in the Pod Drawer cavity.</li></ul>
<b>Off taste is detected</b>	<ul style="list-style-type: none"><li>• Perform Basic Cleaning and Deep Cleaning on page 10.</li><li>• Remove used coffee or tea from Drawer after each brew. Do not leave used coffee or tea in the Drawer for extended periods of time.</li></ul>

**NOTE:** Do not disassemble. There are no user serviceable parts inside the brewer.

## AUTHORIZED SERVICE

---

[www.bunnathome.com](http://www.bunnathome.com)

**BUNN-O-MATIC® CORPORATION**

**IN THE UNITED STATES:**

1400 Stevenson Drive, Springfield, IL 62703  
900 E. Townline Rd., Creston, Iowa 50801  
1-800-352-BUNN (2866)

**IN CANADA:**

280 Industrial Parkway S., Aurora, Ontario L4G 3T9  
1-800-263-2256

To receive full assistance, have the Model and Date Code  
(located on a sticker on the lower back of the machine) ready when calling.



# LIMITED WARRANTY

---

BUNN® My Café® Single Cup Multi-Use Brewer for Home

## Model: MCU

Bunn-O-Matic® Corp. ("BUNN") warrants the My Café Single Cup Multi-Use Brewer for Home (MCU) to be free from defects in materials and workmanship existing at the time of manufacture and appearing within one of the following warranty periods:

- a) Two (2) years from the date of original purchase of a NEW BREWER with delivery of a valid receipt evidencing such purchase or, in the absence of such a receipt, from the date of manufacture as determined by date code of the machine.
- b) Two (2) years from the date of customer's receipt of a REPLACEMENT BREWER, if the original warranty on the replaced Brewer warranty has not expired.
- c) One (1) year from the date of purchase of a REMANUFACTURED BREWER.

If such a defect appears during the warranty period, we will (at our sole option) repair or replace the defective Brewer with no charge for service or parts, provided the Brewer is delivered at the customer's expense to one of our authorized service centers.

Warranty does not cover claims resulting from misuse, failure to follow instructions on installation and use, use with having a high mineral content, neglect, use of unauthorized attachments, commercial use, use of a current or voltage other than specified on the Brewer, or unauthorized service during the warranty period on conditions otherwise covered by warranty.

THIS WARRANTY SHALL BE EXCLUSIVE AND SHALL BE IN LIEU OF ANY OTHER EXPRESS WARRANTY, WRITTEN OR ORAL, INCLUDING BUT NOT LIMITED TO ANY EXPRESS WARRANTY OF MERCHANTABILITY OR FITNESS FOR A PARTICULAR PURPOSE. THE DURATION OF ANY IMPLIED WARRANTIES OF MERCHANTABILITY OR FITNESS FOR A PARTICULAR PURPOSE IS EXPRESSLY LIMITED TO THE PERIOD OF DURATION OF THIS LIMITED WARRANTY.

Some states do not allow limitation on how long an implied warranty lasts, so the above limitations may not apply to you.

THE CUSTOMER'S EXCLUSIVE REMEDY FOR BREACH OF THIS WARRANTY OR OF ANY IMPLIED WARRANTY OR OF ANY OTHER OBLIGATION ARISING BY OPERATION OF LAW OR OTHERWISE SHALL BE LIMITED AS SPECIFIED HEREIN TO REPAIR OR REPLACEMENT, AT OUR SOLE OPTION. IN ANY EVENT, RESPONSIBILITY FOR SPECIAL, INCIDENTAL AND CONSEQUENTIAL DAMAGES IS EXPRESSLY EXCLUDED.

Some states do not allow the exclusion or limitation of incidental or consequential damages, so the above limitation or exclusion may not apply to you.

This warranty gives you specific legal rights, and you may have other rights which vary from state to state.

The UL rating applies to use in a residential environment only. Warranty is void if machine is used in a commercial setting.



BUNN, the BUNN logo, My Café, Brew Better Not Bitter, are registered trademarks and Single Cup Multi-Use Brewer and Spin Lid are trademarks of Bunn-O-Matic Corporation.

The BUNN logo is a trademark of Bunn-O-Matic Corporation.  
43460.0002A 08/12©2012 BUNN-O-MATIC CORPORATION  
[www.bunnathome.com](http://www.bunnathome.com)