

# INSTALLATION INSTRUCTIONS

## Installation Manual

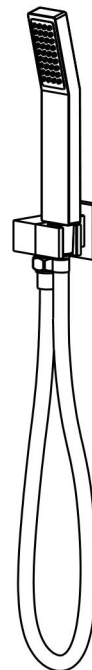
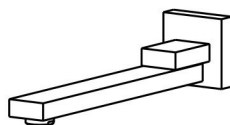
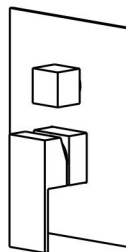
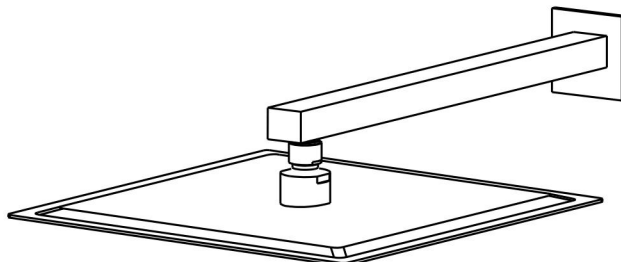

### IAPMO RESEARCH AND TESTING, INC.

5001 East Philadelphia Street, Ontario, California 91761-2816 • (909) 472-4100 Fax (909) 472-4244 • www.iapmo.org



#### CERTIFICATE OF LISTING

IAPMO Research and Testing, Inc. is a product certification body which tests and inspects samples taken from the supplier's stock or from the market or a combination of both to verify compliance to the requirements of applicable codes and standards. This activity is coupled with periodic surveillance of the supplier's factory and operations as well as the assessment of the supplier's Quality Assurance System. This listing is subject to the conditions set forth in the characteristics below and is to be construed as any recommendation, assurance or guarantee by IAPMO Research and Testing, Inc. of the product except as by American Testing Foundation.

Effective Date: August 2013 Void After: August 2016  
Product: Plumbing Fixture Fittings File No. 6737

Issued To: Kaiping Heart Cartridge Co., Ltd.  
No. 28 Heliwan Dong Road,  
Shilong Town,  
Kaiping City, GUANGDONG  
China

Identification: Plumbing supply fittings complying with this Standard shall be marked with the manufacturer's recognized name, trademark, or other mark or, in the case of private labeling, the name, trademark or other mark of the customer for whom the fitting was manufactured. The marking shall be accomplished by use of a permanent mark or by placing a permanent label on the product. Markings on plumbing supply fittings shall be visible after installation.

Single-handle, single-control, and automatic compensating mixing bath and shower valves shall have identifiable temperature control settings in which the settings are indicated by words ("cold", "warm", "hot", etc.), by numbers, or graphically.

Packages shall be marked with the manufacturer's name, trademark, or other mark as well as the model number or, in the case of private labeling, the name, trademark, or mark of the customer for whom the fitting was manufactured as well as the model number.

*David McHenry*  
Chairman, Product Certification Committee

*Ross Cheney*  
CEO, The IAPMO Group



### IAPMO RESEARCH AND TESTING, INC.

5001 East Philadelphia Street, Ontario, California 91761-2816 • (909) 472-4100 Fax (909) 472-4244 • www.iapmo.org



#### CERTIFICATE OF LISTING

IAPMO Research and Testing, Inc. is a product certification body which tests and inspects samples taken from the supplier's stock or from the market or a combination of both to verify compliance to the requirements of applicable codes and standards. This activity is coupled with periodic surveillance of the supplier's factory and operations as well as the assessment of the supplier's Quality Assurance System. This listing is subject to the conditions set forth in the characteristics below and is to be construed as any recommendation, assurance or guarantee by IAPMO Research and Testing, Inc. of the product except as by American Testing Foundation.

The most updated information on this Certificate of Listing is available online at [plb.iapmo.org](http://plb.iapmo.org)  
Effective Date: October 2016 -Rev. 11/28/2016- Void After: October 2017  
Product: Flexible Water Connectors File No. 4955

Issued To: Yuhuan Jiejin Plumbing Hose & Parts Co., Ltd.  
Fuchang Industry Zone  
Yuhuan County  
Chengjiang 317600,  
China

Identification: Manufacturer's name or trademark and UPC® certification mark. Special note on label "For use with water in exposed locations only."

Characteristics: Flexible water connectors manufactured in various sizes, lengths and metal end fittings for hot or cold water applications that consist of an inner tube, which may or may not have an outer braided cover. Connectors are to be installed for use in accessible locations only and in accordance with the manufacturer's instruction, and the latest edition of the Uniform Plumbing Code.

Products listed on this certificate have been tested by an IAPMO R&T recognized laboratory. This recognition has been granted based upon the laboratory's compliance to the applicable requirements of ISO/IEC 17025.

Products are in compliance with the following code(s):  
Uniform Plumbing Code (UPC®)

*David McHenry*  
Chairman, Product Certification Committee

*Ross Cheney*  
CEO, The IAPMO Group



### IAPMO RESEARCH AND TESTING, INC.

5001 East Philadelphia Street, Ontario, California 91761-2816 • USA • (909) 472-4100 • 909-472-4244 • www.iapmo.org



#### CERTIFICATE OF LISTING

IAPMO Research and Testing, Inc. is a product certification body which tests and inspects samples taken from the supplier's stock or from the market or a combination of both to verify compliance to the requirements of applicable codes and standards. This activity is coupled with periodic surveillance of the supplier's factory and operations as well as the assessment of the supplier's Quality Assurance System. This listing is subject to the conditions set forth in the characteristics below and is to be construed as any recommendation, assurance or guarantee by IAPMO Research and Testing, Inc. of the product except as by American Testing Foundation.

The most updated information on this Certificate of Listing is available online at [plb.iapmo.org](http://plb.iapmo.org)  
Effective Date: November 2016 -Rev. 3/1/2017- Void After: November 2017  
Product: Plumbing Fixture Fittings File No. 4528

Issued To: Hegepeli Inc.  
171 Mattatuck Heights  
Waterbury, CT 06705

Identification: Each fitting component shall bear permanent legible markings to identify the manufacturer. This marking shall be the trade name, trademark, or other mark known to identify the manufacturer. The product shall also bear all other markings required by the standard. The marking shall be located where it can be readily seen after installation is complete. The product or packaging shall also bear the UPC® certification mark.

Characteristics: Plumbing fixture fitting components to be installed in accordance with the manufacturer's instructions and the requirements of the latest edition of the Uniform Plumbing Code.

Products listed on this certificate have been tested by an IAPMO R&T recognized laboratory. This recognition has been granted based upon the laboratory's compliance to the applicable requirements of ISO/IEC 17025.

Products are in compliance with the following code(s):  
Uniform Plumbing Code (UPC®)  
National Plumbing Code of Canada

*Tom Collins*  
Chairman, Product Certification Committee

*Ross Cheney*  
CEO, The IAPMO Group



# BEFORE INSTALLATION

| NO. | Item                      | Qty |
|-----|---------------------------|-----|
| 1   | Upper outlet pipe         | 1   |
| 2   | Top shower head           | 1   |
| 3   | Hand-held shower head     | 1   |
| 4   | Hand shower bracket       | 1   |
| 5   | Shower hose               | 1   |
| 6   | Main body                 | 1   |
| 7   | Panel                     | 1   |
| 8   | Water diversion handwheel | 1   |
| 9   | Handle                    | 1   |
| 10  | Lower outlet pipe         | 1   |
| 11  | Accessory bag             | 1   |

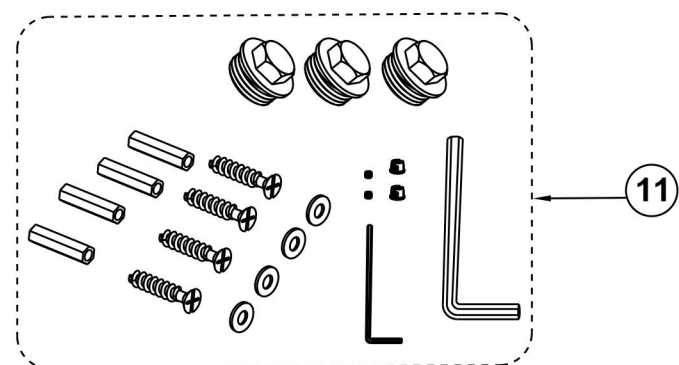
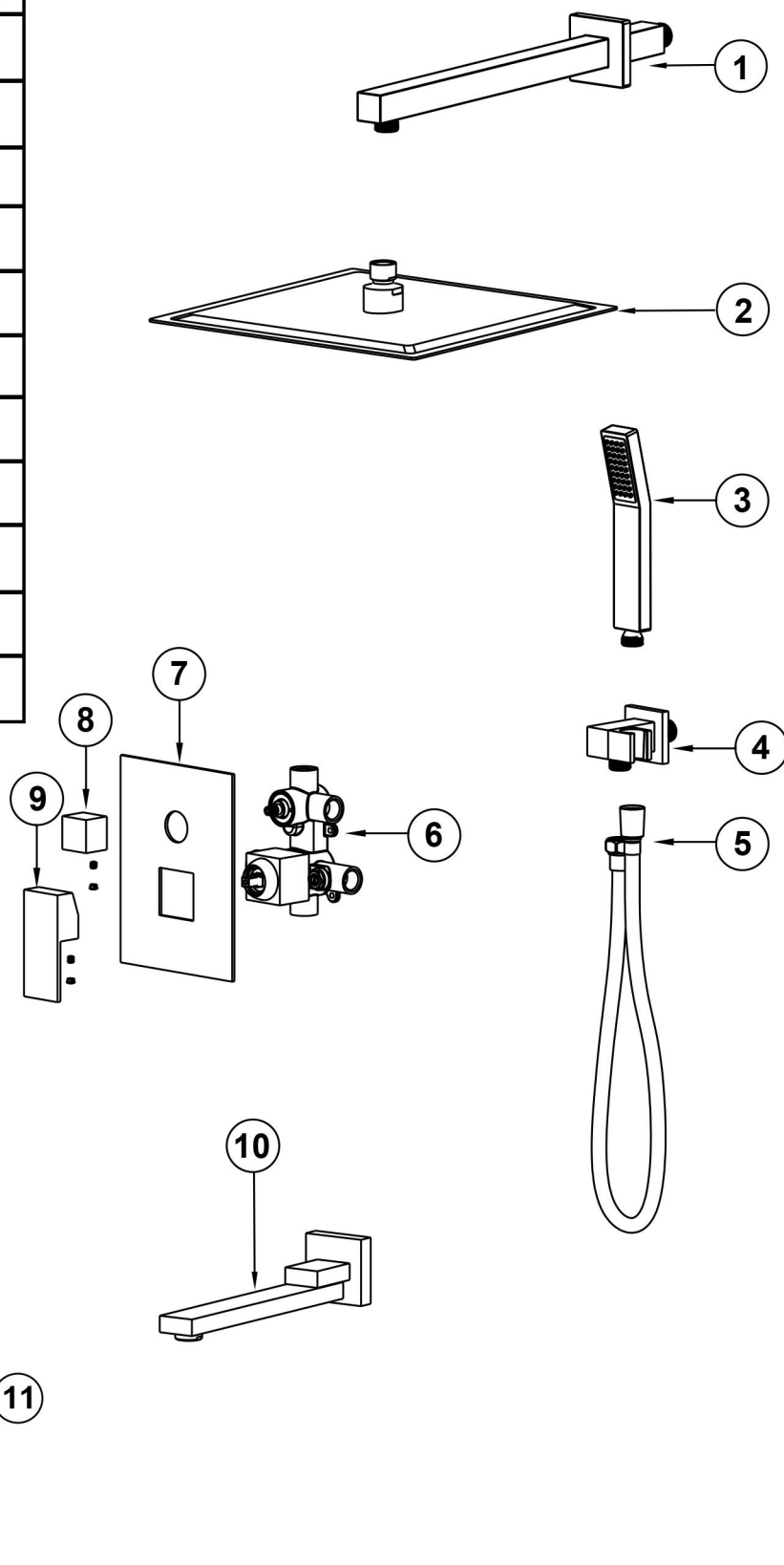

## Check accessories

### Standard List of Accessories:

When you open the product packaging, please check whether the objects in it are consistent with the main body and accessories you purchased. If there is any inconsistency, please contact our company or our distributor.

Note: 1. Accessories are subject to change without prior notice if the change does not affect usage;

2. The appearance of the product is subject to the physical objects you receive, and the schematic diagram is only for reference.

# INSTALLATION STEPS

This product has been inspected and debugged by the factory to the best condition. Please do not disassemble and assemble it yourself.

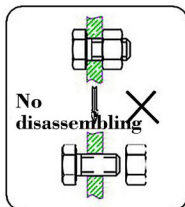

Before installing the faucet, please be sure to remove sundries and sludge from the water pipe to prevent sundries from blocking the faucet.

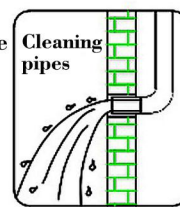

1. Dig pipe grooves for pre-burying pipes.

Unit: inch

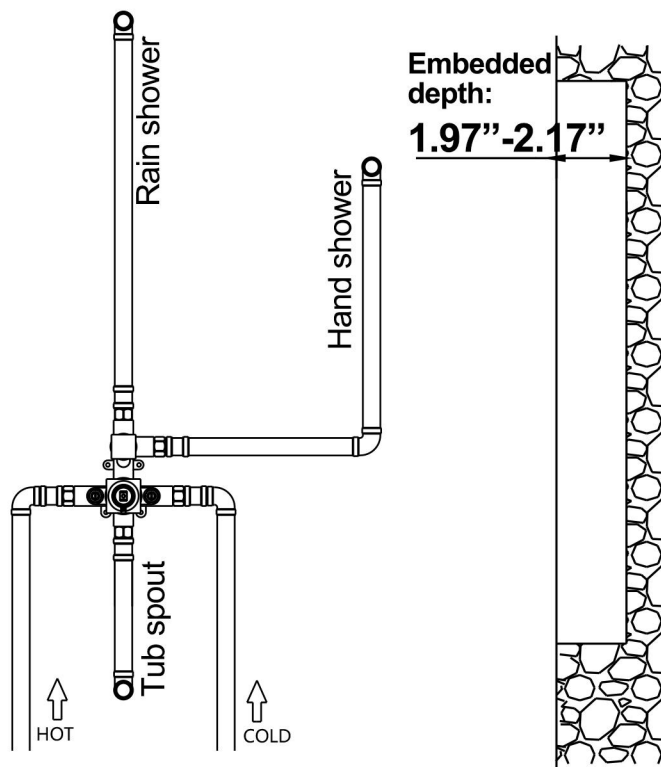

2. Install the main body and water inlet pipes.

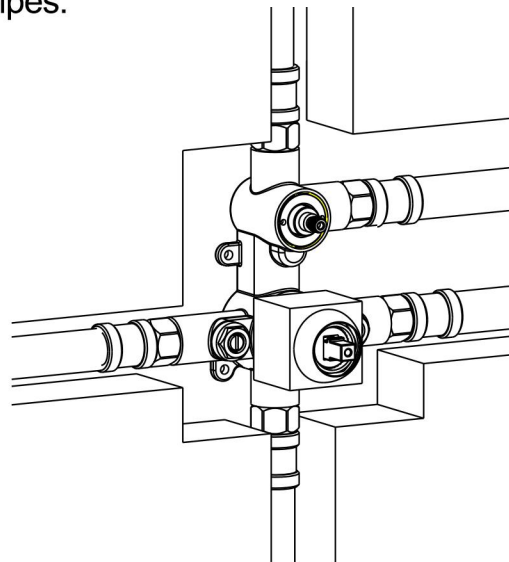

3. Attach the tiles (refer to Figure 4 for important dimensions).

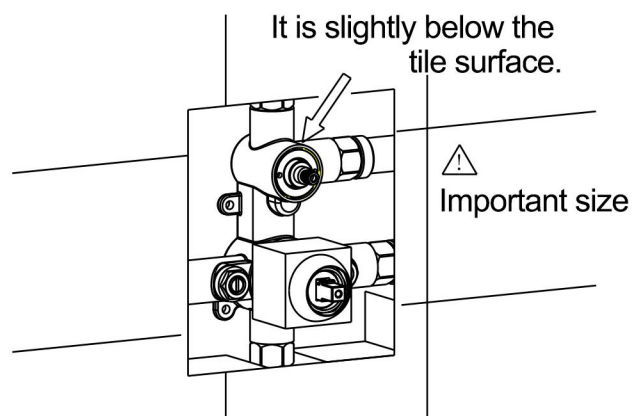

5. Install the upper outlet pipe and the top shower head.  
(wrap the PTFE tape on the thread)

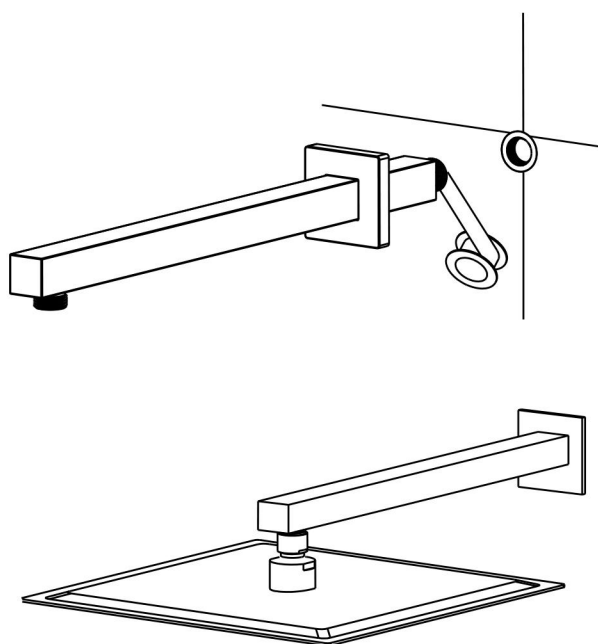

4. The water outlet of the hand shower is slightly lower than the tile surface.

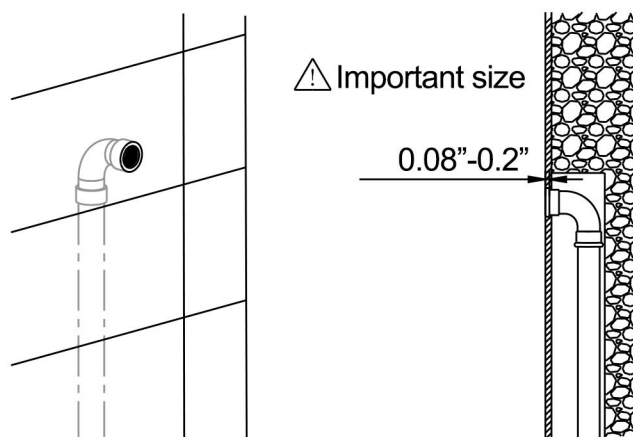

# INSTALLATION STEPS

6. Install the panel and handle.

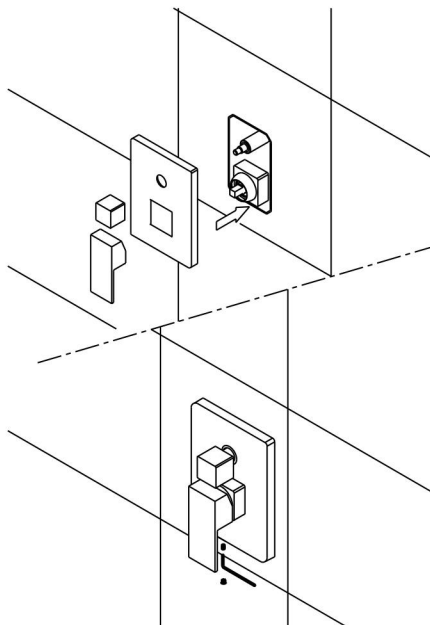

7. Install the hand shower seat.

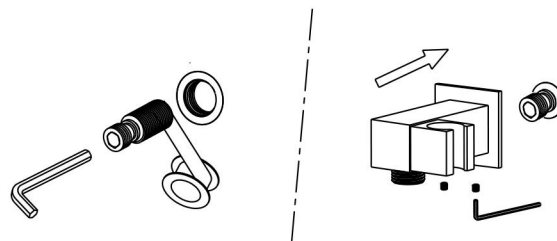

8. Install the lower water pipe.

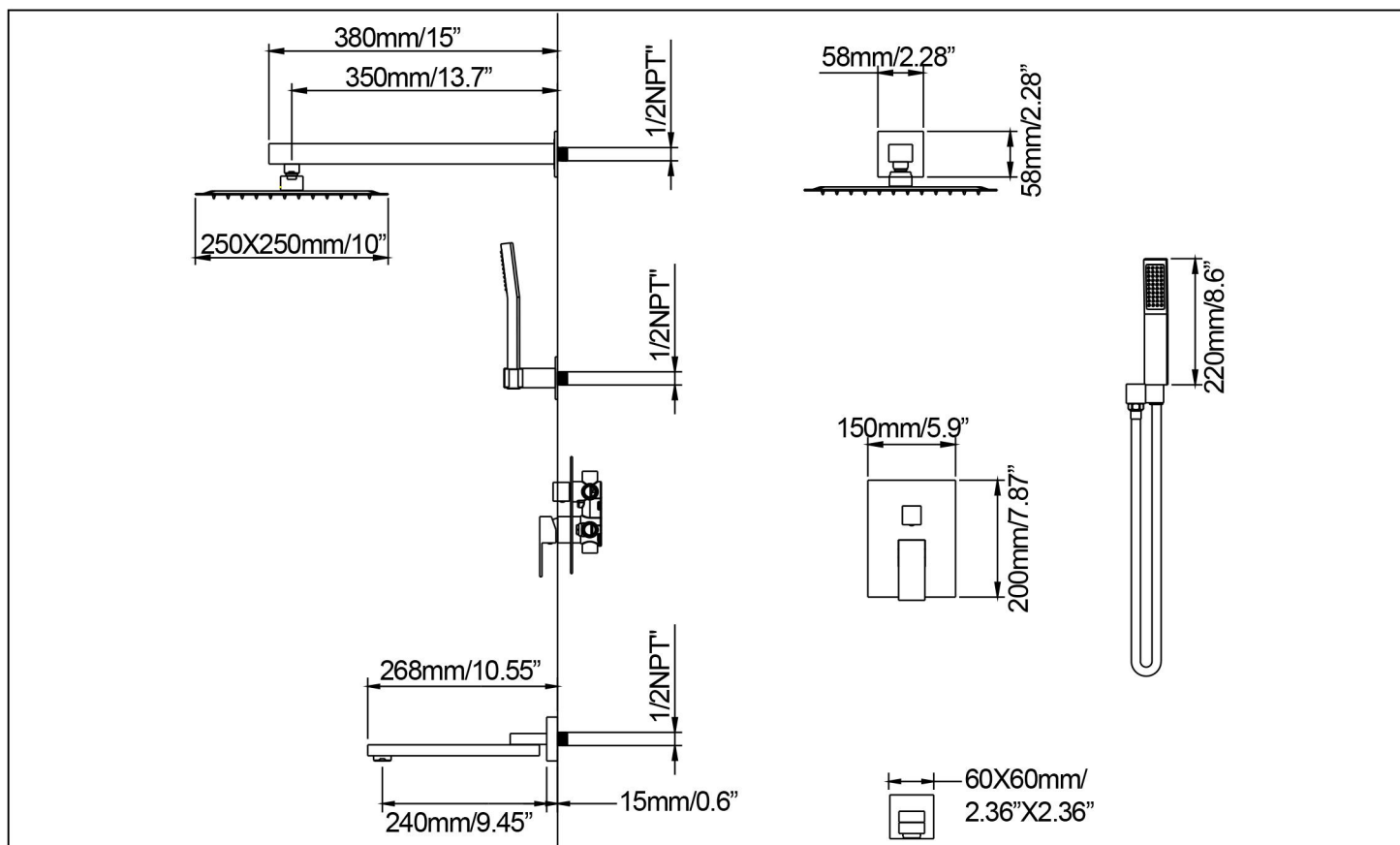
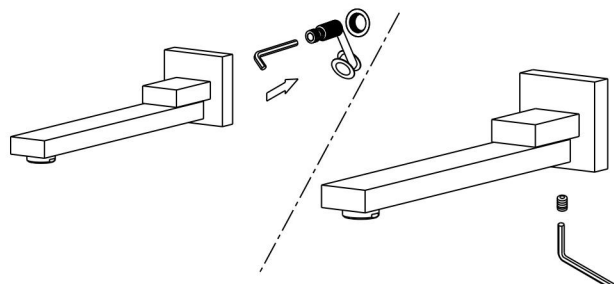

## CLEANING CARE

In order to keep the appearance of faucet clean, bright and good performance, please take care of the faucet as follows;

1. Rinse with water only and dry with soft cotton cloth;
2. Use mild liquid and colorless glass cleaner to remove surface dirt and scale film, or use polish without abrasive effect;
3. Do not use abrasive detergent, polish, emery cloth, paper towel or scraper, etc.;
4. Do not use acid cleaner, or cleaner and soap with insoluble gran etc.;
5. In the process of use, mud may accumulate in the bubbler and make the water flow slow. The bubbler can be unscrewed, rinsed with water, and then installed back in place.



Please feel free to contact us if you have any questions. We will help to solve the issue together with you. OUR EMAIL: [services@rbrohant.com](mailto:services@rbrohant.com)