

ELKAY® Quartz Perfect Drain™ Installation Instructions

For all non-disposer installations in Quartz Perfect Drain™.

STEP 1

Install and properly seat **Drain Seal** within groove of **Flange**.

Incorrect installation may allow leaks and void the warranty!

Apply non-staining plumbers putty to underside of **Flange**.

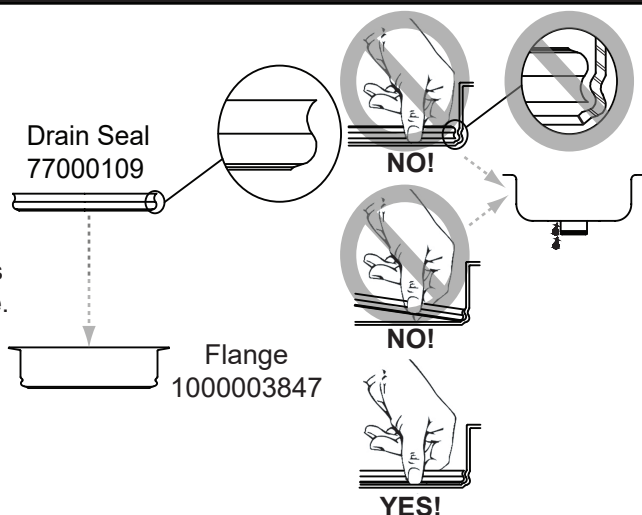

STEP 2

Properly seat **Drain Body** into **Flange**.

Insert **Flange** into sink.

Place **Gasket** over **Flange**. Install **Housing** over **Flange**.

Thread **Lock Nut** onto **Drain Body**.
Place **Poly Washer** on **Tailpiece**.

Install **Tailpiece Assembly** onto **Drain Body** with **Coupling Nut**.

Check for leaks and place **Strainer Basket** into **Drain Body**.

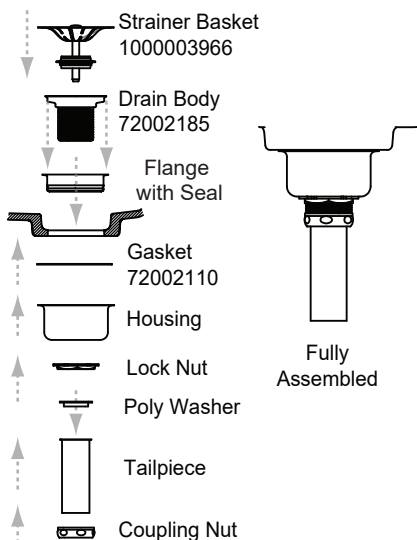

BE CAREFUL TO NOT OVER TIGHTEN THE FITTINGS.

In keeping with our policy of continuing product improvement, Elkay reserves the right to change product specifications without notice. Please visit elkay.com for most current version of Elkay product specification sheets.

This specification describes an Elkay product with design, quality, and functional benefits to the user. When making a comparison of others producers offerings, be certain these features are not overlooked.

Zurn Elkay
1333 Butterfield Road, Suite 200
Downers Grove, IL 60515

©2024 Zurn Elkay
elkay.com

PART NO. 1000003889
Rev: 03/24