



ASSEMBLY INSTRUCTIONS AND PARTS EXPLOSIONS

Y43Z08 Model

ASSEMBLY TOOLS REQUIRED

Two (2) 9/16" Wrenches

ASSEMBLY INSTRUCTIONS (SEE FIGURE 1)

1. Insert output shaft of Y43 transmission (A) in the open end of Flex Coil Shock Top (B)
2. Line up bolt holes through Flex Coil Shock Top and output shaft of the transmission
3. Place included 3/8 -16 x 1.5" bolt (C) through bolt hole
4. Hand-thread 3/8-16" lock nut (D) onto bolt
5. Using two 9/16" wrenches, securely tighten nut and bolt

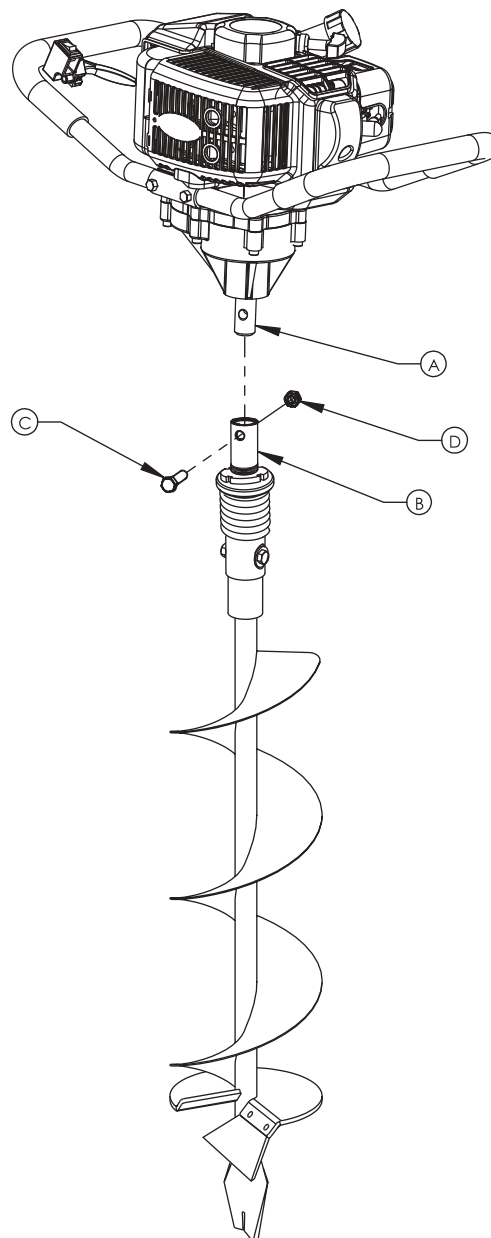

Figure 1



Figure 2



Figure 3



Figure 4



Figure 5



Figure 6



Figure 7



CAUTION

NEVER ALTER/MODIFY ENGINE OR AUGER
IN NO WAY ALTER OR MODIFY THE ENGINE FROM HOW IT CAME FROM THE FACTORY. SERIOUS INJURY OR DEATH MAY OCCUR IF IT IS ALTERED IN ANY WAY. ALWAYS DISCONNECT SPARK PLUG WIRE FROM SPARK PLUG WHEN WORKING ON OR REPLACING PARTS FOR THE ENGINE OR AUGER AND KEEP IT AWAY FROM THE SPARK PLUG. WHEN OPERATING ENGINE, ALWAYS WEAR HEARING PROTECTION!



PLEASE DO NOT START YOUR EARTH AUGER UNTIL YOU HAVE READ THE PREVIOUS SECTION OF THIS MANUAL IF YOU HAVE READ THESE, FOLLOW THE STEPS BELOW TO START YOUR EARTH AUGER. NEVER STORE ENGINE WITH GAS IN THE TANK IN-DOORS. FUEL AND FUEL VAPORS ARE HIGHLY FLAMMABLE. NEVER MIX FUEL AND OIL DIRECTLY IN ENGINE GAS TANK USE ONLY NON-METAL, PORTABLE FUEL CONTAINERS APPROVED BY THE UNDERWRITER'S LABORATORY (U.L.) OR THE AMERICAN SOCIETY FOR TESTING & MATERIALS (ASTM). AN ADULT MUST ALWAYS HANDLE AND FILL THE ENGINE WITH FUEL. ALWAYS HANDLE FUEL IN A WELL VENTILATED AREA, OUT DOORS AWAY FROM FLAMES OR SPARKS.



IMPORTANT

NEVER RUN ENGINE ON STRAIGHT GAS ONLY. THIS ENGINE USES A GAS/OIL MIXTURE. FAILURE TO RUN ON FACTORY RECOMMENDED MIXTURE WILL RESULT IN ENGINE DAMAGE

OPERATION

STEPS FOR WORKING ON ENGINE OR AUGER

- Turn off engine switch.
- Disconnect spark plug wire from spark plug.
- Securely place disconnected spark plug wire safely away from spark plug and any other metal parts. This must always be done or arcing may occur between spark plug wire and metal parts.
- Replace or repair the part on the engine or auger.
- Check all parts that were repaired, or removed during repair, to ensure that they are secure and fit correctly.
NOTE: All repair parts must come from the factory. Never replace parts that are not specifically designed for the engine or auger.
- Replace spark plug wire.

PREPARING ENGINE FOR STARTING

Make sure the black throttle cable housing is seated all the way into the brass ferrule at the engine side of the cable before attempting to start your powerhead engine.

GAS AND OIL QUALITY

To operate the engine, we recommend using 2-cycle oil. This will help to ensure that the engine operates correctly throughout the life of the engine. Use unleaded regular gas only.

MIXTURE

Run earth auger with a 50:1 ratio.

GAS	OIL	RATIO
1 gallon	2.56 ounces	50:1
2 gallons	5.12 ounces	50:1
5 gallons	12.8 ounces	50:1

MIXING FUEL AND FILLING GAS TANK

MIXING FUEL

- Fuel must be mixed in a container outside in a well ventilated area.
- Fill certified fuel container 1/4 full of recommended fuel.
Add recommended amount of 2 cycle oil.
- Screw container cap on straight and tight.
- Shake the container to mix fuel and oil.
- Unscrew gas cap slowly to vent, add the remainder of fuel requirements.
- Wipe away any spilled fuel or oil and allow to evaporate before moving or transporting.



CAUTION

ALWAYS HANDLE FUEL IN A WELL VENTILATED AREA, OUTDOORS, AWAY FROM FLAMES OR SPARKS.

DO NOT START ENGINE IF FUEL IS SPILLED. WIPE OFF EXCESS FUEL AND ALLOW TO DRY. REMOVE ENGINE FROM AREA TO AVOID SPARKS.

Need Help? PLEASE CALL



During the assembly process or while operating or maintaining your auger, if you have any questions, please call our Authorized Service Center at the toll free number listed above.

FILLING GAS TANK

- ✓ When unit has been in operation, always shut-off engine and allow engine to completely cool before refilling the gas tank.
- ✓ Always move to a well ventilated outdoor area away from flames and sparks.
- ✓ Always clean debris from area around the gas cap to keep fuel clean.
- ✓ Remove gas cap slowly and always place the cap on a clean, dry surface.
- ✓ Carefully add fuel without spilling.
- ✓ When filling tank, do not over-fill gas tank. Allow space for fuel to expand.
- ✓ Once tank is full, replace gas cap and tighten. Wipe off any spilled fuel and allow tank to dry before starting engine.

NORMAL OPERATION

- ✓ The Thunderbay Powerhead requires approximately a two hour break-in period before the clutch will transfer maximum power. During this break-in period clutch slippage may occur. Make sure that the clutch is always kept free of oil or other moisture for efficient operation.
- ✓ When drilling holes, do not place excessive body weight on the unit. The unit will operate more efficiently with a shaving action caused by the weight of the unit itself.
- ✓ Never run engine indoors. Exhaust fumes are deadly.
- ✓ This is not an Ice Auger. Do not use an earth auger in the ice.
- ✓ When attaching auger to powerhead, align hole at top of auger shaft with the output shaft hole. Insert 3/8-16 x 1-1/2" bolt and secure bolt with provided 3/8" bi-way lock nut using a wrench.

IMPORTANT NOTE:

The measured sound power level at the operator's position is approximately 100 dBLWA and is guaranteed not to exceed 106 dBLWA. The mass of the powerhead is 21.7 lbs. (9.9 kg.)



ENGINE STARTING (COLD & WARM)

Y43Z08 Model

WARNING

MAKE SURE THE UNIT IS IN A STABLE POSITION BEFORE PULLING STARTER.

WHEN THE UNIT STARTS TO FIRE OR RUN, RELEASE THE THROTTLE CONTROL MOMENTARILY WITH YOUR RIGHT HAND AND RETURN YOUR LEFT HAND TO THE HANDLEBAR POSITION TO MAINTAIN CONTROL AND STABILITY OF THE UNIT WITH BOTH HANDS

STARTING AND STOPPING ENGINE

- ✓ Move engine outdoors to a well ventilated area to ensure you are safe from carbon monoxide poisoning.
- ✓ Make sure you are in an area away from flames or sparks to avoid ignition of vapors if present.
- ✓ To ensure proper air flow, remove all debris from air cleaner holes and gas cap.

COLD ENGINE START

To start engine for the first time or after the engine has cooled off or after running out of fuel.

1. Position the choke lever to **RUN**.

NOTE: Choke must be in the RUN position when pushing or using the primer bulb.

2. Prime unit until primer hose is filled with gas.

NOTE: When using the primer bulb, allow the bulb to return completely to its original position between pushes.

3. Move choke lever to **CHOKE** position.

NOTE: **CHOKE** position is defined by moving the choke lever as far to the **CHOKE** position as possible.

4. Push rocker switch to the **ON position**.

5. Squeeze throttle control with right hand. Grasp starter handle with left hand and pull out slowly, until it pulls slightly harder. Without letting starter handle retract, pull rope with a rapid full arm stroke. Let it return to its original position very slowly until unit fires or runs. Repeat this step every time the starter rope is pulled.

NOTE: If engine fails to start after 5-6 pulls, push primer 1 time and pull starter rope again.

6. After engine starts running, move choke lever to **HALF CHOKE** position until unit runs smoothly.

NOTE: **HALF CHOKE** is defined when the choke lever is between **CHOKE** and **RUN**.

7. Move choke lever to **RUN** position and move throttle to desired speed.

NOTE: Run at full throttle when possible. Do not let unit idle for extended periods of time.

8. To stop engine, push rocker switch to **OFF** position.

1 855 691 5969

CAUTION

ALWAYS HANDLE FUEL IN A WELL VENTILATED AREA, OUT DOORS, AWAY FROM FLAMES OR SPARKS.

ALWAYS WEAR A PROTECTIVE HEARING DEVICE.

DO NOT START ENGINE IF FUEL IS SPILLED.

WIPE OFF EXCESS FUEL AND ALLOW TO DRY REMOVE ENGINE FROM AREA TO AVOID SPARKS.

IF AUGER IS MOUNTED TO ENGINE, ALL SAFETY GUARDS MUST BE SECURELY ON TO AVOID SERIOUS INJURY.

STARTER ROPE CAN CAUSE AN UNANTICIPATED JERK TOWARDS ENGINE PLEASE FOLLOW INSTRUCTIONS TO AVOID INJURY.

NEVER LEAVE ENGINE RUNNING WHILE UNATTENDED.

TURN OFF AFTER EVERY USE.

NEVER CARRY POWERHEAD AND AUGER BETWEEN HOLES WHILE ENGINE IS RUNNING.

WARM ENGINE START

1. Move choke lever to **CHOKE position**.

NOTE: **CHOKE** position is defined by moving the choke lever as far to the **CHOKE** position as possible.

- Continue with Step 5 of Cold Engine Starting.

HOT ENGINE START

1. Continue with Step 5 of Cold Engine Starting.

2. If engine does not fire, refer to Step 1 of Warm Engine Starting.

DO NOT ATTEMPT TO START ENGINE IN THE FOLLOWING WAYS:

- ✓ **DO NOT USE STARTING FLUID.**
- ✓ **DO NOT SPRAY FLAMMABLE LIQUIDS OR VAPORS INTO AIR CLEANER, CARBURETOR OR SPARK PLUG CHAMBER.**
- ✓ **DO NOT REMOVE SPARK PLUG AND PULL ON STARTER ROPE. FLAMMABLE FUEL CAN SPRAY OUT & IGNITE FROM A SPARK FROM SPARK PLUG.**

