

INSTALLATION MANUAL BID 02

WOODBIDGE[®] **ELECTRONIC TOILET SEAT**

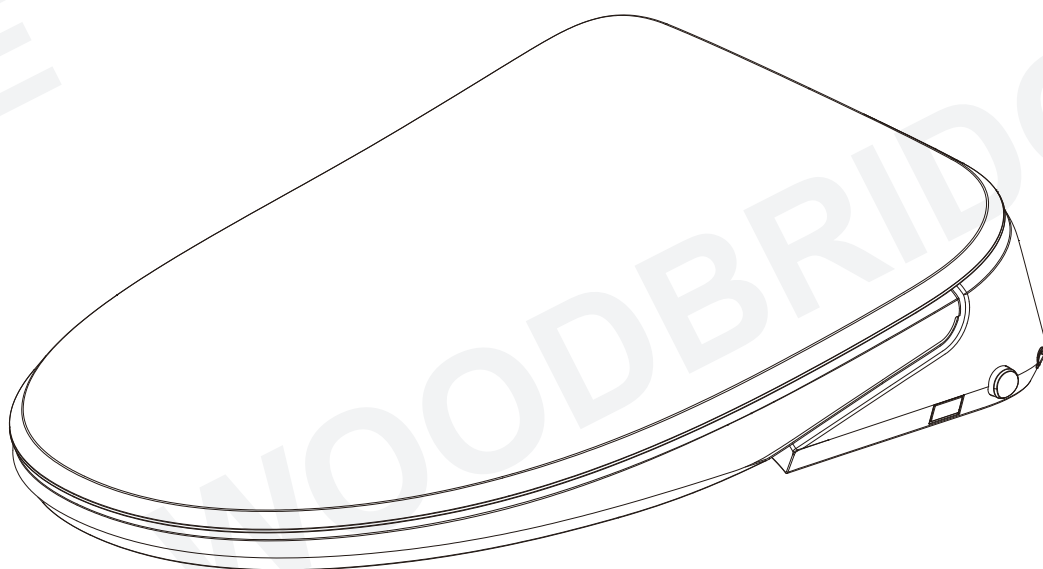

Installation Manual

- Thank you for choosing our products. Please read the instructions carefully before installation and keep it available for future maintenance or reference.
- Our company reserves the right of final interpretation for this manual. The manual is subject to change without notice.

Customer Service Phone: 562-229-0088. (Monday - Friday 9 AM - 5 PM Pacific Time)
Or Email: help@woodbridgebath.com

2020413 REV. 3

When using electrical products, especially when children are present, basic safety precautions should always be followed, including the following:

1. The appliance is not to be used by persons (including children) with reduced physical, sensory or mental capabilities, or lack of experience and knowledge, unless they have been given supervision or instruction.
2. Children being supervised not to play with the appliance.
3. This appliance can be used by children aged from 8 years and above and persons with reduced physical, sensory or mental capabilities or lack of experience and knowledge if they have been given supervision or instruction concerning use of the appliance in a safe way and understand the hazards involved.
4. Children shall not play with the appliance.
5. Cleaning and user maintenance shall not be made by children without supervision.

READ ALL INSTRUCTIONS BEFORE USING



DANGER—To reduce the risk of electrocution:

1. Do not use while bathing.
2. Do not place or store product where it can fall or be pulled into a tub or sink.
3. Do not place in or drop into water or other liquid.
4. Do not reach for a product that has fallen into water. Unplug immediately.
5. Do not wash the main unit or electrical plug with water or detergent.
6. Do not handle the electrical plug with wet hands.
7. Do not put a hand or other staff over the outlet of air dryer or block the outlet of air dryer.
8. Never disassemble, repair or modify this product.
9. During installation, disassembly, repair and maintenance of the product, the power plug must be switched off and water supply be shut off.



WARNING—To reduce the risk of burns, electrocution, fire, or injury to persons.

1. Close supervision is necessary when this product is used by, on, or near children or invalids.
2. Use this product only for its intended use as described in this manual. Do not use attachments not recommended by the manufacturer.
3. Never operate this product if it has a damaged cord or plug, if it is not working properly, if it has been dropped or damaged, or dropped into water. Return the product to a service center for examination and repair.
4. Keep the cord away from heated surfaces.
5. Never use while sleeping or drowsy.
6. Never drop or insert any object into any opening or hose.
7. Do not use outdoors or operate where aerosol (spray) products are being used or where oxygen is being administered.
8. Connect this product to a properly grounded outlet only. See Grounding Instructions.
9. Do not throw cigarettes and other burning stuff into toilet, otherwise it might cause fire.
10. This product is electric appliance, so it must be placed far away from water. Please don't drench urine and other liquid to it.
11. Do not lay on side or upside the product during the electrical circuit.
12. It is prohibited to use other electric appliances in the same socket.
13. It is forbidden to use the power extension or unstable loose outlet.
14. The old aging water supply hose can not be used, otherwise it might cause leakage, fire or electrical shock. Installation of the bidet seat should include specified components and new water supply hose.



CAUTION—Indicates that failure to follow the instruction may cause body injury or property damage.

1. Do not install or use the product in wet places as steam room etc. This product must be connected to properly grounded power outlet socket.
2. It is recommended to use water-proof electrical outlet which should be installed in the place where is not easily got wet.
3. This product should be used with AC 110V-120V, 50/60Hz electrical current only, load current is at least 15A. Power plug must be equipped with ground fault circuit interrupter or ground fault electrical leakage protector or similar high sensitive, rapid type leakage switch (Rated sensitive current under 6mA).
4. When it thunders, it is strongly recommended to pull out the power plug.
5. Do not stand on ceramic toilet.
6. Ceramic toilet must install floor fixing bolt.
7. Do not stand on product unit, seat and cover.
8. Do not lean against the seat cover when using the product, to avoid damage.
9. This product is equipped with soft-closing seal cover. Heavy pressing or pushing may damage the soft-closing damper.
10. Do not use lacquer thinner, petrol, liquid medicine, detergent, insecticide, toilet cleanser and scrubbing brush to clean the product.
11. Exposure to direct sunlight is prohibited.
12. Only use tap water or potable water; otherwise it may cause chafing.
13. Do not connect water supply to heater outlet. Make sure inlet water temperature at 3~35°C
14. When the room temperature is under zero degree, please dry up the water tank, to avoid freezing.
15. Raise rest room temperature to prevent the toilet from damage due to freezing.
16. When move the product from cold or wet environment into normal room temperature, wait for 2 hours until the condensation water is fully volatilized. Doing so can prevent the product from electrical short-circuit.
17. When not using the product over three(3) days, drain the water out of the container and pull the electrical plug from the wall outlet.
18. Stop using the product and shut off the power when product malfunctions, please contact the service people for professional service.

GROUNDING INSTRUCTIONS

This product should be grounded. In the event of an electrical short circuit, grounding reduces the risk of electric shock by providing an escape wire for the electric current. This product is equipped with a cord having a grounding wire with a grounding plug. The plug must be plugged into an outlet that is properly installed and grounded.



DANGER — Improper use of the grounding plug can result in a risk of electric shock.

If repair or replacement of the cord or plug is necessary, do not connect the grounding wire to either flat blade terminal. The wire with insulation having an outer surface that is green with or without yellow stripes is the grounding wire.

This product is factory equipped with a specific electric cord and plug to permit connection to a proper electric circuit. Make sure that the product is connected to an outlet having the same configuration as the plug. No adapter should be used with this product. Do not modify the plug provided — if it will not fit the outlet, have the proper outlet installed by a qualified electrician. If the product must be reconnected for use on a different type of electric circuit, the reconnection should be made by qualified service personnel.

SAVE THESE INSTRUCTIONS

Technical Specification

Main Unit	Rated voltage	110-120V, 50/60Hz
	Rated power	960W
	Water pressure range	The minimum necessary pressure 0.08MPa (hydrostatic pressure), the maximum water pressure 0.8MPa (hydrostatic pressure)
	Power Cord	length is about 1.2m
Cleaning device	Heating power	1400W(120V)
	Water temperature	6-level water temperature adjustment
	Water volume	5-level adjustment
	Cleaning mode	Rear cleaning / Massage cleaning, Front cleaning /Massage cleaning
	Nozzle position	5-level adjustment
	Water pressure protector	Pressure stabilizer, Automatic pressure discharging device
	Anti-fouling device	Anti-syphon device, Anti-backflow device, Filter device
	Safety device	The water temperature sensor, Anti-burning apparatus, Thermostat, Temperature fuse, Ground fault protection, Leakage protection , Anti-freeze cracking device
Drying device (If Applicable)	Warm wind speed	Over 0.2m³/min
	Warm wind temperature	6-level adjustment
	Heating power	200W
	Safety device	High temperature preventer, thermal fuse
Deodorization	Deodorization Method	None Photocatalyst
Heated seat	Surface temperature	6- level adjustment
	Heating power	50W
	Open and close device	Soft close
	Prevent low temperature burn	After 10 minutes of use, the seat temperature will automatically drop slowly to a low level
	Safety device	Seat sensor, Temperature sensor, Bimetal thermostat, Thermal fuse
Caring device	Night light assembly	Smart, Always on, Always off
	Noise-free setting	The buzzer is off at night to avoid buzzer noise to guarantee a quiet environment at night
	User ID setting	To avoid disturbance from remote controls by multi-user
Sterilization device (If Applicable)		Plasma sterilization device
Antibacterial position		Seat, Nozzle

Components Name

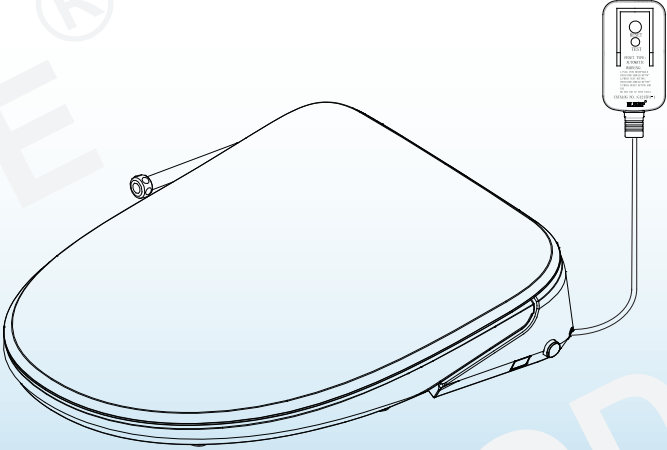
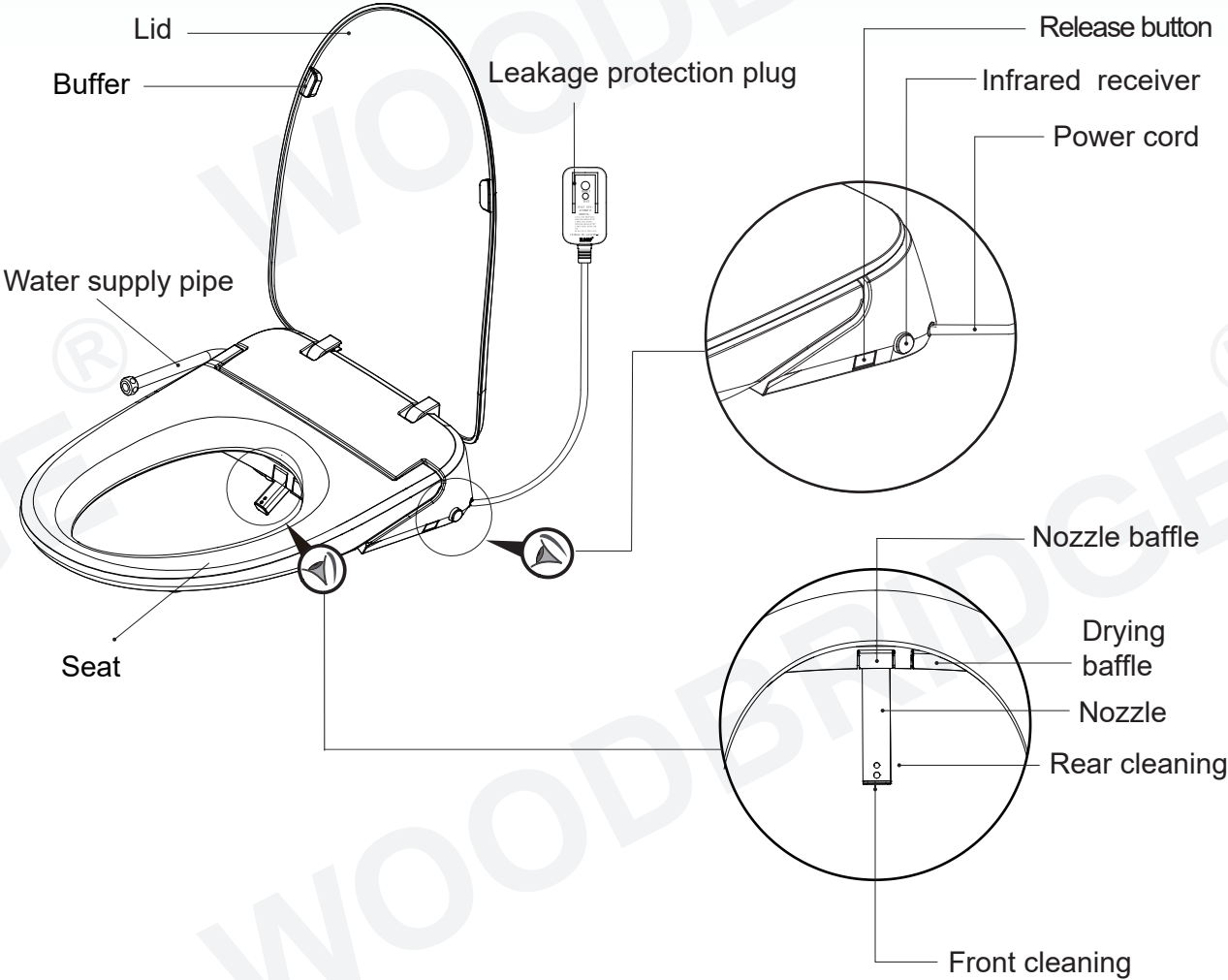





Whole set of product



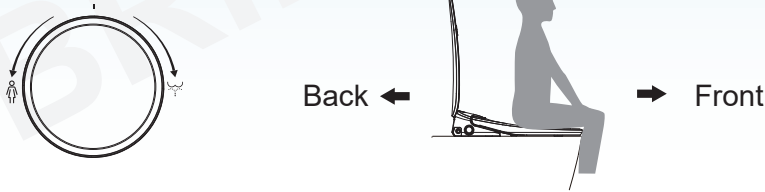

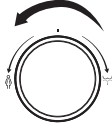

The remote control



Main Unit Knob Instructions (Knob Applies)

		
Rear Cleaning Knob	<ol style="list-style-type: none"> 1. When people is seated, turn Rear Cleaning Knob forward to start rear cleaning function; Rear cleaning → Drying→Stop drying automatically. 2. During rear cleaning, turn the knob forward, the washing position moves forward, otherwise, the washing position moves backward. 	
Front Cleaning Knob	<ol style="list-style-type: none"> 1. When people is seated, turn Front Cleaning Knob backwards to start front cleaning function; Front cleaning→ Drying →Stop drying automatically 2. During front cleaning, turn the knob backwards, the washing position moves backward, otherwise, the washing position moves forward. 	
Stop Knob	Press the knob vertically to stop the function in progress: rear cleaning, front cleaning, drying or nozzle cleaning function.	

Main Unit Side Button Instructions (Button Applies)

	
 Rear Cleaning Button	<ol style="list-style-type: none"> 1. When people is seated, press Rear Cleaning Button shortly to start rear cleaning function; Rear cleaning → Drying→Stop drying automatically 2. When rear cleaning function is on, long press Rear Cleaning Button to massage cleaning function; long press again to stop massage cleaning function. 3. When the cleaning function is on, shortly press Rear Cleaning Button, the nozzle will move back by one step; 4. When no one is seated, press Rear Cleaning Button, the nozzle will stretch out, people can wash the nozzle manually.
 Front Cleaning Button	<ol style="list-style-type: none"> 1. When people is seated, shortly press Front Cleaning Button to start front cleaning function; Front cleaning → Drying → Stop drying automatically 2. When front cleaning function is on, long press Front Cleaning Button to start massage cleaning function. Long press Front Cleaning Button again to turn off massage cleaning function. 3. When cleaning function is on, shortly press Front Cleaning Button, the nozzle will move forward by one step.
 Stop Button	<ol style="list-style-type: none"> 1. Long press Stop Button to make the main unit enter standby mode, press Stop Button again to make the main unit return to Operating mode. [In standby mode, all functions are invalid by pressing any button (on main unit or remote control) except Stop Button. 2. When people is seated, shortly press Stop Button on main unit to stop front cleaning, rear cleaning or drying functions; When no one is seated, repeatedly press Stop Button on the main unit, the main unit will switch between operating mode and power saving mode.

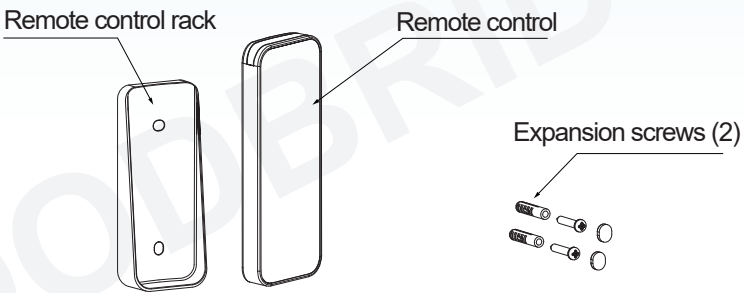
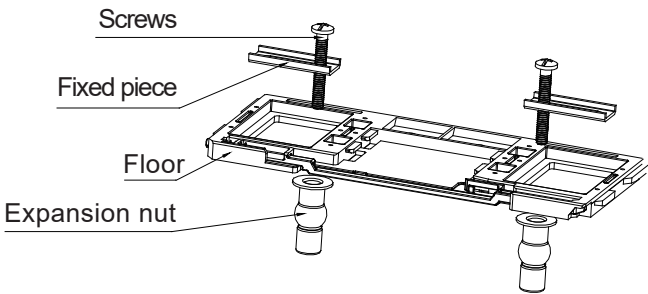
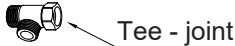
Packing List

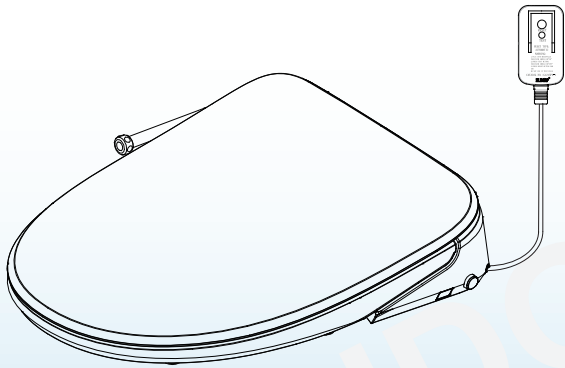
The remote control assembly	1.Remote control	 <p>Remote control rack</p> <p>Remote control</p> <p>Expansion screws (2)</p>
	2.Remote control rack	
	3.Expansion screws (2)	
Base plate assembly	1.Base plate	 <p>Screws</p> <p>Fixed piece</p> <p>Floor</p> <p>Expansion nut</p>
	2.Screws (2)	
	3.Fixed piece (2)	
	4.Expansion nut (2)	
The filter assembly	Tee - joint (1)	 <p>Tee - joint</p>
Manual, Certificate of quality, Mounting Cardboard	Manual(including warranty card)	 <p>Manual (including warranty card)</p> <p>Certificate of quality</p> <p>Mounting Cardboard</p>
	Certificate of quality	
	Mounting Cardboard	
Main unit		

Product Size and Installation Preparation Tool

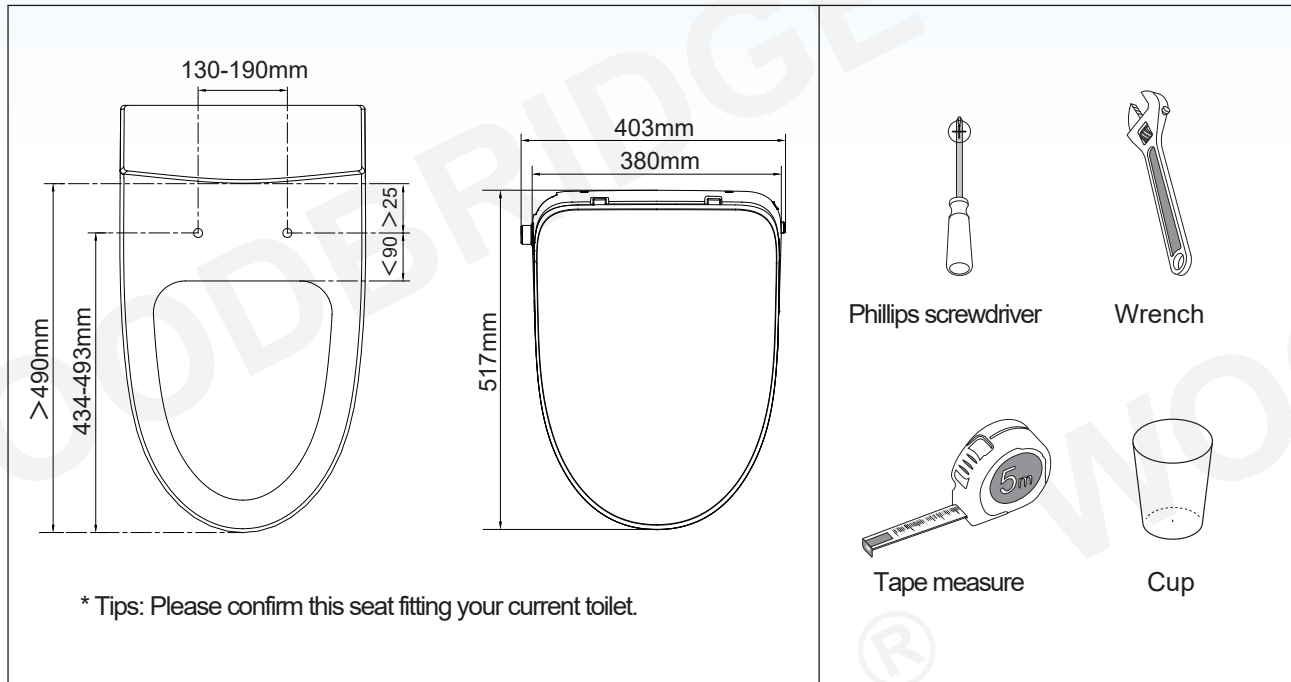

Installation of Main Unit

* This product has been tested for water flow before leaving the factory. There may be a small amount of residual water dripping out when removing the product, which is not a malfunction.

* Do not install this product in a wet place such as a bathroom, and do not put it in a place prone to water.

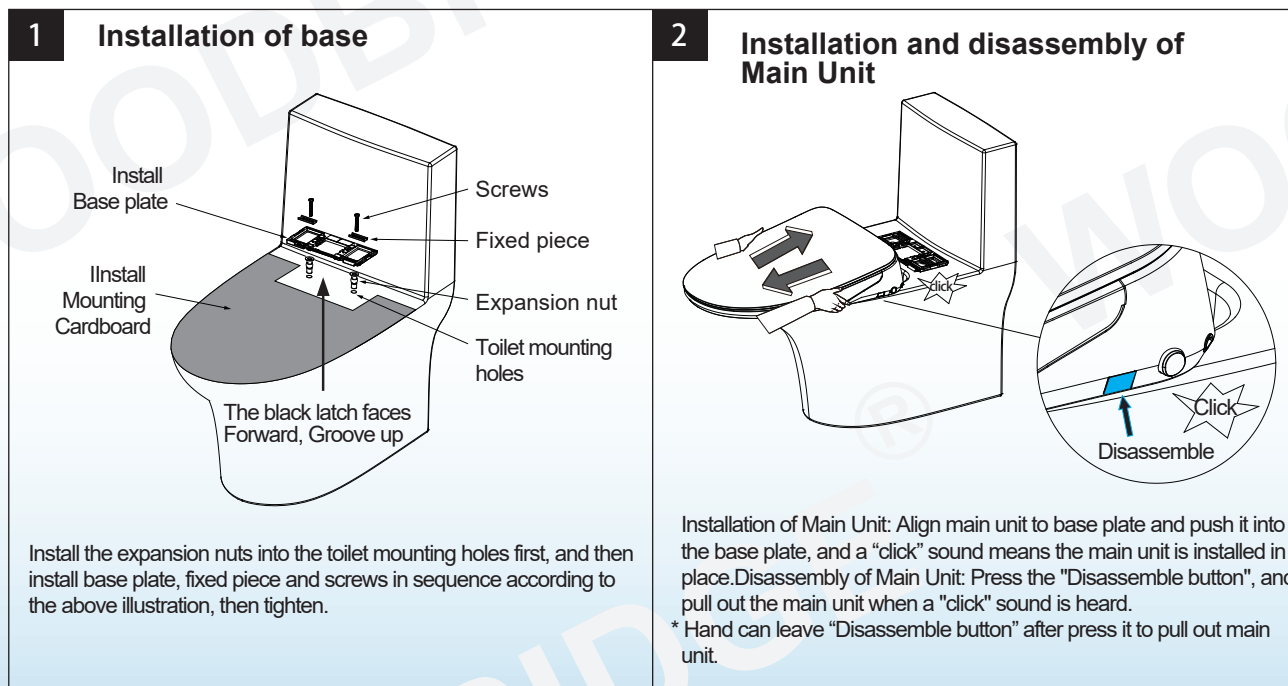

3 Installation of Water inlet pipe and Tee joint

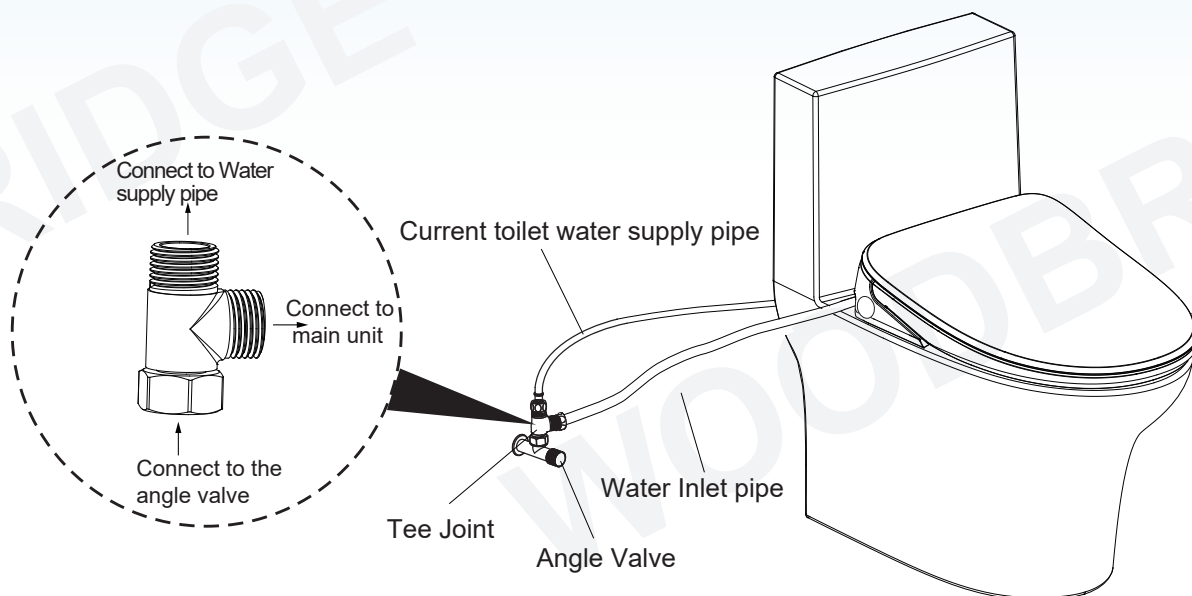

- ① Connect Tee joint to angle valve; (The original Tee joint should be removed);
- ② Connect the inlet end of water supply pipe to Tee joint according to the above illustration;
- ③ Connect main unit to Tee joint according to the above illustration.

Preparation for Start-Up

1. Turn on the angle valve

- Check the tightness of the threaded connection to ensure that there is no water leakage. Turn the angle valve counterclockwise to adjust the opening to the maximum.
(Tips: when the valve is opened for the first time, the angle valve handle has a large torque)

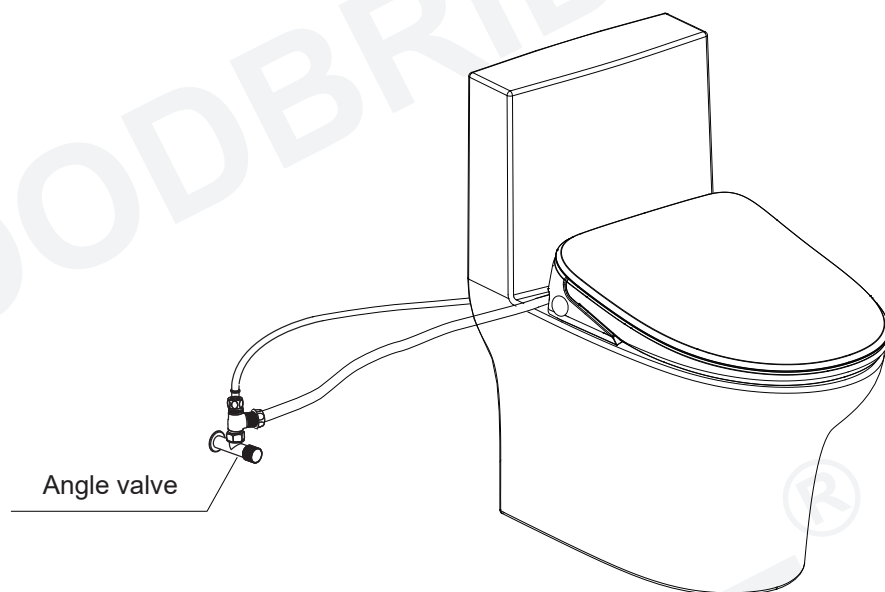

2. Power Connection

- Insert power line leakage protection plug into the power socket, press the reset switch, plug indicator lights on indicating that the power is on.

Tips:

Press electric leakage test button prior to usage, the reset switch pops up indicating that the leakage protection function is normal.

Press the TEST button (then RESET button) every month to assure proper operation.

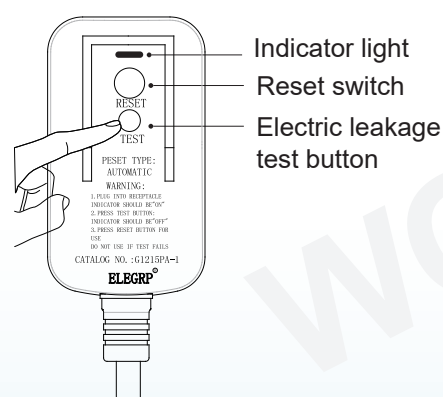

3. Safety self-test

1. The main unit buzzer beeps once, and the knob (button) starts self-test after the white light flashes.
2. The main unit buzzer beeps again, and the self-test is completed, and the knob (button) lights up in white;
3. The function mode is turned on and in normal use.

Daily Maintenance

Maintenance of Main Unit

1. Turn off the power during maintenance of this machine.
2. Wipe the dirty area with a soft cloth that is wrung out of water.
3. After wiping, please turn on the power again.

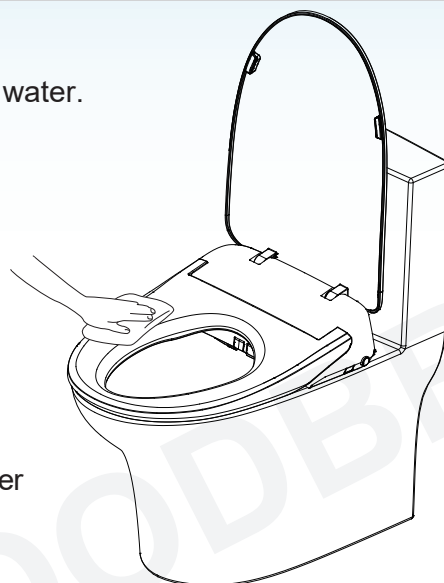
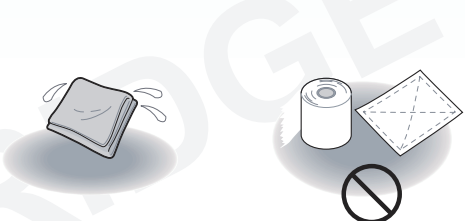

Tips: Do not rinse the surface of the product directly with water during maintenance.

Maintenance of the Nozzle

When there is dirt on the nozzle, maintain it according to the following methods:

1. When no one is seated, turn the knob forward (press Rear Cleaning Button on the main unit), then nozzle rod is extended, and manually clean with a rag or soft brush.
2. Nozzle can be removed and cleaned separately. (Hold the nozzle rod in one hand and pull the nozzle out with the other hand)
3. Put back the nozzle, and then press the knob button (Stop button) on the main unit or the "Stop" button on the remote control, the guided rod retracts.

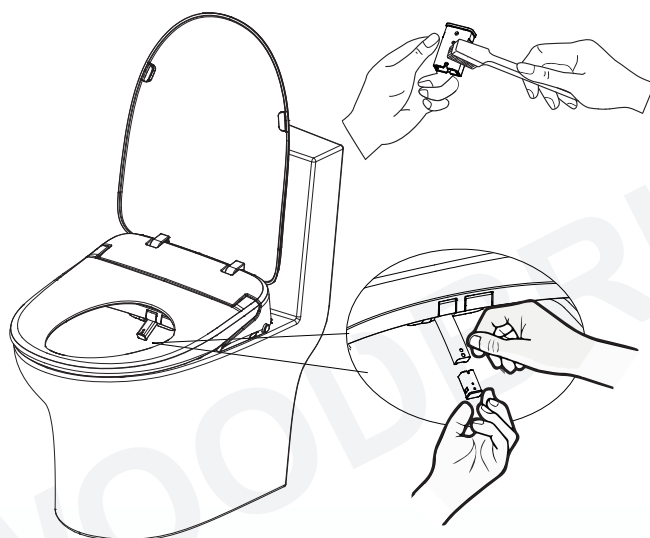
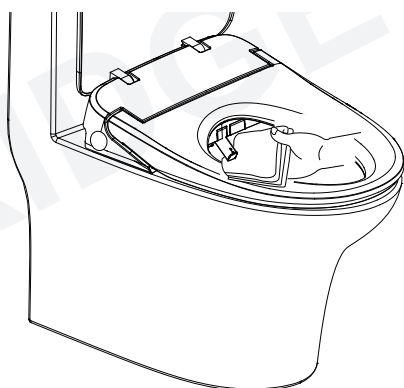

Tips: Do not pull the nozzle rod to prevent the damage of the nozzle rod and motor.

Filter Maintenance

Time for maintenance: It is under normal water pressure but poor flush performance occurs.

1. Turn off the angle valve.
2. Unscrew toilet water inlet pipe and seat water inlet pipe.
3. Take out filter and filter washer
4. Brush filter with toothbrush and clean filter
5. Re-install filter and filter washer, then re-install water inlet pipe

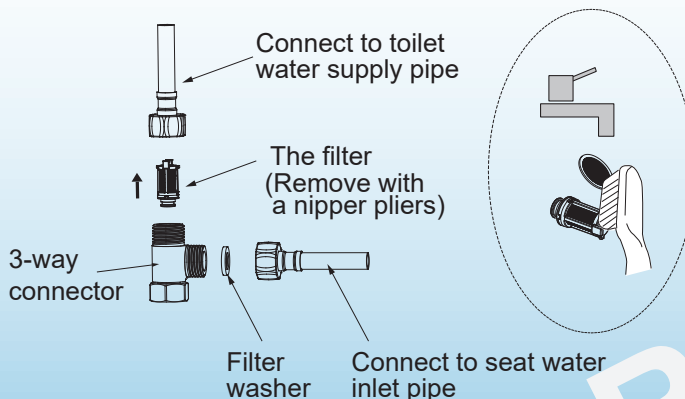

Self-cleaning Waterway Maintenance

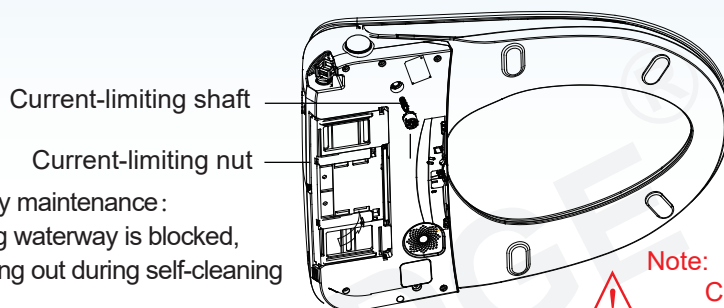

Self-cleaning waterway maintenance:

When the self-cleaning waterway is blocked, there is no water coming out during self-cleaning process.

Note:

Cut off power prior to discharging the water.

1. Turn off the angle valve.
2. Unplug the power plug, cut off the power.
3. Remove the seat, press current-limiting shaft in the middle with a flat-blade screwdriver, then reinstall the seat, and open the inlet valve.
4. If there is still no water coming out after pressing current-limiting shaft, use a flat-blade screwdriver to unscrew current-limiting nut, remove current-limiting shaft, and clean it with a toothbrush or small brush. After cleaning, replace current-limiting nut and current-limiting shaft to the restrictor in the device, then reinstall the seat, and open the inlet valve.

Deodorizing Device Maintenance

Unscrew the screws, take out the deodorant box, and replace the none-photocatalyst.

- ✧ It is recommended to replace the none-photocatalyst after 3 years of use (the specific life span depends on the environment).
- ✧ If you need to replace the none-photocatalyst, please purchase it in the official online store.

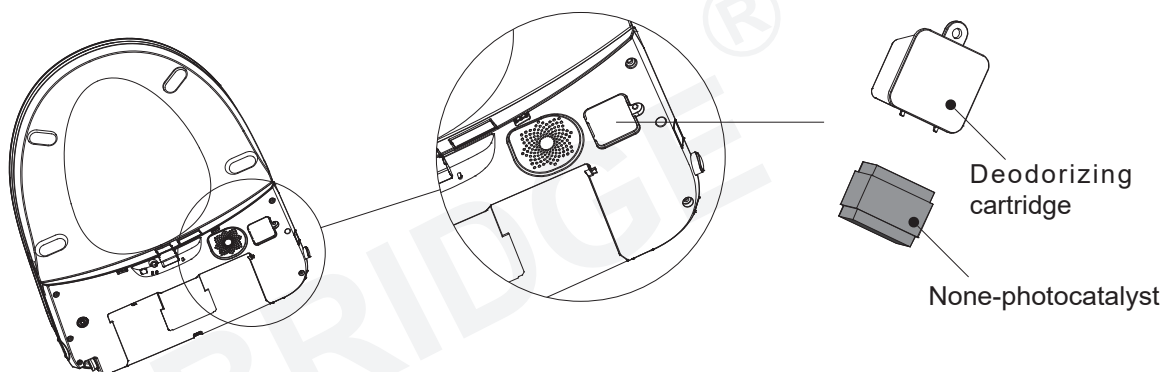

Removal and Installation of Clamp

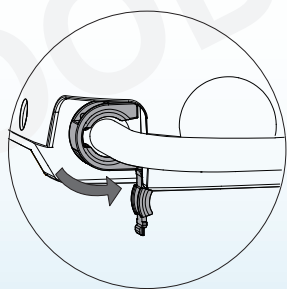

Removal: Open the clamp cover, rotate it counterclockwise, and use a flat-blade screwdriver to pry the clamp out of the slot.

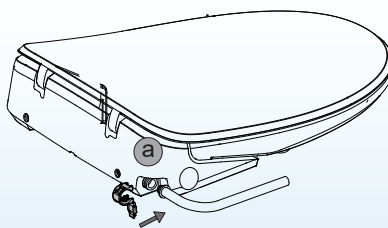

Installation: Install the quick-released connector of water inlet pipe into the main unit, and clip the clamp into the slot.

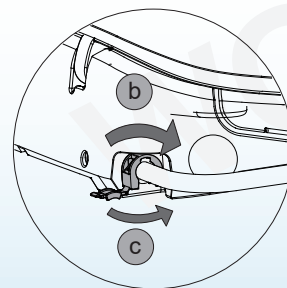

Troubleshooting Guide

Problem	Cause	Solution
No Water from Nozzle	Water inlet hose bent to cause blocking	Solve the problem of bending of water inlet hose
	Inlet valve is off	Turn on the inlet valve
	Water supply is cut off	Connect water supply and wait for the water
Weak water cleaning	Water inlet hose bent to cause partial blocking	Solve the problem of bending of water inlet hose
	Water inlet valve is not fully open	Turn on the inlet valve fully
	Inlet filter blocked	Clean the filter
Low water temperature	The water temperature is set in normal temperature level	Reset the water temperature
low seat temperature	The seat temperature is set in normal temperature level	Reset the seat temperature
	In standby mode	Switch to operating mode and use it after 3 minutes
low wind temperature	The wind temperature is set in normal temperature level	Reset the wind temperature
No wind out	In standby mode or power saving mode	Shift to operating mode to use dry function
Nozzle rod cannot retract	Power off	Push back the nozzle rod lightly and put power on
	Get stuck by impurities	Clear away the impurities
Nozzle rod cannot stretch out	Power off	Put power on
	No sitting in sensing area	Sit right in the sensing area
Remote control cannot display	The battery of the remote control is installed in the opposite direction	Reload the battery
Malfunction of deodorization	User doesn't reach the sensing area in seat	Adjust to reach the sensing area
	Deodorization function keeps working after user leaves	It's a normal phenomenon if deodorization function keeps working after user leaves to ensure eliminating smell entirely
 Caution	If the problems cannot be solved as per above methods, please turn off the power , and contact service providers for maintenance.	
	If the power leakage protection switch always trips, it means that the product is leaking. Please turn off the power, contact the service provider, and ask for professional repairs.	

NOTES

DATE OF INSTALL:

INSTALLER'S NAME:

PLUMBER:

☐

CONTRACTOR:

☐

LICENSE #:

Customer Service Phone: 562-229-0088. (Monday - Friday 9 AM - 5 PM Pacific Time)

Or Email: help@woodbridgebath.com