

PACKAGE CONTENT

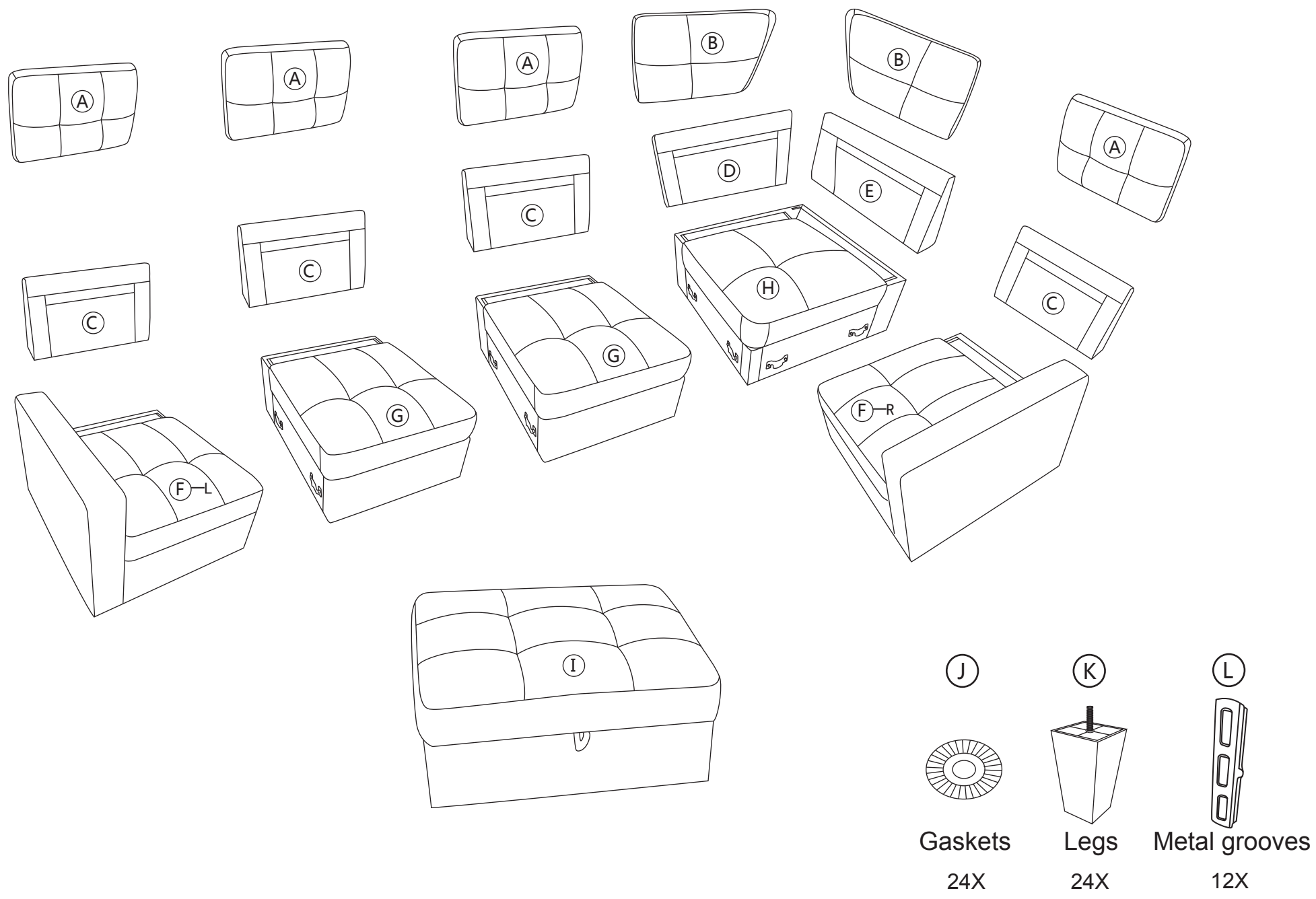

STOP 1

Take out the legs and gaskets. Assemble the legs on the bottom of seats

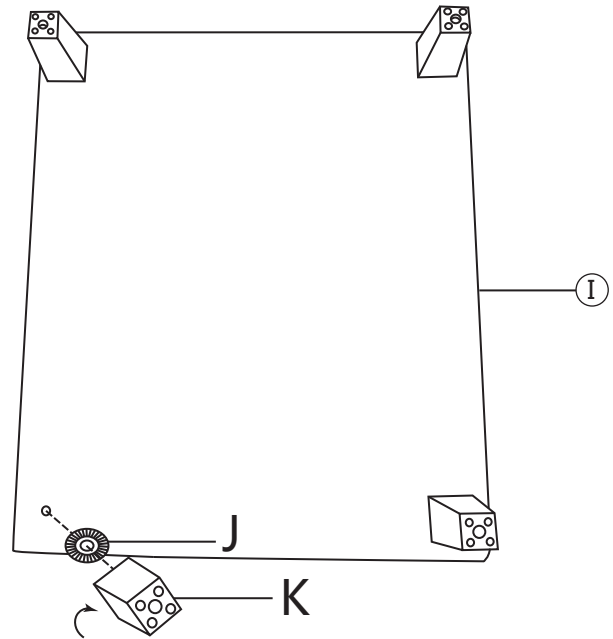
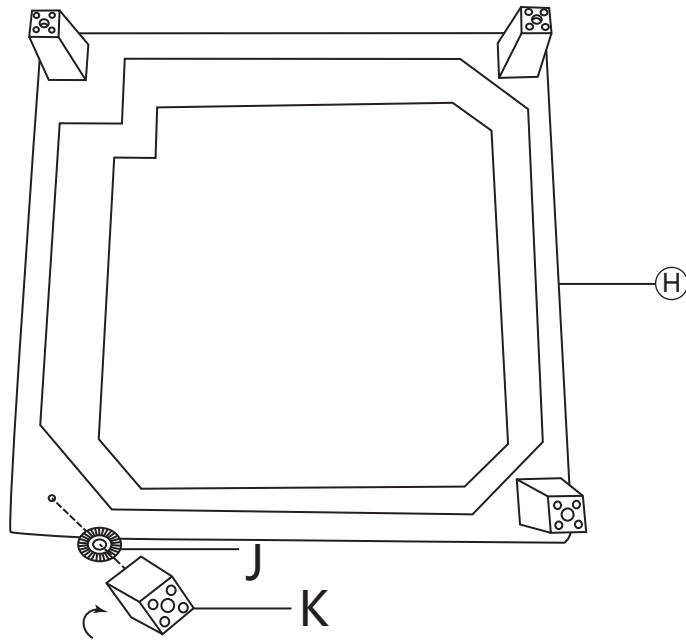
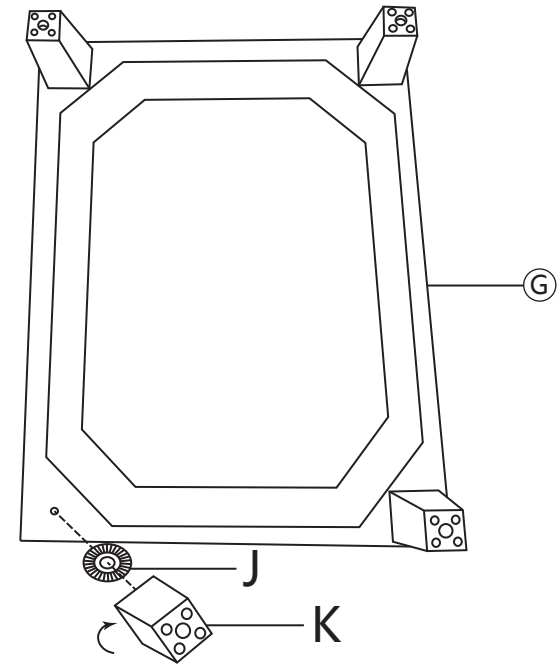
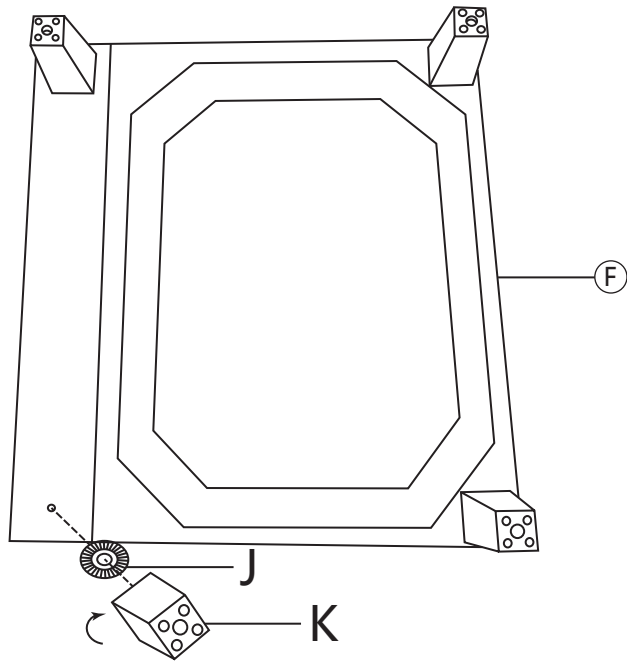

STOP 2

Connect the backrests to the sofa seats (F, G, H) accordingly by aligning the metal grooves (Insert L to M and N)

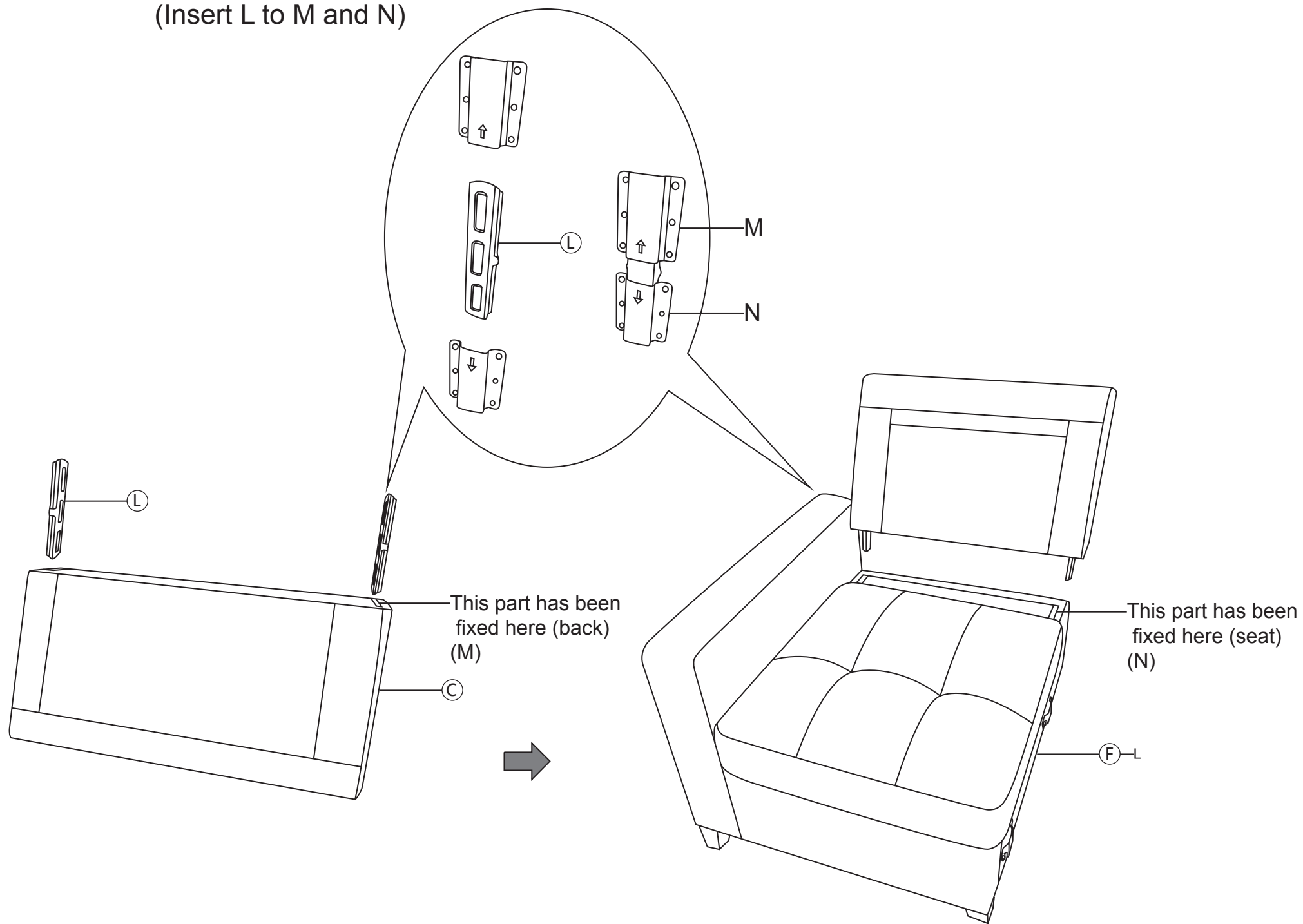

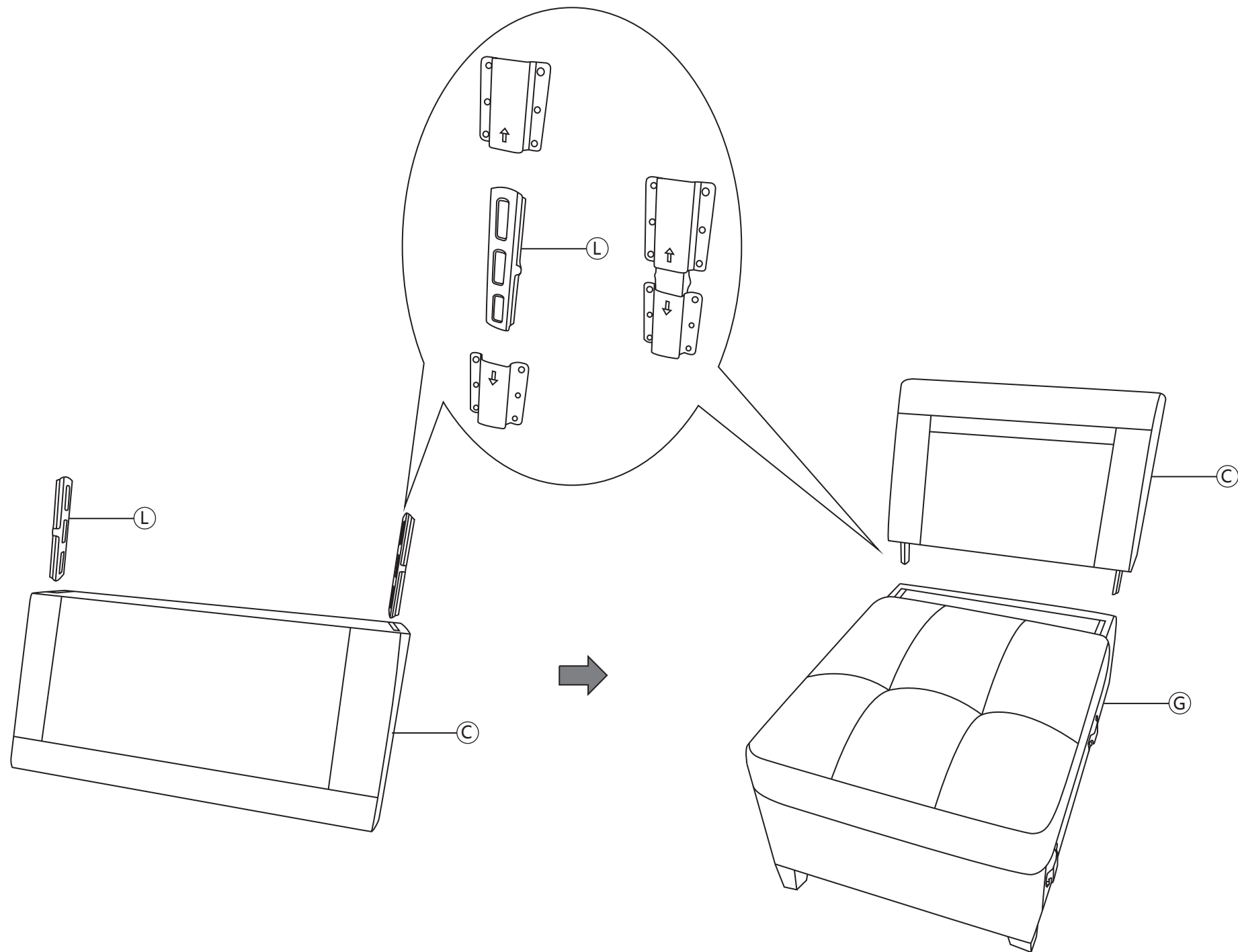

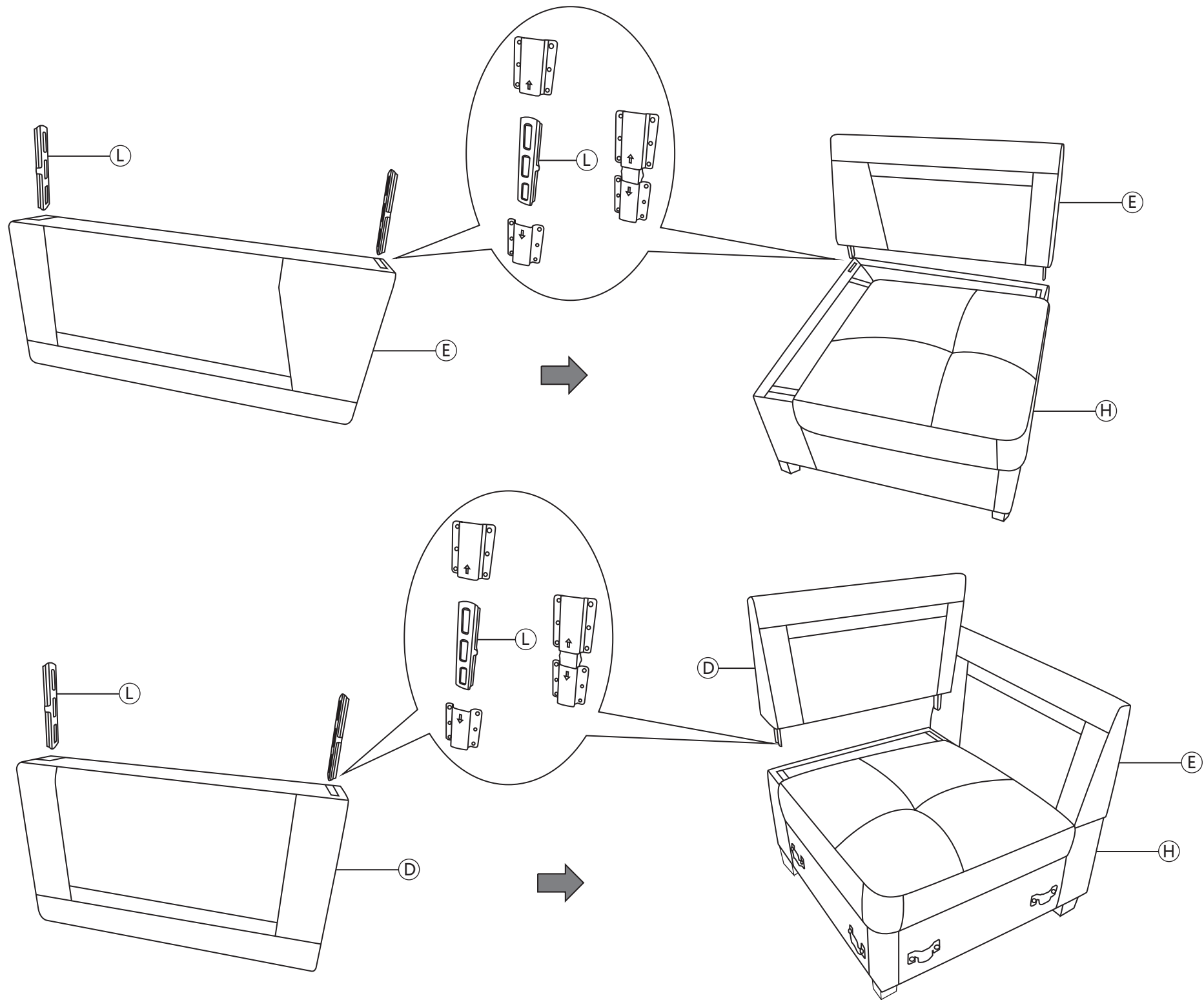

STOP 3

Connect the individual seat to the whole one by aligning the metal grooves fixed on the side of seats

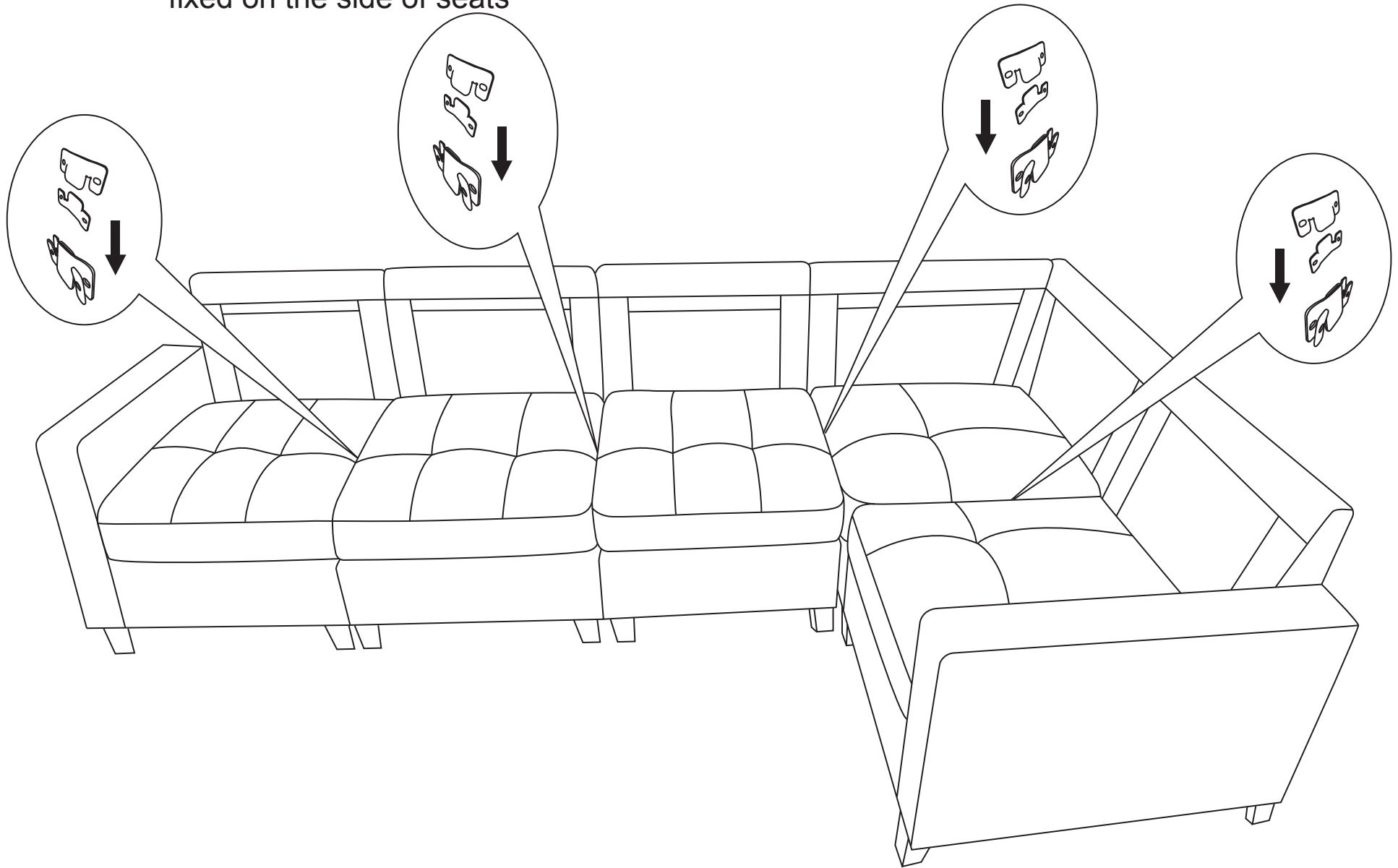

STOP 4

Put the back cushions on the backrests accordingly.

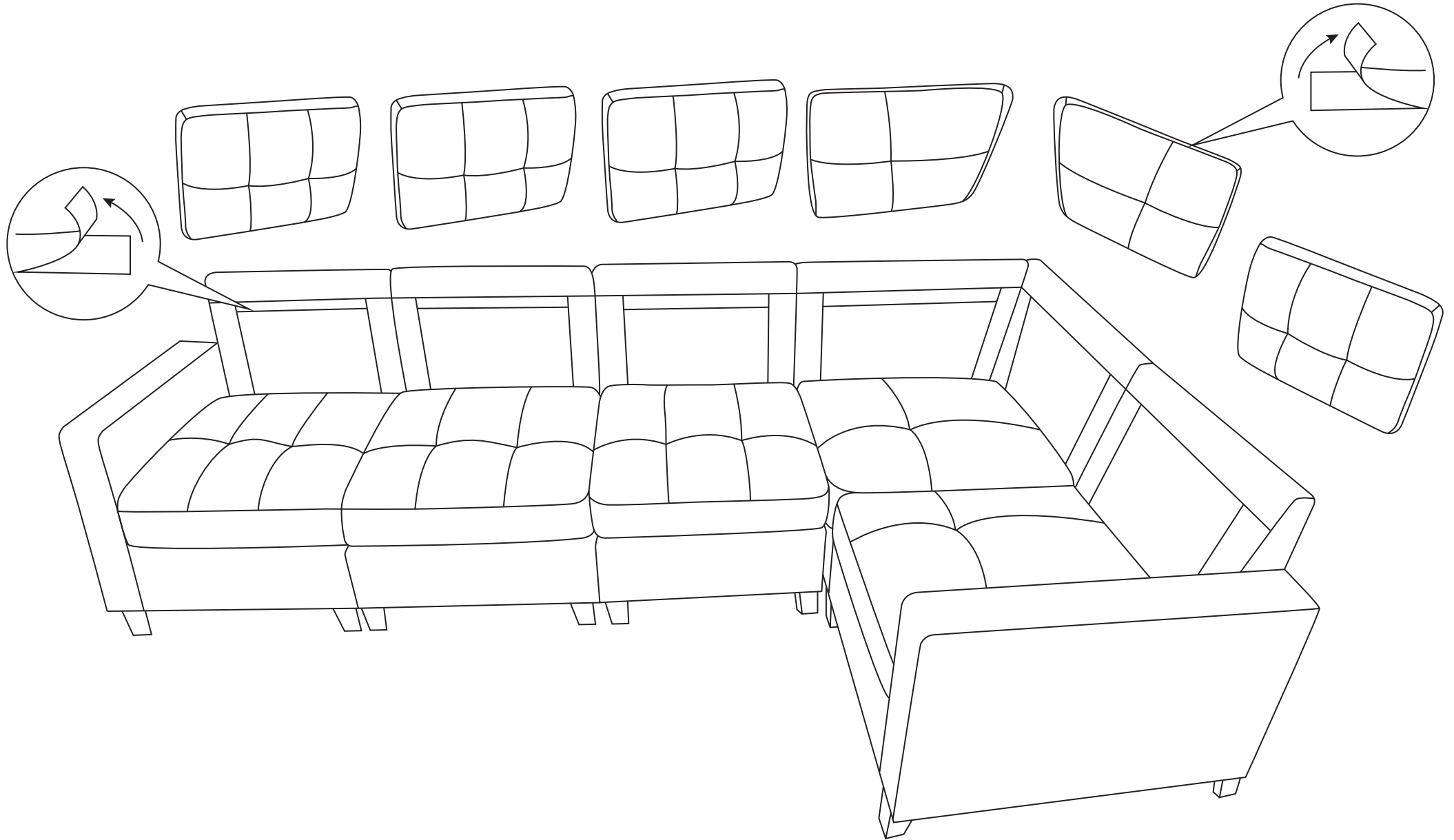

Finish!

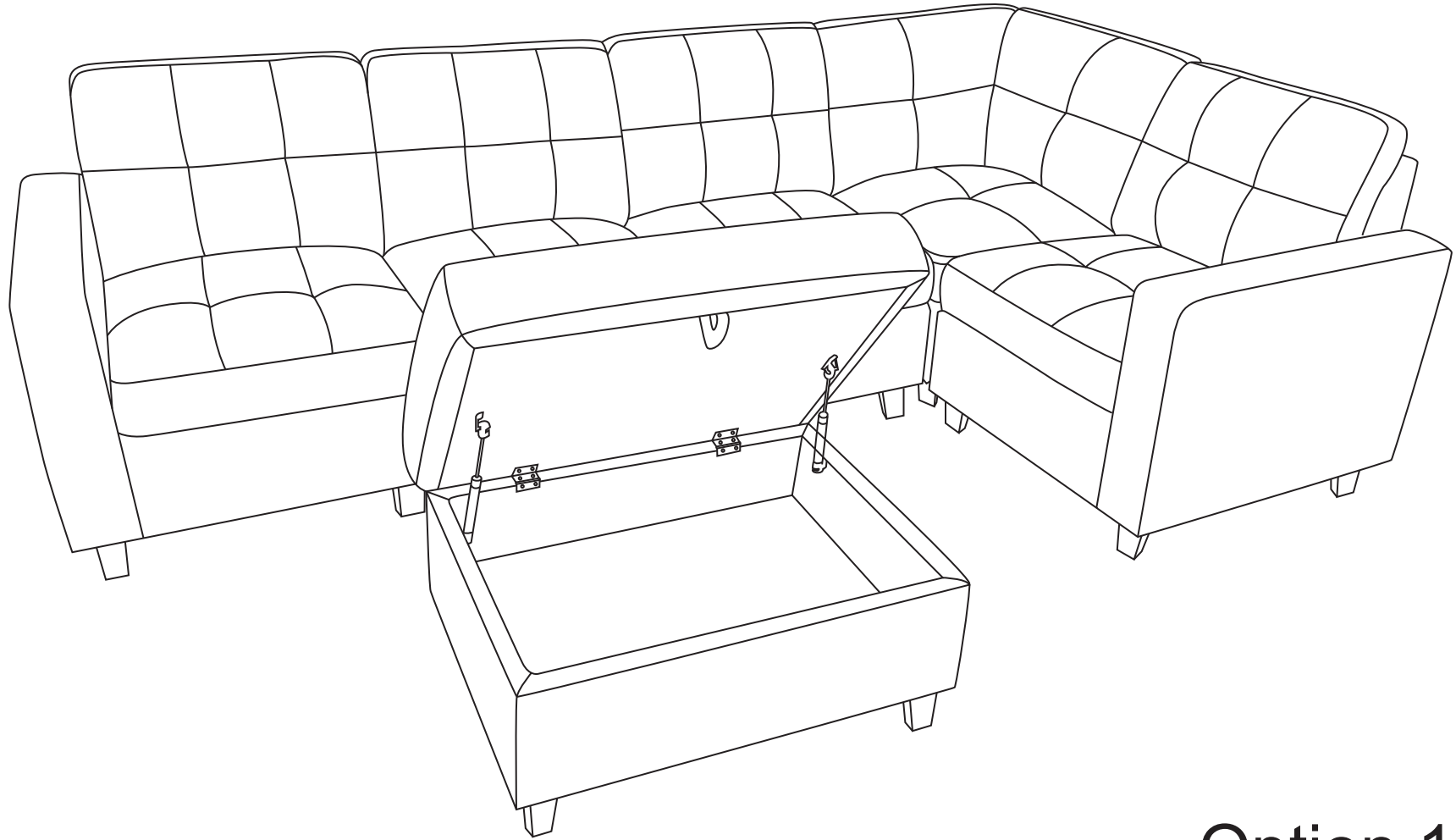

Option 1

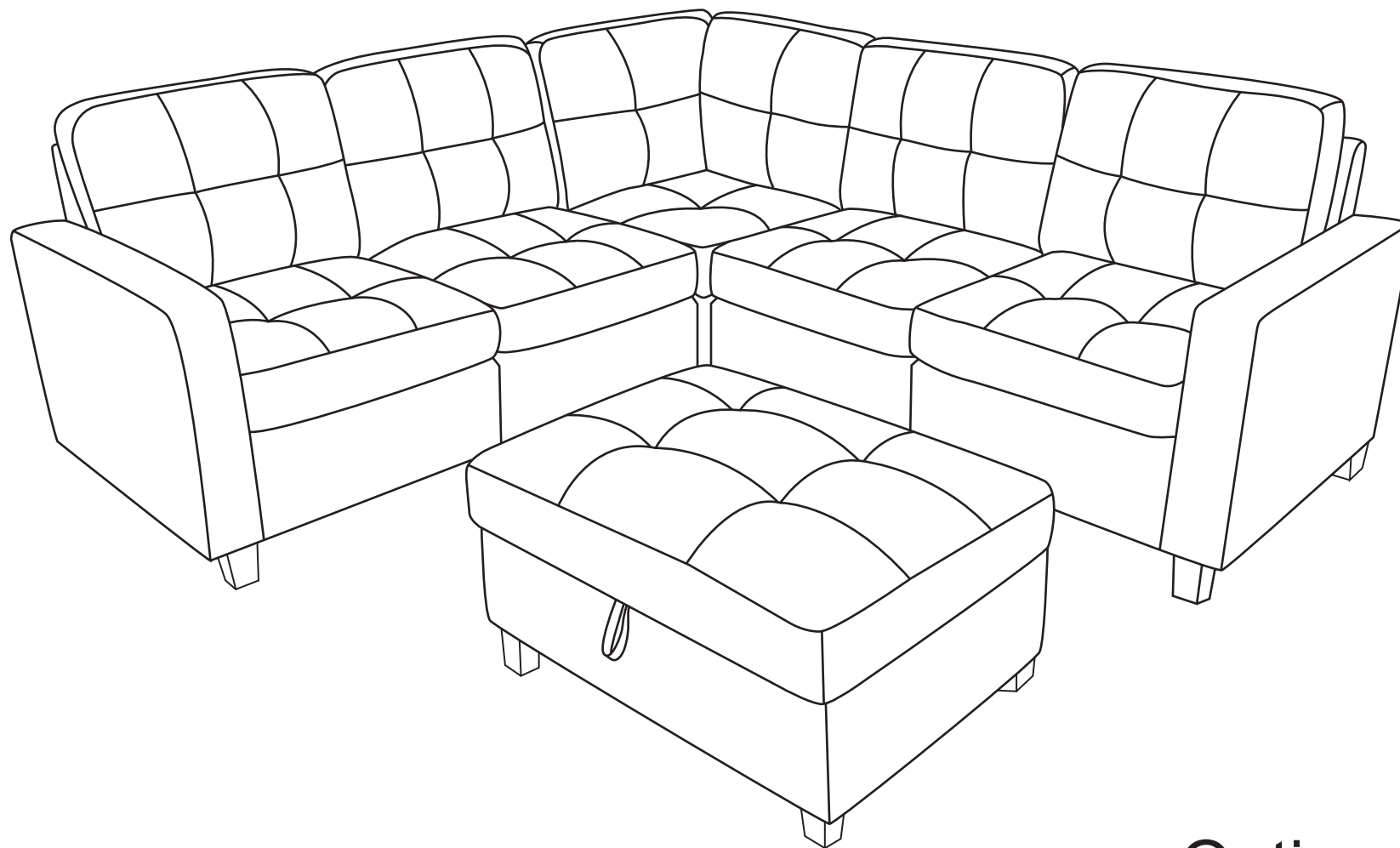

Option 2