

# Multifunctional storage

## Assembly Instructions

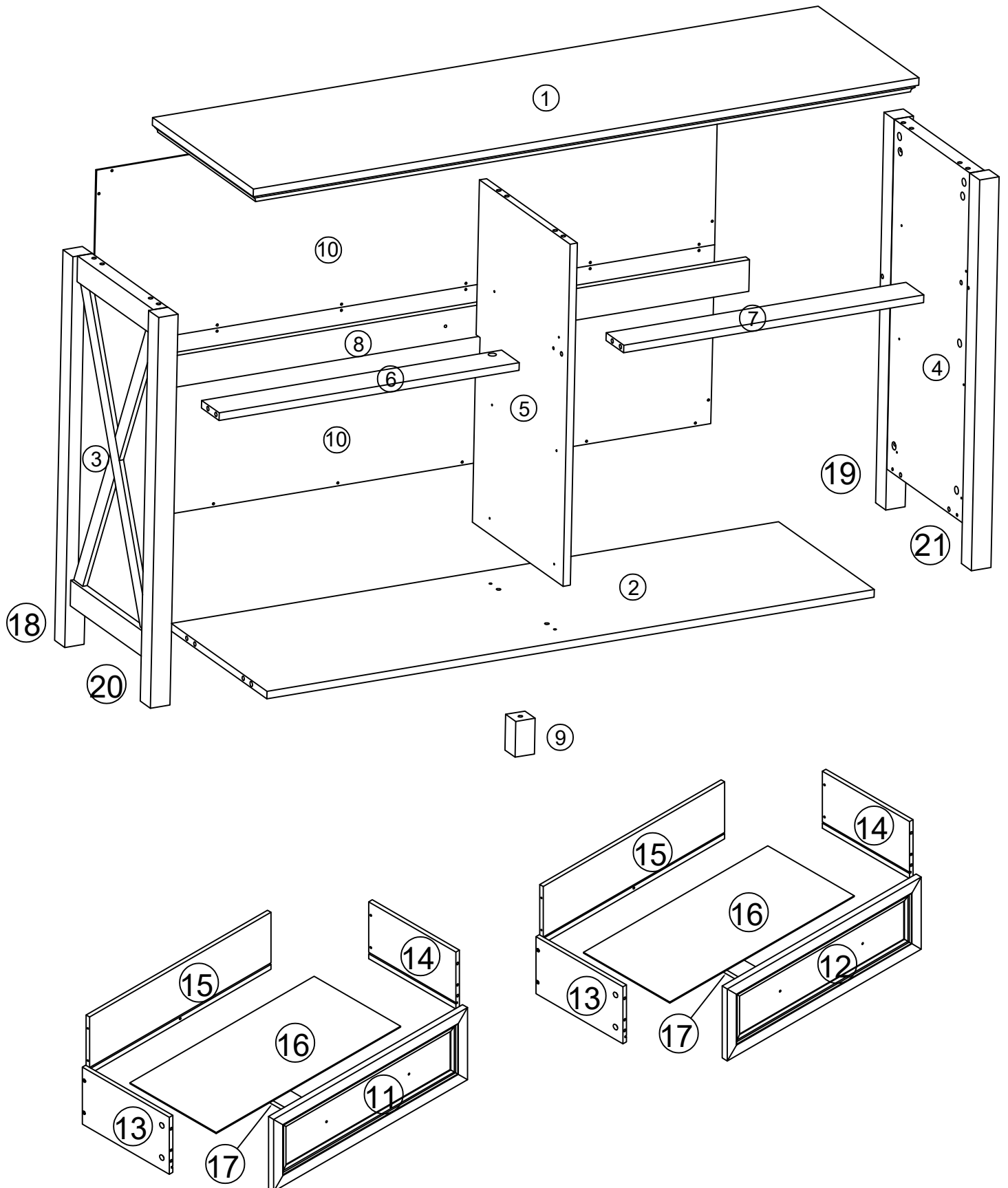

# Parts List



## Components

	.....	① x1
	.....	② x1
	.....	③ x1
	.....	④ x1
	.....	⑤ x1
	.....	⑥ x1
	.....	⑦ x1
	.....	⑧ x1
	.....	⑨ X1
	.....	⑩ x2
	.....	⑪ X3
	.....	⑫ X3
	.....	⑬ X6
	.....	⑭ X6
	.....	⑮ X6
	.....	⑯ X6
	.....	⑰ X6
	.....	⑱ X1
	.....	⑲ X1
	.....	⑳ X1
	.....	㉑ X1

## Screws & Tools

Ⓐ		X60+1
Ⓑ	Ø15 x 9mm	X60+1
Ⓒ	Ø8 x 30mm	X26+1
Ⓓ	Ø6 x 30mm	X12+1
Ⓔ	Ø3.5 x 35mm	X33+2
Ⓕ	Ø3.5 x 12m	X48+2
Ⓖ	Ø3.5 x 12m	X32+1
Ⓕ	300MM	X6sets
Ⓖ		X1sets
Ⓖ		X12
Ⓖ		X2
Ⓖ	M4X8mm	X12
Ⓖ	M6	X1
Ⓖ	M6X30mm	X1

Check all the components & screws before assembly.  
Do not install in case part is missing, contact us to get.  
Send email with your question to [support@idealhouse.vip](mailto:support@idealhouse.vip)  
We will resend within 24 hours

# How to use the cam lock system

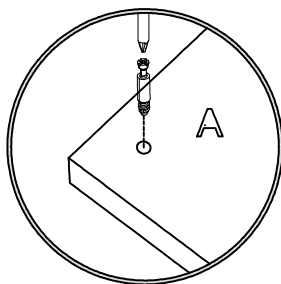

1. Screw cam bolt into panel

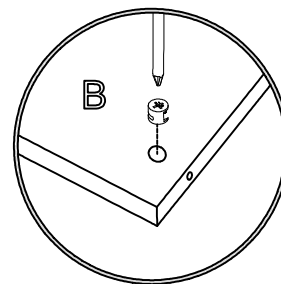

2. Push cam into panel - arrow feature on cam top points to panel edge

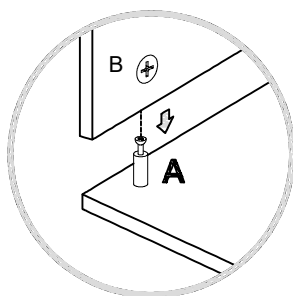

3. Align cam bolt(s) with cam(s) and insert all the way into cross-bored hole(s)

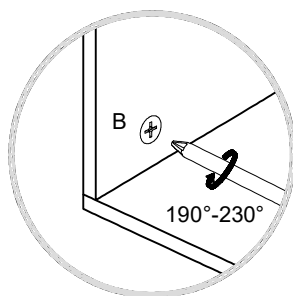

3. Rotate cam(s) clockwise 190°-230° to lock panels together

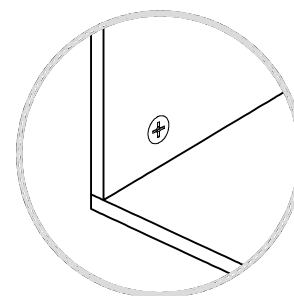

5. Panels should be tight against each other and connection should be rigid

**Insert the wood dowel [C] at least half way by tapping lightly with a rubber mallet ,IF NECESSARY.**

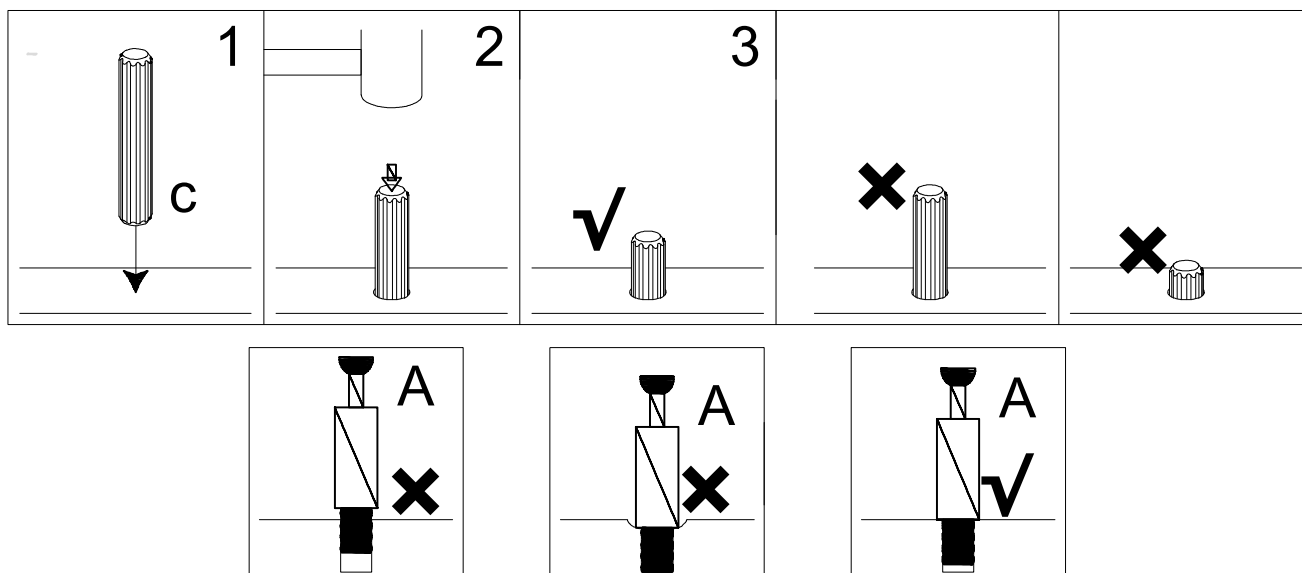

- Unit must be placed on a level surface or leveled with included hardware (when applicable).
- Do not sit or stand on or allow children to climb, sit or stand on the assembled product.
- For safety reasons, it is imperative that this unit be mounted to the wall.
- Do not use without installing the tip restraint.
- Unit can tip over causing severe injury or death.
- Do not exceed the recommended weight limits.
- Evenly distribute the weight on each level and always keep the heavier loads on the bottom.
- Before cutting, drilling or hammering into any wall or floor surface, verify the location of electrical, plumbing and gas lines. Cutting may cause serious injury.

## Ready to assemble the dresser

Before installation, observe each structure of the drawer dresser. The drawer dresser consists of two main parts. You will assemble the chest first, and then install the five drawers. Finally, look at the finished look, and contrast list of part, imagine how to install it faster, hope this will help you.

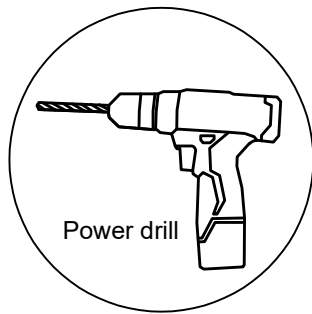

We recommend using a power drill to assemble。

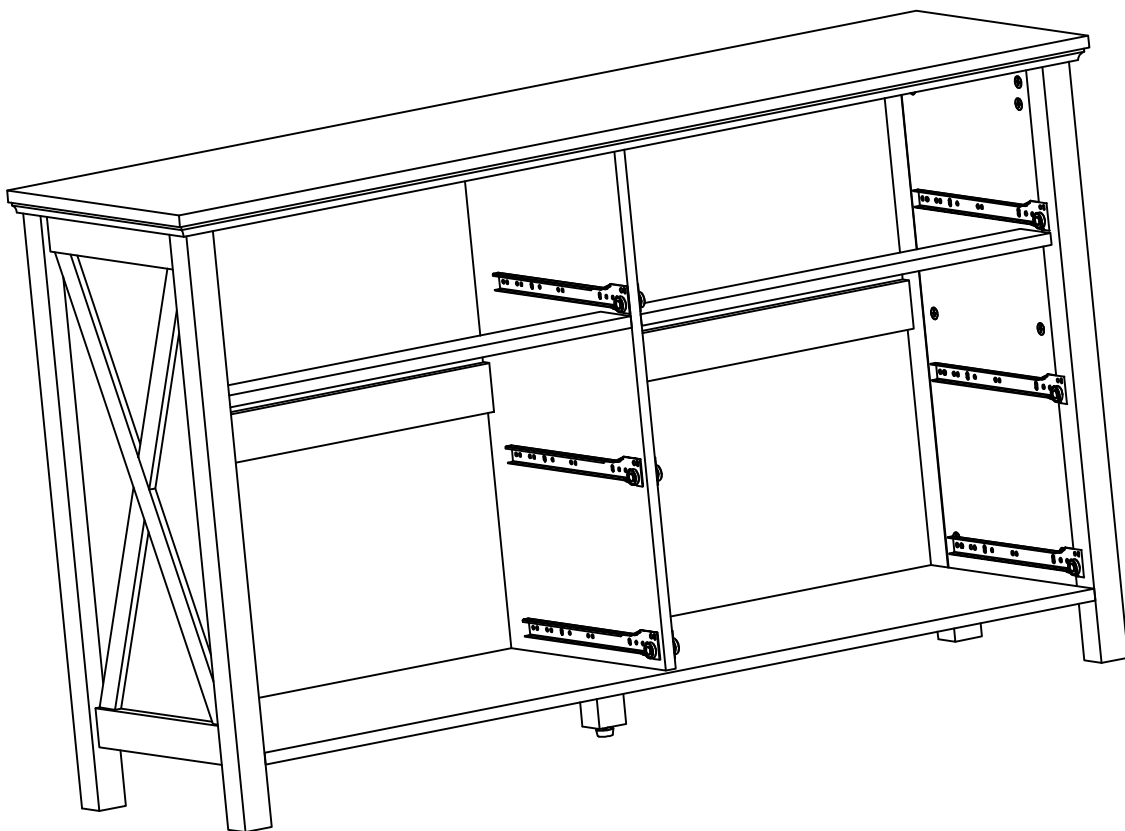

# Step 1

-Attach (A) to (18)&(19)&(20)&(21)

(A)

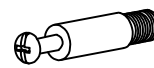

12X

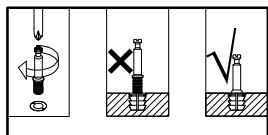

Tighten (A) clockwise until all of their threads are engaged.

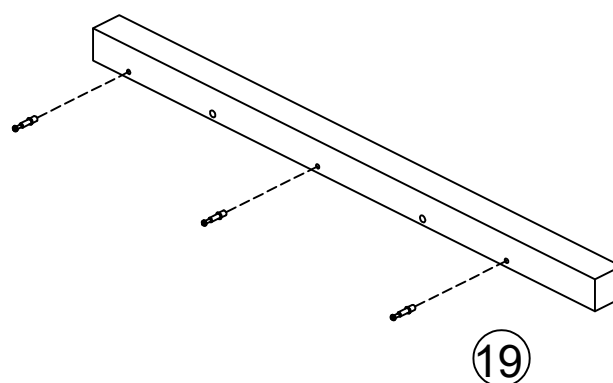
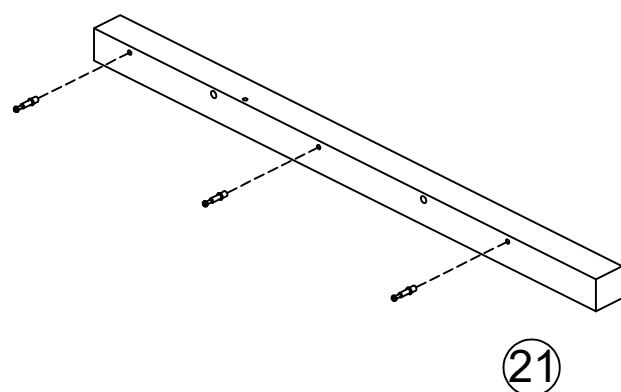
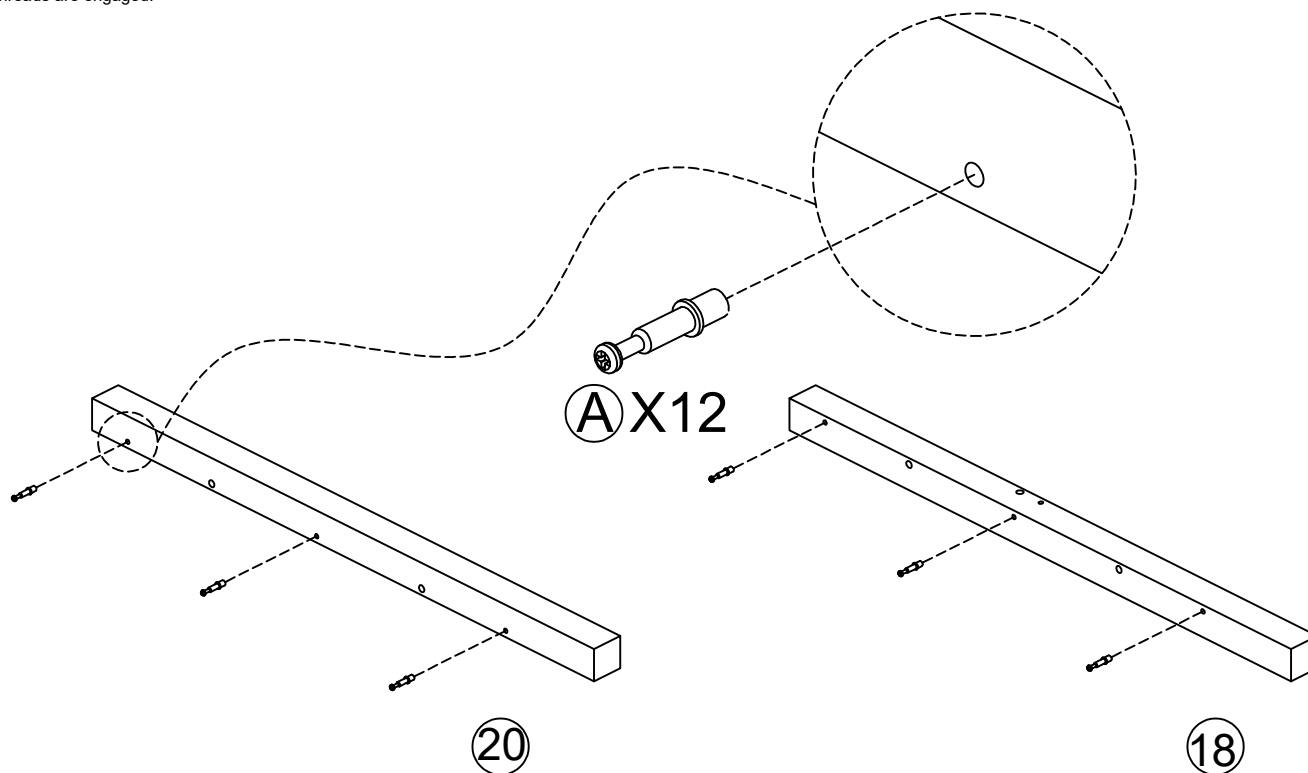

## Step 2

- Attach ③ to ④
- Attach ⑱ & ⑳ to ③ as below shown
- Attach ⑲ & ㉑ to ④ as below shown
- Screw ② to lock the ③ & ④ as below shown

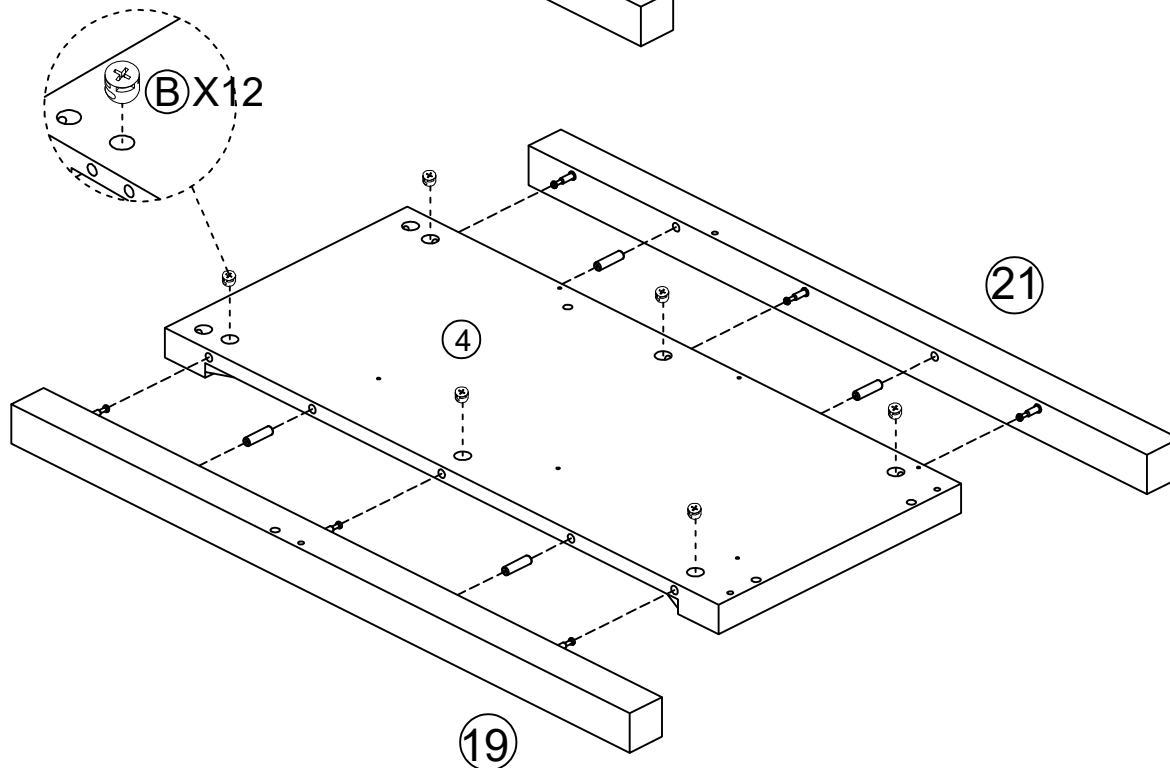
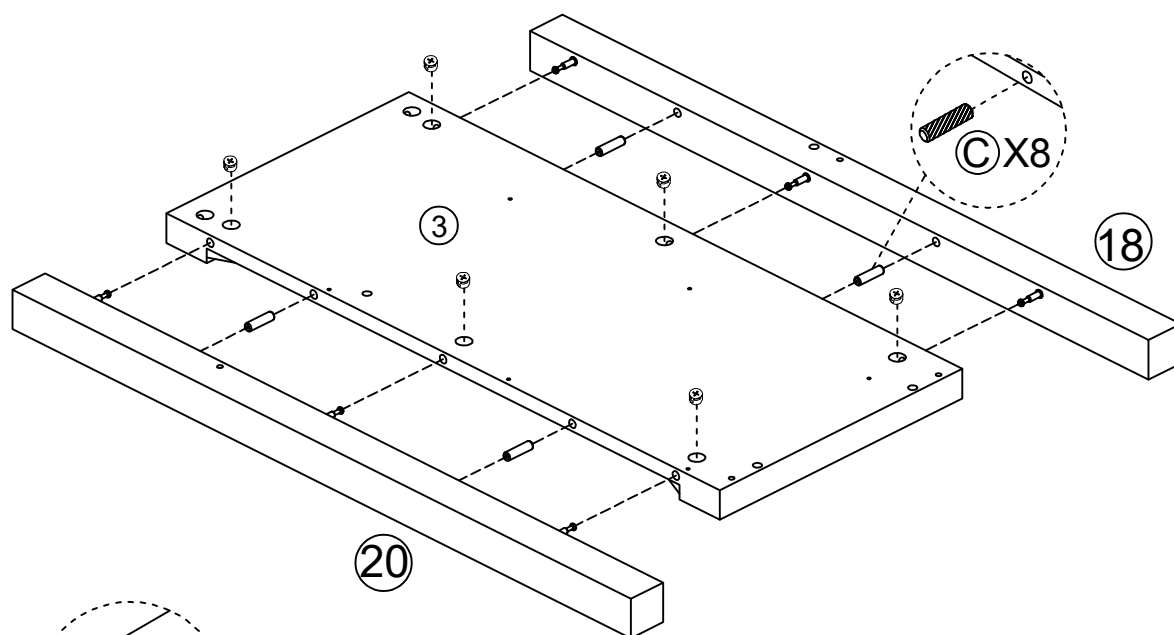
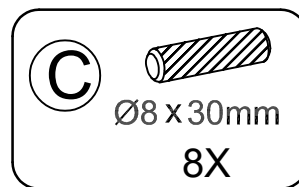
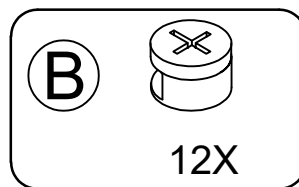

Warm Tips: Make sure the 4 large pre-drilled hole are on the upside  
③ & ④ holes should be in the same side.

## Step 3

-Attach ①A to ③ as below shown

-Install the drawer slides ①H on the left right side panel ③.

When building it make sure to take note of the drawer slides is the one with a flat end.

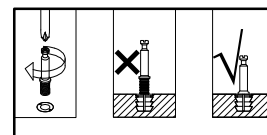

Tighten ①A clockwise until all of their threads are engaged.

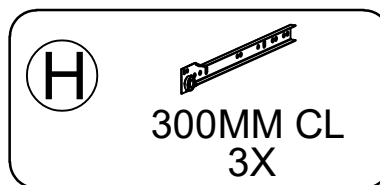
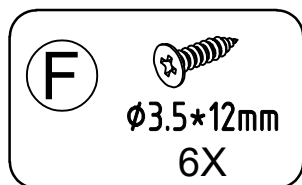
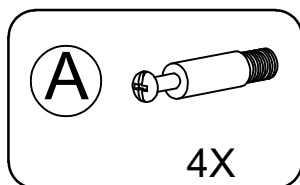

Make sure the 4 large pre-drilled hole are on the upside.

①F should be locked in the Second hole against the pulley.

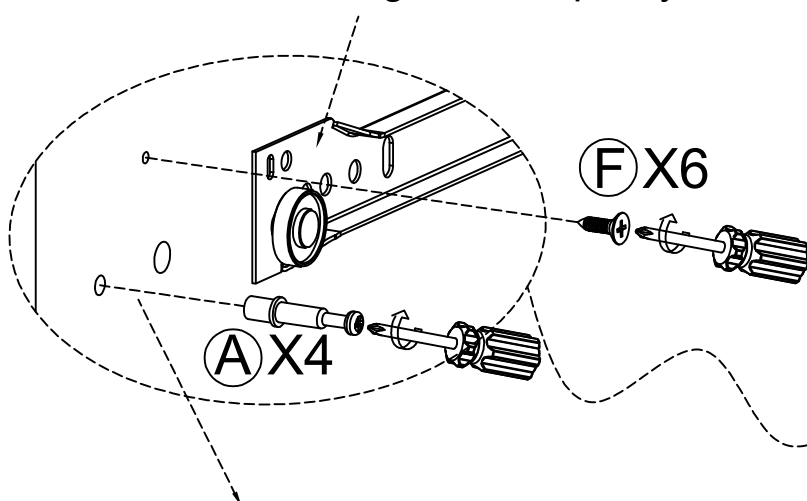

①F should be screw to the small holes

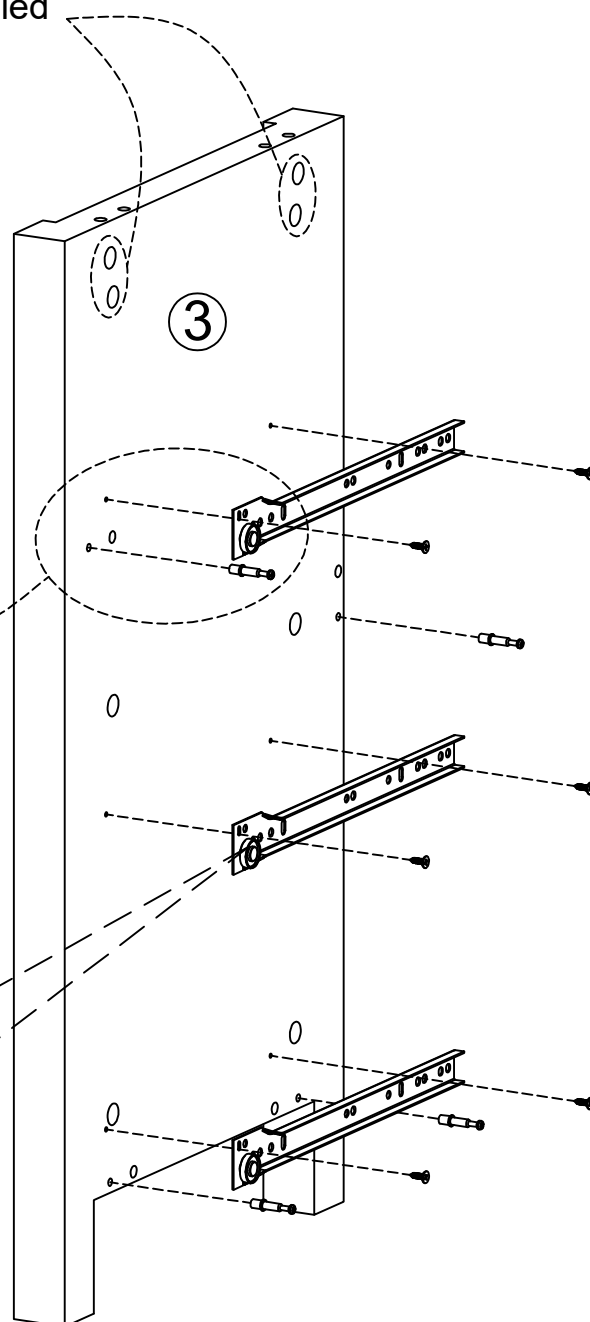
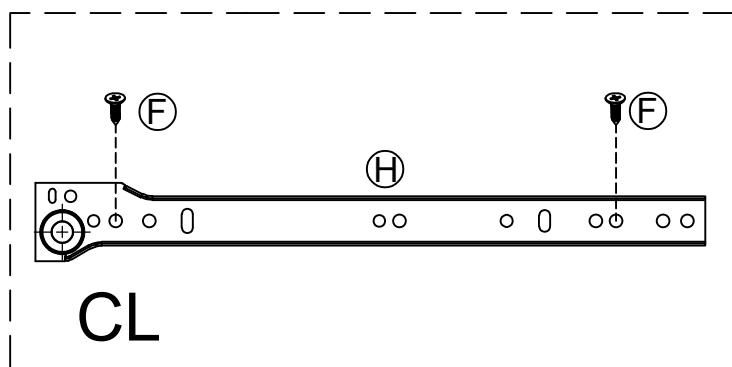



## Step 4

-Attach ① to ⑤ as below shown

-Install the drawer slides ⑧ on the left right side panel ⑤.

When building it make sure to take note of the drawer slides is the one with a flat end.

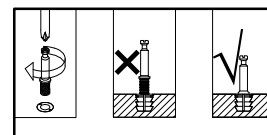

Tighten ① clockwise until all of their threads are engaged.

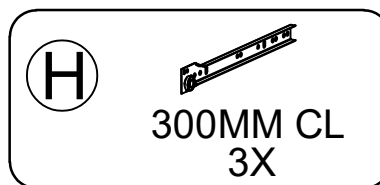
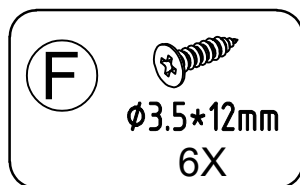
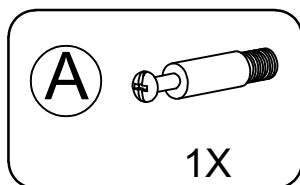

Make sure the 4 large pre-drilled hole are on the upside.

② should be locked in the Second hole against the pulley.

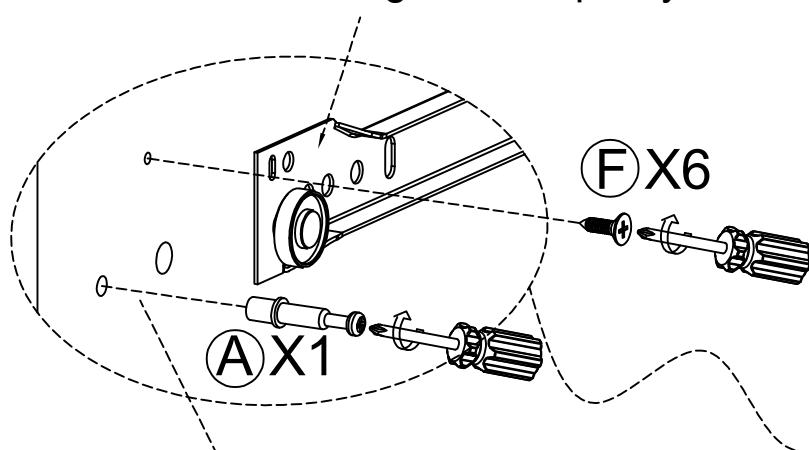

② should be screw to the small holes

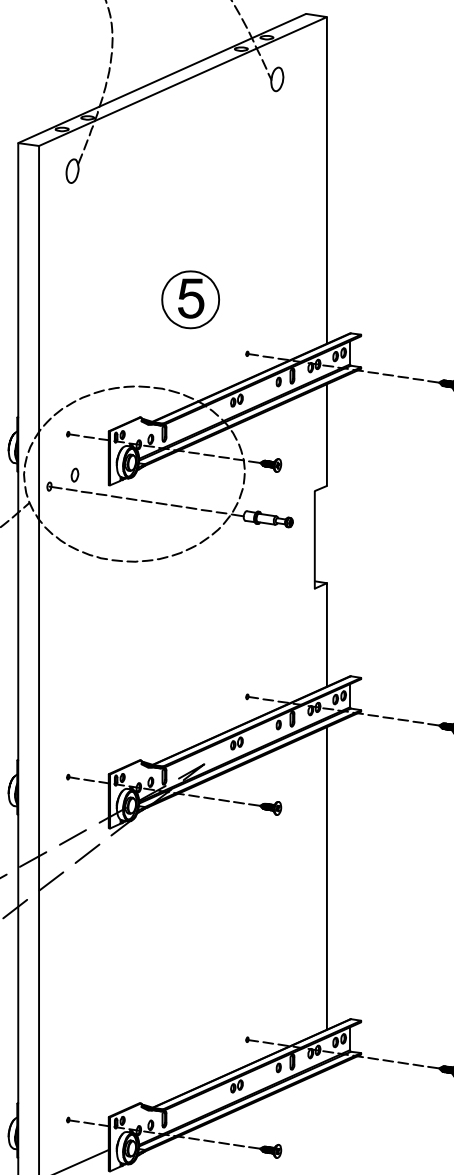
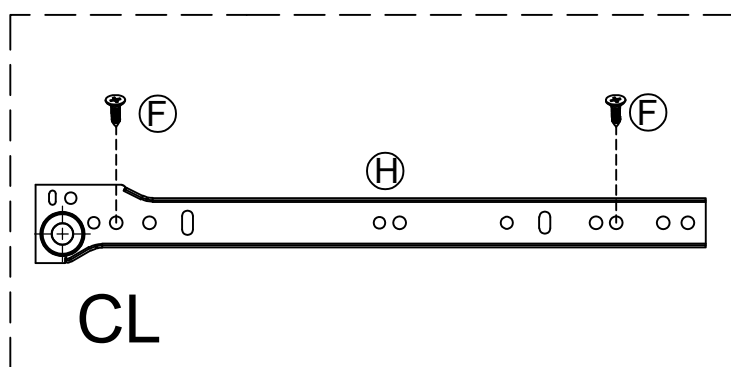

Install first rail on the right side of board ⑤ .

## Step 5

-Attach ① to ⑤ as below shown

-Install the drawer slides ⑧ on the left right side panel ⑤.

When building it make sure to take note of the drawer slides is the one with a flat end.

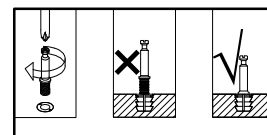

Tighten ① clockwise until all of their threads are engaged.

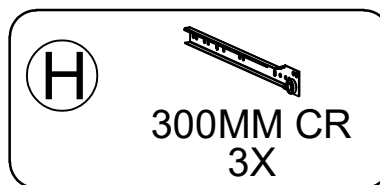
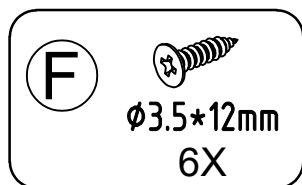
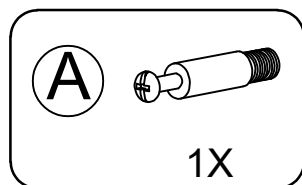

Make sure the 4 large pre-drilled hole are on the upside.

② should be locked in the first hole against the pulley.

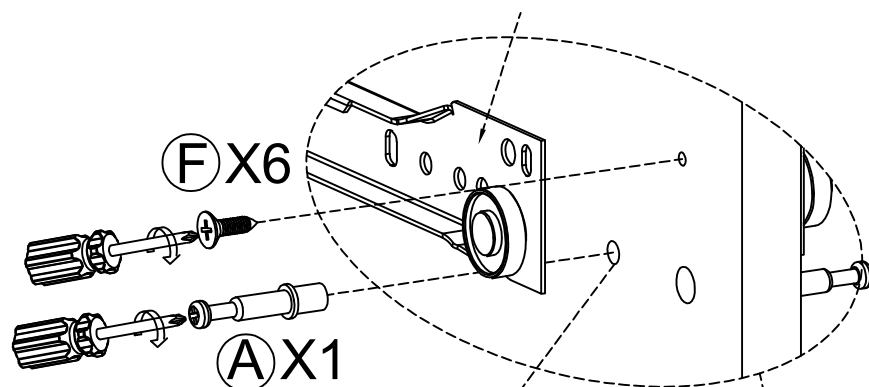

② should be screw to the small holes

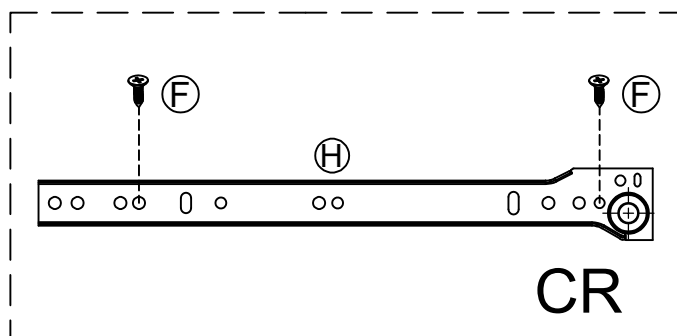

Install second rail on the left side of board ⑤.

## Step 6

-Attach ①A to ④ as below shown

-Install the drawer slides ①H on the left right side panel ④.

When building it make sure to take note of the drawer slides is the one with a flat end.

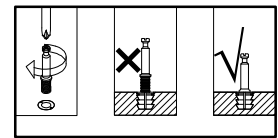

Tighten ①A clockwise until all of their threads are engaged.

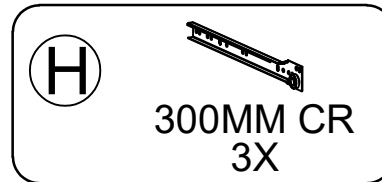
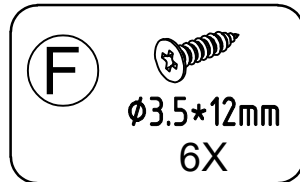
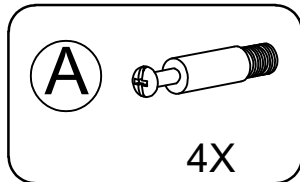

Make sure the 4 large pre-drilled hole are on the upside.

①F should be locked in the second hole against the pulley.

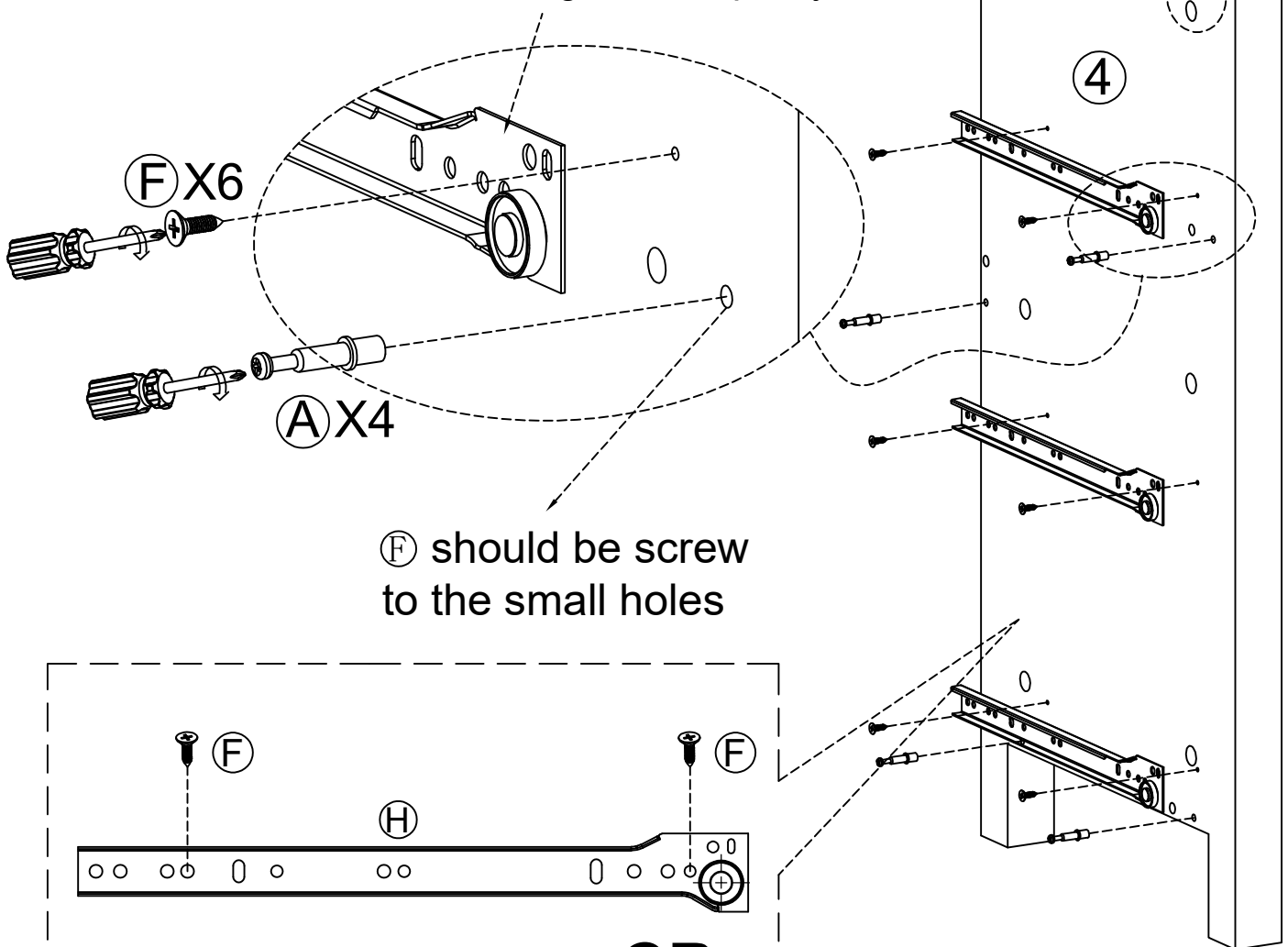

①F should be screw to the small holes

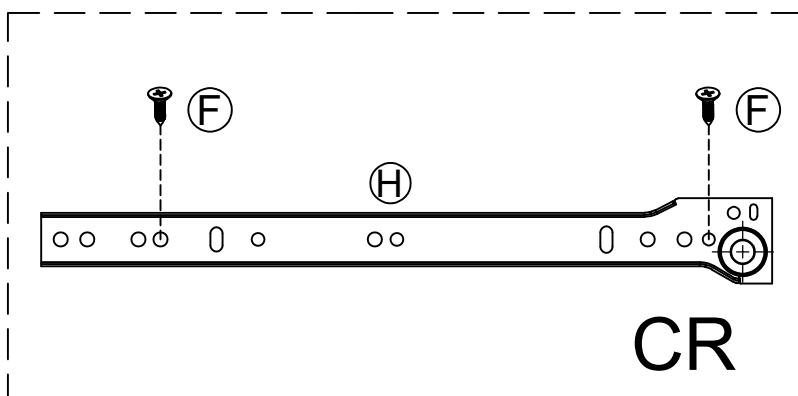

## Step 7

- Attach ②&⑦&⑧ to ⑤ as below shown
- Stick ⑤ to ⑧&⑤, use ① locked
- Stick ⑤ to ②&⑤, use ① locked
- Screw ② to lock the ⑦ as below shown

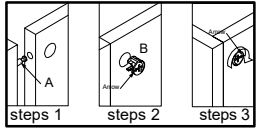
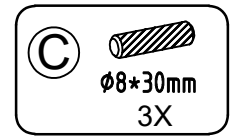
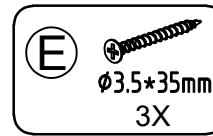
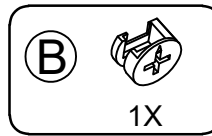

The two boards fit vertically, place (B) and match their holes with (A) then tighten (B) clockwise.

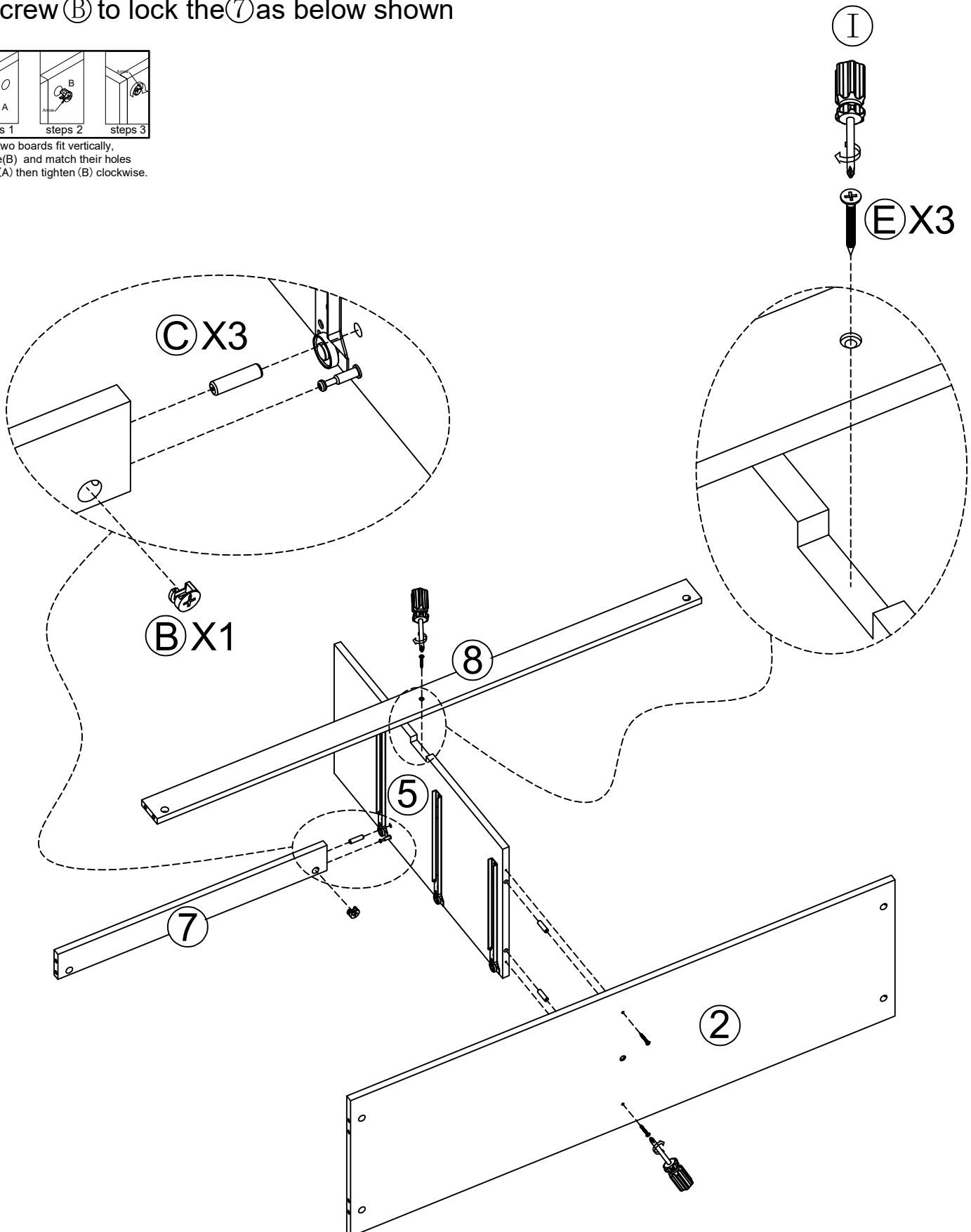

## Step 8

-Attach ⑥ to ⑤ as below shown

-Screw ③ to lock the ⑥ as below shown

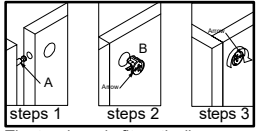

The two boards fit vertically, place (B) and match their holes with (A) then tighten (B) clockwise.

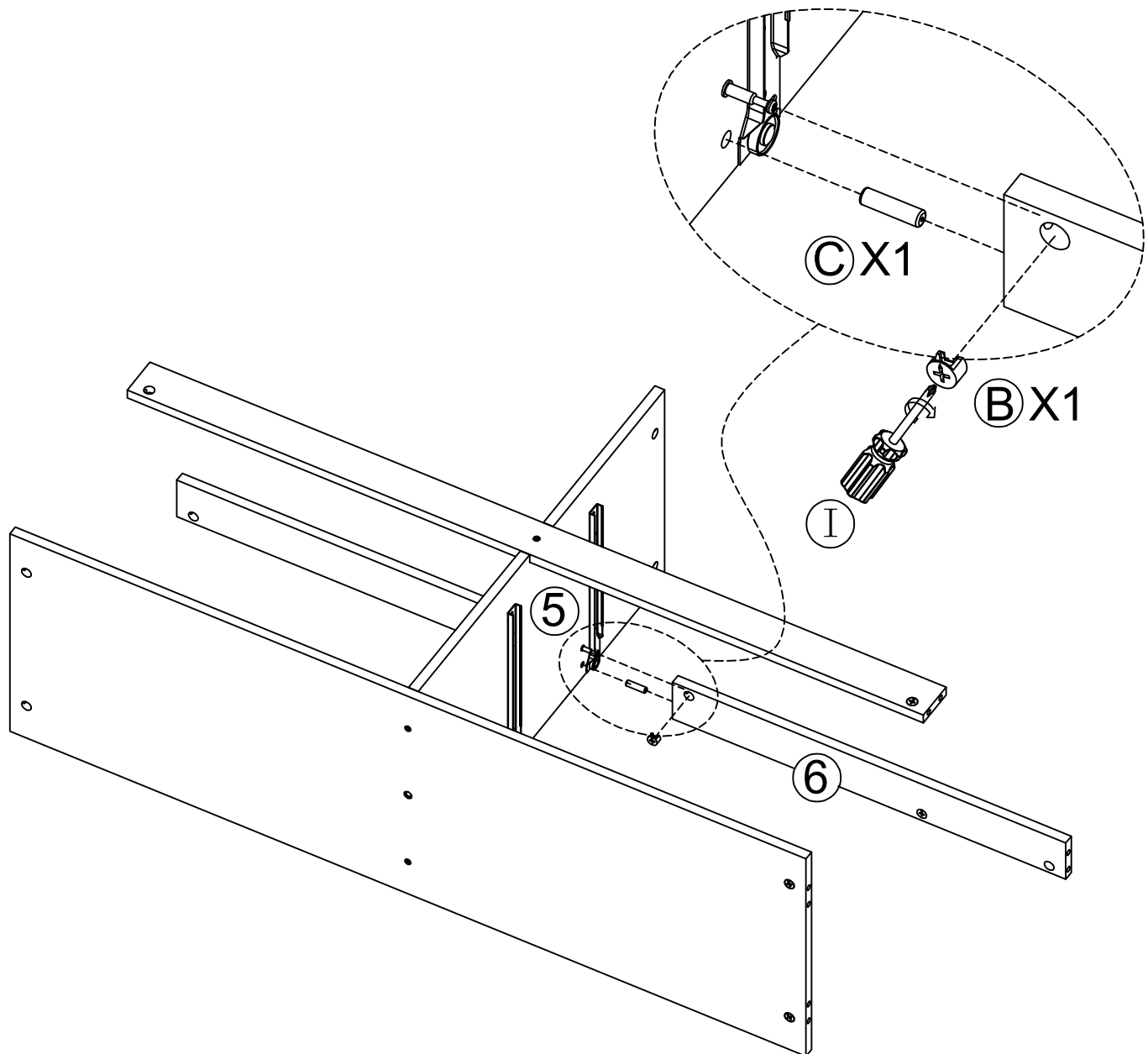
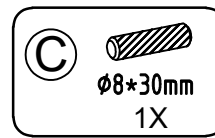
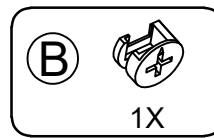

## Step 9

-Attach ③ to ②&⑥&⑧ as below shown

-Screw ① to lock the ②&⑥&⑧ as below shown

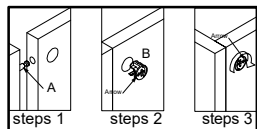

The two boards fit vertically, place (B) and match their holes with (A) then tighten (B) clockwise.

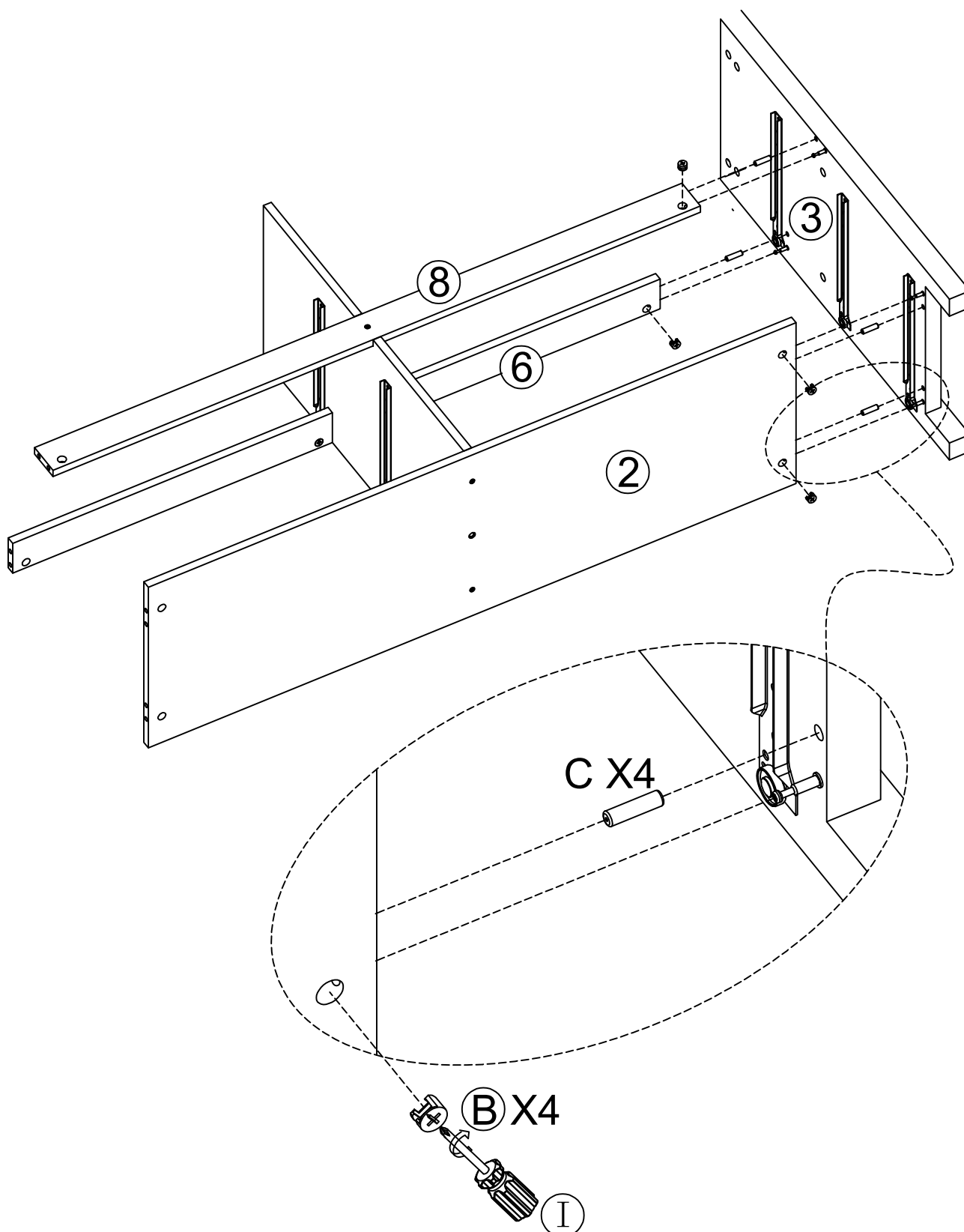
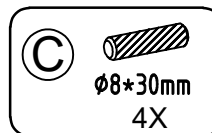
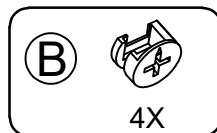

# Step 10

-Attach ④ to ②&⑦&⑧ as below shown

-Screw ① to lock the ②&⑦&⑧ as below shown

-Stick ① to ②&⑨, use ① locked

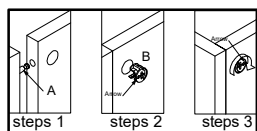
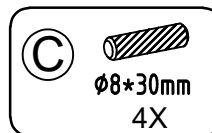
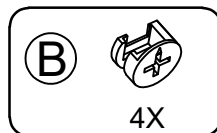

The two boards fit vertically, place ② and match their holes with ① then tighten ② clockwise.

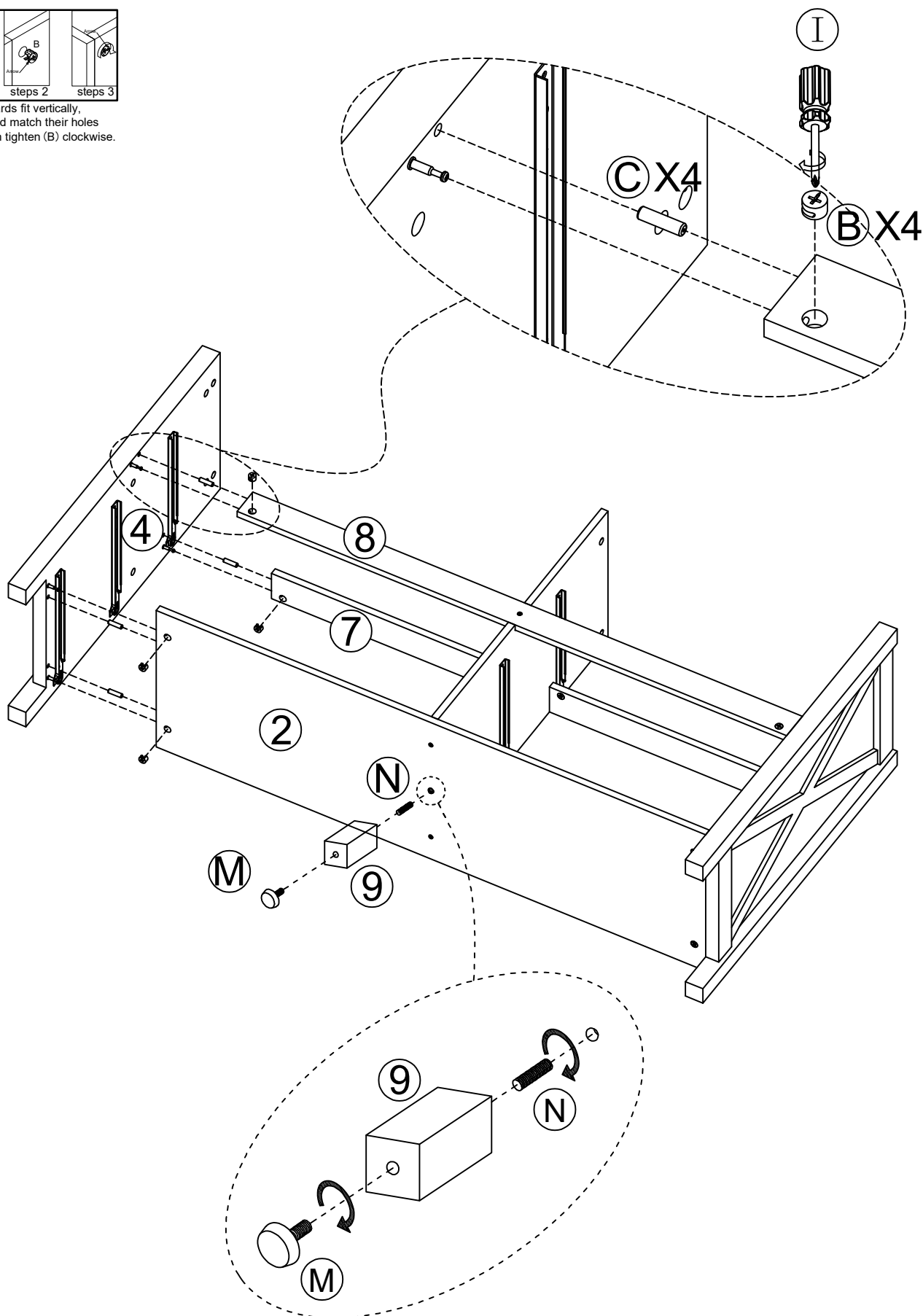

## Step 11

-attach (A) to ① as below shown

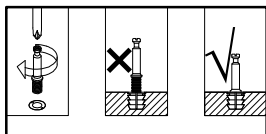

Tighten (A) clockwise until all of their threads are engaged.

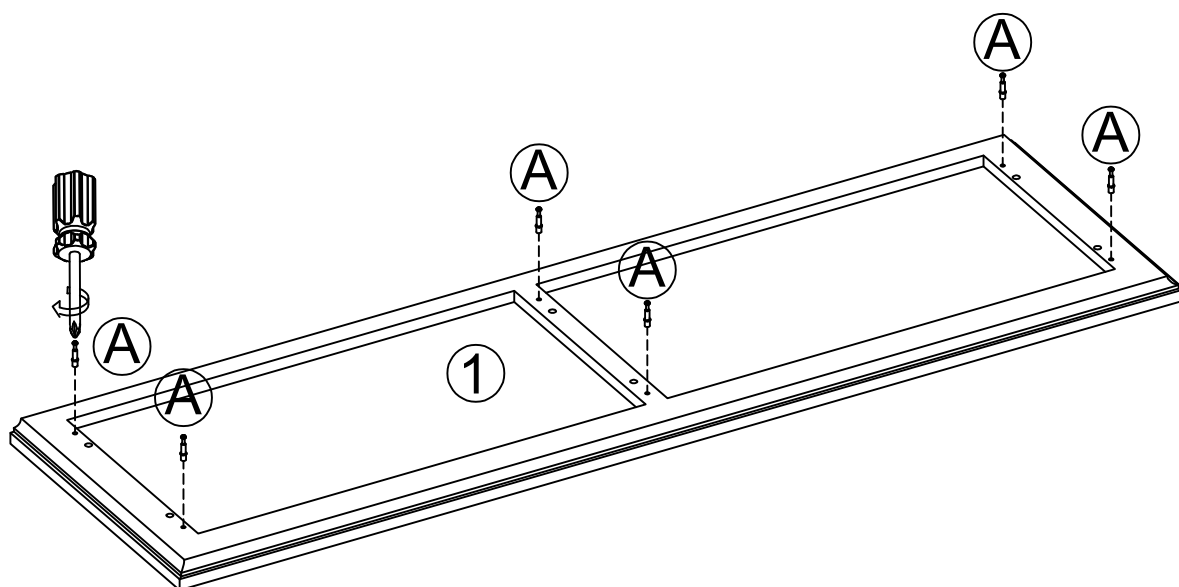
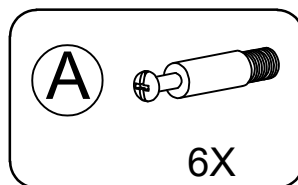



## Step 12

-Attach ① to ③ & ④ & ⑤ as below shown

-Screw ② to lock the ① as below shown

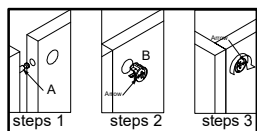

The two boards fit vertically, place (B) and match their holes with (A) then tighten (B) clockwise.

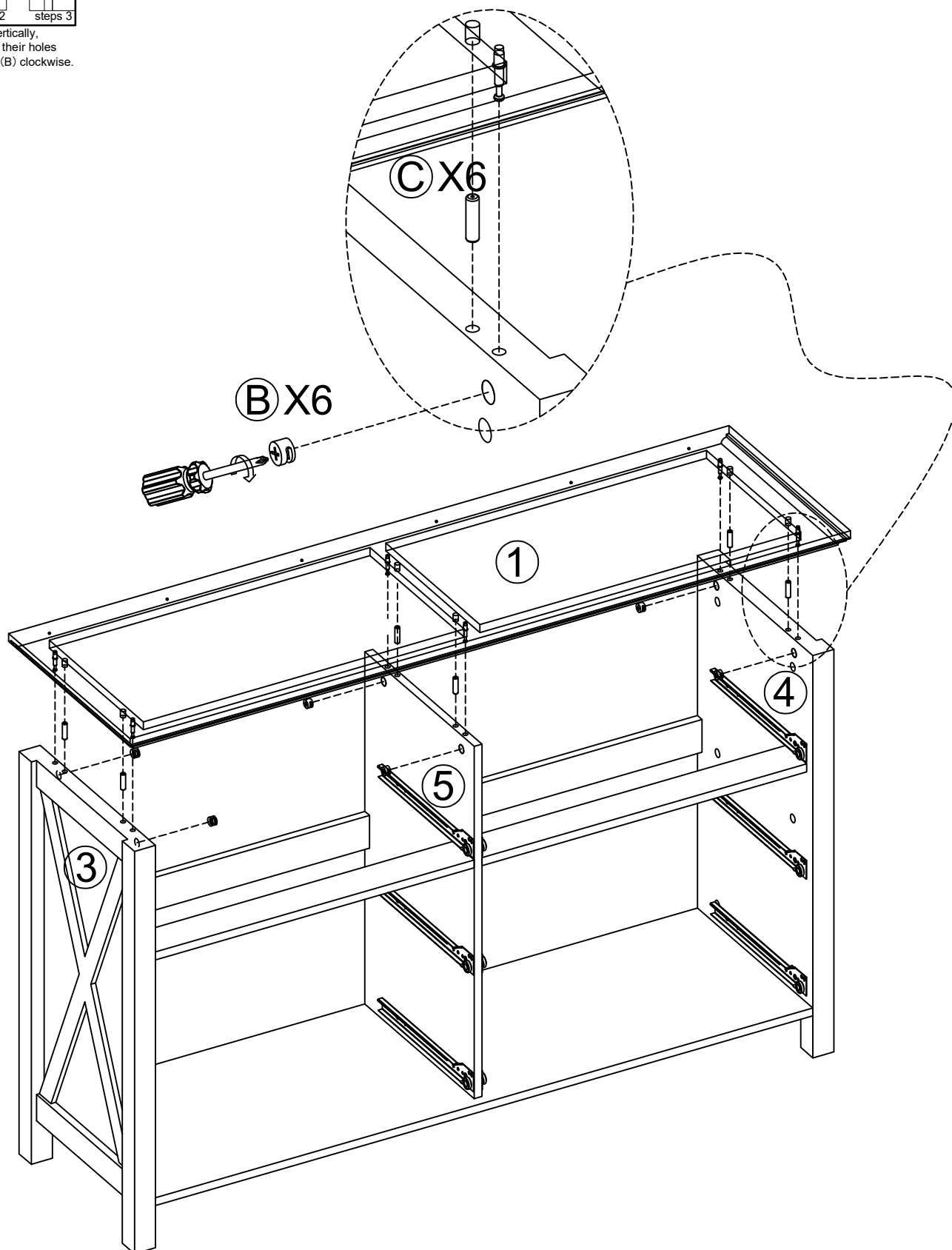
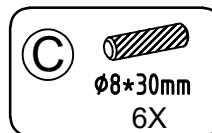
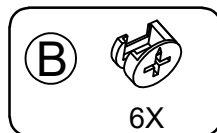

## Step 13

-Screw ⑥ to Back panel ⑩ as below shown

-Stick ⑦ to ① & ⑩, use ⑧ locked

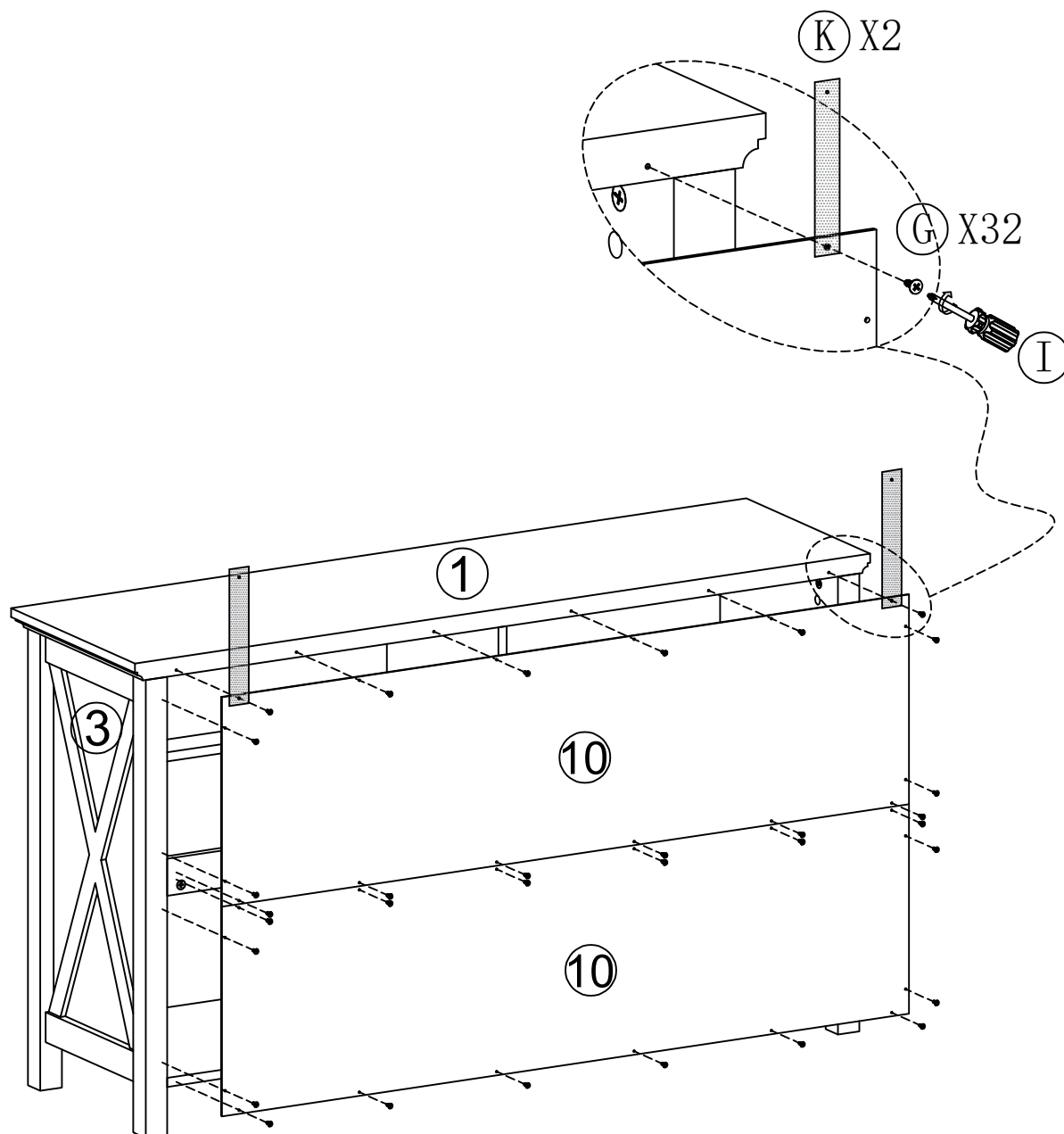
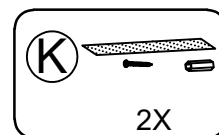
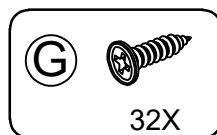

Warm Tips: 1:It is recommended to put the product upside down  
When installing the back panel.

2:It is recommended to attach the back panel ⑩ at  
the top panel ① first

## Step 14

- Screw (A) to (11)/(12) as below shown
- Attach (13)&(14)&(17) to (11)/(12) as below shown
- Screw (B) to lock the (13)&(14)&(17) as blow show

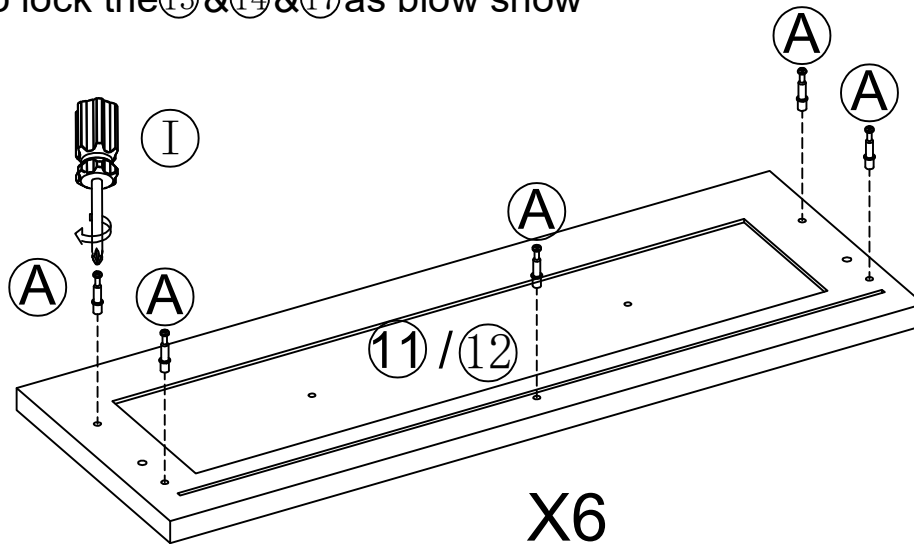
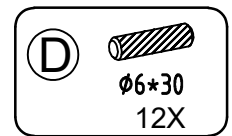
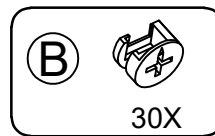
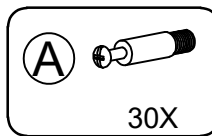

X6

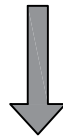

The long groove on the panel is used to install the bottom plate. Please make sure all grooves of these boards are on the same side.

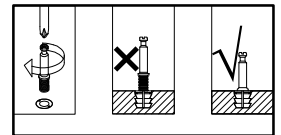

Tighten (A) clockwise until all of their threads are engaged.

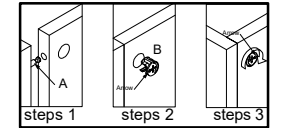

The two boards fit vertically, place (B) and match their holes with (A) then tighten (B) clockwise.

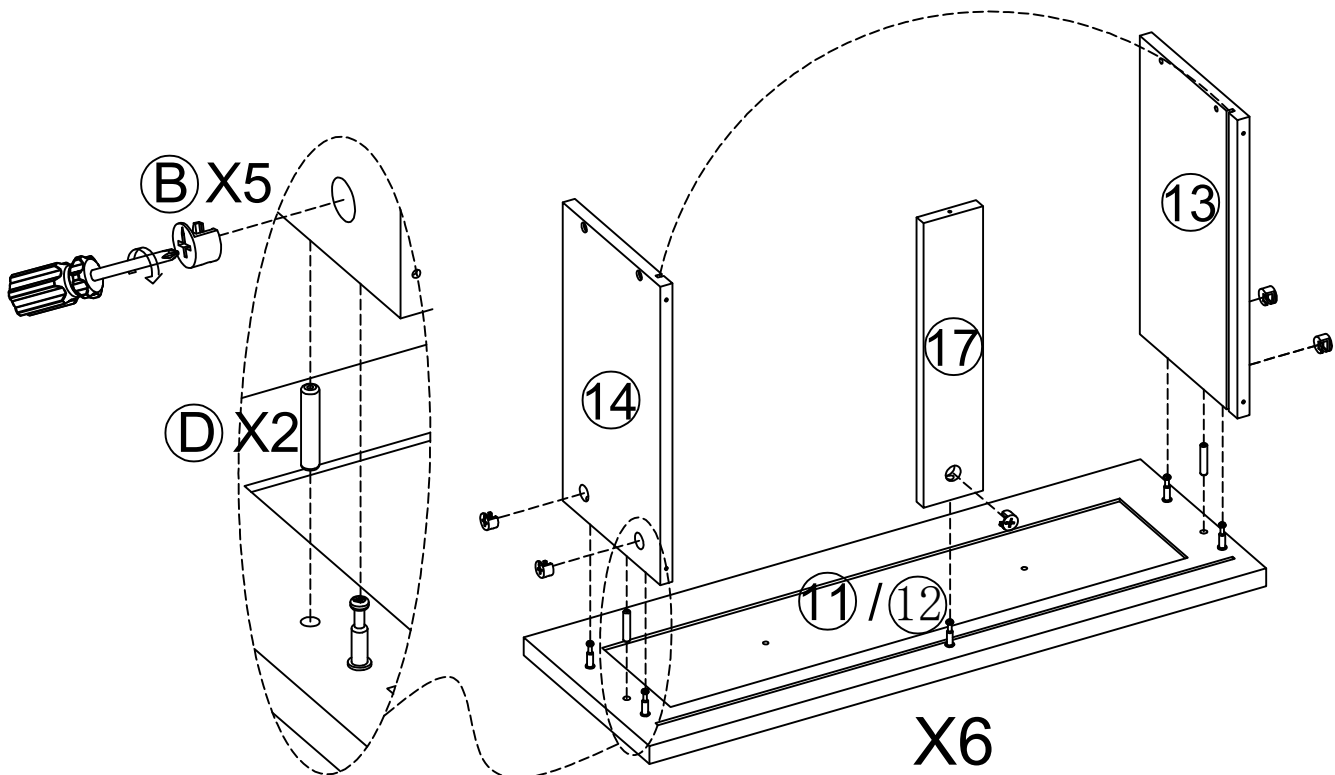

## Step 15

-Attach ⑮&⑯ to ⑬&⑭ as below shown

-Screw ⑮ to attach ⑬& ⑭& ⑮ to ⑮& ⑰ as below shown

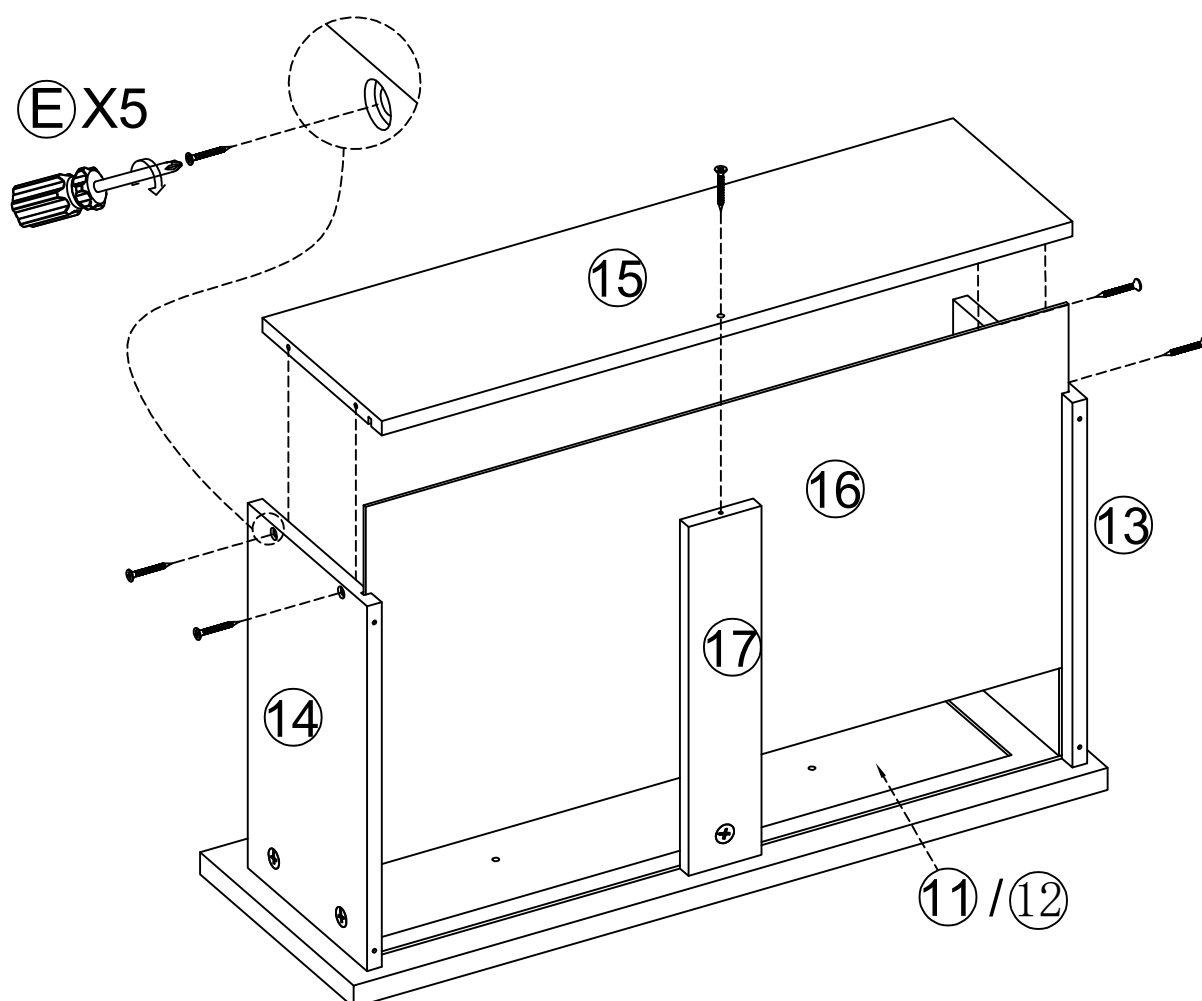
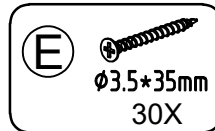

X6

## Step 16

-Screw ① & ② to ① / ② attach as below shown

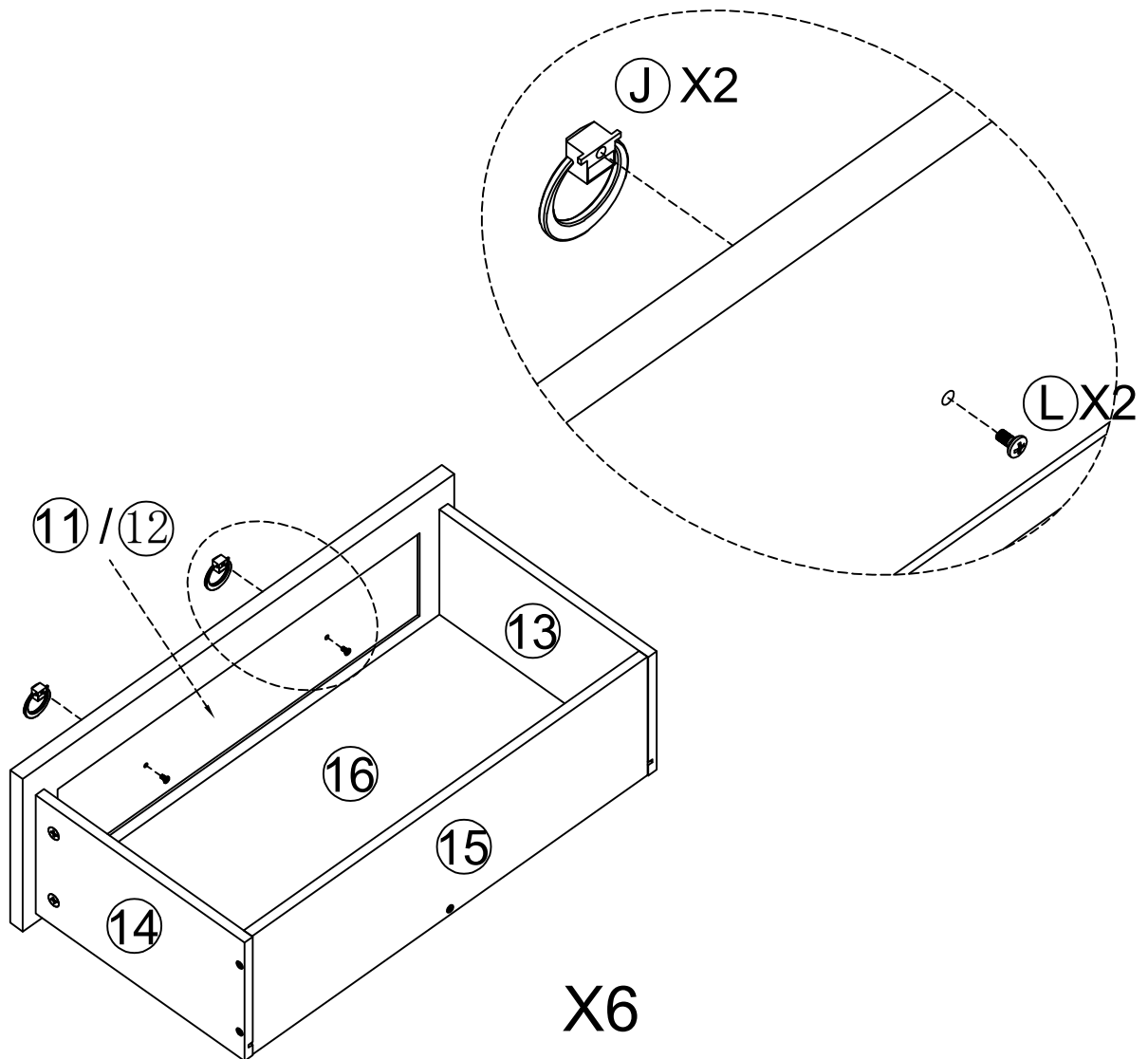
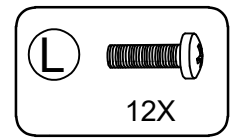
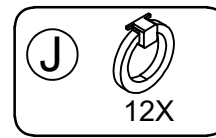

## Step 17

-Install the drawer slides (H) on the drawer side panels (13) & (14) as below shown

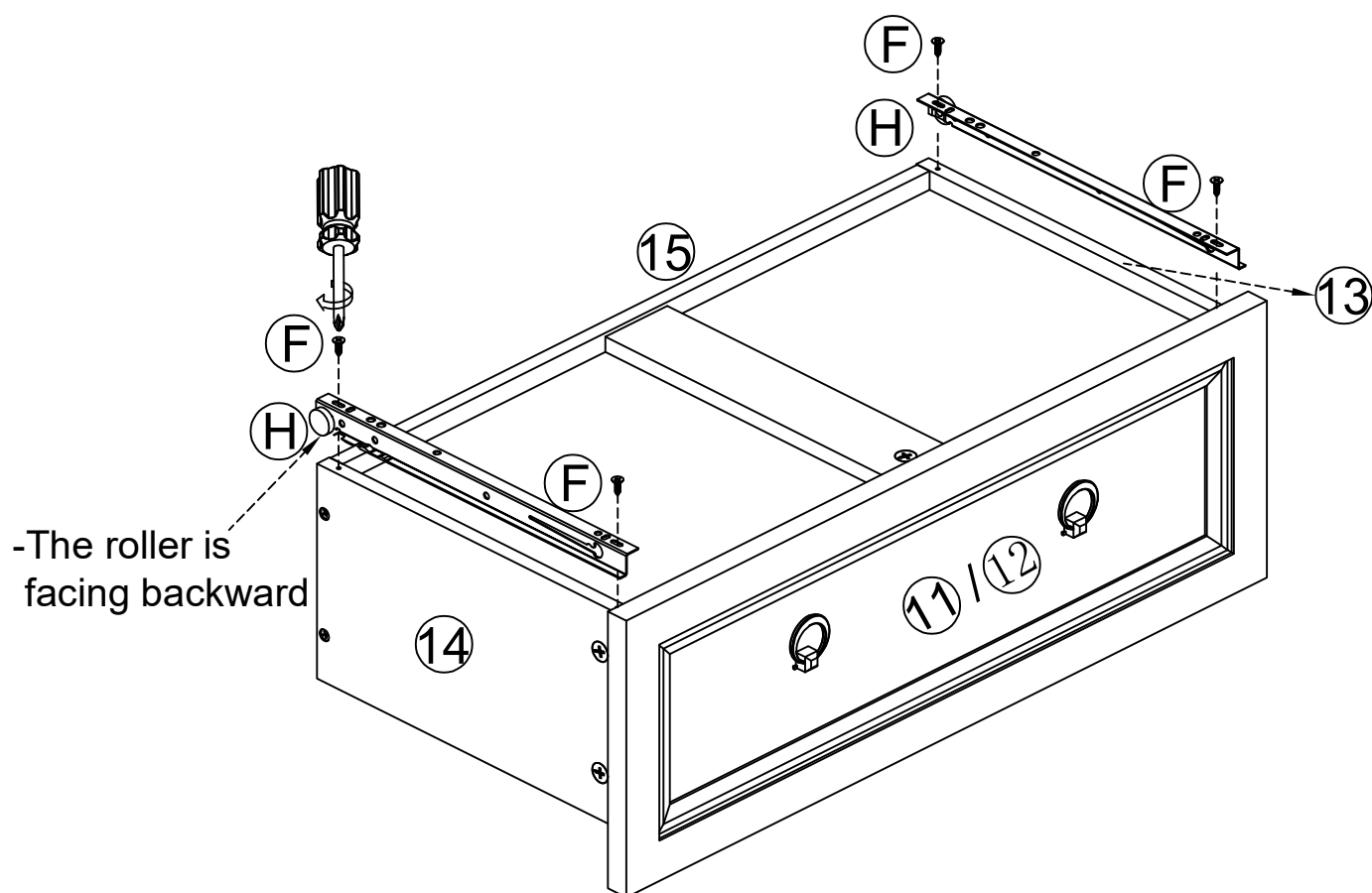
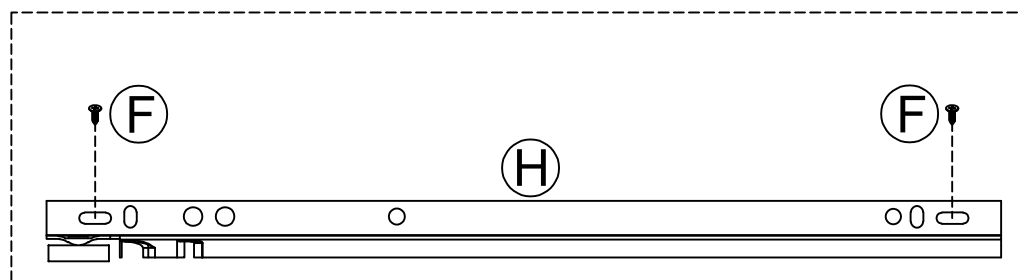
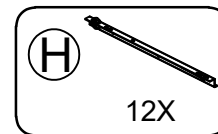
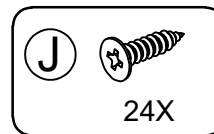

X6

-Repeat the previous step to install the remaining drawers

## Step 18

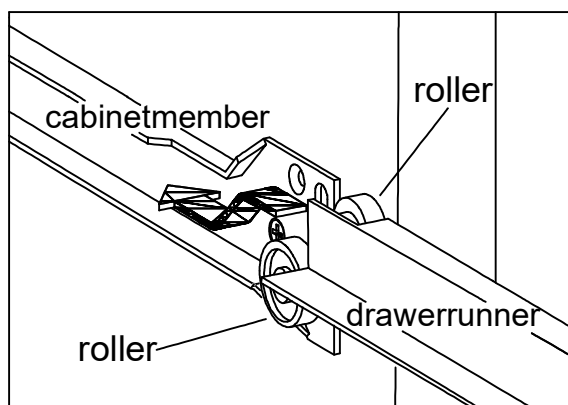
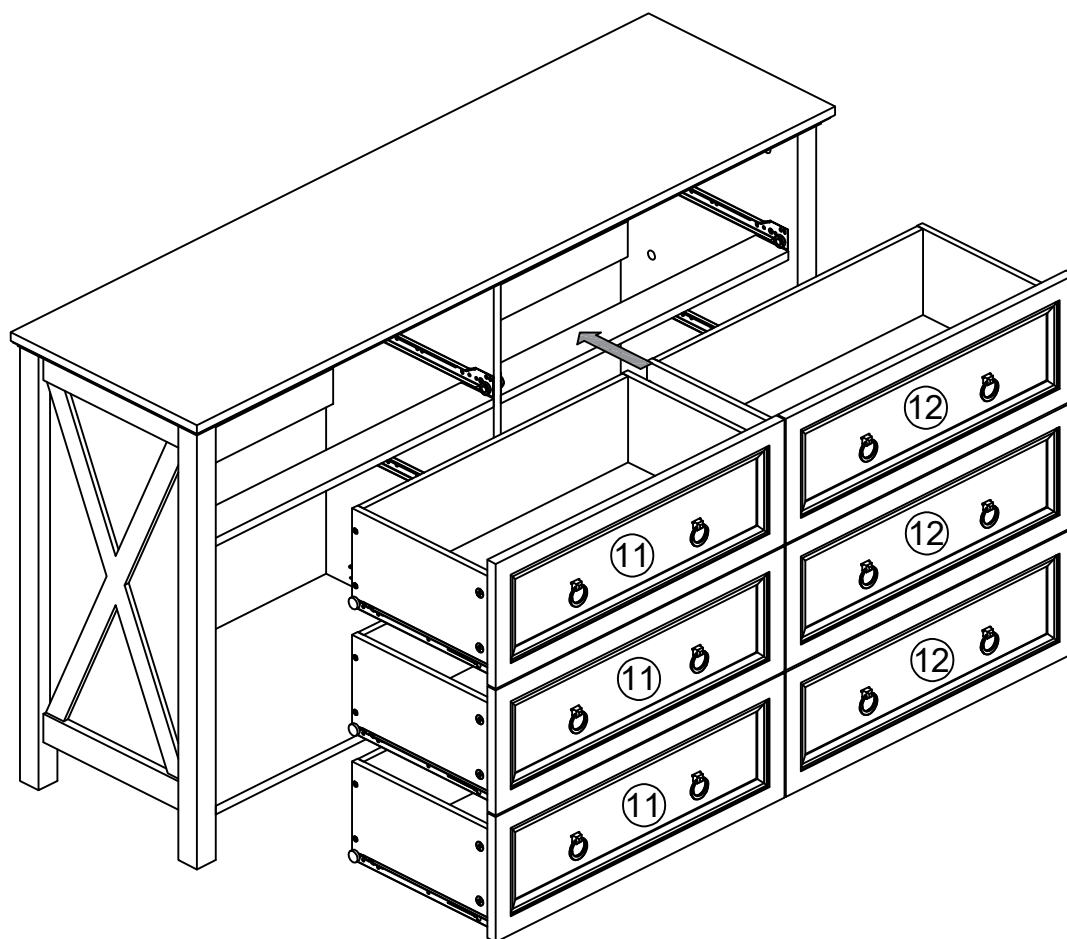

## Step 19

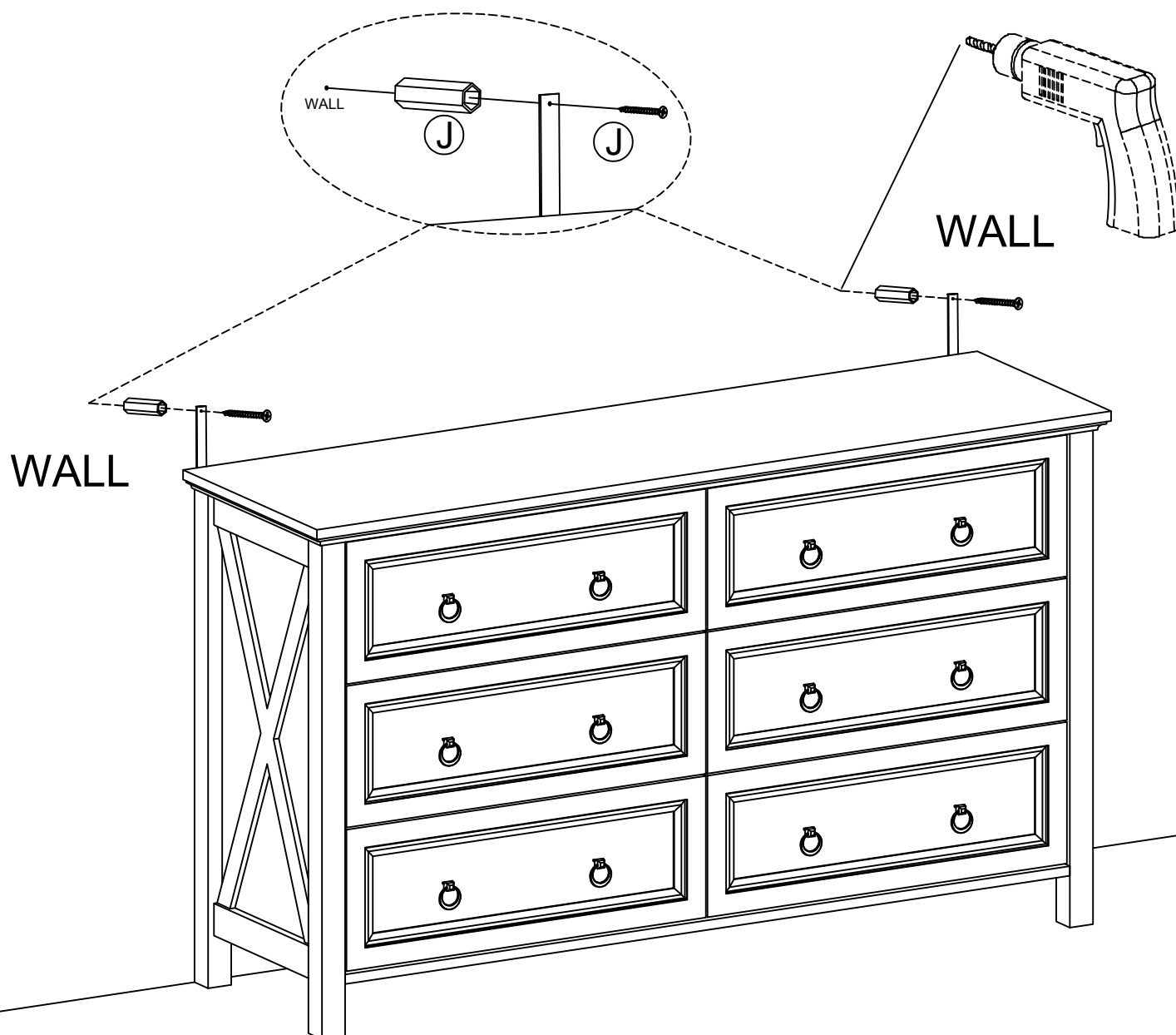
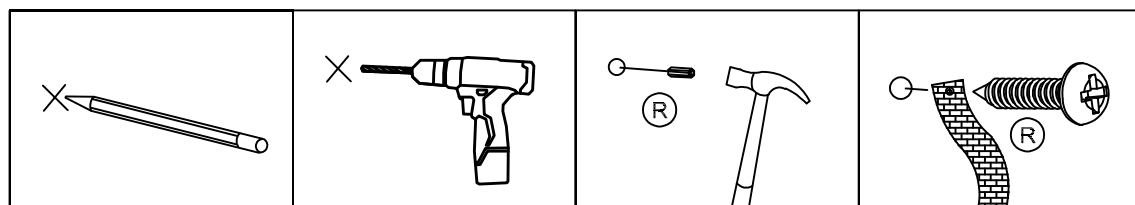

The furniture must permanently be fixed to the wall using the provided anti-tipping device to prevent it from tipping over.

- Mark the drill positions on the wall with a pencil.
- Drill a small hole on the marked positions.
- Insert a wall anchor into the drilled hole.
- Fix the anti-tipping strap to the wall using the provided screws.