

Project		Catalog #		Type	
Prepared by		Notes		Date	



Metalux

LHB Selectable

1.6ft LED Linear Highbay
CCT and Lumen Select

Typical Applications

• Light Commercial • Warehouse • Large Open Areas • Retail

Interactive Menu

- Order Information page 2
- Product Warranty

Product Certification



Product Features



Top Product Features

- (3) CCT and lumen select option provide application versatility
- Replaces up to 400W MHL or 8-lamp T8 equivalent (256W)
- Durable lightweight steel with rigid upper channel
- Standard diffused lens for added protection and glare control
- 0-10V dimming control down to 10%
- Ideal for high ceilings up to 35ft

Dimensional and Mounting Details

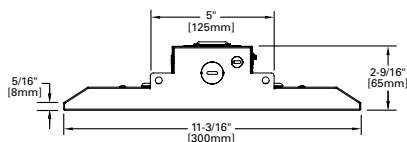

LHBS-1218C3R

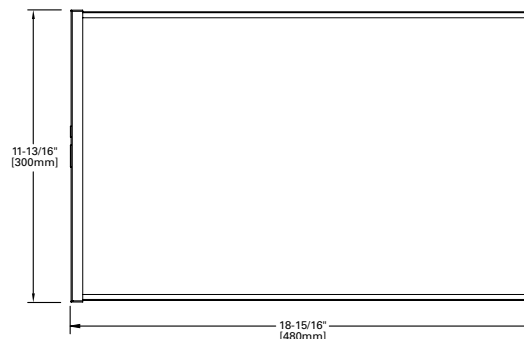
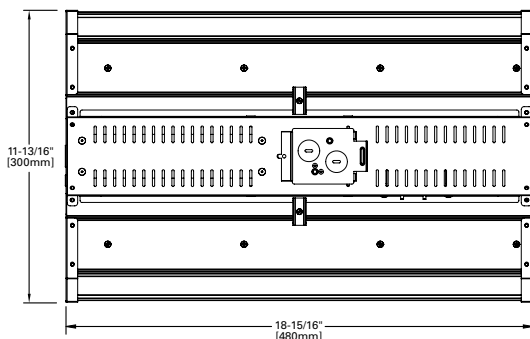

Mounting

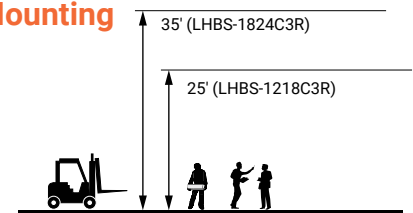

additional product diagrams

Product Information

Default CCT/Lumen Setting: 4000K / Med Power

Catalog Number	UPC	CRI (Min)	Lumen Setting	Nominal CCT (K)	Nominal Lumens	Watts	Efficacy (lm/W)
LHBS-1218C3R	080083277506	80	Low	3500	12008	79	152
				4000	12246	78	157
				5000	12320	80	154
			Medium	3500	14751	99	149
				4000	15288	98	156
				5000	15352	101	152
			High	3500	17255	119	145
				4000	18445	119	155
				5000	18300	122	150
LHBS-1824C3R	080083277520	80	Low	3500	17612	119	148
				4000	18018	117	154
				5000	18120	120	151
			Medium	3500	20440	140	146
				4000	21114	138	153
				5000	20868	141	148
			High	3500	23023	161	143
				4000	24016	158	152
				5000	23652	162	146

Lumen Maintenance

Ambient Temperature	TM-21 Lumen Maintenance (60,000 hours)	Theoretical L70 (Hours)
25°C	> 87.98%	> 163,000

Shipping Data

Catalog No.	Wt.	Units per Pallet
LHBS-1218C3R	7.1 lbs.	78
LHBS-1824C3R	7.1 lbs.	78

Energy Data

	LHBS-1218C3R	LHBS-1824C3R
PF	0.97	0.97
THD %	<20%	<20%
Low Temp Start	-40°C	-40°C

Product Specifications

Construction

- Full body construction with upper channel
- Die formed code gauge steel for added durability and thermal control

Electrical

- 120-277V electronic driver, Class B
- Standard 0-10V dimming to 10%
- 0-10V dimming uses low-voltage grey and purple wire leads
- Default CCT/Lumen setting is 4000K and Med Power

Optics

- UV stabilized acrylic lens covers LEDs
- Diffused lens provides added protection and glare control
- Medium to wide area coverage and distribution
- Lens is IK08 rated for impact protection

LED and Light Engine

- LED's are ≥80 CRI and comply with IESNA LM-79 and LM-80 standards.
- CCT Selectable option available for maximum color flexibility: choose from 3500K, 4000K or 5000K
- Lumen select switch provides three lumen package choices: Low, Medium, High

Mounting

- Includes Chain, V hanger and carabiner clips (already fixed on the chains).
- Great for mounting heights between 25 to 35ft high

Finish

- Standard white polyester powder coat finish painted after fabrication

Compliance and Certifications

- cULus listed for damp location
- Operating ambient temps -40°C to 40°C (-40°F to 104°F)
- DesignLights Consortium Qualified, refer to www.designlights.org for details

Product Warranty

- 5-year limited warranty

Dimensional and Mounting Details

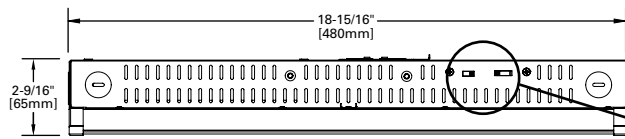

Lumen/
Color Select
Switches

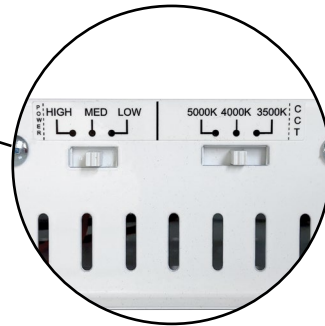

Mounting

