

## SPECIFICATIONS

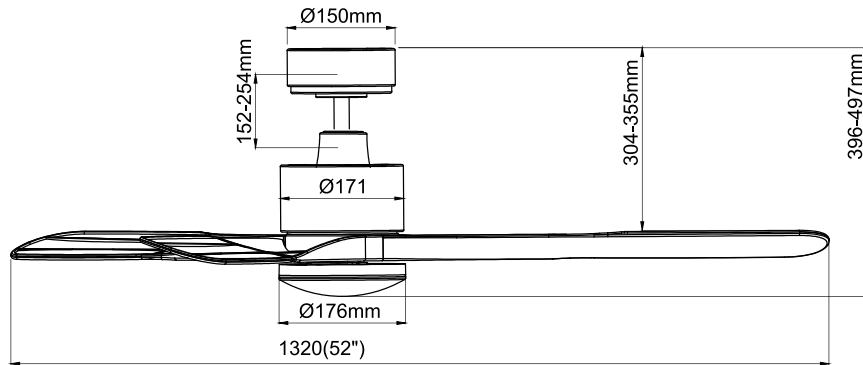

Product Name	Ceiling Fan
Rated Voltage	110V~120V
Motor Power	39W
Wind Speed Level	1~6
Control Method	ALEXA, GOOGLE, APP, Remote Control
N.W & G.W.	N.W. = 12.1lbs; G.W. = 14.3 lbs
Length of Downrods	6" & 10"
Type of Motor	DC
Sound Level	30dB
Fan Material	Durable 3 ABS Plastic Fan Blades

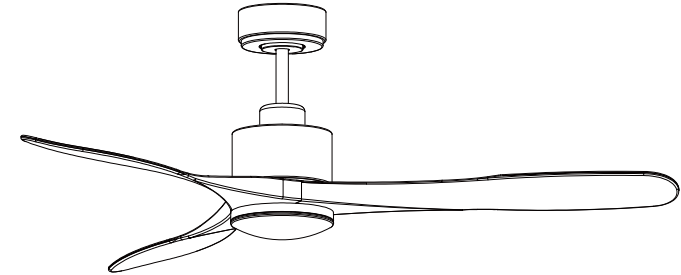

Model: YJ668

## Instruction Manual

CONTACT INFORMATION We want to hear from you!

Feel free to contact us if you have any problems using our product(s) or would like to know more about our brand.

We will be more than happy to provide you with first class pre-sales & after-sales service 24/7.

E-mail: [Cumilo-ceilingfan@foxmail.com](mailto:Cumilo-ceilingfan@foxmail.com)

## SAFETY INFORMATION:



### WARNING

·Before connecting the power supply,make sure that the power supply used matches the specifications of the ceiling fan.

·All wiring must comply with national and local electrical codes ANSI/NFPA70. If you are not familiar with wiring,plase use a qualified electrician.

·To reduce the risk of fire or electric shock, turn off the power to the fuse box or circuit breaker before installing the fan.

·To reduce the risk of personal injury, attach the fan directly to the building's support structure.

·Make sure that the installation location allows the fan blades to rotate without obstacles.

### CONTENTS:

<b>SAFETY INFORMATION</b>	<b>01</b>
<b>FAN STRUCTURE DRAWING</b>	<b>03</b>
<b>INSTALLATION INSTRUCTION</b>	<b>04</b>
<b>REMOTE CONTROL MANUAL</b>	<b>09</b>
<b>APP CONTROL MANUAL</b>	<b>10</b>
<b>SMART APP CONNECTION INSTRUCTION</b>	<b>11</b>
<b>VOCIE COMMAND</b>	<b>13</b>
<b>SPECIFICATIONS &amp; TROUBLESHOOTING</b>	<b>14</b>

## TROUBLESHOOTING:

### PLEASE CHECK THE FOLLOWING BEFORE LODGING A SERVICE REPORT

PROBLEM	REASON	SOLUTION
Fan not moving	1) Main cables not connected. 2) Check the line wires.	1) Check mains & sub circuit breakers or fuse. 2) Check the line wires connections to the fan & switch housing.
Fan noisy	1) Housing screw loose. 2) Wire nut connections rattles against each other. 3) Canopy touches the ceiling.	1) Tighten all screws. 2) Separate & store neatly all the wire nut connections. 3) Check & ensure the canopy is not touching or too close to the ceiling.
Remote control not working	1) Remote & receiver pairing out. 2) Battery not installed. 3) Battery weak.	1) Pairing required – follow page 9 , clause 2. 2) Install the remote control battery. 3) Change new battery.

## Alexa/Google assistant Connection Instruction & Voice Command

### Alexa Connection Instruction

- Make sure you have connected the device to the app and working normally.
- Open Alexa app, go to the skill to search "Tuya Smart" skill.
- Link the skill, log in with your Tuya Smart app account and password, then authorize and connect with Tuya Smart app.
- Then the Alexa will find out the device automatically.

### Google Assistant Connection Instruction

- Make sure you have connected the device to the app and working normally.
- Open Google Home app, Set up a device, choose "Works with Google".
- Search "Tuya Smart", log in with your Tuya Smart app account and password then authorize and connect with Tuya Smart app.
- Then the Google Assistant will find out the device automatically.

### Note:

- Connect the device to the App recommend to turn on WIFI and Bluetooth on your phone.
- This ceiling fan needs to use 2.4Ghz WIFI to work when you connecting the device.

## Common Voice Command:

- "**Alexa/Google, turn on/off the fan/light.**" (Use for turn on / turn off the fan/light)
- "**Alexa, set the direction to summer/winter.**" (Use for Forward/Reverse the fan)
- "**Alexa/Google, set the fan speed to level (which number of speed level you want).**"

**OR "Alexa/Google, set the fan to (which number of speed level you want) speed."**  
(Use for wind speed level)

Such as, "Alexa, set the fan speed to level 1. / Alexa, set the fan to 6 speed."

- "**Alexa/ Google, set the light to (which mode that you want).**" (Use for color temperature of light)

Such as, "Alexa, set the light to Warm white. (warm yellow light)

/Alexa, set the light to Soft white. (the light comes up a little yellow)

/Alexa, set the light to White. (neutral light)

/Alexa, set the light to Daylight white. (the light comes up a little white )

/Alexa, set the light to Cool white. (cool white light)"

- "**Alexa/Google, set/change the light to (how many percent that you want).**"  
(Use for brightness of light)

Such as, "Alexa, set the light to 80%./Google, change the light to 50%."

## MAINTENANCE TIPS:



### WARNING

Do not install the fan with wet hands.

Do not insert foreign objects between the rotating fan blades.

Do not bend the fan blades when installing or cleaning the fan.

Do not disassemble or modify this product or use non-original parts without permission.

Keep children away from your working area.

Properly dispose of the fan's packaging material. Make sure the ceiling fan is firmly secure to the ceiling. Double check all connections before you restore power. Turn off the fan and wait for the blades to stop completely before performing any maintenance or cleaning.

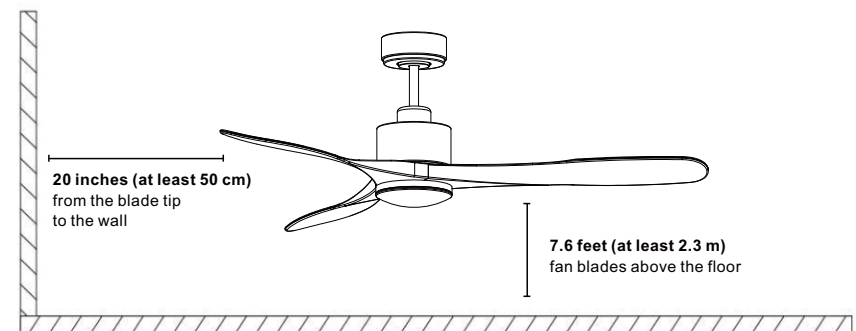

## FAN STRUCTURE DRAWING:

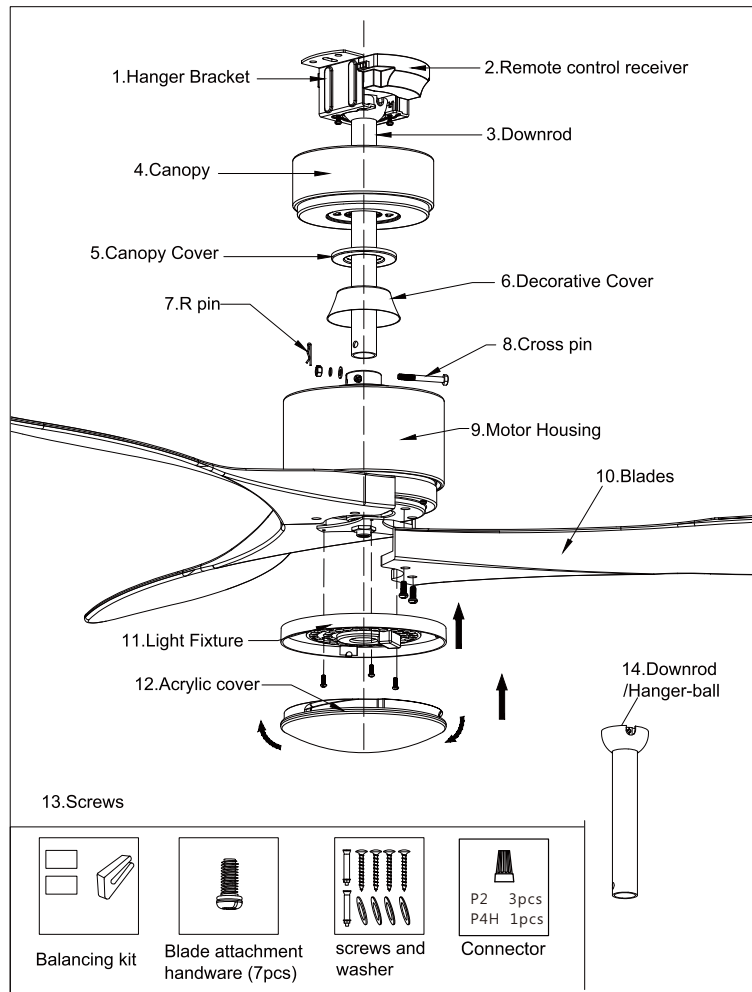

### TOOLS THAT MAY BE USED DURING INSTALLATION :

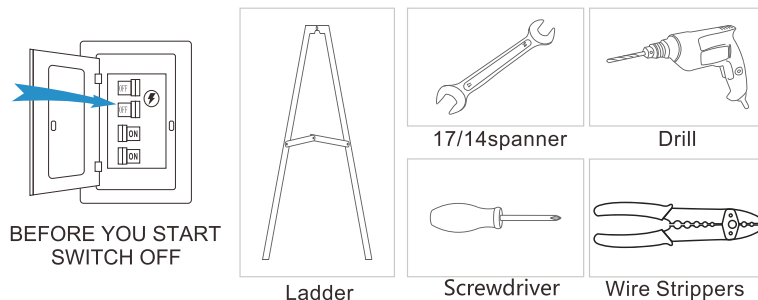

### ADD MANUALLY (WIFI ON & BLUETOOTH OFF)

1. Open "TUYA" smart APP and then Click "Add device" on the APP Page
2. Then Under "Add Manually" SELECT "Small Home Appliances"
3. Then Select "Fan(WI-FI)" (Fig 4) and Type in your WIFI code & password (Fig 5)
4. Turn on the Fan power within 30 seconds, Press the "1H" key on the remote for at least 5 seconds.
5. Then Click "Confirm the indicator is blinking" on the APP page and then Select "Blink Quickly".
6. Waiting for connection and Clicking "Done" on the APP page.  
(Note: if the ceiling fan is not searched, please make sure the 2.4 Ghz WIFI & Bluetooth are on and the network is stable; if the ceiling fan is disconnected within 3 mins please retry to pair the fan by repeating step 1.
7. Then the following page shown (Fig 6) you could operate normally with the page.

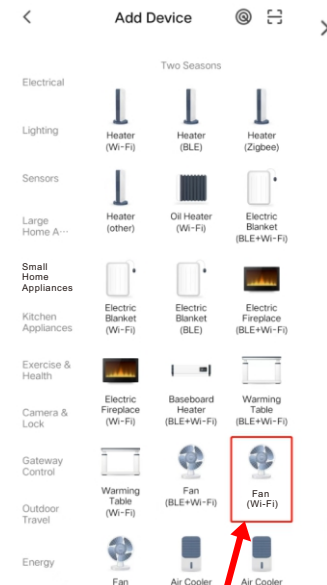

( Fig 4 )

### Select 2.4 GHz Wi-Fi Network and enter password.

If your Wi-Fi is 5Ghz, please set it to be 2.4Ghz. [Common router setting method](#)

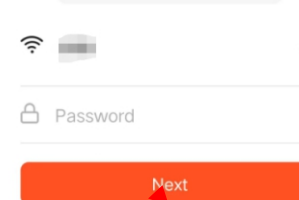
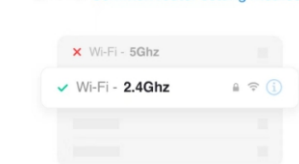

( Fig 5 )

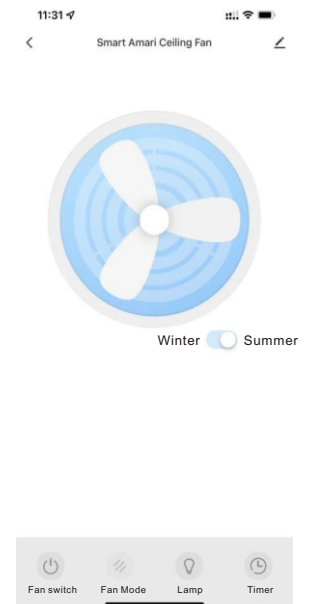

( Fig 6 )

# SMART APP CONNECTION INSTRUCTION



Scan the QR code and download “TUYA” smart APP.  
(The ceiling fan needs work at 2.4 GHz WIFI to connect the device)

[If you have any question, please refer to more detail about our APP & CEILING FAN CONNECTION INSTRUCTION]

## ADD automatically (WIFI & BLUETOOTH both on) --RECOMMENDED

1. Open TUYA smart APP & Turn on the Fan power supply within 30 seconds, Press the button of “1H” on the remote for at least 5 seconds until hearing 2 or more beep sounds.
2. Then Click “Add device”(Fig 1) on the APP Page.
3. Then click “Add” (Fig 2) and wait for the connection(Fig 2) (Note: if the ceiling fan is not searched, please make sure the 2.4 Ghz WIFI & Bluetooth are on and the network is stable; if the ceiling fan is disconnected within 3 mins please retry to pair the fan by repeating step 1.)
4. After connecting successfully, then click “next”.
5. After that, then click “Finish” to enter the interface.
6. Then the following page is shown (Fig 3) you could operate normally with the page.

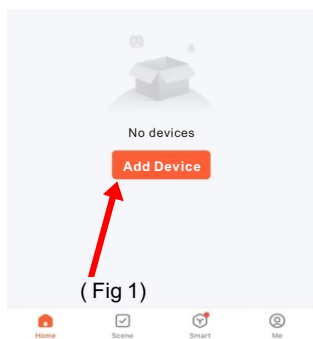

( Fig 1)

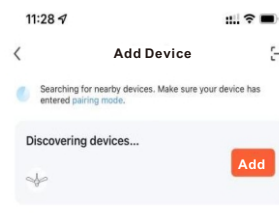

( Fig 2)

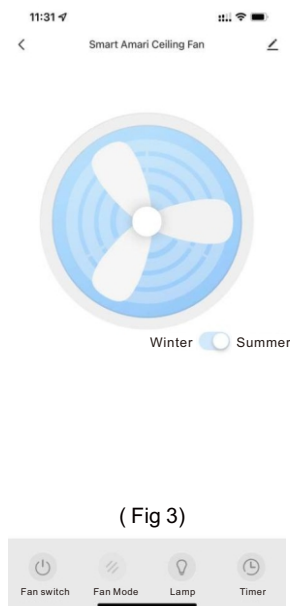
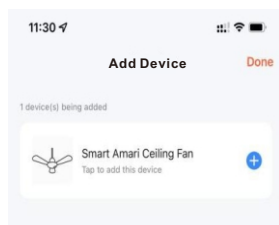

( Fig 3)

## 1. INSTALLATION OF HANGER BRACKET:

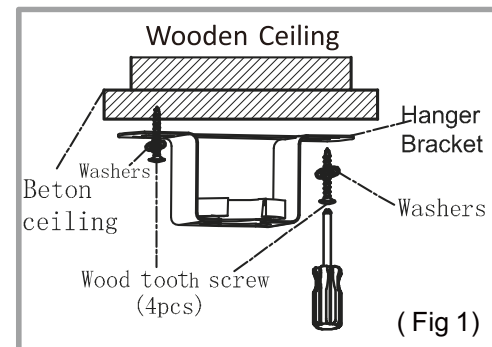

### HARDWARE USED



Wooden Ceiling:  
fasten the hanger bracket to the ceiling with 4 wood tooth screws.

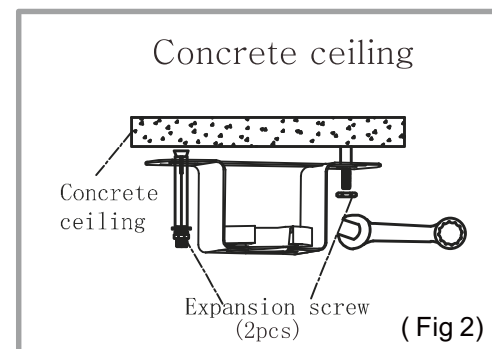

### HARDWARE USED



Concrete ceiling:  
Use the expansion screw to fix the hanger bracket to the ceiling.

## 2. INSTALLATION OF FAN BLADES & LIGHTKIT

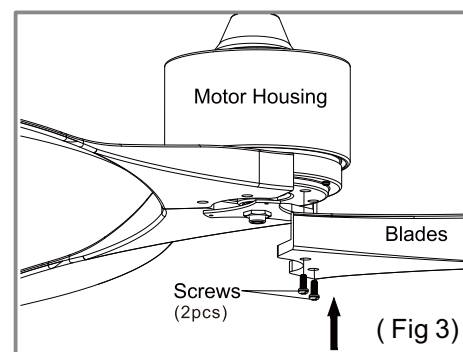

Attach blades to the motor. Align the holes of blade and motor. Using screws from hardware package and tighten each screw securely.  
(fig 3)

## APP CONTROL MANUAL

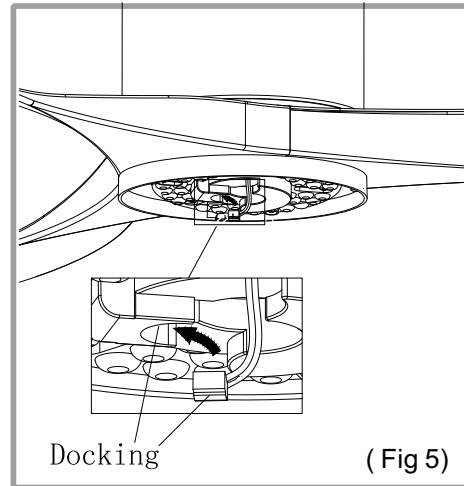
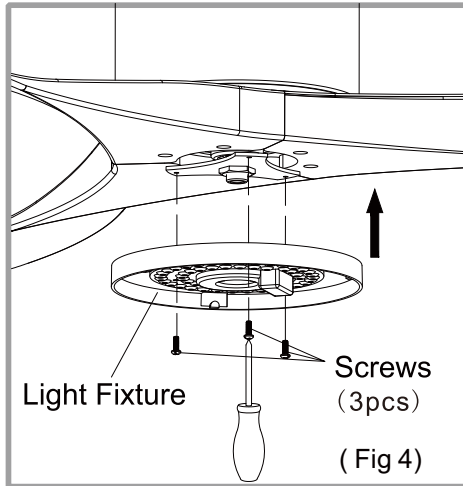

- 1) Remove three screw from the motor round piece. (Fig 4)
- 2) Fix the light kit with the 3 screws. (Fig 4)
- 3) Connect the motor line to the panel line. (Fig 5)

### 3.INSTALLATION OF DOWNROD / HANGER BALL:

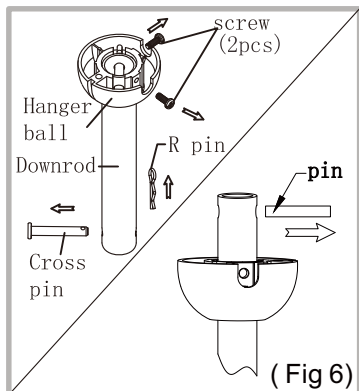

1. Remove the screw and pin from the hanger ball; Remove the "R" pin and and cross pin from the downrod. (Fig 6)

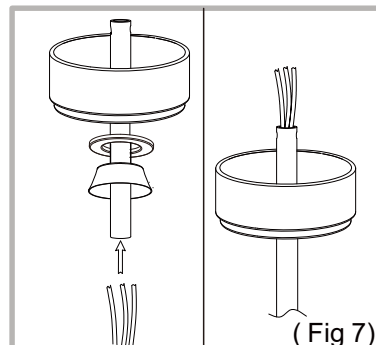

2. Select a suitable downrod. put the canopy and the decorative through the downrod, then put the wire through the downrod. (Fig 7)

**Set up for FAN ON/OFF**

Switch ON Mode custom

**Set up for Wind Speed Level**

- Speed Level 1(Slowest)
- Speed Level 2
- Speed Level 3
- Speed Level 4
- Speed Level 5
- Speed level 6(Fastest)

**4 Modes of Fan Mode**

- Natural: The speed set up to levels 1- 5 be automatic circulation.
- Sleep: The wind blowing makes people feel comfortable when people sleep.
- Fresh: The speed set up level 1.
- Smart: The speed set up level 2.

**Set up for Timer, you could set it exactly to how many hours and how many minutes to shut down**

TimedShutdown • 2h

**Setup for fan direction (Forward/Reverse)**

Fan direction forward reverse

**Setup for Light ON/OFF**

Light

**You could set up from darkest to brightest**

**As you click the dimmer, the page will be come out, you could set up Brightness and color temperature.**

**You could setup schedule whatever you want.**

**Also, you could Setup Color Temperature from 1 to 100**

**TopBar Title**

White Warm Cool Night

Brightness • 100

Color Temperature • 0

16 10

17 11

18 12

Repeat Once >

Note >

Notification >

Switch ON >

Light ON >



## REMOTE CONTROL MANUAL (BUTTON FUNCTION):

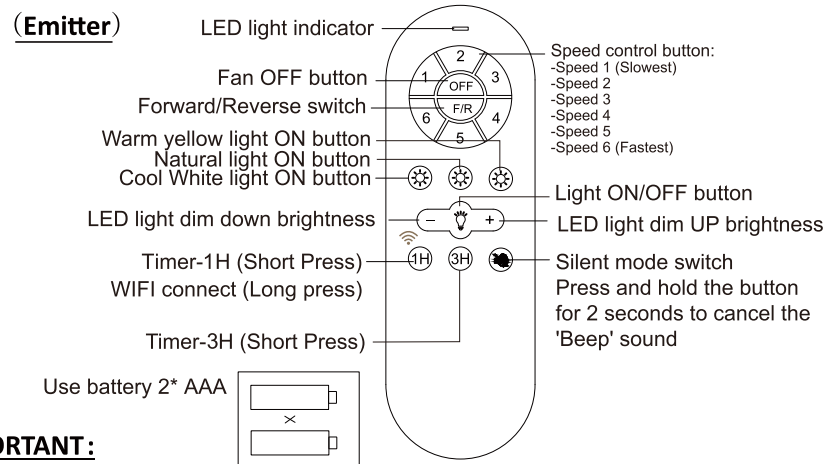

### IMPORTANT:

1. Learning code matching mode is used between emitter and receiver. Turn "ON" the supply power within 30 second sand press the emitter's "OFF" button for 5 seconds, it can load normally after hearing a long sound "bee", which means learning successfully and it can works normally.(PS: Learning mode is not accepted after turn "ON" the supply power for 30 seconds)
2. When the emitter cannot control the receiver, please check the battery switch touching normally or not, correction of the positive and negative, full or empty of the power.
3. When the emitter cannot control the receiver, please check is there any existence of similar remote controlled products nearby, then check whether they works, because remote controlled product with the same frequency will disturb each other.
4. Low voltage of battery will affect the sensitivity of the emitter and the signal reception accordingly(the indicated light will be dimmed when the battery get low voltage).must replace if the battery is getting low voltage.
5. Please take out the battery from the emitter when leaving unused for long time.
6. The maximum load of lighting see the above"POWER PARAMETER LIST"PS: please connect the ground wire correctly, otherwise it may cause the light micro-light or flash
7. When installing the fan, the fan ceiling cover don't press the antenna(or other wire),it is easy to break down the wire and short-circuited.
8. The APP Linking method.(Only Intellectual product)  
Turn on the supply power within 60 seconds and Press the emitter's 'WiFi Pairing' button for 5 seconds, until hear continuous 'bee' sound.

## 3. INSTALLATION OF DOWNROD / HANGER BALL:

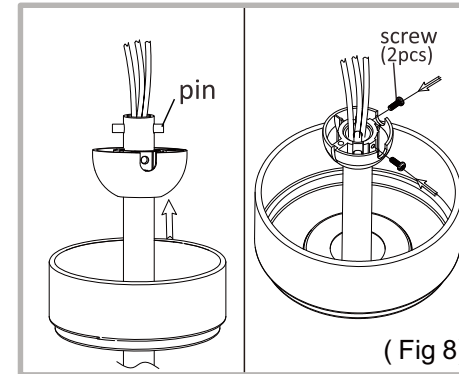

3. Install back the screws and pin to the hanger ball , ensure to fasten the screws.  
( Fig 8)

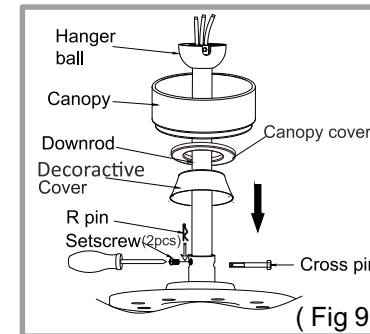

4. Loosen the two setscrews in the download support, and lock The cross pin with the "R" pin, and tighten back the two screws. (Note: The wire might block the cross pin slightly)

\*The "R" pin must be properly installed to prevent the cross pin from working loose.\*  
( Fig 9)

## 4. HANGING OF CEILING FAN:

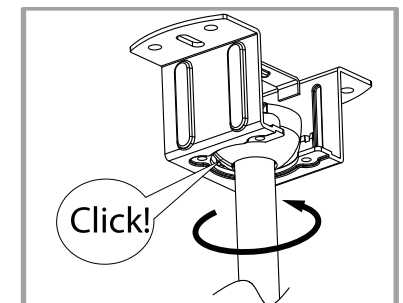
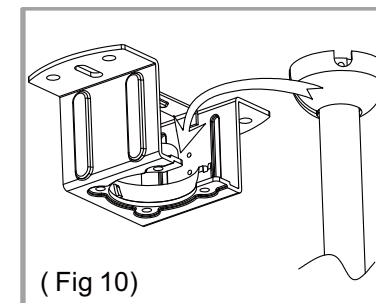

Lift the assembled fan onto the hanger bracket. Ensure the concave groove of the hanger ball is positioned on the hanger lug of the hanger bracket.

## 5. WIRING OF CEILING FAN :

Total six colors of wires connected from the top of the motor:

- \* White, Black, Yellow - wires for lightkit
- \* Black(L1), Red(L2), Brown(L3) – live wire for fan
- \* Green – ground wire

The installation is to be in accordance with the National Electrical Code ANSI/NFPA 70 and local codes.

### HARDWARE USED



wire  
connectors  
P2 3pcs  
P4H 1pcs

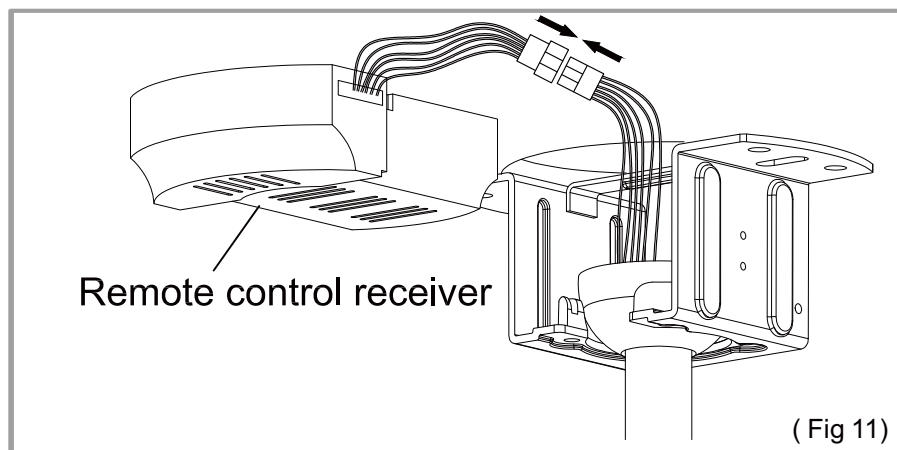

1) Connect the ceiling fan cord to the receiver.

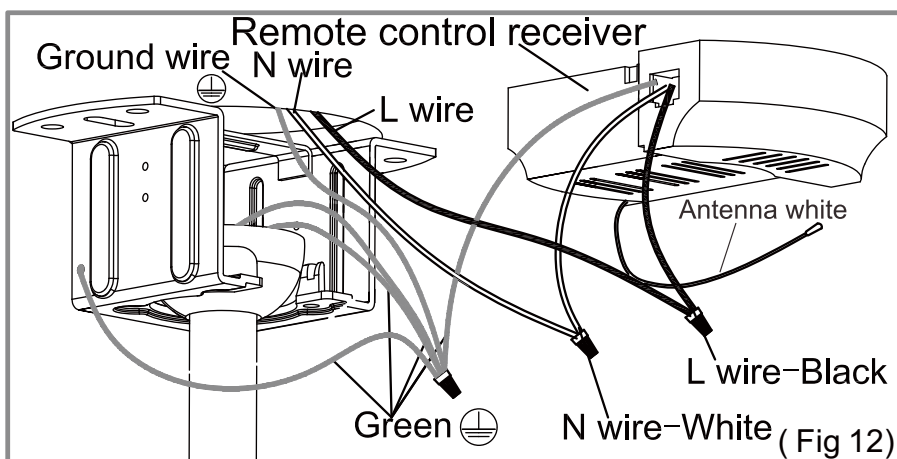

2) Connect the wires of remote control receiver to AC wires (Household supply): Green to Ground, White to Neutral, Black to Live.

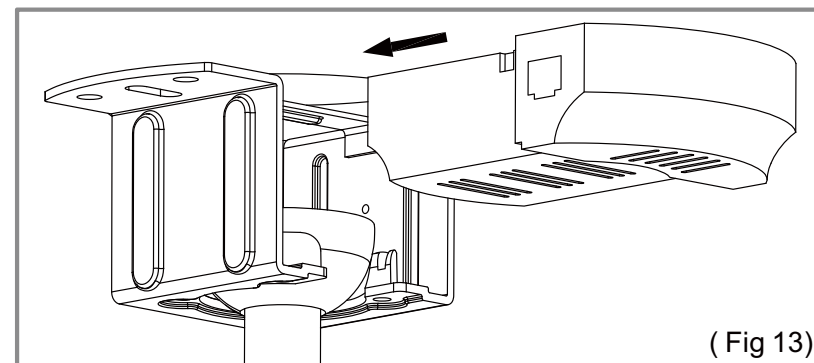

3) Tidy up the wire and put the receiver into the hanger bracket.

## 6. INSTALLATIONS OF CANOPY & LIGHTCOVER:

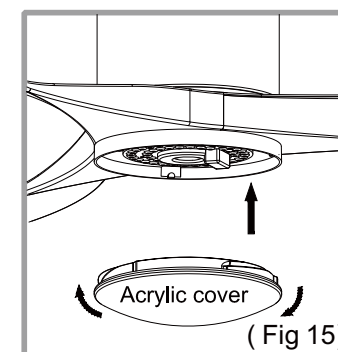
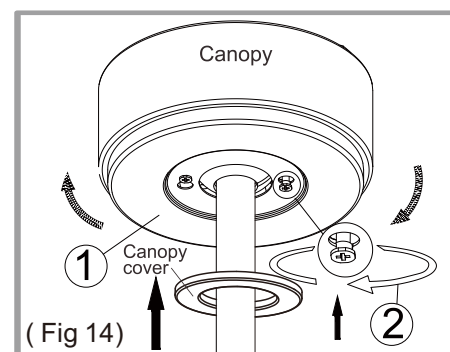

1) Please rotate all the wires around the hanger bracket in the same direction to tuck all wires into the canopy. Then, rotate the canopy and tighten the screws into two right holes. (Fig 14)

2) Attach the canopy cover with magnet to the canopy. (Fig 14)

3) Rotate the light cover until fixed. (Fig 15)