

LIFT RECLINER

“

*When you drag your tired body,
exhausted all the energy, back home.*

*If you have our recliner chair
with upholstery fabric and stylish
appearance,*

*I believe
that our chair can quickly help you
relieve the fatigue state,
and rejuvenated.*



INSTALLATION INSTRUCTIONS

PACKAGE PARTS

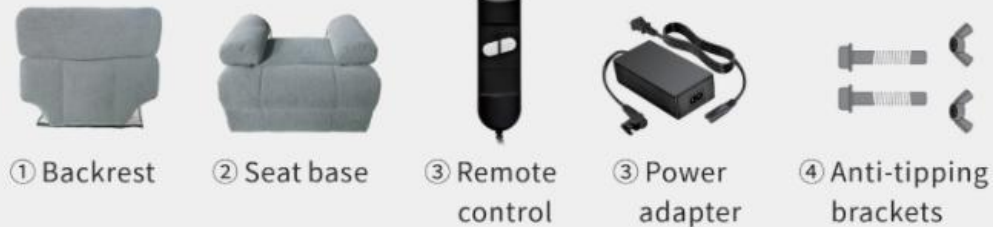

SOFA INSTALLATION

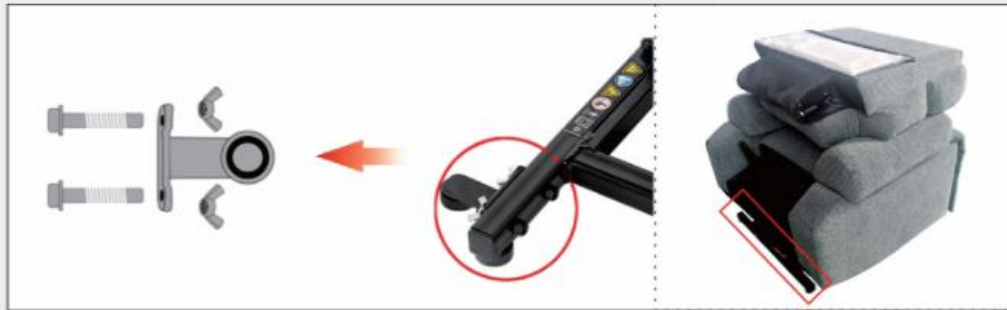

Step 1: Install the anti-tipping brackets.



Step 2: Place the backrest as shown above. Then insert to the seat base.

(Please check whether both metal inserts slide successfully before next step.)



Step 3: Align the metal inserts and install the backrest firmly.

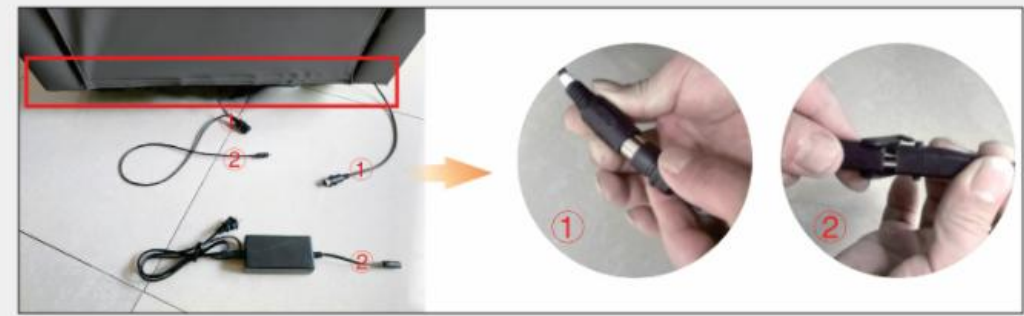

Step 4: Connect relative cords for the remote and power adapter.
(There are 2 cords/jacks at the back of the seat base. ① is for the remote and ② is for power adapter.)

MAINTENANCE



- To avoid being damaged, please carry and move the sofa carefully.
- Wipe the dirt or dust away with sponge or clean cloth gently.
- Keep away from direct-sunlight area or air-conditioner.

WARNING



Keep kids away from the chair when in use.



No sitting on the back or extended footrest.



No sitting on the arm.



No jumping.
No standing up when the chair is reclined.

CUSTOMER SERVICE

- For any need during installation & use, please reach us through the platform

